

## KVR400D2D8R3/2G

### 2GB 256M x 72-Bit DDR2-400 CL3

### Registered 240-Pin ECC DIMM

#### DESCRIPTION:

This document describes ValueRAM's 256M x 72-bit 2GB (2048MB) DDR2-400 CL3 SDRAM (Synchronous **DRAM**) "dual rank" registered ECC memory module. The components on this module include eighteen 128M x 8-bit (16M x 8-bit x 8 Bank) DDR2-400 SDRAM in FBGA packages. This 240-pin DIMM uses gold contact fingers and requires +1.8V. The electrical and mechanical specifications are as follows:

#### FEATURES:

- |                                                 |                               |
|-------------------------------------------------|-------------------------------|
| ✓ Clock Cycle Time (tCK) CL=3                   | 5ns (min.) / 8ns (max.)       |
| ✓ Row Cycle Time (tRC)                          | 55ns (min.)                   |
| ✓ Refresh to Active/Refresh Command Time (tRFC) | 127.5ns                       |
| ✓ Row Active Time (tRAS)                        | 40ns (min.) / 70,000ns (max.) |
| ✓ Single Power Supply of                        | +1.8V (+/- .1V)               |
| ✓ Power                                         | 3.725 W (operating)           |
| ✓ UL Rating                                     | 94 V - 0                      |

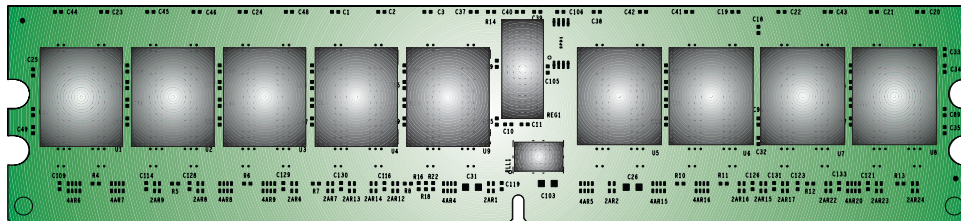

COMP SIDE

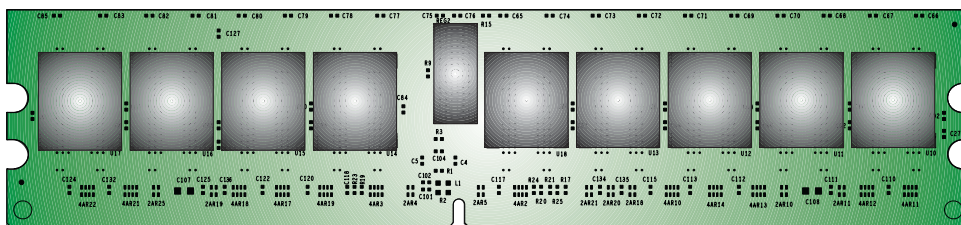

SOLDER SIDE - MIRRORED

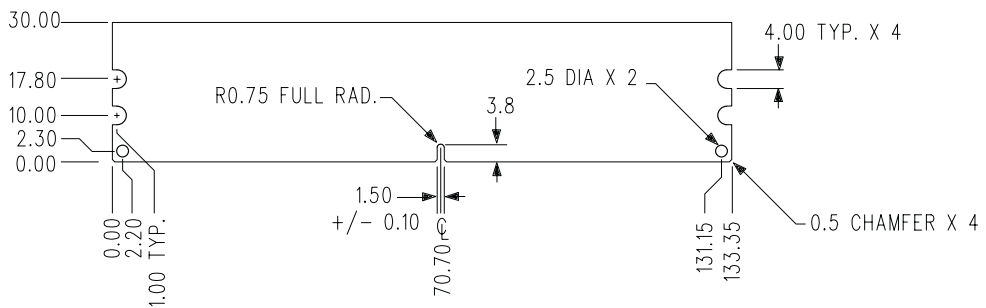

Figure 1: KVR400D2D8R3/2G 240-Pin DIMM