

## KVR400D2D4R3/2GI

### 2GB 256M x 72-Bit DDR2-400

### CL3 Registered 240-Pin ECC DIMM

#### DESCRIPTION:

This document describes ValueRAM's 256M x 72-bit 2GB (2048MB) DDR2-400 CL3 SDRAM (Synchronous **DRAM**) "dual rank" registered ECC "Intel certified" memory module. The components on this module include thirty-six 128M x 4-bit (32M x 4-bit x 4 Bank) DDR2-400 SDRAM in FBGA packages. This 240-pin DIMM uses gold contact fingers and requires +1.8V. The electrical and mechanical specifications are as follows:

#### FEATURES:

☑ Clock Cycle Time (tCK) CL=3	5ns (min.) / 8ns (max.)
☑ Row Cycle Time (tRC)	55ns (min.)
☑ Refresh to Active/Refresh Command Time (tRFC)	105ns
☑ Row Active Time (tRAS)	40ns (min.) / 70,000ns (max.)
☑ Single Power Supply of	+1.8V (+/- .1V)
☑ Power	7.525 W (operating)
☑ UL Rating	94 V - 0

**Note:** The module defined in this data sheet is one of several configurations available under this part number. While all configurations are compatible, the DRAM combination and/or the module height may vary from what is described here. However, in no configuration will the module height exceed 1.250" (31.75mm).

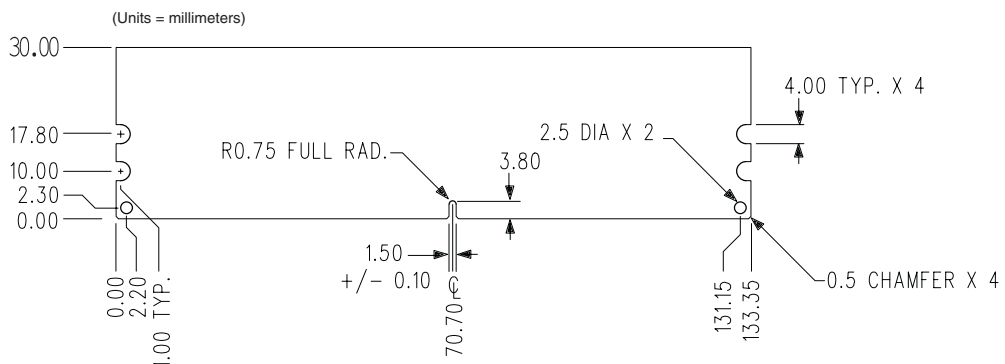
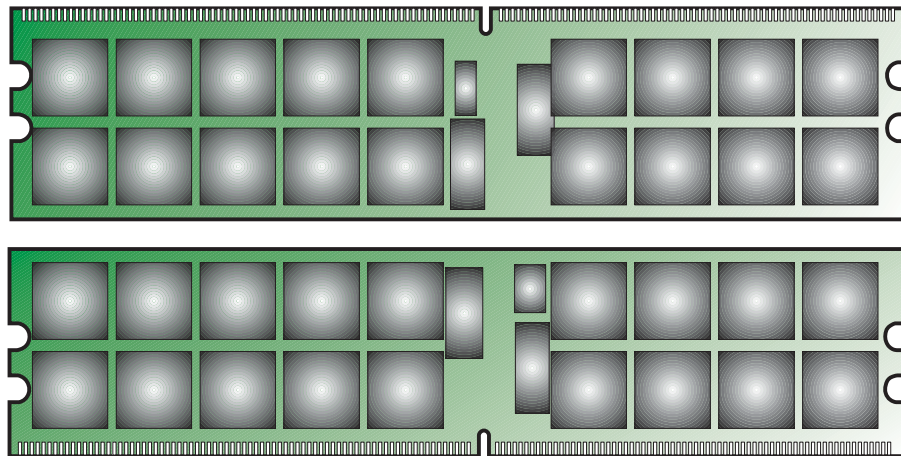

**Figure 1: KVR400D2D4R3/2GI 240-Pin DIMM**