

Philips
Home cinema speakers



HTS3111



Add great surround sound to your TV

Obsessed with sound

Enjoy amazing TV entertainment and surround sound with your Blu-ray or DVD player without the clutter of multiple speakers. This home theatre speaker is a great companion for the TV by either mounting on the wall, or putting it on a tabletop.

Great listening experience

- DoubleBASS technology for fuller and deeper bass
- Dolby Digital and DTS for great surround sound

Designed to enhance your cinema at home

- Curved SoundBar design for a wider sound dispersion
- Designed to prevent dust build-up and reduce sound distortion
- Flexible placement on the wall, tabletop or stand

Simply enjoy all your entertainment

- Easily connect your devices for an enhanced TV experience
- MP3 Link plays music from portable media players

PHILIPS

Highlights

DoubleBASS technology



DoubleBASS ensures you hear even the deepest bass tones from compact-sized subwoofers. It captures low frequencies and recreates them in the audible range of the subwoofer - delivering sound with more boom and panache, and ensuring you get a full, uncompromised listening experience.

Dolby Digital and DTS

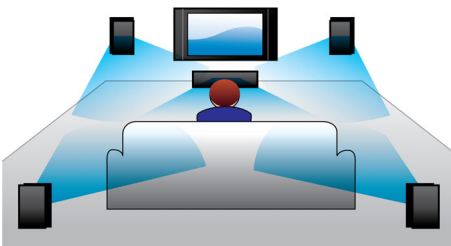

Go digital and get the most out of your music and movies. Even stereo music sounds great because Dolby Digital and DTS Digital Surround enhance digital music and videos, pumping it up so you get truly immersive surround sound out of your home cinema speaker.

Curved SoundBar design

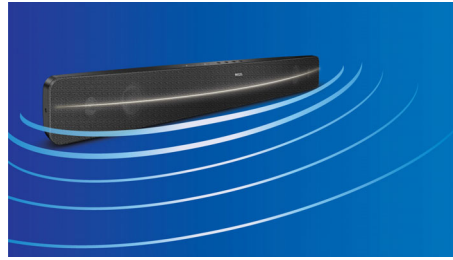

Curved SoundBar design for a wider sound dispersion

Optimised sound quality



Special dust-resistant mesh material protects the speakers from any dirt that may affect sound dispersion.

Flexible placement

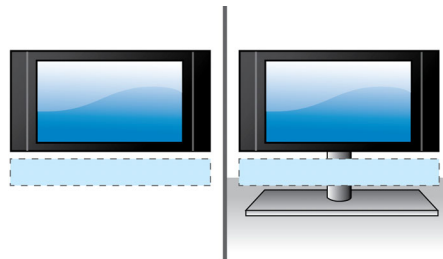

Enjoy the versatility of this home theatre system that allows you to place it where you want. Whether on a TV stand, on a table or mounted on a wall, the product looks sensational and functions without compromise. For once, you get to control how

your home looks without giving up an incredible home theatre experience.

Easily connect your devices



Not only will TV broadcasts now sound better, all the devices that are linked to your TV will also sound sensational. Designed to give you hassle-free entertainment, the connection is made in one step. All your devices that are linked with your home theatre can be enjoyed on your TV to enhance your TV experience, giving you vibrant, clear and rich tones for awesome music and movie moments.

MP3 Link

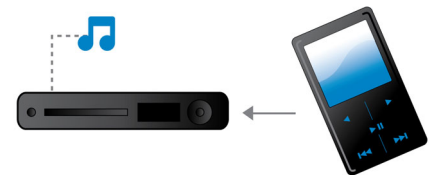

MP3 Link allows playback of MP3 files directly from your portable media player on your home theatre system. Simply connect your portable MP3 player to the built-in MP3 Link jack and enjoy your MP3 music in the superior sound quality delivered by the Philips home theatre system. MP3 Link brings your portable music into the comfort of your living room.

Specifications

Accessories

- Compatible accessories: 2.5 cm Screw x 2, Wall plug x 2
- Included accessories: 1 x CR2025 Battery, Power cord, Quick start guide, Remote Control, User Manual, Wall mount bracket, World Wide Warranty leaflet

Connectivity

- Front/Side connections: MP3 Link
- Rear Connections: AUX in, Digital coaxial in, Digital optical in

Dimensions

- Main Unit (W x H x D): 945 x 93 x 58 mm
- Main Unit Weight: 1.7 kg
- Subwoofer (W x H x D): 123 x 309 x 369 mm
- Subwoofer Weight: 3.81 kg
- Subwoofer cable length: 4 m
- Packaging (W x H x D): 1010 x 487 x 186 mm
- Weight incl. Packaging: 9.8 kg

Loudspeakers

- Loudspeaker types: Integrated with main unit

- Speaker Drivers per side: 1 x 1.5" tweeter, 1 x 2.5" woofer
- Speaker Frequency Range: 150–20k Hz
- Speaker Impedance: 4 ohm
- Tweeter Impedance: 4 ohm
- Subwoofer type: Passive
- Subwoofer driver: 1 x 6.5" woofer
- Subwoofer freq range: 20–150 Hz
- Subwoofer impedance: 3 ohm

Power

- Power consumption: 20 W
- Power supply: 110-127 V/220-240 V, ~50-60 Hz
- Standby power consumption: <1 W

Sound

- Sound Enhancement: Dolby Digital Prologic II, DoubleBass, Night Mode, Treble, Mid and Bass Control
- Sound System: Dolby Digital 5.1, DTS Digital Surround
- Speaker output power: 30 W x 2
- Subwoofer output power: 40 W
- Total Power RMS @ 30% THD: 100 W



Issue date 2013-09-14

Version: 16.4.13

12 NC: 8670 000 71582
EAN: 87 12581 58036 0

© 2013 Koninklijke Philips N.V.
All Rights reserved.

Specifications are subject to change without notice.
Trademarks are the property of Koninklijke Philips N.V.
or their respective owners.

www.philips.com