



LCD Monitor Quick Start Guide

DesignVue Designer Monitor | PD Series



DN:PD05Q-EQ-V0

© 2020 BenQ Corporation. All rights reserved. Rights of modification reserved.

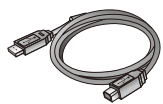
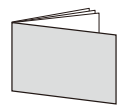
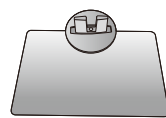
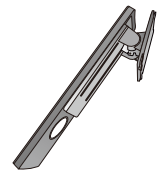
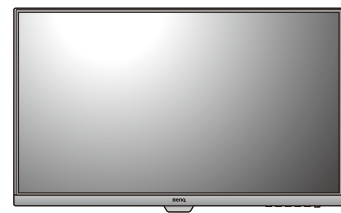
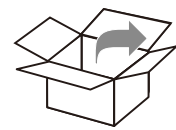
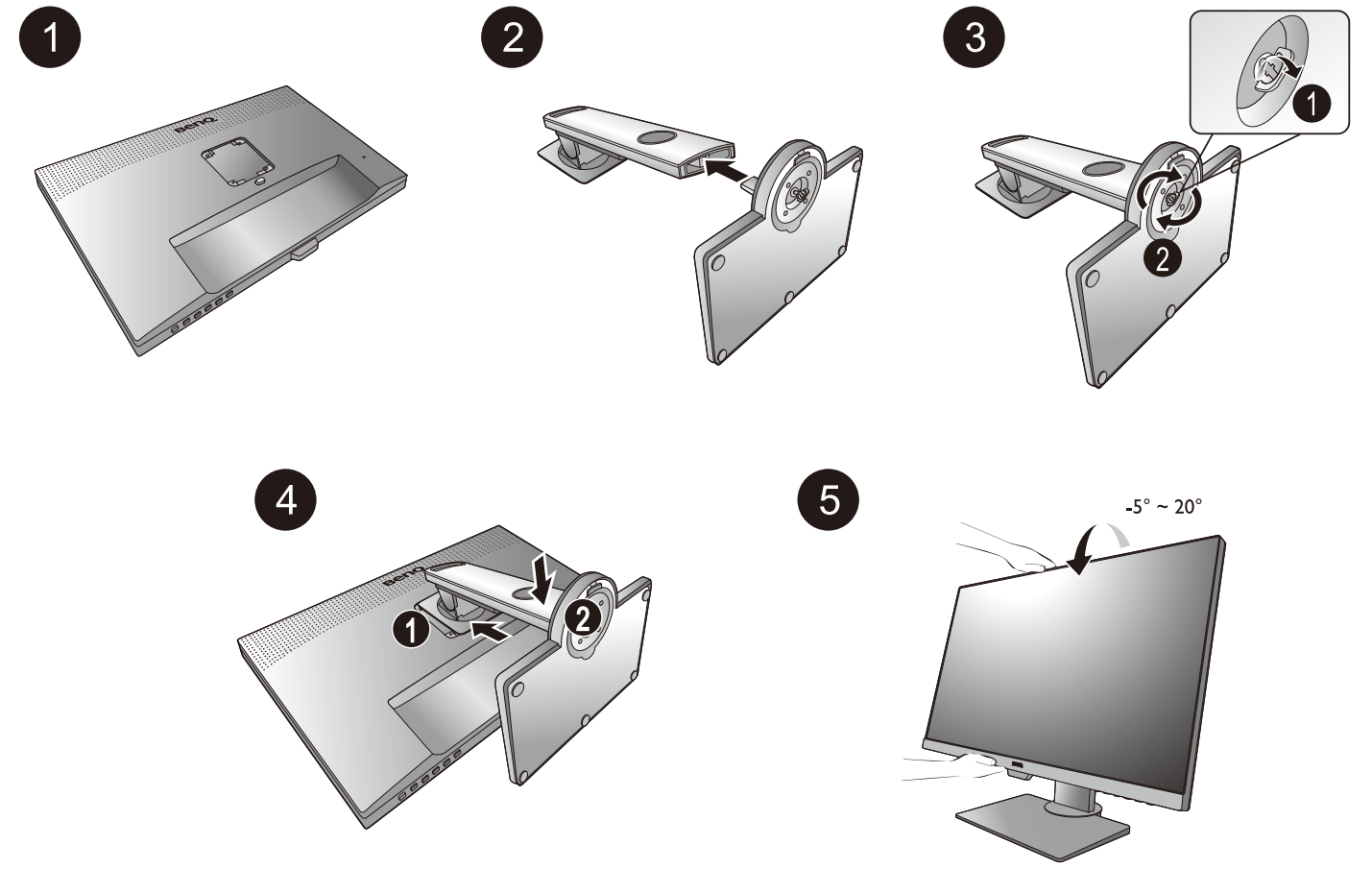

USB

USB-C™

DP

HDMI (optional)

- 6 Video
- 7 Audio
- 8 USB

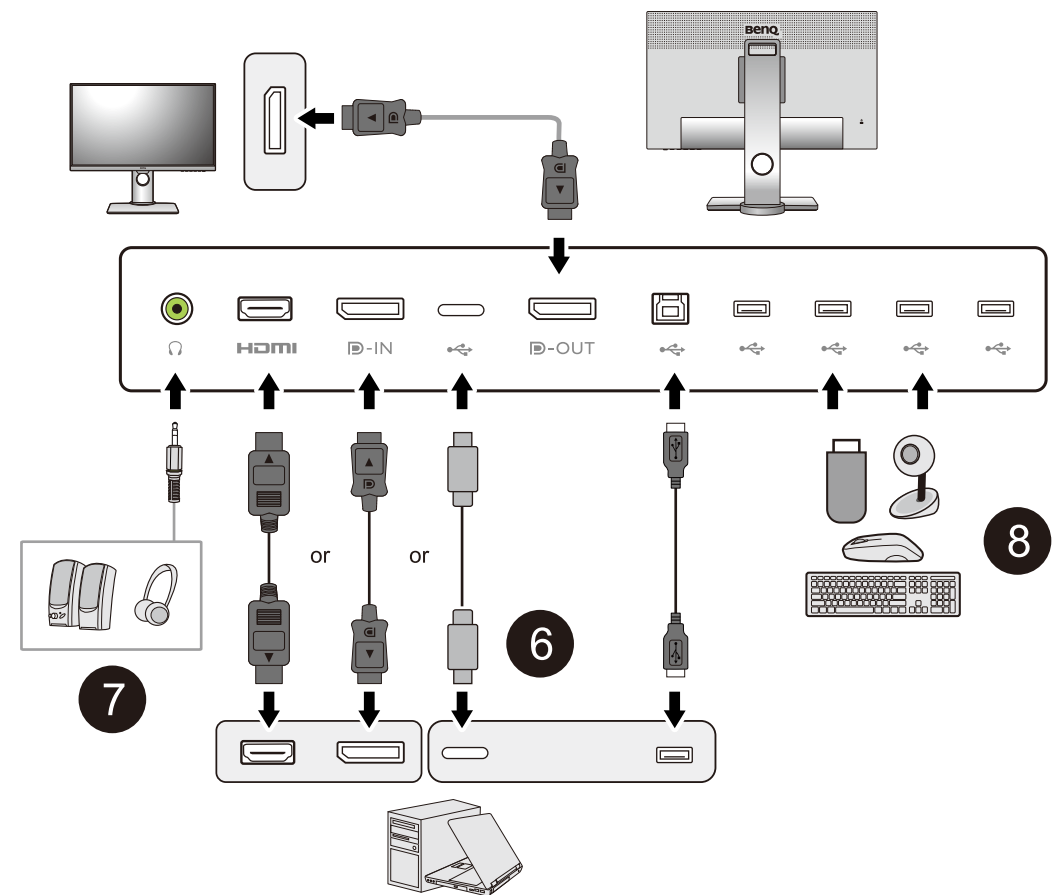

9

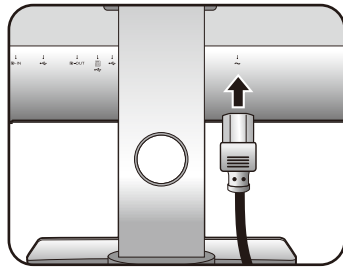

10

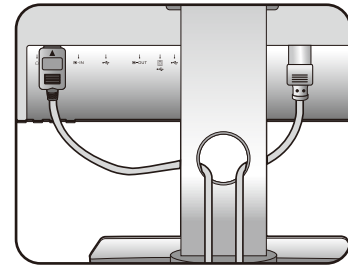

11

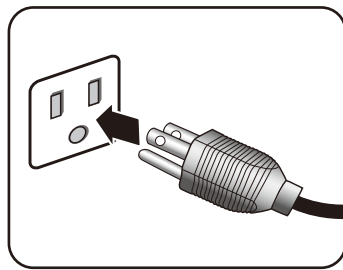

12

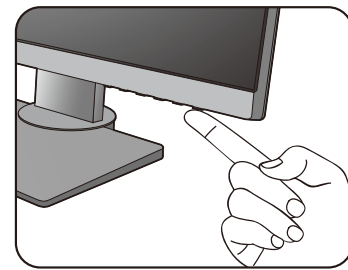

Connecting multiple monitors via MST (Multi-Stream Transport)

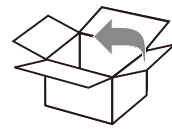
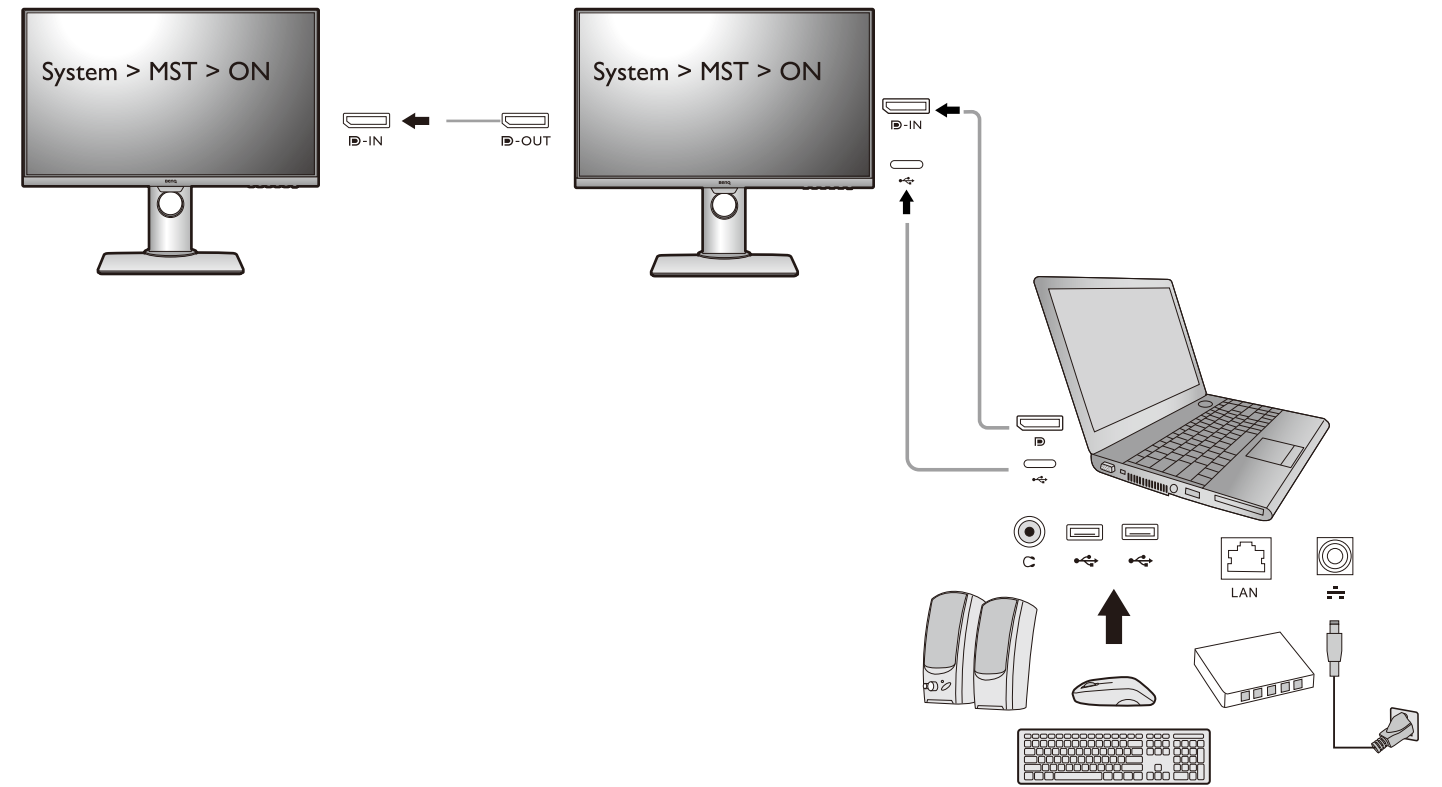

1

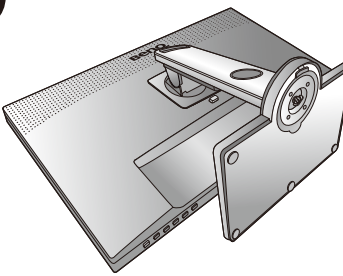

2

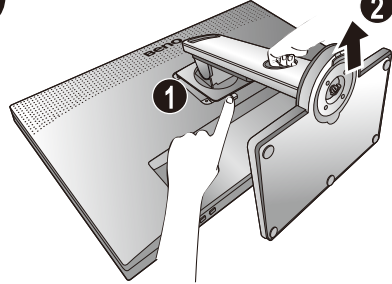

3

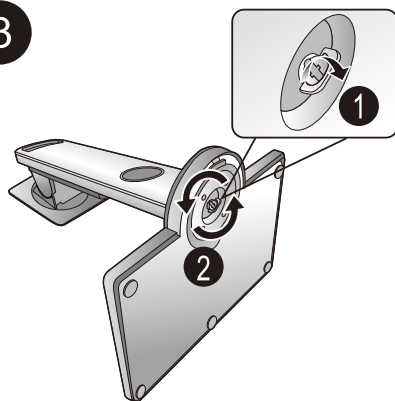

4

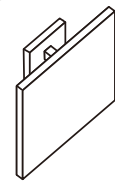
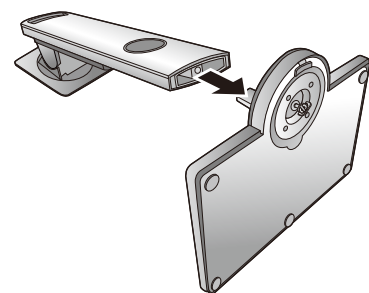

1

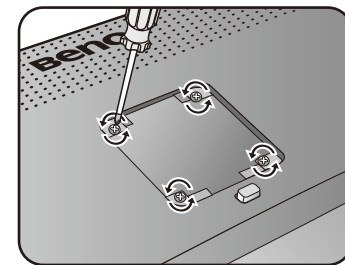

M4 x 10 mm

2

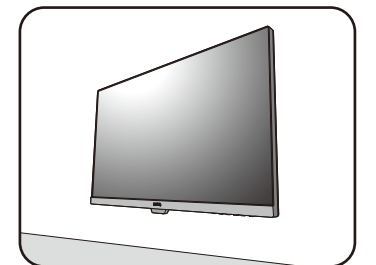

www.BenQ.com > Support > Download & FAQ > Model name > User Manual

For product support and more information.

