

VGA EDID Emulator

2A-130G

User Guide

© Copyright 2010 ATEN® International Co., Ltd.
ATEN and the ATEN logo are trademarks of ATEN International Co., Ltd. All rights reserved. All other trademarks are the property of their respective owners.

This product is RoHS compliant.

Printing Date: 08/2010

Package Contents
1 2A-130G VGA EDID Emulator

A Hardware Overview

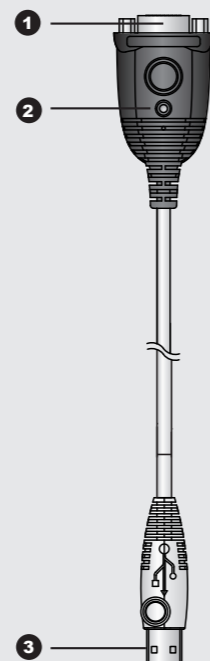

B Hardware Installation

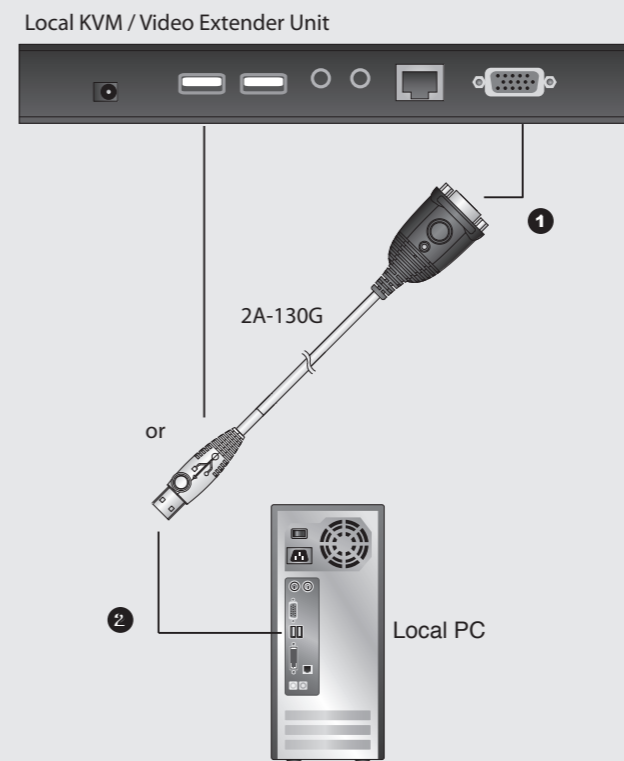

FCC Information
This equipment has been tested and found to comply with the limits for a Class B digital device, pursuant to Part 15 of the FCC Rules. These limits are designed to provide reasonable protection against harmful interference in a residential installation. This equipment generates, uses and can radiate radio frequency energy, and if not installed and used in accordance with the instruction manual, may cause interference to radio communications. However, there is no guarantee that interference will not occur in a particular installation. If this equipment does cause harmful interference to radio or television reception, which can be determined by turning the equipment off and on, the user is encouraged to try to correct the interference by one or more of the following measures:

- Reorient or relocate the receiving antenna;
- Increase the separation between the equipment and receiver;
- Connect the equipment into an outlet on a circuit different from that which the receiver is connected;
- Consult the dealer/an experienced radio/television technician for help.

Online Registration

International:
<http://support.aten.com>
North America:
http://www.aten-usa.com/product_registration

Technical Phone Support

International:
886-2-86926959
North America:
1-888-999-ATEN Ext: 4988
United Kingdom:
44-8-4481-58923

The following contains information that relates to China:

部件名称	有毒有害物质或元素				
	铅	汞	镉	六价铬	多溴联苯/多溴二苯醚
电器部件	○	○	○	○	○
结构部件	○	○	○	○	○

○: 表示该有毒有害物质在该部件所有均质材料中的含量均在SJ/T 11363-2006规定的限量要求之下。
●: 表示符合欧盟的豁免条款, 但含有有毒有害物质至少在部件的某一均质材料中的含量超出SJ/T 11363-2006的限量要求。
×: 表示该有毒有害物质至少在该部件的某一均质材料中的含量超出SJ/T 11363-2006的限量要求。



Hardware Review

1. VGA Connector
2. Power LED
3. USB Connector (Power only)

Hardware Installation

The 2A-130G is designed for ATEN KVM extender or video extender installations that do not utilize a local monitor at the site where the computer/ video source is located. The 2A-130G emulates and stores a default ATEN EDID (Extended Display Identification Information).

1. Plug the 2A-130G's VGA connector into the local monitor's VGA port on your local KVM extender or video extender unit.
2. Plug the 2A-130G's USB connector into any available USB port on your local Extender or computer. This provides power to the 2A-130G.
3. Connect the rest of your ATEN KVM extender or video extender installation according to the installation instructions in the User Guide.

Compatible Extenders

The 2A-130G works with the following ATEN KVM extenders and video extenders:

- CE700A, CE750, CE770, CE800b, CE350, CE370, VE150, VE200

Supported Resolutions

Standard Timings Supported	
640 x 480p	at 60Hz IBM VGA
800 x 600p	at 60Hz VESA
1024 x 768p	at 60 Hz VESA
Extra Timings Supported	
1600 x 1200p	at 60Hz – VESA STD
1280 x 1024p	at 60Hz – VESA STD
1152 x 920p	at 66Hz – VESA STD
1440 x 900p	at 60 Hz – VESA STD
1680 x 1050p	at 60Hz – VESA STD
1920 x 1080p	at 60Hz – VESA STD
1280 x 800p	at 60Hz – VESA STD
1920 x 1200p	at 60Hz – VESA STD

Specifications

Function		2A-130G
Connectors	Video	1 x HDB-15 Male (Blue)
	Power	1 x USB Type A Male
LEDs	Power	1 (Green)
Video		1920 x 1200@60Hz
Cable Length		0.35 m
Power Consumption		DC5V, 0.06W
Environment	Operating Temp.	0–50°C
	Storage Temp.	-20–60°C
	Humidity	0–80% RH, Non-condensing
Physical Properties	Housing	Plastic
	Weight	42 g
	Dimensions (L x W x H)	6.59 x 3.40 x 1.60 cm