

# Dreame Bot W10 **Pro**

## Self-Cleaning Robot Vacuum and Mop





## Advanced obstacle avoidance with AI Action.

1. AI Action autonomously perceives obstacles and avoids them.
2. LiDAR navigation plans the optimal route.
3. AI custom cleaning automatically recognizes the room type and adjusts cleaning accordingly.



## Vacuums and mops.

1. 4,000Pa suction with 19.2cm ultra-wide brush picks up dirt and debris.
2. Mops spin at 180RPM with 10N of continuous downward pressure to remove grime.
3. Ultrasonic carpet detection identifies carpets in advance.



## Mop cleaning and hot air drying.

1. Mops are automatically washed without manual intervention.
2. Hot air dries the mops to prevent mildew or bacteria growth.



## Large capacity for huge coverage.

1. Equipped with a 4.5L super large clean water and a 4L waste water tank.
2. A huge 6,400mAh battery delivers up to 170 minutes of continuous cleaning.



## Additional features for convenient cleaning.

1. D-shaped build vacuums along walls and into corners.
2. Voice control to start and stop cleaning with a word.
3. 18mm obstacle-crossing.
4. Anti-collision and anti-fall technology.
5. Auto-return to recharge and clean, resuming from where cleaning left off.

# Superior Obstacle Avoidance



## AI Action combines with 3D ToF.

AI Action with 3D ToF technology identifies, recognizes, and intelligently decides how to clean around obstacles. This enables W10 Pro to learn from its daily cleaning tasks and recognize household items that may impede floor cleaning (cables, shoes, slippers, socks, etc.).

	Power Cable	Socks	Shoes	Scale	Chair Legs
Distance	12cm	6cm	3cm	3cm	3cm

(Chart 1\*)

\*Chart 1: Tested by Dreame lab, actual performance will vary based on different home environments.

# Route optimization with LiDAR navigation.

Using the AI camera, W10 Pro not only identifies obstacles in its path, but also accurately estimates their position and size. LiDAR navigation allows W10 Pro to bypass obstacles and follow the optimal route.



# Real-time video with AI Camera.\*

A high-definition camera, remote control, and real-time whole-house cruising makes it easy to take control of your cleaning. Send clear voice recording at the same time you view the video feed to interact with people or pets remotely.



\*AI Camera: The video function is only supported by the Dreamhome app. It is disabled by default and needs to be turned on manually via a physical button. The video will not be stored on the server. The video function is planned to go online through OTA.



# AI custom cleaning.

Automatically recognizes the room type and sets the cleaning method.

AI automatically detects the room type, and sets the corresponding suction power, mop dampness, and cleaning times according to different areas. Get stronger suction on carpeted rooms or moister mopping in rooms with hard floors for the ideal clean throughout your home—without having to do a thing.

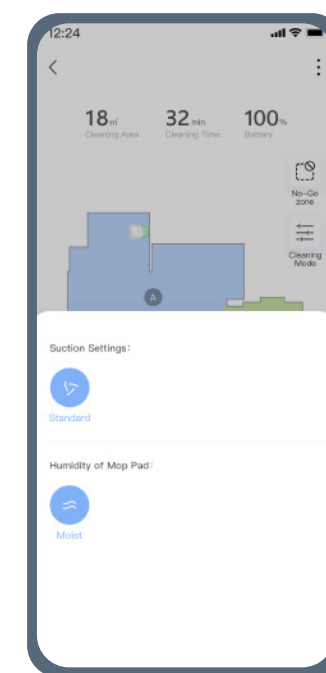

Cleaning App Version 1.0

Only one cleaning method.

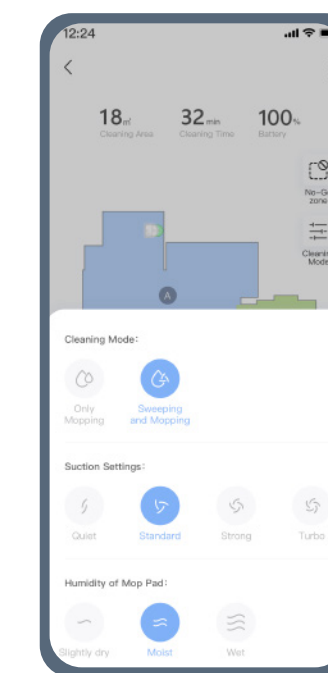

Cleaning App Version 2.0

Allowed for manual adjustment of the cleaning method.



Cleaning App Version 3.0 (Current)

Provides intelligent analysis and automatic adjustment.

Scenes	Bedroom	Living Room	Balcony/Corridor	Bathroom	Kitchen/Dining Room
Suction Power	Quiet	Standard	Standard	Strong	Strong
Mop Dampness	Standard	Wet	Standard	Dry	Wet
Cleaning Time	1	1	1	1	2

(Chart 2\*)

\*Chart 2: Tested by Dreame lab, actual performance will vary based on different home environments.

# Vacuuming and Mopping 2-In-1



## Powerful vacuuming.

### 1. Powerful 4,000Pa suction cleans deeply.

Easily cleans up large particles and fine dust. 4 levels of suction, which can be adjusted according to the dirtiness of the floor.

### 2. 19.2cm ultra-wide brush for broader sweeping.

Compared with the ordinary (17cm) roller brush, it has a broader sweeping range and covers larger areas.

### 3. Tangle-free brush design.

A comb-like design mitigates tangled hair and makes it easier to clean.

### 4. 450ml large dust tank holds more dirt and debris.

No need to frequently empty the dustbin, making cleaning even easier.

# Thorough mopping.

## 5. Dual rotary mops with strong downward pressure.

The dual rotary mops are pressed closely to the floor, allowing them to rotate at an impressive 180RPM with 10N of continuous downward pressure. Powerful enough to easily clean dust, lint, juice stains, coffee stains, and more.

## 6. Multi-layered composite material mop.

Composite material made of tendon cloth and sponge cloth absorbs and locks in liquid, leaving no water stains. Strong, durable, and easy to clean.

## 7. Water level control for better mopping.

Select from three water volume options in the app to suit different cleaning needs and ensure impressive mopping performance.

## 8. Vacuum/mopping route display.

Distinguishable route display for vacuum and mopping, helping you to know the cleaning state at a glance.

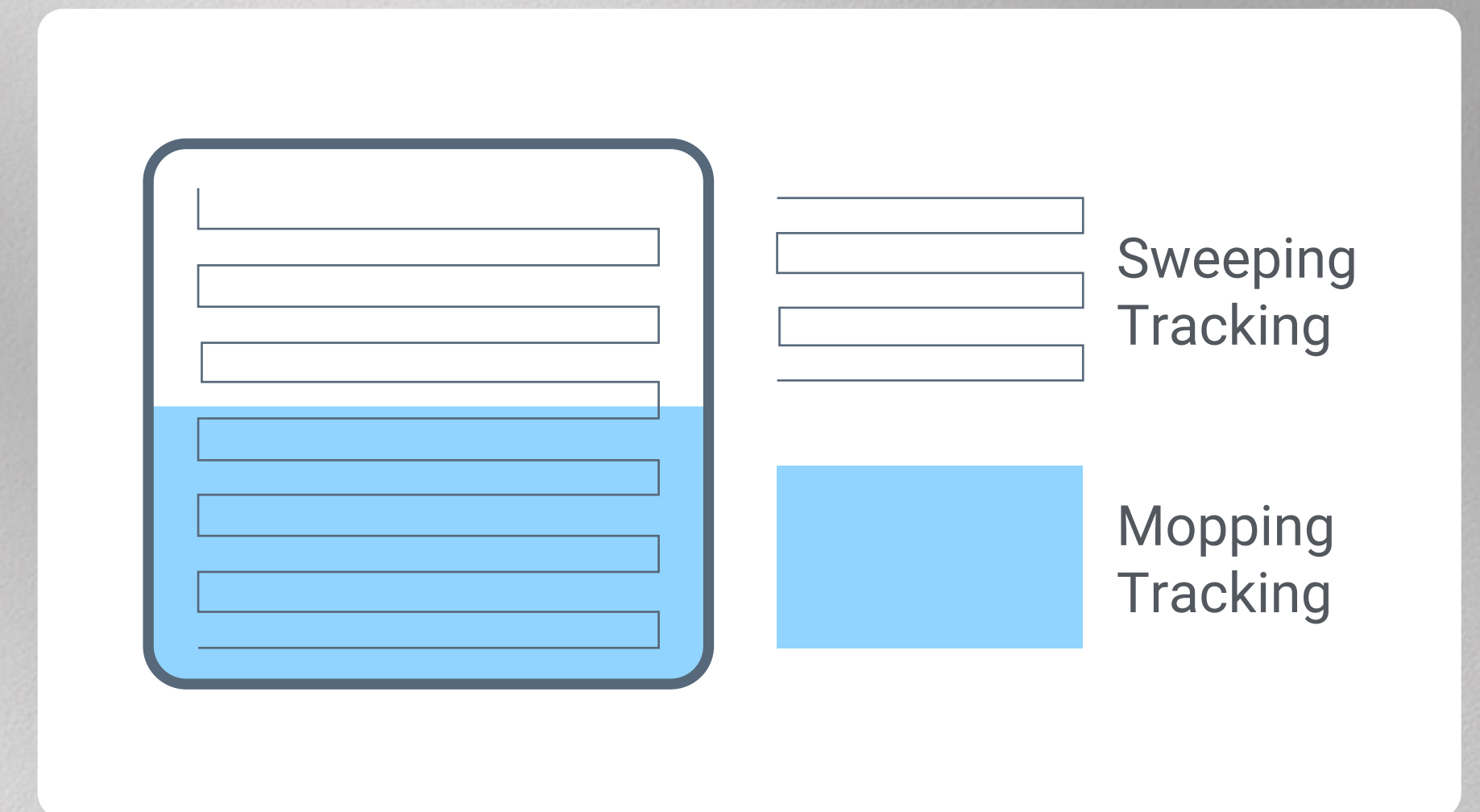

# Ultrasonic Carpet Detection



## Avoids carpet while mopping.

---

When in Only Mopping mode or Sweeping and Mopping mode and the mops are attached, ultrasonic sensors automatically detect carpet and tell the robot to avoid it to prevent accidental wetting.

## Boosts suction while vacuuming.

---

When the mops are removed and Sweeping mode is engaged, suction power is automatically boosted when carpets are identified to dig down deep and clean them more thoroughly.

# Mop Self-Cleaning and Hot Air Drying



## Self-cleans the rotary-mops.

---

The pads are sprayed with water and then spin rapidly against small grooves to dislodge dirt. The cleaning tray is detachable for easy maintenance. A nozzle at the bottom of the dock deposits the waste water into the dirty water tank.

- High-pressure waterspout for quick wetting the mops.
- Compact studding for multiple/repetitive scrubbing.
- Speedy centrifugal force for hassle-free drying.
- Detachable washboard for easy maintenance.

## Returns automatically to clean longer.

---

When the pads get dirty, it automatically returns to the dock to scrub and wash the mop pads. Also, the cleaning frequency can be set in the app according to your cleaning requirements.

# Dries with hot air.

The hot air drying starts automatically as soon as mop auto-cleaning is finished and W10 Pro has finished its cleaning session to ensure the mops are fresh, clean, and free of mold and unpleasant odor. Drying with low noise and hot air keeps the mop hygienic without disturbing you.



## Dreame Bot W10 Pro

- Hot air drying, more sanitary.
- Fast-drying, readily available.
- Lower noise, less disturbance.

VS



## Other Robot Vacuums

- Cool air drying, easily breeding mold and odor.
- Longer drying time (5h) and waiting time.
- Noisy and disturbing.

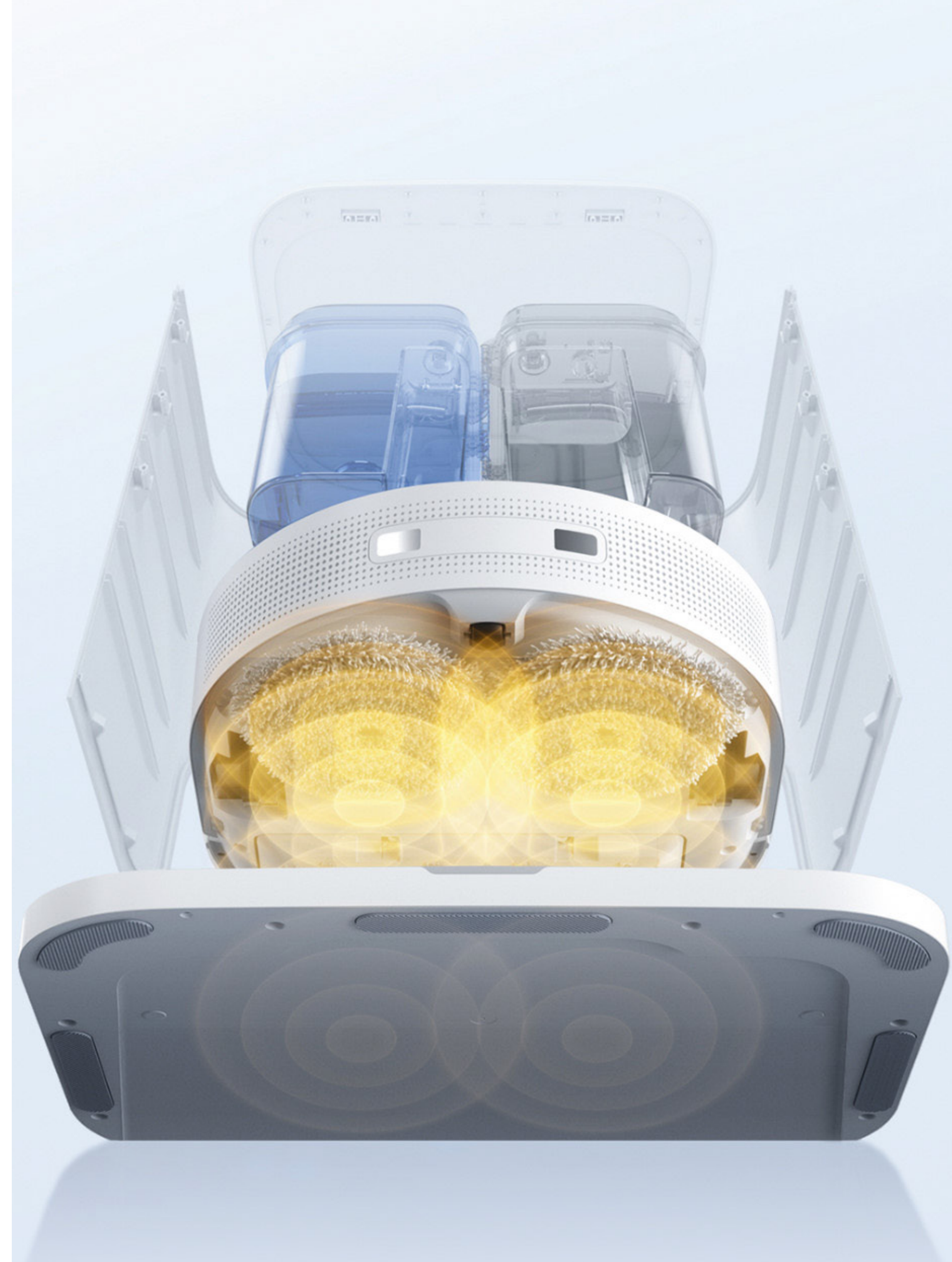

# Large Capacity and Huge Coverage



## 4.5L super-large clean water and 4L waste tank.

---

Two water tanks, one for clean water and the other for waste water, eliminate the need for frequent refilling or dumping and allow W10 Pro to clean large areas.

## Voice prompt and notification for water tanks.

---

While cleaning the mop pads, if the clean water tank doesn't have sufficient water or the waste water tank is full, you will get a voice prompt or a notification on the app.

# Massive 6,400mAh Battery

A huge 6,400mAh battery delivers up to 170 minutes of continuous cleaning and cleans up to 300m<sup>2</sup> on a single charge.

\*300m<sup>2</sup>: Refers to an area including furniture. Data is based on Dreame laboratory testing simulating a home environment with W10 Pro fully charged, operating in Only Mopping mode. Performance may vary in actual use depending on the environment, settings, and other variables.

\*170min: Based on laboratory testing simulating a home environment with the W10 Pro fully charged, operating all-in-one cleaning mode, and with suction power set to eco mode. Performance may vary in actual use depending on the environment, settings, and other variables.



# Personalized Map Operation



Advanced LiDAR navigation facilitates fast scanning and accurate mapping. Once W10 Pro has drawn a floor plan of your house, easily partition rooms and set customized cleaning plans via the app rather than cleaning the entire house every time.

## Map multiple floors.

You can save up to 3 maps, so you don't need to build maps repeatedly for duplexes or multi-level homes.

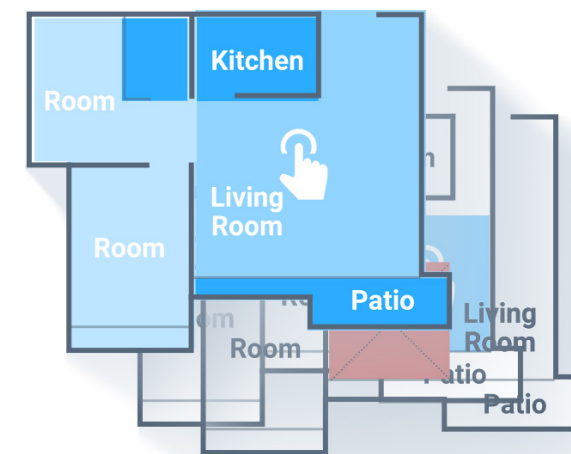

## Create virtual No-Go Zones.

Set up No-Go Zones or No-Mopping Zones on the map so that the robot does not go there when in a certain mode.

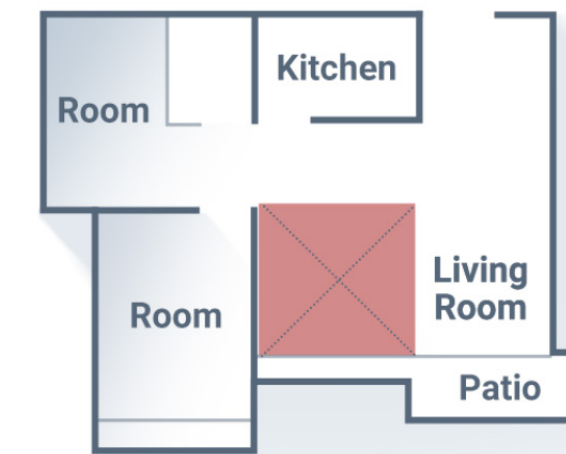

## Cleans room by room.

After the map is created, rooms can be distinguished according to the actual house layout, automatically partitioned, and named.

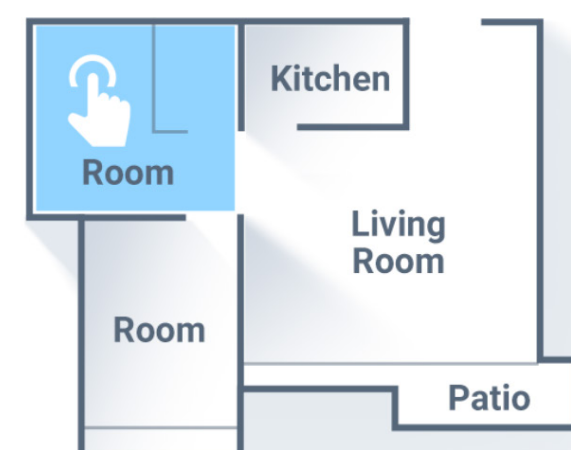

## Focus cleaning with cleaning zones.

Users can use the mobile app to mark an area on the map to clean thoroughly.



# Convenient Features

## D-shaped design for better cleaning.

W10 Pro hugs walls and corners closer thanks to its D-shaped design. Side brush catches debris from the edge and the 19.2cm oversized roller covers more area. A 31.4cm ultra-narrow body shuttles freely between the legs of tables and chairs.

### D-Shaped Design

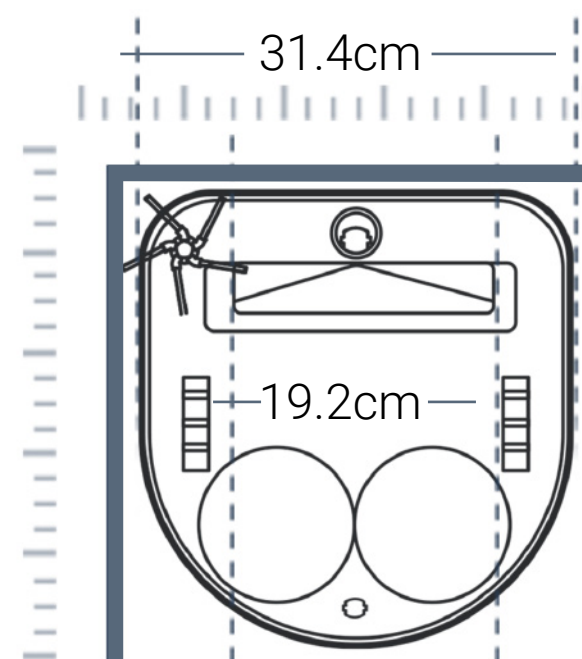

VS

### Round Design

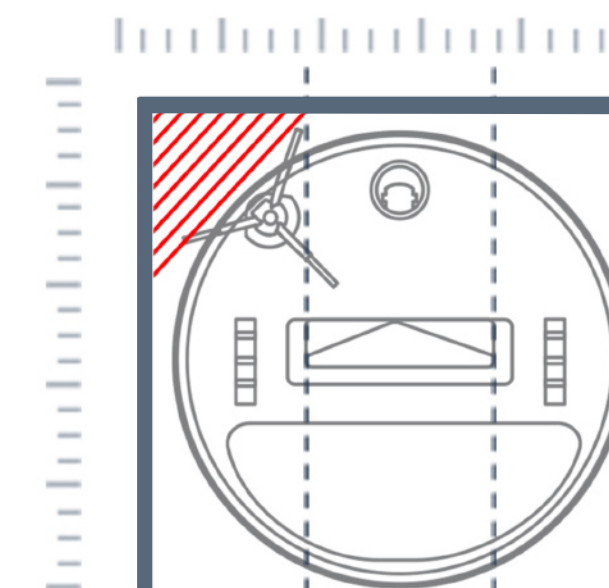

- Easily inserts into corners to pick up debris.
- Closely hugs walls and edges.
- A narrow body enables smooth cleaning under tables and chairs.

- Leaves a large area that cannot be swept as the robot cannot properly access corners.
- The body is wide, preventing it from accessing narrow areas and making it easy for the robot to get stuck.



# Voice activated control for easy operation.

---

Link your smart home devices to W10 Pro and take control with Alexa to start or stop cleaning with voice commands. Put automatic whole-home cleaning at the tip of your tongue.

# Low noise for minimal disruption.

---

W10 Pro's high-speed rotating mops effectively remove stains and hardly make any sound. The whisper-quiet operation makes it practical to have your floors cleaned while you sleep.



## 18mm obstacle-crossing for whole-home cleaning.

Overcomes 18mm obstacles like a pro to navigate freely throughout your home.



## Automatically returns to recharge.

Low battery prompts auto-return to recharge. When the battery is low, it will automatically return to the charging station.



## Anti-collision and anti-fall technology.

When W10 Pro encounters obstacles or high stairs, it will intelligently adjust the direction and return to the safe area.



## Resumes cleaning from the breakpoints.

After stopping to recharge, the robot automatically returns to the spot it previously stopped to resume cleaning.

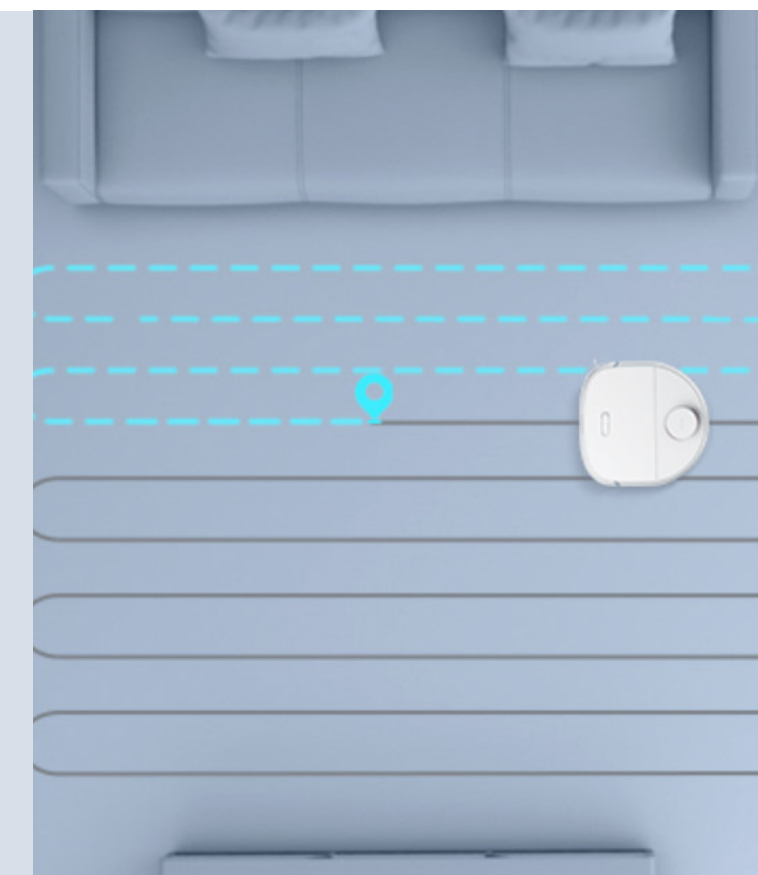

# Package List

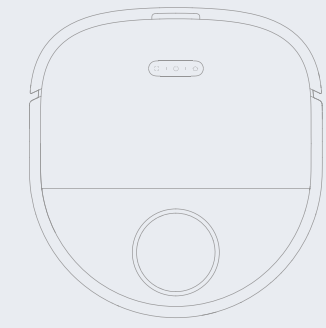

Robot

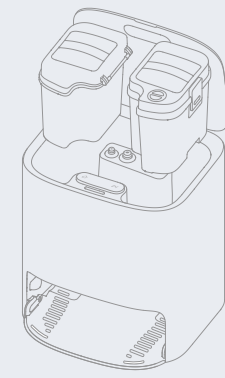

Self-Wash Base

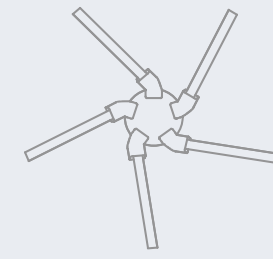

Cleaning Tool

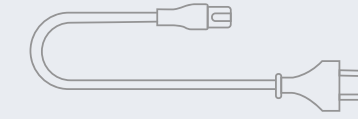

Power Cord

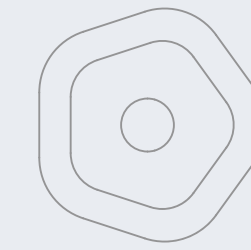

Mop Pad × 2

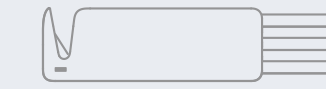

Side Brush



Cleaning Brush

## Product Specifications

<b>Dreame Bot W10 Pro</b> <b>Self-Cleaning Robot Vacuum and Mop</b> 	
Product Dimensions	334 × 314 × 105.5mm
Connection Type	Wi-Fi IEEE 802.11b/g/n 2.4 GHz
Rated Input	220-240V
Rated Power	55W
Battery Capacity	6,400mAh
Dust Tank	450ml

<b>Self-Wash Base</b> 	
Product Dimensions	375 × 400 × 430mm
Rated Input	100-240V
Rated Output	19.8V === 1A
Rated Power	65W
Clean Water Tank	4.5L
Waste Water Tank	4L