



Installation Environment

Kyocera Recommends selecting the Location for the printer as follows:

- 1 Room Temperature range: 50 to 90.5°F
- 2 Humidity Level: 10 to 80%
- 3 Power: A dedicated 120VAC 60Hz 15A outlet

Avoid the following locations when selecting a site for the machine. Adverse environmental conditions may affect the image quality.

- + Avoid locations near a window or with exposure to direct sunlight.
- + Avoid locations with vibrations.
- + Avoid locations with rapid temperature fluctuations.
- + Avoid locations with direct exposure to hot or cold air.
- + Avoid poorly ventilated locations.

Recommended Installation Space

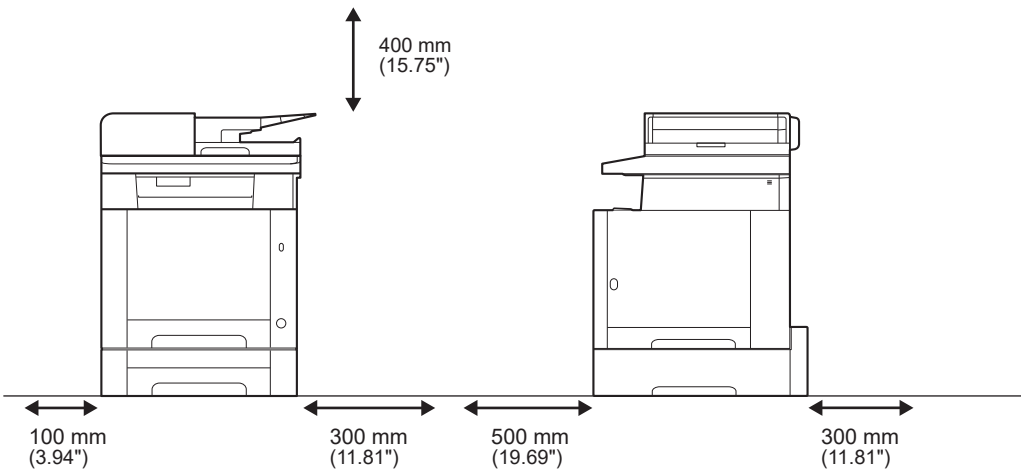

Step 1 Setting up the Printer

- 1 Open the Box. Remove the machine carefully from the box grasping both sides.
- 2 Lift the main unit from the handles by cardboard handles, using two people.

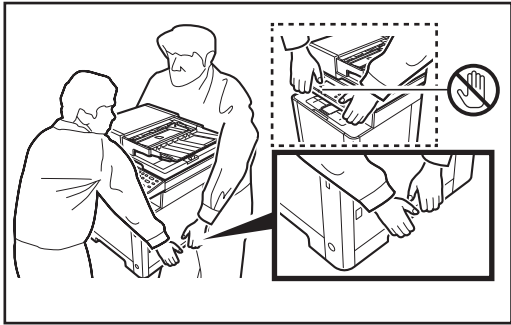
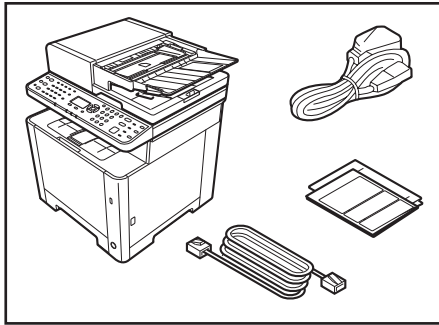

- 3 Remove the fixing tapes.
 - The front of main unit: 1
 - The rear of main unit: 2
 - The left side of main unit: 1
 - Document Processor (with a drying agent): 5
- 4 Open the Document Processor cover and remove a cushioning, a sheet of paper.

- 5 Open the right cover. After Removing the packing material, shake and install the toner container. Close the right cover.

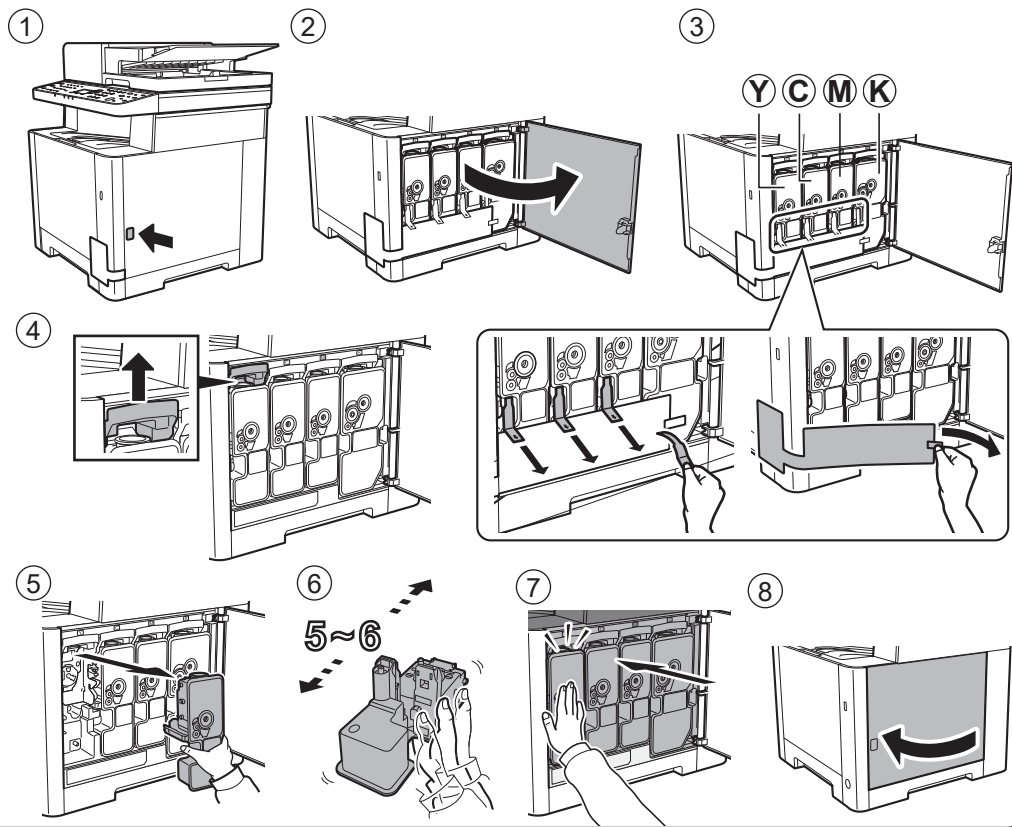

Step 2 Loading Paper

- 1 Pull the Cassette 1 completely out of the machine.

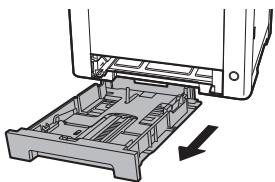

- 2 Adjust the paper length and width guide to the paper size required.

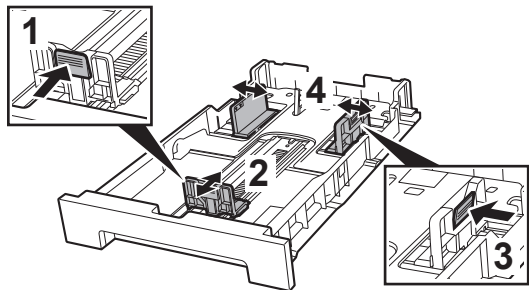

- 3 Fan the paper, then tap it on a level surface.

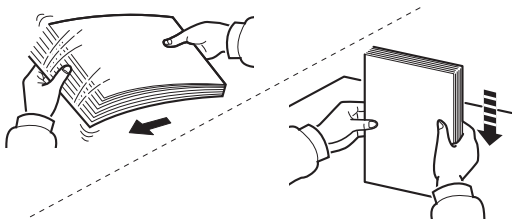

- 4 Load paper.

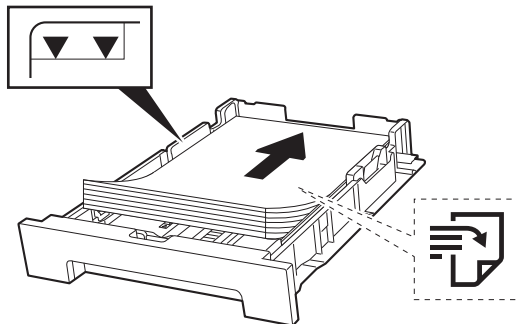

- 5 Gently push the Cassette 1 back in.

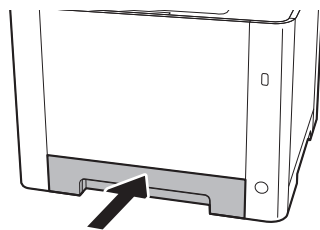

- + Set print side face-up.
- + No bent or folder edges in the paper. Such paper may cause paper jams.
- + Set the quantity of the paper less than the maximum paper indication on the side or the cassette.
- + If the paper is loaded without adjusting the paper length guide and the paper width guides, skewed paper feeding, and a paper jam will occur.

Step 3 Powering on the Printer

- 1 Connect the power cord to the rear of the machine and the other end to the power outlet.

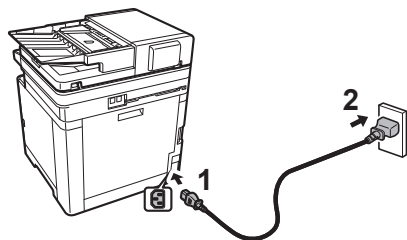

- 2 Turn the power switch ON at the front of the printer.

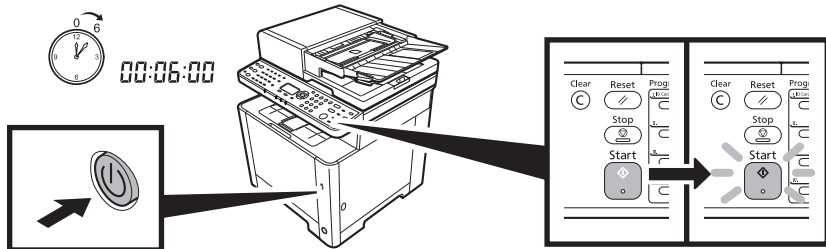

Step 4 Default Settings of the Machine

1 Press [▲] [▼] key to select default language > [OK] key.

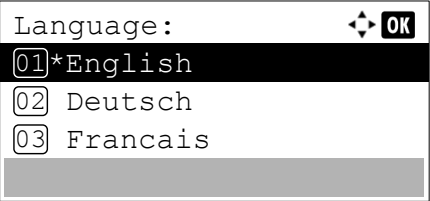

The Managed by Admin screen appears.

2 Select [No (home)] > [OK] key when you use the machine without login as the administrator at home.

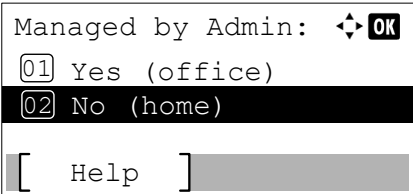

The setup screen appears.

3 Select [Change] when you change the time zone, date and time. Follow the instructions on the screen. If not, select [Skip].

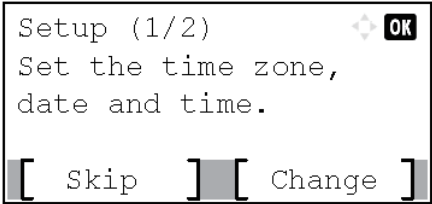

The screen moves to the next step.

4 Select [Change] when you set the IP address to use the machine on the network. Follow the instructions on the screen.

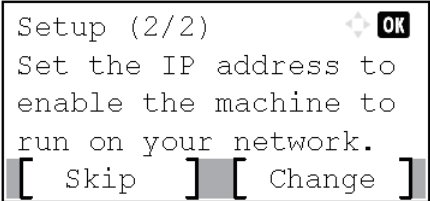

5 When the following screen appears, select [Yes] > [Finish].

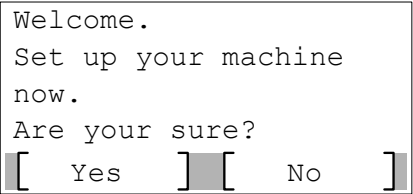

NOTE

Prepare the device and information according to the your environment. When you set the network later, select [Skip].

For details of the network settings, refer to the Operation Guide.

Step 5 Printing a Status Page

1 [System Menu/Counter] key > [▲] [▼] key > [Report] > [OK] key > [▲] [▼] key > [Report Print] > [OK] key

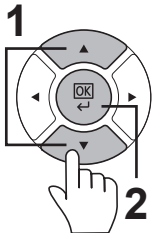
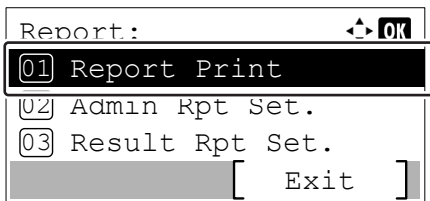
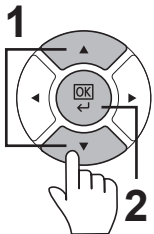
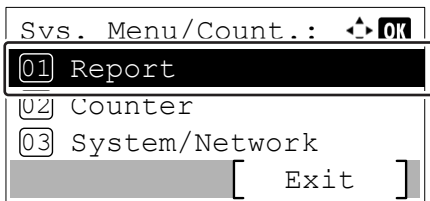

2 [▲] [▼] key > [Status Page] > [OK] key > [Yes]

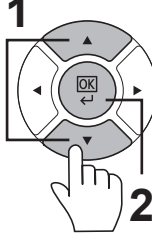
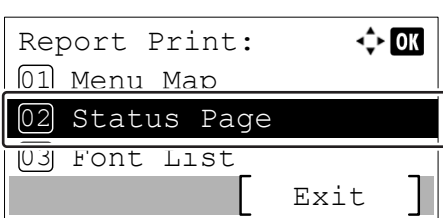

Step 6 Installing Software

Access the following URL and select your model and OS.
Download Center: <https://kyocera.info/>

For Windows

Download and run the Web Installer and follow the on-screen instructions to install the driver and software.

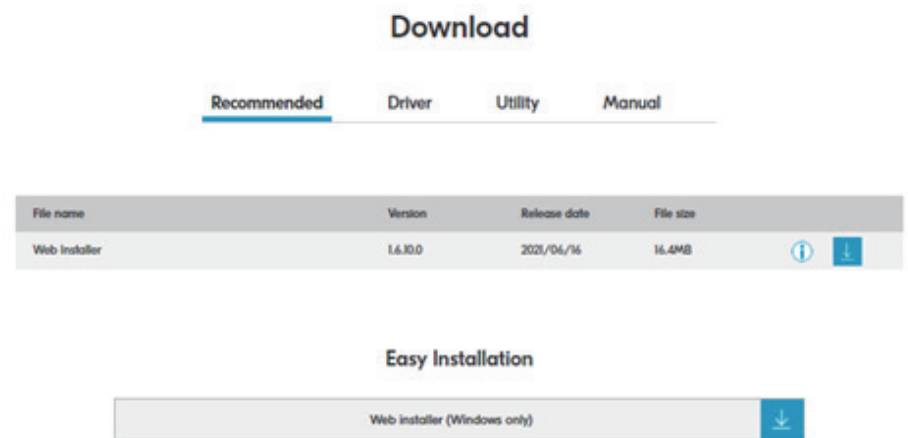

For Macintosh

Download and run the driver and follow the on-screen instructions to install.

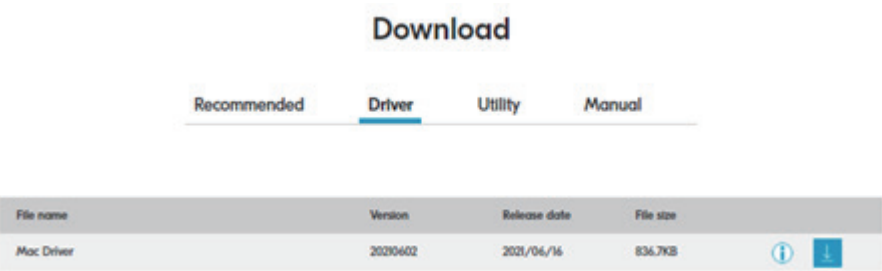

Videos on machine setup, software installation, etc. are also available on this site.
<https://kyocera.inst-guide.com/tb11f/>

