

eufy Security Indoor Cam S350

User Guide (T8416)

AT A GLANCE

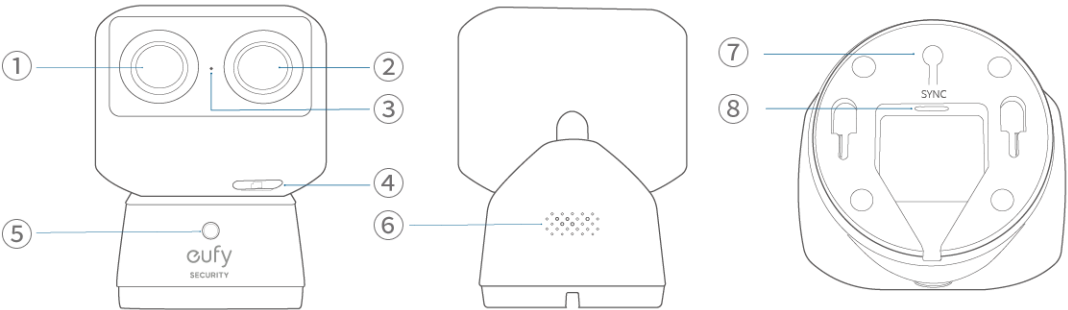

①	Wide-Angle LensL	⑤	Status LED
②	Telephoto Lens	⑥	Speaker
③	Microphone	⑦	SYNC Button
④	microSD Slot Insert a microSD card* (not included) to store recordings	⑧	Power Input

*Use at least a Class 10 microSD card with a maximum of 128 GB.

WHAT’S INCLUDED

Indoor Cam S350	USB Cable	Power Adapter	Wall Mount
Positioning Sticker	Screw Pack	Quick Start Guide	

You may need a screwdriver, drill, and ladder.

SETTING UP THE SYSTEM

1. Download and install the eufy Security app, and sign up for an account.







2. Connect the camera to a power source and wait until the status LED turns solid blue.

3. Tap + in the app and follow the in-app instructions to add your camera.



LED Light Guide

	Solid Violet	System is initializing
	Solid Blue	Working normally or ready for setup
	Blinking Red	Not connected to the internet
	Solid Red	Recording or the live stream is being viewed
	Flashing Blue and Red	Firmware upgrade in progress <i>*Keep the camera connected to a power source</i>

INSTALLING YOUR CAMERA

Telephoto Lens Focusing Distance

To ensure an optimal zoom experience from the telephoto lens, place the camera at least 8 ft (2.5 m) away from the area to be monitored.

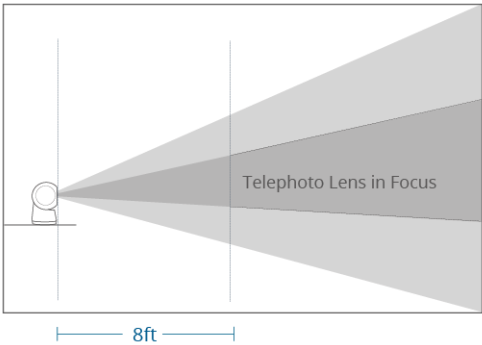

Choose a Location

The camera can be placed on a table or shelf, or can be installed on a wall or ceiling. Select a location and height that achieves your desired view and is within reach of a power outlet.

 **Note:** Keep the camera at least 0.7ft/0.2m away from any objects or walls to avoid infrared reflection, which may impact night vision performance.

Camera Field of View

On a Table or Shelf

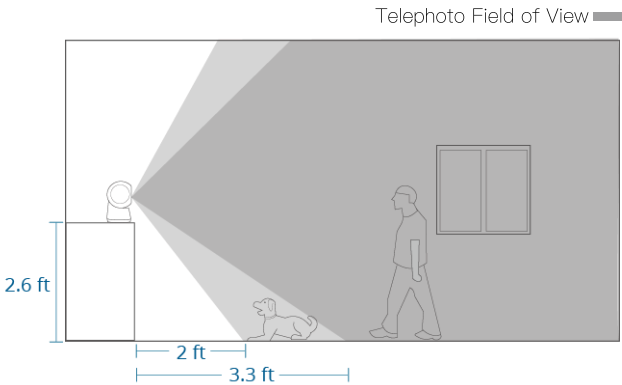

On the Wall

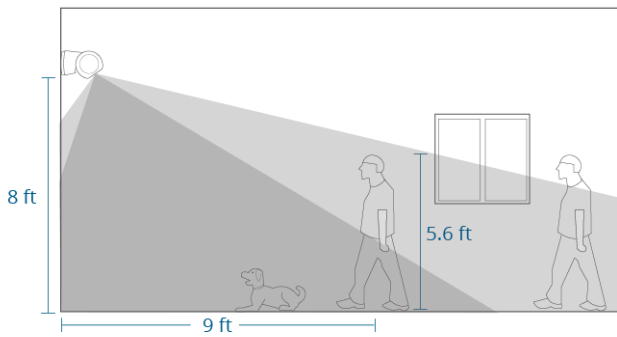

On the Ceiling

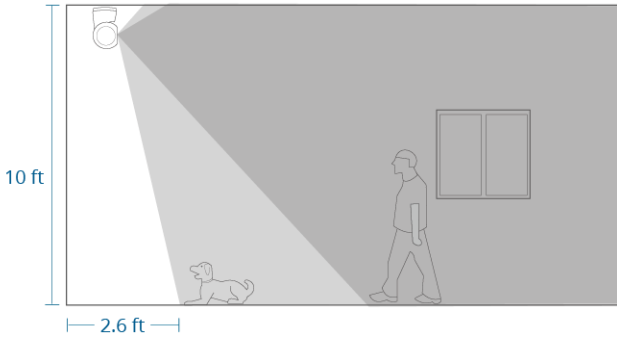

Install on a Wall or Ceiling

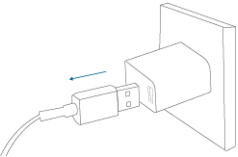

Note: Disconnect the camera from the power outlet before mounting.

1. Mark the screw positions on the wall or ceiling with the positioning sticker and drill a pilot hole.

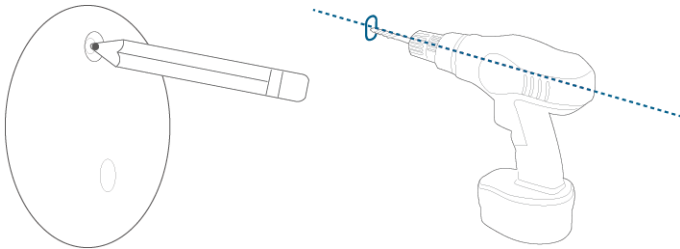

2. Hold the mounting plate on the wall and make sure the "UP" arrow is pointing up. Secure the mounting plate to the wall or ceiling with the screws.

On the Wall

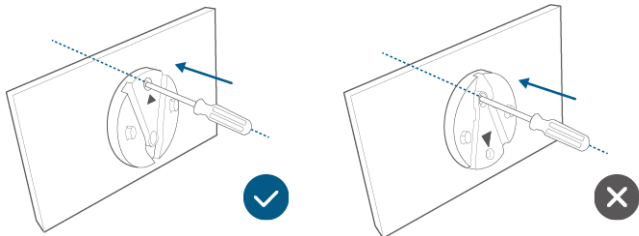

On the Ceiling

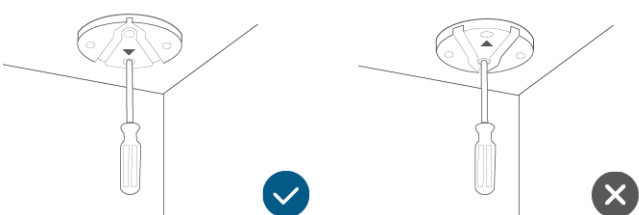

3. Keep the camera disconnected from power. Connect the USB-C Cable to the camera with the other end not connected to a power source.

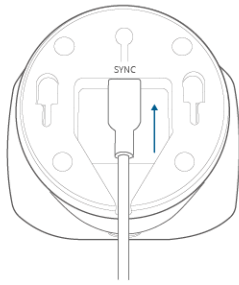
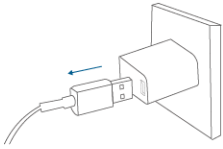

4. If mounting on a wall, place the cable into the cable channel of the mounting plate.

** Skip this step for ceiling installation.*

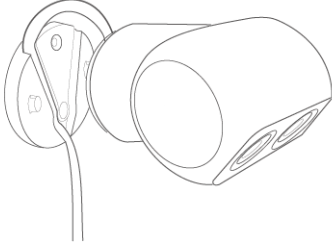

5. Slide the camera onto the mounting plate and make sure it is attached securely.

On the Wall

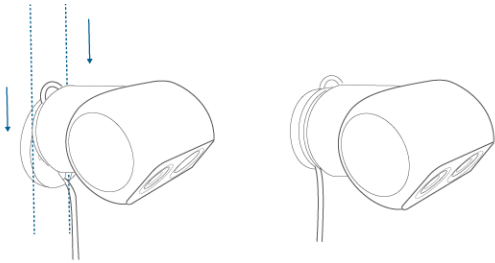

On the Ceiling

