

# JABRA BOOST

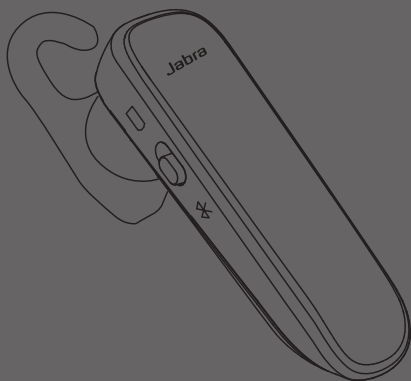

User Manual

[jabra.com/boost](https://jabra.com/boost)

A BRAND BY

**GN Netcom**

---

© 2014 GN Netcom A/S. All rights reserved. Jabra® is a registered trademark of GN Netcom A/S. All other trademarks included herein are the property of their respective owners. The Bluetooth® word mark and logos are owned by the Bluetooth SIG, Inc. and any use of such marks by GN Netcom A/S is under license. (Design and specifications subject to change without notice).

---

MADE IN CHINA  
MODEL: OTE15



---

**Declaration of Conformity** can be found on  
[www.jabra.com/CP/US/declarations-of-conformity](http://www.jabra.com/CP/US/declarations-of-conformity)

# CONTENTS

1. WELCOME .....	4
2. HEADSET OVERVIEW .....	5
3. HOW TO WEAR .....	6
3.1 CHANGE EARGELS	
3.2 ATTACHING THE EARHOOK	
4. HOW TO CHARGE THE BATTERY .....	8
4.1 CHARGE USING PC	
4.2 CHARGE USING CAR CHARGER	
4.3 EXTEND BATTERY LIFE (POWER NAP)	
5. HOW TO CONNECT .....	11
6. HOW TO USE .....	12
6.1 CALLS	
6.2 MULTIPLE CALL HANDLING	
7. SOFTWARE .....	15
7.1 JABRA ASSIST	
8. SUPPORT .....	16
8.1 FAQ	
8.2 HOW TO CARE FOR YOUR HEADSET	
9. TECHNICAL SPECIFICATIONS .....	17

# 1. WELCOME

Thank you for using the Jabra Boost. We hope you will enjoy it!

## **JABRA BOOST FEATURES**

- Voice guidance
- Battery and pairing status display
- HD voice
- Long talk time - Up to 9 hours
- Power Nap feature
- New comfort pack
- Wireless freedom - Up to 30m/98ft

## 2. HEADSET OVERVIEW

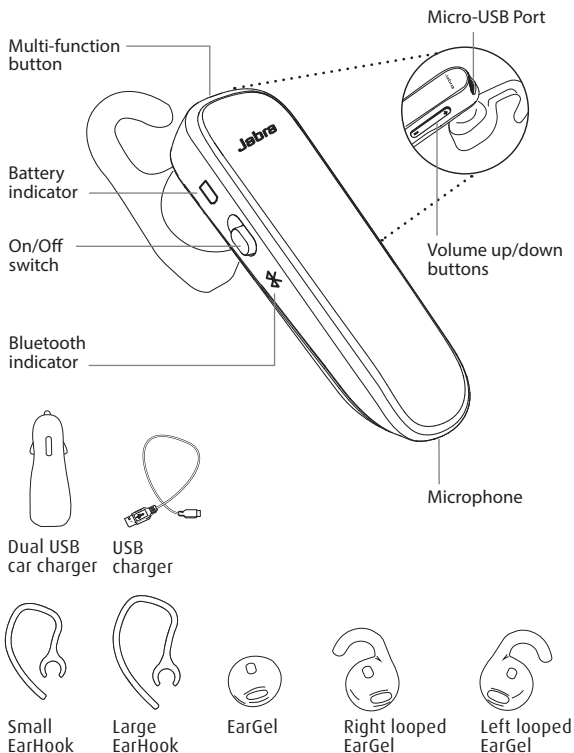

**NOTE:** the dual USB car charger is available for select countries only.

### 3. HOW TO WEAR

The headset can be worn on the left or right ear, with or without the EarHook. Additional EarGels and EarHooks are available in the pack.

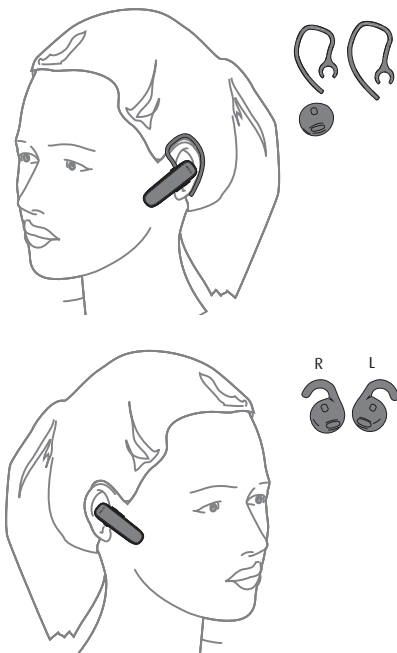

## 3.1 CHANGE EARGELS

---

Choose between 3 ergo-designed EarGels for optimal fit and comfort (standard, left looped, or right looped).

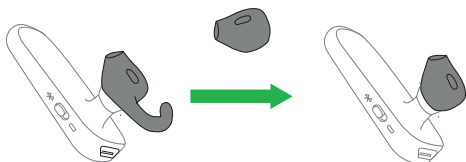

## 3.2 ATTACHING THE EARHOOK

---

Select between two different EarHook sizes (small or large). The EarHook can be attached to the headset for a more secure fit, and can be worn with the Standard EarGel (suitable for left or right ear).

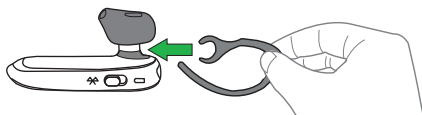

## 4. HOW TO CHARGE THE BATTERY

Fully charge the headset before first use, and enjoy up to 9 hours talk time. It takes approx. 2 hours to charge.

### 4.1 CHARGE USING PC

---

Simply connect the headset to the PC using the supplied USB cable.

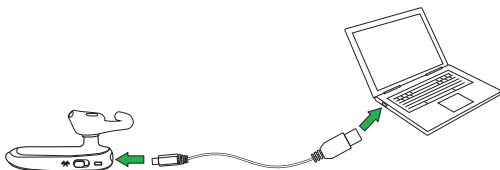



## 4.2 CHARGE USING CAR CHARGER

---

1. Connect the headset to the dual USB car charger using the supplied USB cable.
2. Plug the dual USB car charger into the car's power outlet.

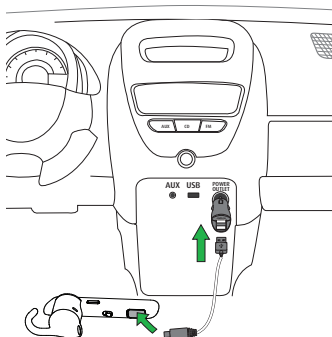

It takes approx. 2 hours to fully charge the headset.

**NOTE:** the dual USB car charger can charge your headset and your mobile device simultaneously.

## 4.3 EXTEND BATTERY LIFE (POWER NAP)

---

To extend battery life the headset will automatically enter Power Nap mode when the headset is out of range of your connected mobile device for more than 60 minutes. Power Nap provides 365 days of battery readiness.

To exit Power Nap (or answer an incoming call) simply tap the **Multi-function** button on the headset. Your mobile device must be within range, switched on and have Bluetooth enabled.

## 5. HOW TO CONNECT

1. Turn the headset on (set the **On/Off** switch to the On position).
2. Press and hold (3 secs) the **Multi-function** button until the Bluetooth indicator flashes blue, and the voice guided instructions are announced.
3. Wear the headset and follow the voice-guided instructions to connect to your Bluetooth device.

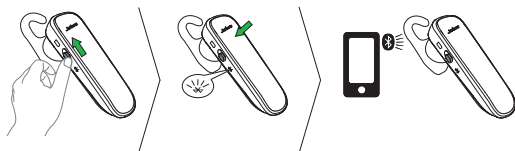

## 6. HOW TO USE

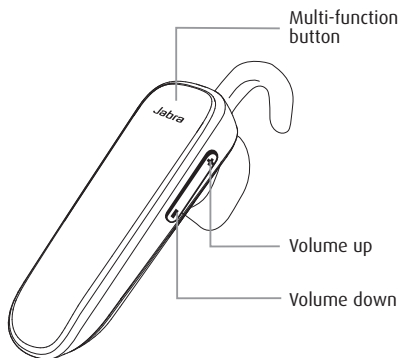
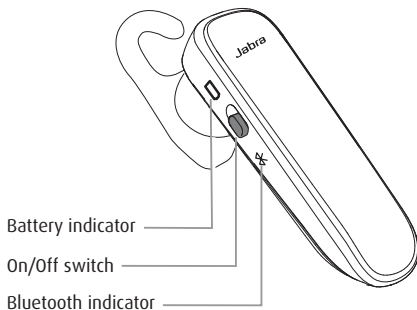

## 6.1 CALLS

---

### CALLS

---

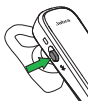

On/off

Slide the **On/off** switch

---

Answer/end  
call

Tap the **Multi-function** button

---

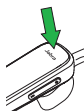

Reject call

Double-tap the **Multi-function**  
button

---

Redial last  
number

Double-tap the **Multi-function**  
button

---

Activate  
Siri/Google  
Now voice  
commands

Press and hold (1 sec) the  
**Multi-function** button

---



Adjust speaker  
volume

Tap the **Volume up** or  
**Volume down** button

---

Mute/un-mute  
microphone

Tap both the **Volume up** and  
**Volume down** at the same time

---

## 6.2 MULTIPLE CALL HANDLING

---

The headset can accept and handle multiple calls simultaneously.

### MULTIPLE CALLS

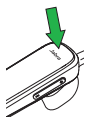

---

End current call and  
answer incoming call

Tap the **Multi-  
function** button

---

Switch between held call  
and active call

Press and hold  
(2 secs) the  
**Multi-function**  
button

---

Put current call on hold  
and answer incoming call

Press and hold  
(2 secs) the  
**Multi-function**  
button

---

Reject incoming call

Double-tap the  
**Multi-function**  
button

---

# 7. SOFTWARE

## 7.1 JABRA ASSIST

---

Jabra Assist is a Smartphone app that enables GPS tracking of the headset, pairing assistance, and headset battery status.

- Android download - Google Play
- iOS download - App Store

## 8. SUPPORT

### 8.1 FAQ

---

View the comprehensive FAQ on [Jabra.com/Boost](https://Jabra.com/Boost).

### 8.2 HOW TO CARE FOR YOUR HEADSET

---

- Always store the headset with the power off and safely protected
- Avoid storage at extreme temperatures (above 40°C/104°F or below 0°C/32°F). This can shorten battery life and may affect headset operation
- Do not expose the headset to rain or other liquids



## 9. TECHNICAL SPECIFICATIONS

JABRA BOOST HEADSET	SPECIFICATION
Weight:	8.5 g (0.30 oz)
Dimensions:	L 49.3 mm x W 14.5 mm x H 9.5 mm L 1.94 in x W 0.57 in x H 0.37 in
Microphones:	Omni-directional microphone
Speaker:	11 mm dynamic speaker
Operating range:	30m/98ft (phone dependent)
Bluetooth version:	4.0
Paired devices:	Up to 8, connected to two at the same time (MultiUse™)
Supported Bluetooth profiles:	A2DP(v1.2), Hands Free Profile (v1.6), Headset profile(v1.2)
Talk time:	Up to 9 hours
Power nap battery time:	Up to 365 days
Operating temperature:	-10°C to 55°C (14°F to 131°F)
Storage temperature:	0°C to 40°C (32°F to 104°F)
USB charging cable	5V, >100 mA
Pairing passkey or PIN:	0000

