

Jabra[®]
YOU'RE ON

JABRA MOVE WIRELESS



User Manual

jabra.com/movewireless

1. WELCOME.....	3
2. WHAT'S IN THE BOX.....	4
3. HOW TO WEAR.....	5
3.1 HEIGHT ADJUSTMENT	
4. HOW TO CHARGE.....	6
4.1 BATTERY STATUS	
5. HOW TO CONNECT.....	7
5.1 BLUETOOTH CONNECT TO A NEW OR SECOND MOBILE DEVICE	
5.2 CONNECT TO 3.5 MM JACK CONNECTOR	
6. HOW TO USE	9
6.1 MUSIC & CHAT	
6.2 TURN HEADPHONES ON/OFF	
6.3 MULTIPLE CALL HANDLING	
6.4 VOICE GUIDANCE	
7. SUPPORT	13
7.1 FAQ	
7.2 FACTORY RESET	
7.3 HOW TO CARE FOR YOUR HEADPHONES	
8. TECHNICAL SPECIFICATIONS	14

1. WELCOME

Thank you for purchasing the Jabra Move Wireless. We hope you will enjoy it!

JABRA MOVE WIRELESS FEATURES

- Premium wireless sound experience - amplifies without distortion. Brings out the depth and clarity of your music
- Seals the sound - angled earcups allow you to hear all the music
- Easily connect with any device via Bluetooth 4.0
- Life proof - lightweight, comfortable headphones built & tested for life on the move
- Premium materials - stainless steel
- Wired option - detachable cord for when you need to be wired

2. WHAT'S IN THE BOX

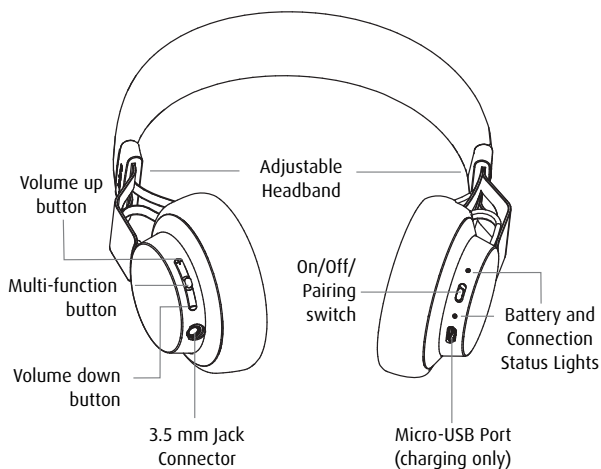

Micro-USB cable



Audio cable

3. HOW TO WEAR

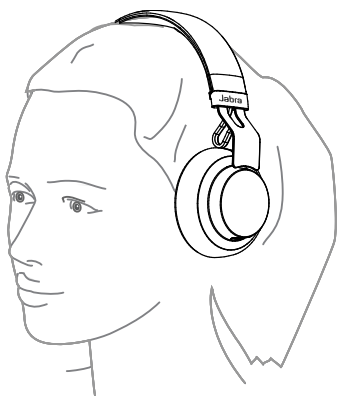

3.1 HEIGHT ADJUSTMENT

Get the perfect fit by adjusting the headband, as illustrated.

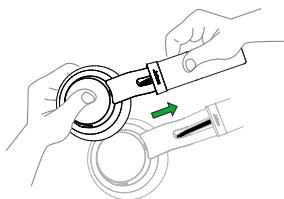

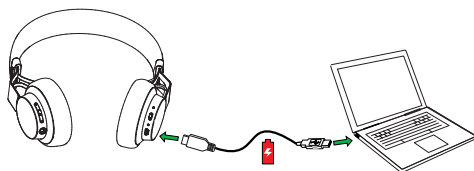

4. HOW TO CHARGE

Plug the headphones into any available USB port on your PC using any micro-USB cable.



4.1 BATTERY STATUS

Tap the Multi-function button when not on a call to see the battery status. It takes 1-2 hours to fully charge the headphones.

LED	COLOR	BATTERY LEVEL
	Green	Medium/High
	Red	Low
	Flashing red	Critically low

5. HOW TO CONNECT

The Jabra Move Wireless will automatically attempt to Bluetooth connect to a mobile device whenever it is powered on (unless already connected to a Bluetooth device). Simply follow the voice-guided connection instructions.

5.1 BLUETOOTH CONNECT TO A NEW OR SECOND MOBILE DEVICE

1. Hold the **On/Off/Pairing** switch in the Pairing position for 3 secs.
2. Pairing mode will be announced in the headphones, and the Bluetooth light will flash blue.
3. Follow the voice-guided instructions to connect to your Bluetooth device.

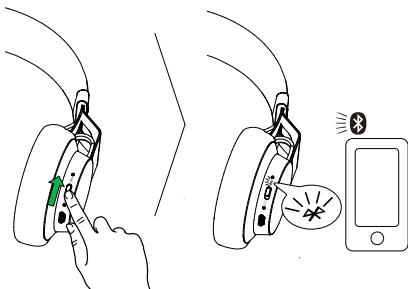

NOTE: If two mobile phones have been connected to the Jabra Move Wireless, you may need to select which phone will be used for calls/music. Simply open the Bluetooth menu on the mobile phone you wish to use for calls/music and select the Jabra Move Wireless from the list of devices.

5.2 CONNECT TO 3.5 MM JACK CONNECTOR

Connect the headphones to a 3.5 mm jack connector on your mobile device or PC using the supplied audio cable.

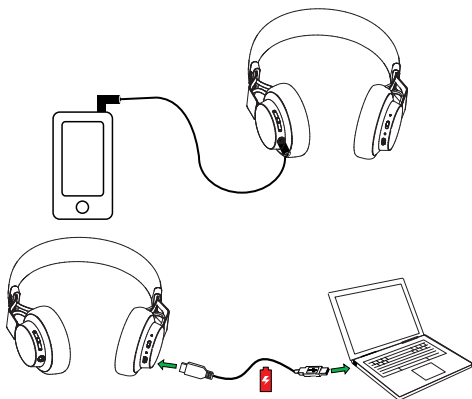

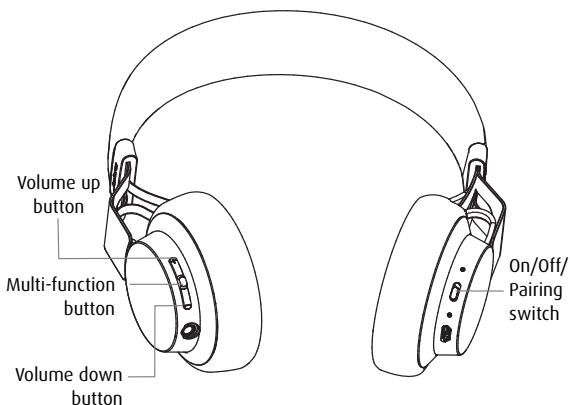

NOTE: Bluetooth connections are disabled when connected to the 3.5 mm Jack Connector.

6. HOW TO USE



6.1 MUSIC & CHAT

The buttons on the headphones enable you to control your music and phone calls.

FUNCTION	HOW TO DO IT
 <p data-bbox="273 252 459 282">Pause/play music</p>	<p data-bbox="584 236 850 299">Tap the Multi-function button</p>
<p data-bbox="273 394 428 424">Adjust volume</p>	<p data-bbox="584 376 840 439">Tap the Volume up or Volume down button</p>
 <p data-bbox="273 526 377 556">Skip track</p>	<p data-bbox="584 488 855 591">Press and hold either the Volume up or Volume down button</p>
<p data-bbox="273 667 422 697">Battery status</p>	<p data-bbox="584 632 845 735">Tap the Volume up or Volume down button, when not on a call</p>
<p data-bbox="273 796 446 826">Answer/end call</p>	<p data-bbox="584 778 852 840">Tap the Multi-function button</p>
 <p data-bbox="273 931 381 961">Reject call</p>	<p data-bbox="584 910 857 979">Press and hold (1 sec) the Multi-function button</p>
<p data-bbox="273 1063 474 1093">Redial last number</p>	<p data-bbox="584 1042 829 1111">Double-tap the Multi-function button</p>

6.2 TURN HEADPHONES ON/OFF

Slide the **On/Off/Pairing** switch to **On** or **Off**.

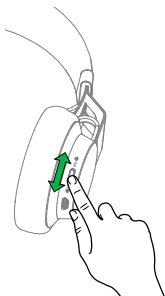

6.3 MULTIPLE CALL HANDLING

The headphones can accept and handle multiple calls simultaneously.

	FUNCTION	HOW TO DO IT
	Put current call on hold and answer incoming call	Press (2 secs) the Multi-function button
	Switch between held call and active call	Press (2 secs) the Multi-function button
	Reject incoming call	Double-tap the Multi-function button

6.4 VOICE GUIDANCE

CLICK TO LISTEN WHAT YOU HEAR

To connect Move, go to the Bluetooth menu on your phone and select it from the list.

Connected

Disconnected

Connection cancelled

Two devices connected

No device connected

Recharge battery

Battery level low

Battery level medium

Battery level full

Voice prompts off

Voice prompts on

Redialing

7. SUPPORT

7.1 FAQ

View the full FAQ at jabra.com/movewireless

7.2 FACTORY RESET

To factory reset the headphones and clear the pairing list, press and hold (5 secs) both the **Volume up** button and the **Multi-function** button at the same time.

7.3 HOW TO CARE FOR YOUR HEADPHONES

- Always store the headphones with the power off and safely protected.
- Avoid storage at extreme temperatures (above 85°C/185°F or below -20°C/-4°F). This can shorten battery life and may affect operation. High temperatures may also degrade performance.
- Do not expose the headphones to rain or other liquids.

8. TECHNICAL SPECIFICATIONS

JABRA MOVE HEADPHONES	SPECIFICATION
Weight:	150 grams
Dimensions:	H 172 mm x W 146.1 mm x L 59 mm
Microphone:	4 mm Omni-directional microphone
Speaker:	40 mm dynamic speaker
Operating range:	Up to 10 meters (33 feet)
Bluetooth version:	4.0
Paired devices:	Up to 8 devices, connected to 2 at same time (MultiUse™)
Supported Bluetooth profiles:	Headset profile v1.2, Handsfree profile v1.6, A2DP v1.2, AVRCP v1.4
Talk time:	Up to 8 hours
Standby time:	Up to 12 days
Operating temperature:	-10° C to 60° C (14 F to 140 F)
Storage temperature:	-20° C to 85° C (-4 F to 185 F)
Pairing passkey or PIN:	0000