

DOT

WIRELESS HEADSET

8TDOTTWSK
8TDOTTWSW

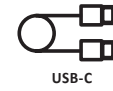
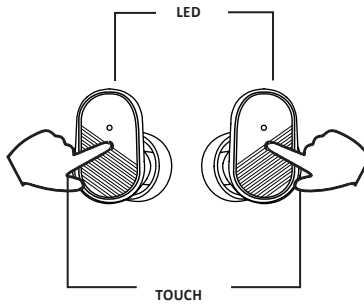

EN
Technical specifications:
 Bluetooth®: v5.3
 Supported profiles: Headset – Handsfree – A2DP – AVRCP
 Range: 10m
 Bluetooth® Frequency Range: 2.402MHz-2.480MHz
 Battery Voltage: 3.7V
 Battery Capacity: 40mAh X 2
 Charging Case battery capacity: 250mAh
 USB-C port Voltage (V): 5V
 USB-C Port Current (A): 0.5A
 Maximum EIRP: 4.77 dBm
 Stand-by Time: 150 hrs
 Talk Time: about 4.5 hrs
 Play Time: about 7 hrs
 Charging the earphones: about 1.5 hours
 Charging the Charging Case: about 2 hrs
 Weight: 32g

IT
Specifiche tecniche: Bluetooth: v5.3
 Profili supportati: Headset – Handsfree – A2DP – AVRCP
 Portata: 10m
 Bluetooth Frequency Range: 2402MHz-2480MHz
 Battery Voltage: 3.7V
 Battery Capacity: 40mAh X 2
 Charging Case battery capacity: 250mAh
 USB-C port Voltage (V): 5V
 USB-C port current (A): 0.5A
 Maximum EIRP: 4.77 dBm
 Stand-by Time: 150h
 Talk Time: 4.5h circa
 Play Time: 7h circa
 Ricarica auricolari: 1.5ore circa
 Ricarica Charging Case: 2h circa
 Peso: 32g

FR
Spécifications techniques:
 Bluetooth® - version 5.3
 Profils supportés : Écouteurs - Mains libres - A2DP - AVRCP
 Portée : 10 m
 Gamme de fréquences Bluetooth® : 2 402 MHz - 2 480 MHz
 Tension de la batterie : 3,7 V
 Capacité de la batterie : 40 mAh x 2
 Capacité de la batterie du Charging Case : 250 mAh
 Tension du port USB-C (V) : 5 V
 Courant du port USB-C (A) : 0,5 A
 PIRE max : 4,77 dBm
 Autonomie en stand-by : 150 h
 Autonomie en conversation : 4,5 h environ
 Autonomie en lecture : 7 h environ
 Charge des écouteurs : 1,5 h environ
 Charge du Charging Case : 2 h environ
 Poids : 32 g

DE
Technische Eigenschaften:
 Bluetooth®: v5.3
 Unterstützte Profile: Headset – Handsfree – A2DP – AVRCP
 Reichweite: 10 m
 Bluetooth®-Frequenzbereich: 2402 MHz-2480 MHz
 Akkuspannung: 3,7 V
 Akkukapazität: 40 mAh X 2
 Charging Case Akkukapazität: 250 mAh
 USB-C-Anschluss Spannung (V): 5 V
 USB-C-Anschluss Strom (A): 0,5 A
 Maximale EIRP: 4,77 dBm
 Standby-Zeit: 150 Stunden
 Sprechzeit: ca. 4,5 Stunden
 Spielzeit: ca. 7 Stunden
 Laden des Headsets: ca. 1,5 Stunden
 Ladezeit des Charging Case: ca. 2 Stunden
 Gewicht: 32 g

ES
Especificaciones técnicas:
 Bluetooth®: v5.3
 Perfiles admitidos: Headset – Handsfree – A2DP – AVRCP
 Alcance: 10 m
 Rango de frecuencia Bluetooth®: 2402 MHz-2480 MHz
 Voltaje de la batería: 3.7 V
 Capacidad de la batería: 40 mAh X 2
 Capacidad de la batería del Charging Case: 250 mAh
 Voltaje (V) del puerto USB-C: 5 V
 Corriente (A) del puerto USB-C: 0.5 A
 Potencia isotrópica radiada equivalente máxima: 4,77 dBm
 Autonomía en modo de espera: 150 h
 Tiempo de conversación: 4,5 h aprox.
 Tiempo de reproducción: 7 h aprox.
 Carga de los auriculares: 1,5 h aprox.
 Carga del Charging Case: 2 h aprox.
 Peso: 32 g

TR
Teknik özellikler:
 Bluetooth®: v5.3
 Desteklenen profiller: Kulaklık – Eller Serbest – A2DP – AVRCP
 Kapsama alanı: 10m
 Bluetooth® Frekans Aralığı: 2402 MHz-2480 MHz
 Pili Voltajı: 3.7V
 Pili Kapasitesi: 40mAh X 2
 Charging Case pili kapasitesi: 250mAh
 USB-C port Gerilimi (V): 5V
 USB-C port akımı (A): 0,5A
 Maksimum EIRP: 4,77 dBm
 Bekleme Süresi: 150h
 Konuşma Süresi: Yaklaşık 4.5h
 Çalma Süresi: Yaklaşık 7h
 Kulak içi kulaklıkların yeniden şarj edilmesi: Yaklaşık 1.5saat
 Charging Case yeniden şarj edilmesi: Yaklaşık 2h
 Ağırlık: 32g

NL
Technische gegevens:
 Bluetooth®: v5.3
 Ondersteunde profielen: Headset – Handsfree – A2DP – AVRCP
 Bereik: 10 m
 Frequentiebereik Bluetooth®: 2402MHz-2480MHz
 Batterijspanning: 3,7V
 Batterijcapaciteit: 40mAh X 2
 Batterijcapaciteit opladcase: 250mAh
 Spanning USB-C-poort (V): 5V
 Stroomsterkte USB-C-poort (A): 0,5A
 Maximum EIRP: 4,77 dBm
 Tijdsduur in stand-by: 150 uur
 Tijdsduur in gesprek: ongeveer 4,5 uur
 Afspeltijd: ong. 7 u
 Oplaadtijd headset: ongeveer 1,5 uur
 Oplaadtijd opladcase: ongeveer 2 uur
 Gewicht: 32 g

FI
Kuulokkeen tekniset:
 Bluetooth®: v5.3
 Tuettut profiilit: Headset – Handsfree – A2DP – AVRCP
 Kantama: 10 m
 Bluetooth® taajuusalue: 2402MHz-2480MHz
 Akkujännite: 3,7 V
 Akun kapasiteetti: 40mAh X 2
 Charging Case -latauskotelon akun kapasiteetti: 250mAh
 USB-C -portin jännite (V): 5 V
 USB-C -portin virta (A): 0,5 A
 Maks. EIRP: 4,77 dBm
 Stand-by-aika: 150 tuntia
 Puhelka: noin 4,5 tuntia
 Musiikkunteloaika: noin 7 tuntia
 Kuulokkeiden lataaminen: Noin 1,5 tuntia
 Charging Case -latauskotelon lataaminen: noin 2 tuntia
 Paino: 32 g

SV
Tekniska specifikationer:
 Bluetooth®: v5.3
 Profiler som stöds: Headset – Handsfree – A2DP – AVRCP
 Räckvidd: 10 m
 Bluetooth® frekvensområde: 2402 MHz-2480 MHz
 Batterispanning: 3,7V
 Batterikapacitet: 40 mAh X 2
 Batterikapacitet: laddningsfodralet: 250 mAh
 USB-C -portens spänning (V): 5 V
 USB-C -port ström (A): 0,5 A
 Maximal EIRP: 4,77+dBm
 Standby-tid: 150h
 Talktid: Cirka 4,5 timmar
 Speltid: Cirka 7 timmar
 Laddning av hörlurarna: Cirka 1,5 timme
 Laddning av laddningsfodralet: Cirka 2 timmar
 Vikt: 32g

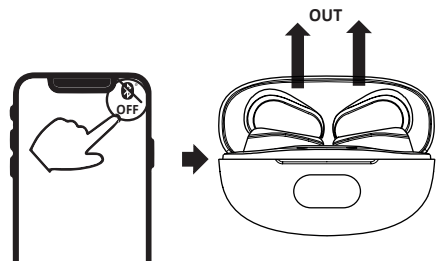
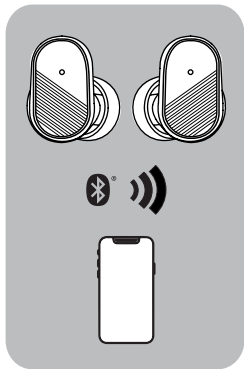
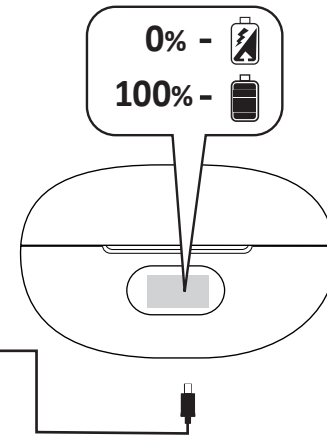
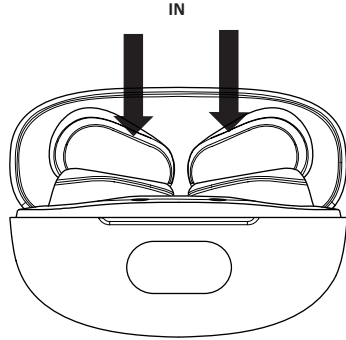

RED/BLUE

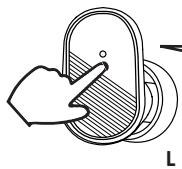
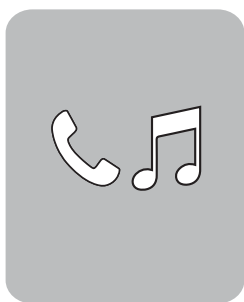
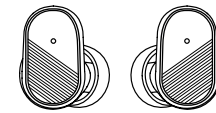
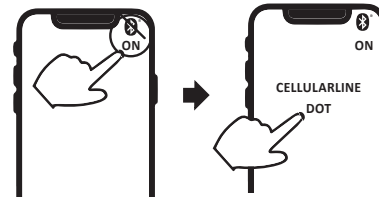

L

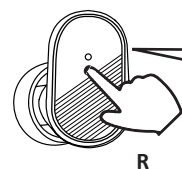
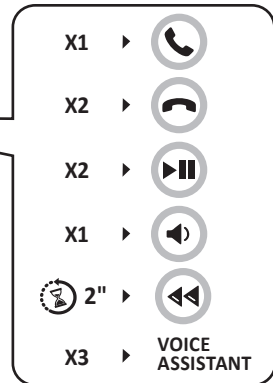

R

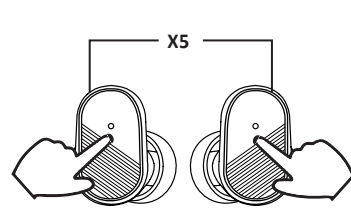
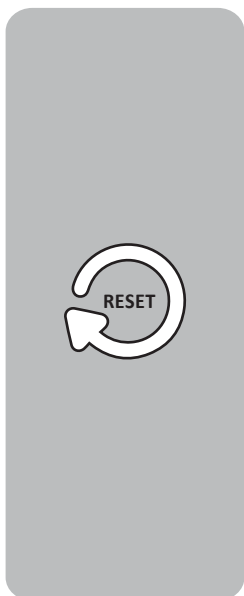
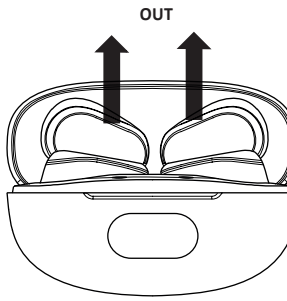
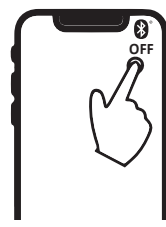
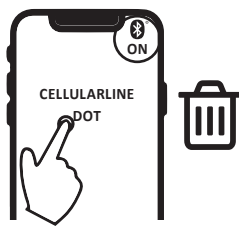
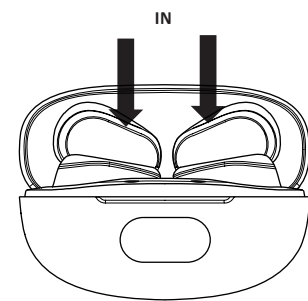
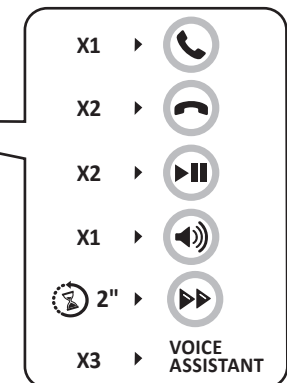

X5 BLUE

X5 BLUE

RED/BLUE

