



G4101

MS-S3371

Server Motherboard
User Guide

Contents

- Regulatory Notices..... 4
- Safety Information 6
- Specifications..... 7
- Overview of Components 9
- Block Diagram 10
- CPU Socket 13
 - CPU & Heatsink Installation..... 14
- Memory Slots..... 17
 - CPU0_DIMM_F1~L1: DDR5 DIMM Slots 17
 - Recommended Memory Population..... 18
 - Key Parameters for DIMM Configuration 18
 - Installing Memory Modules..... 19
- Storage Connectors 20
 - JMCI01~8: MCI0 8i Connectors 21
 - M2_1~2: M.2 Slots (M Key, PCIe 3.0, 22110/ 2280) 22
 - Installing M.2 SSD 22
- Expansion Slots 23
 - PCIE_SL0T1~6: PCIe Expansion Slots 23
- Power Connectors..... 24
 - JPWR_MB1~4: 8-Pin 12V Power Connectors (for MB PWR) 24
 - JPWR_MB5: 8-Pin 12V Power Connector (for BP PWR)..... 24
 - JPWR_MB6, JPWR_MB8: 4-Pin 5V Power Connectors..... 25
 - JPWR_MB7, JPWR_MB9: 4-Pin 3V Power Connectors 25
 - JPWR_HDD1: 8-Pin HDD/SATA Power Connector (on PDB)..... 25

Revision
V1.2, 2024/04

Cooling Connectors	26
SYS_FAN1~8: System/CPU Fan Connectors.....	26
CPU_FAN1~2: CPU Pump Connectors.....	26
WATER_LEAKING1: CPU Pump Water Leak Detection Connector	27
USB Connectors	28
DOM1: USB 3.2 Gen 1 Type-A Port.....	28
JREAR1, JFUSB1: USB 3.2 Gen 1 Headers	29
Other Connectors and Components	30
JVGA: Front VGA Header	30
LAN1: GbE RJ45 Port (for mgmt.)	30
JFP1: Front Panel Header.....	31
JTPM1: SPI TPM Header	32
J95X8: 95X8 I/O Board Header	33
JIPMB1: IPMB Header.....	34
JPSU1: PDB Header	34
BP_I2C_1, PDB_I2C_1: I2C Headers.....	35
JCOM1: COM Port Header	35
JBTN1: Power Button Header.....	36
JREST1: Reset Button Header.....	36
JUID: UID Button Header	36
JCHASSIS1: Chassis Intrusion Header	37
BAT1: CMOS Battery.....	38
Replacing CMOS battery.....	38
Jumpers	39
Onboard LEDs.....	40
BMC_HB_LED: BMC Heartbeat LED.....	40
SEG_LED1~4: Port 80 Debug LEDs.....	41

Regulatory Notices

WEEE Statement

Under the European Union ("EU") Directive on Waste Electrical and Electronic Equipment, Directive 2012/19/EU, products of "electrical and electronic equipment" cannot be discarded as municipal waste anymore and manufacturers of covered electronic equipment will be obligated to take back such products at the end of their useful life.



Chemical Substances Information

In compliance with chemical substances regulations, such as the EU REACH Regulation (Regulation EC No. 1907/2006 of the European Parliament and the Council), MSI provides the information of chemical substances in products at:

<https://csr.msi.com/global/index>

CE Conformity

Hereby, Micro-Star International CO., LTD declares that this device is in compliance with the essential safety requirements and other relevant provisions set out in the European Directive.



FCC-A Radio Frequency Interference Statement

This equipment has been tested and found to comply with the limits for a Class A digital device, pursuant to Part 15 of the FCC Rules. These limits are designed to provide reasonable protection against harmful interference when the equipment is operated in a commercial environment. This equipment generates, uses and can radiate radio frequency energy and, if not installed and used in accordance with the instruction manual, may cause harmful interference to radio communications. Operation of this equipment in a residential area is likely to cause harmful interference, in which case the user will be required to correct the interference at his own expense.



Notice 1

The changes or modifications not expressly approved by the party responsible for compliance could void the user's authority to operate the equipment.

Notice 2

Shielded interface cables and AC power cord, if any, must be used in order to comply with the emission limits.

This device complies with Part 15 of the FCC Rules. Operation is subject to the following two conditions:

- This device may not cause harmful interference, and
- This device must accept any interference received, including interference that may cause undesired operation.

Battery Information

Please take special precautions if this product comes with a battery.

- Danger of explosion if battery is incorrectly replaced. Replace only with the same or equivalent type recommended by the manufacturer.
- Avoid disposal of a battery into fire or a hot oven, or mechanically crushing or cutting of a battery, which can result in an explosion.
- Avoid leaving a battery in an extremely high temperature or extremely low air pressure environment that can result in an explosion or the leakage of flammable liquid or gas.
- Do not ingest battery. If the coin/button cell battery is swallowed, it can cause severe internal burns and can lead to death. Keep new and used batteries away from children.

European Union:



Batteries, battery packs, and accumulators should not be disposed of as unsorted household waste. Please use the public collection system to return, recycle, or treat them in compliance with the local regulations.

BSMI:



廢電池請回收

For better environmental protection, waste batteries should be collected separately for recycling or special disposal.

California, USA:



The button cell battery may contain perchlorate material and requires special handling when recycled or disposed of in California.

For further information please visit:

<http://www.dtsc.ca.gov/hazardouswaste/perchlorate/>

Copyright and Trademarks Notice

msi

MSI

微星

微星科技
MICRO-STAR INTERNATIONAL



Copyright © Micro-Star Int'l Co., Ltd. All rights reserved. The MSI logo used is a registered trademark of Micro-Star Int'l Co., Ltd. All other marks and names mentioned may be trademarks of their respective owners. No warranty as to accuracy or completeness is expressed or implied. MSI reserves the right to make changes to this document without prior notice.

Technical Support

If a problem arises with your product and no solution can be obtained from the user's manual, please contact your place of purchase or local distributor. Alternatively, please visit <https://eps.msi.com/support> for further guidance.

Safety Information

- Always read the safety instructions carefully.
- Keep this User's Manual for future reference.
- Keep this equipment away from humidity.
- Lay this equipment on a reliable flat surface before setting it up.
- The openings on the enclosure are for air convection hence protects the equipment from overheating. **Do not cover the openings.**
- Make sure the voltage of the power source and adjust properly before connecting the equipment to the power inlet.
- Place the power cord such a way that people can not step on it. Do not place anything over the power cord.
- Always unplug the power cord before inserting any add-on card or module.
- All cautions and warnings on the equipment should be noted.
- Never pour any liquid into the opening that could damage or cause electrical shock.
- If any of the following situations arises, get the equipment checked by service personnel:
 - The power cord or plug is damaged.
 - Liquid has penetrated into the equipment.
 - The equipment has been exposed to moisture.
 - The equipment does not work well or you can not get it work according to User's Manual.
 - The equipment has dropped and damaged.
 - The equipment has obvious sign of breakage.
- **Do not leave this equipment in an environment unconditioned, storage temperature above 60°C (140°F), it may damage the equipment.**

Specifications

Model	G4101
Form factor	Proprietary
Dimensions	310mm (12.2"W) x 548mm (21.57"D)
Processor	Single AMD EPYC™ 9004 Series Processor with AMD 3D V-Cache™ Technology, TDP up to 400W
Socket	1 x AMD Socket SP5 (LGA 6096)
Networking	1 x GbE RJ45 port (for Mgmt.) (Realtek® RTL8211FD-CG)
Server Management	<ul style="list-style-type: none"> • 1 x GbE RJ45 port (for Mgmt.) (Realtek® RTL8211FD-CG) • ASPEED AST2600 with AMI MegaRAC based firmware (supports IPMI 2.0 and DMTF Redfish® API)
Graphics	1 x Front VGA header (from AST2600 BMC)
Memory	<ul style="list-style-type: none"> • 12 x DDR5 DIMM slots, 1DPC, RDIMM/ 3DS-RDIMM - Max Frequency: 4800 MT/s (1DPC) - Max Capacity per DIMM: <ul style="list-style-type: none"> » RDIMM: 96GB » 3DS-RDIMM: 512GB
Storage	<ul style="list-style-type: none"> • 8 x MCIO 8i connectors - 6 x MCIO 8i (PCIe 5.0 x8) - 2 x MCIO 8i (PCIe 5.0 x8 or SATA 3.0, 6Gb/s) • 2 x M.2 M-Key slots (PCIe 3.0, 2280/ 22110) - M2_1: PCIe 3.0 x4 - M2_2: PCIe 3.0 x2
Expansion Slots	<ul style="list-style-type: none"> • 6 x PCIe 5.0/4.0 x16 Full-height/Full-length (FHFL) slots - PCIE_SLOT1~4: PCIe 5.0 x16 slots (supports quad-width riser card, signal from CPU) - PCIE_SLOT5~6: PCIe 4.0 x16 slots (PCIe 4.0 x8 signal from CPU)
Internal USB Connectors	<ul style="list-style-type: none"> • 2 x USB 3.2 Gen 1 headers (JREAR1, JFUSB1) • 1 x USB 3.2 Gen 1 Type-A port (DOM1)
System Connectors	<ul style="list-style-type: none"> • 1 x Front panel header • 1 x Front VGA header • 1 x SPI TPM header • 1 x 95X8 I/O board header • 1 x PDB header • 1 x COM port header • 1 x IPMB header • 2 x I2C headers • 1 x Power button header • 1 x Reset button header • 1 x UID button header • 1 x Chassis intrusion header

Model	G4101
Cooling Connectors	<ul style="list-style-type: none"> • 5 x 6-pin system cooling fan connectors (supports chassis non hot-swap fans) • 3 x 6-pin CPU cooling fan connectors (supports CPU cooling non hot-swap fans) • 2 x 4-pin CPU pump connectors (supports CPU cooling pump) • 1 x 4-pin CPU pump water leak detection connector
Power Connectors	<ul style="list-style-type: none"> • 4 x 8-Pin 12V power connectors (for MB PWR) • 1 x 8-Pin 12V power connector (for BP PWR) • 2 x 4-Pin 5V power connectors • 2 x 4-Pin 3V power connectors • 1 x HDD/SATA power connector (on PDB)
Jumpers	<ul style="list-style-type: none"> • 1 x CMOS clear jumper • 1 x UID/ BMC select jumper • 1 x BMC select jumper • 1 x SATA & NVMe signal select jumpers
LED Features	<ul style="list-style-type: none"> • 1 x BMC heartbeat LED • 4 x Port 80 debug LEDs
TPM	1 x TPM header (with SPI interface)
Security	TPM 2.0
Environment	<ul style="list-style-type: none"> • Operating Temperature: 0°C ~ 40°C • Non-operating Temperature: -20°C ~ 70°C • Non-operating Relative Humidity: 5% ~ 85% (non-condensing)
Certification	CE, FCC (Class A)

Overview of Components

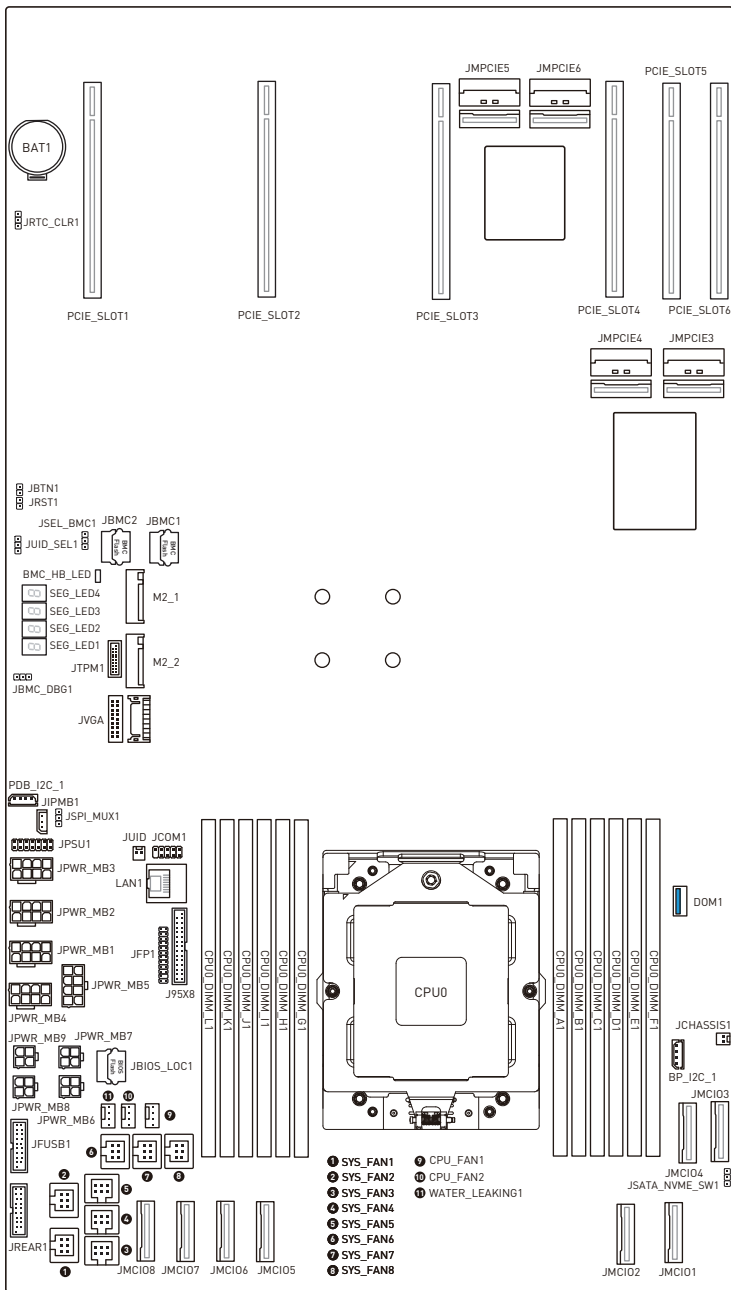

Block Diagram

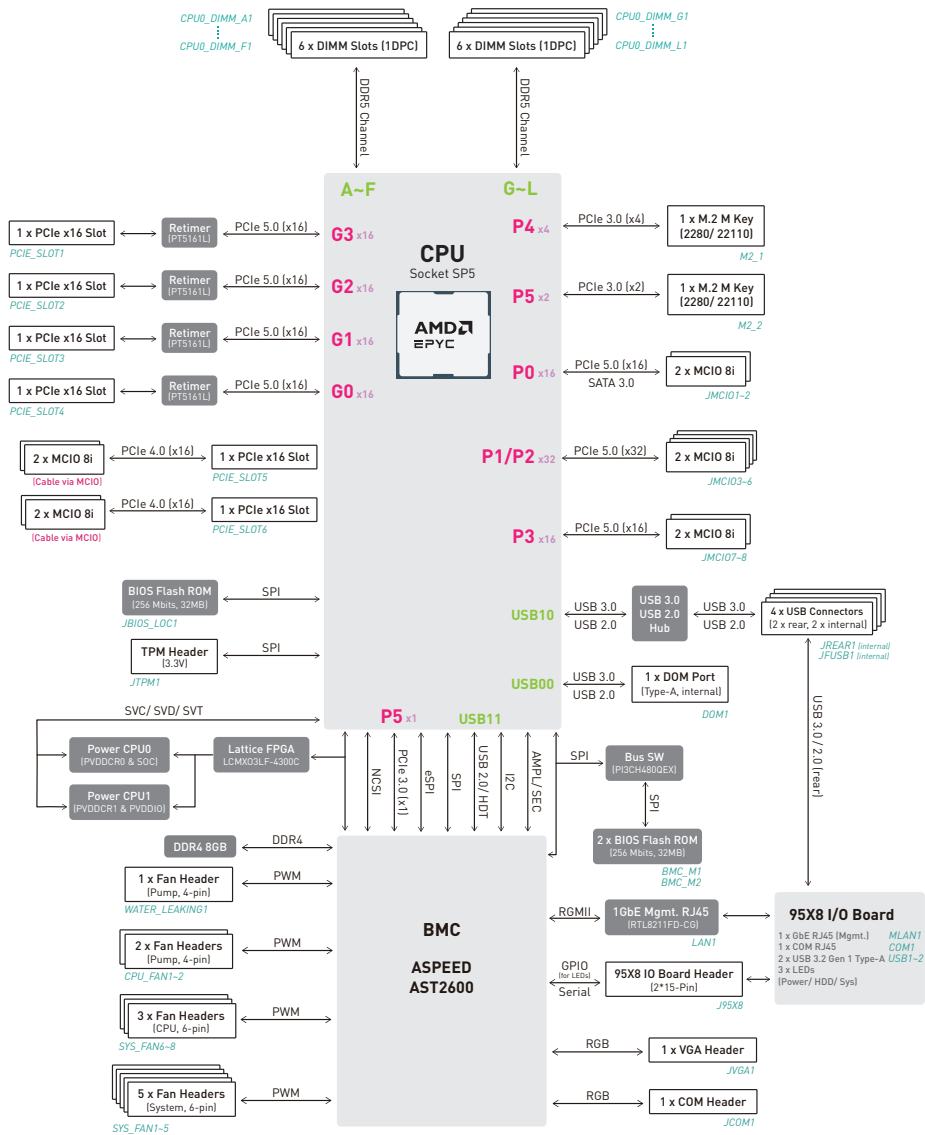

Component Contents

Component	Page
CPU Socket	13
Memory Slots	17
CPU0_DIMM_F1~L1: DDR5 DIMM Slots	17
Storage Connectors	20
JMCI01~8: MCI0 8i Connectors	21
M2_1~2: M.2 Slots (M Key, PCIe 3.0, 22110/ 2280)	22
Expansion Slots	23
PCIE_SLOT1~6: PCIe Expansion Slots	23
Power Connectors	24
JPWR_MB1~4: 8-Pin 12V Power Connectors (for MB PWR)	24
JPWR_MB5: 8-Pin 12V Power Connector (for BP PWR)	24
JPWR_MB6, JPWR_MB8: 4-Pin 5V Power Connectors	25
JPWR_MB7, JPWR_MB9: 4-Pin 3V Power Connectors	25
JPWR_HDD1: 8-Pin HDD/SATA Power Connector (on PDB)	25
Cooling Connectors	26
SYS_FAN1~8: System/CPU Fan Connectors	26
CPU_FAN1~2: CPU Pump Connectors	26
WATER_LEAKING1: CPU Pump Water Leak Detection Connector	27
USB Connectors	28
D0M1: USB 3.2 Gen 1 Type-A Port	28
JREAR1, JFUSB1: USB 3.2 Gen 1 Headers	29
Other Connectors and Components	30
JVGA: Front VGA Header	30
LAN1: GbE RJ45 Port (for mgmt.)	30
JFP1: Front Panel Header	31
JTPM1: SPI TPM Header	32
J95X8: 95X8 I/O Board Header	33
JIPMB1: IPMB Header	34
JPSU1: PDB Header	34

Component	Page
BP_I2C_1, PDB_I2C_1: I2C Headers	35
JCOM1: COM Port Header	35
JBTN1: Power Button Header	36
JRST1: Reset Button Header	36
JUID: UID Button Header	36
JCHASSIS1: Chassis Intrusion Header	37
BAT1: CMOS Battery	38
Jumpers	39
Onboard LEDs	40
BMC_HB_LED: BMC Heartbeat LED	40
SEG_LED1~4: Port 80 Debug LEDs	41

CPU Socket

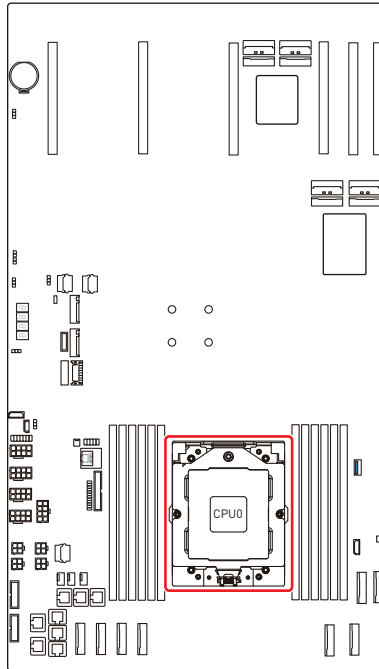

Important

- **Overheating** will seriously damage the CPU and system. Always make sure the cooling fan can work properly to protect the CPU from overheating. Make sure that you apply an even layer of thermal paste (or thermal tape) between the CPU and the heatsink to enhance heat dissipation.
- While **replacing the CPU**, always turn off the power supply or unplug the power supply's power cord from the grounded outlet first to ensure the safety of CPU.
- Do not touch the CPU socket content to avoid damage.
- Whenever CPU is not installed, always protect your CPU socket pins with the plastic cap covered.
- Please refer to the documentation in the CPU cooler package for more details about the CPU cooler installation.
- Read the CPU status in BIOS.

CPU & Heatsink Installation

Use appropriate ground straps, gloves and ESD mats to protect yourself from electrostatic discharge (ESD) while installing the processor.



Images are for illustration purposes only; actual parts may vary.

1. Remove the screw on the top of the retention frame.

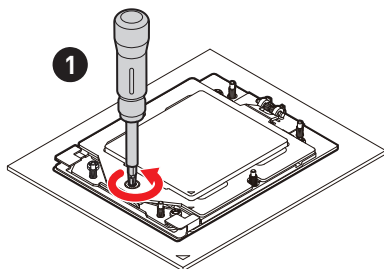

2. After removing the top screw, the **spring-loaded retention frame** will rise up. Hold it gently until it is fully open.
 3. Lift the **rail frame** by gripping the lift tabs near the front edge of the rail frame.
- As both frames are spring-loaded, keep a tight grip on them while lifting to avoid an abrupt swinging motion.

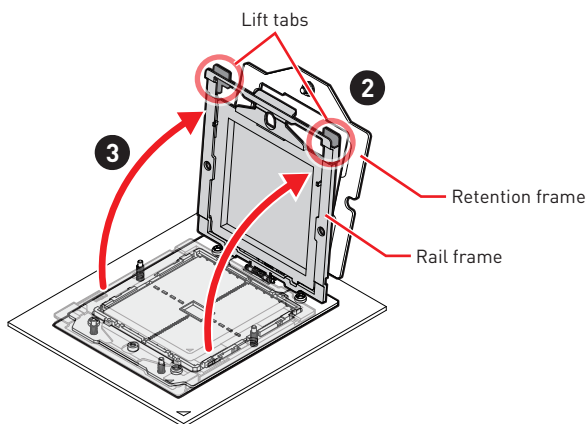

4. Pull the **external cap** upward through the rail guides on the rail frame to remove it.
 5. Grip the handle of the **carrier frame** and slide it downward with the flanges and the rail guides aligned.
- CPUs are shipped from the factory with pre-assembled carrier frames.
 - Make sure the flanges of the carrier frame are firmly loaded on the rails before closing the rail frame.

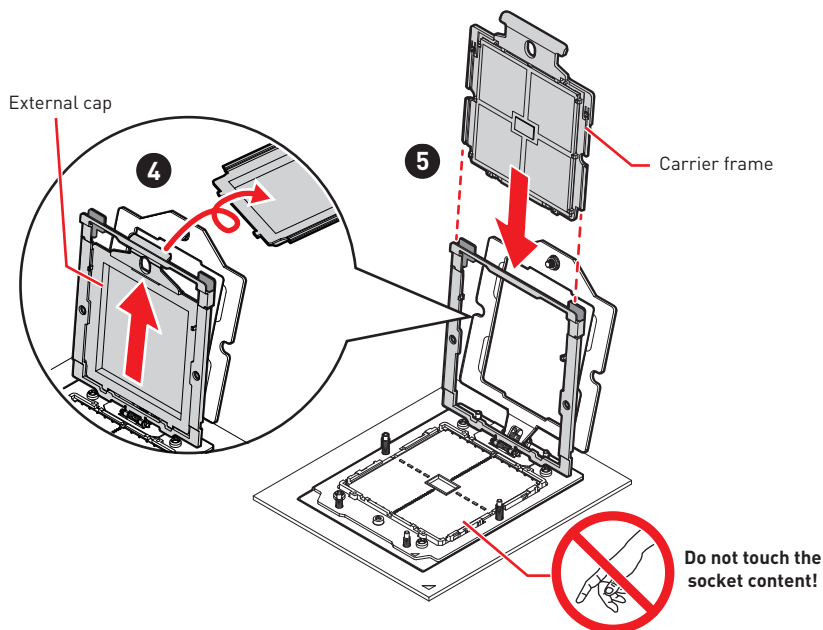

6. Grip the lift tabs at the front edge of the rail frame with the carrier frame loaded, then gently lower it to engage the carrier's latching mechanism to the socket housing.

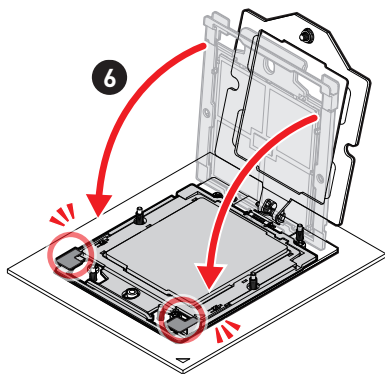

7. Push the retention frame downward and use a torque screwdriver to tighten the screw in the middle.

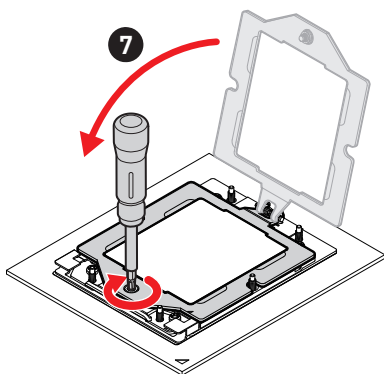

Torque Screwdriver Settings

Screw Head: Torx T20

Torque: 12.5-15 kgf-cm*

*12.5-15 kgf-cm

= 122.6~147 N-m

= 10.9~13 lbf-in

8. For peak thermal performance, apply proper amount of **thermal paste** to the bottom center of the heatsink. (Skip this step if there is pre-applied thermal paste.)
9. Lower the heatsink until it rests firmly in place after aligning the six screw holes on its bottom with the motherboard's studs.
10. Tighten all screws in **diagonal sequence** with a torque screwdriver.
- To avoid damaging the fins of the heatsink, **always grip the heatsink along the axis of the fins**. Holding a heatsink along the side might damage its fins or solder.
 - To avoid distributing uneven pressure on the CPU, it is recommended to **secure the heatsink in two steps**: first, loosely attach the screws at six points and then gradually tighten them.
 - Confirm if your heatsink is firmly installed before turning on your system.

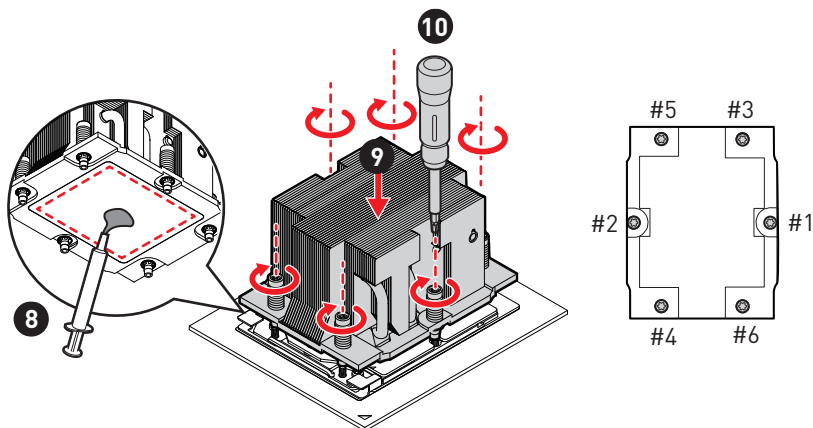

Memory Slots

CPU0_DIMM_F1~L1: DDR5 DIMM Slots

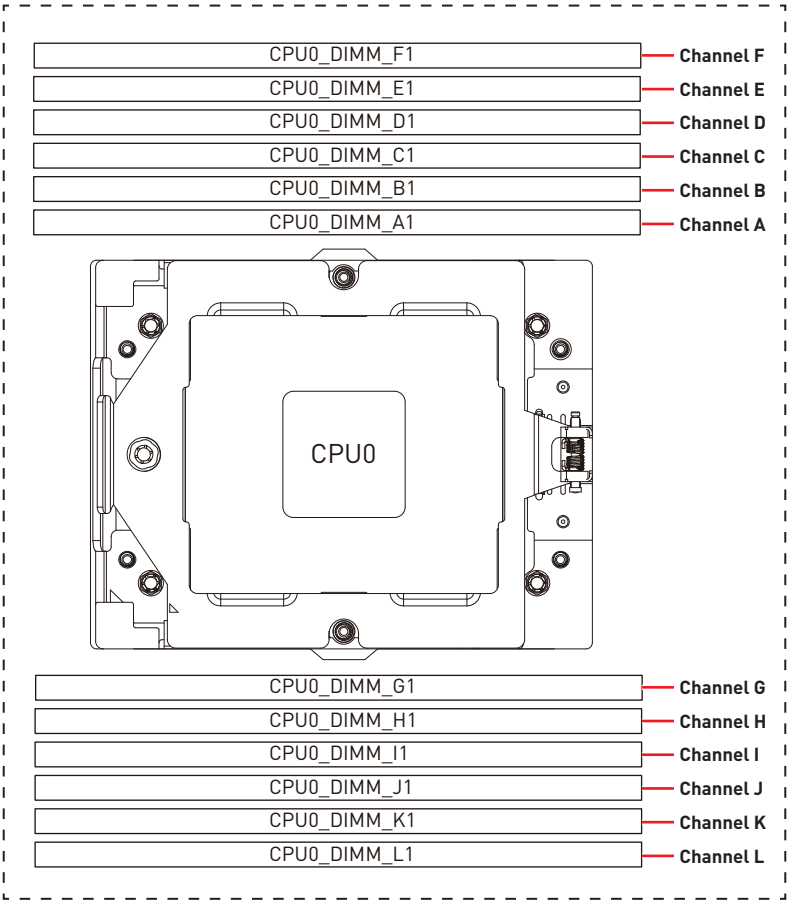

Recommended Memory Population

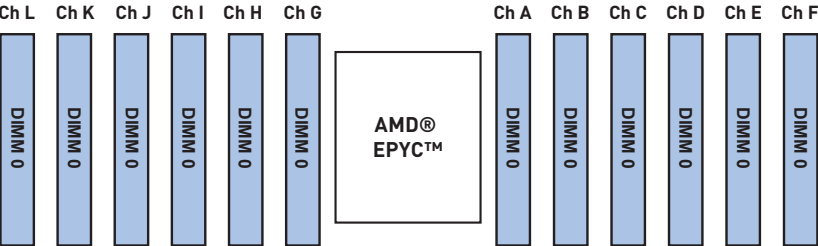

Channel	L	K	J	I	H	G	C P U	A	B	C	D	E	F
Qty. of DDR5													
12	V	V	V	V	V	V		V	V	V	V	V	V
10		V	V	V	V	V		V	V	V	V	V	
8		V		V	V	V		V	V	V		V	
6				V	V	V		V	V	V			
4				V		V		V		V			
2						V		V					
1								V					

Key Parameters for DIMM Configuration

Parameter	Possible Values		
# of DIMMs Populated Per Channel	1DPC (1 DIMM per channel)		
DIMM Type	RDIMM, 3DS RDIMM		
DIMM Construction	RDIMM	1R (1 rank)	4800 MT/s memory speed supported
		2R (2 ranks)	
	3DS RDIMM	2S2R (4 ranks)	
		2S4R (8 ranks)	
		2S8R (16 ranks)	

Important

- There should be at least 1 DDR5 DIMM populated.
- Paired memory installation for Max performance.
- Populate the same DIMM type in each channel, specifically: 1. Use the same DIMM size; 2. Use the same number of ranks per DIMM.
- We don't suggest other memory installation.

Installing Memory Modules

1. Open the side clips to unlock the DIMM slot.
2. Insert the DIMM vertically into the slot, ensuring that the off-center notch at the bottom aligns with the slot.
3. Push the DIMM firmly into the slot until it clicks and the side clips automatically close.
4. Verify that the side clips have securely locked the DIMM in place.

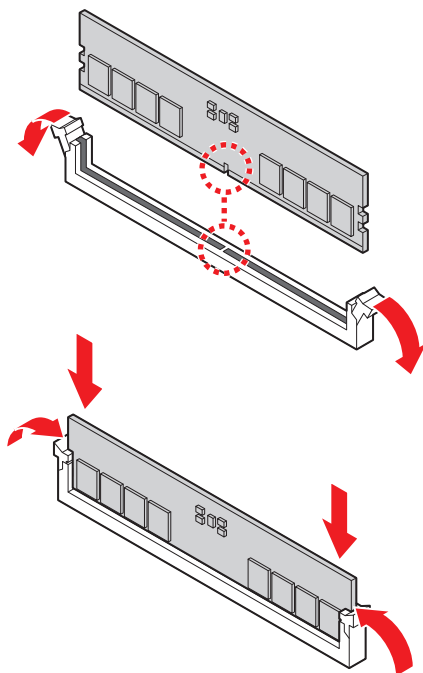

Important

You can barely see the golden finger if the memory module is properly inserted in the DIMM slot.

Storage Connectors

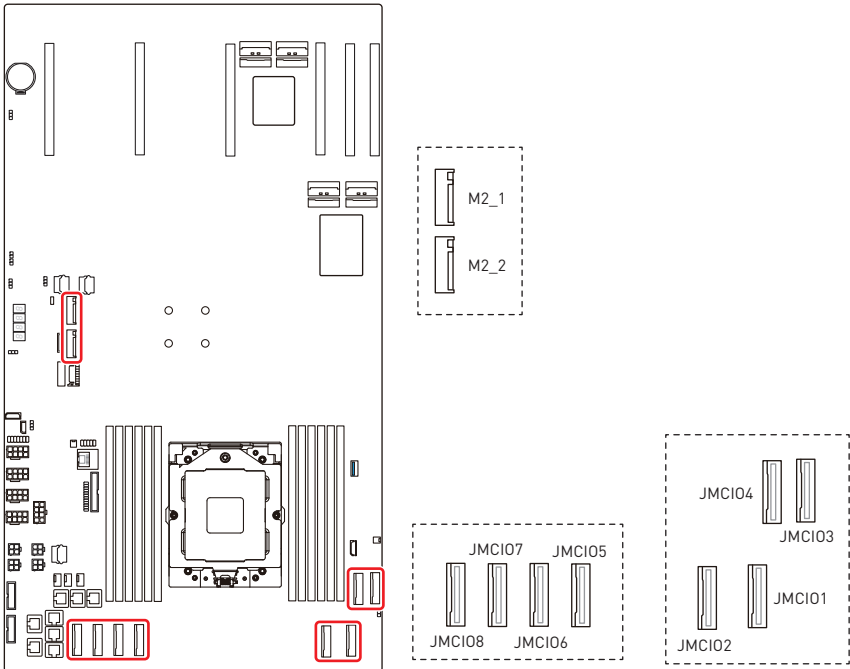

Name	Description
JMCIO1~2	PCIe 5.0 x8, 32GT/s (default)
	SATA 3.0, 6Gb/s
JMCIO3~8	PCIe 5.0 x8, 32GT/s
M2_1	PCIe 3.0 x4, 8GT/s
M2_2	PCIe 3.0 x2, 8GT/s

JMCI01~8: MCIO 8i Connectors

These connectors serve as MCIO interface ports, supporting both SATA and NVMe devices.

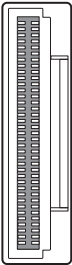
<div>JMCI01~8</div> <div><div>A1</div><div>B1</div><div>A37</div><div>B37</div></div>	A1	GND	B1	GND
	A2	SSD_RX+	B2	SSD_TX+
	A3	SSD_RX-	B3	SSD_TX-
	A4	GND	B4	GND
	A5	SSD_RX+	B5	SSD_TX+
	A6	SSD_RX-	B6	SSD_TX-
	A7	GND	B7	GND
	A8	NC	B8	SMB_PEHPCPU_LV3_SCL
	A9	FM_SMB_CPU_ALERT_N	B9	SMB_PEHPCPU_LV3_SDA
	A10	GND	B10	GND
	A11	CLK_100M_SSD_DP	B11	RST_PCIE_CPU_PERST_N
	A12	CLK_100M_SSD_DN	B12	FM_PCIE_SSD_PRSNT_N
	A13	GND	B13	GND
	A14	SSD_RX+	B14	SSD_TX+
	A15	SSD_RX-	B15	SSD_TX-
	A16	GND	B16	GND
	A17	SSD_RX+	B17	SSD_TX+
	A18	SSD_RX-	B18	SSD_TX-
	A19	GND	B19	GND
	A20	SSD_RX+	B20	SSD_TX+
	A21	SSD_RX-	B21	SSD_TX-
	A22	GND	B22	GND
	A23	SSD_RX+	B23	SSD_TX+
	A24	SSD_RX-	B24	SSD_TX-
	A25	GND	B25	GND
	A26	NC	B26	SMB_PEHPCPU_LV3_SCL
	A27	FM_SMB_CPU_ALERT_N	B27	SMB_PEHPCPU_LV3_SDA
	A28	GND	B28	GND
	A29	CLK_100M_SSD_DP	B29	RST_PCIE_CPU_PESST_N
	A30	CLK_100M_SSD_DN	B30	FM_PCIE_SSD_PRSNT_N
	A31	GND	B31	GND
	A32	SSD_RX+	B32	SSD_TX+
	A33	SSD_RX-	B33	SSD_TX-
	A34	GND	B34	GND
	A35	SSD_RX+	B35	SSD_TX+
	A36	SSD_RX-	B36	SSD_TX-
	A37	GND	B37	GND

M2_1~2: M.2 Slots (M Key, PCIe 3.0, 22110/ 2280)

Please install the M.2 solid-state drive (SSD) into the M.2 slot as shown below.

Installing M.2 SSD



Video Demonstration

Watch the video to learn how to install M.2 SSD.



1. Loosen the M.2 riser screw from the motherboard.

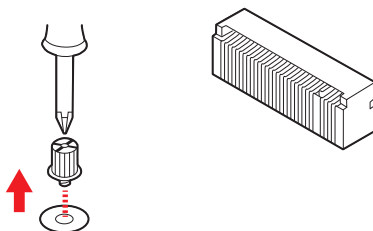

2. Set the M.2 riser screw at the appropriate location based on the length of your M.2 SSD.

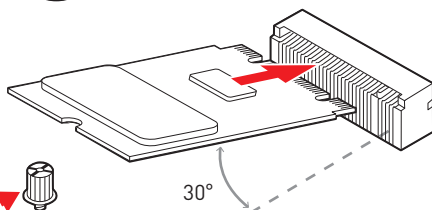

3. Insert your M.2 SSD into the M.2 slot at a 30-degree angle.

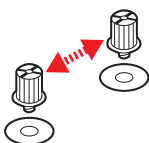

4. Secure the M.2 SSD in place with the supplied M.2 screw.

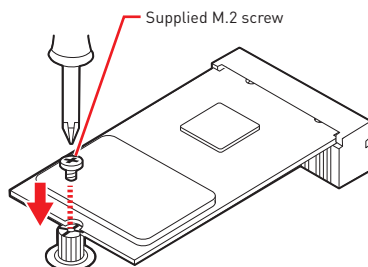

Expansion Slots

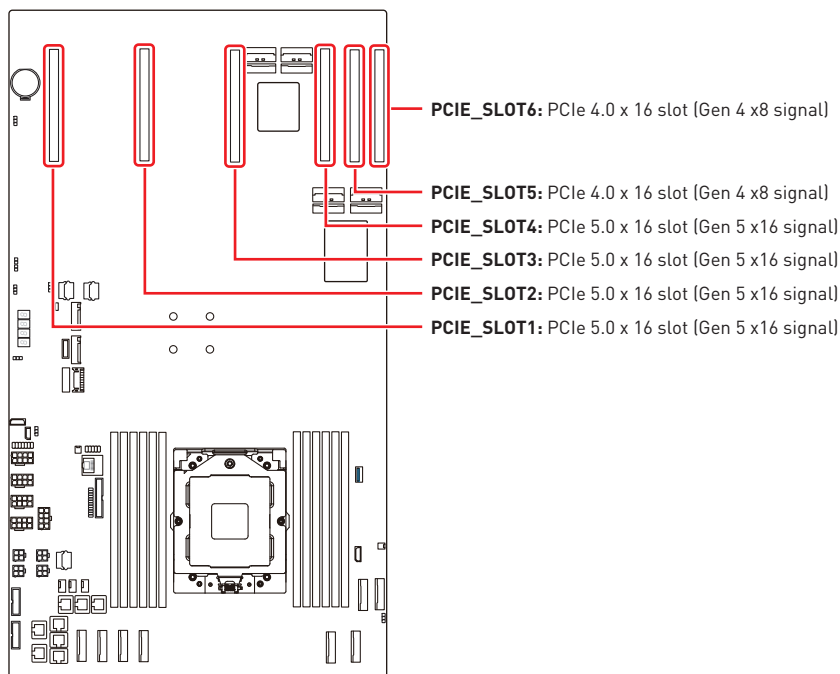

PCIE_SLOT1~6: PCIe Expansion Slots

The PCI Express(Peripheral Component Interconnect Express) slots support PCIe interface expansion cards.



Important

When adding or removing expansion cards, make sure that you unplug the power supply first. Meanwhile, read the documentation for the expansion card to configure any necessary hardware or software settings for the expansion card, such as jumpers, switches or BIOS configuration.

Power Connectors

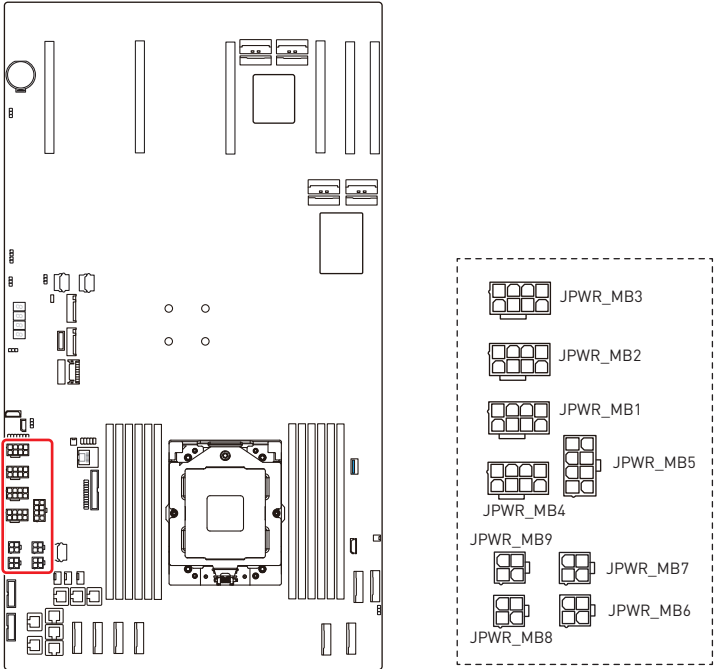

JPWR_MB1~4: 8-Pin 12V Power Connectors (for MB PWR)

JPWR_MB1~4		1	GND	5	P12V
		2	GND	6	P12V
		3	GND	7	P12V
		4	GND	8	P12V

JPWR_MB5: 8-Pin 12V Power Connector (for BP PWR)

JPWR_MB5		1	GND	5	P12V
		2	GND	6	P12V_AUX
		3	GND	7	P12V_AUX
		4	GND	8	P12V_STBY

JPWR_MB6, JPWR_MB8: 4-Pin 5V Power Connectors

JPWR_MB6 JPWR_MB8		1	GND	3	P5V
		2	GND	4	P5V

JPWR_MB7, JPWR_MB9: 4-Pin 3V Power Connectors

JPWR_MB7 JPWR_MB9		1	GND	3	P3V
		2	GND	4	P3V

JPWR_HDD1: 8-Pin HDD/SATA Power Connector (on PDB)

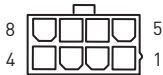
JPWR_HDD1		1	GND	5	P12V
		2	GND	6	P12V
		3	GND	7	P12V
		4	GND	8	P12V

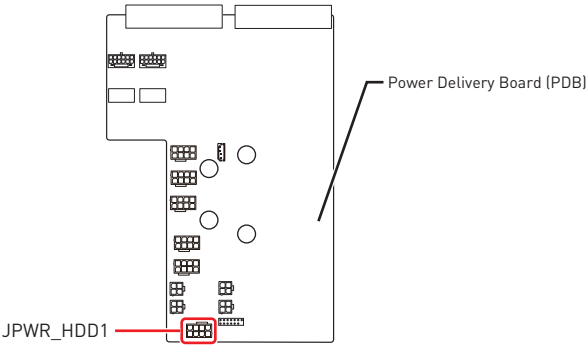

 **Important**

Make sure that all power connectors are securely connected to the power supply to ensure stable operation of the motherboard.

Cooling Connectors

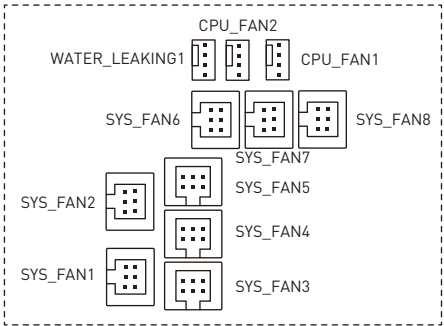
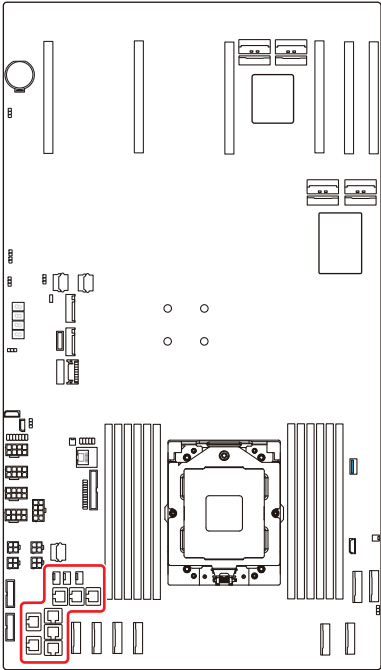

SYS_FAN1~8: System/CPU Fan Connectors

The fan connectors support system/ CPU cooling fans.

SYS_FAN1~8		1	FAN_TACH	2	P12V
		3	PWM	4	P12V
		5	GND	6	GND

CPU_FAN1~2: CPU Pump Connectors

The fan connectors support CPU cooling pump.

CPUFAN1~2		1	GND
		2	P12V
		3	FAN_TACH
		4	BMC_PWM

WATER_LEAKING1: CPU Pump Water Leak Detection Connector

This connector is for detecting water leaks in the CPU water cooling pump. If a leak is detected, the system will automatically shut down for protection.

<div><div>WATER_LEAKING1</div><div><div>1</div><div><div><div></div><div></div><div></div><div></div><div></div></div></div><div>4</div></div></div>	1	P5V_AUX
	2	Water_Leaking
	3	GND
	4	GND

USB Connectors

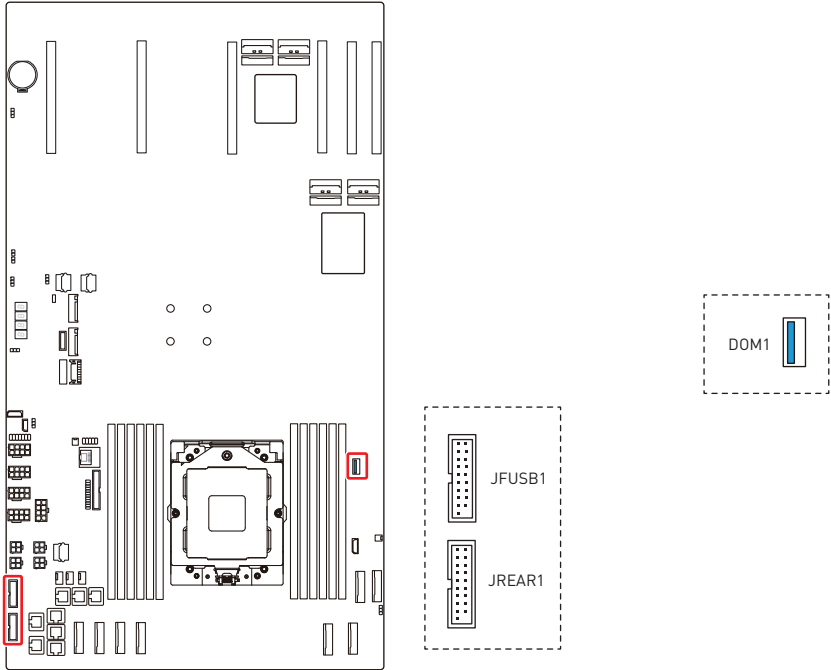

DOM1: USB 3.2 Gen 1 Type-A Port

The USB (Universal Serial Bus) port is used for connecting USB devices such as keyboards, mice, or other compatible peripherals. It supports data transfer rates up to **5 Gbps** and is backward-compatible with USB 2.0 devices.



JREAR1, JFUSB1: USB 3.2 Gen 1 Headers

These headers are backward-compatible with USB 2.0 devices and support data transfer rate up to **5 Gbps**.

JREAR1

JFUSB1

10

11

1

20

JREAR1			
1	P5V_AUX_USB_BP2	11	HUB_SSD2P_ESD_DP
2	HUB_SSRX1N_ESD	12	HUB_SSD2N_ESD_DN
3	HUB_SSRX1P_ESD	13	GND
4	GND	14	HUB_SSTX2_C_ESD_TXP
5	HUB_SSTX1_C_ESD_TXN	15	HUB_SSTX2_C_ESD_TXN
6	HUB_SSTX1_C_ESD_TXP	16	GND
7	GND	17	HUB_SSRX2P_ESD
8	HUB_SSD1N_ESD_DN	18	HUB_SSRX2N_ESD
9	HUB_SSD1P_ESD_DP	19	P5V_AUX_USB_BP3
10	NC	20	No Pin
JFUSB1			
1	P5V_AUX_USB_BP4	11	HUB_SSD4P_ESD_DP
2	HUB_SSRX3N_ESD_RXN	12	HUB_SSD4N_ESD_DN
3	HUB_SSRX3P_ESD_RXP	13	GND
4	GND	14	HUB_SSTX4_C_TXP_ESD_TXP
5	HUB_SSTX3_C_TXN_ESD_TXN	15	HUB_SSTX4_C_TXP_ESD_TXP
6	HUB_SSTX3_C_TXP_ESD_TXP	16	GND
7	GND	17	HUB_SSRX4P_ESD_RXP
8	HUB_SSD3N_ESD_DN	18	HUB_SSRX4N_ESD_RXN
9	HUB_SSD3P_ESD_DP	19	P5V_AUX_USB_BP5
10	NC	20	No Pin

Other Connectors and Components

JVGA: Front VGA Header

The VGA connector is provided for monitors.

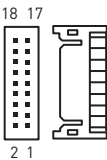
	1	NC	2	NC
	3	F_RED1	4	GND
	5	F_GRN1	6	GND
	7	F_BLU1	8	GND
	9	F_VS1	10	GND
	11	F_HS1	12	GND
	13	F_DDCDAT1	14	NC
	15	F_DDCCLK1	16	P5V
	17	NC	18	NC

LAN1: GbE RJ45 Port (for mgmt.)

The standard RJ-45 LAN jack is for connection to the Local Area Network (LAN). You can connect a network cable to it.

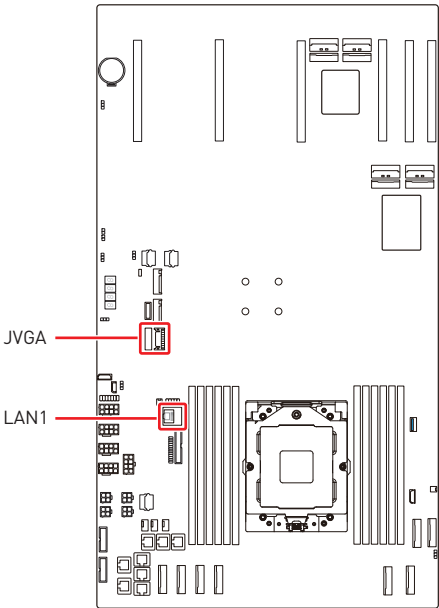

JFP1: Front Panel Header

The front panel header is provided for electrical connection to the front panel switches and LEDs.

<div>JFP1</div> <div><div>24</div><div>23</div><div>2</div><div>1</div></div>	1	VDD_33_DUAL	2	P3V3_AUX
	3	N/A	4	P3V3_AUX
	5	FP_PWR_LED_B_R_N	6	FP_ID_LED_B_R_N
	7	VDD_33_RUN	8	SYS_ERR_LED#_N
	9	FP_HDD_ACT_LED_N	10	SYS_FLT_LED#_N
	11	FP_PWR_BTN_L_R	12	VDD_33_DUAL
	13	GND	14	LAN_NIC_0_ACT_N_R
	15	FP_RST_BTN_L_R	16	SMB_BMC_HSBP_STBY_LVC3_SDA
	17	GND	18	SMB_BMC_HSBP_STBY_LVC3_SCL
	19	FP_ID_BTN_N_R	20	FP_CHASSIS_INTRUSION [TP]
	21	GND	22	VDD_33_DUAL
	23	NMI_BTN_N_R	24	LAN_NIC_1_ACT_N_R

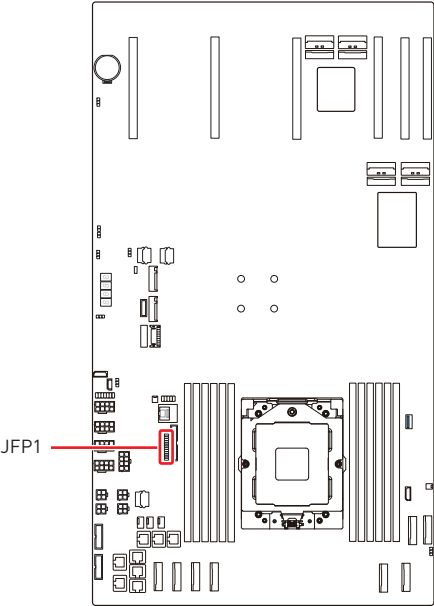

JTPM1: SPI TPM Header

This header connects to a TPM (Trusted Platform Module) (optional). Please refer to the TPM security platform manual for more details.

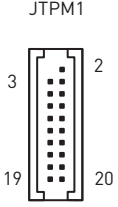
	1	No pin	2	P3V3_AUX
	3	TPM_RSMRST_N	4	N/A
	5	GND	6	P3V3_AUX
	7	SPI_P0_3V3_LOC_CLK	8	P3V3_AUX
	9	P3V3_AUX	10	SPI_P0_3V3_LOC_MISO
	11	N/A	12	SPI_CPU0_3V3_MOSI
	13	SPI_TPM_CS_N	14	GND
	15	P3V3_AUX	16	N/A
	17	IRQ_TPM_SPI_N	18	P3V3_AUX
	19	P0_RESET_LS_L	20	P3V3_AUX

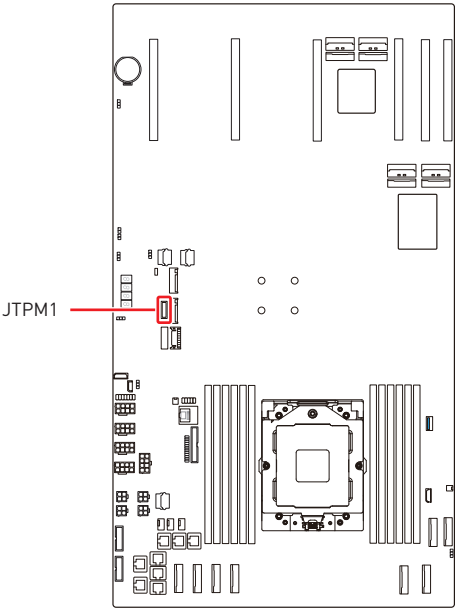

J95X8: 95X8 I/O Board Header

The 95X8 I/O board header is designed to interface with the 95X8 I/O Board. This I/O Board functions as an I/O expander, enabling the expansion of input/output capabilities within a system.

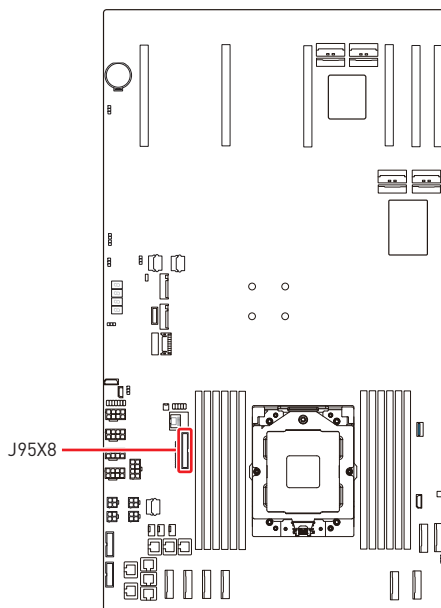
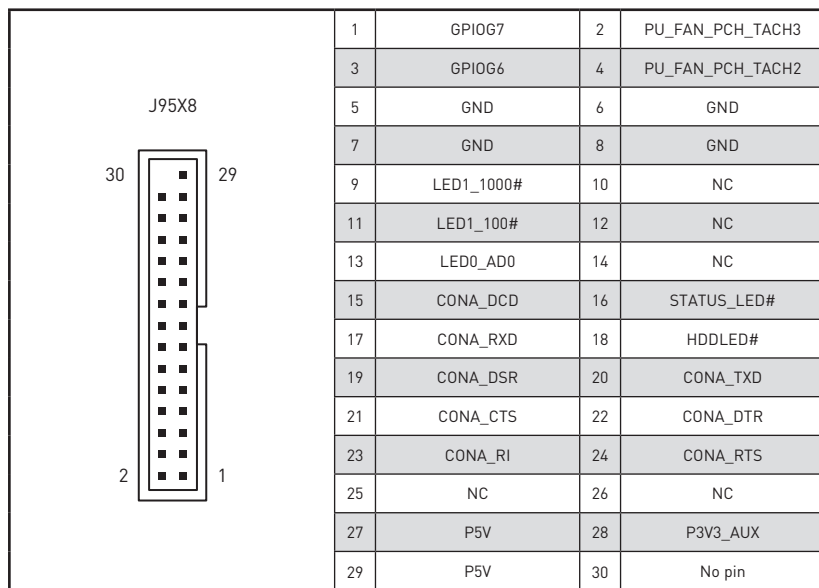

JIPMB1: IPMB Header

Intelligent Platform Management Bus (IPMB) box header is used to connect various management components, such as Baseboard Management Controller (BMC).

	1	SMB_PS1_DAT
	2	GND
	3	SMB_PS1_CLK

JPSU1: PDB Header

This header is designed to interface with the Power Distribution Board (PDB).

	1	PMBUS_CLK1	2	VDD_33_DUAL_EN
	3	PMBUS_DATA1	4	VDD_33_DUAL_PG
	5	SMB_PMBUS_ALERT_N	6	VDD_5_DUAL_EN
	7	PS_ON_N	8	VDD_5_DUAL_PG
	9	PSU_PWR0K_SH_BUF<0>	10	VDD_33_RUN_EN
	11	PSU_PWR0K_SH_BUF<1>	12	VDD_33_RUN_PG
	13	NC	14	PSU_PWR_OK

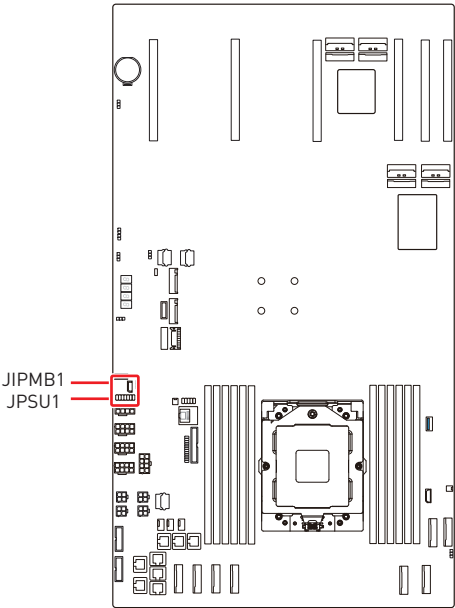

BP_I2C_1, PDB_I2C_1: I2C Headers

I2C connector is used to connect to the System Management Bus (SMBus).

<div>BP_I2C_1</div> <div>PDB_I2C_1</div> 	1	NC
	2	BP_I2C_CLK1
	3	BP_I2C_DAT1
	4	GND

JCOM1: COM Port Header

This header is a 16550A high speed communications port that sends/receives 16 bytes FIFOs. You can attach a serial device to it.

<div>JCOM1</div> 	1	CONB_DCD	2	CONB_RXD
	3	CONB_TXD	4	CONB_DTR
	5	GND	6	CONB_DSR
	7	CONB_RTS	8	CONB_CTS
	9	CONB_RI	10	No pin

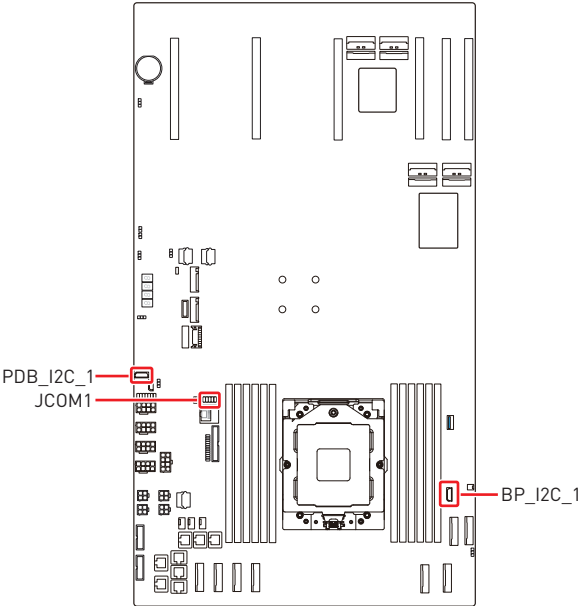

JBTN1: Power Button Header

This header is provided to connect the system power button.

JBTN1		1	FP_PWR_BTN#	2	GND
-------	---	---	-------------	---	-----

JRST1: Reset Button Header

This header is provided to connect the system reset button.

JRST1		1	FP_RST_BTN#	2	GND
-------	---	---	-------------	---	-----

JUID: UID Button Header

This header is provided to connect the system UID button.

JUID		1	REAR_ID_BTN_N	2	GND
------	---	---	---------------	---	-----

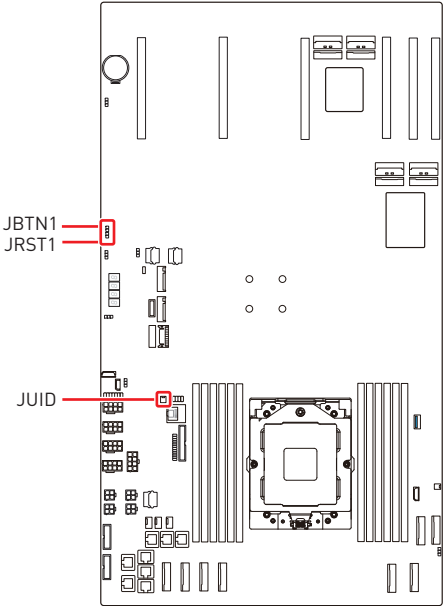

JCHASSIS1: Chassis Intrusion Header

This header connects to the chassis intrusion switch cable. If the chassis is opened, the chassis intrusion mechanism will be activated. The system will record this status and show a warning message on the screen. To clear the warning, you must enter the BIOS utility and clear the record.

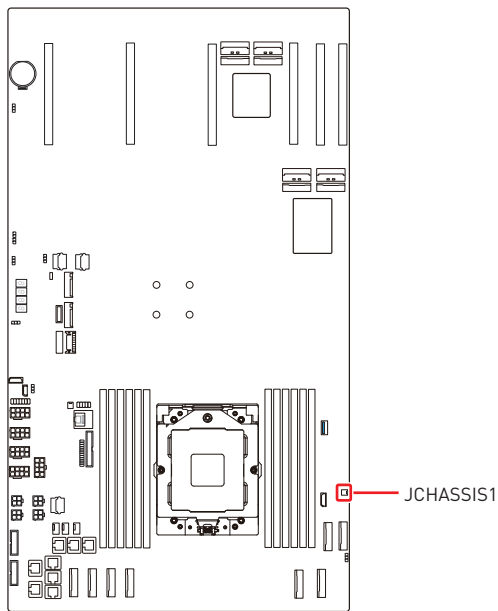
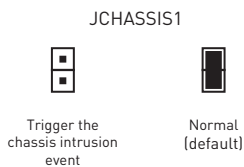

BAT1: CMOS Battery

If the CMOS battery is out of charge, the time in the BIOS will be reset and the data of system configuration will be lost. In this case, you need to replace the CMOS battery.

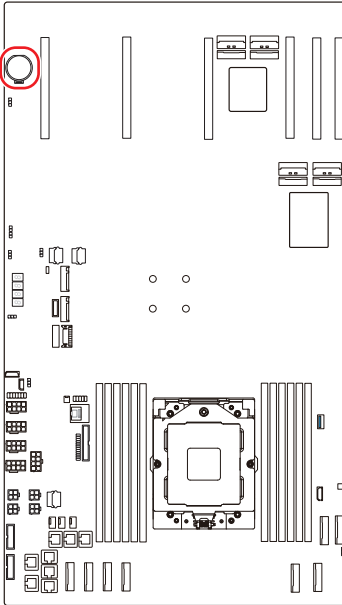

Replacing CMOS battery

1. Push the retainer clip to free the battery.
2. Remove the battery from the socket.
3. Install the new CR2032 coin-cell battery with the + sign facing up. Ensure that the retainer holds the battery securely.

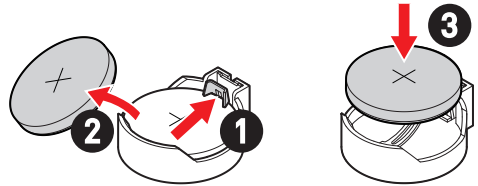

WARNING

KEEP OUT OF REACH OF CHILDREN





- Swallowing can lead to chemical burns, perforation of soft tissue, can death.
- Severe burns can occur within 2 hours of ingestion.
- If you think batteries might have been swallowed or placed inside any part of the body, seek immediate medical attention.

Jumpers

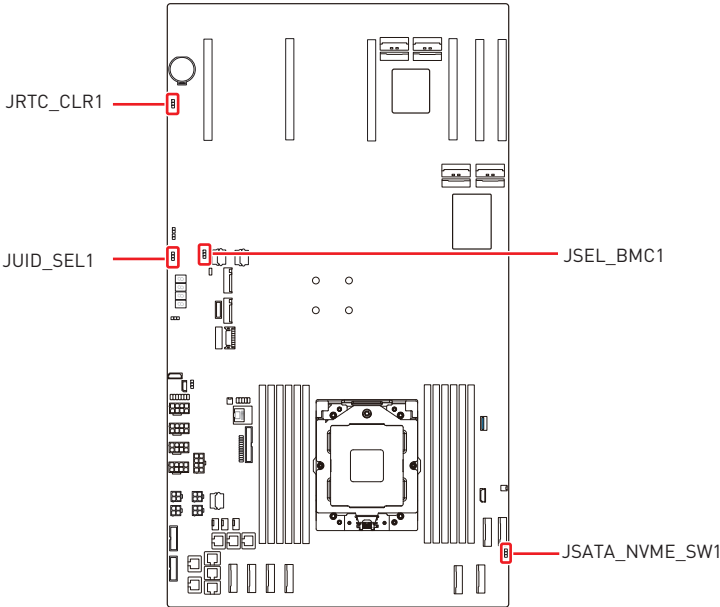

Avoid adjusting jumpers when the system is on; it will damage the motherboard.



Jumper Name	Default Setting	Description
JRTC_CLR1	 1	1-2: Normal (default) 2-3: Clear CMOS
JUID_SEL1	 1	1-2: UID Button (default) 2-3: BMC RST Button
JSEL_BMC1	 1	1-2: BMC2 2-3: BMC1 (default)
JSATA_NVME_SW1	 1	1-2: JMCIO1~2 setting to SATA SIGNAL 2-3: JMCIO1~2 setting to NVME SIGNAL (default)

Onboard LEDs

BMC_HB_LED: BMC Heartbeat LED

This LED indicates the BMC (Baseboard Management Controller) status.

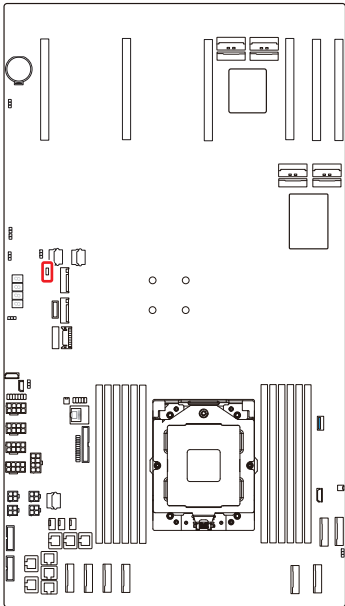

LED Status	Description
Off	BMC is not activated
Blinking	BMC is functioning normally

SEG_LED1~4: Port 80 Debug LEDs

The Port 80 Debug LEDs display progress and error codes during and after POST (Power-On Self Test).

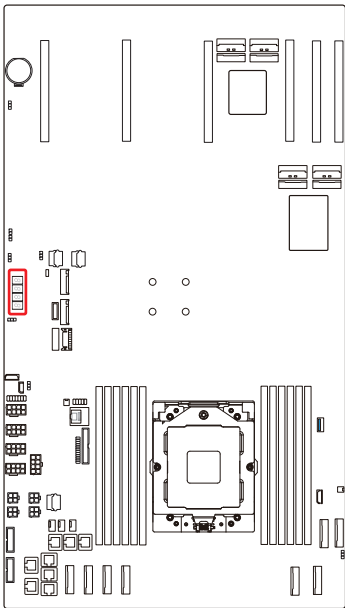

Hexadecimal Character Table

Hexadecimal	0	1	2	3	4	5	6	7
LED display	0	1	2	3	4	5	6	7
Hexadecimal	8	9	A	B	C	D	E	F
LED display	8	9	A	b	C	d	E	F



MSI.COM



EPS.MSI.COM