

Lenovo

ThinkVision

M14t Gen2 LCD Monitor

User's Guide

Machine Type: 63FD

Think

Product Number

63FD-UAR6-WW
D24140QX0



First Edition (06 2024)

© Copyright Lenovo 2024
All rights reserved.

LENOVO products, data, computer software, and services have been developed exclusively at private expense and are sold to governmental entities as commercial items as defined by 48 C.F.R. 2.101 with limited and restricted rights to use, reproduction and disclosure.

LIMITED AND RESTRICTED RIGHTS NOTICE: IF products, data, computer software, or services are delivered pursuant a General Services Administration "GSA" contract, use, reproduction, or disclosure is subject to restrictions set forth in Contract No. GS-35F-05925.

Contents

| | |
|---|------------|
| Product Number | i |
| Contents | ii |
| Safety information | iv |
| Safety and Maintenance Guidelines | v |
| Chapter 1 Getting started | 1-1 |
| Shipping contents | 1-1 |
| Product overview | 1-2 |
| Types of adjustments..... | 1-2 |
| Cable lock slot | 1-2 |
| Using clips | 1-3 |
| Protection Bag | 1-4 |
| Setting up your monitor | 1-5 |
| Connecting and turning on your monitor | 1-5 |
| Registering your option..... | 1-8 |
| Chapter 2 Adjusting and using your monitor | 2-1 |
| Comfort and accessibility | 2-1 |
| Arranging your work area | 2-1 |
| Health Administration | 2-2 |
| Low Blue Light | 2-4 |
| Accessibility information | 2-4 |
| Interact with your monitor | 2-5 |
| Inverted mode..... | 2-6 |
| Touch Screen..... | 2-7 |
| Lenovo Passive Pen..... | 2-10 |
| Touch setting when multi monitors connecting..... | 2-11 |
| Adjusting your monitor image..... | 2-12 |
| Using the direct access controls..... | 2-12 |
| Using the On-Screen Display(OSD) controls | 2-12 |
| Using the Wake on touch Function..... | 2-14 |
| Selecting a supported display mode | 2-15 |
| Understanding power management | 2-16 |
| Caring for your monitor..... | 2-18 |
| Wall Mounting (Optional)..... | 2-18 |
| Chapter 3 Reference information | 3-1 |
| Monitor specifications..... | 3-1 |
| Troubleshooting..... | 3-2 |
| Manually installing the monitor driver | 3-4 |
| Service information..... | 3-5 |
| Appendix A. Service and Support | A-1 |
| Registering your option | A-1 |
| Online technical support..... | A-1 |
| Telephone technical support..... | A-1 |
| Worldwide telephone list..... | A-2 |
| Appendix B. Notices | B-1 |
| Recycling information | B-2 |
| Collecting and recycling a disused Lenovo computer or monitor | B-2 |
| Disposing of Lenovo computer components | B-2 |
| Trademarks..... | B-3 |
| Turkish statement of compliance..... | B-3 |

| | |
|---|-----|
| Ukraine RoHS..... | B-3 |
| India RoHS | B-3 |
| Power cords and power adapters (optional) | B-3 |

Safety information

General Safety guidelines

For tips to help you use your computer safely, go to:

<http://www.lenovo.com/safety>

Before installing this product, read the Safety Information.

يجب قراءة إرشادات السلامة قبل تشغيل هذا المنتج.

Antes de instalar este produto, leia as Informações de Segurança.

在安装本产品之前，请仔细阅读 **Safety Information** (安全信息)。

Prije instaliranja ovog proizvoda obavezno pročitajte sigurnosne upute.

Před instalací tohoto produktu si přečtěte příručku bezpečnostních instrukcí.

Læs sikkerhedsforskrifterne, før du installerer dette produkt.

Ennen kuin asennatt ämän tuotteen, lue turvaohjeet kohdasta Safety Information.

Avant d'installer ce produit, lisez les consignes de sécurité.

Vor der Installation dieses Produkts die Sicherheitshinweise lesen.

Πριν εγκαταστήσετε το προϊόν αυτό, διαβάστε τις πληροφορίες ασφάλειας (safety information).

לפני שתתקינו מוצר זה, קראו את הוראות הבטיחות.

A termék telepítése előtt olvassa el a Biztonsági előírásokat!

Prima di installare questo prodotto, leggere le Informazioni sulla Sicurezza.

製品の設置の前に、安全情報をお読みください。

본 제품을 설치하기 전에 안전 정보를 읽으십시오.

Пред да се инсталира овој продукт, прочитајте информацијата за безбедност.

Lees voordat u dit product installeert eerst de veiligheidsvoorschriften.

Les sikkerhetsinformasjonen (Safety Information) før du installerer dette produktet.

Przed zainstalowaniem tego produktu, należy zapoznać się z książką "Informacje dotyczące bezpieczeństwa" (Safety Information).

Antes de instalar este produto, leia as Informações sobre Segurança.

Перед установкой продукта прочтите инструкции по технике безопасности.

Pred inštaláciou tohto produktu si prečítajte bezpečnostné informácie.

Pred namestitvijo tega proizvoda preberite Varnostne informacije.

Antes de instalar este producto lea la información de seguridad.

Läs säkerhetsinformationen innan du installerar den här produkten.





សូមអានព័ត៌មានសុវត្ថិភាពមុនពេលចាប់ផ្តើមបញ្ចូលកម្មវិធី

安裝本產品之前，請先閱讀「安全資訊」。

Safety and Maintenance Guidelines

Important Safety Information

The power cord is designed for use with your monitor. To use a different cord, use only a power source and connection compatible with this monitor.

-  **WARNING:** Always connect your monitor, the computer, and other equipment to a grounded (earthed) power outlet. To reduce the risk of electric shock or damage to your equipment, do not disable the power cord grounding feature. The grounding plug is an important safety feature.
-  **WARNING:** For your safety, be sure that the grounded power outlet you plug the power cord into is easily accessible to the operator and located as close to the equipment as possible. To disconnect power from the equipment, unplug the power cord from the power outlet by grasping the plug firmly. Never pull on the cord.
-  **CAUTION:** To protect your monitor, as well as your computer, connect all power cords for your computer and its peripheral devices (such as a monitor, printer, or scanner) to a surge protection device such as a power strip with surge protection or uninterruptible power supply (UPS). Not all power strips provide surge protection; the power strips must be specifically labelled as having this ability. Use a power strip whose manufacturer offers a damage replacement policy, so you can replace your equipment if surge protection fails.
-  **CAUTION:** A certified power supply cord has to be used with this equipment. The relevant national installation and/or equipment regulations shall be considered. A certified power supply cord not lighter than ordinary polyvinyl chloride flexible cord according to IEC 60227 (designation H05VV-F 3G 0.75mm² or H05VVH2-F2 3G 0.75mm²) shall be used. An alternative flexible cord is synthetic rubber.

Safety Precautions

- Use only a power source and connection compatible with this monitor, as indicated on the label/back plate of the monitor.
- Be sure the total ampere rating of the products connected to the outlet does not exceed the current rating of the electrical outlet, and the total ampere rating of the products connected to the power cord does not exceed the rating of the power cord. Look on the power label to determine the ampere rating (Amps or A) for each device.
- Install your monitor near a power outlet that you can easily reach. Disconnect the monitor by grasping the plug firmly and pulling it from the outlet. Never disconnect the monitor by pulling the cord.
- Do not allow anything to rest on the power cord. Do not walk on the cord.
- While using VESA mount application, the AC Inlet must face to down side. Do not face any other position.

Maintenance Guidelines

To enhance the performance and extend the life of your monitor:

- Do not open your monitor cabinet or attempt to service this product yourself. If your monitor is not operating properly or has been dropped or damaged, contact your Lenovo authorized dealer, reseller, or service provider.
- Adjust only those controls that are described in the operating instructions.
- Turn your monitor off when not in use. You can substantially increase the life expectancy of the monitor by using a screen saver program and turning off the monitor when not in use.
- Keep your monitor in a well-ventilated area, away from excessive light, heat, or moisture.
- Slots and openings in the cabinet are provided for ventilation. These openings must not be blocked or covered. Never push objects of any kind into cabinet slots or other openings.
- Unplug the monitor from the power outlet before cleaning. Do not use liquid cleaners or aerosol cleaners.
- Do not drop the monitor or place it on an unstable surface.
- When removing the monitor base, you must lay the monitor face down on a soft area to prevent it from getting scratched, defaced, or broken.

Cleaning the Monitor

The monitor is a high-quality optical device that requires special care when cleaning. To clean the monitor, follow these steps:

1. Turn off the computer and the monitor.
2. Unplug your monitor from the power outlet before cleaning.

-  **CAUTION:** Do not use benzene, thinner, ammonia, or any volatile substance to clean the monitor screen or cabinet. These chemicals may damage the monitor. Do not use liquid or aerosol cleaners. Never use water to clean an LCD screen.
3. Wipe the screen with a dry, soft, clean cloth. If the screen requires additional cleaning, use an antistatic screen cleaner.
 4. Dust the monitor housing. Use a damp cloth to clean the cabinet. If the cabinet requires additional cleaning, use a clean cloth dampened with isopropyl alcohol.
 5. Plug in the monitor.
 6. Turn on the monitor and the computer.

Chapter 1 Getting started

This User's Guide contains detailed information on the ThinkVision® M14t Gen2 LCD Monitor. For a quick overview, please see the Setup Poster that was shipped with your monitor.

M14t Gen2 supports Lenovo Accessories and Display Manager-**ThinkColour**.

Shipping contents

The product package should include the following items:

- Information Flyer
- LCD Monitor
- USB Type C-Cable and L-shape dongle
- Protection bag
- Clip x 2
- Passive pen

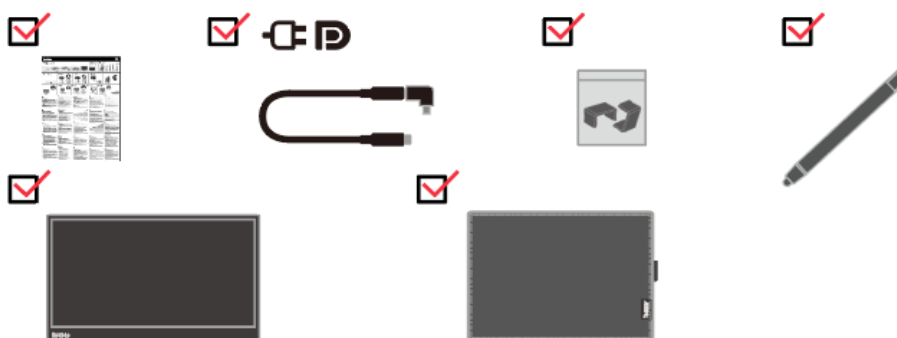

Product overview

This section will provide information on adjusting monitor positions, setting user controls, and using the cable lock slot.

Types of adjustments

Tilt

Please see the illustration below for an example of the tilt range.

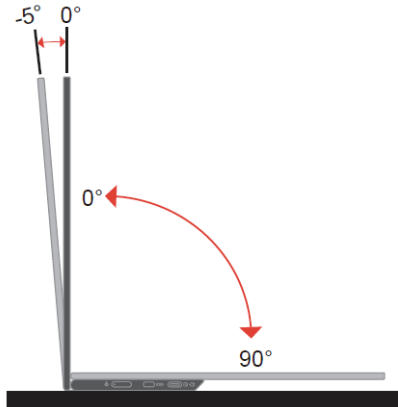

Height Adjustment

After using the support located at the bottom of the base, you can raise the height of the monitor.

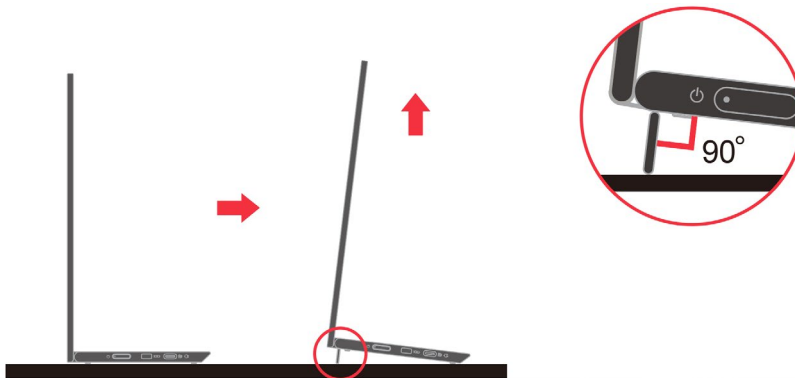

Cable lock slot

Your monitor is equipped with a cable lock slot. Please follow the instructions that came with the cable lock to attach it.

Your monitor supports the following Lenovo lock: 4X90H35558



Using clips

The following instructions show how to use clip for monitor wall mounting (optional).

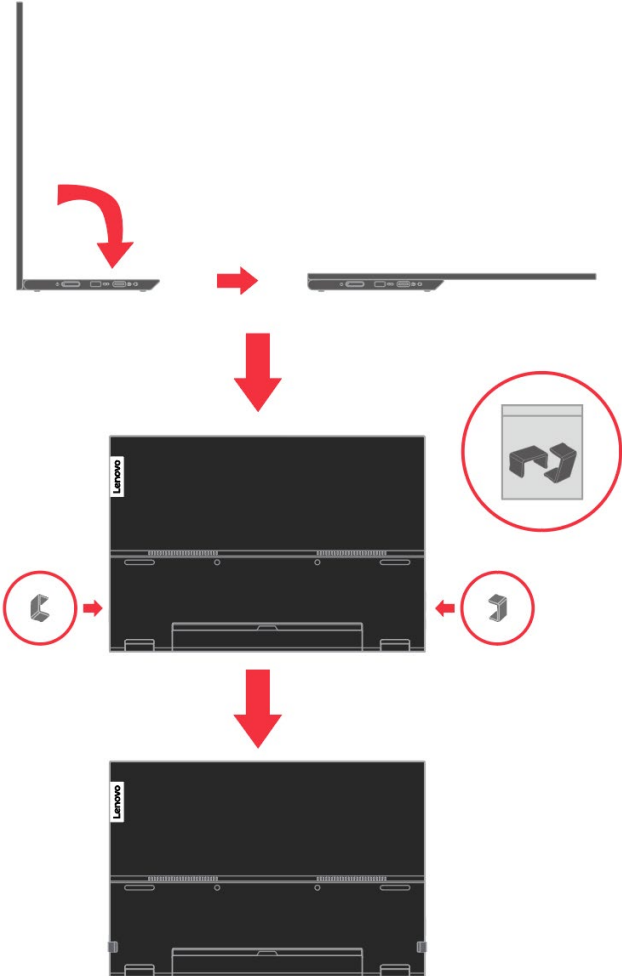

Note: To attach a VESA mount, please see “Wall Mounting (Optional)” on page 2-18.

Protection Bag

The protection bag shipped with the monitor can protect your monitor from damage when shipping or storage.

Following illustrations show how to use the protection bag.

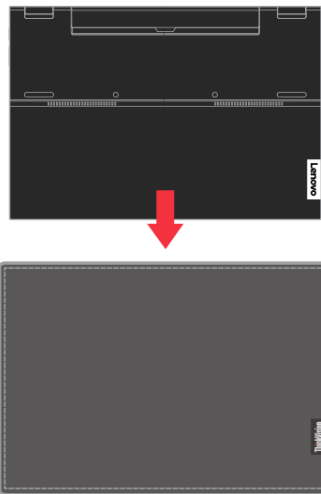

Passive pen can be stored at the side of protection bag.

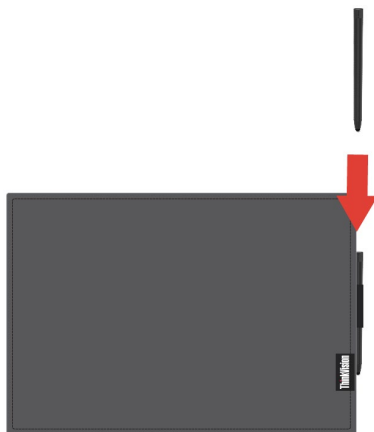

Setting up your monitor

This section provides information to help you set up your monitor.

Connecting and turning on your monitor

Note: Be sure to read the Safety Information located in the Flyer before carrying out this procedure.

1. Power off your computer and all attached devices, and unplug the computer power cord.



2. There are 3 kinds of usage for M14t Gen2; they are normal usage, charging usage and support USB 2.0 HID devices.

Both usages can support USB 2.0 data transfer with supported devices.

- **Normal usage:**

There are 2 kinds of normal usage for M14t Gen2; they are notebook and M14t Gen2, mobile phone and M14t Gen2.

- 1) Connect the USB-C port of notebook and M14t Gen2 with a USB type-C cable.
(Electronically marked cable, current rating: 5A)

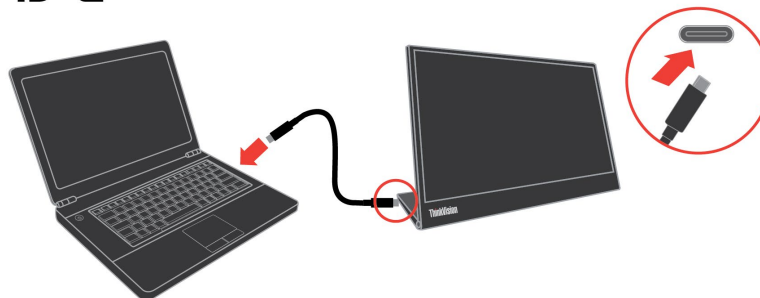

- 2) Connect the USB-C port of mobile phone and M14t Gen2 with a USB type-C cable.
(Electronically marked cable, current rating: 5A)

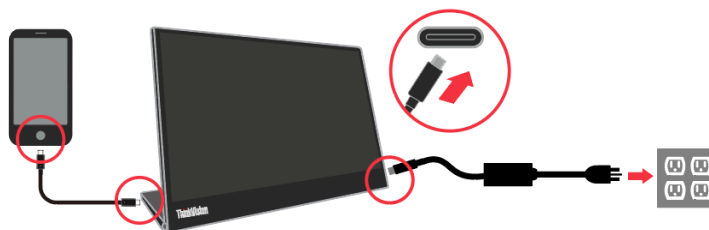

NOTE:

- For normal usage, devices connected to M14t Gen2 need to support video signal and power output.
- When you encounter abnormal display condition, please check your devices to see if they support USB-C Alt-mode display and Connect Type-C power adapter in another Type-C port is must. After checking, please re-connect and try again.
- Not all smart phones can power on M14t Gen2. Please confirm with your phone manufacturer to ensure that your phone can output at least 10W (5V2A) through the USB-C Port without Type-C power adapter.

- **Charging usage:**

There are 2 kinds of charging usage for M14t Gen2; they are notebook and M14t Gen2 with power adapter, mobile phone and M14t Gen2 with power adapter.

- 1) Connect Type-C power adapter to the left or right side of M14t Gen2 and connect M14t Gen2 to the notebook with a USB-C cable.
(Electronically marked cable, current rating: 5A)

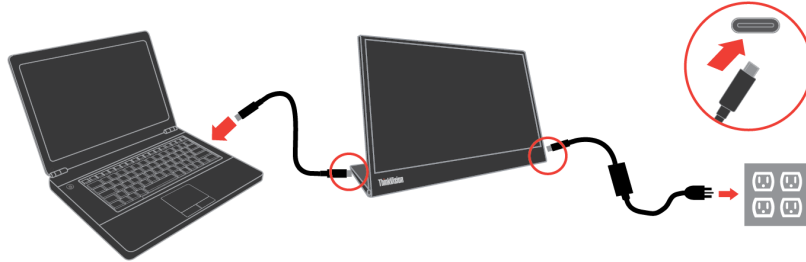

- 2) Connect Type-C power adapter to the left or right side of M14t Gen2 and connect M14t Gen2 to the mobile phone with a USB-C cable.
(Electronically marked cable, current rating: 5A)

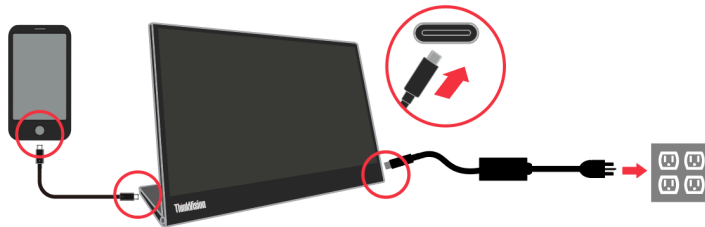

NOTE:

- When you encounter abnormal charging condition, please check your power capacity of power adapter connected with M14t Gen2 and make sure it is enough for M14t Gen2 and other devices.
- In order to use the monitor smoothly, please refer to the display mode on page 2-15 and power management on page 2-16.
- Recommend users to set out screen timeout as “never” on phones to avoid monitor screen off.

- **USB 2.0 HID Device support:**

Connect the USB-C port of notebook and M14t Gen2 with a USB type-C cable.

(Electronically marked cable, current rating: 5A) and connect USB2.0 HID Devices in M14t Gen2 another USB-C port.

1) USB-C Earphone (include Digital codec IC)

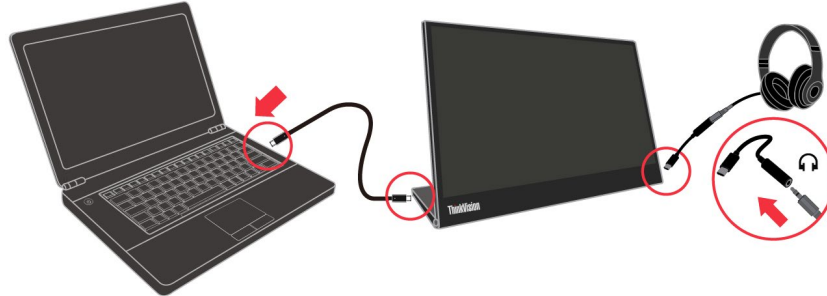

2) USB 2.0 Mouse/Keyboard/Disk.....

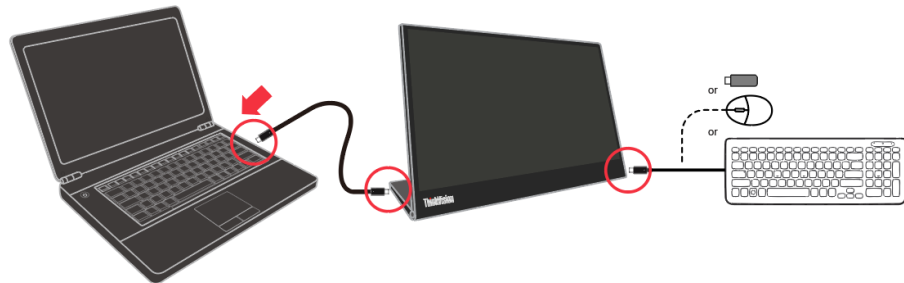

NOTE 1:

USB-C earphone converter only support USB CODEC included type, not support USB-C audio adapter accessory mode.

NOTE 2:

Excessive sound pressure from ear-/headphones can cause hearing damage/hearing loss.

NOTE 3:

When you encounter abnormal display condition, please check your Sources devices to see if they support PDO 5V/2A or above for M14t Gen2 and USB2.0 devices. After checking, please re-connect and try again.

NOTE 4:

Only allow USB 2.0 devices that consume less than 2.5 Watts (5V/0.5A)

3. L-shape dongle usage.

The L-shape dongle can be connected to the adapter or USB-C port to have a better cable management.

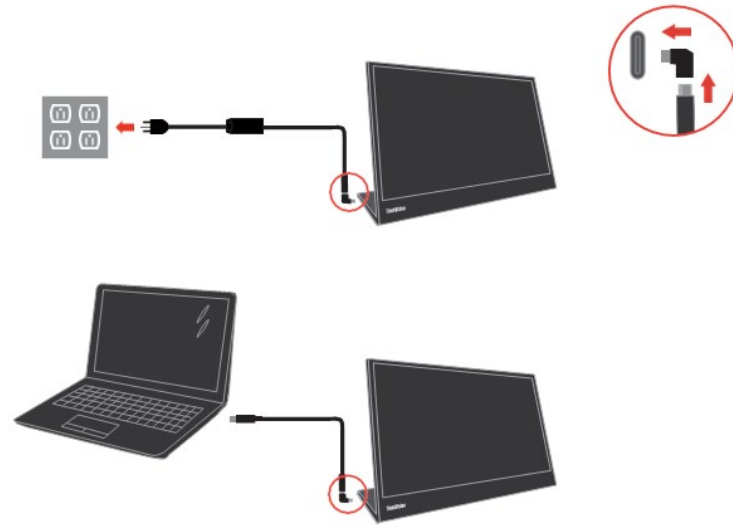

Note: Suggest to use when you rotating the monitor to a different angle, do not use when you need to press the direct access controls key.

4. Power on the monitor.

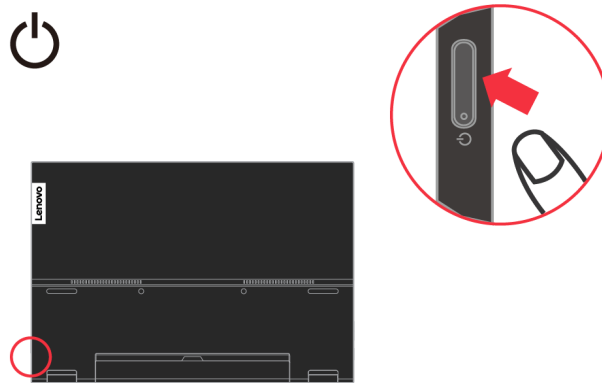

5. To install the monitor driver, you must download it from Lenovo website, (http://support.lenovo.com/docs/m14t_gen2) and follow the instructions on page 3-4.

Registering your option

Thank you for purchasing this Lenovo® product. Please take a few moments to register your product and provide us with information that will help Lenovo to better serve you in the future. Your feedback is valuable to us in developing products and services that are important to you, as well as in developing better ways to communicate with you. Register your option on the following Web site:

<http://www.lenovo.com/register>

Lenovo will send you information and updates on your registered product unless you indicate on the Web site questionnaire that you do not want to receive further information.

Chapter 2 Adjusting and using your monitor

This section will give you information on adjusting and using your monitor.

Comfort and accessibility

Good ergonomic practice is important to get the most from your personal computer and to avoid discomfort. Arrange your workplace and the equipment you use to suit your individual needs and the kind of work that you perform. In addition, use healthy work habits to maximize your performance and comfort while using your computer.

Arranging your work area

Use a work surface of appropriate height and available working area to allow you to work in comfort.

Organize your work area to match the way you use materials and equipment. Keep your work area clean and clear for the materials that you typically use and place the items that you use most frequently, such as the computer mouse or telephone, within the easiest reach.

Equipment layout and setup play a large role in your working posture. The following topics describe how to optimize equipment setup to achieve and maintain good working posture.

Positioning and viewing your monitor

Position and adjust your computer monitor for comfortable viewing by considering the following items:

- **Viewing distance:** Optimal viewing distances for monitors range from approximately 510mm to 760mm (20 in to 30 in) and can vary depending on ambient light and time of day. You can achieve different viewing distances by repositioning your monitor or by modifying your posture or chair position. Use a viewing distance that is most comfortable for you.
- **Monitor height:** Position the monitor so your head and neck are in a comfortable and neutral (vertical, or upright) position. If your monitor does not have height adjustments, you might have to place books or other sturdy objects under the base of the monitor to achieve the desired height. A general guideline is to position the monitor such that the top of the screen is at or slightly below your eye-height when you are comfortably seated. However, be sure to optimize your monitor height so the line of site between your eyes and the centre of the monitor suits your preferences for visual distance and comfortable viewing when your eye muscles are in a relaxed state.
- **Tilt :** Adjust the tilt of your monitor to optimize the appearance of the screen content and to accommodate your preferred head and neck posture.
- **General location:** Position your monitor to avoid glare or reflections on the screen from overhead lighting or nearby windows.

The following are some other tips for comfortable viewing of your monitor:

- Use adequate lighting for the type of work you are performing.
- Use the monitor brightness, contrast, and image adjustment controls, if equipped, to optimize the image on your screen to meet your visual preferences.
- Keep your monitor screen clean so you can focus on the screen's contents.

Any concentrated and sustained visual activity can be tiring for your eyes. Be sure to periodically look away from your monitor screen and focus on a far object to allow your eye muscles to relax. If you have questions on eye fatigue or visual discomfort, consult a vision care specialist for advice.

Health Administration

Prolong exposure to computer screens may cause temporary visual fatigue. Factors including working environment, working habit and posture, screen flicker and blue light contribute to this condition. To minimize visual fatigue certain adjustments can be made on the work stations or using suitable computer screens with features that alleviate eye strain.

Environment

Visual fatigue is affected by the working environment. Glare reductions and appropriate lighting situations help minimize this condition.

- Glare reduction

Glare can be reduced by

- a) Changing position of any light source that is causing the glare.
- b) Fitting the light sources with appropriate diffusers or lampshade.
- c) Using curtains or blind on windows to minimize glare from direct sunlight.
- d) Adjusting monitor position to be perpendicular to the source of light or windows.
- e) Using an anti-glare screen - ThinkVision monitors have anti-glare surface treatment that scatters light for a reflection-free work usage.

- Lighting

Adequate lighting is necessary to avoid glare and eye fatigue. Excessive or insufficient lighting makes the display on screen harder to see. Generally, lighting level should not exceed 750 lux and levels ranging from 300 to 500 lux are most appropriate for computer desk work. Recommended lighting arrangement includes positioning work stations away from direct sunlight or using overhead lighting with baffles or louvers that reduces glare.

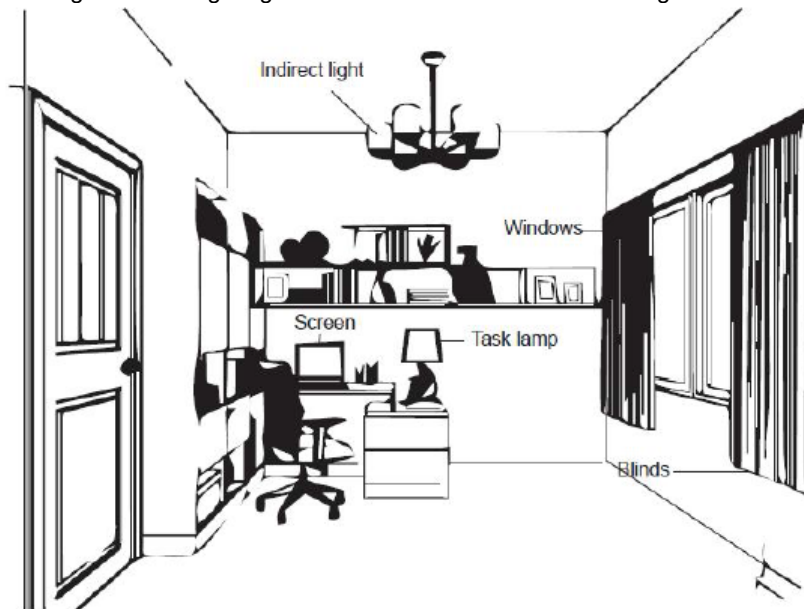

Working Habits

Long exposures to computer screens may cause eye strain. Symptoms include headache, burning eyes, blurred vision and discomfort. To minimize eye strain, computer users can adjust working habits to let their eyes relax and recover.

- Break Times

Computer users should take some time away from the screen especially if working for prolonged hours. Generally, it is recommended to take short breaks (5 – 15 mins) after 1 –2 hours of continuous computer works. Taking short and frequent breaks is more advised than longer breaks.

- Looking at Distant Objects

Users often blink less when in front of monitor screen. To minimize eye strain and dryness, users should rest the eye periodically by focusing on objects that are far away.

- Eye and Neck Exercises

Certain exercise reduces eye strain and prevent early onset of musculo-skeletal disorders. It is recommended to repeat these exercises often. However, should symptoms persists it is recommended to consult a physician.

Exercises for the eye:

1. Alternate looking up and looking down while keeping the body and head upright.
2. Slowly roll your eyes to look to the left and right.
3. Roll eyes to look at objects on the upper right corner and then on lower right. Do same thing to look at objects on the upper left and lower left.

Exercises for the neck:

1. Relax arm at the side. Bend head forward to slightly stretch the neck. Hold for 5 seconds.
2. Relax arm at the side. Turn head to the right. Hold for 5 seconds. Then turn head to the left.
3. Relax arm at the side. Swing head to the left. Hold for 5 seconds. Then swing head to the right.

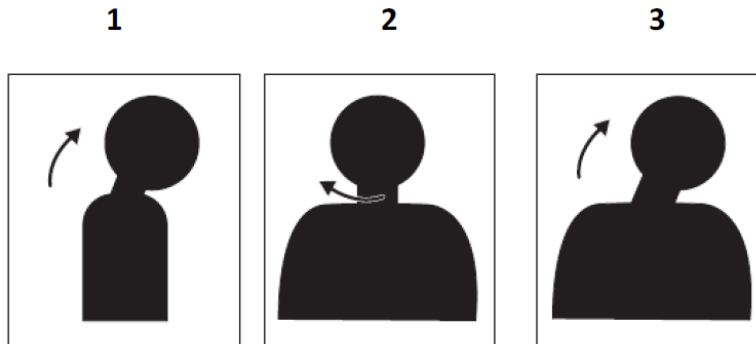

Working Posture

Appropriate working position helps minimize eye discomfort. Seating position and ideal placement of monitor are essential for a comfortable working experience.

- Seating Position

Placing the monitor too far or too close may lead to eye strain. Far viewing distance causes users to lean forward to see small texts, which strain the eyes and torso. Close viewing distance, on the other hand, strains the eye resulting from exerting more effort to focus and also causes the user to sit in awkward body posture (i.e. tilting the head, typing with outstretched arms, etc.)

Recommended viewing distance between the eye and the monitor screen is 1.5 x the diagonal of the screen. Solutions in meeting this required distance in cramped office situations include pulling desk away from wall or divider to make room for monitor, using flat panel or compact displays placing the monitor in the desk corner, or placing the keyboard in an adjustable drawer to create a deeper working surface.



ThinkVision monitors are design to maximize work space (e.g. having thin profiles, compatible for ThinkCentre Tiny back mount, practical cable management, etc).

- Viewing Angle

Neck fatigue and pain may result from prolong turning of the head to see objects on the monitor screen. To minimize this, position the monitor directly in front so the head, neck and torso face forward to the screen. It is recommended that monitor should not be more than 35 degrees to the right or left of the head.

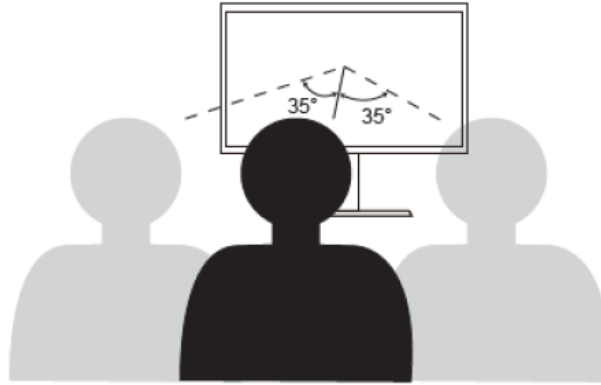

Monitors should also not be placed too high or too low as this contributes to awkward posture which results to muscle fatigue.

Reduce Flicker

Monitor flickers refer to repeated changes in monitor light intensity. It is caused by several factors including but not limited to voltage fluctuations. Reducing flicker minimizes eye strain and headaches. ThinkVision monitors allow users to use high frequency display modes that can effectively reduce flicker.

Low Blue Light

1. The panel default support LBL function.
2. The brightness and contrast factory mode default setting value is 75 & 75.

Concerns on blue light affecting eye health have risen over the years. Blue light have wavelength between 300 nm to 500 nm. The monitors under default setting mode reduce blue light emissions. The monitors achieve the requirement of Low blue Light (Hardware Solution).

Accessibility information

Lenovo is committed to providing greater access to information and technology to people with disabilities. With assistive technologies, users can access information in the way most appropriate to their disability. Some of these technologies are already provided in your operating system; others can be purchased through vendors or accessed at:

https://lenovo.ssbartgroup.com/lenovo/request_vpat.php

Interact with your monitor

The monitor can be placed at different positions. The orientation of the content changes automatically when you rotate the monitor to a different angle. To optimize the experience, the default setting of auto rotation is on. You can turn off the auto rotation through the setting in OSD.

You can switch your display into one of 3 user modes by rotating the display to a different angle.

Note:

- Resolution and project mode can be memorized when M14t Gen2 in stand mode or portrait mode respectively by notebook.
- For more convenient use, please firstly rotate to the angle you need then adjust display mode in notebook.
- Recommend users to set extend mode when M14t Gen2 is in portrait mode.
- When rotating M14t Gen2, make sure the connection between M14t Gen2 & attached device is connected properly. Improper connection might cause the connection to be loose and M14t Gen2 will enter **standby** mode. You can re-connect the attached device to resume M14t Gen2.

Stand mode

Suitable for tasks that require limited interaction with the touch screen (such as displaying graphs or PowerPoint presentations).



Portrait mode

Suitable for tasks that require little or no touch (such as viewing photos or playing videos).

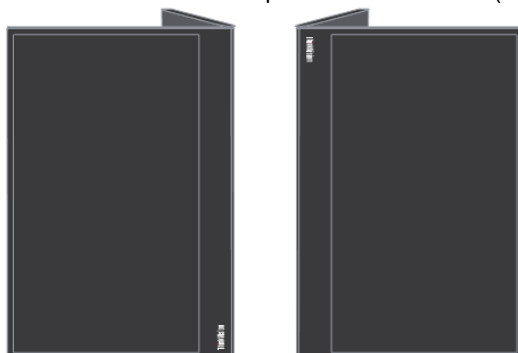

Note:

In this mode, place M14t Gen2 on flat surface and connect M14t Gen2 with attached device through the USB-C port on the top. Place M14t Gen2 on uneven surface might cause the button on the bottom to be mis-activated.

Inverted mode



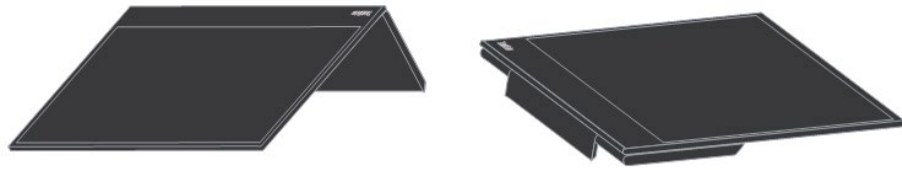









Suitable for tasks that require frequently touching the screen (such as surfing the web, playing games, and more).

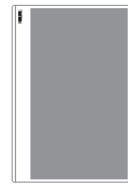

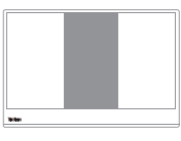
Rotation display

When connected with different devices, M14t Gen2 can display in different modes as below:

- When connected with notebook, M14t Gen2 in portrait mode will display center-screen or full-screen based on notebook desktop modes (Duplicate or Extend).
- When connected with Phone, M14t Gen2 in portrait mode will display center-screen or full-screen based on phone positions (Portrait or Landscape).

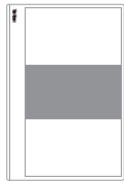
| Connected device | Monitor | | | |
|--|---|--|--|--|
| <p data-bbox="499 779 590 801">Notebook</p>  | <p data-bbox="715 779 826 801">Stand mode</p>  | <p data-bbox="911 779 1023 801">Inverted mode</p>  | <p data-bbox="1118 763 1246 819">Portrait mode (duplicate)</p>  | <p data-bbox="1315 763 1442 819">Portrait mode (extend)</p>  |
| <p data-bbox="512 1048 577 1070">Phone</p>  | <p data-bbox="715 1048 826 1070">Stand mode</p>  | <p data-bbox="911 1048 1023 1070">Inverted mode</p>  | <p data-bbox="1118 1032 1246 1088">Portrait mode (duplicate)</p>  | |
| <p data-bbox="512 1317 577 1339">Phone</p>  | <p data-bbox="715 1317 826 1339">Stand mode</p>  | <p data-bbox="911 1317 1023 1339">Inverted mode</p>  | <p data-bbox="1118 1301 1246 1357">Portrait mode (duplicate)</p>  | |

Note:

Rotating process should take few seconds, please be patient to wait.

Touch Screen

1. M14t Gen2 is equipped with Touch screen to optimize your M14t Gen2 experience.
 - You can use either single finger touch, or multi-finger touch up to maximum simultaneous 10 touch points.
 - You can use Lenovo Passive Pen.
2. M14t Gen2 touch function is available with notebooks or smart phones with Windows, Android, Chrome OS which supports HID multi-touch, Microsoft Pen Protocol or single-touch. Please confirm with your notebook/phones manufacturer to be sure its function availability. The default setting is to support Windows OS. You can change the touch support OS selection in OSD. You can change the touch support OS selection in OSD.

Note:

- Do not touch the screen with sharp objects, it may result in damage, and void warranty.
- Do not push hard, or rest anything on the glass surface (if in horizontal position) as it will damage the screen and void warranty.
- Please keep your hands clean and dry before touching the screen to ensure fluid touch operation.

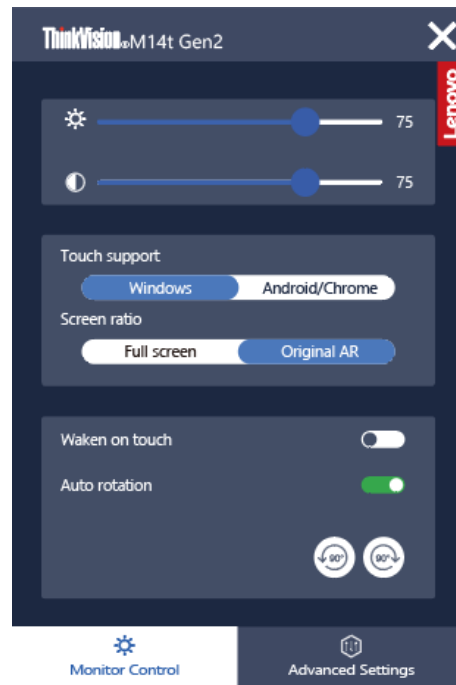

If your connected device supports multi-touch function, you can navigate the screen with simple touch gestures.

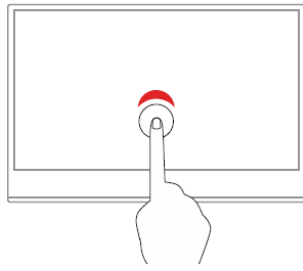

Tap once

- From the Start menu: Open an app or item.
- From the desktop: Select an app or item.
- In an open app: Perform an action such as Copy, Save, and Delete, depending on the app.

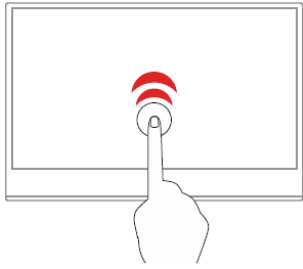

Tap twice quickly

Open an app or item from the desktop.

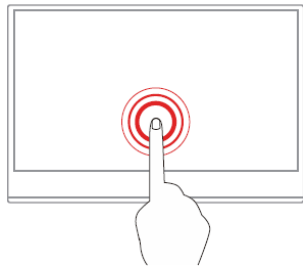

Tap and hold

Open a shortcut menu.

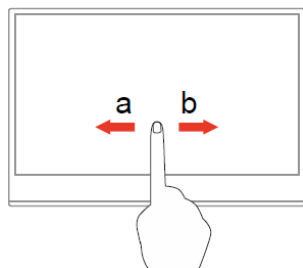

Slide

Scroll through items, such as lists, pages, and photos.

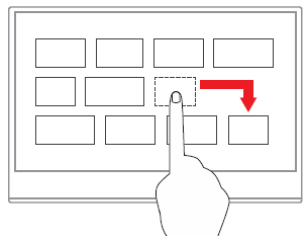

Drag an item to the location you want

Move an object.

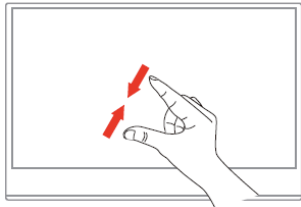
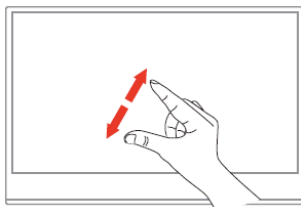
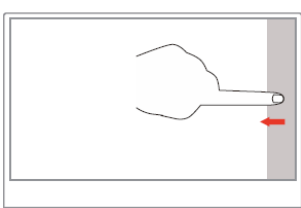
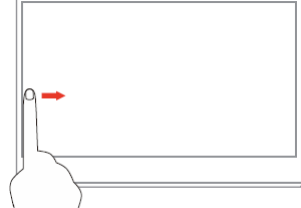
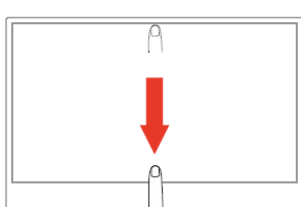
| | |
|---|---|
|  | <p>Move two fingers closer together Open an app or item from the desktop.</p> |
|  | <p>Move two fingers farther apart Zoom in.</p> |
|  | <p>Swipe in from the right edge Open the action center to see your notifications and quick actions.</p> |
|  | <p>Swipe in from the left edge View all your open windows in task view.</p> |
|  | <p>Swipe downwards shortly from the top edge (for fullscreened app or when your computer is in the tablet mode) Show a hidden title bar.</p> <p>Swipe in from the top edge to the bottom edge (when your computer is in the tablet mode) Close the current app.</p> |

Lenovo Passive Pen

Selected models are equipped with Lenovo Passive Pen. The pen is not waterproof. Keep the pen away from water and excessive moisture. To purchase Lenovo Passive Pen, go to

<https://www.lenovo.com/accessories>.

You can perform the following operations with the Lenovo Passive Pen:

Use Lenovo Passive Pen

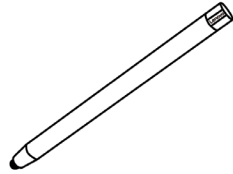

You can perform the following operations with the Lenovo Passive Pen:

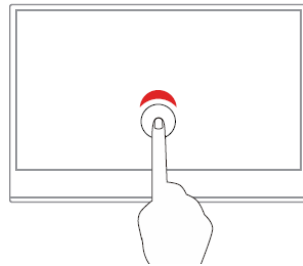

Tap once

Click or make a selection.

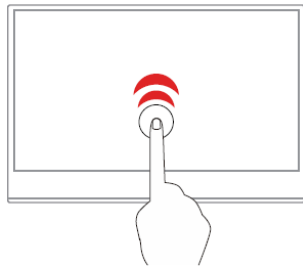

Tap twice quickly

Open an app or item from the desktop.

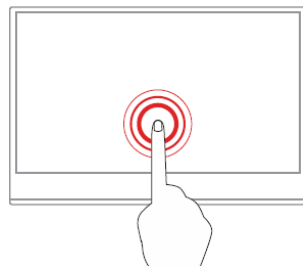

Tap and hold

Right-click.

Touch setting when multi monitors connecting

Please follow below steps to set M14t Gen2 as the touch monitor when connecting multiple monitors with notebooks.

Step 1: Search “Control Panel”

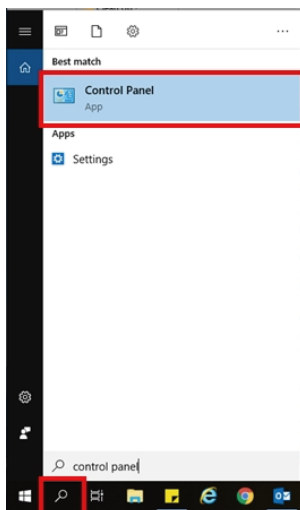

Step 2: Find “Tablet PC Settings”

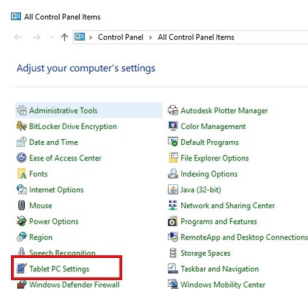

Step 3: Click “SetUp”

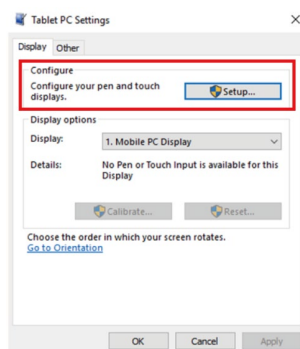

Step 4: Press Enter until the message moves to M14t Gen2. Tap the screen to identify it to complete the setting.

Follow the steps above and the M14t Gen2 will display the message shown below:

Tap this screen with a single finger or touch pen to identify it as the touch monitor. If this is not the Tablet PC screen, press Enter to move to the next screen. To close the tool, press Esc.



Adjusting your monitor image

This section describes the user control features used to adjust your monitor image.

Using the direct access controls

The direct access controls can be used when the On Screen Display (OSD) is not displayed.

Table 2-1 Direct access controls

| Icon | Control | Description |
|---|------------|--|
|  | Brightness | Press + or - key for Brightness adjustment. |
| | Contrast | Press and hold + key over 3 seconds for Contrast adjustment |
|  | Main menu | Open OSD main menu. |
| | Over Drive | Press and hold menu key over 3 seconds for Over drive adjustment |
| N/A | DDC/CI | Press - key and hold for 3s to enable / disable DDC/CI function. |

Using the On-Screen Display(OSD) controls

To use the controls: Press  to open the main OSD menu.

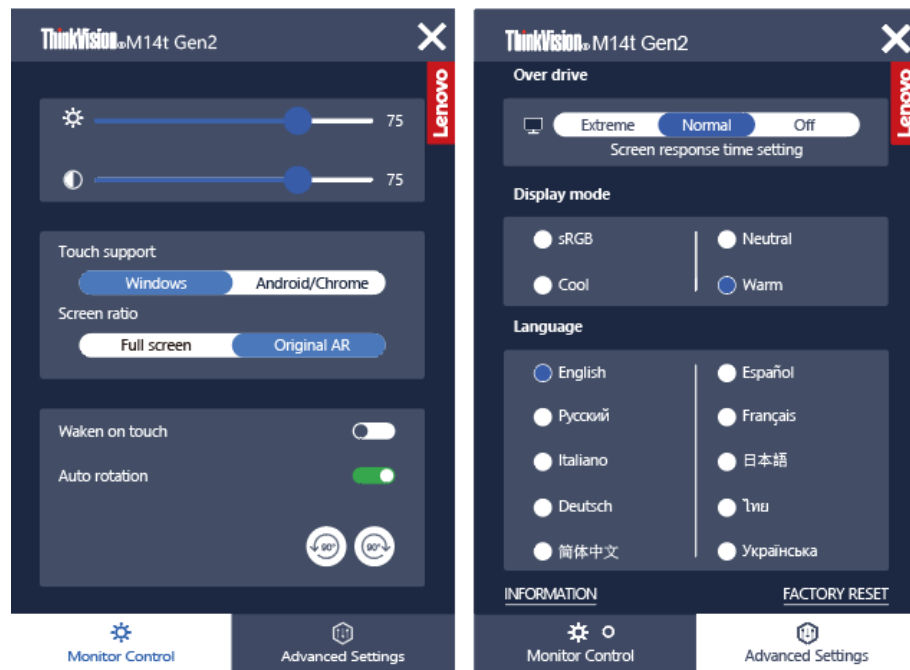

Note:

- When Brightness adjustment bar is displayed on screen, use + or - for adjustment.
- When Contrast adjustment bar is displayed on screen, use + or - for adjustments.
- The use of Extreme Mode (response time) may result in reduced display quality when fast moving video graphics are displayed. Users should check Extreme Mode (response time) to verify if it is compatible with any applications they would like to use it with.
- When the OSD menu is opened, only the OSD area has touch function, and other areas on the screen do not have touch function.
- The ENERGY STAR option resets all user settings to default values so that the monitor can meet the requirements of Energy Star.







Energy Star is an energy saving program for consumer electronics led by the U.S. government. It was launched in 1992 by EPA and DOE to reduce energy consumption and greenhouse gas emissions. Energy Star logo is a symbol of energy conservation and environmental protection. It improves the concept of energy efficiency of consumers and manufacturers, and effectively guides the market.

The regulation of Energy Star improves energy efficiency and reduces air pollution by using more energy-efficient equipment in homes, offices and factories. One way to achieve this goal is to use management to reduce energy consumption when products are not in use. The default settings for monitors conform to Energy Star certification. Any changes by users for more features and functionalities may increase power consumption, which will exceed the limitation of Energy Star's standard. If the user changes the options related to energy efficiency when using, such as brightness, color mode, etc., select All Reset Factory or choose the Energy Star option, the power consumption will be restored to the energy efficiency with Energy Star standard.

For more information, please refer to (www.energystar.gov/products). All products of Energy Star will be posted online and can be accessed directly by governments, public institutions and consumers.

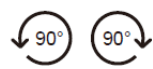
Table 2-2 Direct access controls

| OSD Icon on Main Menu | Submenu | Description |
|--|---|--|
|  Monitor control |  Brightness | Adjusts overall screen brightness. |
| |  Contrast | Adjusts difference between light and dark areas. |
| | Touch support | Select Windows for notebook with Windows OS and select Android/Chrome for Android phone. |
| | Screen ratio | Adjust the screen ratio to Full screen/Original AR, Screen display time may be extended when adjusted to Full screen. |
| | Waken on touch | Wake up monitor from standby mode through touch. |
| | Auto rotation | Selects to Enable/Disable Auto rotation. |
| |  | Selects to Enable/Disable manual rotation and turn the image in the clockwise/anti-clockwise direction. |
|  Advanced settings | Over drive | Screen response time setting. |
| | Display mode | Adjusts sRGB/Neutral/Cool/Warm. |
| | Language | Changes languages of menu. |
| | Information | Shows resolution, refresh rate, serial number, Firmware version and product details. This screen does not allow any changes to the settings. |
| | Factory Reset | Resets monitor to the original factory settings. |

Using the Wake on touch Function

You can wake up your monitor from **standby** mode through touch. To use the function:
Press  to open the main OSD menu. Turn on the wake on touch function.

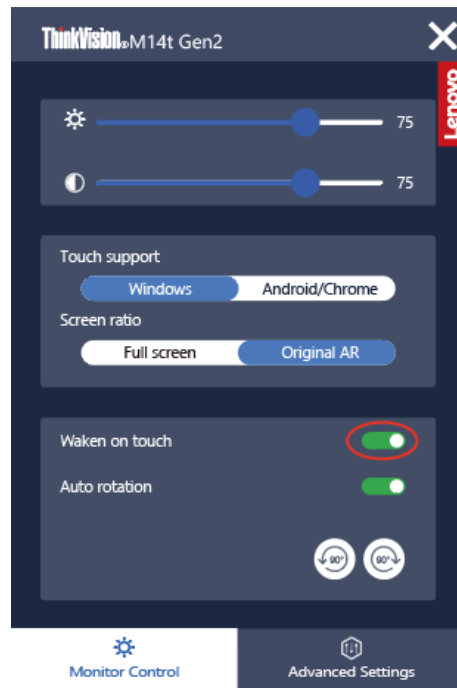

Note:

- It can't support wake on touch when notebook enter the Modern Standby
- Turn on the wake on touch function, the power consumption will increase in **standby** mode.

Selecting a supported display mode

The display mode the monitor uses is controlled by the computer. Therefore, refer to your computer documentation for details on how to change display modes.

The image size, position and shape might change when the display mode changes.

Unlike CRT monitors, which require a high refresh rate to minimize flicker, LCD or Flat Panel technology is inherently flicker-free.

Note: If your system has previously been used with a CRT monitor and is currently configured to a display mode outside the range of this monitor, you may need to re-attach the CRT monitor temporarily until you have re-configured the system; preferably to 2240x1400 at 60Hz, which is the Native Resolution Display mode.

Response time: 8ms with overdrive @60Hz.

Table 2-3. Factory set display modes

| Addressability | Refresh rate |
|----------------|--------------|
| 640x480 | 60Hz, 75Hz |
| 720x400 | 70Hz, 75Hz |
| 800x600 | 60Hz, 75Hz |
| 1024x768 | 60Hz, 75Hz |
| 1280x768 | 60Hz |
| 1280x800 | 60Hz, 75Hz |
| 1280x1024 | 60Hz, 75Hz |
| 1366x768 | 60Hz |
| 1440x900 | 60Hz, 75Hz |
| 1600x1200 | 60Hz, 75Hz |
| 1680x1050 | 60Hz, 75Hz |
| 1920x1080 | 60Hz, 75Hz |
| 1920x1200 | 60Hz, |
| 2240x1400 | 60Hz |
| 1400x2240 | 60Hz |

Note: The video signal source connected to M14t Gen2 needs to support USB-C DP Alt-mode video output.

Understanding power management

Power management is invoked when the computer recognizes that you have not using your mouse or keyboard for a user-definable period. There are several states as described in the table below.

For optimal performance, switch off your monitor at the end of each working day, or whenever you expect to leave it unused for long periods during the day.

Table 2-4. Power indicator

| State | Power Indicator | Screen | Restoring Operation | Compliance |
|---------------------|-----------------|--------|---|----------------|
| On | Steady white | Normal | | |
| Standby/ Suspend | Steady amber | Blank | Press a key or move the mouse. There may be a slight delay reappears. Note: Standby also occurs if there is no image output to the monitor. | ENERGY STAR |
| Off | Off | Off | Press power key to switch on. There may be a slight delay before the image reappears. | ENERGY STAR |

Power Management Modes

| VESA Modes | Horizontal Sync | Vertical Sync | Video | Power Indicator | Power Consumption |
|------------------|-----------------|---------------|--------|-----------------|---|
| Normal operation | Active | Active | Active | White | Max Consumption*: 8.5 W (without Type C output) 83 W (with 65W output) Typical Consumption: 7.3 W (without Type C output) 78 W (with 65W output) |
| Active-off mode | Inactive | Inactive | Off | Amber | Less than 0.3 W |
| Switch off | - | - | - | Off | Less than 0.3 W |

| Energy Star | Power consumption |
|------------------|-------------------|
| P _{on} | 6.77 W |
| E _{TEC} | 23.56 kWh/yr |

** Maximum power consumption with max luminance.

This document is informational only and reflects laboratory performance. Your product may perform differently, depending on the software, components and peripherals you ordered and shall have no obligation to update such information. Accordingly, the customer should not rely upon this information in making decisions about electrical tolerances or otherwise. No warranty as to accuracy or completeness is expressed or implied.

Power Input and Output Definition:

- M14t Gen2 can be powered on by devices more than 10W with USB-C interfaces that can support 5V, 9V, 15V and 20V power delivery output. The permitted maximum input power of M14t Gen2 is DC 100W.
- The maximum power delivery output of M14t Gen2 is 65W and monitor can support 5V, 9V, 15V and 20V power delivery output; but only when the input power is 20Vdc.
- If you connect M14t Gen2 with mobile phones only, mobile phones need to support USB-C PD2.0 output or above.
- The power capacity of power adapter connected with M14t Gen2 will affect the charging capability of M14t Gen2 to devices.
 - Recommend to use 65W or above of type-C adapter to use with M14t Gen2 when you want to charge your notebook.
 - Recommend to use 18W or above of type-C adapter to use with M14t Gen2 when you want to charge your mobile phone.
- While plugging with adapters without USB-C PD function and another type c side connecting with phone or notebook, M14t Gen2 may consume power from phones or notebook.

Recommendation of USB-C devices:

Because notebooks and mobile phones with a USB Type-C port released on the market are very various, we can't guarantee that the monitor can charge all types of notebooks and mobile phones with a USB Type-C port. Make sure that the USB Type-C cable complies with the USB PD specification. Otherwise, your devices may be damaged. So please use the attached USB Type-C cable.

Caring for your monitor

Be sure to turn off the power before you perform any maintenance on the monitor.

Do not:

- Apply water or liquid directly to your monitor.
- Use solvents or abrasives.
Use flammable cleaning materials to clean your monitor or any other electrical equipment.
- Touch the screen area of your monitor with sharp or abrasive items. This type of contact may cause permanent damage to your screen.
- Use any cleaner which contains an anti-static solution or similar additives. This may harm the coating of the screen area.

Do:

- Lightly dampen a soft cloth with water and use this to gently wipe the covers and the screen.
- Remove grease or finger marks with a damp cloth and a little mild detergent.

Wall Mounting (Optional)

Refer to the instructions that come with the VESA compatible base mounting kit.

1. Place the monitor face down on a non-abrasive surface on stable flat table.
2. Use clips to lock the monitor.

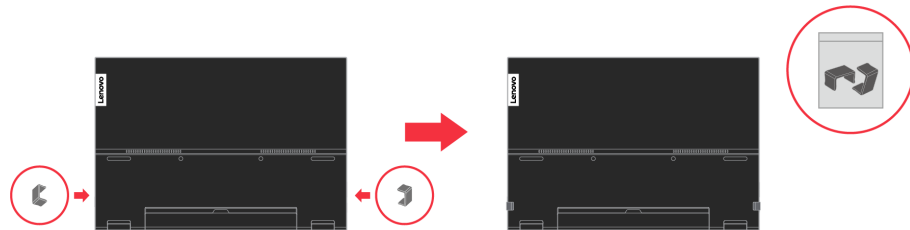

3. Attach the mounting bracket from the wall mounting kit to the monitor.
4. Mount the monitor on the wall by following the instructions that come with the base mounting kit.

NOTE: For use only with UL and GS Listed Wall Mount Bracket with minimum weight/load bearing capacity of 6.00 kg. Attach the mounting bracket from the VESA compatible wall mounting kit (100mm x100mm distance), the type of VESA mounting screw is M4 x 6 mm.

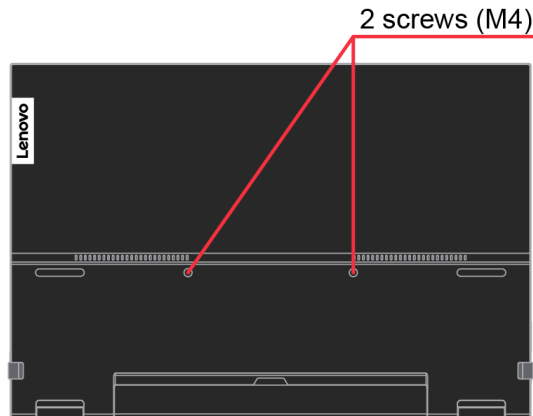

Chapter 3 Reference information

This section contains monitor specifications, instructions to manually install the monitor driver, troubleshooting information, and service information.

Monitor specifications

Table 3-1. Monitor specifications

| | | |
|---|---------------------------|--|
| Dimensions | Height | 223.1 mm (8.78 in.) |
| | Depth | 14.1 mm (0.56 in.) |
| | Width | 314.8 mm (12.39 in.) |
| Weight | Unpacked | 0.7 kg |
| Stand | Tilt range | Range: 0°~90° |
| Image | Viewable image size | 355.6 mm (14.00 in.) |
| | Maximum height | 188.5 mm (7.42 in.) |
| | Maximum width | 301.6 mm (11.87 in.) |
| | Pixel pitch | 0.135 mm (V) |
| | Response time | Off: 20 ms Normal: 8 ms Extreme: 6 ms |
| Power input | Supply voltage/current | 5V or 9V or 15V DC 3A or 20V DC 5A Max. |
| USB Type C PD Function | Supply voltage/current | 5V or 9V or 15V DC 3A or 20V DC 3.25A Max. |
| Power consumption Note: Power consumption figures are for the monitor only. | Max Consumption | 8.5 W (without Type C output) 83 W (with Type C output) |
| | Typical Consumption | 7.3 W (without Type C output) 78 W (with Type C output) |
| | Standby/Suspend | <0.3 W |
| | Off | <0.3 W |
| Video input (Digital) | Input signal | Type C |
| | Horizontal addressability | 2240 pixels (max) |
| | Vertical addressability | 1400 lines (max) |
| | Clock frequency | 220 MHz (max) |
| Communications | VESA DDC | CI |
| Altitude Test | Operation | 16404 ft |
| Supported Display Modes (VESA Standard modes between noted ranges) | Horizontal frequency | 30 kHz – 140 kHz |
| | Vertical frequency | 50 Hz – 75 Hz |
| | Native Resolution | 2240 x 1400 at 60 Hz |
| Temperature | Operating | 0° to 40°C (32°F to 104° F) |
| | Storage | -20° to 60°C (-4°F to 140° F) |
| | Shipping | -20° to 60°C (-4° F to 140° F) |
| Humidity | Operating | 30% to 80% |
| | Storage | 30% to 90% |
| | Shipping | 30% to 90% |

Troubleshooting

If you have a problem setting up or using your monitor, you might be able to solve it yourself. Before calling your dealer or Lenovo, try the suggested actions that are appropriate to your problem.

Table 3-2. Troubleshooting

| Problem | Possible cause | Suggested action | Reference |
|--|--|--|--|
| The words "Out of Range" are shown on the screen, and the power indicator is flashing white. | The system is set to a display mode which is not supported by the monitor. | <ul style="list-style-type: none">• If you are replacing an old monitor, reconnect it and adjust the display mode to within the specified range for your new monitor.• If using a Windows system, restart the system in safe mode, then select a supported display mode for your computer.• If these options do not work, contact the Customer Support Centre. | "Selecting a supported display mode" on page 2-6 |
| The image quality is unacceptable. | The video signal cable is not connected with the monitor or system completely. | Be sure the signal cable is firmly plugged into the system and monitor. | "Connecting and turning on your monitor" on page 1-5 |
| The power indicator is not lit and there is no image. | <ul style="list-style-type: none">• The monitor's power switch is not switched on.• The power cord is loose or disconnected.• There is no power at the outlet. | <ul style="list-style-type: none">• Be sure the power cord is connected properly.• Be sure the outlet has power.• Power on the monitor.• Try using another power cord.• Try using another electrical outlet. | "Connecting and turning on your monitor" on page 1-5 |

Table 3-2. Troubleshooting (continued)

| Problem | Possible cause | Suggested action | Reference |
|---|--|---|--|
| Screen is blank and power indicator is steady amber or flashing white | The monitor is in Standby/Suspend mode | <ul style="list-style-type: none"> Press any key on the keyboard or move the mouse to restore operation. Check the Power options settings on your computer. | "Understanding power management" on page 2-16 |
| The power indicator is white, but there is no image. | The video signal cable is loose or disconnected from the system or monitor. | Be sure the video cable is connected with the system properly. | "Connecting and turning on your monitor" on page 1-5 |
| | The monitor brightness is at the lowest setting. | Adjust the brightness setting on the Brightness control. | "Adjusting your monitor image" on page 2-12 |
| One or more of the pixels appear discoloured | This is a characteristic of the LCD technology and is not an LCD defect. | If there are more than five pixels missing, contact the Customer Support Centre. | Appendix A, "Service and Support" on page A-1 |
| <ul style="list-style-type: none"> Fuzzy lines in text or a blurry image. Horizontal or vertical lines through the image. | <ul style="list-style-type: none"> Image setup has not been optimized. Your system Display Properties setting have not been optimized. | Adjust the resolution settings on your system to match the native resolution for this monitor: 2240 x 1400 at 60 Hz. | "Selecting a supported display mode" on page 2-15 |
| | | When working in the native resolution, you may find additional improvements by adjusting the Dots Per Inch (DPI) setting on your system. | See the Advanced section of your system's display properties. |
| Monitor consumes power from notebook or phones when connected with adaptor | Adaptor has no USB-C PD function | Use USB C to C adaptor connecting with M14t Gen2 and charging your notebook or phone. | "Understanding power management" on page 2-16 |
| M14t Gen2 can't be powered on by notebooks or phones | <ul style="list-style-type: none"> USB C ports of notebooks or phones can't support power output or Alt-mode. Notebooks or phones have no enough power to support M14t Gen2. | <ul style="list-style-type: none"> Check the USB C ports of notebooks or phones and make sure they support PD 2.0 and DP 1.2 Alt mode. Connect notebook with adaptor then power on M14t Gen2. | "Connecting and turning on your monitor" on page 1-4 and "Understanding power management" on page 2-16 |
| Normally display when M14t Gen2 connecting with 45W power adapter and notebook, but no charging symbol showing in notebook | <ul style="list-style-type: none"> Power input of notebook must be 45w or above, M14t Gen2 can't provide enough power for notebook. | <ul style="list-style-type: none"> You can connect the adapter and M14t Gen2 with notebook, then notebook can be charged by adaptor and can power on M14t Gen2. Use 65W or above adaptor to connect with M14t Gen2, and then charge notebook. | "Understanding power management" on page 2-16 |

Manually installing the monitor driver

Below are steps for manually installing the monitor driver in Microsoft Windows 10, Microsoft Windows 11.

1. Turn off the computer, all attached devices.
2. Ensure that the monitor is connected correctly.
3. Turn on the monitor and then the system unit. Allow your computer to start the Windows operating system.
4. From the Lenovo website http://support.lenovo.com/docs/m14t_gen2, find the corresponding monitor driver and download it to a PC to which this monitor is connected (such as a desktop).
5. Right-click the Windows **Start** button on the desktop, then click **Device Manager**, and double click **Monitor**.
6. Double-click **Generic Monitor**.
7. Click the **Driver** tab.
8. Click **Update Driver**, and then click **Browse Computer to find the driver**.
9. Click **Let me pick from a list of available drivers on my computer**.
10. Click the **Have Disk...** button. By clicking the **Browse** button, browse and point to the following path: **X:\Monitor Drivers\Windows** (where X indicates “the folder in which the downloaded driver is located” (such as a desktop)).
11. Select **m14t gen2.inf** file, Click **Open** button. Click **OK** button.
12. In the new window, select **M14t Gen2** and click **Next**.
13. After the installation is complete, delete all downloaded files and close all Windows.
14. Restart the system. The system will automatically.

Service information

Customer responsibilities

The warranty does not apply to a product which has been damaged due to accident, misuse, abuse, improper installation, usage not in accordance with product specifications and instructions, natural or personal disaster, or unauthorized alterations, repairs or modifications.

The following are examples of misuse or abuse and not covered by warranty:

- Images burned on to the screen of a CRT monitor. Burned image is preventable by utilizing a moving screen saver or power management.
- Physical damage to covers, bezel, base and cables.
- Scratches or punctures on monitor screens.

Getting further help

If you still can't solve your problem, please contact the Customer Support Centre. For more information on contacting the Customer Support Centre, please see Appendix A, "Service and Support" on page A-1.

Service parts

The following parts are for use by Lenovo service, or Lenovo authorized dealers to support the customer warranty. Parts are for service use only. The table below shows information for model 63FD-UAR6-WW.

Table 3-3. List of service parts

| FRU (Field Replaceable Unit) Part number | Description | Colour | Machine Type Model (MTM) |
|--|-----------------------------------|--------------|--------------------------|
| 5D11P36188 | M14t Gen2 – 14.0 inch Monitor | Raven Black | 63FD-UAR6-WW |
| 5C11P37200 | M14t Gen2 -USB Type C-C cable 1 m | Raven Black | 63FD-UAR6-WW |
| 5C11P37201 | M14t Gen2 – L-shape dongle | Raven Black | 63FD-UAR6-WW |
| 5CF1P41486 | M14t Gen2 - Protect Bag | Gray surface | 63FD-UAR6-WW |
| 5T71P41537 | M14t Gen2 – Passive touch pen | Iron Grey | 63FD-UAR6-WW |

Appendix A. Service and Support

The following information describes the technical support that is available for your product, during the warranty period or throughout the life of the product. Refer to your Lenovo Statement of Limited Warranty for a fully explanation of Lenovo warranty terms.

Registering your option

Register to receive product service and support updates, as well as free and discounted computer Accessories and content. Go to:
<http://www.lenovo.com/support>

Online technical support

Online technical support is available during the life of your product through the Lenovo Support Web site at <http://www.lenovo.com/support>

Product replacement assistance or exchange of defective components also is available during the warranty period, assistance for replacement or exchange of defective components is available. In addition, if your option is installed in a Lenovo computer, you might be entitled to service at your location. Your technical support

representative can help you determine the best alternative.

Quebec Disclaimer

Quebec Disclaimer: English

IMPORTANT NOTICE FOR QUEBEC CONSUMERS:

In regard to section 79.18 of Quebec's Regulation respecting the application of the Consumer Protection Act, Lenovo in no way guarantees the availability of (a) replacement parts; (b) repair services; and (c) information necessary to maintain or repair the goods. For up-to-date information on the technical support and parts available for your purchase, please consult <https://support.lenovo.com/ca/en>

Quebec Disclaimer: Canadian French

AVIS IMPORTANT POUR LES CONSOMMATEURS DU QUÉBEC:

En ce qui concerne l'article 79.18 du Règlement d'application de la Loi sur la protection du consommateur du Québec, Lenovo ne garantit en aucune façon la disponibilité des éléments suivants : (a) les pièces de rechange; (b) les services de réparation; et (c) les renseignements nécessaires à l'entretien à la réparation du bien. Pour obtenir des renseignements à jour sur le soutien technique et les pièces disponibles pour votre achat, veuillez consulter <https://support.lenovo.com/ca/fr>.

Telephone technical support

Installation and configuration support through the Customer Support Center will be withdrawn or made available for a fee, at Lenovo's discretion, 90 days after the option has been withdrawn from marketing. Additional support offerings, including step-by-step installation assistance, are available for a nominal fee.

To assist the technical support representative, have available as much of the following information as possible:

- Option name
- Option number
- Proof of purchase
- Computer manufacturer, model, serial number, and manual
- Exact wording of the error message (if any)
- Description of the problem
- Hardware and software configuration information for your system

If possible, be at your computer. Your technical support representative might want to walk you through the problem during the call.

Worldwide telephone list

Phone numbers are subject to change without notice. For the most current phone Numbers, go to <http://www.lenovo.com/support/phone>

| Country or Region | Telephone Number |
|--------------------------|--|
| Argentina | 0800-666-0011 (Spanish, English) |
| Australia | 1-800-041-267 (English) |
| Austria | 0810-100-654 (local phone) (German) |
| Belgium | Warranty service and support: 02-339-36-11 (Dutch, French) |
| Bolivia | 0800-10-0189 (Spanish) |
| Brazil | Calls made from within the Sao Paulo region: 11-3889-8986 Calls made from outside the Sao Paulo region: 0800-701-4815 (Portuguese) |
| Brunei Darussalam | 800-1111 (English) |
| Canada | 1-800-565-3344 (English, French) |
| Chile | 800-361-213(Spanish) |
| China | Technical Support Line: 400-100-6000 (Mandarin) |
| China (Hong Kong S.A.R.) | (852) 3516-8977 (Cantonese, English, Mandarin) |
| China (Macau S.A.R.) | 0800-807 / (852) 3071-3559 (Cantonese, English, Mandarin) |
| Colombia | 1-800-912-3021 (Spanish) |
| Costa Rica | 0-800-011-1029 (Spanish) |
| Croatia | 385-1-3033-120(Croatian) |
| Cyprus | 800-92537(Greek) |
| Czech Republic | 800-353-637(Czech) |
| Denmark | Warranty service and support: 7010-5150 (Danish) |
| Dominican Republic | 1-866-434-2080(Spanish) |
| Ecuador | 1-800-426911 (OPCION 4) (Spanish) |
| Egypt | Primary: 0800-0000-850 Secondary:0800-0000-744 (Arabic, English) |
| El Salvador | 800-6264 (Spanish) |
| Estonia | 372-66-0-800 (Estonian, Russian, English) |
| Finland | Warranty service and support: +358-800-1-4260(Finnish) |
| France | Warranty service and support (hardware): 0810-631-213(French) |
| Germany | Warranty service and support: 0800-500-4618 (toll-free)(German) |
| Greece | Lenovo Business Partner (Greek) |
| Guatemala | Dial 999-9190, wait for operator, and request to reach 877-404-9661 (Spanish) |
| Honduras | Dial 800-0123(Spanish) |
| Hungary | +36-13-825-716 (English, Hungarian) |
| India | Primary: 1800-419-4666 (Tata) Secondary: 1800-3000-8465 (Reliance) Email: commercialts@lenovo.com (English and Hindi) |
| Indonesia | 1-803-442-425 62 213-002-1090 (Standard Charges Apply) (English, Bahasa Indonesia) |
| Ireland | Warranty service and support: 01-881-1444 (English) |
| Israel | Givat Shmuel Service and Center: +972-3-531-3900 (Hebrew, English) |

| Country or Region | Telephone Number |
|-------------------|--|
| Italy | Warranty service and support: +39-800-820094 (Italian) |
| Japan | 0120-000-817 (Japanese, English) |
| Kazakhstan | 77-273-231-427(Standard charges Apply) (Russian, English) |
| Korea | 080-513-0880 (Collect Call) 02-3483-2829 (Toll Call) (Korean) |
| Latvia | 371-6707-360(Latvian, Russian, English) |
| Lithuania | 370 5278 6602(Italian, Russian, English) |
| Luxembourg | ThinkServer and ThinkStation: 352-360-385-343 ThinkCentre and ThinkPad: 352-360-385-222 (French) |
| Malaysia | 1-800-88-0013 03-7724-8023 (Standard Charges Apply) (English) |
| Malta | 356-21-445-566(English, Italian, Maltese Arabic) |
| Mexico | 001-866-434-2080(Spanish) |
| Netherlands | 020-513-3939 (Dutch) |
| New Zealand | 0508-770-506 (English) |
| Nicaragua | 001-800-220-2282 (Spanish) |
| Norway | 8152-1550(Norwegian) |
| Panama | Lenovo Customer Support Center:001-866-434(Toll-Free) (Spanish) |
| Peru | 0-800-50-866 (OPCION 2) (Spanish) |
| Philippines | 1-800-8908-6454 (GLOBE subscribers) 1-800-1441-0719 (PLDT subscribers) (Tagalog, English) |
| Poland | Laptops and tablets branded with logo Think: 48-22-273-9777 ThinkStation and ThinkServer: 48-22-878-6999 (Polish, English) |
| Portugal | 808-225-115 (Standard Charges Apply) (Portuguese) |
| Romania | 4-021-224-4015(Romanian) |
| Russia | +7-499-705-6204 +7-495-240-8558 (Standard Charges Apply) (Russian) |
| Singapore | 1-800-415-5529 6818-5315 (Standard Charges Apply) (English, Mandarin, Bahasa Malaysia) |
| Slovakia | ThinkStation and ThinkServer: 421-2-4954-5555 |
| Slovenia | 386-1-2005-60 (Slovenian) |
| Spain | 34-917-147-833(Spanish) |
| Sri Lanka | +9477-7357-123 (Sumathi Information systems) (English) |
| Sweden | Warranty service and support: 077-117-1040 (Swedish) |
| Switzerland | Warranty service and support: 0800-55-54-54 (German, French, Italian) |
| Taiwan | 0800-000-702 (Mandarin) |
| Thailand | 001-800-4415-734 (+662) 787-3067 (Standard Charges Apply) (Thai, English) |
| Turkiye | 0-212-912-01-34 (Turkish) |
| United Kingdom | Standard warranty support: 03705-500-900 (local rate) Standard warranty support: 08705-500-900(English) |
| United States | 1-800-426-7378 (English) |
| Uruguay | 000-411-005-6649 (Spanish) |
| Venezuela | 0-800-100-2011 (Spanish) |
| Vietnam | 120-11072 (Toll Free) 84-8-4458-1042 (Standard Charges Apply) (Vietnamese, English) |

Appendix B. Notices

Lenovo may not offer the products, services, or features discussed in this document in all countries. Consult your local Lenovo representative for information on the products and services currently available in your area. Any reference to a Lenovo product, program, or service is not intended to state or imply that only that Lenovo product, program, or service may be used. Any functionally equivalent product, program, or service that does not infringe any Lenovo intellectual property right may be used instead. However, it is the user's responsibility to evaluate and verify the operation of any other product, program, or service.

Lenovo may have patents or pending patent applications covering subject matter described in this document. The furnishing of this document does not give you any license to these patents. You can send license inquiries, in writing to:

*Lenovo (United States), Inc.
1009 Think Place – Building One
Morrisville, NC 27560
U.S.A.
Attention: Lenovo Director of Licensing*

LENOVO PROVIDES THIS PUBLICATION "AS IS" WITHOUT WARRANTY OF ANY KIND, EITHER EXPRESS OR IMPLIED, INCLUDING, BUT NOT LIMITED TO THE IMPLIED WARRANTIES OF NON-INFRINGEMENT, MERCHANTABILITY OR FITNESS FOR A PARTICULAR PURPOSE.

Some jurisdictions do not allow disclaimer of express or implied warranties in certain transactions, therefore, this statement may not apply to you.

This information could include technical inaccuracies or typographical errors. Changes are periodically made to the information herein; these changes will be incorporated in new editions of the publication. Lenovo may make improvements and/or changes in the product(s) and/or the program(s) described in this publication at any time without notice.

The products described in this document are not intended for use in implantation or other life support applications where malfunction may result in injury or death to persons. The information contained in this document does not affect or change Lenovo product specifications or warranties. Nothing in this document shall operate as an express or implied license or indemnity under the intellectual property rights of Lenovo or third parties. All information contained in this document was obtained from specific environments and presented as an illustration. The result obtained in other operating environments may vary.

Lenovo may use or distribute any of the information you supply in any way it believe appropriate without incurring any obligation to you.

Any references in this publication to non-Lenovo Web sites are provided for convenience only and do not in any manner serve as an endorsement of those Web sites. The materials at those Web sites are not part of the materials for this Lenovo product, and use of those Web sites is at your own risk.

Any performance data contained herein was determined in a controlled environment. Therefore, the result obtained in other operating environments may vary significantly. Some measurements may have been made on development-level systems and there is no guarantee that these measurements will be the same on generally available systems. Furthermore, some measurements may have been estimated through extrapolation. Actual results may vary. Users of this document should verify the applicable data for their specific environment.

Recycling information

Lenovo encourage owners of information technology (IT) equipment to responsibly recycle their equipment when it is no longer needed. Lenovo offers a variety of programs and services to assist equipment owners in recycling their IT products. For information on recycling Lenovo products, go to:
www.lenovo.com/recycling

環境配慮に関して

本機器またはモニターの回収リサイクルについて

企業のお客様が、本機器が使用済みとなり廃棄される場合は、資源有効利用促進法の規定により、産業廃棄物として、地域を管轄する県知事あるいは、政令市長の許可を持った産業廃棄物処理業者に適正処理を委託する必要があります。また、弊社では資源有効利用促進法に基づき使用済みパソコンの回収および再利用・再資源化を行う「PC 回収リサイクル・サービス」を提供しています。詳細は、
https://www.lenovo.com/jp/ja/services_warranty/recycle/pcrecycle/をご参照ください。

また、同法により、家庭で使用済みとなったパソコンのメーカー等による回収再資源化が 2003 年 10 月 1 日よりスタートしました。詳細は、
https://www.lenovo.com/jp/ja/services_warranty/recycle/personal/をご参照ください。

重金属を含む内部部品の廃棄処理について

本機器のプリント基板等には微量の重金属（鉛など）が使用されています。使用後は適切な処理を行うため、上記「本機器またはモニターの回収リサイクルについて」に従って廃棄してください。

Collecting and recycling a disused Lenovo computer or monitor

If you are a company employee and need to dispose of a Lenovo computer or monitor that is the property of the company, you must do so in accordance with the Law for Promotion of Effective Utilization of Resources. Computers and monitors are categorized as industrial waste and should be properly disposed of by an industrial waste disposal contractor certified by a local government. In accordance with the Law for Promotion of Effective Utilization of Resources, Lenovo Japan provides, through its PC Collecting and Recycling Services, for the collecting, reuse, and recycling of disused computers and monitors. For details, visit the Lenovo Web site at

https://www.lenovo.com/jp/ja/services_warranty/recycle/pcrecycle/. Pursuant to the Law for Promotion of Effective Utilization of Resources, the collecting and recycling of home-used computers and monitors by the manufacturer was begun in October 1, 2003. This service is provided free of charge for home-used computers sold after October 1, 2003. For details, visit the Lenovo Web site at

https://www.lenovo.com/jp/ja/services_warranty/recycle/personal/.

Disposing of Lenovo computer components

Some Lenovo computer products sold in Japan may have components that contain heavy metals or other environmental sensitive substances. To properly dispose of disused components, such as a printed circuit board or drive, use the methods described above for collecting and recycling a disused computer or monitor.

Trademarks

The following terms are trademarks of Lenovo in the United States, other countries, or both:

Lenovo
The Lenovo logo
ThinkCentre
ThinkPad
ThinkVision

Microsoft, Windows, and Windows NT are trademarks of the Microsoft group of companies. Other company, product, or service names may be trademarks or service marks of others.

Turkish statement of compliance

The Lenovo product meets the requirements of the Republic of Türkiye Directive on the Restriction of the Use of Certain Hazardous Substances in Electrical and Electronic Equipment (EEE).

Türkiye AEEE yönetmeliğine Uygunluk Beyanı

Bu Lenovo ürünü, T.C. Çevre Şehircilik ve İklim Değişikliği Bakanlığı'nın Atık Elektrikli ve Elektronik Eşyaların Kontrolü Yönetmeliğine (AEEE)" uygundur.

Lenovo and the Lenovo logo are trademarks of Lenovo in the United States, other countries, or both.

Ukraine RoHS

Цим підтверджуємо, що продукція Леново відповідає вимогам нормативних актів України, які обмежують вміст небезпечних речовин.

India RoHS

RoHS compliant as per E-Waste (Management & Handling) Rules, 2011.

Power cords and power adapters (optional)

Use only the power cords and power adapters supplied by the product manufacturer. Do not use the ac power cord for other devices.