

PHILIPS

AC3033
AC3039



EN User manual 1

ZH-T 使用手冊 21



Contents

1	Important	2
	Safety	2
	Electromagnetic fields (EMF)	4
	Recycling	4
	Simplified EU declaration of conformity	4
2	Your air purifier	5
	Product overview	5
	Controls overview	6
3	Getting started	7
	Installing the filter	7
	Wi-Fi indicator	7
	Wi-Fi connection	8
4	Using the air purifier	9
	Understanding the air quality light	9
	Turning on and off	10
	Changing the mode setting	10
	Switching the display indicator	11
	Using the light on/off function	11
	Checking the filter status	12
5	Cleaning and maintenance	12
	Cleaning schedule	12
	Cleaning the body of the air purifier	13
	Cleaning the particle sensor	13
	Cleaning the surface of the filter	14
	Replacing the filter	15
	Filter reset	16
6	Storage	16
7	Troubleshooting	17
8	Guarantee and service	20
	Order parts or accessories	20

1 Important

Safety

Read this user manual carefully before you use the appliance, and save it for future reference.

Danger

- Do not clean the appliance with water, any other liquid, or a (flammable) detergent, nor let them enter the appliance, to avoid electric shock and/or a fire hazard.
- Do not spray any flammable materials such as insecticides or fragrance around the appliance.

Warning

- Check if the voltage indicated on the appliance corresponds to the local power voltage before you connect the appliance.
- If the power cord is damaged, you must have it replaced by Philips, a service center authorized by Philips, or similarly qualified persons in order to avoid a hazard.
- Do not use the appliance if the plug, the power cord, or the appliance itself is damaged.
- This appliance can be used by children aged from 8 years and above and persons with reduced physical, sensory or mental capabilities or lack of experience and knowledge if they have been given supervision or instruction concerning use of the appliance in a safe way and understand the hazards involved.
- Child shall not play with the appliance.
- Cleaning and maintenance shall not be made by children without supervision.
- Do not block the air inlet and outlet, e.g. by placing items on the air outlet or in front of the air inlet.
- Make sure that foreign objects do not fall into the appliance through the air outlet.

- Standard WiFi interface based on 802.11b/g/n at 2.4 GHz with a maximum output power of 31.62 mW EIRP.

Caution

- This appliance is not a substitute for proper ventilation, regular vacuum cleaning, or use of an extractor hood or fan while cooking.
- Always place and use the appliance on a dry, stable, level, and horizontal surface.
- Leave at least 20cm free space around the appliance and leave at least 30cm free space above the appliance.
- Do not sit or stand on the appliance. Do not place anything on top of the appliance.
- Do not place the appliance directly below an air conditioner to prevent condensation from dripping onto the appliance.
- Only use the original Philips filters specially intended for this appliance. Do not use any other filters.
- Combustion of the filter may cause irreversible human hazard and/or jeopardize other lives. Do not use the filter as fuel or for similar purpose.
- Avoid knocking against the appliance (the air inlet and outlet in particular) with hard objects.
- Do not insert your fingers or objects into the air outlet or the air inlet to prevent physical injury or malfunctioning of the appliance.
- Do not use this appliance when you have used indoor smoke-type insect repellents or in places with oily residues, burning incense, or chemical fumes.
- Do not use the appliance near gas appliances, heating devices or fireplaces.
- Always unplug the appliance when you want to move, clean appliance, replace the filter or carry out other maintenance.
- The appliance is only intended for household use under normal operating conditions.

- Do not use the appliance in wet surroundings or in surroundings with high humidity or high ambient temperatures, such as the bathroom, toilet, or kitchen, or in a room with major temperature changes.
- The appliance does not remove carbon monoxide (CO) or radon (Rn). It cannot be used as a safety device in case of accidents with combustion processes and hazardous chemicals.

Electromagnetic fields (EMF)

This Philips appliance complies with all applicable standards and regulations regarding exposure to electromagnetic fields.

Recycling

Do not throw away the product with the normal household waste at the end of its life, but hand it in at an official collection point for recycling. By doing this, you help to preserve the environment.

Follow your country's rules for the separate collection of electrical and electronic products. Correct disposal helps prevent negative consequences for the environment and human health.

Simplified EU declaration of conformity

Hereby, DAP B.V. declares that the radio equipment type AC3033/AC3039 is in compliance with Directive 2014/53/EU. The full text of the EU declaration of conformity is available at the following internet address: www.philips.com.

2 Your air purifier

Congratulations on your purchase, and welcome to Philips!

To fully benefit from the support that Philips offers, register your product at www.philips.com/welcome.

Product overview

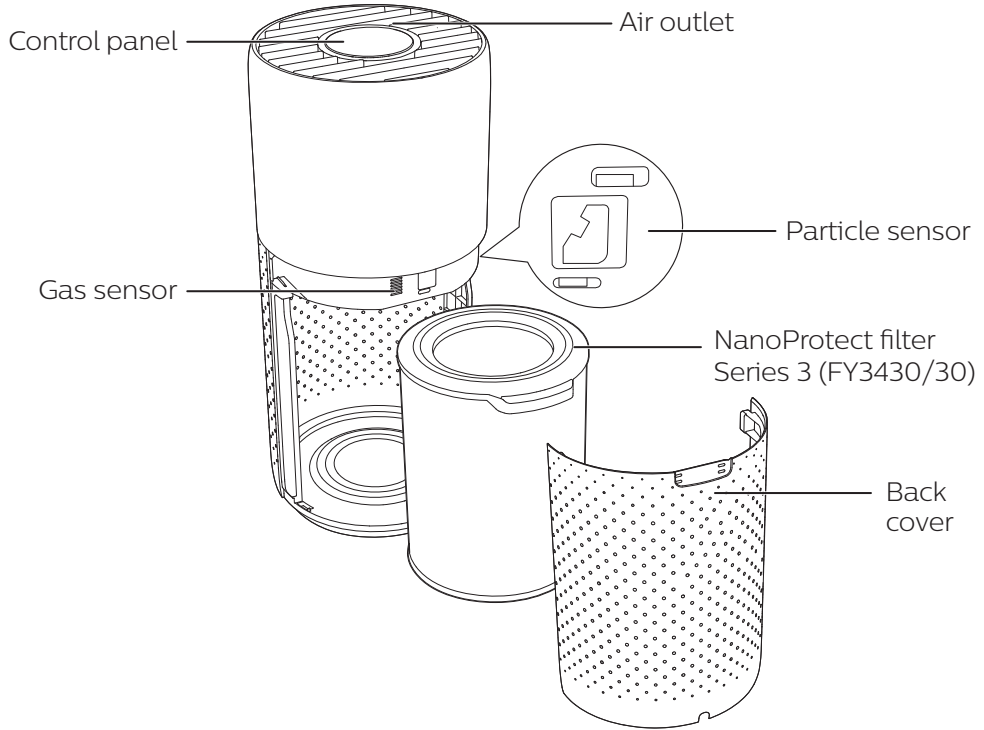

Controls overview

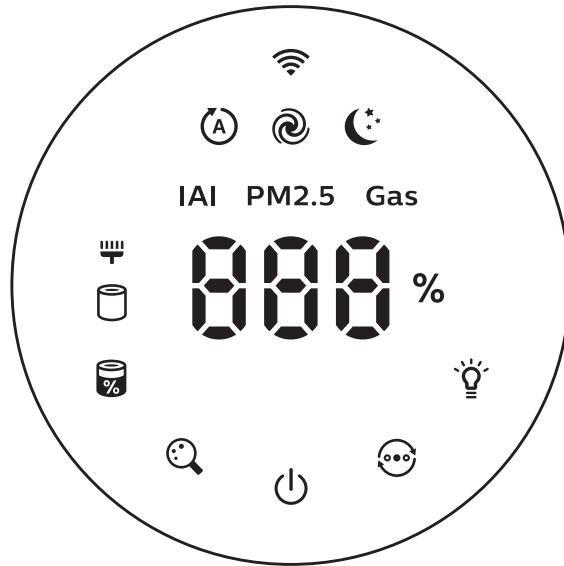

Control buttons

	Filter status/reset button		Display switch button
	Power on/off button		Mode switch button
	Light on/off button		

Display panel

	Wi-Fi indicator		Auto mode
	Turbo mode		Sleep mode
IAI	Indoor Allergen Index display	PM2.5	PM2.5 display
Gas	Gas pollution display		Filter cleaning alert
	Filter replacement alert		

3 Getting started

Installing the filter

Remove all packaging of the filter before first use.

Note: Make sure the air purifier is unplugged from the electrical outlet before installing the filter.

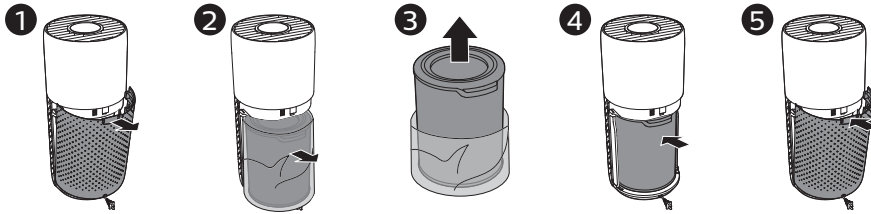



- 1 Pull the back cover and remove it from the appliance.
- 2 Pull the filter from the appliance.
- 3 Remove all packaging materials of the air purification filter.
- 4 Put the filter back into the appliance.
- 5 Reattach the back cover.

Wi-Fi indicator

Wi-Fi icon status	Wi-Fi connection status
Blink in orange	Connecting to the smartphone
Stable in orange	Connected to the smartphone
Blink in white	Connecting to the server
Stable in white	Connected to the server
Off	Wi-Fi function disabled

Wi-Fi connection

Setting up the Wi-Fi connection for the first time

- 1 Download and install the Philips "Clean Home+" app from the **App Store** or **Google Play**.
- 2 Put the plug of the air purifier in the power socket and touch  to turn on the air purifier.
↳ The Wi-Fi indicator  blinks orange for the first time.
- 3 Make sure that your smartphone or tablet is successfully connected to your Wi-Fi network.
- 4 Launch the "Clean Home+" app and click on "Connect a New Device" or press the "+" button on the top of the screen. Follow the onscreen instructions to connect the air purifier to your network.







Note:

- This instruction is only valid when the air purifier is being set up for the first time. If the network has changed or the setup needs to be performed again, see Chapter "Reset the Wi-Fi connection" on page 8.
- If you want to connect more than one air purifier to your smartphone or tablet, you have to do this one by one.
- Make sure that the distance between your smartphone or tablet and the air purifier is less than 10 m without any obstructions.
- This App supports the latest versions of Android and iOS. Please check www.philips.com/cleanhome for the latest update of supported operating systems and devices.

Reset the Wi-Fi connection

Note:

- Reset the Wi-Fi connection when your default network has changed.
- 1 Put the plug of the air purifier in the power socket and touch  to turn on the air purifier.
 - 2 Touch  and  simultaneously for 3 seconds until you hear a beep.
↳ The air purifier goes to pairing mode.
↳ The Wi-Fi indicator  blinks orange.
 - 3 Follow the steps 3-4 in "Setting up the Wi-Fi connection for the first time" section.

4 Using the air purifier

Understanding the air quality light

The air quality light automatically goes on when the air purifier is switched on, and lights up all colors in sequence. After approximately 30 seconds, the particle sensor selects the color that corresponds to the surrounding air quality of airborne particles.

Air quality light color	Air quality level
Blue	Good
Blue-purple	Fair
Purple-red	Poor
Red	Very poor

The color of the air quality light is determined by the highest risk index among PM2.5, IAI and Gas readings.

IAI

The professional-grade **AeraSense** sensor detects the level of indoor air allergen and with numerical feedback from 1 to 12 the potential risk level of indoor air allergens can be displayed. 1 indicates best air quality.

IAI level	Air quality light color
1-3	Blue
4-6	Blue-purple
7-9	Purple-red
10-12	Red

PM2.5

AeraSense sensing technology accurately detects and quickly responds to even the slightest particle change in the air. It provides you with reassurance with real-time PM2.5 feedback.

PM2.5 level	Air quality light color
≤12	Blue
13-35	Blue-purple
66-55	Purple-red
>55	Red

Most of the indoor air pollutants fall under PM2.5 – which refers to airborne particle pollutants smaller than 2.5 micrometers. Common indoor sources of fine particles are tobacco smoke, cooking, burning candles. Some airborne bacteria and the smallest mold spores, pet allergen and dust mite allergen particles also fall under PM2.5.

GAS



With an advanced gas sensor, a display ranging from L1 to L4 shows the level change of potential harmful gases (incl. VOC, odor, etc.) detected. L1 indicates best air quality.

Gas level	Air quality light color
L1	Blue
L2	Blue-purple
L3	Purple-red
L4	Red

Turning on and off

Note:

- For optimum purification performance, close doors and windows.
- Keep curtains away from the air inlet or air outlet.

- 1 Put the plug of the air purifier in the power socket.
- 2 Touch  to switch on the air purifier.
 - ↳ The air purifier beeps.
 - ↳ The "---" displays on the screen during warming up. Then the air purifier shows the IAI/PM2.5/ Gas level after measuring the air quality.
 - ↳ The air purifier operates in the auto mode with IAI displayed on the screen.
- 3 Touch and hold the  button for 3 seconds to switch off the air purifier.

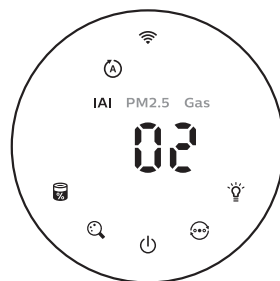



Note: If the air purifier stays connected to the electrical outlet after turning OFF, the air purifier will operate under the previous settings when turned ON again.

Changing the mode setting

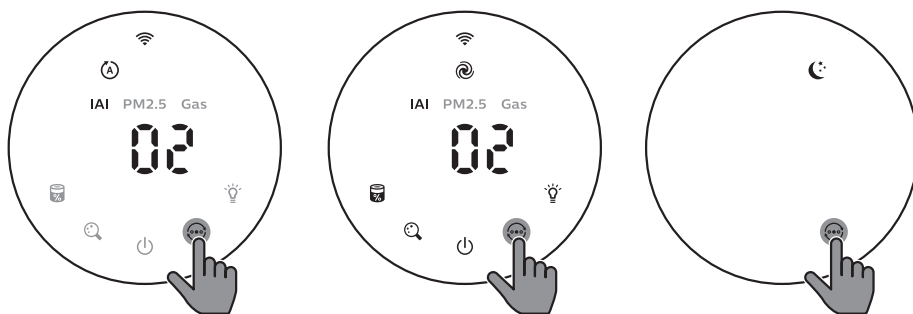
You can choose Auto mode, Turbo mode or the Sleep mode by touching the  button.



Auto mode (): In Auto mode, the dual-sensor sense the air quality in real-time and the appliance automatically adjusts the fan speed in accordance with the ambient air quality, the control panel can automatically adjust display screen brightness according to the ambient light.

Turbo mode (): In Turbo mode, the air purifier operates on the highest speed.

Sleep mode (): In Sleep mode, the air purifier operates quietly at a low speed. After 3 seconds, the screen lights off.

Switching the display indicator

Note: The appliance displays IAI level by default.

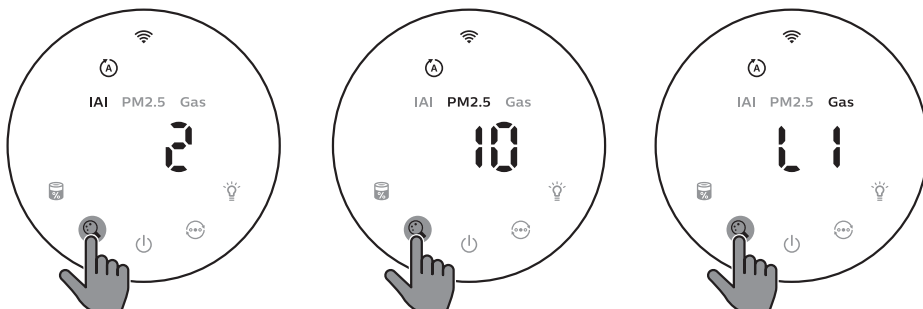

- Touch the  button to switch display indicator among IAI/PM2.5/Gas.

Using the light on/off function

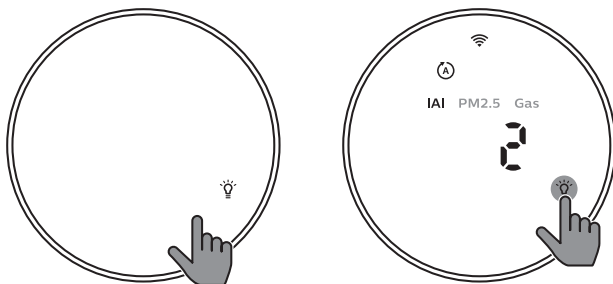

With the light sensor, the control panel can automatically turn on, turn off or dim according to the ambient light. The control panel will be off or dim when the ambient light is dark. You can touch any button to wake up all lights. Then, if no further operation, all lights will be off or dim again to match with the ambient light.

You can touch the light on/off button  manually to turn off all lights and the control panel. Touch any button to wake up all lights.

Checking the filter status

- Touch the filter status check/reset  button to check the filter service life status.
 - ↳ The percentage of remaining service life of the filter displays on the screen.

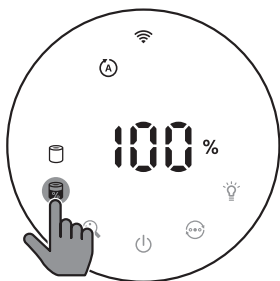

Icon color	Filter life indication	Display (%)
Blue	Optimal service life	16-100
Blue-purple	Good service life	9-15
Purple-red	Service life almost reaches the end	4-8
Red	Service life ends, replace the filter	0-3

Note: The appliance goes back to normal display if no operations after 3 seconds.

5 Cleaning and maintenance

Note:

- Always unplug the appliance before you clean it.
- Never immerse the appliance in water or any other liquid.
- Never use abrasive, aggressive, or flammable cleaning agents such as bleach or alcohol to clean any part of the appliance.
- Never use any liquids (including water) to clean the filter.
- Do not attempt to clean the particle sensor and gas sensor with a vacuum.

Cleaning schedule

Frequency	Cleaning method
When necessary	Wipe the fabric part of the appliance with a damp cloth, wipe the plastic part of the appliance with a soft, dry cloth
	Clean the air outlet cover
Every two months	Clean the particle sensor with a dry cotton swab
The  displays on the screen	Clean the surface of the filter

Cleaning the body of the air purifier

Regularly clean the inside and outside of the air purifier to prevent dust from collecting.

- 1 Wipe the fabric surface gently with a damp cloth.
- 2 Use a soft, dry cloth to clean both the interior and exterior of the air purifier and the air outlet.

Note:

- The fabric covered on the appliance can not be removed.
- Do not use hot water, alcohol, harsh cleaners to clean the fabric.

Cleaning the particle sensor

Clean the particle sensor every 2 months for optimal functioning of the appliance.

Note:

- If the air purifier is used in a dusty environment, it may need to be cleaned more often.
- If the humidity level in the room is very high, condensation may develop on the particle sensor and the air quality light may indicate a more poor air quality even though the air quality is actually good. If this occurs, clean the particle sensor.
- The gas sensor doesn't need to be cleaned.

- 1 Switch off the air purifier and unplug from the power socket.

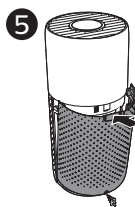
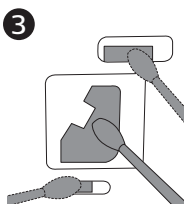
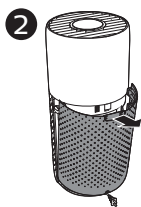

- 2 Pull the back cover and remove it from the appliance.
- 3 Clean the particle sensor with a damp cotton swab.
- 4 Dry all parts thoroughly with a dry cotton swab.
- 5 Reattach the back cover.

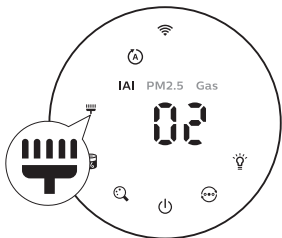

Cleaning the surface of the filter

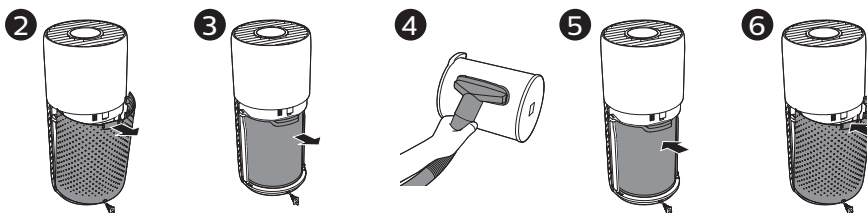

Filter alert light status	Action
The filter cleaning alert  displays on the screen	Clean the surface of the filter with a vacuum cleaner

- 1 Switch off the air purifier and unplug from the power socket.



- 2 Pull the back cover and remove it from the appliance.
- 3 Pull the filter from the appliance.
- 4 Clean the surface of the filter with a vacuum cleaner.
- 5 Put the filter back into the appliance.
- 6 Reattach the back cover.
- 7 Put the plug of the air purifier in the power socket.
- 8 Touch the  button to switch on the appliance.
- 9 Touch and hold the filter status check/reset button  for 3 seconds to reset the filter cleaning time.
- 10 Wash your hands thoroughly after cleaning the filter.

Replacing the filter

Understanding the healthy protection lock

This air purifier is equipped with a filter replacement indicator to make sure that the air purification filter is in optimal condition when the air purifier is operating. When the filter need to be replaced, the filter replacement alert  lights up red.

If the filter is not replaced in time, the air purifier will stop operating and automatically lock to protect the air quality in the room. Replace the filter as soon as possible.

Replacing the filter

Note:

- The filter is not washable or reusable.
- Always turn off the air purifier and unplug from the electrical outlet before replacing the filter.

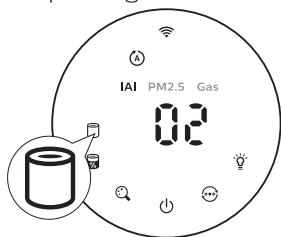

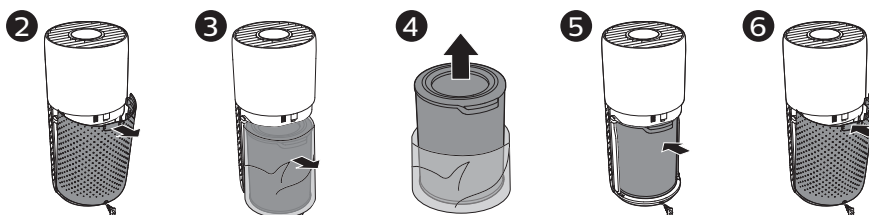

Filter alert light status	Action
The filter replacement alert  lights up	Replace the NanoProtect filter Series 3 (FY3430/30)

1 Switch off the air purifier and unplug from the power socket.





- 2 Pull the back cover and remove it from the appliance.
- 3 Pull the filter from the appliance.
- 4 Remove all packaging materials of the air purification filter.
- 5 Put the filter back into the appliance.
- 6 Reattach the back cover.

- 7 Put the plug of the air purifier in the power socket.
 - 8 Touch the  button to switch on the appliance.
 - 9 Touch and hold the filter status check/reset button  for 3 seconds to reset the filter lifetime counter.
 - 10 Wash your hands thoroughly after replacing the filter.
- Note:** Do not smell the filter as it has collected pollutants from the air.

Filter reset

You can replace the filter even before filter replacement alert () displays on the screen. After replacing a filter, you need to reset the filter lifetime counter manually.

- 1 Touch the power  button for 3 seconds to turn off the appliance and unplug from power socket.
- 2 Put the power plug in the power socket.
- 3 Within 15 seconds after power on, touch and hold  and  button for 3 seconds to reset the filter lifetime counter.

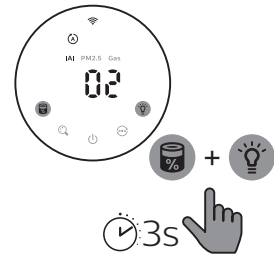



6 Storage

- 1 Turn off the air purifier and unplug from the power socket.
- 2 Clean the air purifier, particle sensor and the surface of the filter (see chapter "Cleaning and maintenance").
- 3 Let all parts air dry thoroughly before storing.
- 4 Wrap the filter in air tight plastic bags.
- 5 Store the air purifier, filter in a cool, dry location.
- 6 Always thoroughly wash hands after handling filters.

7 Troubleshooting

This chapter summarizes the most common problems you could encounter with the appliance. If you are unable to solve the problem with the information below, contact the Consumer Care Center in your country.

Problem	Possible solution
The appliance does not work properly.	<ul style="list-style-type: none">• The filter replacement alert has been on continuously but you have not replaced the corresponding filter. As a result, the appliance is now locked. In this case, replace the filter and long press  to reset the filter lifetime counter.
The airflow that comes out of the air outlet is significantly weaker than before.	<ul style="list-style-type: none">• The surface of the filter is dirty. Clean the surface of the filter (see the chapter "Cleaning and maintenance").
The air quality does not improve, even though the appliance has been operating for a long time.	<ul style="list-style-type: none">• Check if the packing material is removed from the filter.• The filter has not been placed in the appliance. Make sure that the filter (FY3430/30) is properly installed.• The particle sensor is wet. The humidity level in your room is high and causes condensation. Make sure that the particle sensor is clean and dry (see the chapter "Cleaning and maintenance").• Room size is large or the outdoor air quality is poor. For optimum purification performance, please close the doors and windows when operating the air purifier.• There are indoor pollution resources. For instances, smoking, cooking, incense, perfume or alcohol.• Filter reaches the end of life. Replace the filter with a new one.
The color of the air quality light always stays the same.	<ul style="list-style-type: none">• The particle sensor is dirty. Clean the particle sensor (see the chapter "Cleaning and maintenance").

Problem	Possible solution
The appliance produces a strange smell.	<ul style="list-style-type: none"> • The first few times you use the appliance, it may produce a plastic smell. This is normal. However, if the appliance produces a burnt smell even if removing filters, contact your Philips dealer or an authorized Philips service center. The filter may produce smell after being used for a while because of the absorption of indoor gases. It's recommended that you reactivate the filter by putting it in direct sunlight for repeated use. If odor still exists, replace the filter.
The appliance is extra loud.	<ul style="list-style-type: none"> • It's normal if the appliance runs at the Turbo mode. • In the Auto mode, if the appliance is too loud, maybe the appliance runs at high speed because air quality becomes worse, or your personalized setting in App triggers a higher fan speed. You can choose the Sleep mode, or change the settings in the App. • If anything drops into air outlet, it may also cause abnormal loud sound. Immediate turn off appliance, turn appliance upside down, to get foreign objectives out of appliance. • If there is abnormal sound, contact the Consumer Care Center in your country.
The appliance still indicates that I need to replace a filter, but I already did.	<ul style="list-style-type: none"> • Perhaps you did not reset the filter lifetime counter. Switch on the appliance. Then touch and hold the reset button () for 3 seconds.
Error code "E1" displays on the screen.	<ul style="list-style-type: none"> • The motor has malfunctions. Contact the Consumer Care Center in your country.

Problem	Possible solution
The Wi-Fi setup is not successful.	<ul style="list-style-type: none"> • If the router your purifier is connected to is dual – band and currently it is not connecting to a 2.4GHz network, please switch to another band of the same router (2.4GHz) and try to pair your purifier again. 5GHz networks are not supported. • Web authentication networks are not supported. • Check if the purifier is within range of the Wi-Fi router. You can try to locate the air purifier closer to the Wi-Fi router. • Check if the network name is correct. The network name is case-sensitive. • Check if the Wi-Fi password is correct. The password is case-sensitive. • Retry the setup with the instructions in section "Reset the Wi-Fi connection". • The Wi-Fi connectivity can be interrupted by electromagnetic or other interferences. Keep the appliance away from other electronic devices that may cause interferences. • Check if the mobile device is in airplane mode. Make sure to have the airplane mode deactivated when connecting to the Wi-Fi network. • Consult the help section in the App for extensive and up-to-date troubleshooting tips.

8 Guarantee and service

If you need information or if you have a problem, please visit the Philips website at www.philips.com or contact the Philips Consumer Care Center in your country (you can find its phone number in the worldwide guarantee leaflet). If there is no Consumer Care Center in your country, go to your local Philips dealer.

Order parts or accessories

If you have to replace a part or want to purchase an additional part, go to your Philips dealer or visit www.philips.com/support.

If you have problems obtaining the parts, please contact the Philips Consumer Care Center in your country (you can find its phone number in the worldwide guarantee leaflet).

目錄

1	重要事項	22
	安全	22
	電磁場 (EMF)	23
	環保	23
	簡短歐盟符合性聲明	23
2	您的空氣清新機	24
	產品概要	24
	控制鍵概覽	25
3	使用入門	26
	安裝濾網	26
	Wi-Fi 指示燈	26
	Wi-Fi 連接	27
4	使用空氣清新機	28
	了解空氣質素燈	28
	開關	29
	更改模式設定	29
	切換顯示指示燈	30
	使用開燈/關燈功能	30
	檢查濾網狀態	31
5	清潔與保養	31
	清潔時間表	31
	清潔空氣清新機機身	32
	清潔微粒感應器	32
	清潔濾網表面	33
	更換濾網	33
	重設濾網	35
6	儲存	35
7	疑難排解	35
8	保障及服務	37
	訂購零件或配件	37

1 重要事項

安全

使用本產品前請先閱讀本用戶手冊，並保管以作將來參考。

危險事項

- 請勿用水、任何液體或（易燃）清潔劑清潔此產品，或讓它們進入此產品，以免導致觸電和/或火災。
- 請勿在本產品周圍噴射殺蟲劑或芳香劑等易燃物品。

警告

- 在連接本產品前，請檢查產品註明的指示電壓與當地電源電壓是否對應。
- 如果電源線損壞，為避免危險，必須由 Philips、Philips 授權的維修中心或類似的合資格人士來更換。
- 若插頭、電源線或產品本身已受損，請勿使用。
- 此產品可供八歲及以上兒童，體能、感官或心智能力低下人仕，或缺乏知識及經驗人仕使用，如該等人仕已就使用本產品給予監督或有關安全使用本產品的指導及明白本產品的使用所涉及的危險。
- 請勿讓孩童將本產品當成玩具。
- 兒童不應於沒有監督情況下對產品進行清潔及維護。
- 請勿阻塞進氣口和排氣口，例如在排氣口上面或進氣口前面放置物件。
- 確保異物不會通過排氣口掉入裝置內部。
- WiFi 介面採用標準 802.11b/g/n 制式、2.4 GHz 頻段，最大輸出功率為 31.62 mW EIRP。

注意

- 本產品並不是適當通風設備、正規吸塵器或煮食時使用的抽油煙機或風扇的替代品。
- 在乾燥、穩定、平滑和水平表面上使用產品。
- 在本產品的周圍至少留出 20 厘米的空間，本產品上方至少留出 30 厘米空間。

- 請勿坐或站立在裝置上。請勿在裝置上放置任何物品。
- 請勿在冷氣機正下方放置產品，以避免冷凝滴水到產品上。
- 僅使用本產品專用的原裝 Philips 濾網。請勿使用任何其他濾網。
- 燃燒濾網可能造成對健康無可挽回的危害及/或危及他人生命。不要使用濾網作為燃料或類似用途。
- 避免以硬物碰撞產品（尤其是產品的進氣口或排氣口）。
- 請勿將您的手指或其他物件放入進氣口或排氣口，以免造成身體傷害或產品故障。
- 若您使用室內煙型驅蚊劑，或該地方有油跡、香火或化學煙霧，請勿使用本產品。
- 請勿在煤氣用具、暖氣設備或壁爐旁邊使用本產品。
- 當移動及清潔產品、更換濾網或進行其他維修保養時，請務必拔出本產品的插頭。
- 本產品只適合一般操作環境下的家居使用。
- 請勿在洗手間或廚房等高濕度或高溫環境，或溫度變化較大的房間使用本產品。
- 本產品不會去除一氧化碳 (CO) 或氫 (Rn)。本產品不能在含有燃燒過程和危險化學品的意外中充當安全裝置。

電磁場 (EMF)

這款 Philips 產品符合一切有關電磁場暴露的適用安全標準及條例。

環保

請勿在本產品使用壽命結束後當作一般家庭垃圾廢棄，應交給官方回收站作循環再用。這樣做有助保護環境。

請遵守您的國家/地區回收電器和電子產品的法則。正確處理廢棄產品有助避免對環境和人體造成負面影響。

簡短歐盟符合性聲明

DAP B.V. 在此聲明無線電設備類型 AC3033/AC3039符合歐盟指令 2014/53/EU。歐盟符合性聲明的全文可在以下網頁查閱：www.philips.com。

2 您的空氣清新機

感謝您購買 Philips 產品，歡迎來到 Philips 世界！

請前往以下網址註冊您的產品，以獲得 Philips 的完整支援：

www.philips.com/welcome。

產品概要

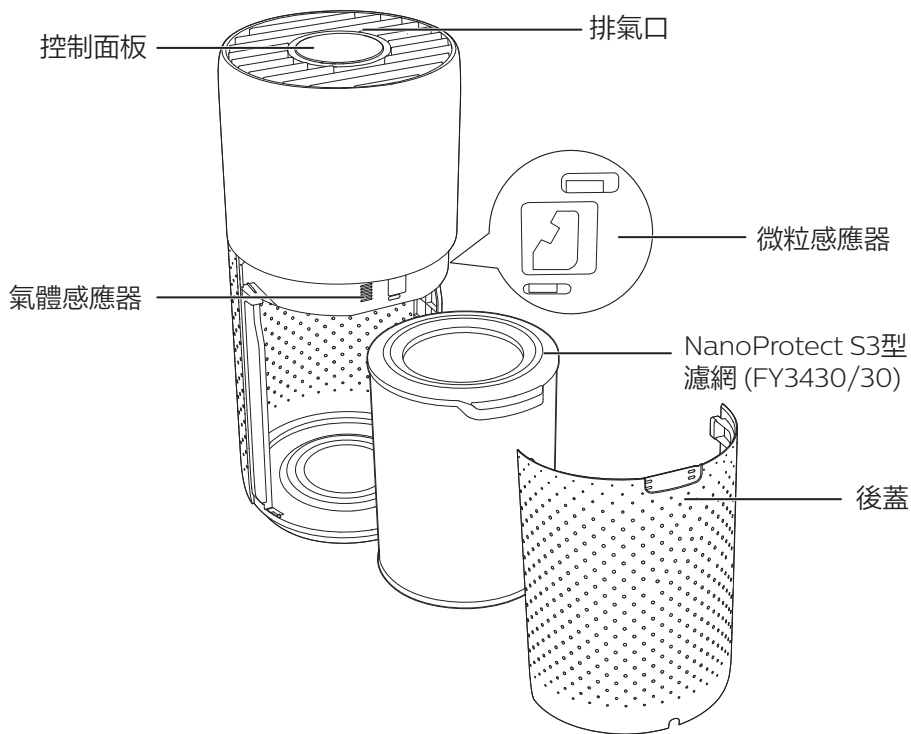

控制鍵概覽

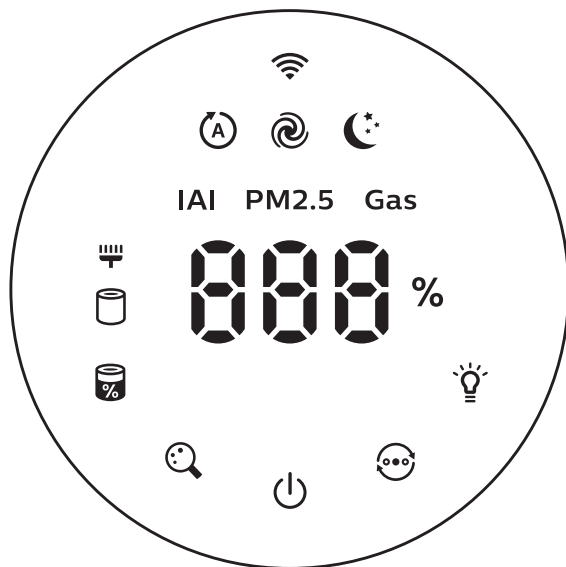

控制按鈕

	濾網狀態/重設按鈕		顯示切換按鈕
	電源開/關按鈕		模式切換按鈕
	燈光開/關按鈕		

顯示面板

	Wi-Fi 指示燈		自動模式
	特強模式		睡眠模式
IAI	室內致敏原指數顯示	PM2.5	PM2.5 顯示
Gas	氣體污染顯示		清潔濾網提示
	濾網更換警示		

3 使用入門

安裝濾網

首次使用前，請移除濾網的所有包裝。

備註：安裝濾網前，請確保將空氣清新機的插頭從電源插座拔出。

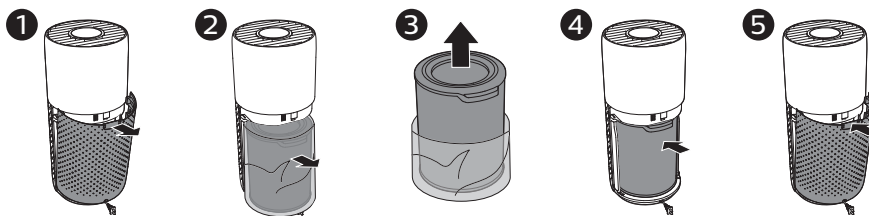

- 1 拉起後蓋，從產品拆下。
- 2 從產品拉出濾網。
- 3 移除空氣淨化濾網的所有包裝物料。
- 4 將濾網裝回本產品。
- 5 重新裝上後蓋。

Wi-Fi 指示燈

Wi-Fi 圖示狀態	Wi-Fi 連接狀態
閃爍橙色燈光	正在連接手機
穩定顯示橙色燈光	已連接至手機
閃爍白色燈光	正在連接伺服器
穩定顯示白色燈光	已連接伺服器
關閉	Wi-Fi 功能已停用

Wi-Fi 連接

首次設定 Wi-Fi 連線

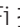
- 1 前往 App Store 或 Google Play 下載並安裝 Philips「Clean Home+」應用程式。
- 2 將空氣清新機的插頭插入電源插座，輕按  以開啟空氣清新機。
↳ Wi-Fi 指示燈  於首次使用時會亮橙燈。
- 3 請確保您的智能手機或平板電腦已成功連線至 Wi-Fi 網絡。
- 4 啟動「Clean Home+」應用程式。輕觸螢幕上方的「連接新裝置」或者「+」按鈕，按照畫面上的指示，將空氣清新機連接至您的網絡。







備註：

- 本指示僅適用於首次設定空氣清新機。如網絡有變或需要重新設定，請參閱第 27 頁「重設 Wi-Fi 連線」。
- 如您要將多於一部空氣清新機連接至智能電話或平板電腦，您必須逐一連接。
- 請確保流動智能電話或平板裝置與空氣清新機的距離在 10 米以內，而且沒有任何障礙物。
- 本應用程式支援最新版本的 Android 和 iOS。請查閱 www.philips.com/cleanhome，以了解支援作業系統和裝置的最新資料。

重設 Wi-Fi 連線

備註：

- 當預設網絡有變時，請重設 Wi-Fi 連線
- 1 將空氣清新機的插頭插入電源插座，輕按  以啟動空氣清新機。
 - 2 同時按住  和  3 秒，直至聽到「嗶」聲為止。
↳ 空氣清新機進入配對模式。
↳ Wi-Fi 指示燈  閃爍橙色燈光。
 - 3 請按照「首次設定 Wi-Fi 連線」部分的步驟 3 至 4 操作。

4 使用空氣清新機

了解空氣質素燈

開啟空氣清新機時，空氣質素燈將自動亮起，並順序顯示所有顏色。約 30 秒後，微粒感應器會根據周遭空中粒子的空氣質素，選擇相應的顏色。

空氣質素燈的顏色由 PM2.5、IAI 和氣體讀數的最高風險指數決定。

空氣質素指示燈的顏色	空氣質素水平
藍色	良好
藍紫色	一般
紫紅色	差
紅色	非常差

過敏原

專業級的 AeraSense 感應器可偵測室內空氣過敏原的水平，透過 1 至 12 的數值反應顯示室內空氣過敏原的潛在危險等級。1 代表最佳的空氣質素。

IAI 水平	空氣質素指示燈的顏色
1-3	藍色
4-6	藍紫色
7-9	紫紅色
10-12	紅色

PM2.5

AeraSense 感應技術能夠準確地偵測並快速回應，即使對空氣中最微小的粒子變化也不例外。確保可為您提供即時的 PM2.5 反應的保證。

大多數室內空氣污染物屬於 PM2.5，即是指小於 2.5 微米的空中粒子污染物。常見的室內微細粒子來自煙草煙霧、烹飪、燃燒蠟燭。一些空中傳播的細菌和最小的霉菌孢子、寵物致敏原和塵蟎致敏原粒子亦屬於 PM2.5。

PM2.5 水平	空氣質素指示燈的顏色
≤12	藍色
13-35	藍紫色
66-55	紫紅色
>55	紅色

氣體

裝置設有先進的氣體感應器，從螢幕上 L1 到 L4 的數值顯示潛在有害氣體的水平變化（包括 VOC、臭氣等）。L1 代表最佳的空氣質素。

氣體水平	空氣質素指示燈的顏色
L1	藍色
L2	藍紫色
L3	紫紅色
L4	紅色

開關

備註：

- 請關閉門窗，以獲得最佳的空氣淨化效果。
- 窗簾必須遠離進氣口或排氣口。

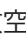
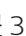
- 1 將空氣清新機的插頭插入電源插座。
- 2 按下  以開啟空氣清新機。
 - ↳ 空氣清新機發出嗶聲。
 - ↳ 正準備運作時，「---」將顯示在螢幕上。在測量空氣質素後，空氣清新機會顯示過敏原/PM2.5/氣體水平。
 - ↳ 空氣清新機會以自動模式運作，並在螢幕上顯示過敏原級別。
- 3 輕按住  按鈕 3 秒以關閉空氣清新機。

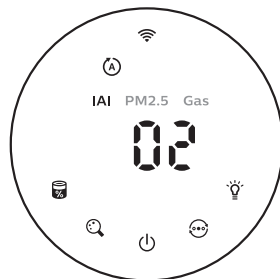

備註：如空氣清新機在「關閉」後繼續連接至電源插座，空氣清新機在再次「開啟」時，將按之前的設定操作。

更改模式設定

您可輕按  按鈕，選擇自動模式、特強模式或睡眠模式。

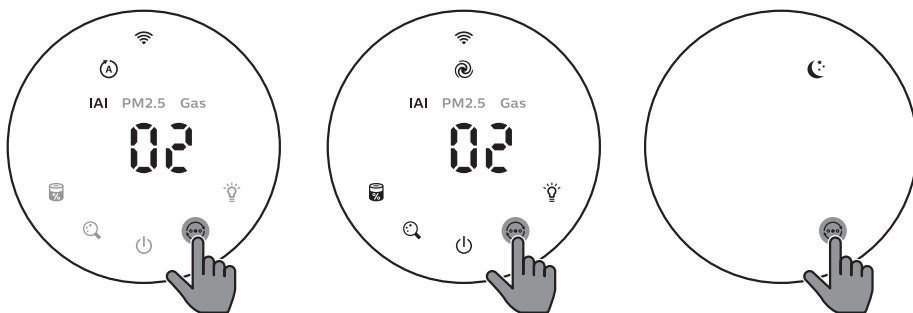

自動模式 (A)：在自動模式中，雙重感應器會即時感測空氣質素，本產品會根據空氣質素環境選擇風扇速度，而控制面板亦會根據環境光線自動調校螢幕亮度。

特強模式 (@)：在特強模式中，空氣清新機會以最高速度運作。

睡眠模式 (☾)：在睡眠模式中，空氣清新機會以緩慢速度安靜運作。3 秒後，螢幕的燈光會關閉。

切換顯示指示燈

備註：本產品預設顯示過敏原水平。

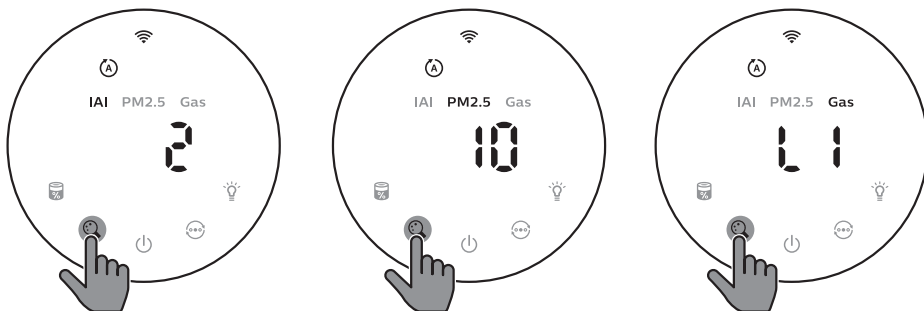

- 輕按  按鈕，切換顯示過敏原/PM2.5/氣體指示燈。

使用開燈/關燈功能

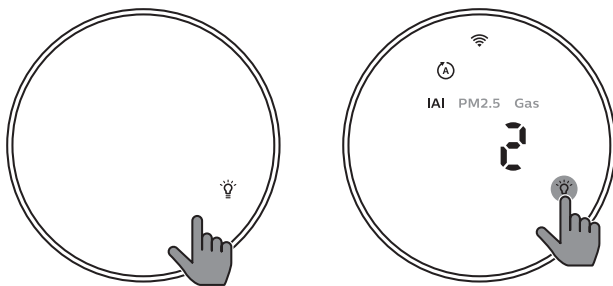

裝置的光線感應器會讓控制面板根據環境光線自動開啟、關閉或變暗。在環境光線昏暗時，控制面板便會關閉或變暗。您可以輕按任何按鈕來喚醒所有燈光。如果沒有進一步操作，所有燈光便會關閉或變暗以配合環境光線。

您可以輕按燈光開/關按鈕  來關閉所有燈光和控制面板。輕按任何按鈕來喚醒所有燈光。

檢查濾網狀態

- 點按濾網狀態檢查/重設  按鈕，檢查濾網的使用壽命狀態。
 - 濾網餘下的使用壽命會以百分比顯示在螢幕上。

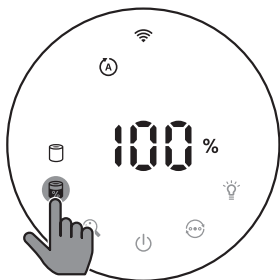

圖示顏色	濾網使用壽命指示	顯示 (%)
藍色	最佳使用壽命	16-100
藍紫色	良好使用壽命	9-15
紫紅色	使用壽命即將結束	4-8
紅色	使用壽命結束，請更換濾網	0-3

備註：如果 3 秒後沒有進行操作，本產品會回到正常顯示畫面。

5 清潔與保養

備註：

- 必需在清潔前拔出產品插頭。
- 切勿將本產品侵入水中或任何其他液體中。
- 請勿使用磨蝕性、侵略性或易燃清潔劑（如漂白劑或酒精）清洗本產品的任何一部分。
- 請勿使用任何液體（包括水）來清潔濾網。
- 請勿以吸塵機清潔微粒感應器及氣體感應器。

清潔時間表

頻率	清潔方法
必要時	用濕布擦拭產品的布料部分，用柔軟的乾布擦拭產品的塑膠部分
	清潔排氣口護蓋
每兩個月	使用乾棉花棒清潔微粒感應器
 在螢幕上顯示	清潔濾網表面

清潔空氣清新機機身

請定時清潔本空氣清新機的內部和外部，以避免積聚塵埃。

- 1 用濕布輕輕擦拭布料表面。
- 2 使用柔軟的乾布清潔空氣清新機和排氣口的內部和外部。

備註：

- 本產品表面的布料無法移除。
- 請勿使用熱水、酒精及刺激性清潔劑來清潔布料。

清潔微粒感應器

每 2 個月清潔一次微粒感應器，讓本產品發揮出最佳功能。

備註：

- 如在多塵的環境內使用空氣清新機，則可能需要更常清潔。
- 如房間濕度非常高，水滴便會凝結在微粒感應器上，即使實際空氣質素良好，空氣質素燈仍可能會顯示較差的空氣質素。如果出現這個情況，請清潔微粒感應器。
- 不需清潔氣體感應器。

- 1 關閉空氣清新機，並將其從電源插座拔出。

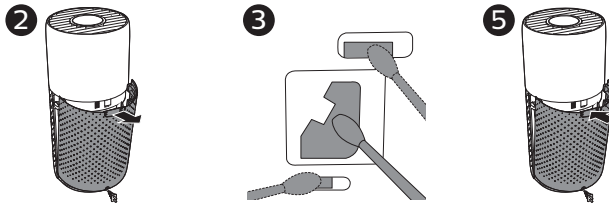

- 2 拉起後蓋，從產品拆下。
- 3 使用濕棉花棒清潔微粒感應器。
- 4 使用乾爽的棉花棒徹底擦乾所有部件。
- 5 重新裝上後蓋。

清潔濾網表面

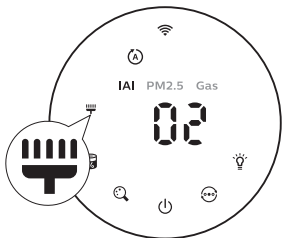

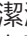
濾網指示燈狀態	動作
清潔濾網提示  會在螢幕上顯示。	使用吸塵機清潔濾網表面

1 關閉空氣清新機，並將其從電源插座拔出。

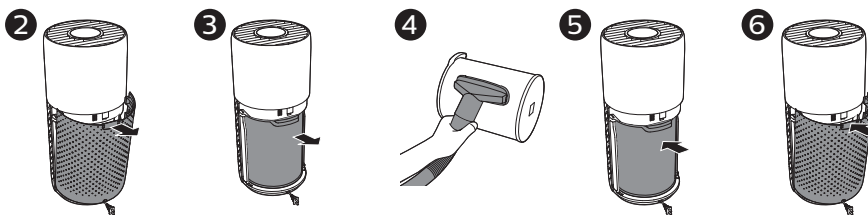

2 拉起後蓋，從產品拆下。

3 從產品拉出濾網。

4 使用吸塵機清潔濾網表面。

5 將濾網裝回本產品。

6 重新裝上後蓋。

7 將空氣清新機的插頭插入電源插座。

8 按下  按鈕開啟本產品。

9 按住濾網狀態檢查/重設按鈕  3 秒，以重新設定濾網清潔時間。

10 清潔濾網後，必須徹底洗淨雙手。

更換濾網

了解清新保護鎖

空氣清新機設有濾網替換指示燈，以確保空氣清新機濾網在空氣清新機運作時處於良好狀態。需要更換濾網時，濾網更換提示  燈會亮起紅色。

如果沒有及時更換濾網，空氣清新機將停止運作並自動鎖定，以保障房間的空氣質素。請盡快更換濾網。

更換濾網

備註：

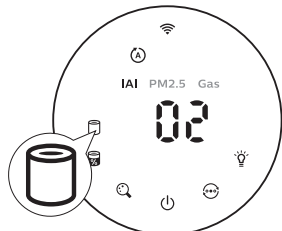

- 請勿清洗或重用濾網。
- 更換濾網前，必須關閉空氣清新機，並將插頭從電源插座拔出。

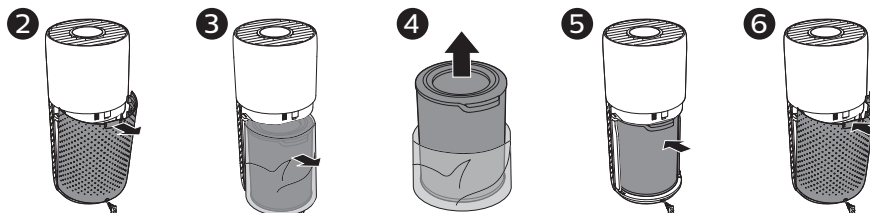

濾網指示燈狀態	動作
濾網更換提示  燈會亮起	更換 NanoProtect S3型濾網 (FY3430/30)

1 關閉空氣清新機，並將其從電源插座拔出。

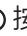



- 2 拉起後蓋，從產品拆下。
- 3 從產品拉出濾網。
- 4 移除空氣淨化濾網的所有包裝物料。
- 5 將濾網裝回本產品。
- 6 重新裝上後蓋。
- 7 將空氣清新機的插頭插入電源插座。
- 8 按下  按鈕開啟本產品。
- 9 按住濾網狀態檢查/重設按鈕  3 秒，以重新設定濾網壽命計算器。
- 10 更換濾網後，必須徹底洗淨雙手。

備註：因濾網滿佈空氣中的污染物，請勿嗅聞濾網。

重設濾網

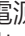
您可以在屏幕顯示濾網更換警示 () 之前更換濾網。更換濾網後，您需要手動重設濾網壽命計算器。

- 1 輕按電源  按鈕 3 秒以關閉本產品，並將插頭從電源插座拔出。
- 2 將電源插頭插入電源插座。
- 3 開啟電源後 15 秒內，按住  及  按鈕 3 秒，以重設濾網壽命計算器。

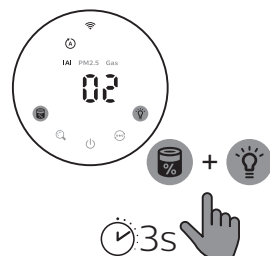



6 儲存

- 1 關閉空氣清新機，並將插頭從牆身插座拔出。
- 2 清潔空氣清新機、微粒感應器和濾網表面（請參閱「清潔與保養」章節）。
- 3 必須讓所有部件風乾方可存放。
- 4 將濾網放入密封膠袋中。
- 5 將空氣清新機、濾網存放於陰涼乾爽的地方。
- 6 處理濾網後，必須徹底洗淨雙手。

7 疑難排解

本章節總結一些您在本產品上最常見的問題。如果您按照以下資料仍未能解決問題，請聯絡您的國家的 Philips 顧客服務中心。

問題	可行解決方案
本產品無法正確操作。	<ul style="list-style-type: none">• 濾網更換提示燈已亮起但沒有更換相應濾網，因此本產品已被鎖定。在這情況，請更換該濾網並按住 ，以重設濾網壽命計算器。
排氣口排出的風量比以前明顯減弱。	<ul style="list-style-type: none">• 濾網的表面骯髒。清潔濾網表面（請查看「清潔與保養」章節）。

問題	可行解決方案
本產品經過長時間運作，空氣質素仍沒有改善。	<ul style="list-style-type: none"> 請檢查是否已移除濾網的所有包裝物料。 本產品的濾網未有更換。確保正確安裝濾網 (FY3430/30)。 微粒感應器變濕。您的房間濕度高，導致水分凝結。確保微粒感應器清潔和保持乾燥（請參閱「清潔與保養」章節）。 房間面積大或室外空氣質素差。 為獲得最佳淨化性能，請在操作空氣清新機時關閉門窗。 有室內污染源頭。例如，吸煙、烹飪、焚香、香水或酒精。 濾網的使用壽命結束。更換全新的濾網。
空氣質素光環的顏色永遠保持同一顏色。	<ul style="list-style-type: none"> 微粒感應器處於骯髒的狀態。清潔微粒感應器（請查看「清潔與保養」章節）。
本產品發出一陣怪味。	<ul style="list-style-type: none"> 在您最初數次使用本產品時，它可能會發出一點塑膠氣味。此為正常。可是，如果本產品在更換濾網後發出燒焦的氣味，請聯絡您的 Philips 經銷商或認可的 Philips 服務中心。由於吸收了室內氣體，濾網使用一段時間後可能會產生氣味。建議您將濾網置於陽光下，然後再重新使用。如果仍有異味，請更換濾網。
本產品聲浪太大。	<ul style="list-style-type: none"> 如果本產品運行特強模式，屬正常現象。 在自動模式中，如果本產品聲響太大，可能是因為空氣質素變差，或者您在應用程式中的個人化設定令風扇速度提高，所以產品才以高速運行。您可以選擇睡眠模式，或在應用程式中更改設定。 如果有任何東西掉入排氣口，亦有可能產生異常響亮的聲音。立即關閉產品，並倒轉產品，以便從產品中取出外來物體。 如果仍然有不正常的聲響，請聯絡您所在國家/地區的客戶服務中心。
即使我已替換濾網，本產品仍表示需要替換。	<ul style="list-style-type: none"> 可能您沒有重設濾網的使用時間。開啟本產品按住重設按鈕 () 3 秒。
螢幕顯示「E1」的錯誤代碼。	<ul style="list-style-type: none"> 摩打出現故障。請聯絡您所在國家/地區的客戶服務中心。

問題

可行解決方案

未能成功設定
Wi-Fi。

- 如果本產品所連接的路由器為雙頻，而目前不是連接 2.4GHz 網絡的話，請將該路由器的頻段切換至 2.4GHz，然後再次嘗試進行配對。不支援 5GHz 網絡。
 - Web 驗證網絡不受支援。
 - 檢查本產品是否在 Wi-Fi 路由器所覆蓋的範圍內。您可以嘗試將空氣清新機移近 Wi-Fi 路由器。
 - 請檢查網絡名稱是否正確。網絡名稱有大小寫之分。
 - 請檢查 Wi-Fi 密碼是否正確。密碼有大小寫之分。
 - 根據「重設 Wi-Fi 連線」部分的指示，嘗試重新設定。
 - Wi-Fi 連線可能被電磁場或其他干擾而中斷。讓本產品遠離可能會造成干擾的其他電子裝置。
 - 請檢查流動裝置是否處於飛行模式。連接至 Wi-Fi 網絡時，請確保已停用飛行模式。
 - 請參閱應用程式中的說明部分，以獲取最新的詳細疑難排解貼士。
-

8 保障及服務

如果您需要資料或有疑問，請前往 Philips 網站 www.philips.com，或聯絡您國家/地區的 Philips 客戶服務中心（電話號碼可於全球保障小冊子上找到）。如果您的國家/地區沒有客戶服務中心，請前往當地的 Philips 經銷商。

訂購零件或配件

如果您需要更換零件或想訂購額外配件，請前往您的 Philips 經銷商或瀏覽 www.philips.com/support。

如果您索取有關零件時遇上問題，請聯絡您的國家/地區 Philips 客戶服務中心（您可在全球保障小冊子上找到其電話號碼）。



© 2021 Philips Domestic Appliances Holding B.V.
保留所有權利

3000 059 83151

