

Core Floorstanding with
Brother Printer Mount

Assembly Instructions

Tools Required:

- Socket Driver
- 10mm Spanner **or adjustable spanner*

Sheet Code: BP-IM-094_REV0
Release Date: 16/08/2024

Copyright 2024 Spotspot Ltd. (T/A Bouncepad) all rights reserved.
Confidential, no part of this publication may be reproduced or transmitted in any form without the written permission of the copyright holder.

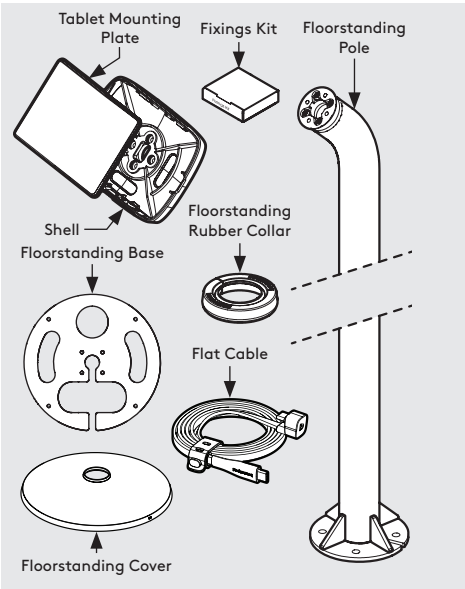

In the Box (Floorstanding)

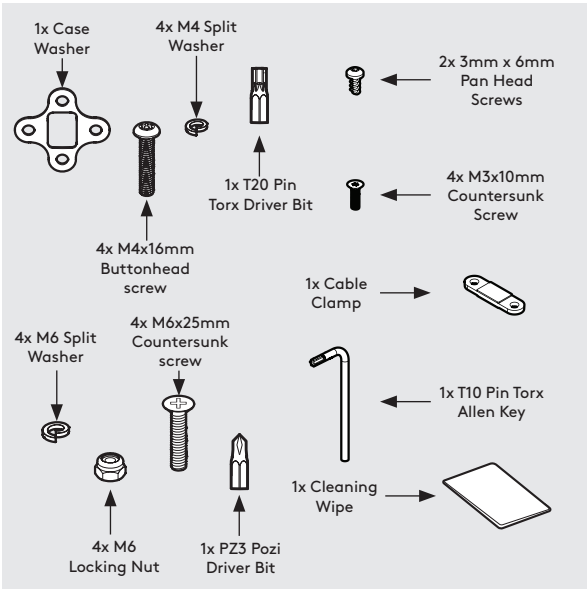

Fixings List (Floorstanding)

** Due to the modular nature of our product range you may receive additional fixings in the fixings kit*

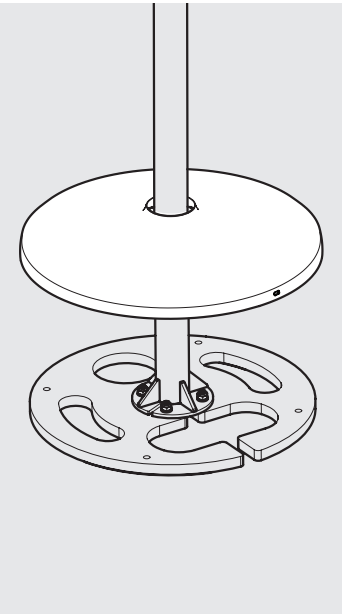
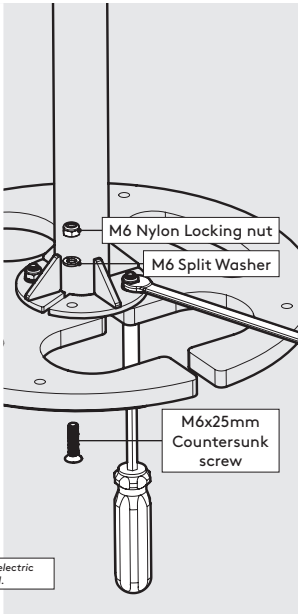
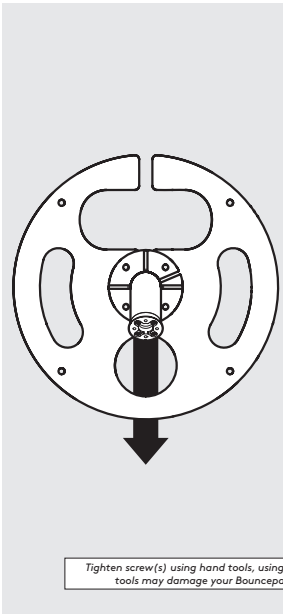
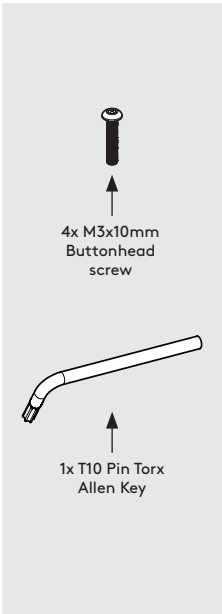
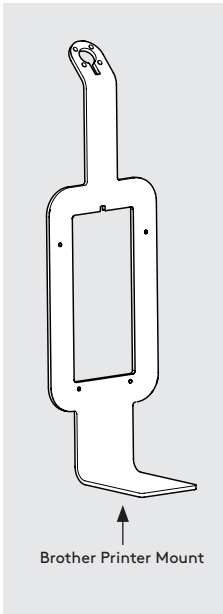

In the Box (Printer Mount)



Fixings List (Printer Mount)



1 Orientate, locate & secure the Floorstanding Pole to the Floorstanding Base as shown. Ensure that all fixings are installed correctly.



2 Locate the Floorstanding Cover over the Floorstanding Pole.

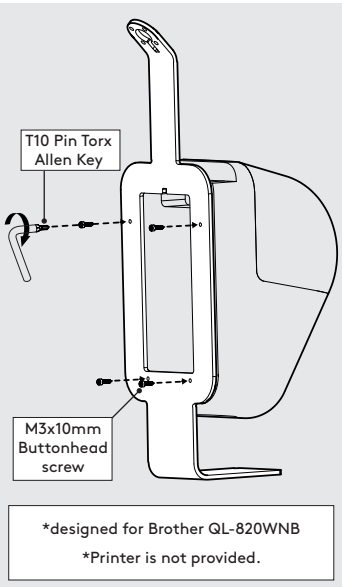
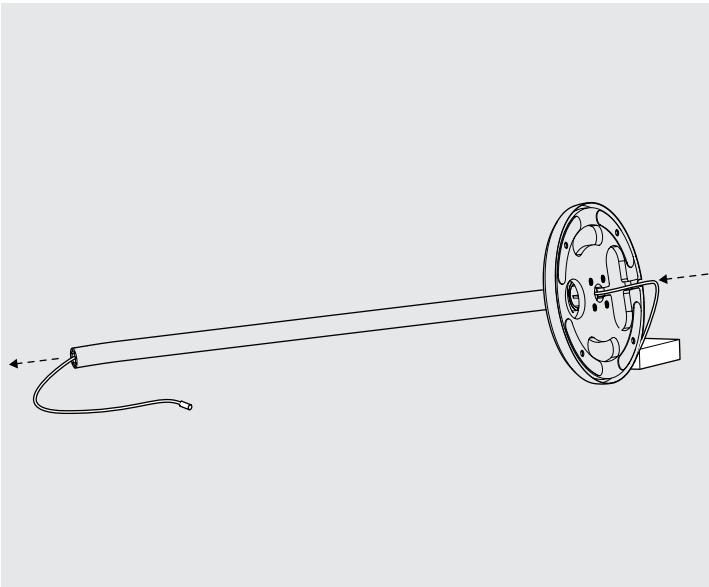
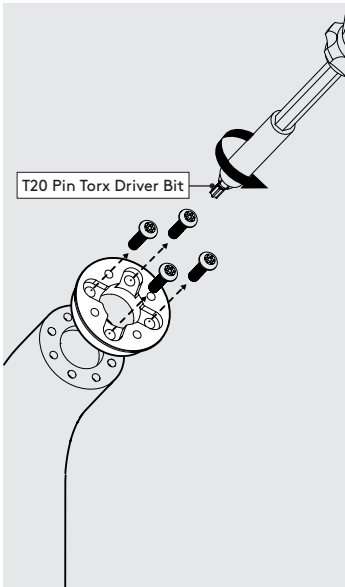

3 Remove Neck-Ring using T20 driver bit and Socket Driver.



4 Feed the printer's power cable through the Floorstanding Pole.



5 Attach the printer to the Printer Mount using M3x10mm Screws.

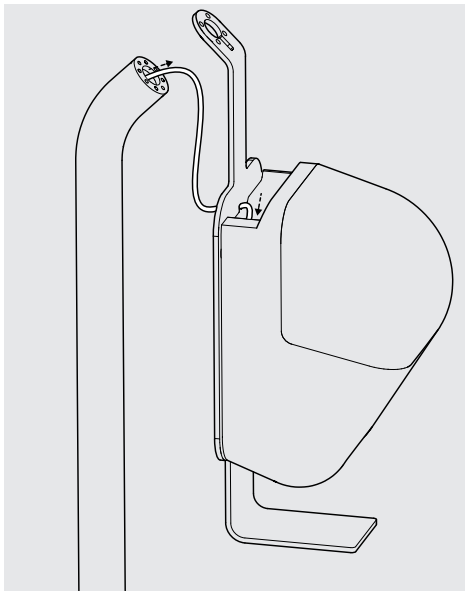

6

Feed power cable through Printer Mount and plug into Printer

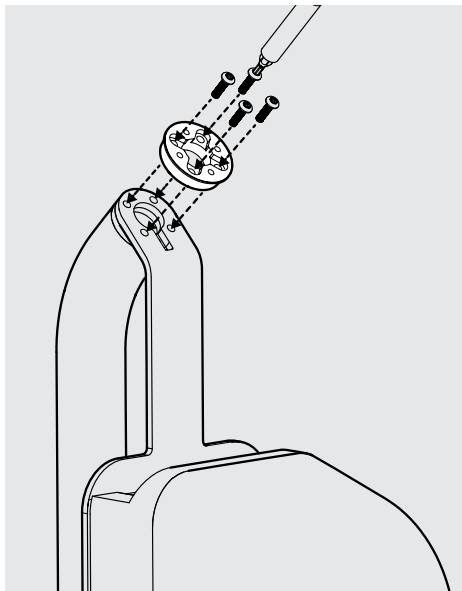

7

Re-attach Neck-Ring

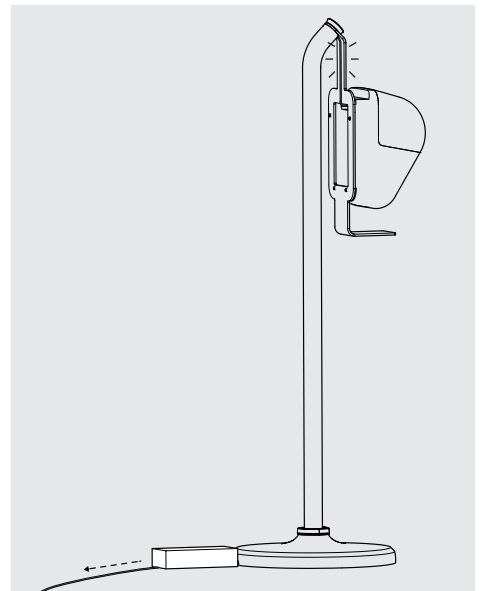

8

Pull cable back to remove any slack near the Printer Mount

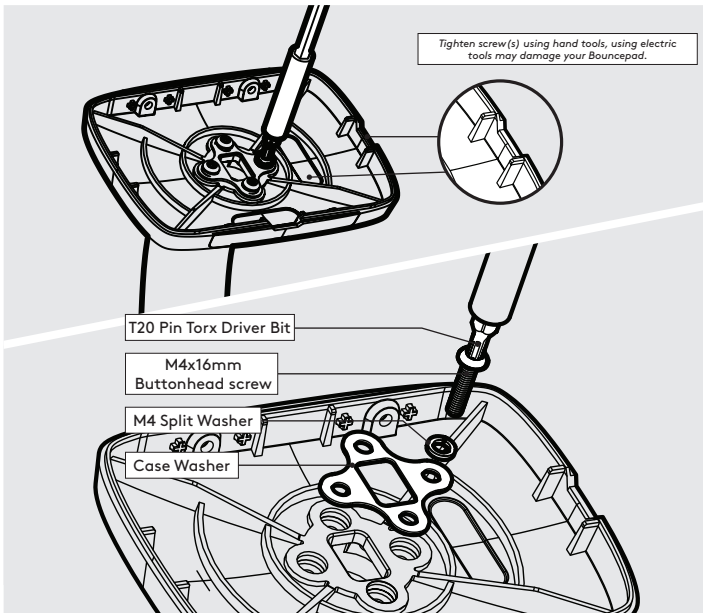

9

Locate & attach the Shell to the Floorstanding in the correct orientation.

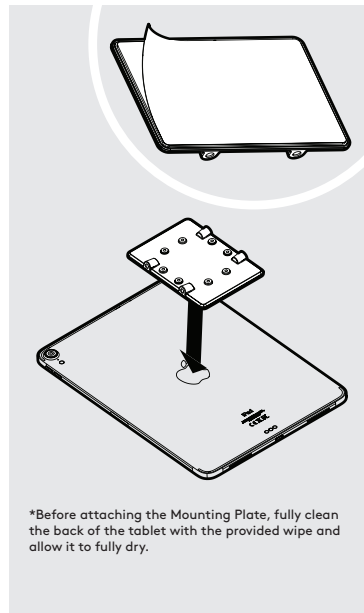

10

Remove the Mounting Plate adhesive backing. Attach level & centrally to the Tablet back as shown.

For optimal adhesion, press firmly and leave for 72hrs in a 20°C environment before use. Do not reposition. Do not use prior to the 72hrs.

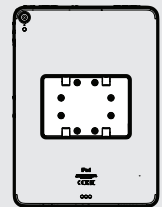

Portrait

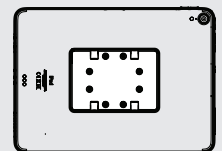

Landscape

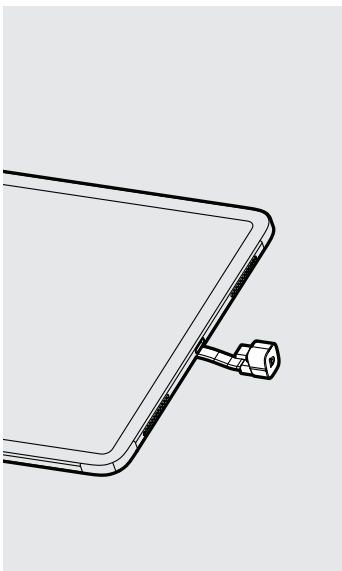

11

Attach the Flat Cable to the Tablet with the U-Bend Head.

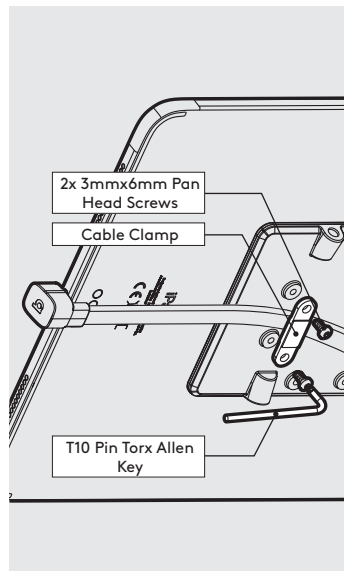

12

Secure the Flat Cable to the Mounting Plate with the Cable Clamp as shown.

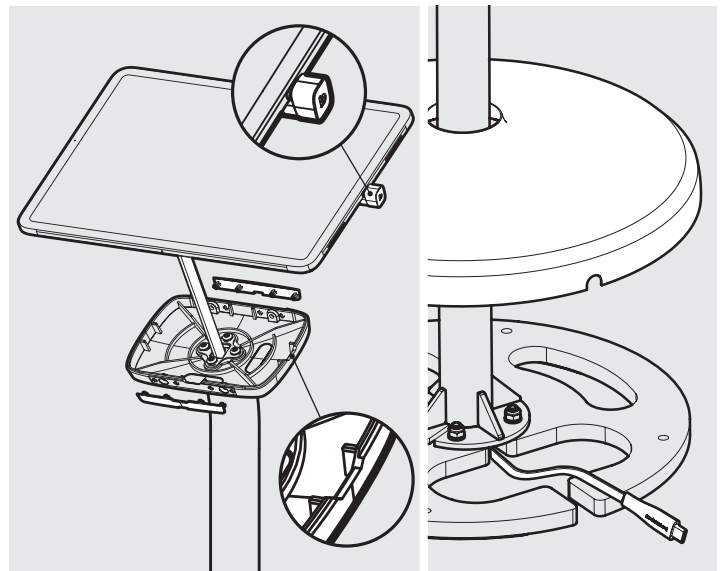

13

Remove the Fixing Covers. Feed the Flat Cable into the assembly & locate the Tablet in the chosen orientation.

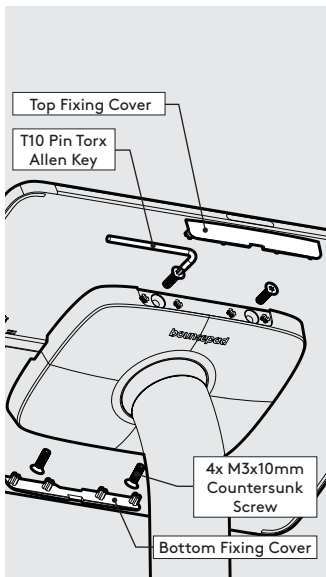

14 Secure the Tablet to the Shell & attach the Fixing Covers as shown.

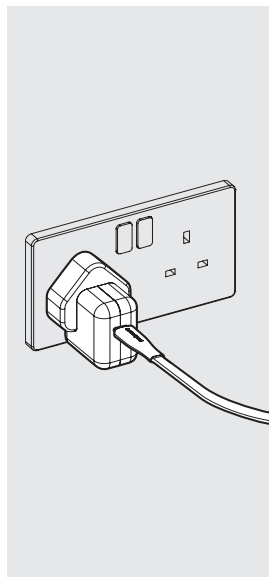

15.1 Connect the tablet power cable to its mains power source.

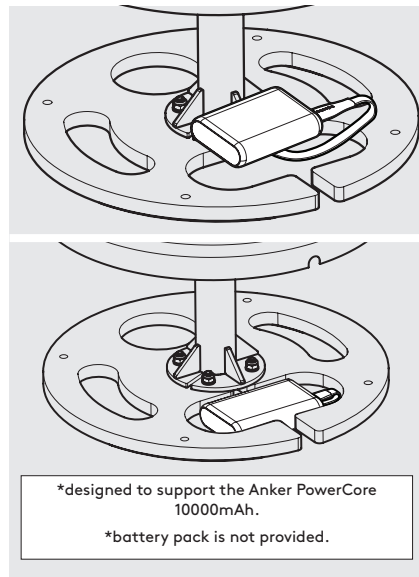

15.2 If installing a battery pack, connect the Tablet Cable and locate the pack into the Floorstanding Base.

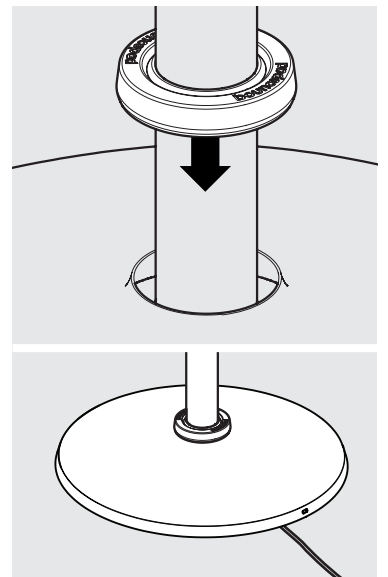

16 With the Floorstanding Cover on the ground, locate & fit the Floorstanding Rubber Collar.

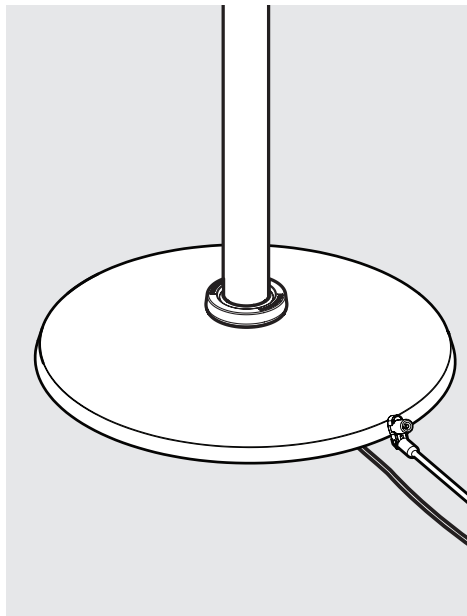

17 Use a Kensington® Microsaver product to tether to a secure object. (refer to your Kensington® instructions for full details)

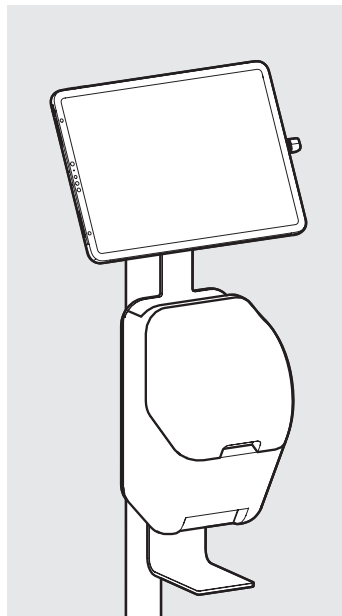

18 Installation is now complete.