

112303 UK Power Cord, C13 to BS1363, 7.5m, 10A Fuse

Product Images

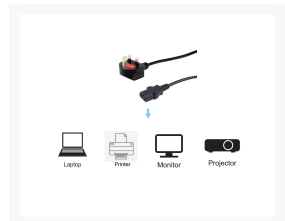

Short Description

- C13 Female x 1
- BS1363 Male x 1
- Cable Length: 2.0m
- Conductor: H05VVH2-F 3x0.75mm2
- Load capacity: 250V/10A, 2500W
- Fuse: 10A Fuse
- ASTA/ BS/ VDE approved

Description

The equip® Power Cord is designed to carry clear and crisp electricity, building a sustainable power supply environment

Additional Information

Connector 1	IEC C13 Female
Connector 2	BS1363 Male
Approval and Compliance	ASTA,VDE,ROHS,REACH,UKCA
Package Contents	UK Power Cord, C13 to BS1363, 7.5m, 10A Fuse
Cable Length	7.5m
Dimensions (W x D x H)	49.5 x 45 x 7500 mm
Product weight (kg)	0.76
Color	Black
EAN	4015867238950
Model Number	112303

