

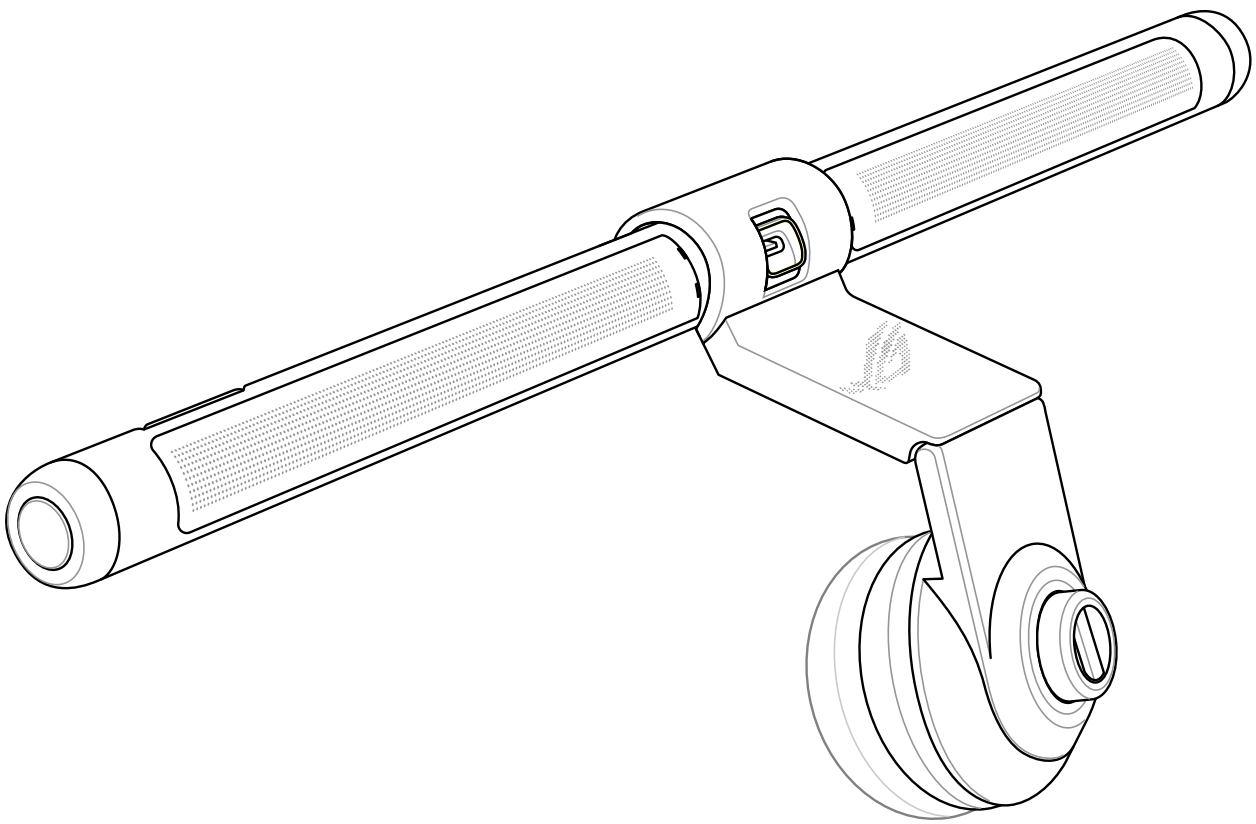

# ROG AURA MONITOR LIGHT BAR (ALB01) USER GUIDE



# Package contents

- 1 x ROG Aura Monitor Light Bar
- 1 x Patent Clamp
- 1 x USB Power Cable
- 1 x Warranty Card
- 1 x Quick Start Guide

# Specifications

Model		ALB01
DC power input		5V, 1A
Max. power consumption		5W
LED color rendering (indexCRI)		Ra ≥ 95
Color temperature		2700K~6500K
Uniformity		≥ 60% (distance from illuminated surface 45cm; illuminated area 60cm x 40cm)
Average brightness (lux)		> 500 lux (distance from illuminated surface 45cm; illuminated area 60cm x 40cm)
Control interface		USB Type-C® port Scroll bar Physical buttons
Mounting solution		Patented clamp
Operating temperature		0°C ~ 40°C
Certification		IEC 62471 IEEE Std 1789
Dimension (L x W x H)	Physical item	498.4mm x 107.57mm x 117.44mm
	Box dimension	552mm x 174mm x 88mm
Weight (g)	Item weight	659.2g
	Gross weight	2351.3g
App Support		Armoury Crate NOTE: Allows you to turn the Aura Sync function (synchronizes Aura RGB lighting effect among all supported devices) on or off.
		ASUS DisplayWidget Center NOTE: Allows you to configure both the Light Bar and the Aura RGB Lighting with three control modes supported: Light Bar only / Aura RGB Lighting only / Both Light Bar and Aura RGB Lighting.

# Clamp configurations

## Clamp configuration A (9mm~55mm, recommended for flat displays)

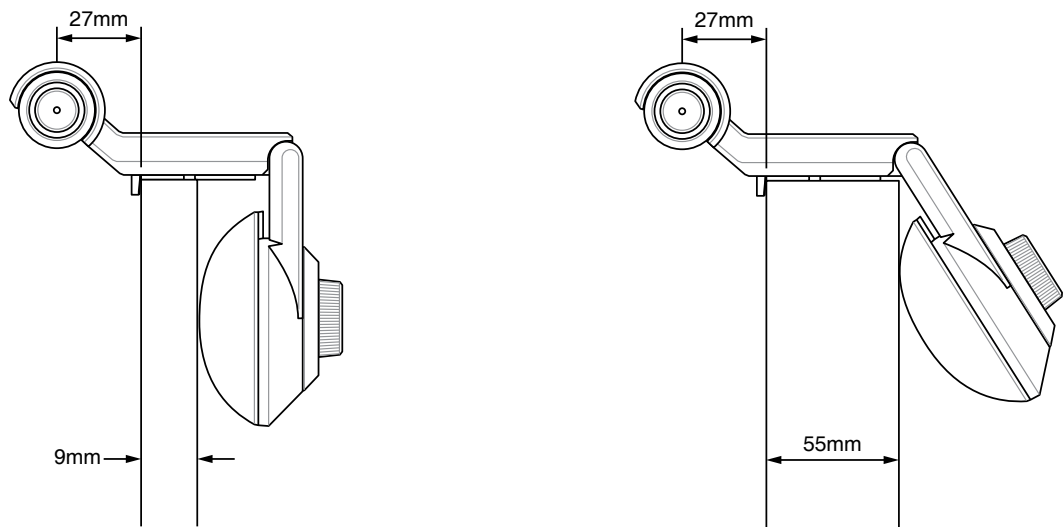

## Clamp configuration B (6mm~30mm, recommended for curved displays)

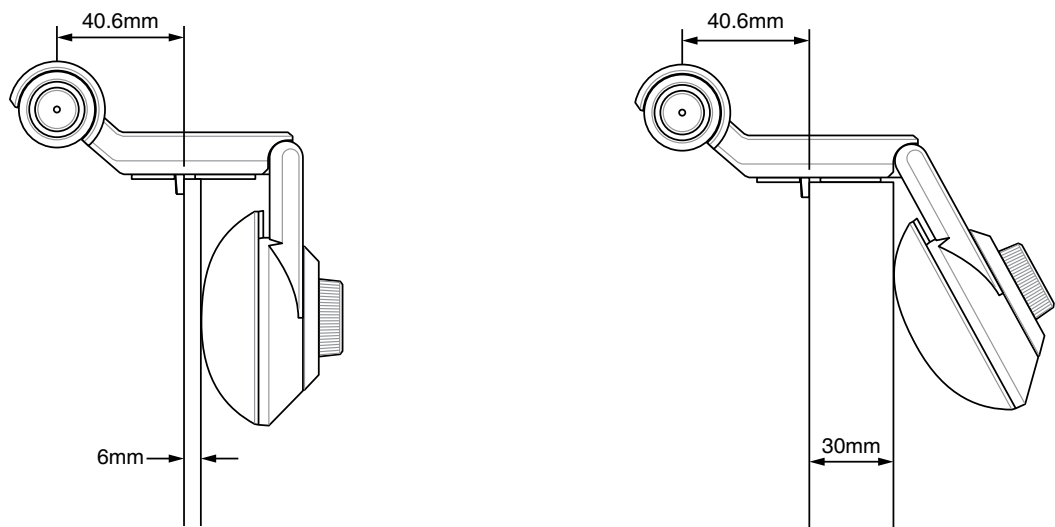

# Product overview

## Bottom view

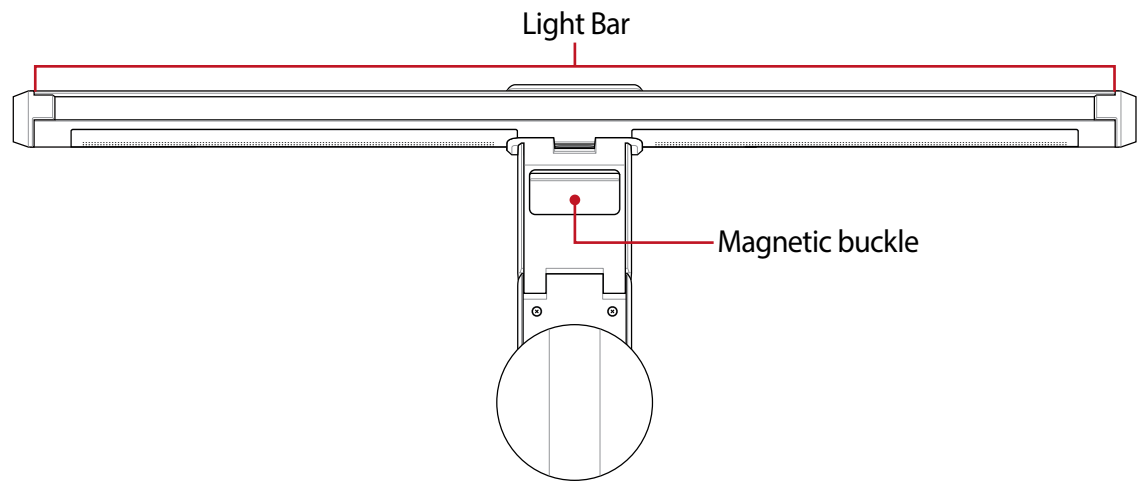

## Rear view

Brightness & Color Temperature Switch  
(key press to toggle between Brightness and Color temperature, scroll up/down to adjust color temperature or brightness)

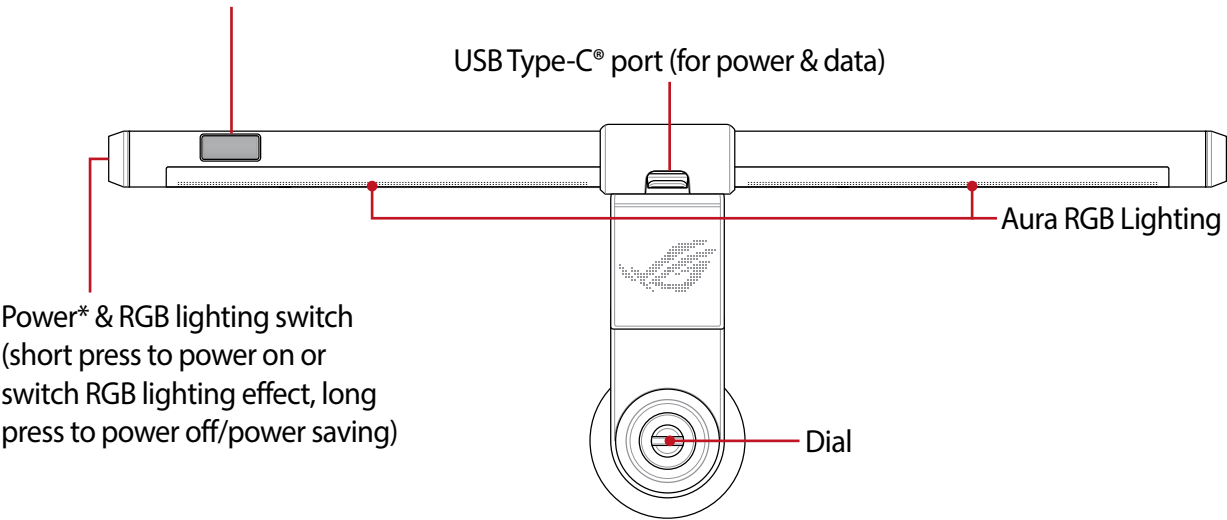

\* The power LED will change according to the current mode selected, please refer to the table below for the different LED indications:

Mode	Power LED indicator color
Power ON and Brightness mode	White
Power ON and Color Temperature mode	Yellow
Power Saving NOTE: Long press to enter Power Saving mode	Orange (Light Bar and Aura RGB Lighting are off)
Power Off NOTE: Powers off automatically 30 seconds from Power Saving mode	Off

# Installation and assembly

1

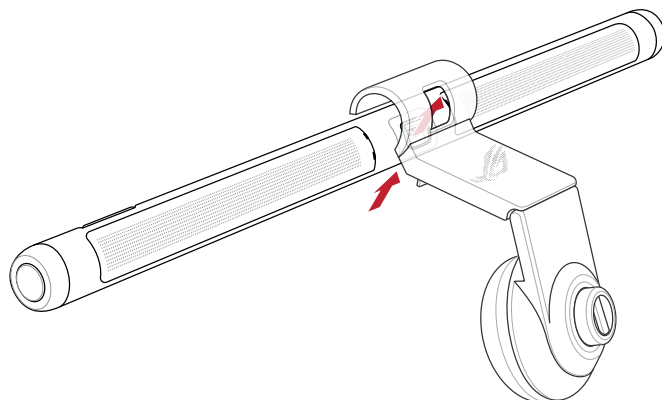

2

A

**Clamp configuration A**

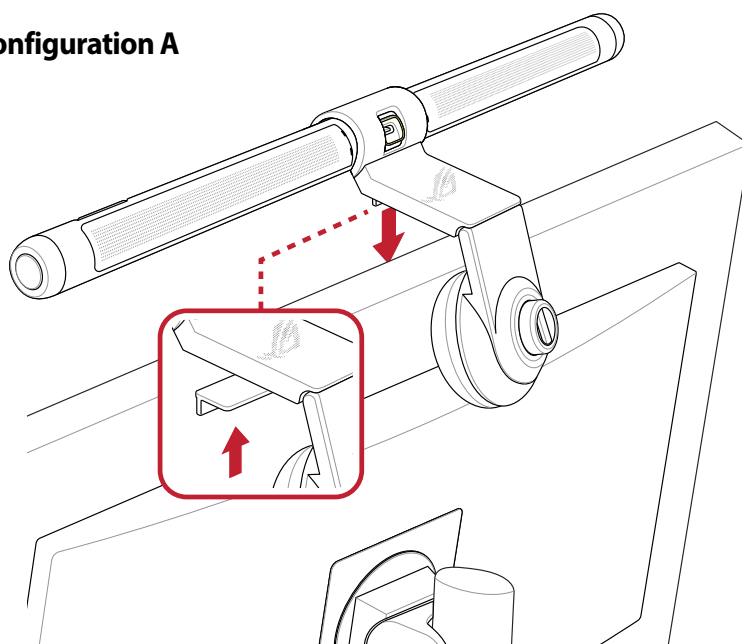

B

**Clamp configuration B**

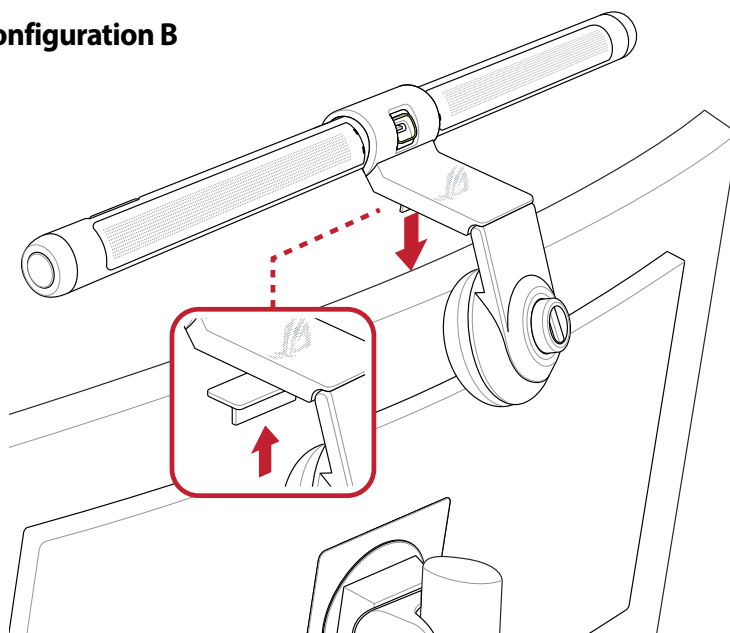

3

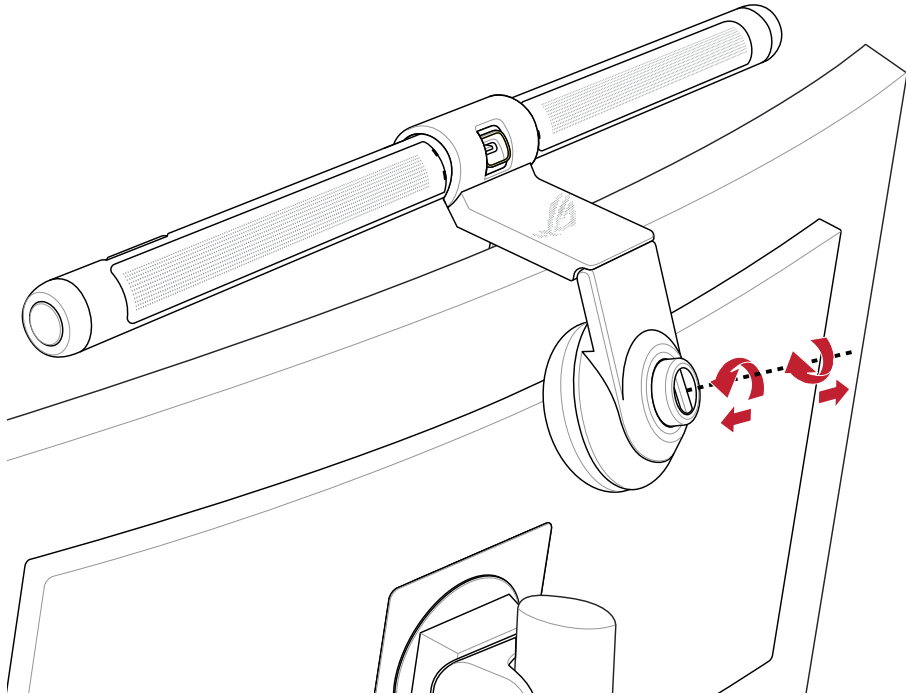

4

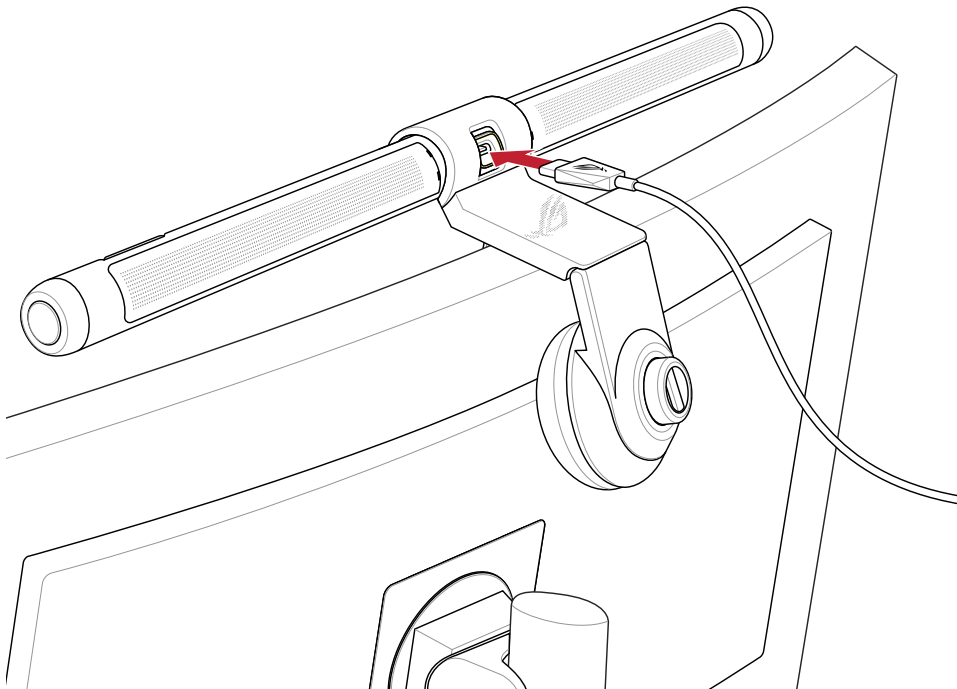



ASUS DisplayWidget Center

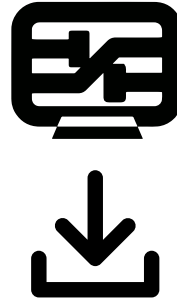

ASUS DisplayWidget Center



## **Maintenance and Troubleshooting**

- First turn off the ROG Aura Monitor Light Bar and disconnect the USB power cord. When cleaning the ROG Aura Monitor Light Bar, wipe using a soft, lint-free cloth, lightly moistened with a mild detergent solvent. Do not use alcohol or any other chemical solvents like kerosene, naphtha and so on, as the ROG Aura Monitor Light Bar's casing may become damaged.
- Do not rinse the ROG Aura Monitor Light Bar or any of its components directly with water.
- If the ROG Aura Monitor Light Bar does not turn on, check to make that the USB power cable is properly connected to the USB port.
- The Power LED indicator will flash when the power supply of the ROG Aura Monitor Light Bar is insufficient (less than 5V). When this happens, connect the ROG Aura Monitor Light Bar to another USB port that provides 5V output voltage.
- If the problem persists, please contact the place of purchase for help.
- Suitability for indoors use only.
- The light source of this luminaire is not replaceable; when the light source reaches its end of life the whole luminaire should be replaced.

## **Notices**

### **Product information for EU Energy Label**

This product contains a light source of energy efficiency class G.

