

# Quick Installation Guide

Indoor/Outdoor Access Point

Note: This guide uses EAP650 D120-Outdoor for demonstration. Images may differ from your actual product.

© 2025 TP-Link 7106511969 REV1.0.1

## 1 Overview

### Package Contents



EAP



Screw  
(For securing the  
grounding wire)



Installation Guide

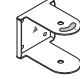

EAP Bracket



Mounting Bracket



Hose Clamps



Plastic  
Wall Anchors



Self-tapping  
Screws



Hex Socket Bolts



L-shaped  
Hex Screwdriver



Spiral Cover

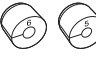

Φ6 / Φ5 Seals  
(for shielded / unshielded cables)

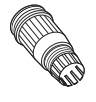

Bracket



O-Ring

## Panel Layout

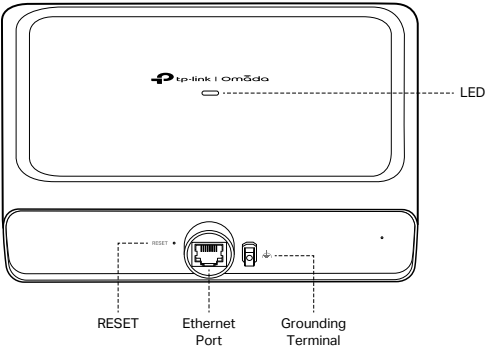

## SYS LED Explanation

LED Status	Indication
Flashes green twice	Initialization is completed.
Solid green	The device is initializing or working properly.
Flashing orange	System errors. RAM, Flash, Ethernet, WLAN or firmware may be malfunctioning.
Slowly flashing orange, green	Firmware update is in progress. Do not disconnect or power off the device.
Quickly flashing green	Locate the device.
Quickly flashing orange, green	The device is being reset to its factory default settings.
Slowly flashing green	The device is in an isolated state.

## 2 Lightning and ESD Protection

Proper grounding is extremely important for outdoor devices.

To reduce the damage of potential lightning and ESD attacks, connect the EAP's grounding terminal to grounding facilities using a proper grounding wire, which should meet local installation requirements. Secure the grounding wire to the grounding terminal with the provided screw.

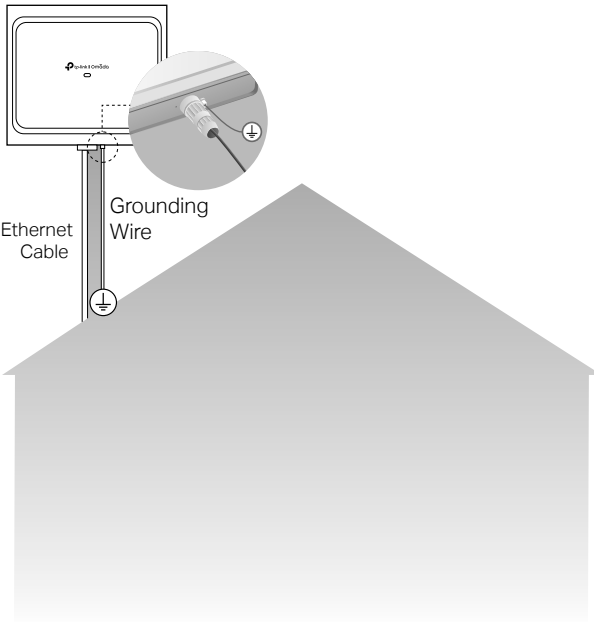

## 3 Orientation

With built-in directional antennas, the EAP provides sector-shaped network coverage. Install the EAP with the front facing the target area. For antenna details, refer to the product specifications or datasheet on our official website.

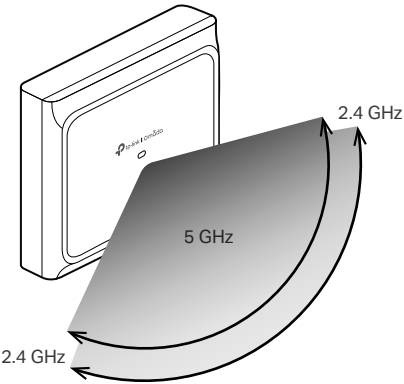

## 4 Mount the AP

### Option 1: Pole Mounting

**Step 1:**  
Secure the EAP bracket to the back of the EAP with the provided hex socket bolts.

**Step 2:**  
Secure the mounting bracket to the pole with the provided hose clamps.

**Step 3:**  
Remove the bolt in the middle of the mounting bracket, connect the EAP bracket to the mounting bracket, then screw the bolt back.

**Step 4:**  
Rotate the EAP horizontally to adjust its orientation.

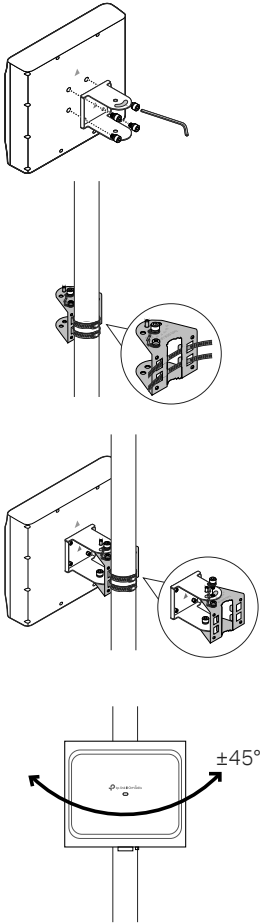

### Option 2: Wall Mounting

**Step 1:**  
Secure the EAP bracket to the back of the EAP with the provided hex socket bolts.

**Step 2:**  
Place the mounting bracket in the correct position. Mark positions for the screw holes.  
Drill holes at the marked positions.

**Step 3:**  
Secure the mounting bracket to the wall with the provided plastic wall anchors and self-tapping screws.

**Step 4:**  
Remove the bolt in the middle of the mounting bracket, connect the EAP bracket to the mounting bracket, then screw the bolt back.

**Step 5:**  
Rotate the EAP horizontally to adjust its orientation.

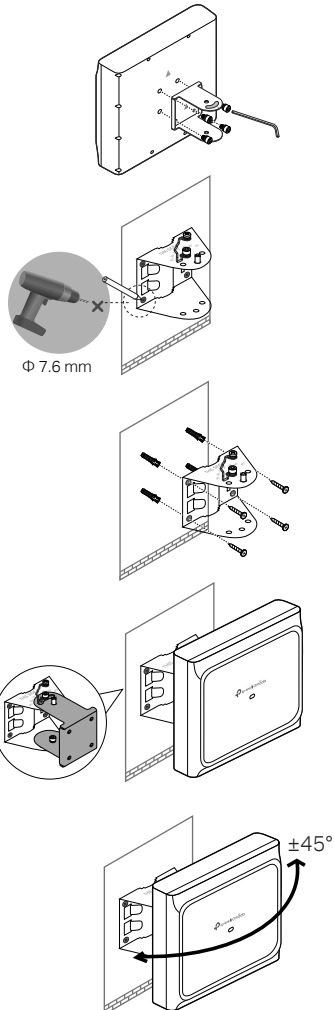

### More Mounting Options

• **Optional AP Mount Accessories**  
For additional rotation options, you can purchase optional AP mount accessories as needed. For more info, go to <https://www.tp-link.com/business-networking/omada-accessory-ap-accessory/>

• **Compatible Fixing/Mounting Adapters**  
For additional installation options (such as boom installation), you can prepare fixing/mounting adapters that are compatible with the following interfaces for installation:  
The interface on the back of the product (fixed with M5 screws):

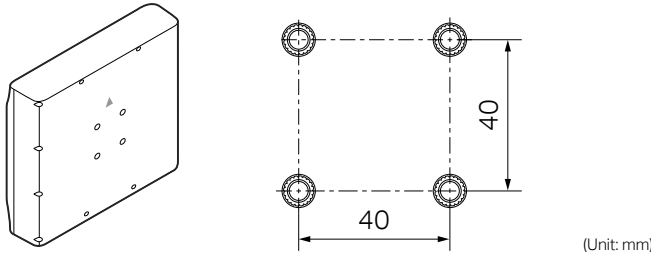

The interface on the mounting bracket:

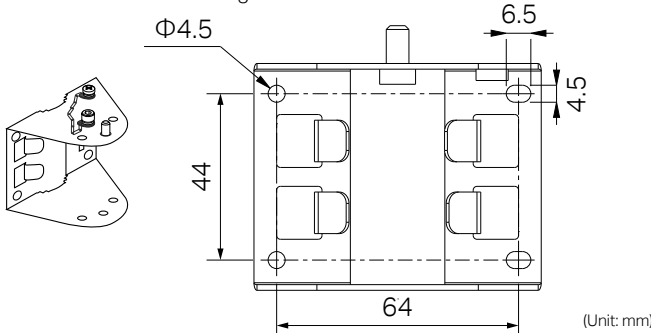

5 Connect the Cable

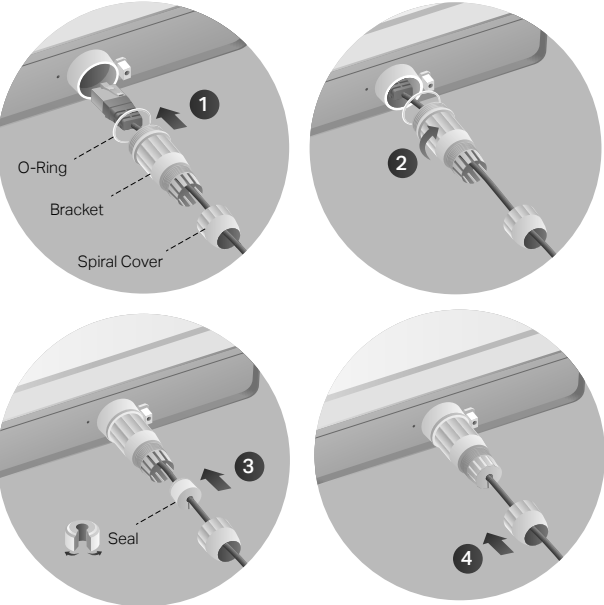

- 1 Fit an Ethernet cable through the Spiral Cover, Bracket, and O-Ring, and connect the cable to the port.
- 2 Fit the O-Ring to the head of the Bracket and screw the Bracket to the body of the device.  
**Note:** Don't warp the O-Ring.
- 3 Fit the Ethernet cable through the Seal's slit with the thinner side towards the Bracket, and plug the seal to the Bracket.  
**Note:** To ensure waterproofing, choose the proper Seal according to the type and diameter of the Ethernet cable.
- 4 Screw the Spiral Cover to the Bracket.

Method 2: Controller Mode

Omada Controller integrates Omada gateways/routers, switches, access points, and more for centralized management.

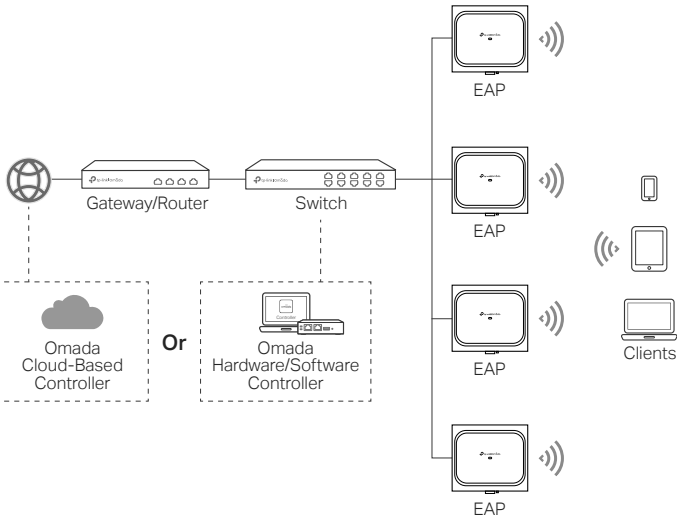

- Notes:
- A DHCP server (typically a gateway/router with the DHCP function enabled) is required to assign IP addresses to the EAPs and clients in your local network.
  - The Omada Controller must have network access to your Omada devices (the gateways/routers, switches, and EAPs) in order to find, adopt, and manage them.

6 Power On

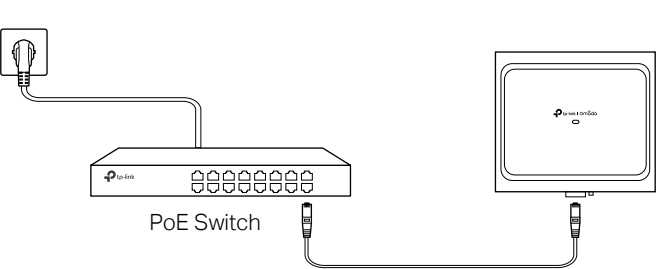

7 Software Configuration

Choose a method to set up your EAPs:

- Method 1: Standalone Mode**  
Configure and manage EAPs separately (Convenient for a small network with only a few devices)
- Method 2: Controller Mode**  
Configure and manage EAPs in batches on a central platform, namely the Omada Controller.

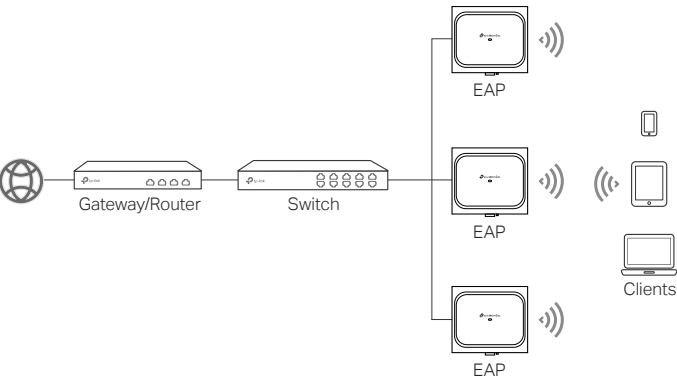

Method 1: Standalone Mode

If your network has only a few devices, you can configure and manage EAPs separately on their standalone pages.



- Notes:
- Before you start, be sure to power up and connect your devices according to the topology figure.
  - A DHCP server (typically a gateway/router with the DHCP function enabled) is required to assign IP addresses to the EAPs and clients in your local network.

Via Omada App

- Download and install the TP-Link Omada App from App Store or Google Play.  
 or    
Scan for Omada Omada
- Add the Controller via local access or cloud access.
  - Option 1: Local Access**  
**Note:** Local access applies to the On-Premises Hardware/Software Controller.
    - Connect your mobile device to the EAP by using the default SSIDs printed on the product.
    - Launch the Omada App and go to the **Controller Mode** page. Tap the + button in the upper-right corner to add your On-Premises Controller.
  - Option 2: Cloud Access**
    - Launch the Omada App and log in with your TP-Link ID.
    - Go to the **Controller Mode** page. A list of Controllers that have been bound with your TP-Link ID will appear.
- Launch the Controller, access your site, and go to the **Devices** page.
- Now you can adopt and manage the EAPs.



The Omada App is designed to help you quickly configure common settings. If you want to configure advanced settings, use the web page of your Controller.

Via Web Browser

**Note:** The EAP web page is inaccessible while the EAP is managed by a Controller.

- Connect your device to the EAP by using the default SSIDs printed on the product.
- Launch a web browser and enter <https://tplinkeap.net> in the address bar. Use **admin** for both Username and Password to log in.  

- Set up a new Username and Password for secure management. Then you can configure the AP.

Via Omada App

- Download and install the TP-Link Omada App from App Store or Google Play.  
 or    
Scan for Omada Omada
- Connect your mobile device to the EAP by using the default SSIDs printed on the product.
- Launch the Omada App, go to the **Standalone Mode** page, and wait for the EAP to appear. Tap on the EAP to configure it.

The Omada App is designed to help you quickly configure common settings. If you want to configure advanced settings, use the web page of your EAP.



Safety Information

- Keep the device away from fire or hot environments. DO NOT immerse in water or any other liquid.
- Do not attempt to disassemble, repair, or modify the device. If you need service, please contact us.
- Do not use the device where wireless devices are not allowed.
- This equipment can be powered only by equipments that comply with Power Source Class 2 (PS2) or Limited Power Source (LPS) defined in the standard of IEC 62368-1.

TP-Link hereby declares that the device is in compliance with the essential requirements and other relevant provisions of directives 2014/53/EU, 2011/65/EU and (EU)2015/863. The original EU Declaration of Conformity may be found at <https://www.tp-link.com/en/support/ce/>.

TP-Link hereby declares that the device is in compliance with the essential requirements and other relevant provisions of the Radio Equipment Regulations 2017. The original UK Declaration of Conformity may be found at <https://www.tp-link.com/support/ukca/>

**Attention:** In EU member states, EFTA countries and Northern Ireland, the operation in the frequency range 5150MHz-5350MHz is only permitted indoors.

**Attention:** In Great Britain, the operation in the frequency range 5150MHz - 5350MHz is only permitted indoors.

For EAP Controller, go to the **Devices** page and select the desired EAP to specify the channel.

For web browser, go to **Wireless > Wireless Settings** to specify the channel.

	AT	BE	BG	CH	CY	CZ	DE	DK
	EE	EL	ES	FI	FR	HR	HU	IE
	IS	IT	LI	LT	LU	LV	MT	NL
	NO	PL	PT	RO	SE	SI	SK	UK(NI)
	UK							

For detailed configurations, refer to the user guides of the controller and EAPs. The guides can be found on the download center of our official website: <https://www.tp-link.com/support/download/?type=smb>

To ask questions, find answers, and communicate with TP-Link users or engineers, please visit <https://community.tp-link.com/business> to join the TP-Link Community.

For technical support, user guides, and other information, please visit <https://www.tp-link.com/support/?type=smb>, or simply scan the QR code.

