

Original Floorstanding +  
Brother Printer Mount

Assembly Instructions

Tools Required:

- Socket Driver
- 10mm Spanner \*for adjustable spanner

Sheet Code: BP-IM-057\_REV3  
Release Date: 14/05/2025

Copyright 2025 SpotSpot Ltd. (T/A Bouncepad) all rights reserved.  
Confidential, no part of this publication may be reproduced or transmitted in any form without the written permission of the copyright holder.

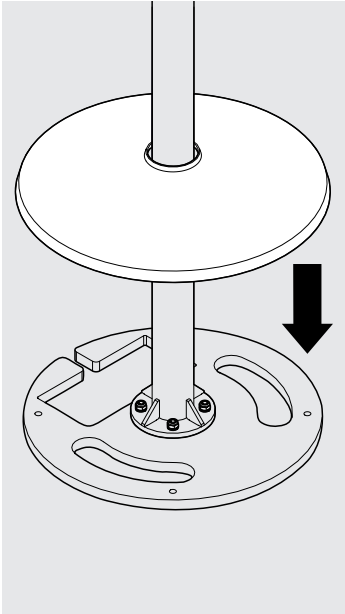
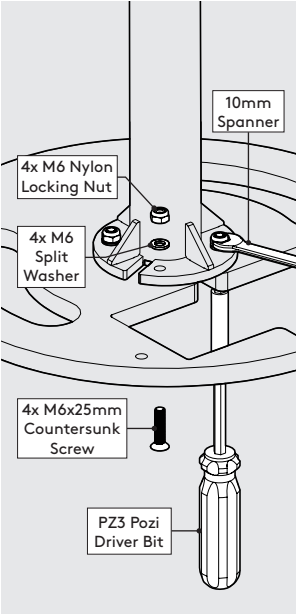
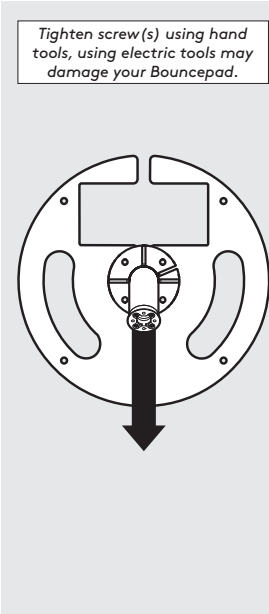
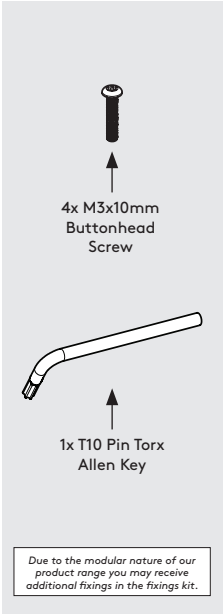
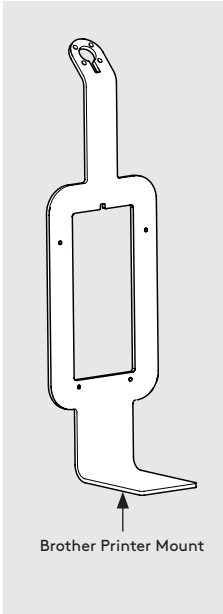
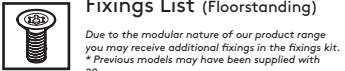
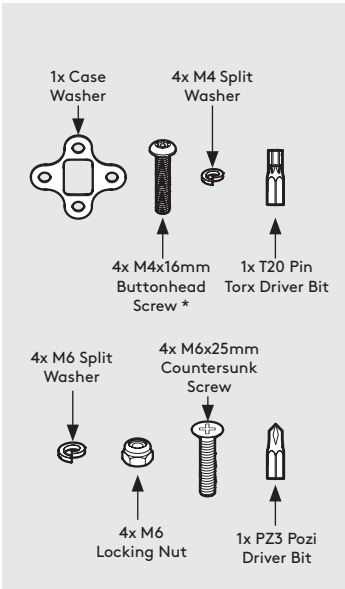
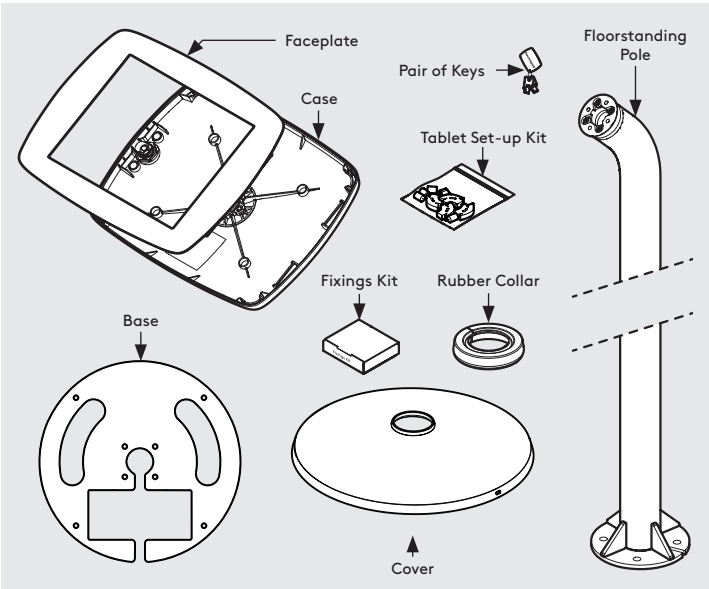

1 Orientate, locate & secure the Floorstanding Pole to the Base as shown. Ensure that all fixings are installed correctly.

2 Locate the Cover over the Floorstanding Pole.

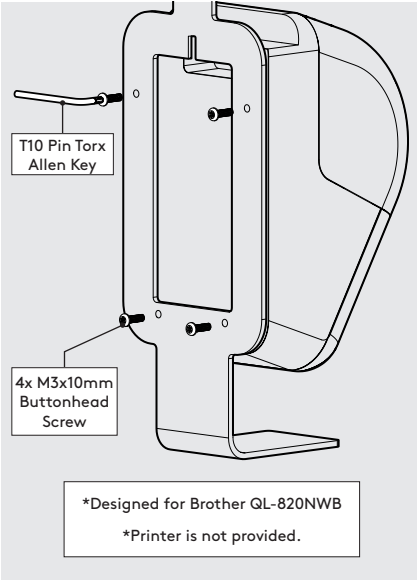
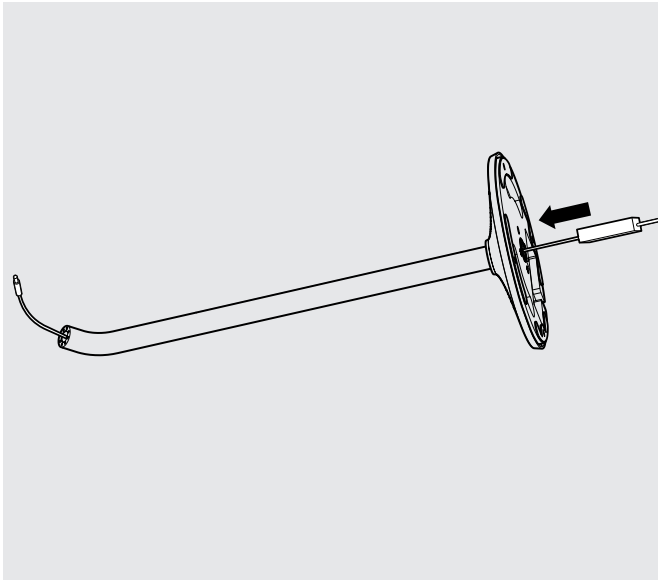
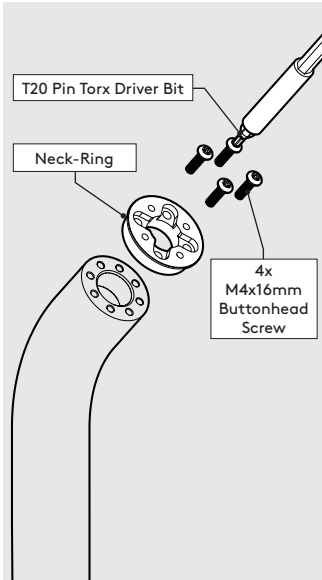

3 Remove Neck-Ring using T20 driver bit & Socket Driver.

4 Feed the Printer's Power Cable through the Floorstanding Pole.

5 Attach the Printer to the Printer Mount using M3x10mm Screws

\*Designed for Brother QL-820NWB  
\*Printer is not provided.

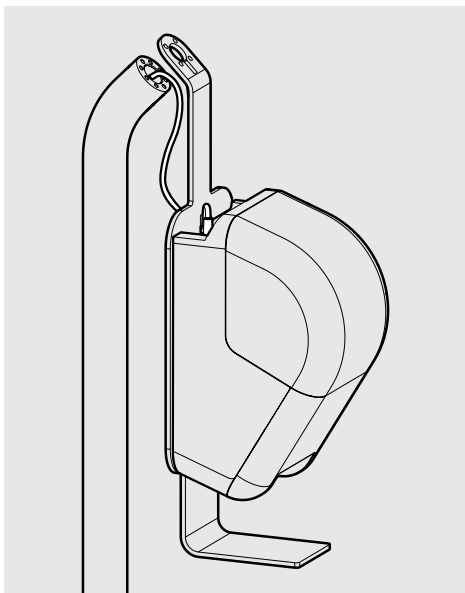

6

Feed Printer's Power Cable through Printer Mount & plug into the Printer.

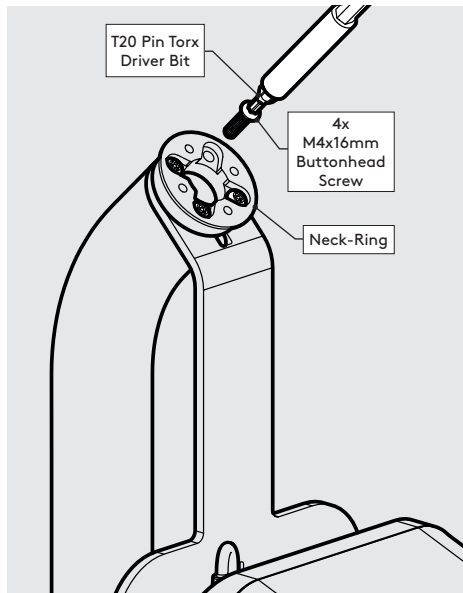

7

Re-attach Neck-Ring using the same Fixings.

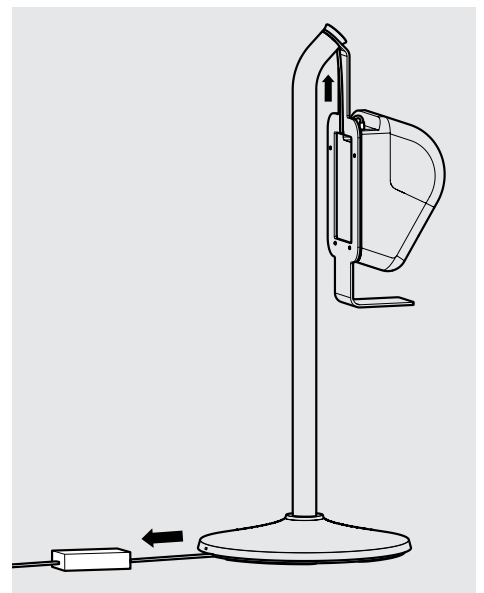

8

Pull Printer's Power Cable back to remove any slack near the Printer Mount.

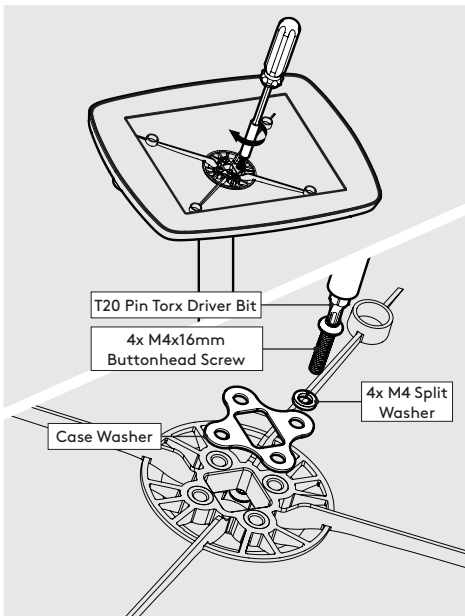

9

Locate & secure the Case onto the Floorstanding Pole as shown. Tighten by hand.

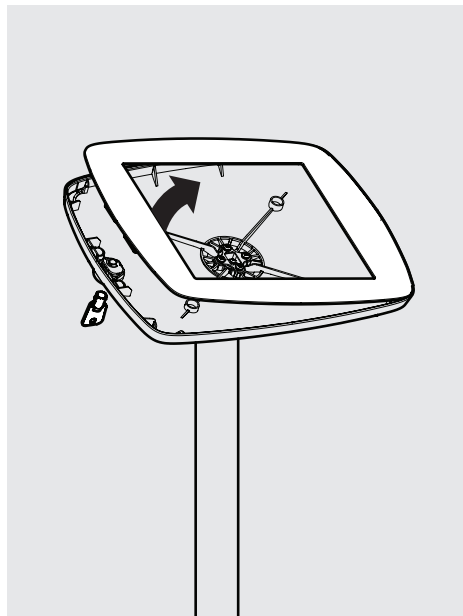

10

Unlock & remove the Faceplate from the Case.

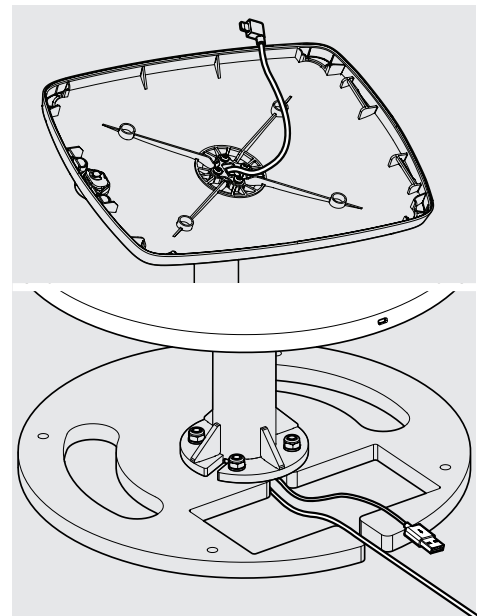

11

Feed the Tablet's Power Cable through the Case & Floorstanding Pole.

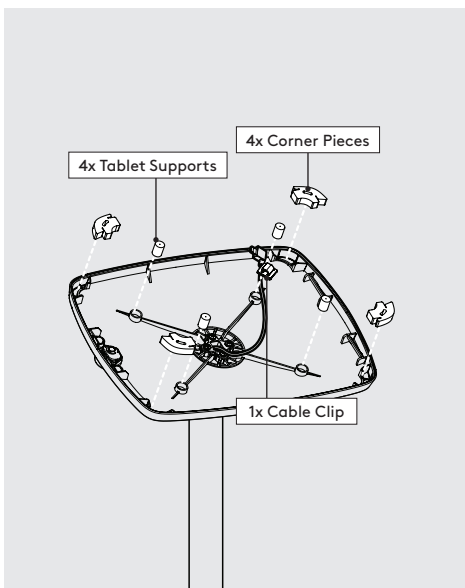

12

Install the Tablet Setup Kit. Each kit is specific per Tablet & Case.

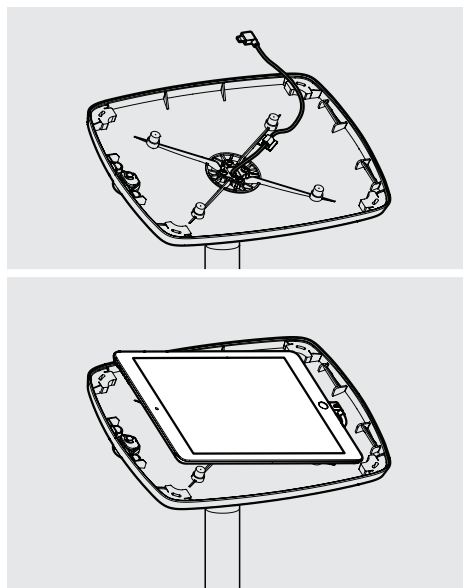

13

Install the Tablet into the Case & connect to Power Cable.

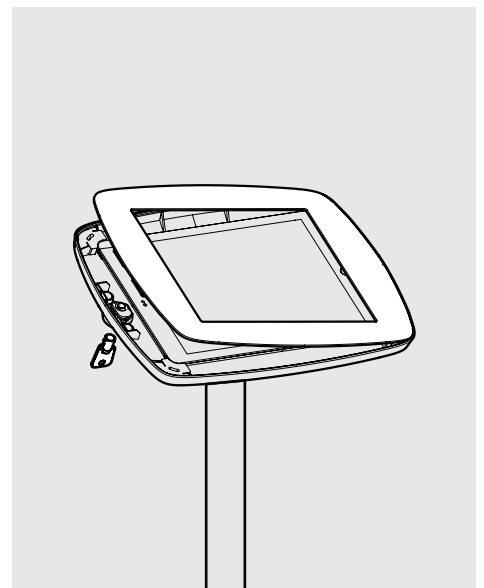

14

Locate and lock the Faceplate onto the Case.

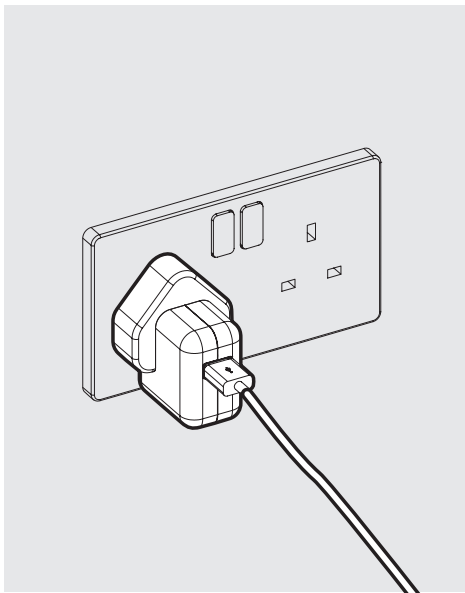

**15.1** Connect the Power Cables to a mains power source.

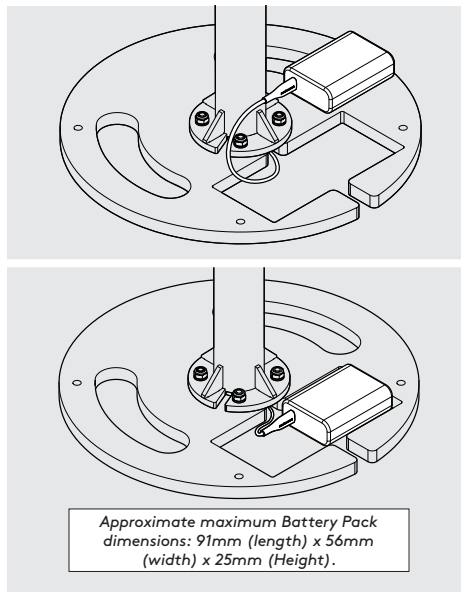

**15.2** If installing a Battery Pack, connect the Tablet's Power Cable & locate into the Base.

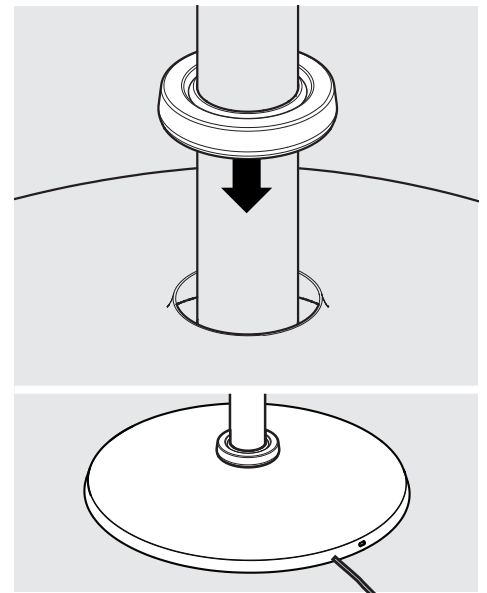

**16** With the Cover on the ground, locate and fit the Rubber Collar.

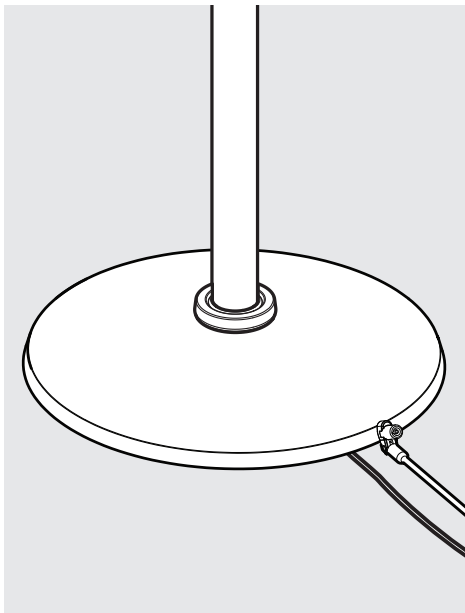

**17** Use a Kensington® Microsaver product to tether to a secure object. (refer to your Kensington® instructions for full details)

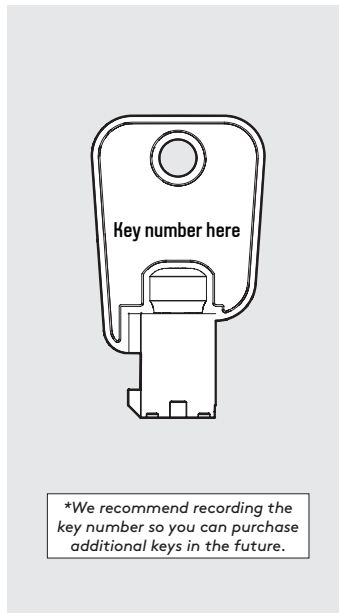

**18** Installation is now complete.

## Branding Mount

### Assembly Instructions

Follow these instructions for the successful assembly of your Branding board to your Floorstanding.

Sheet Code: BP-OR-IM-011\_REV2  
Release Date: 01/04/2019

Copyright 2016 Spotsport Ltd. (T/A Bouncepad) all rights reserved. Confidential, no part of this publication may be reproduced or transmitted in any form without the written permission of the copyright holder.

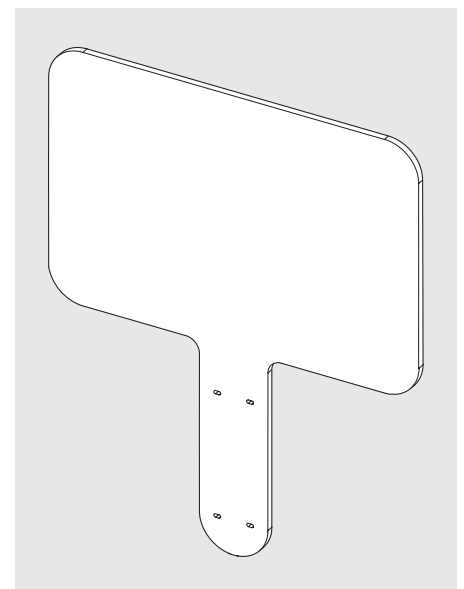
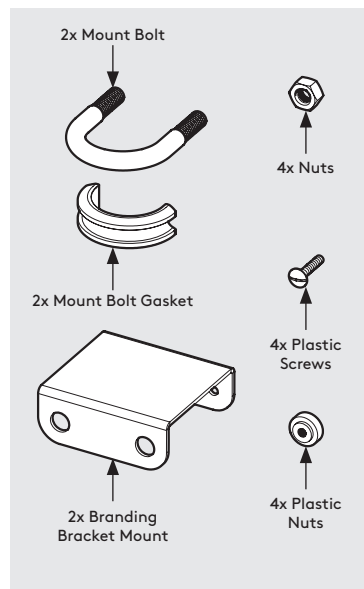
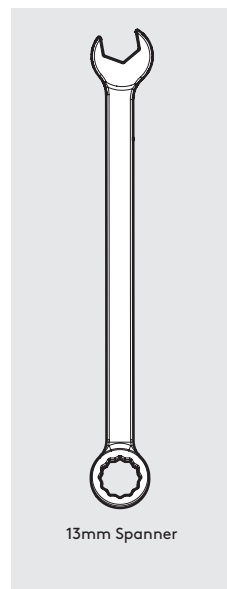

0

Tools required

0

Branding Mount - In the Box

A1

Follow 'A' steps if installing a Placard board

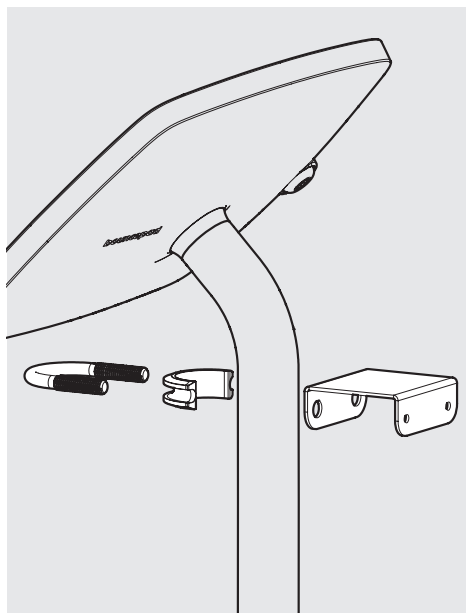

A2

Locate the top Bracket Mount & Mount Bolt to Floorstanding pole.

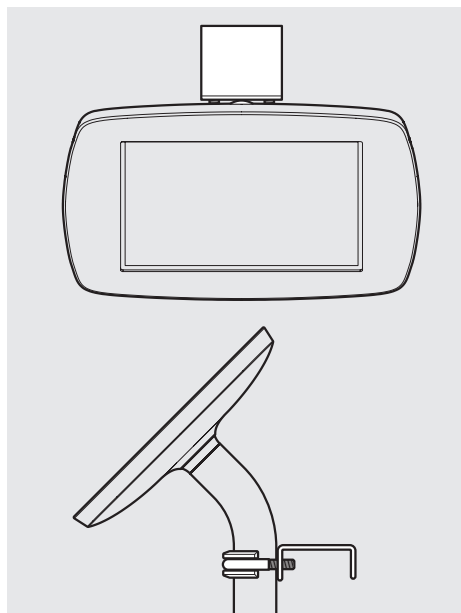

A3

Ensure that the Bracket Mount & Mount Bolt are positioned correctly as shown.

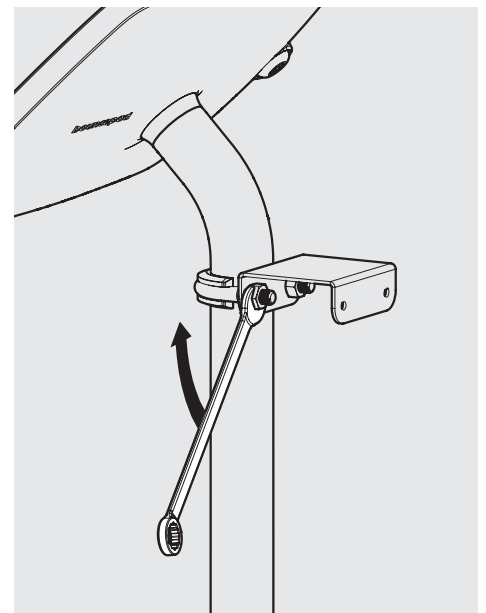

A4

Secure the Bracket Mount & Mount Bolt to the Floorstanding Pole with the supplied Nuts. Tighten evenly.

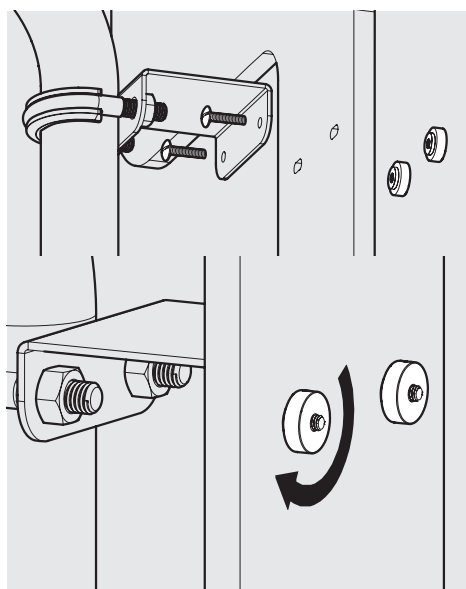

A5

Locate the Placard Board to the Bracket Mount. Secure with the supplied Plastic Screws & Nuts.

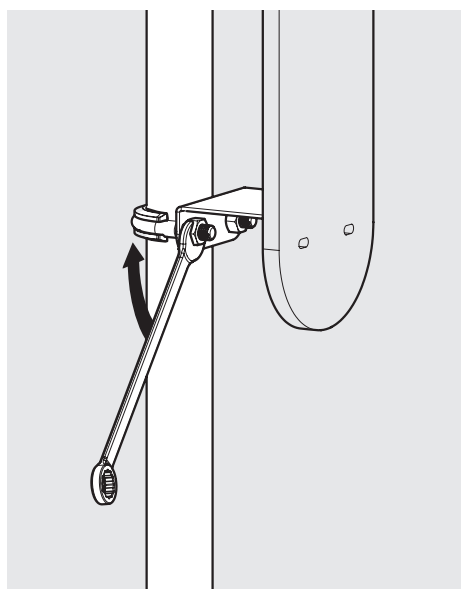

A6

Locate & secure the bottom Bracket Mount & Mount Bolt. Tighten the nuts evenly.

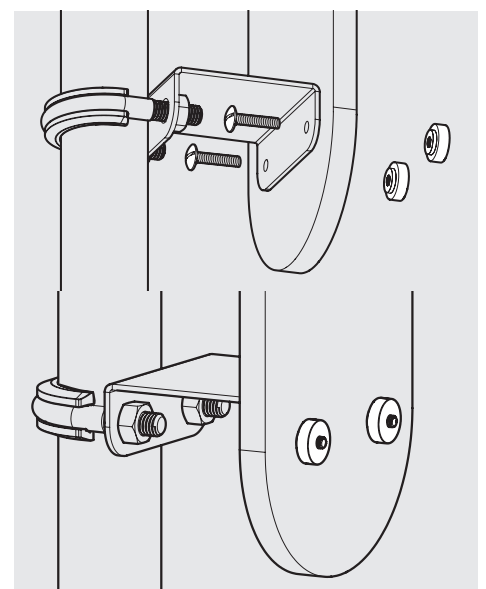

A7

Secure the bottom section of the Placard Board with the Plastic Screws & Nuts. Installation now complete.

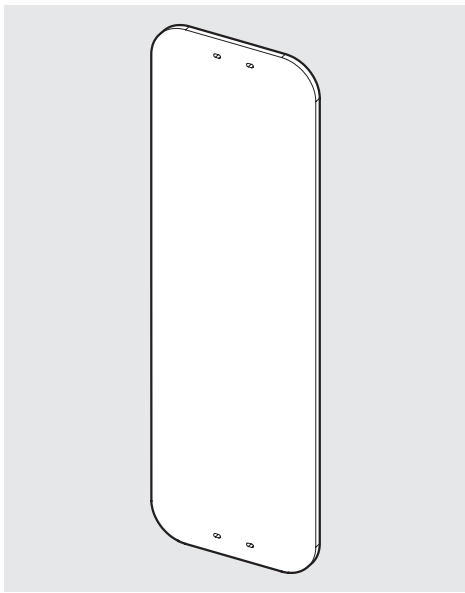

**B1** Follow 'B' if installing a Front Board

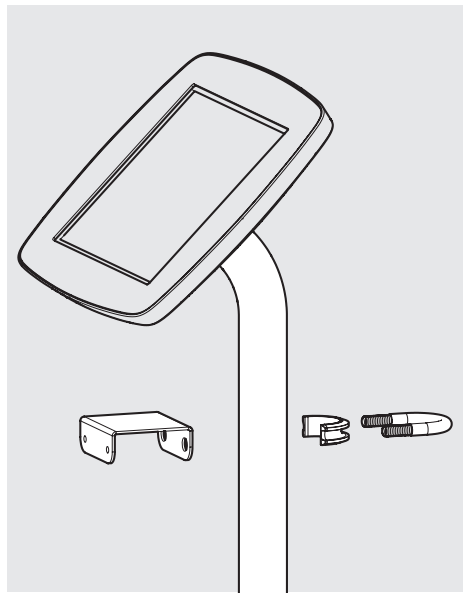

**B2** Locate the top Bracket Mount & Mount Bolt to the Floorstanding pole.

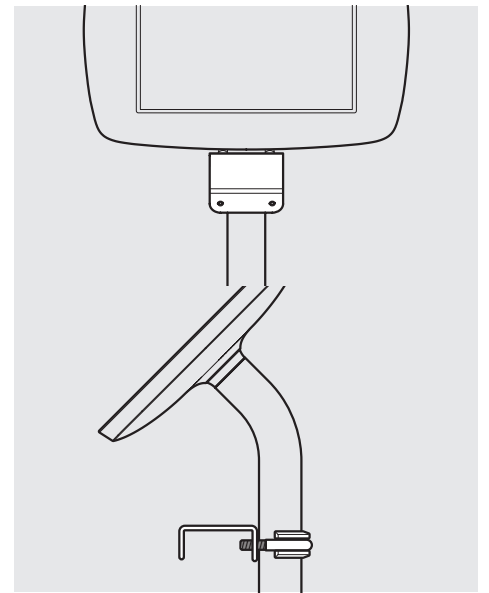

**B3** Ensure the Bracket Mount & Mount Bolt are positioned correctly as shown.

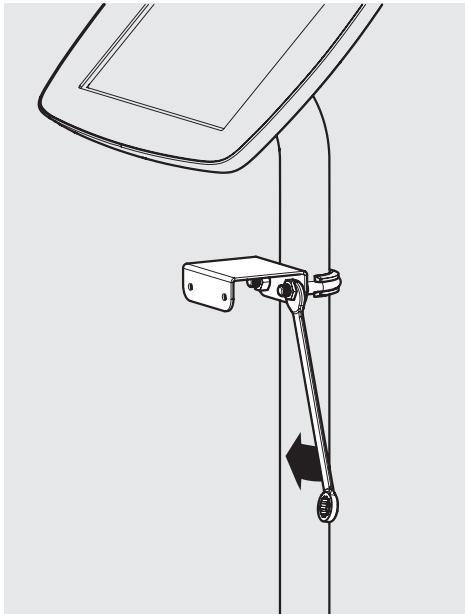

**B4** Secure the Bracket Mount & Mount Bolt to the Floorstanding Pole with the supplied Nuts. Tighten evenly.

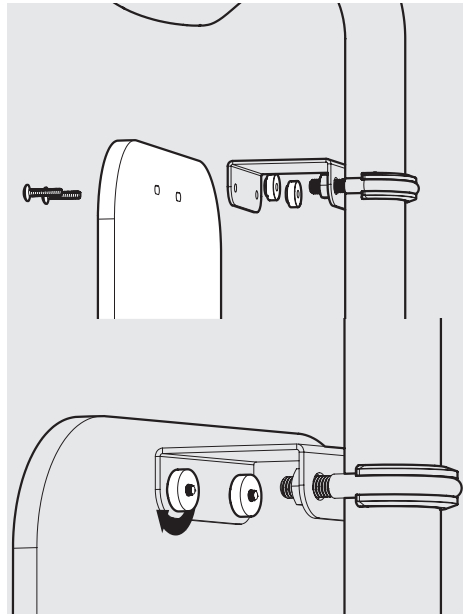

**B5** Locate the Front Board to the Bracket Mount. Secure with the supplied Plastic Screws & Nuts.

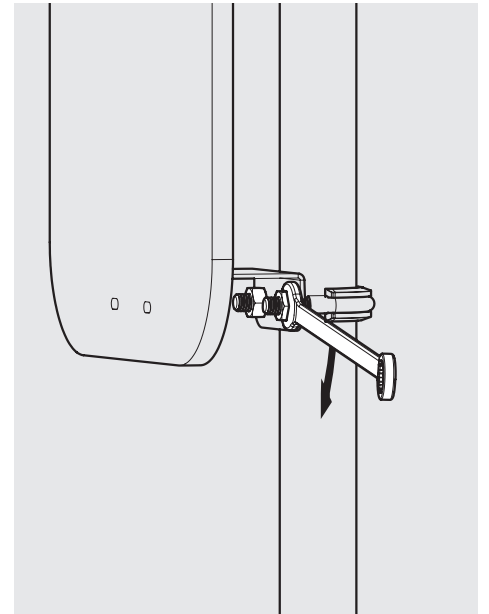

**B6** Locate & secure the bottom Bracket Mount & Mount Bolt. Tighten the nuts evenly.

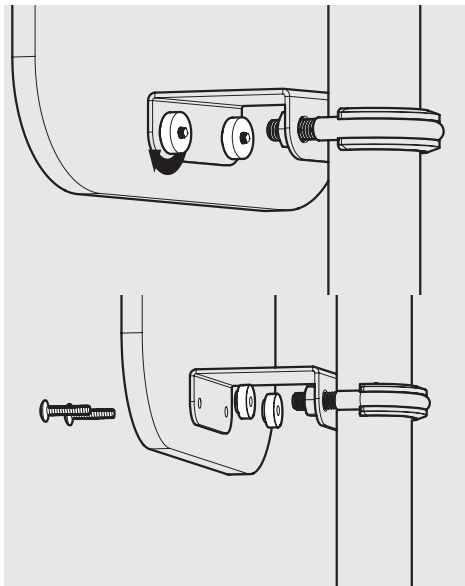

**B7** Secure the bottom section of the Front Board with the Plastic Screws & Nuts. Installation now complete.