

Dell 22 Monitor

SE2225HM

User's Guide

Notes, cautions, and warnings

 **NOTE:** A NOTE indicates important information that helps you make better use of your product.

 **CAUTION:** A CAUTION indicates either potential damage to hardware or loss of data and tells you how to avoid the problem.

 **WARNING:** A WARNING indicates a potential for property damage, personal injury, or death.

Contents

Safety instructions	5
About your monitor	6
Package contents	6
Product features	7
Operating system compatibility	10
Identifying parts and controls	10
Front view	10
Back view	11
Side view	12
Bottom view, without monitor stand	12
Monitor specifications	13
Resolution specifications	14
Supported video modes	14
Preset display modes	14
Electrical specifications	15
Physical characteristics	16
Environmental characteristics	17
Pin assignments	18
HDMI port	18
VGA port	19
Plug-and-play capability	20
LCD monitor quality and pixel policy	20
Ergonomics	21
Handling and moving your display	22
Maintenance guidelines	23
Cleaning your monitor	23
Setting up the monitor	24
Connecting the stand	24
Connecting your monitor	26
Connecting HDMI cable	26
Connecting VGA cable	26
Securing your monitor using Kensington lock (optional)	27
Removing the monitor stand	28
VESA wall Mounting (optional)	29
Using tilt	29
Operating your monitor	30
Turning on the monitor	30
Using the front panel controls	30
Using the OSD lock function	31
Using the On-Screen Display (OSD) menu	32
Accessing the OSD menu	32
OSD warning messages	37
Setting the maximum resolution	38
Troubleshooting	39
Self-test	39

Built-in diagnostics.....	40
Common problems	41
Product-specific problems.....	42
Regulatory information	43
Contacting Dell.....	44

Safety instructions

Use the following safety guidelines to protect your monitor from potential damage and to ensure your personal safety. Unless otherwise noted, each procedure included in this document assumes that you have read the safety information that shipped with your monitor.

 **NOTE:** Before using the monitor, read the safety information that is shipped with your monitor and printed on the product. Keep the documentation at a secure location for future reference.

 **WARNING:** Use of controls, adjustments, or procedures other than those specified in this documentation may result in exposure to shock, electrical hazards and/or mechanical hazards.

 **CAUTION:** The possible long-term effect of listening to audio at high volume through the headphones (on monitor that support it) may damage your hearing ability.

- Place the monitor on a solid surface and handle it carefully.
 - The screen is fragile and can be damaged if dropped or hit with a sharp object.
 - Ensure that your monitor is electrically rated to operate with the AC power available in your location.
 - Keep the monitor in room temperature. Excessive cold or hot conditions can have an adverse effect on the liquid crystal of the display.
 - Connect the power cable from the monitor to a wall outlet that is near and accessible. See [Connecting your monitor](#).
- Do not place and use the monitor on a wet surface or near water.
- Do not subject the monitor to severe vibration or high impact conditions. For example, do not place the monitor inside a car trunk.
- Unplug the monitor when it is going to be left unused for an extended period.
- To avoid electric shock, do not attempt to remove any cover or touch the inside of the monitor.
- Read these instructions carefully. Keep this document for future reference. Follow all warnings and instructions that are marked on product.
- Certain monitors can be wall mounted using the VESA mount that is sold separately. Ensure to use the correct VESA specifications as mentioned in the wall mounting section of the User's Guide.

For information about safety instructions, see the *Safety, Environmental and Regulatory Information (SERI)* document that is shipped with your monitor.







About your monitor

Package contents

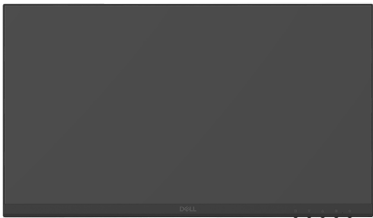
The following table provides the list of components that are shipped with your monitor. If any component is missing, contact Dell. For more information, see [Contacting Dell](#).

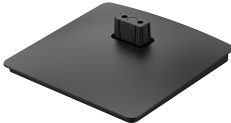
- NOTE:** Some items may be optional and may not ship with your monitor. Some features may not be available in certain countries.
- NOTE:** To set up the stand from any other source, see the documentation which comes with the stand for instruction.

Table 1. Monitor components and descriptions.

Component image	Component description
	Monitor
	Stand riser
	Stand base
	Power cable (varies by country or region)
	HDMI cable (1.80 m)
	QR card Safety, Environmental, and Regulatory Information

Product features

The **Dell SE2225HM** flat panel monitor has an active matrix, Thin-Film Transistor (TFT), Liquid Crystal Display (LCD) panel with LED backlight. The monitor features include:

- 544.9 mm (21.5 in.) viewable area display (measured diagonally).
 - 1920 x 1080 resolution, with full-screen support for lower resolutions.
 - Supports a refresh rate of 100 Hz.
 - Wide viewing angle of 178 degrees in vertical and horizontal directions.
 - Contrast ratio (3000:1).
 - Digital connectivity with HDMI port.
 - Plug-and-play capable if supported by your computer.
 - On-Screen Display (OSD) adjustments for easy setup and screen optimization.
 - ≤ 0.3 W in Standby mode.
 - Optimize eye comfort with a flicker-free screen.
 - Security-lock slot.
 - RoHS compliant.
 - BFR/PVC-Reduced (Its circuit boards are made from BFR/PVC-free laminates).
 - Energy Star certified.
 - Dell ComfortView Plus is an integrated low blue light screen feature that improves eye comfort by reducing potentially harmful blue light emissions without compromising color. Through ComfortView Plus technology, Dell has reduced harmful blue light exposure from 50% to 35%.
 - This monitor is certified with TÜV Rheinland Eye Comfort 3.0 with a 3-star rating. It incorporates key technologies that also deliver a flicker-free screen, up to 100 Hz refresh rate, a color gamut of minimum 72% NTSC. Dell ComfortView Plus feature is enabled by default on your monitor.
 - This monitor uses a low blue light panel. When the monitor is reset to factory settings or default setting, it is in compliance with TÜV Rheinland's hardware low blue light certification.*
- *This monitor is in compliance with TÜV Rheinland hardware low blue light certification under Category 3.

Blue light ratio:

The ratio of light in the range from 415 nm-455 nm compared to 400 nm-500 nm must be less than 50%.

Table 2. Blue light ratio.

Category	Blue light ratio
1	< 20%
2	20% < R < 35%
3	35% < R < 50%

- Reduces the harmful blue light that is emitted from the screen, ensuring a more comfortable viewing experience for your eyes while maintaining accurate color representation.
- The monitor uses Flicker-Free technology to eliminate visible flicker, providing a more comfortable viewing experience and helps to prevent eye strain and fatigue.

About TÜV Rheinland Eye Comfort 3.0

TÜV Rheinland Eye Comfort 3.0 certification program presents a consumer-friendly star rating scheme to the display industry promoting eye wellness from safety to eye care. Compared to existing certifications, the 5-star-rating program adds rigorous testing requirements on overall eye care attributes such as low blue-light, flicker-free, refresh rate, color gamut, color accuracy and ambient light sensor performance. It lays out requirement metrics and rates the product performance on five levels, and the sophisticated technical assessment process provides consumers and buyers with indicators that are easier to judge.

The eye wellness factors being considered remain constant, however, the standards for the various star ratings are different. The higher the star rating, the more stringent the standards. The table below lists the major eye comfort requirements which apply in addition to the basic eye comfort requirements (such as pixel density, uniformity of luminance and color, and freedom of movement).

For more information around **TÜV Eye Comfort certification** please see <https://www.tuv.com/world/en/eye-comfort.html>



Table 3. Eye Comfort 3.0 requirements

Eye Comfort 3.0 requirements and star rating scheme for monitors				
Category	Test item	Star rating scheme		
		3-star	4-star	5-star
Eye Care	Low Blue Light	TÜV Hardware LBL Category III ($\leq 50\%$) or Software LBL solution ¹	TÜV Hardware LBL Category II ($\leq 35\%$) or Category I ($\leq 20\%$)	TÜV Hardware LBL Category II ($\leq 35\%$) or Category I ($\leq 20\%$)
	Flicker Free	TÜV Flicker Reduced or TÜV Flicker Free	TÜV Flicker Reduced or TÜV Flicker Free	Flicker Free
Ambient Light Management	Ambient Light Sensor performance	No sensor	No sensor	Ambient light sensor
	Intelligent CCT control	No	No	Yes
	Intelligent Luminance control	No	No	Yes
Image quality	Refresh Rate	>60 Hz	>75 Hz	>120 Hz
	Luminance uniformity	Luminance uniformity $\geq 75\%$		
	Color Uniformity	Color uniformity $\Delta u'v' \leq 0.02$		
	Freedom of movement	Luminance changes shall decrease less than 50%; The color shift shall be less than 0.01.		
	Gamma difference	Gamma difference $\leq \pm 0.2$	Gamma difference $\leq \pm 0.2$	Gamma difference $\leq \pm 0.2$
	Wide color gamut ²	NTSC ³ Min.72% (CIE 1931) or sRGB ⁴ Min.95% (CIE 1931)	sRGB ⁴ Min.95% (CIE 1931)	DCI-P3 ⁵ Min.95% (CIE 1976) & sRGB ⁴ Min.95% (CIE 1931) or Adobe RGB ⁶ Min.95% (CIE 1931) & sRGB ⁴ Min.95% (CIE 1931)
Eye Comfort User Guide	User guide	Yes	Yes	Yes
Remark	¹ Software controls the blue light emission by reducing excessive blue light, resulting in a more yellow tone. ² Color gamut describes the availability of colors in the display. Various standards were developed for specific purposes. 100% corresponds to the full color space as defined in the standard. ³ NTSC stands for National Television Standards Committee, which developed a color space for the television system that is used in the United States. ⁴ sRGB is a standard red, green, and blue color space that is in use on monitors, printers, and the World Wide Web. ⁵ DCI-P3, short for Digital Cinema Initiatives - Protocol 3, is a color space used in digital cinema that encompasses a wider range of colors than the standard RGB color space. ⁶ Adobe RGB is a color space created by Adobe Systems that encompasses a broader range of colors than the standard RGB color model, particularly in the cyans and greens.			

Operating system compatibility

- Windows 10, Windows 11, and later versions*
*The operating system compatibility on Dell and Alienware branded monitors may vary based on factors such as:
- Specific release dates when operating system versions, patches, or updates are available.
- Specific release dates when Dell and Alienware branded monitor firmware, software application, or driver updates are available on the Dell support website.

Identifying parts and controls

Front view

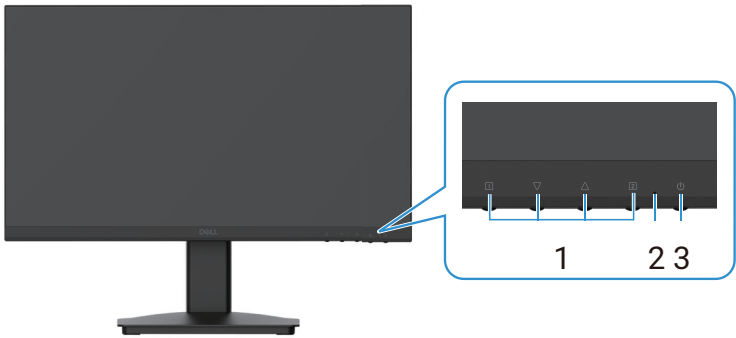

Figure 1. Front view of the monitor

Table 4. Front view of descriptions.

Label	Description	Use
1	Function buttons	To access the OSD menu and change the settings if required. For more information, see Using the front panel controls .
2	LED indicator	A solid blue light indicates that the monitor is turned on and functioning. A solid orange light indicates that the monitor is in Standby mode.
3	Power button	Press the power button to turn the monitor on or off.

Back view



Figure 2. Back view of the monitor

Table 5. Back view descriptions.

Label	Description	Use
1	Regulatory information	List the regulatory approvals.
2	Regulatory label (including MyDell QR code, serial number, and Service Tag label)	See this label if you must contact Dell for technical support. The Service Tag is a unique alphanumeric identifier that allows Dell service technicians to identify your monitor's specifications and access warranty information.
3	Stand release button	Release the stand from the monitor.
4	VESA mounting holes (100 mm x 100 mm)	Enables wall mounting the monitor using a VESA mount or arm.

Side view

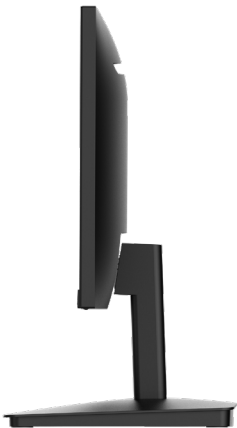

Figure 3. Side view of the monitor

Bottom view, without monitor stand

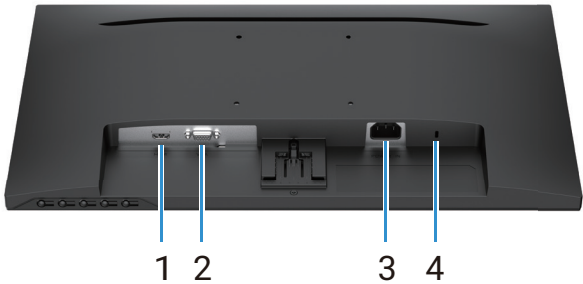

Figure 4. Bottom view of the monitor

Table 6. Bottom view of descriptions.

Label	Description	Use
1	HDMI port	Connect to your computer with the HDMI cable.
2	VGA port	Connect to your computer with the VGA cable.
3	Power port	To connect the monitor power cable.
4	Security-lock slot (based on Kensington Security Slot)	Secure your monitor using a security lock (purchased separately) to prevent unauthorized movement of your monitor. For more information, see Securing your monitor using Kensington lock (optional) .

Monitor specifications

Table 7. Monitor specifications.

Description	Value
Screen type	Active matrix-TFT LCD
Panel type	Vertical Alignment (VA) Technology
Viewable area	
Diagonal	544.9 mm (21.5 in.)
Active area	
Horizontal	478.66 mm (18.84 in.)
Vertical	260.28 mm (10.25 in.)
Area	124585 mm ² (193.11 in. ²)
Pixel pitch	
Horizontal	0.2493 mm
Vertical	0.2410 mm
Pixel per inch (PPI)	102
Viewing angle	
Horizontal	178° (typical)
Vertical	178° (typical)
Brightness	250 cd/m ² (typical)
Contrast ratio	3000:1 (typical)
Faceplate coating	Anti-glare with hard-coating 3H
Backlight	LED Edgelight System
Response time	
Normal mode	8 ms (gray to gray)
Fast mode	5 ms (gray to gray)
Color depth	16.70 million colors
Color gamut	NTSC 72% (CIE 1931) (minimum)
Connectivity	<ul style="list-style-type: none"> • 1 HDMI port (HDCP 1.4) (supports up to FHD 1920 x 1080, 100 Hz as per specified in HDMI 1.4) • 1 VGA port
Bezel width (edge of monitor to active area)	
Top	7.05 mm (0.28 in.)
Left/Right	7.05 mm (0.28 in.)
Bottom	18.49 mm (0.73 in.)
Security	Security lock slot (cable lock sold separately)
Tilt angle	-5°/+ 21°

Resolution specifications

Table 8. Resolution specifications.

Description	Value
Horizontal scan range	
HDMI	30 kHz to 111 kHz (automatic)
VGA	30 kHz to 82 kHz (automatic)
Vertical scan range	
HDMI	50 Hz to 100 Hz (automatic)
VGA	50 Hz to 76 Hz (automatic)
Maximum preset resolution	
HDMI	1920 x 1080 up to 100 Hz
VGA	1920 x 1080 up to 60 Hz

Supported video modes

Table 9. Supported video modes.

Description	Value
Video display capabilities (HDMI)	480p at 60 Hz 576p at 50 Hz 720p at 60 Hz 720p at 50 Hz 1080p at 50 Hz 1080p at 60 Hz

Preset display modes

Table 10. Timing table.

Display mode	Horizontal frequency (kHz)	Vertical frequency (Hz)	Pixel clock (MHz)	Sync polarity (Horizontal/Vertical)
DMT, 640 x 480	31.47	59.94	25.18	-/-
DMT, 640 x 480	37.50	75.00	31.50	-/-
DMT, 800 x 600	37.88	60.32	40.00	+/+
DMT, 800 x 600	46.88	75.00	49.50	+/+
DMT, 1024 x 768	48.36	60.00	65.00	-/-
DMT, 1024 x 768	60.02	75.00	78.75	+/+
DMT, 1152x864	67.50	75.00	108.00	+/+
CTA, 1280 x 720	45.00	59.94	74.25	-/+
CTA, 1280 x 720	56.46	74.78	95.75	-/+
DMT, 1280 x 1024	63.98	60.02	108.00	+/+
DMT, 1280 x 1024	79.98	75.03	135.00	+/+
DMT, 1600 x 900	60.00	60.00	108.00	+/+
CTA, 1920 x 1080	67.50	60.00	148.50	+/+
CTA, 1920 x 1080	83.89	75.00	174.50	+/+
CTA, 1920 x 1080 (Only HDMI)	110.00	100.00	228.80	+/+

Electrical specifications

Table 11. Electrical specifications.

Description	Value
Video input signals	<ul style="list-style-type: none">• Analog RGB: 0.7 V \pm 5 %, 75 Ω input impedance.• HDMI 1.4 (HDCP 1.4), 600 mV for each differential line, 100 Ω input impedance per differential pair.
AC input voltage/frequency/current	100 VAC to 240 VAC/50 Hz or 60 Hz \pm 3 Hz/1.0 A (maximum)
Inrush current	<ul style="list-style-type: none">• 120 V: 30 A (maximum) at 0°C (cold start)• 240 V: 60 A (maximum) at 0°C (cold start)
Power Consumption	<ul style="list-style-type: none">• 0.3 W (Off mode)¹• 0.3 W (Standby mode)¹• 11.7 W (On mode)¹• 20.7 W (Max)²• 12.1 W (P_{on})³• 37.76 kWh (TEC)³

¹ As defined in EU 2019/2021 and EU 2019/2013.

² Max brightness and contrast setting.

³ P_{on}: Power consumption of On Mode as defined in Energy Star 8.0 version.

TEC: Total energy consumption in kWh as defined in Energy Star 8.0 version.

This document is informational only and reflects laboratory performance. Your product may perform differently, depending on the software, components, and peripherals you ordered, and shall have no obligation to update such information.

Accordingly, the customer should not rely upon this information in making decisions about electrical tolerances or otherwise. No warranty as to accuracy or completeness is expressed or implied.



NOTE: This monitor is ENERGY STAR certified.

This product qualifies for ENERGY STAR in the factory default settings which can be restored by **Factory Reset** function in the OSD menu. Changing the factory default settings or enabling other features may increase power consumption that could exceed the ENERGY STAR specified limit.

Physical characteristics

Table 12. Physical characteristics.

Description	Value
Signal cable type:	
Analog	D-Sub (VGA), 15 pins
Digital	HDMI, 19 pins
NOTE: Dell monitors are designed to work optimally with the video cables that are shipped with your monitor. As Dell does not have control over the different cable suppliers in the market, the type of material, connector, and process that is used to manufacture these cables, Dell does not guarantee video performance on cables that are not shipped with your Dell monitor.	
Dimensions (with stand):	
Height	395.75 mm (15.58 in.)
Width	492.86 mm (19.40 in.)
Depth	211.80 mm (8.34 in.)
Dimensions (without stand):	
Height	286.48 mm (11.28 in.)
Width	492.86 mm (19.40 in.)
Depth	44.90 mm (1.77 in.)
Stand dimensions:	
Height	181.60 mm (7.15 in.)
Width	219.90 mm (8.66 in.)
Depth	211.80 mm (8.34 in.)
Weight:	
With packaging	4.38 kg (9.66 lb)
With stand assembly and cables	2.96 kg (6.53 lb)
Without stand assembly and cables	2.23 kg (4.92 lb)
Stand assembly	0.44 kg (0.97 lb)

Environmental characteristics

Table 13. Environmental characteristics.

Description	Value
Temperature	
Operating	0°C to 40°C (32°F to 104°F)
Non-operating (Storage/Shipping)	-20°C to 60°C (-4°F to 140°F)
Humidity	
Operating	10% to 80% (non-condensing)
Non-operating (Storage/Shipping)	5% to 90% (non-condensing)
Altitude	
Operating (maximum)	5,000 m (16,400 ft)
Non-operating (maximum)	12,192 m (40,000 ft)
Thermal dissipation	
maximum	70.79 BTU/hour
typical	54.72 BTU/hour

Pin assignments

HDMI port

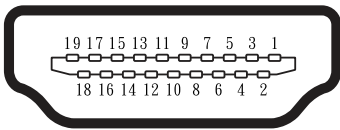

Figure 5. HDMI port

Table 14. Pin assignments (HDMI port).

Pin Number	Signal Assignment
1	TMDS DATA 2+
2	TMDS DATA 2 SHIELD
3	TMDS DATA 2-
4	TMDS DATA 1+
5	TMDS DATA 1 SHIELD
6	TMDS DATA 1-
7	TMDS DATA 0+
8	TMDS DATA 0 SHIELD
9	TMDS DATA 0-
10	TMDS CLOCK+
11	TMDS CLOCK SHIELD
12	TMDS CLOCK-
13	CEC
14	Reserved (N.C. on device)
15	DDC CLOCK (SCL)
16	DDC DATA (SDA)
17	DDC/CEC Ground
18	+5 V POWER
19	HOT PLUG DETECT

VGA port

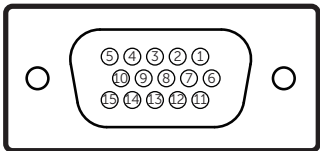

Figure 6. VGA port

Table 15. Pin assignments (VGA port).

Pin Number	Signal Assignment
1	Video-Red
2	Video-Green
3	Video-Blue
4	GND
5	Self-test
6	GND-R
7	GND-G
8	GND-B
9	DDC +5 V
10	GND-sync
11	GND
12	DDC data
13	H-sync
14	V-sync
15	DDC clock

Plug-and-play capability

You can install the monitor in any Plug and Play-compatible computer. The monitor automatically provides the computer with its Extended Display Identification Data (EDID) using Display Data Channel (DDC) protocols so the computer can configure itself and optimize the monitor settings. Most monitor installations are automatic, you can select different settings as required. For more information about changing the monitor settings, see [Operating your monitor](#).

LCD monitor quality and pixel policy

During the LCD monitor manufacturing process, it is normal for one or more pixels to become fixed in an unchanging state, which are hard to see and do not affect the display quality or usability. For more information about Dell Monitor Quality and Pixel Policy, see www.dell.com/pixelguidelines.

Ergonomics

△ **CAUTION:** Improper or prolonged usage of a keyboard may result in injury.

△ **CAUTION:** Viewing the monitor screen for extended periods of time may result in eye strain.

For comfort and efficiency, observe the following guidelines when setting up and using your computer workstation:

- Position your computer so that the monitor and keyboard are directly in front of you as you work. Special shelves are commercially available to help you correctly position your keyboard.
- To reduce the risk of eye strain and neck, arm, back, or shoulder pain from using the monitor for long periods of time, we recommend you to:
 - Set the distance of the screen between 20 in. to 28 in. (50 cm - 70 cm) from your eyes.
 - Blink frequently to moisten your eyes or wet your eyes with water after prolonged usage of the monitor.
 - Take regular and frequent breaks for 20 minutes every two hours.
 - Look away from your monitor and gaze at a distant object at 20 ft away for at least 20 seconds during the breaks.
 - Perform stretches to relieve tension in the neck, arms, back, and shoulders during the breaks.
- Ensure that the monitor screen is at eye level or slightly lower when you are sitting in front of the monitor.
- Adjust the tilt of the monitor, its contrast, and brightness settings.
- Adjust the ambient lighting around you (such as overhead lights, desk lamps, and the curtains or blinds on nearby windows) to minimize reflections and glare on the monitor screen.
- Use a chair that provides good lower-back support.
- Keep your forearms horizontal with your wrists in a neutral, comfortable position while using the keyboard or mouse.
- Always leave space to rest your hands while using the keyboard or mouse.
- Let your upper arms rest naturally on both sides of the chair.
- Ensure that your feet are resting flat on the floor.
- When sitting, make sure that the weight of your legs is on your feet and not on the front portion of your seat. Adjust your chair's height or use a footrest if necessary to maintain a proper posture.
- Vary your work activities. Try to organize your work so that you do not have to sit and work for extended periods of time. Try to stand or get up and walk around at regular intervals.
- Keep the area under your desk clear of obstructions and cables or power cords that may interfere with comfortable seating or present a potential trip hazard.

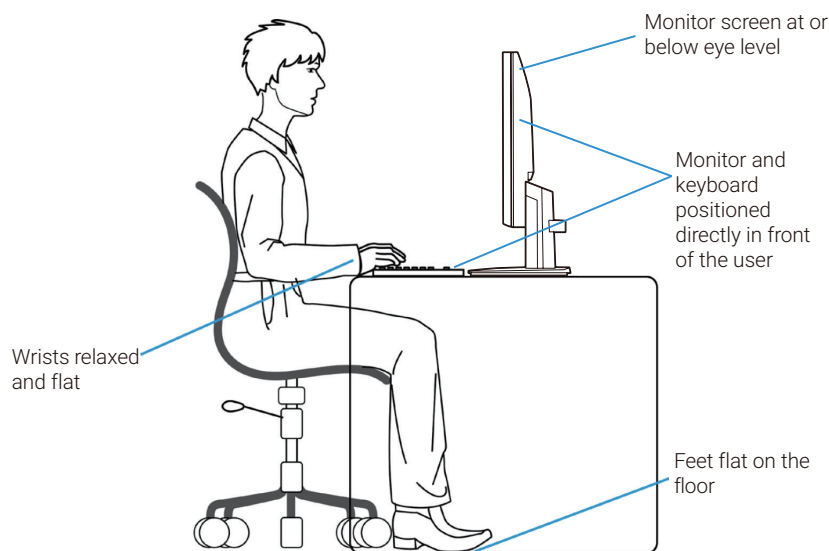

Figure 7. Ergonomics or comfort and efficiency

Handling and moving your display

To ensure that the monitor is handled safely when lifting or moving it, follow the guidelines that are mentioned below:

- Before moving or lifting the monitor, turn off your computer and the monitor.
- Disconnect all cables from the monitor.
- Place the monitor in the original box with the original packing materials.
- Hold the bottom edge and the side of the monitor firmly without applying excessive pressure when lifting or moving the monitor.

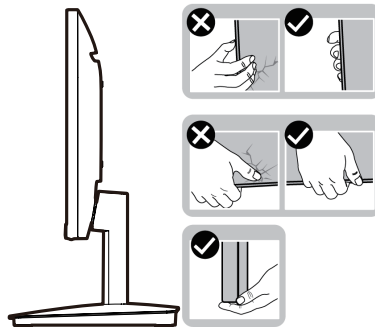

Figure 8. Moving or lifting the monitor

- When lifting or moving the monitor, ensure that the screen is facing away from you and do not press on the display area to avoid any scratches or damage.

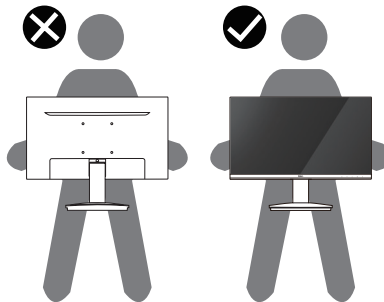

Figure 9. Ensure that the screen is facing away from you

- When transporting the monitor, avoid any sudden shock or vibration to it.
- When lifting or moving the monitor, do not turn the monitor upside down while holding the stand base or stand riser. This may result in accidental damage to the monitor or cause personal injury.

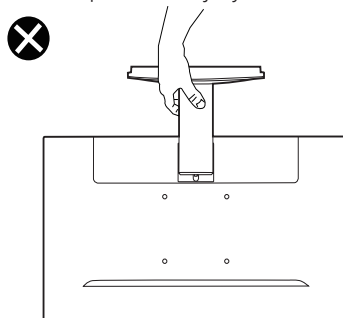

Figure 10. Do not turn the monitor upside down





Maintenance guidelines

Cleaning your monitor

 **CAUTION:** Read and follow the [Safety instructions](#) before cleaning the monitor.

 **WARNING:** Before cleaning the monitor, unplug the monitor power cable from the electrical outlet.

For best practices, follow the instructions in the list below when unpacking, cleaning, or handling your monitor:

- Use a clean cloth that is slightly dampened with water to clean the stand assembly, the screen, and the chassis of your Dell monitor. If available, use a screen-cleaning tissue or solution suitable for cleaning Dell monitors.
- After cleaning the surface of the table, ensure that it is thoroughly dry and free from any moisture or cleaning agent before placing your Dell monitor on it.
 -  **CAUTION:** Do not use detergents or other chemicals such as benzene, thinner, ammonia, abrasive cleaners, alcohol, or compressed air.
 -  **CAUTION:** Using chemicals for cleaning may cause changes in the appearance of the monitor, such as color fading, milky film on the monitor, deformation, uneven dark shade, and peeling of screen area.
 -  **WARNING:** Do not spray the cleaning solution or even water directly on the surface of the monitor. Doing so allows liquids to accumulate at the bottom of the display panel and corrode the electronics resulting in permanent damage. Instead, apply the cleaning solution or water to a soft cloth and then clean the monitor.
 -  **NOTE:** Monitor damage due to improper cleaning methods and the use of benzene, thinner, ammonia, abrasive cleaners, alcohol, compressed air, detergent of any kind will lead to a Customer Induced Damage (CID). CID is not covered under the standard Dell warranty.
- If you notice white residual powder when you unpack your monitor, wipe it off with a cloth.
- Handle your monitor with care as a darker-colored monitor may get scratched and show white scuff marks more than a lighter-colored monitor.
- To help maintain the best image quality on your monitor, use a dynamically changing screen saver and turn off your monitor when not in use.

Setting up the monitor

Connecting the stand

- ① **NOTE:** The stand is not attached when the monitor is shipped from the factory.
- ① **NOTE:** The following instructions are applicable only for the stand that was shipped with your monitor. If you are attaching a stand that you purchased from any other source, follow the setup instructions that were included with the stand.

1. Assemble the stand riser to stand base.
 - a. Place the monitor stand base on a stable table top.
 - b. Slide the monitor stand body in the correct direction down onto the stand base until it clicks into place.

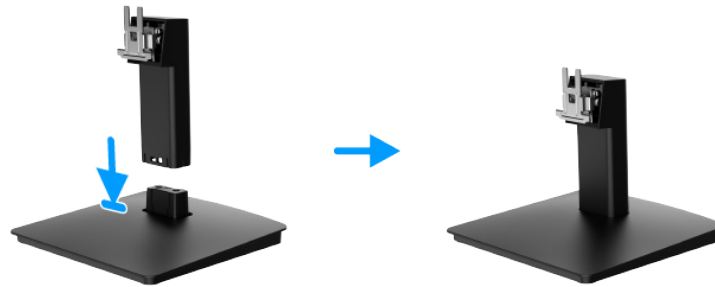

Figure 11. Assemble the stand

2. Attach the stand assembly to the monitor.
 - a. Open the monitor protective cover.
 - b. Align the stand-riser bracket with the grooves at the back of the monitor.
 - c. Slide the stand assembly until it snaps into place.



Figure 12. Attach the stand

3. Hold the riser and monitor with both hands as shown below and lift carefully, then place on a flat surface.



Figure 13. Hold the stand riser and lift the monitor

4. Lift the protective cover from the monitor.

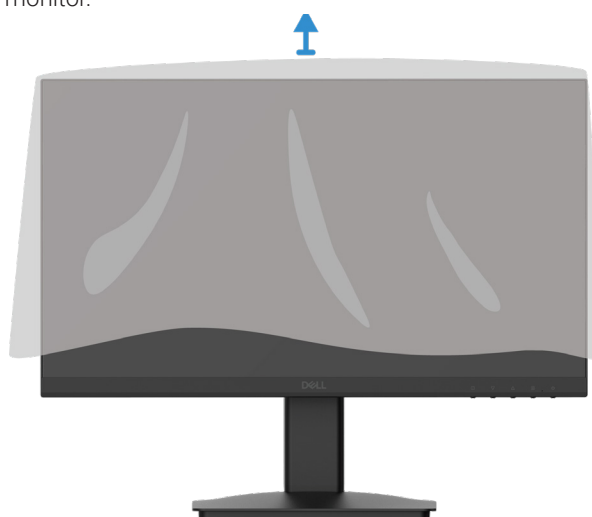

Figure 14. Lift the protective cover from the monitor

Connecting your monitor

- ⚠ WARNING:** Before you begin any of the procedures in this section, follow the [Safety instructions](#).
- ⚠ WARNING:** For your safety, be sure that the grounded power outlet you plug the power cable into is accessible to the operator and located as close to the equipment as possible. To disconnect power from the equipment, unplug the power cable from the power outlet by grasping the plug firmly. Never pull on the cord.
- ⚠ WARNING:** A certified power supply cord has to be used with this equipment. The relevant national installation and/or equipment regulations shall be considered. A certified power supply cord not lighter than ordinary polyvinyl chloride flexible cord according to IEC 60227 (designation H05VV-F 3G 0.75 mm² or H05VVH2-F2 3G 0.75 mm²) shall be used. An alternative flexible cord is synthetic rubber.
- i NOTE:** Do not connect all cables to the computer simultaneously.
- i NOTE:** Dell monitors are designed to work optimally with Dell supplied inbox cables. Dell does not guarantee the video quality and performance when using non-Dell cables.

To connect your monitor to the computer:

1. Turn off your computer and disconnect the power cable.
2. Connect HDMI or VGA cable from your monitor to the computer.

Connecting HDMI cable

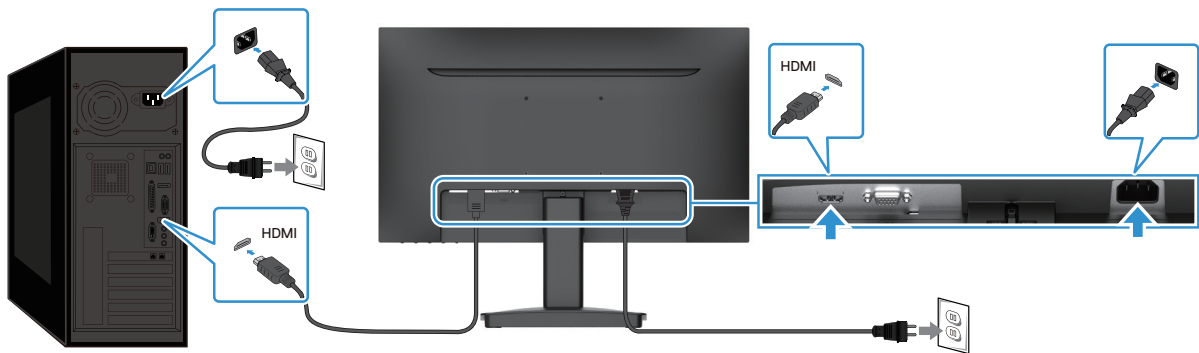

Figure 15. Connecting HDMI cable

Connecting VGA cable

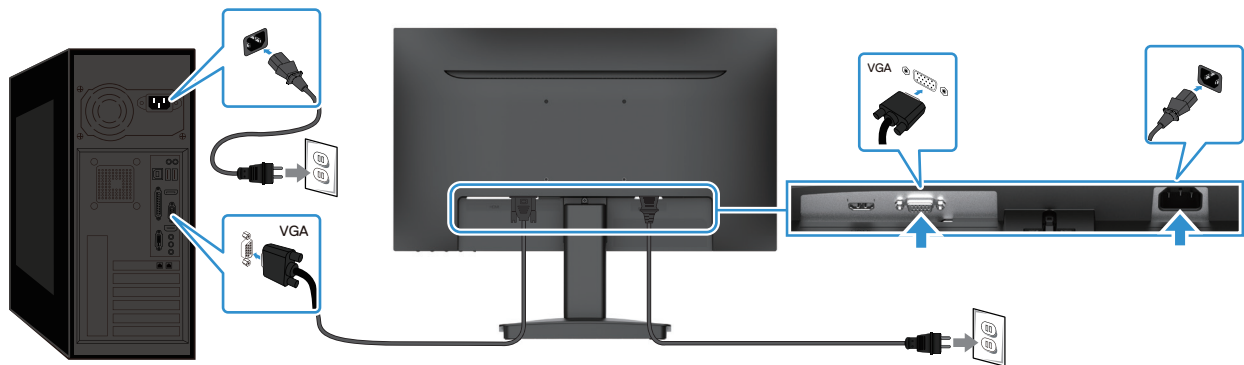

Figure 16. Connecting VGA cable

Securing your monitor using Kensington lock (optional)

The security-lock slot is located at the bottom of the monitor (see [Security-lock slot](#)). Secure your monitor to a table using the Kensington security lock.

For more information about using the Kensington lock (sold separately), see the documentation that is shipped with the lock.

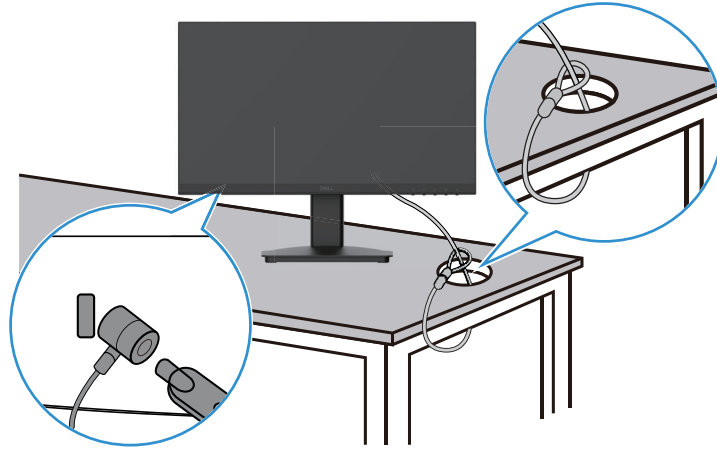

Figure 17. Using Kensington lock

NOTE: The image is for illustration purpose only only. The appearance of the lock may vary.

Removing the monitor stand

- ① **NOTE:** To prevent scratches on the LCD screen when removing the stand, ensure that the monitor is placed on a soft surface and handle it carefully.
- ① **NOTE:** The following instructions are applicable only for the stand that was shipped with your monitor. If you are removing a stand that you purchased from any other source, follow the setup instructions that are included with the stand.
- ① **NOTE:** Before removing the stand, ensure that you have disconnected all the cables from the monitor.

To remove the stand:

1. Place the monitor on a soft cloth along the desk.



Figure 18. Place the monitor on the desk

2. Use a long and thin screwdriver to push the released button.

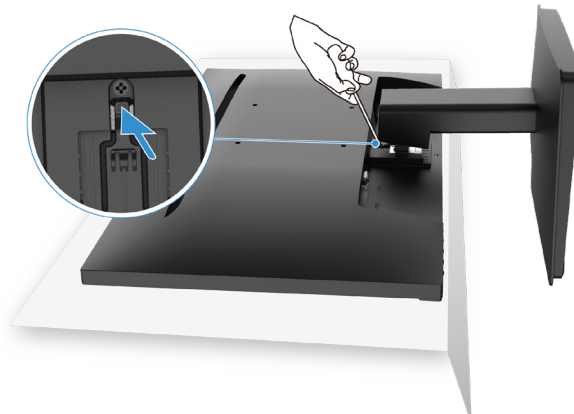

Figure 19. Push the release button

3. While keeping the release button pressed, pull the stand out from the monitor.



Figure 20. Remove the stand

VESA wall Mounting (optional)

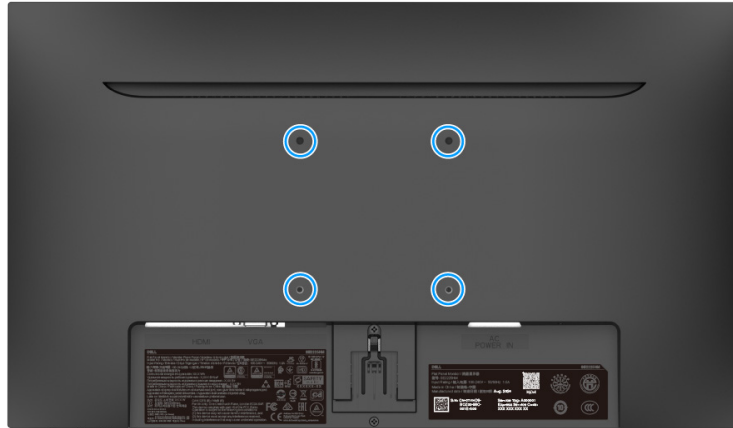

Figure 21. VESA wall Mounting

See the instructions that come with the VESA-compatible base mounting kit.

1. Set the monitor panel on a soft cloth or cushion on a stable, flat surface.
2. Remove the stand.
3. Secure the mounting bracket from the wall mounting kit to the monitor.
4. Mount the monitor on the wall. For more information, see the documentation that is shipped with the wall mounting kit.

NOTE: Use M4x10 (mm) screws to connect the monitor to the wall-mounting kit. VESA screws are not included with the monitor. Use only with UL, CSA, or GS-listed wall-mount brackets that have a minimum weight/load capacity of 8.92 kg (19.67 lb).

Using tilt

You can tilt the monitor for the most comfortable viewing angle.

NOTE: The stand is not attached when the monitor is shipped from the factory.

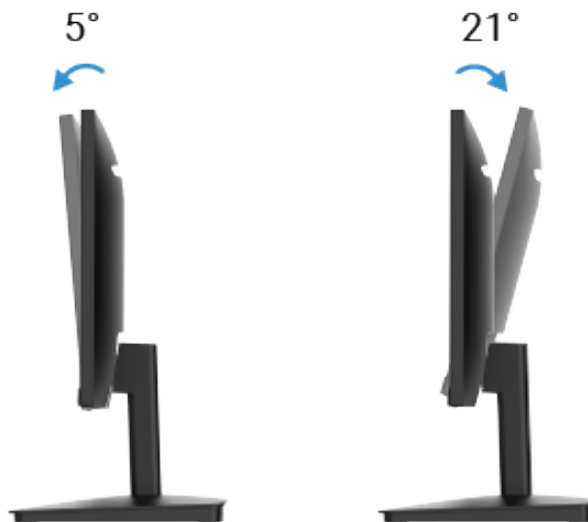



Figure 22. Tilt adjustment

Operating your monitor

Turning on the monitor

Press the  button to turn on the monitor.

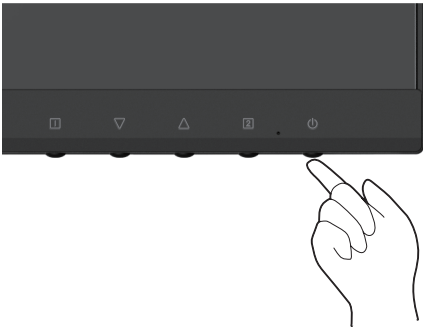

Figure 23. Turn on the monitor

Using the front panel controls

Use the control buttons at the front of the monitor to adjust the image being displayed.

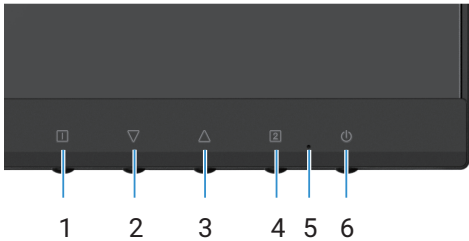







Figure 24. Front panel controls

The following table describes the control buttons:





Table 16. Control buttons description.

	Control buttons	Description
1		To launch the On-Screen Display (OSD) menu. For more information, see Accessing the OSD menu .
		Use this button to go back to the main menu or exit the OSD main menu.
2		Use the Down button to decrease values or move down in a menu.
		When not in the OSD menu, directly enters Contrast/Brightness.
3		Use the Up button to increase values or move up in a menu.
		When not in the OSD menu, directly enters Color Vision Mode.
4		Use this button to select the OSD menu.
		When not in the OSD menu, directly enters Input Source.
5		A solid blue light indicates that the monitor is turned on and functioning. A solid orange light indicates that the monitor is in Standby mode.
6		To turn the monitor On or Off.

Using the OSD lock function

You can lock the control buttons to prevent access to the OSD menu and/ or power button.

Table 17. Control buttons description.

	Control buttons	Description
1		Press and hold these control buttons for 10 seconds to lock or unlock the access to the OSD menu.  NOTE: This works only outside the OSD menu.
2		Press and hold these control buttons for 10 seconds to lock or unlock the access to the power button.  NOTE: This works only outside the OSD menu.

Using the On-Screen Display (OSD) menu

Accessing the OSD menu

NOTE: Any changes that you make are automatically saved when you move to another menu, exit the OSD menu, or wait for the OSD menu to close automatically.

1. Press the  button to display the OSD main menu.

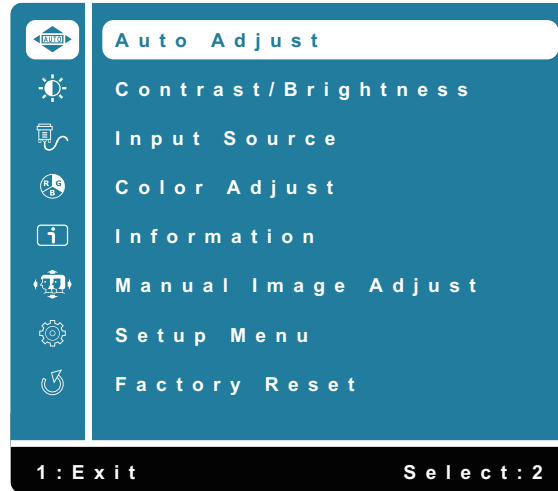

Figure 25. OSD main menu



















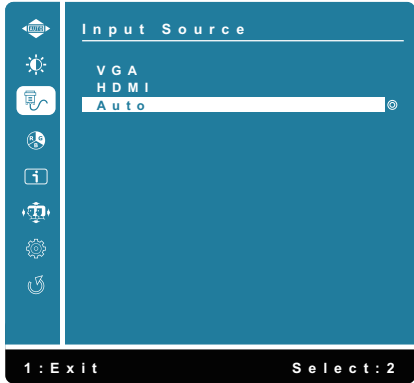

2. Press the  and  buttons to move between the setting options. As you move from one icon to another, the option name is highlighted.
3. Press the  button once to activate the highlighted option.
4. Select the  button going back to the previous menu.

Table 18. OSD Tree list.

Icon	Menu and submenus	Description
	Auto Adjust	<p>Adjust the Horizontal Position, Vertical Position, Phase (Fine Tune) and Clock (H. Size) of the screen.</p> <p> NOTE: Only available for D-SUB input.</p> 
	Contrast/Brightness	<p>Use this option to control the brightness or contrast settings.</p> 
	Contrast	<p>Adjust brightness first, and adjust contrast only if you need further adjustment.</p> <p>Press the Δ button to increase contrast and press the ∇ button to decrease contrast (min 0 ~ max 100).</p> <p>The contrast function adjusts the degree of difference between darkness and lightness on the screen.</p>
	Brightness	<p>Brightness adjusts the luminance of the backlight (min 0 ~ max 100).</p> <p>Press the ∇ button to decrease the brightness.</p> <p>Press the Δ button to increase the brightness..</p>
	DCR	To set the DCR function on/off. If DCR is on, brightness should be at 100 and should not be adjustable.
	ECO	To control ECO function on/off. If ECO is on, brightness should be at 20 and should not be adjustable. DCR should not be adjustable.

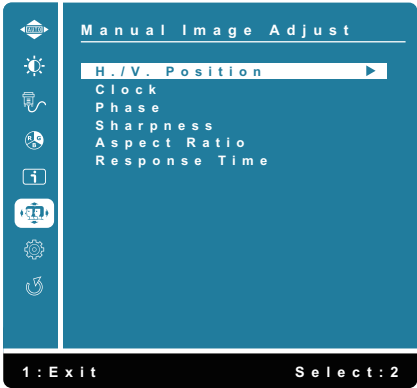
Icon	Menu and submenus	Description
	Input Source	Use the Input Source menu to switch between the different video signals that may be connected to your monitor. 
	VGA	Push [2] to select VGA input when you are using the VGA connector.
	HDMI	Push [2] to select HDMI input when you are using the HDMI connector.
	Auto	Select Auto to scan for available input signals.
	Color Adjust	When you select Color Adjust , you can choose Cool , Normal , Warm , User Color and Color Vision Mode from the list. 
	Cool	Decrease the color temperature. The screen appears cooler with a blue tint.
	Normal	Adds red to screen image for warmer white and richer red.
	Warm	Increase the color temperature. The screen appears warmer with a red/yellow tint.
	User Color	Individual adjustments for red (R), green (G), blue (B). Each step will increase/decrease value by 1.
	Color Vision Mode	Provides an optimum display environment depending on the contents displayed. To select Standard , Scenery , Game , Cinema , Text mode. When it is not under Standard mode, " Contrast/Brightness " option on " Main Menu " can't be selected.

Icon	Menu and submenus	Description
	Information	<p>When you select Information, details such as Model Name, Input Source, Resolution, H. Frequency, V. Frequency, Pixel Clock, and Service Tag are displayed.</p> 
	Manual Image Adjust	<p>When you select Manual Image Adjust, you can choose H. /V. Position, Clock, Phase, Sharpness, Aspect Ratio and Response Time from the list.</p> 
	H. /V. Position	To adjust the horizontal and vertical position of the video.
	Clock	The Phase and Pixel Clock adjustments allow you to adjust your monitor to your preference.
	Phase	If satisfactory results are not achieved with the phase adjustment, first use the Clock (coarse) adjustment, then reapply the Phase (fine) adjustment.
	Sharpness	Adjusts the sharpness of the display.
	Aspect Ratio	To adjusts the video mode between Full Screen or 4:3
	Response Time	Adjust the response time of the panel (Normal/Fast).

Icon	Menu and submenus	Description
	Setup Menu	<p>When you select Setup Menu, you can choose Language Select, OSD Position, OSD Time Out, OSD Background and Self-Diagnostic from the list.</p> 
	Language	To select one of the following languages: English, Spanish, French, German, Brazilian Portuguese, Russian, Japanese or Simplified Chinese.
	OSD Position	Adjust the horizontal position of the OSD. Adjust the vertical position of the OSD.
	OSD Time Out	To configure the display duration of the OSD.
	OSD Background	Enables the user to adjust OSD transparency to 0, 20, 40, 60, 80, or 100.
	Self-Diagnostic	Enables you to check if your monitor is functioning properly.
	Factory Reset	Restore all preset values to the factory default settings.

OSD warning messages

The following Power warning message box applies to OSD functions for the first time.

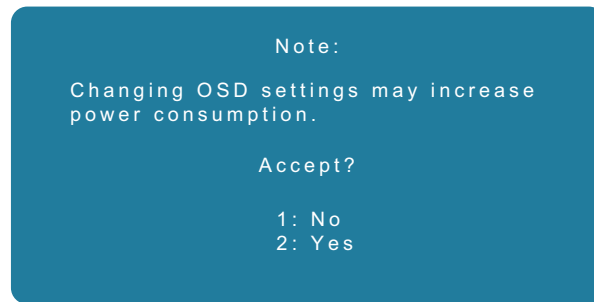

Figure 26. Power warning message

Activate the computer and wake up the monitor to gain access to the OSD.

In the active-off mode, you could only press **2** button into Input Source.

If VGA or HDMI cable is not connected, a floating dialog box as shown below appears. The monitor enters sleep mode, and the LED color indicator is orange.



Figure 27. Signal cable disconnected warning message

When the monitor does not support a particular resolution mode, the following message is displayed:



Figure 28. Out of range warning message

See [Troubleshooting](#) for more information.

Setting the maximum resolution

 **NOTE:** The steps may vary slightly depending on the version of Windows you have.

To set the maximum resolution for the monitor:

In Windows 10 and Windows 11:

1. Right-click the desktop and click **Display settings**.
2. If you have more than one monitor connected, ensure that you select **SE2225HM**.
3. Click the **Display settings** drop-down list and select **1920 x 1080**.
4. Click **Keep changes**.

If you do not see 1920 x 1080 as an option, you must update your graphics driver to the latest version. Depending on your computer, complete one of the following procedures:

If you have a Dell desktop or laptop:

- Go to www.dell.com/support, enter your service tag, and download the latest driver for your graphics card.

If you are using a non-Dell computer (laptop or desktop):

- Go to the support site for your non-Dell computer and download the latest graphic card drivers.
- Go to the graphics card's website and download the latest graphic card drivers.

Troubleshooting

⚠ WARNING: Before you begin any of the procedures in this section, follow the [Safety instructions](#).

Self-test

Your monitor provides a self-test feature that allows you to check if your monitor is functioning properly. If your monitor and computer are properly connected but the monitor screen remains dark, run the monitor self-test by performing the following steps:

1. Turn off both your computer and the monitor.
2. Disconnect all video cables from the monitor. This way, the computer does not have to be involved.
3. Turn on the monitor.

ⓘ NOTE: A dialog box should appear on-screen (against a black background), if the monitor cannot sense a video signal and is working correctly. While in self-test mode, the power LED remains blue.



Figure 29. Signal cable disconnected warning message

ⓘ NOTE: This message also appears during normal operation, when the video cable is disconnected or damaged.

4. Turn off your monitor and reconnect the video cable; then turn on your computer and the monitor. If your monitor remains dark after you reconnect the cables, check your video controller and computer.

Built-in diagnostics

Your monitor has a built-in diagnostic tool that helps you determine if any screen abnormality you experience is an inherent problem with your monitor, or with your computer and video card.

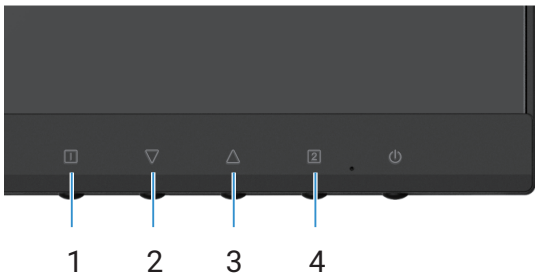

Figure 30. Built-in diagnostics function buttons

Table 19. Label description

Label	Description
1	Button 1
2	Button 2
3	Button 3
4	Button 4

1. Plug in the power cable and signal cables, and then turn on the monitor.
2. Press the **Button 1** to display the OSD main menu.
3. Press the **Button 2** and **Button 3** to select **Setup Menu > Self-Diagnostic** to initiate the self-diagnostic process.
4. When initiated, a gray screen appears. Inspect the screen for abnormalities.
5. Press the **Button 1**, **Button 2**, **Button 3** or **Button 4**. The color of the screen changes to red. Inspect the screen for abnormalities.
6. Repeat step 5 and inspect the screen when it displays the colors green, blue, black, and white followed by the on-screen text.
7. The test is completed when the text screen appears. To exit, press the **Button 1**, **Button 2**, **Button 3** or **Button 4** again.

Common problems

The following table provides general information about common monitor problems that you might encounter and the possible solutions:

Table 20. Common problems and solutions.

Common symptoms	Possible solutions
No video/Power LED off	<ul style="list-style-type: none"> Ensure that the video cable connecting the monitor and the computer is properly connected and secure. Verify that the power outlet is functioning properly using any other electrical equipment. Ensure that the power button is pressed. Ensure that the correct input source is selected using the Input Source menu.
No video/Power LED on	<ul style="list-style-type: none"> Increase brightness and contrast controls using the OSD. Perform a monitor self-test feature check. Check for bent or broken pins in the video cable connector. Run the built-in diagnostics. Ensure that the correct input source is selected using the Input Source menu.
Poor focus	<ul style="list-style-type: none"> Eliminate video extension cables. Reset the monitor to Factory Settings (Factory Reset). Change the video resolution to the correct aspect ratio.
Shaky/Jittery video	<ul style="list-style-type: none"> Reset the monitor to Factory Settings (Factory Reset). Check environmental factors. Relocate the monitor and test in another room.
Missing pixels	<ul style="list-style-type: none"> Cycle power On-off. A pixel that is permanently off is a natural defect that can occur in LCD technology. For more information about Dell Monitor Quality and Pixel Policy, see Dell Support site at: www.dell.com/pixelguidelines.
Stuck-on pixels	<ul style="list-style-type: none"> Cycle power On-off. A pixel that is permanently off is a natural defect that can occur in LCD technology. For more information about Dell Monitor Quality and Pixel Policy, see Dell Support site at: www.dell.com/pixelguidelines.
Brightness problems	<ul style="list-style-type: none"> Reset the monitor to Factory Settings (Factory Reset). Adjust brightness and contrast controls using OSD.
Geometric distortion	<ul style="list-style-type: none"> Reset the monitor to Factory Settings (Factory Reset). Adjust horizontal and vertical using OSD.
Horizontal/Vertical lines	<ul style="list-style-type: none"> Reset the monitor to Factory Settings (Factory Reset). Perform a monitor self-test feature check and determine if these lines are also in self-test mode. Check for bent or broken pins in the video cable connector. Run the built-in diagnostics.
Synchronization problems	<ul style="list-style-type: none"> Reset the monitor to Factory Settings (Factory Reset). Perform a monitor self-test feature check to determine if the scrambled screen appears in self-test mode. Check for bent or broken pins in the video cable connector. Restart the computer in safe mode.
Safety-related issues	<ul style="list-style-type: none"> Do not perform any troubleshooting step. Contact Dell immediately.

Common symptoms	Possible solutions
Intermittent problems	<ul style="list-style-type: none"> Ensure that the video cable connecting the monitor to the computer is connected properly and is secure. Reset the monitor to Factory Settings (Factory Reset). Perform a monitor self-test feature check to determine if the intermittent problem occurs in self-test mode.
Missing color	<ul style="list-style-type: none"> Perform monitor self-test feature check. Ensure that the video cable connecting the monitor to the computer is connected properly and is secure. Check for bent or broken pins in the video cable connector.
Wrong color	<ul style="list-style-type: none"> Change the Color Vision Mode in the Color Adjust OSD to Graphics or Video depending on the application. Try different User Color in Color Adjust OSD. Adjust R/G/B value in User Color OSD if the Color Vision Mode is turned off. Run the built-in diagnostics.
Image retention from a static image left on the monitor for a long period	<ul style="list-style-type: none"> Set the screen to turn off after a few minutes of screen idle time. These can be adjusted in the Windows Power Options or Mac Energy Saver setting. Alternatively, use a dynamically changing screensaver.
Video ghosting or overshooting	<ul style="list-style-type: none"> Change the Response Time in the Manual Image Adjust OSD to Off/Normal/Fast depending on your application and usage.

Product-specific problems

Table 21. Product-specific problems and solutions.

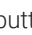
Specific symptoms	Possible solutions
Screen image is too small	<ul style="list-style-type: none"> Check the Aspect Ratio setting in the Manual Image Adjust settings OSD. Reset the monitor to Factory Settings (Factory Reset).
Cannot adjust the monitor with the buttons on the bottom of the panel	<ul style="list-style-type: none"> Turn off the monitor, unplug the power cable, plug back, and then turn on the monitor. Check whether the OSD menu is locked. If yes, press the  button and  button for 10 seconds to unlock (for more information, see Lock).
No input signal when user controls are pressed	<ul style="list-style-type: none"> Check the signal source. Ensure that the computer is not in standby or sleep mode by moving the mouse or pressing any key on the keyboard. Check if the video cable is plugged in properly. Disconnect and reconnect the video cable if necessary. Reset the computer or video player.
The picture does not fill the entire screen	<ul style="list-style-type: none"> Due to different video formats (aspect ratio) of DVDs, the monitor may display in full screen. Run the built-in diagnostics.

Regulatory information

FCC notices (U.S. only) and other regulatory information

For FCC notices and other regulatory information, see the regulatory compliance at www.dell.com/regulatory_compliance

EU product database for energy label and product information sheet

<https://eprel.ec.europa.eu/qr/2187041>

Contacting Dell

To contact Dell for sales, technical support, or customer service issues, see www.dell.com/contactdell.

① **NOTE:** Availability varies by country and product, and some services may not be available in your country.

① **NOTE:** If you do not have an active internet connection, you can find contact information about your purchase invoice, packing slip, bill, or Dell product catalog.