

### Sunny Lounge™ Island Manual

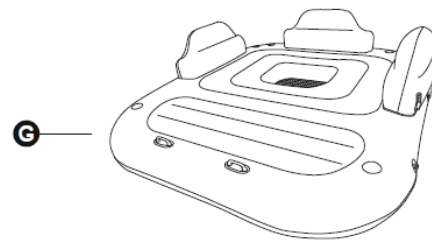

	A	B	C	D	E	F	G
43407	x3	x2	x1	x1	x1	x1	x1

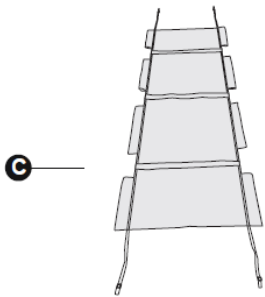
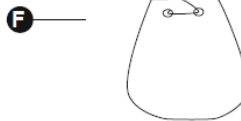
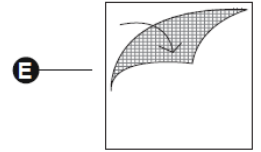

2.

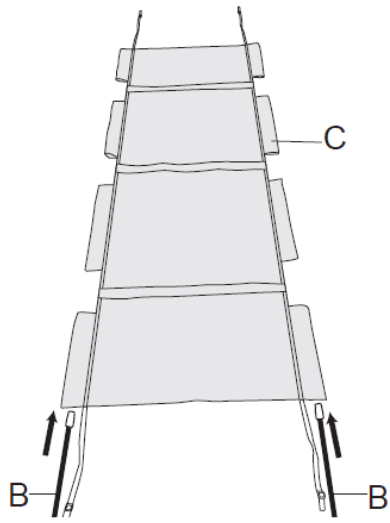

3.

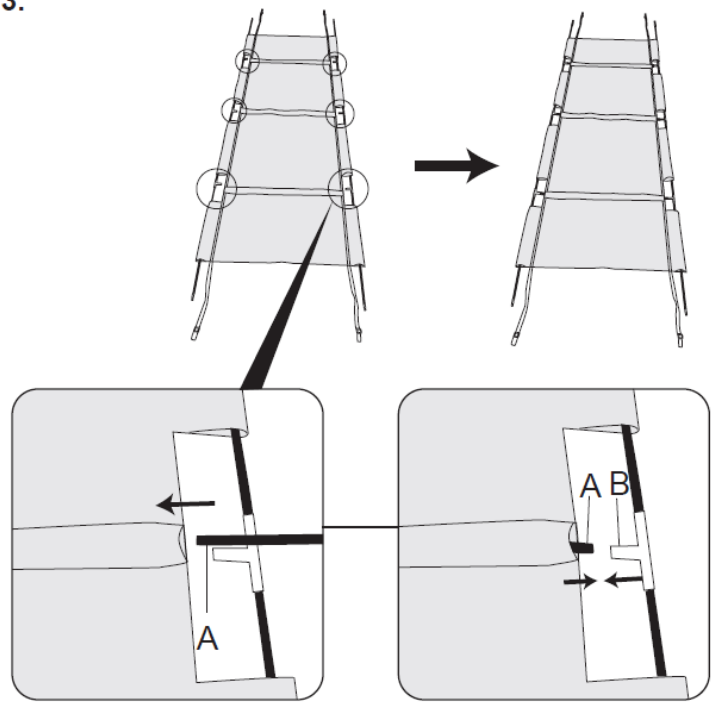

4.

①

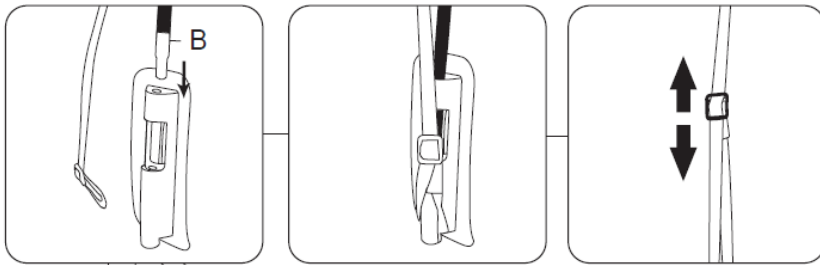

②

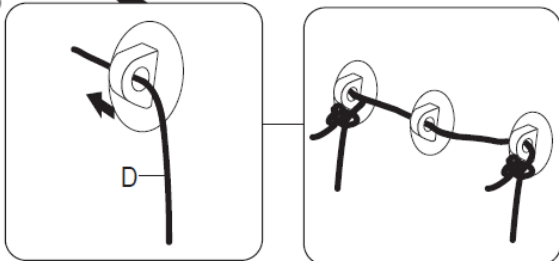

5.

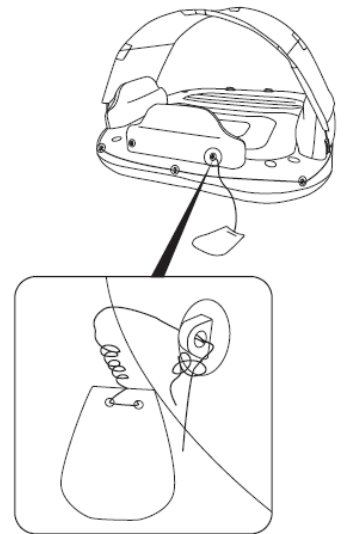

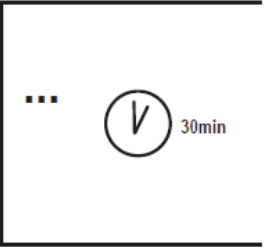
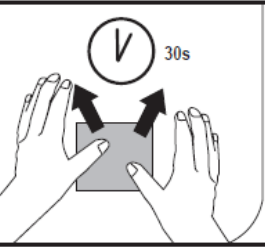
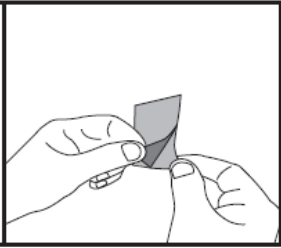
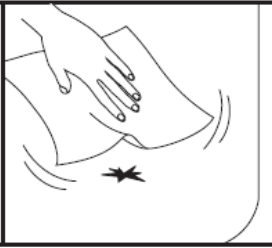
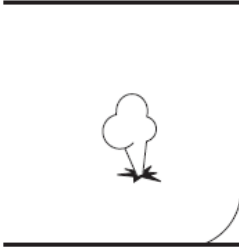
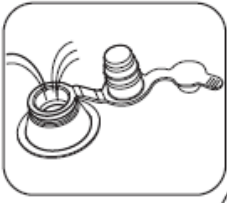

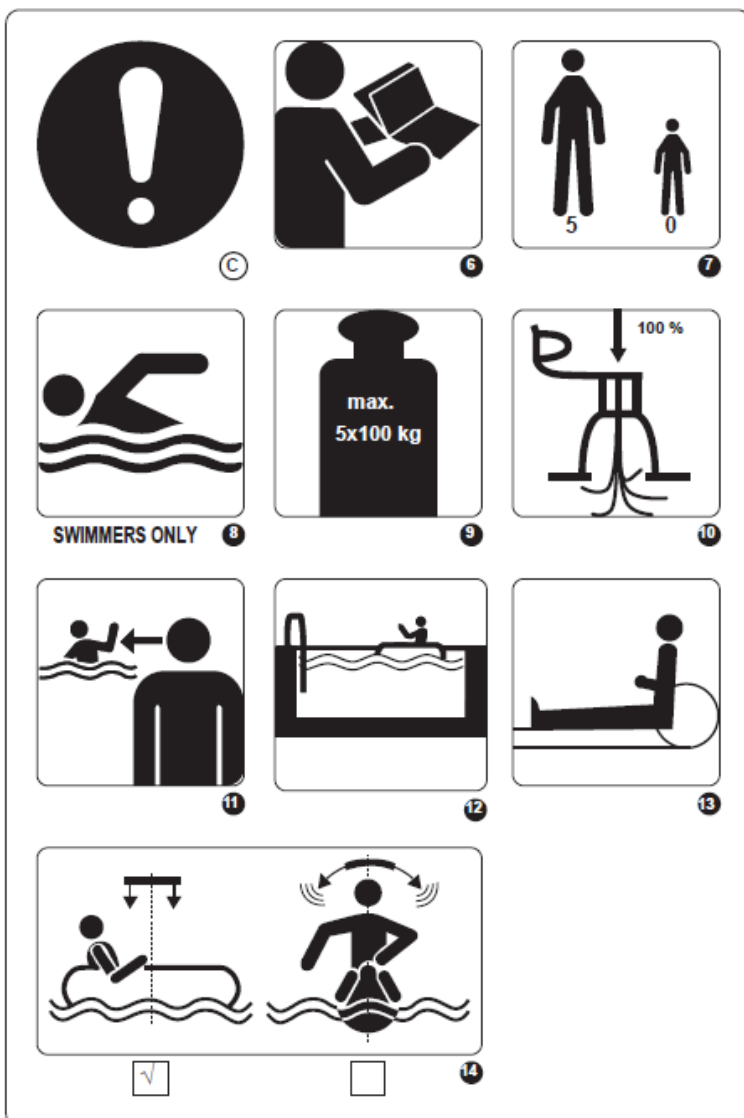
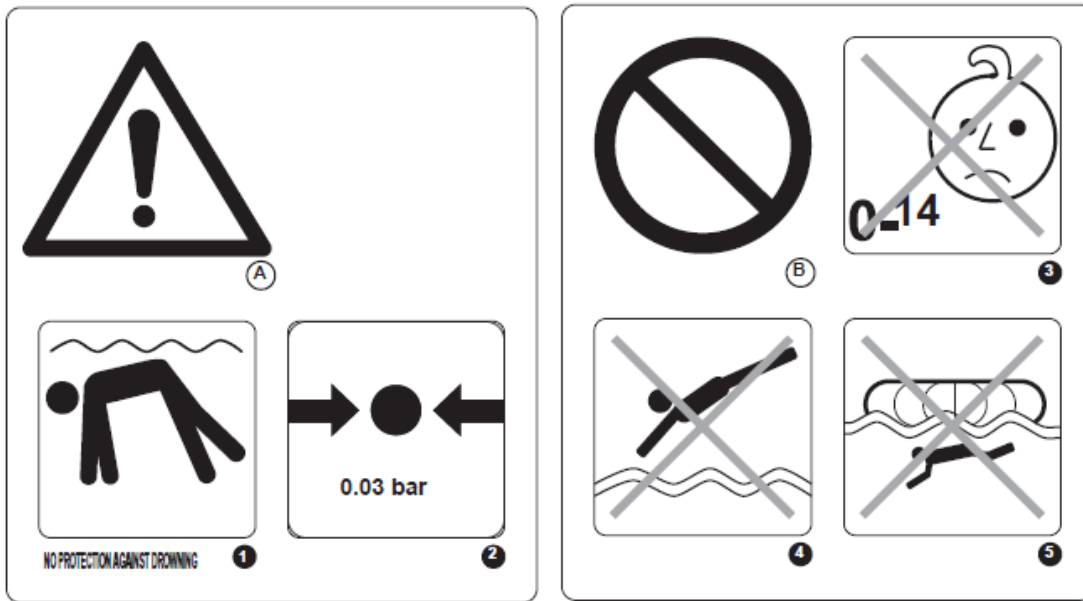

A. WARNING

B. PROHIBITION

C. MANDATORY

1. NO PROTECTION AGAINST DROWNING

2. DESIGN WORKING PRESSURE: 0.03 BAR

3. NOT FOR CHILDREN 14 YEARS OF AGE AND BELOW, APPLY ONLY TO CHILDREN ABOVE 14 YEARS OF AGE

4. NO DIVING

5. DO NOT SWIM UNDERNEATH THE STRUCTURE
6. READ INSTRUCTIONS FIRST
7. NUMBER OF USERS, 5 ADULTS
8. SWIMMERS ONLY
9. MAXIMUM LOAD CAPACITY 500 KG
10. FULLY INFLATE ALL AIR CHAMBERS
11. ALWAYS SUPERVISE CHILDREN IN WATER
12. POOL USE ONLY
13. THE INTENDED POSTURE-SITTING
14. DEVICE PROVIDES FLOATING STABILITY

## OWNER'S MANUAL

Non-compliance with these operating instructions may expose you to serious danger.

- **ATTENTION! NO PROTECTION AGAINST DROWNING!**
- **SWIMMERS ONLY!**
- Evenly distribute loads when use the product. Tipping and drowning may occur with uneven distribution of loads.

### SAVE THESE INSTRUCTIONS

## TECHNICAL SAFETY INSTRUCTIONS

Read the manual and follow the instructions. For your own safety, always heed the advice and warnings in these instructions.

Only use the product in the places and conditions for which it is intended.

- Passenger numbers and load weight shall by no means exceed passenger number and maximum weight capacity in the specifications.
  - This product should not be used as life saving device.
  - Before every use, carefully inspect all product components, to ensure everything is in good condition and tightly secured.
  - Be careful when landing on the ground. Sharp or rough objects (such as rocks, cement, shells, glass, etc.) may puncture the product.
- NOTE:** Poles contain fiberglass; we recommend wearing gloves during assembly.

## PRODUCT DESCRIPTIONS

Item No.	Size	Passenger Number	Maximum Load Capacity
43407	3.00 m x 2.75 m / 9'10" x 9'	5	500 kg (1102 lbs)

## SETUP INSTRUCTIONS



### PARTS & TOOLS NEEDED

Compare the parts in your box to the parts listed in this manual. Verify that the equipment components represent the model that you had intended to purchase.

### RECOMMENDATIONS DURING THE INSTALLATION

- Adult assembly required.
- Due to the high elasticity of the canopy pole, extend it carefully to avoid injury.
- Fill the air chambers until most of the wrinkles are gone and it feels firm to touch but NOT hard.
- Do not over-inflate the product. Do not use an air compressor or high-pressure pump.
- Under and over-inflation of the product will result in safety hazards.

- Be sure to close and press in the safety valves after inflation.  
**NOTE:** Never stand on or rest objects on the product during inflation. Always check product for leaks before use.
- Thread the rope through the grommets around the outside of the island one by one. (Only for product with rope)  
**NOTE:** Tighten rope for a tight fit around product or loosely tie for loose fit for flexible grip.
- Fill the anchor bag with rocks or sand to weigh it down. Hang the anchor bag to make the island more stable.



## ASSEMBLY INSTRUCTIONS

- For installation instructions, follow the illustrations inside the manual. Drawings are for illustration purposes only. May not reflect actual product. Not to scale.

## DISASSEMBLY INSTRUCTIONS

1. Remove the canopy from the product.
2. Open and pinch the bottom of the valves to deflate.

## MAINTENANCE AND STORAGE

1. After use, use a damp cloth to gently clean all surfaces.  
**NOTE:** Never use solvents or other chemicals that may damage the product.
2. Store in a dry place, with a temperature higher than 15°C/59°F, out of reach of children.