

VP3276T-4K

Display User Guide

IMPORTANT: Please read this User Guide to obtain important information on installing and using your product in a safe manner, as well as registering your product for future service. Warranty information contained in this User Guide will describe your limited coverage from ViewSonic® Corporation, which is also found on our web site at <http://www.viewsonic.com> in English, or in specific languages using the Regional selection box of our website.

Model No. VS20044
P/N: VP3276T-4K

Thank you for choosing ViewSonic®

As a world-leading provider of visual solutions, ViewSonic® is dedicated to exceeding the world's expectations for technological evolution, innovation, and simplicity. At ViewSonic®, we believe that our products have the potential to make a positive impact in the world, and we are confident that the ViewSonic® product you have chosen will serve you well.

Once again, thank you for choosing ViewSonic®!

Safety Precautions

- Read these instructions completely before using the equipment.
- Keep these instructions in a safe place.
- Heed all warnings and follow all instructions.
- Sit at least 18" / 45 cm from the monitor.
- When installing the monitor, please leave 4" / 10 cm of open space around the monitor for ventilation safety purposes.
- Always handle the display with care when moving it.
- Always use cabinets or stands or installation methods recommended by the manufacturer of the monitor set.
- Always use furniture that can safely support the monitor.
- Always ensure the monitor is not overhanging the edge of the supporting furniture.
- This equipment is not suitable for use in locations where children are likely to be present.
- Always educate children about the dangers of climbing on furniture to reach the monitor or related equipment.
- Always route and manage cords and cables connected to your monitor so they cannot be tripped over, pulled, or grabbed.
- Exercise caution when removing the rear cover of the monitor. This monitor contains high-voltage parts.
- Do not use this equipment near water. To reduce the risk of fire or electric shock, do not expose the monitor to rain or moisture.
- Avoid exposing the monitor to direct sunlight or other sources of sustained heat. Do not install near any heat sources such as radiators, heat registers, stoves, or other devices (including amplifiers) that may increase the temperature of the monitor to dangerous levels.
- Clean with a soft, dry cloth. If further cleaning is required, see the "Maintenance" section in this guide for further instructions.
- Avoid touching the screen. Skin oils are difficult to remove.
- Do not touch, rub, or apply pressure to the monitor screen, as it may permanently damage the screen.
- Do not place the monitor in an unstable location.
- Do not place the monitor on tall furniture (for example, cupboards or bookcases) without anchoring both the furniture and the monitor to a suitable support.
- Do not place the monitor on cloth or other materials that may be located between the product and supporting furniture.

- Place the monitor in a well-ventilated area. Do not place anything on the display that prevents heat dissipation.
- Do not place heavy objects on the display, video cable, or power cord.
- Do not place items that might tempt children to climb, such as toys and remote controls, on the top of the monitor or furniture on which the product is placed.
- If smoke appears, an abnormal noise, or a strange odor is present, immediately switch the display off and contact your dealer or ViewSonic. It is dangerous to continue using the display.
- Do not attempt to circumvent the safety provisions of the polarized or grounding-type plug. A polarized plug has two blades with one wider than the other. A grounding type plug has two blades and a third grounding prong. The wide blade and the third prong are provided for your safety. If the plug does not fit into your outlet, obtain an adaptor and do not attempt to force the plug into the outlet.
- Please confirm the distribution system installed in the building. The system should provide a circuit breaker rated at 120/240V, 20A.
- When connecting to a power outlet, DO NOT remove the grounding prong. Please ensure grounding prongs are NEVER REMOVED.
- Protect the power cord from being treaded upon or pinched, particularly at the plug, and at the point where it emerges from the equipment. Be sure that the power outlet is located near the equipment so that it is easily accessible.
- Only use attachments/accessories specified by the manufacturer.
- Use only with the cart, stand, tripod, bracket, or table specified by the manufacturer, or sold with the equipment. When a cart is used, use with caution when moving the cart/equipment combination to avoid injury from tipping over.
- Unplug this equipment when it will be unused for long periods of time.
- Refer all servicing to qualified service personnel. Service will be required when the unit has been damaged in any way, such as: if the power-supply cord or plug is damaged, if liquid is spilled onto or objects fall into the unit, if the unit is exposed to rain or moisture, or if the unit does not operate normally or has been dropped.
- Excessive sound volume from ear-/headphones may cause hearing damage/hearing loss.
- Adjustment of the volume control as well as the equalizer may increase the ear-/headphones output voltage and therefore, the sound volume level.
- The factors influencing the ear-/headphones output other than those specified by the manufacturer (e.g. operating system, equalizer software, firmware, driver) may increase the ear-/headphone output voltage and therefore, the sound volume level.

- **Stability Hazard:** The display may fall, causing serious personal injury or death. To prevent injury, this display must be securely attached to the floor/wall in accordance with the installation instructions.
- Fastening the monitor to a wall or fixed object using cordage or other restraining devices can help support the weight of the monitor in order to prevent the monitor from falling over.

Hole pattern (W x H)	Screw Specification	Screw Quantity
100 x 100 mm	M4 x 10 mm	4

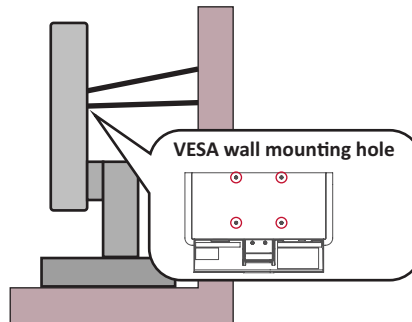

Note:

- Restraining device/cordage should be able to withstand 100N force.
- Make sure the cordage is straightened, and any slack is removed. The back of the device shall face the wall to ensure the device cannot tilt under external force.
- Make sure the monitor does not tilt under external force at any height and rotation angle of the device.
- If the existing monitor is going to be retained and relocated, the same considerations as above should be applied.

Contents

Safety Precautions	3
Introduction	8
Package Contents	8
Product Overview	9
Initial Setup	10
Installing the Stand	10
Removing the Stand	11
Mounting the Monitor.....	11
Using the Security Slot.....	12
Making Connections	13
Connecting to Power	13
Connecting to Video	14
HDMI	14
DisplayPort	15
Thunderbolt	16
Thunderbolt Daisy Chain Connectivity	17
USB Connection	18
Using the USB Ports.....	19
Audio Connection	20
Network Connection.....	21
Using the Monitor	22
Adjusting the Viewing Angle.....	22
Height Adjustment	22
Screen Orientation Adjustment (Monitor Pivot).....	23
Swivel Angle Adjustment.....	24
Tilt Angle Adjustment.....	25
Turning the Monitor On/Off.....	26
Using the Joy Key	26
Startup Menu	27
Hot Keys	30
Configuring the Settings	33
General Operations	33
On-Screen Display (OSD) Menu Tree	35
Menu Options	47

Advanced Features and Settings	54
Auto Pivot	54
Colorbration+	55
Color Temp. Light	56
Dual Color	57
Firmware Update.....	58
HDR (High-Dynamic-Range).....	59
KVM	60
Multi-Picture.....	62
PBP (Picture-by-Picture).....	63
PIP (Picture-in-Picture).....	64
Appendix	65
Specifications.....	65
Glossary	67
Troubleshooting	72
Maintenance.....	74
General Precautions.....	74
Cleaning the Screen.....	74
Cleaning the Case	74
Blue Light Filter and Eye Health.....	75
Calculating Breaks	75
Looking at Distant Objects	75
Eye and Neck Exercises	75
Regulatory and Service Information	76
Compliance Information.....	76
FCC Compliance Statement.....	76
Industry Canada Statement.....	76
CE Conformity for European Countries.....	76
Declaration of RoHS2 Compliance.....	77
Indian Restriction of Hazardous Substances	78
Product Disposal at End of Product Life	78
Copyright Information	79
Customer Service	80
Limited Warranty	81
Mexico Limited Warranty.....	84

Introduction

Package Contents

- Monitor
- Power adapter
- Video cable
- Quick start guide

Note: The cables included in your package may vary depending on your country. Please contact your local reseller for more information.

Product Overview

Front and Rear View

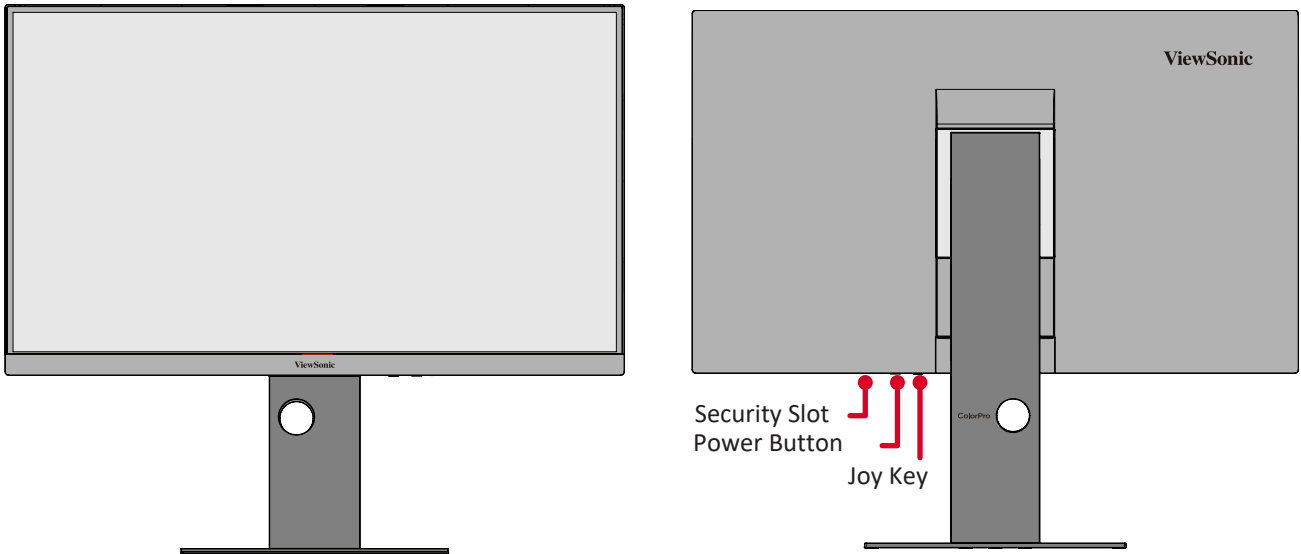

Bottom View

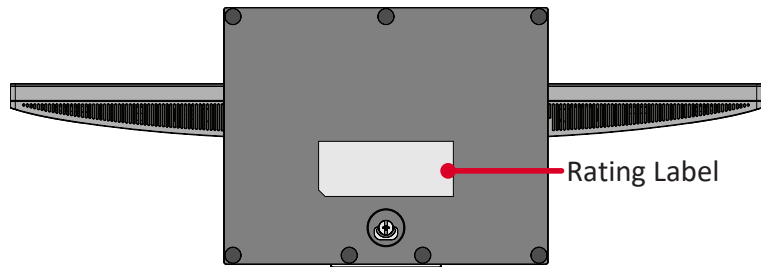

I/O Ports

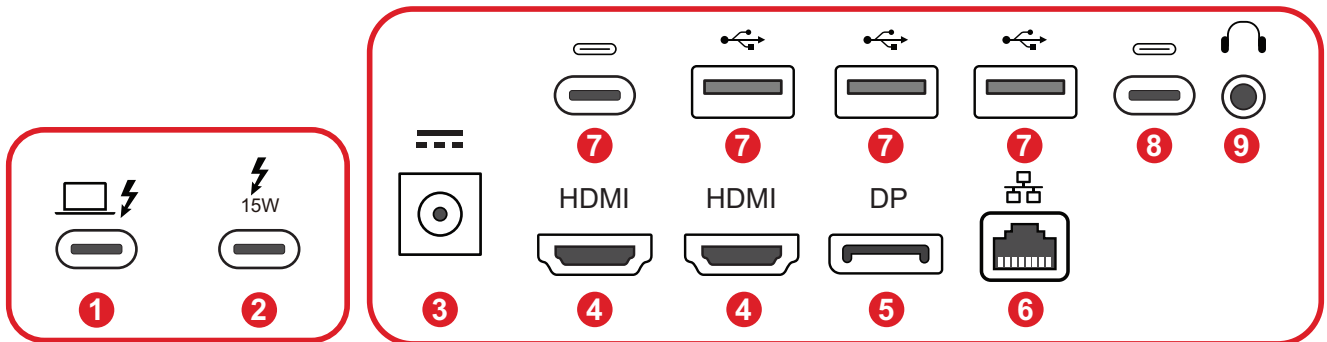

- 1. Thunderbolt In
- 2. Thunderbolt Out
- 3. DC IN
- 4. HDMI
- 5. DisplayPort
- 6. LAN
- 7. USB Downstream
- 8. USB Upstream
- 9. Audio Out

Note: For more information about the **Joy Key** and its functions, please see “Using the Joy Key”.

Initial Setup

Installing the Stand

1

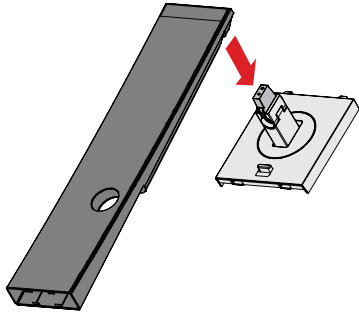

2

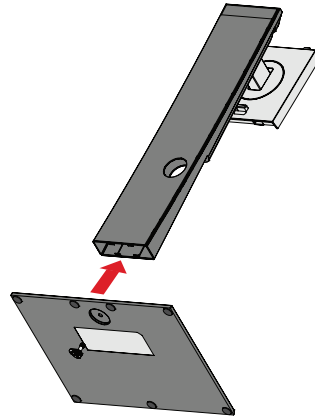

3

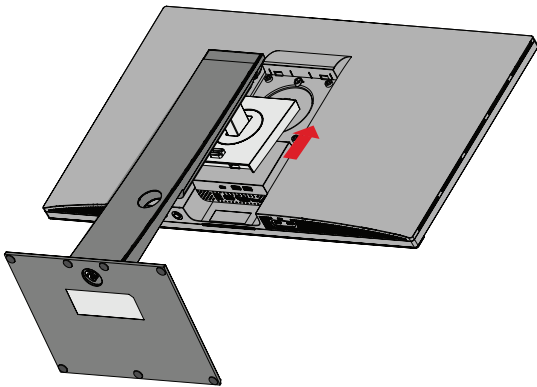

4

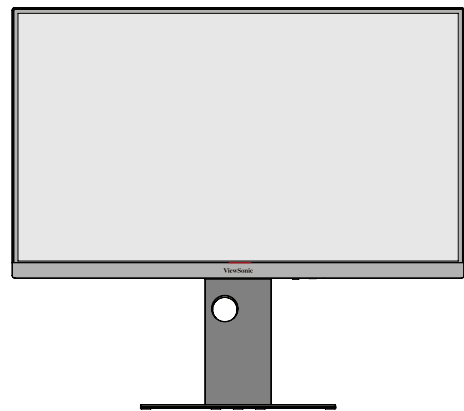

1. Attach the monitor stand's neck to the VESA cover until it clicks into place.
2. Connect the monitor stand's neck to the monitor stand's base with the captive screw.
3. Place the monitor on a flat, stable surface with the screen facing down, then align and slide the upper hooks of the monitor stand into the stand mounting slots.
4. Lift the monitor into its upright position on a flat, stable surface.

NOTE: Place the monitor on a flat, stable surface to ensure safety and optimal performance.

Removing the Stand

1

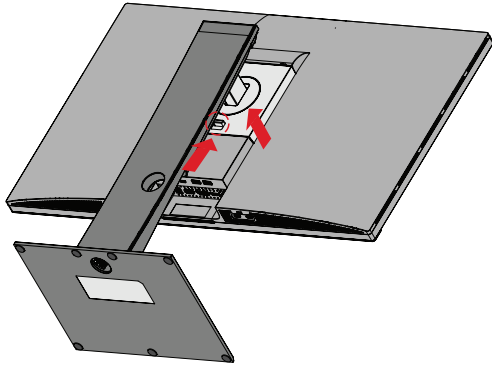

2

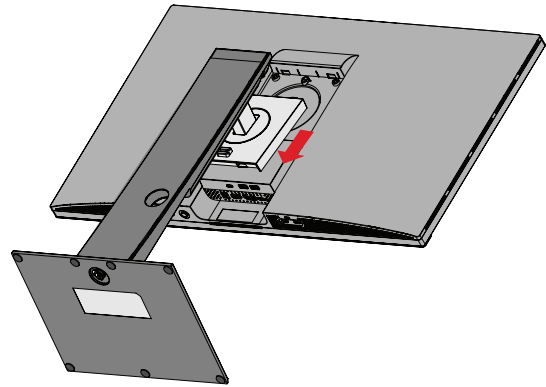

IMPORTANT: Before removing the stand, turn off the monitor, disconnect all cables, and place the monitor on a flat, stable surface with the screen facing down.

1. Press and hold the quick release tab and carefully lift the stand.
2. Pull down slightly to disengage the hooks and remove the stand.

Mounting the Monitor

After removing the stand, the monitor can be mounted using an optional mounting kit.

NOTE: For use only with a UL certified mounting kit. To obtain a mounting kit or height adjustment base, contact ViewSonic® or your local dealer.

Refer to the table below for the standard dimensions for mounting kits.

Maximum Loading	Hole pattern (W x H)	Screw Specification	Screw Quantity
14 kg	100 x 100 mm	M4 x 10 mm	4

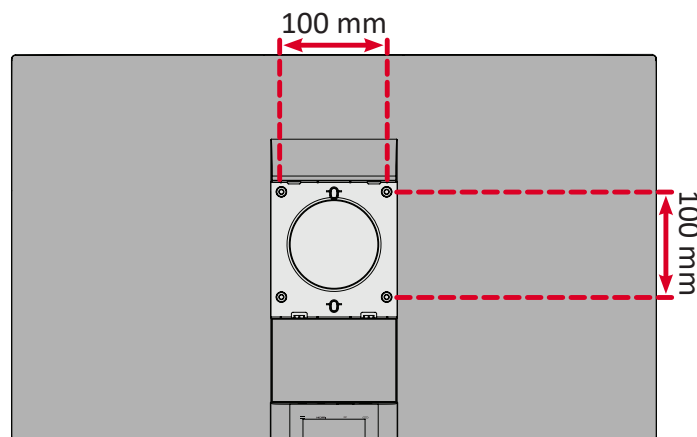

1. Attach the mounting bracket to the VESA mounting holes at the rear of the monitor, securing it with four M4 x 10 mm screws.
2. Follow the mounting kit instructions to mount the monitor.

Using the Security Slot

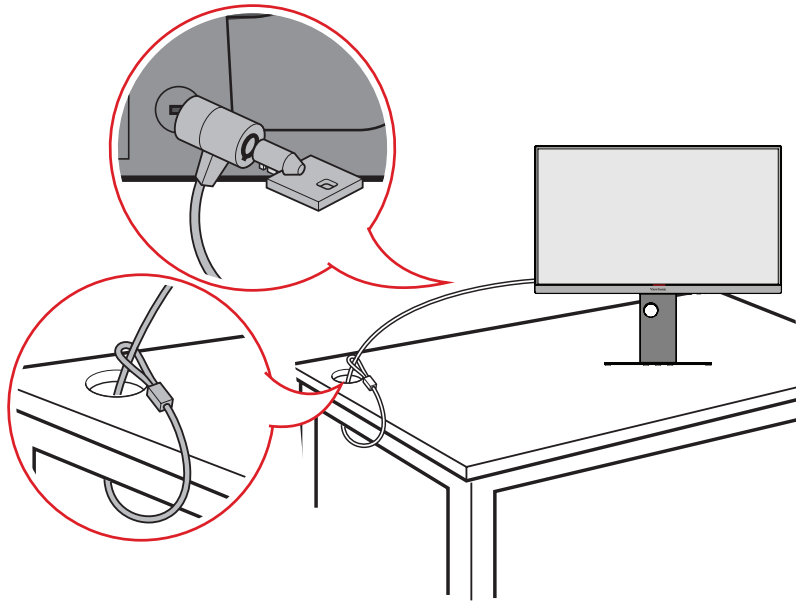

To help prevent the monitor from being stolen, use a security slot locking device to secure the monitor to a fixed object.

Additionally, fastening the monitor to a wall or fixed object using a security cable can help support the weight of the monitor in order to prevent the monitor from falling over.

Making Connections

Connecting to Power

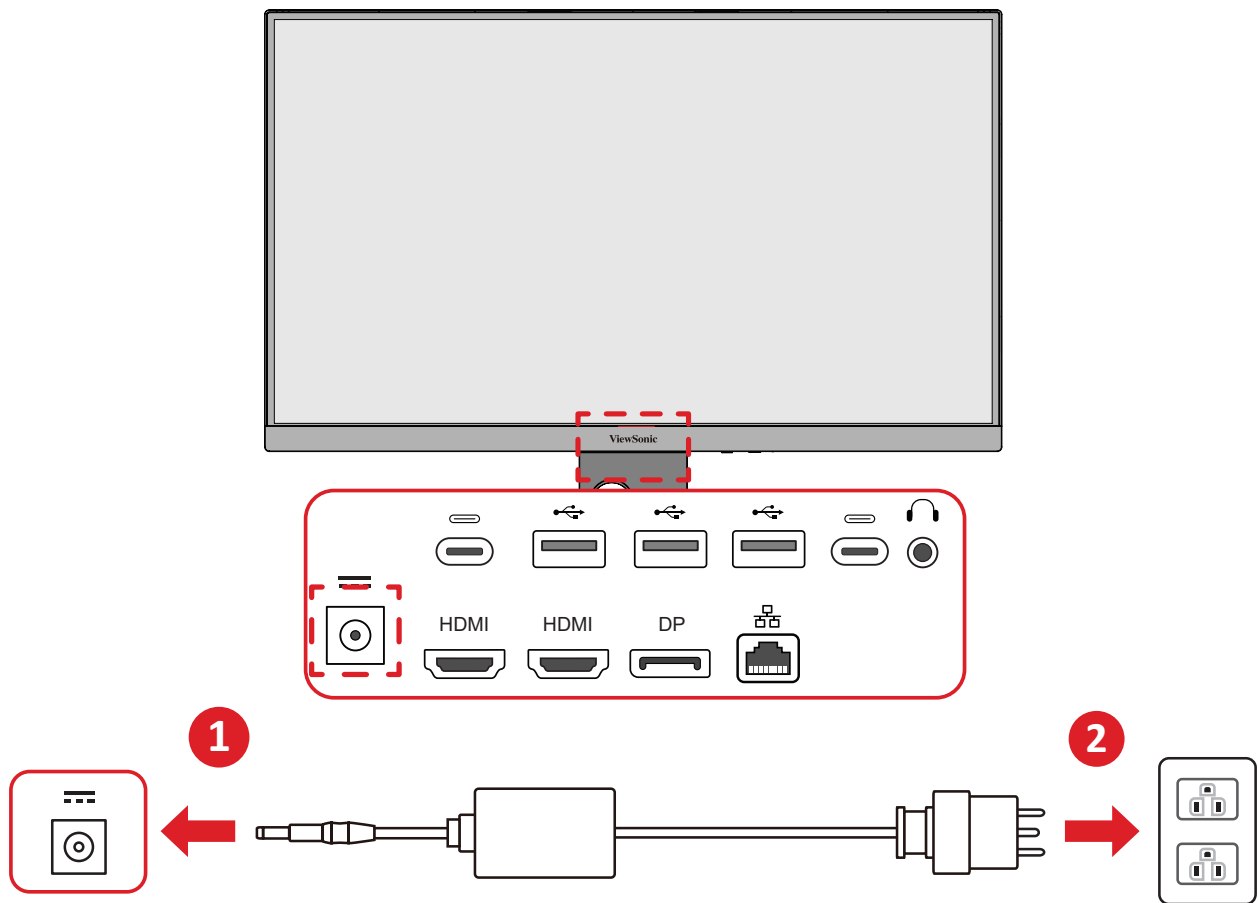

1. Connect the power adapter to the **DC IN** jack at the rear of the monitor.
2. Plug the power adapter plug into a power outlet.

DisplayPort

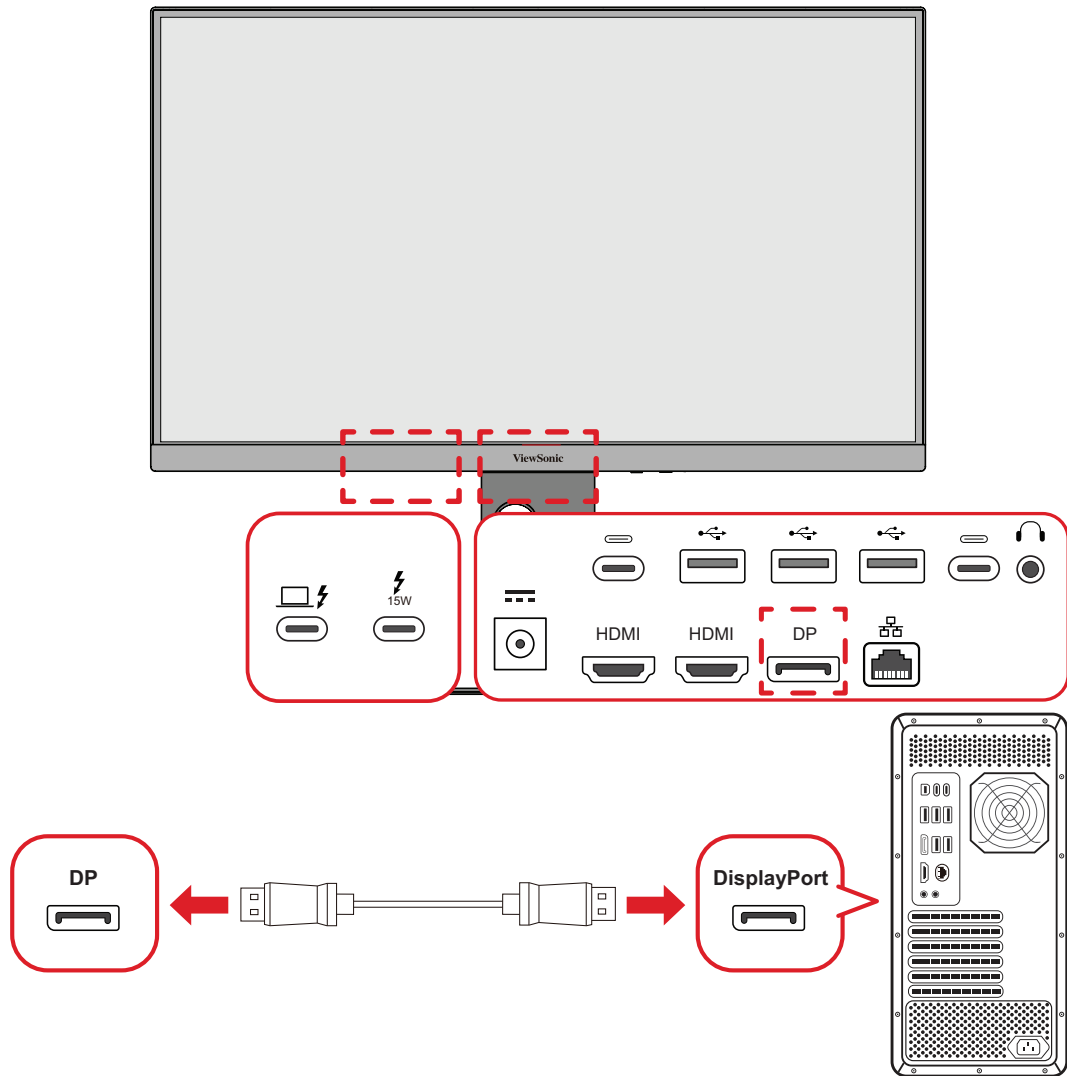

1. Connect one end of a DisplayPort cable to the **DP** port of the monitor.
2. Plug the other end of the cable into the DisplayPort or Mini DisplayPort port of your computer.

Note: To connect the monitor to the Thunderbolt port (v. 1 & 2) on your Mac, connect the Mini DisplayPort end of a “Mini DisplayPort to DisplayPort cable” to the Thunderbolt output port of your Mac. Then connect the other end of the cable to the DisplayPort port of the monitor.

Thunderbolt

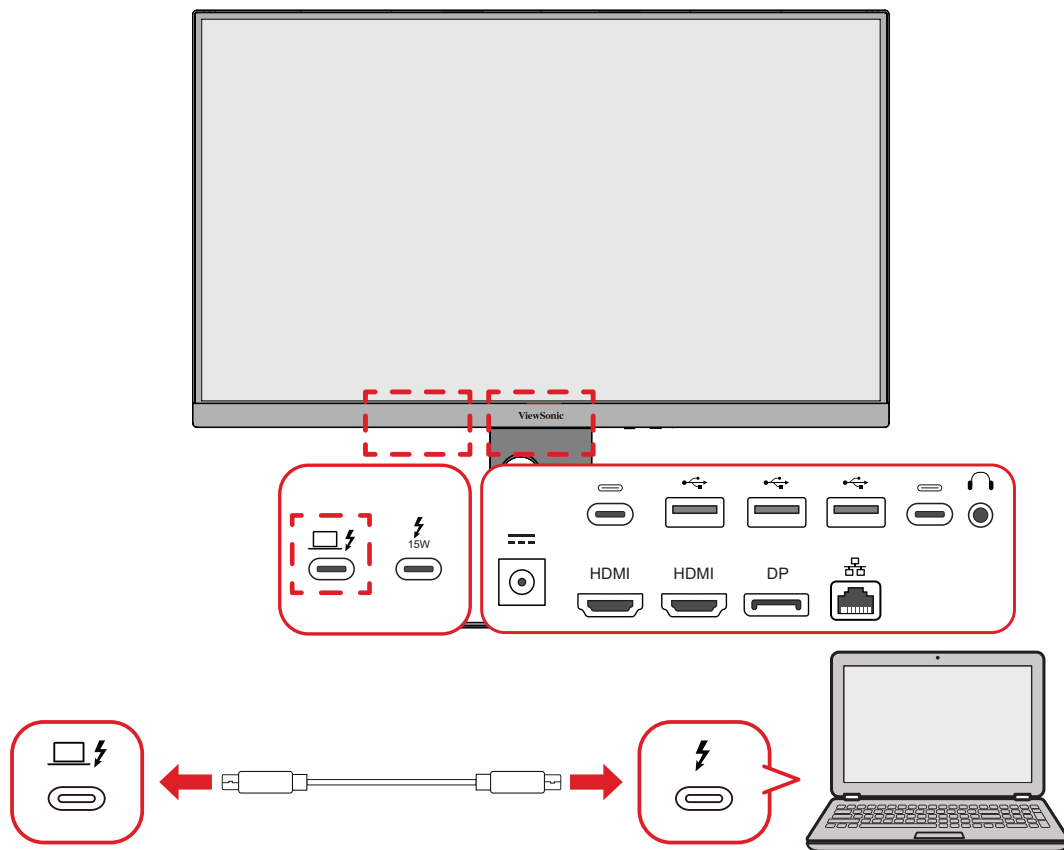

1. Connect one end of a Thunderbolt cable to the **Thunderbolt In** port of the monitor.
2. Plug the other end of the cable into the Thunderbolt port of your computer.

Note:

- The Thunderbolt and USB Type C port supports video, data transfer, and up to 100W power delivery; actual functionality depends on your device's Thunderbolt and USB Type C specifications.
- For proper operation, please ensure your device supports DisplayPort Alt Mode and USB Power Delivery (PD), and avoid using Thunderbolt or USB Type C charging and DC power on the laptop at the same time.

Thunderbolt Daisy Chain Connectivity

With one Thunderbolt In port and one Thunderbolt Out port, you can daisy chain up to two of ViewSonic's 4K (3840 x 2160) @ 60 Hz monitors, while maintaining the full 40 Gbps Thunderbolt bandwidth for video, data, and power delivery.

Example of Maximum Number of the VP3276T-4K Monitors



Note:

- The diagram is provided for reference only. The number of monitors you can connect to your system depends on your graphics card compatibility and monitor resolution.
- A laptop's screen can be counted as one monitor.
- Please use Thunderbolt 4 certified cables with the Thunderbolt 4 icon shown.

USB Connection

The monitor supports two types of USB ports, upstream and downstream. When making connection(s), observe the following guidelines.

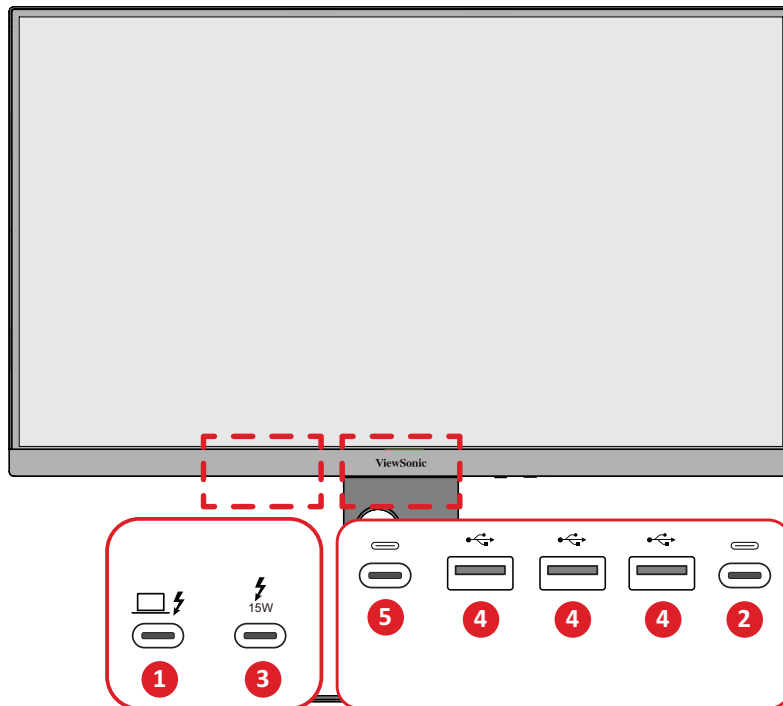

USB Type	Connection Type	Description
1	Upstream	Thunderbolt
2		Type C
3	Downstream	Thunderbolt
4		Type A
5		Type C

Note: To use peripheral devices with the downstream USB Type A and Type C ports, please also connect your computer to the monitor’s **Thunderbolt In** port.

Using the USB Ports

1. To use the downstream USB ports, connect one end of a Thunderbolt cable to the upstream **Thunderbolt In** port of the monitor. Plug the other end of the cable, into a Thunderbolt port of your computer.
2. Connect your peripheral device(s) to a downstream USB Type A or Type C port of the monitor.

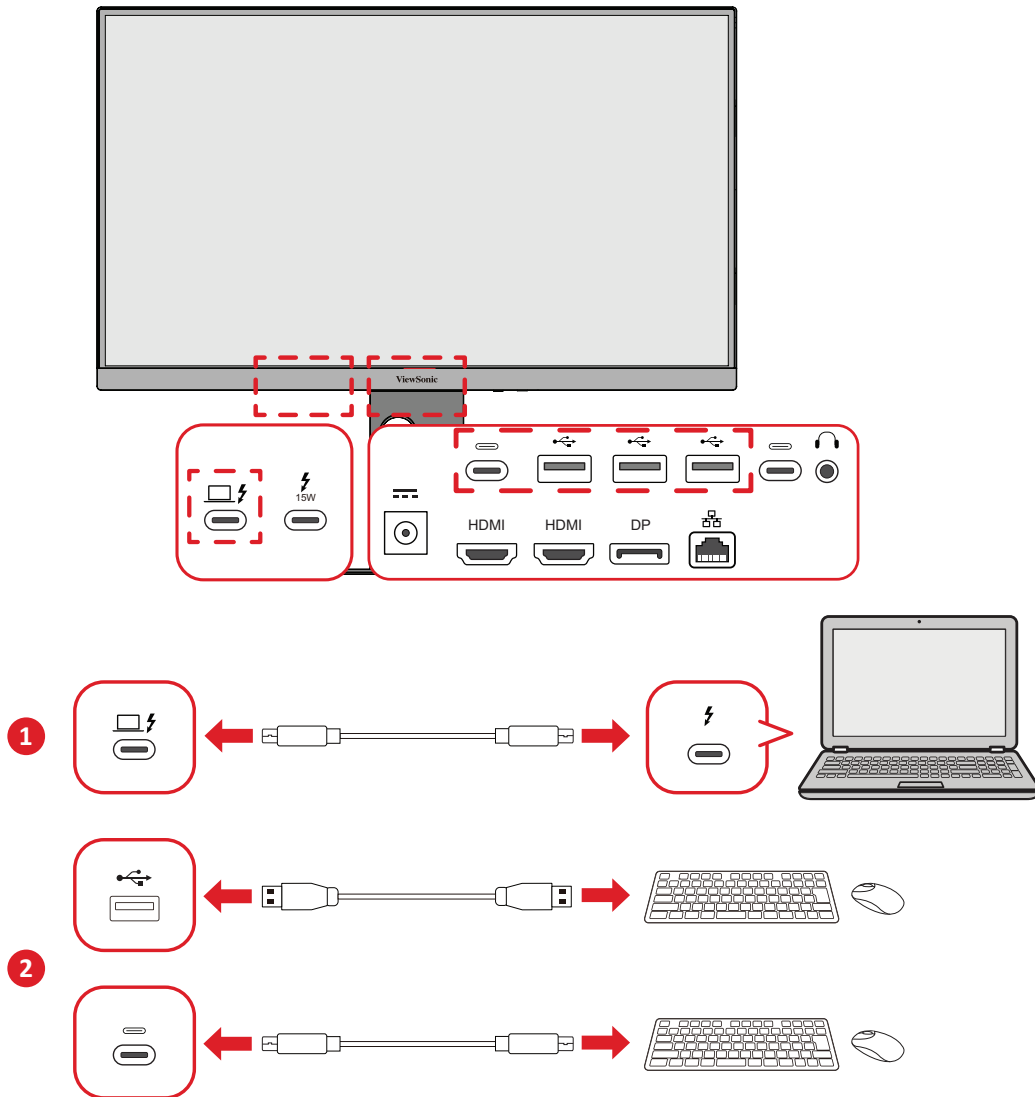

Network Connection

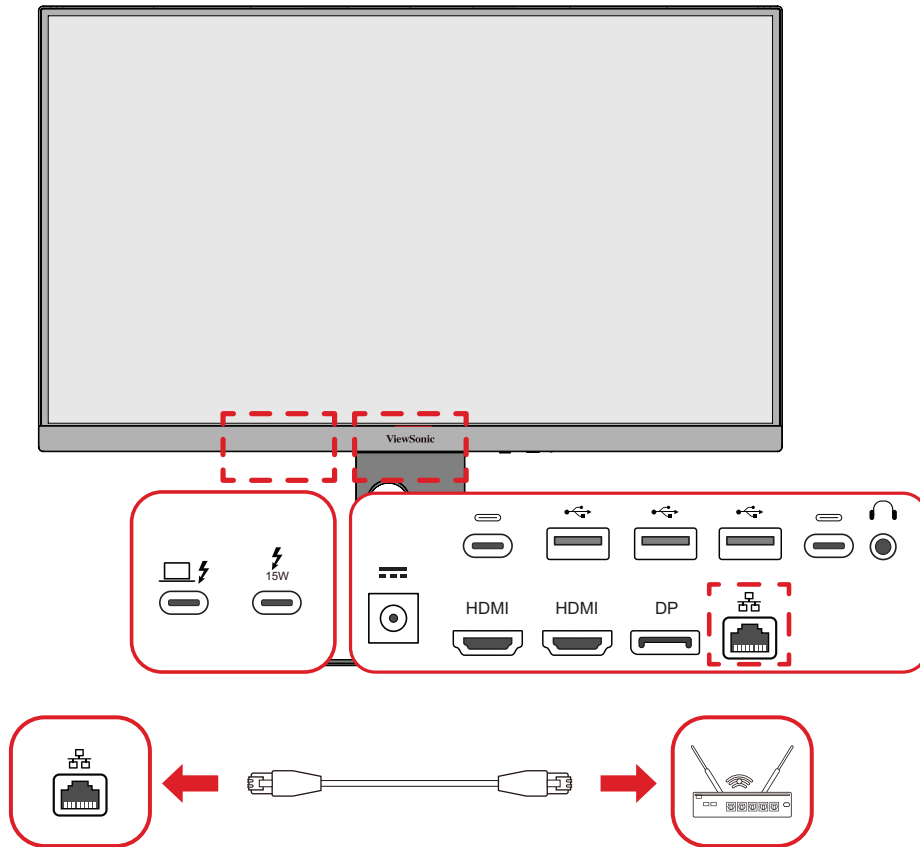

1. Connect one end of an Ethernet cable to the **LAN** port of the monitor.
2. Plug the other end of the cable into your network device.

Note: To use the network connection on your connected computer, please make sure your computer is also connected to the monitor by one of its USB upstream ports.

Using the Monitor

Adjusting the Viewing Angle

Height Adjustment

Lower or raise the monitor to the desired height (0 to 120 mm).

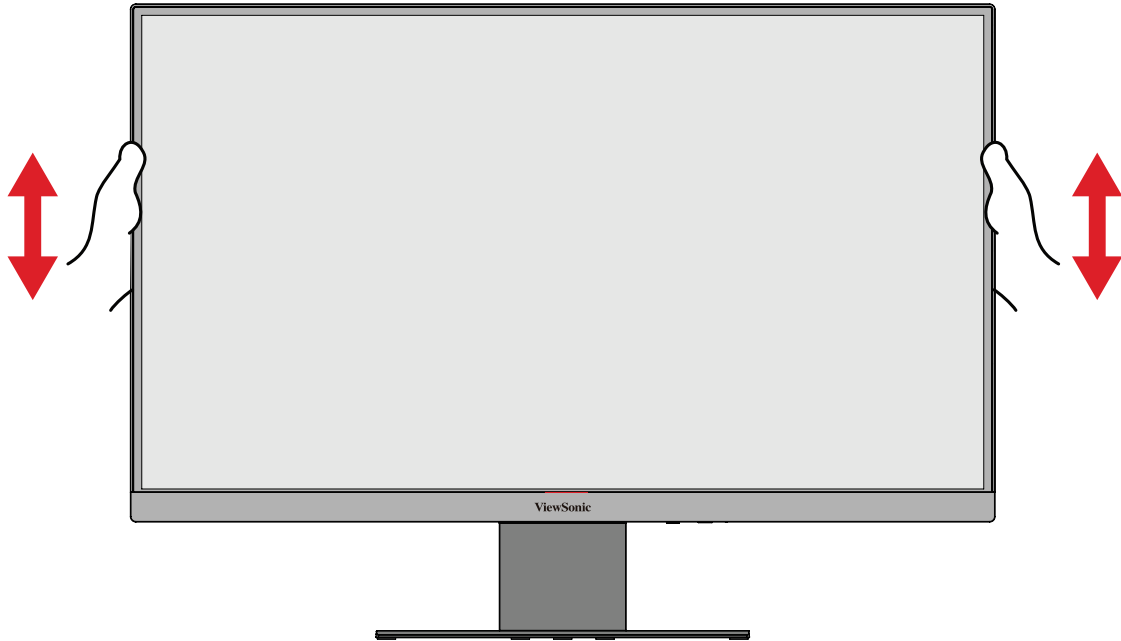

Note: When adjusting, press down firmly along the adjustment track holding the monitor with both hands on the side.

Screen Orientation Adjustment (Monitor Pivot)

1. Adjust the monitor height to the highest position. Then tilt the monitor backwards to the full tilt position.

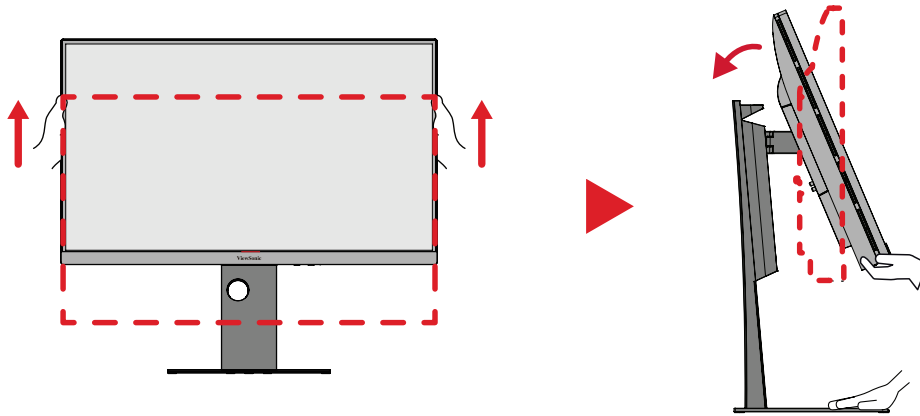

2. Rotate the monitor 90 degrees clockwise or counterclockwise from landscape to portrait orientation.

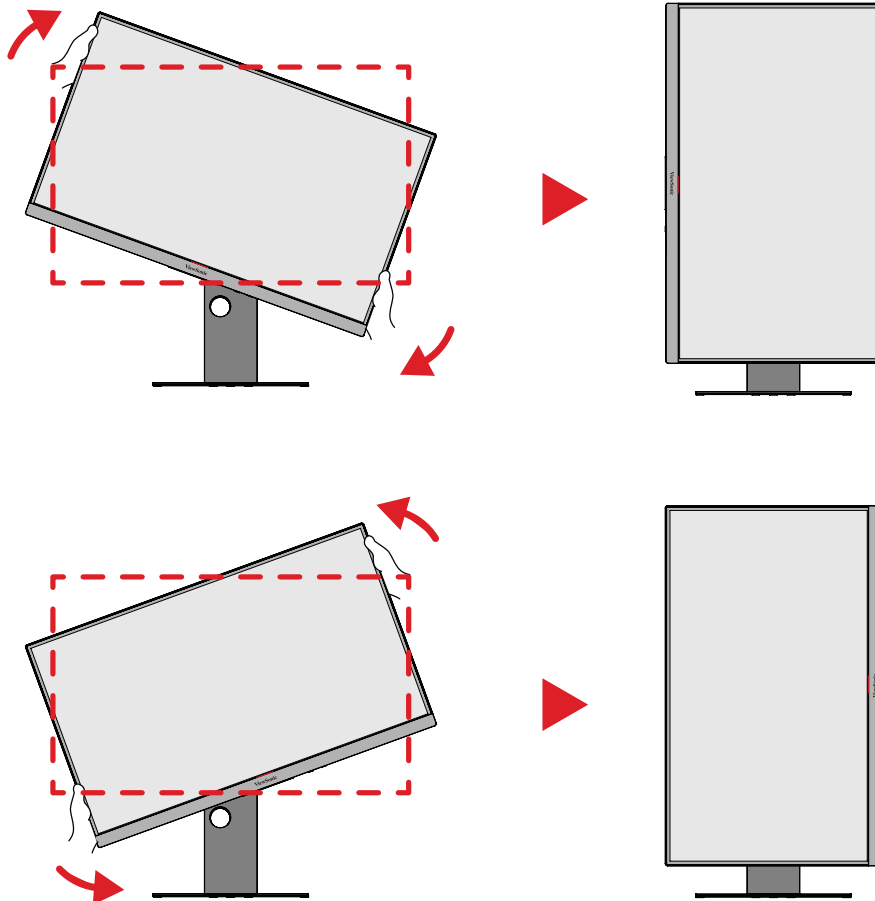

Note:

- When adjusting, make sure to hold both sides of the monitor firmly with both hands.
- If using the Auto Pivot function, the system can detect the screen orientation automatically.

Swivel Angle Adjustment

Swivel the monitor to the left or right for the desired viewing angle ($\pm 30^\circ$).

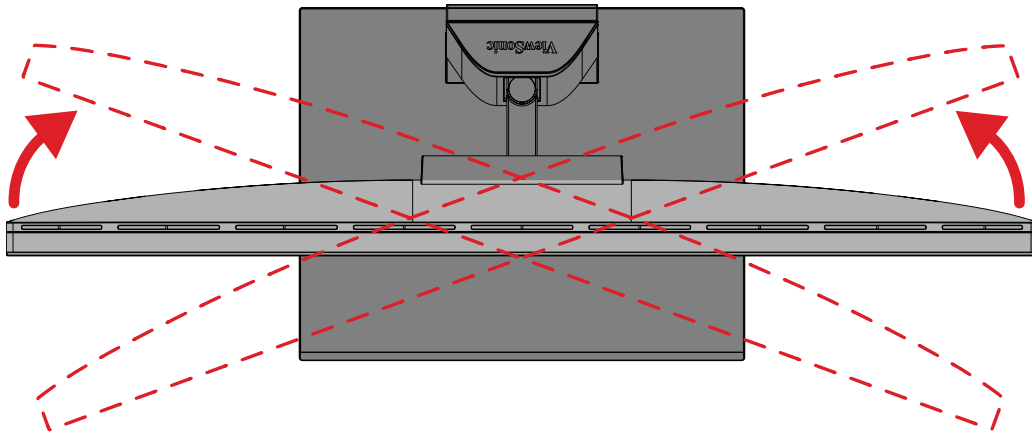

Tilt Angle Adjustment

Tilt the monitor forwards or backwards to the desired viewing angle (-5° to 22°).

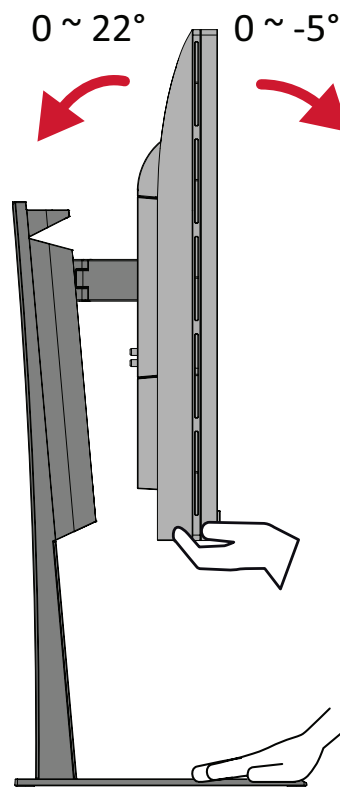

Note: When adjusting, support the stand firmly with one hand while tilting the monitor forwards or backwards with the other hand.

Turning the Monitor On/Off

Note: The monitor will still consume some power as long as the power cord is connected to the power outlet. If the monitor is not being used for a long period of time, please disconnect the power plug from the power outlet.

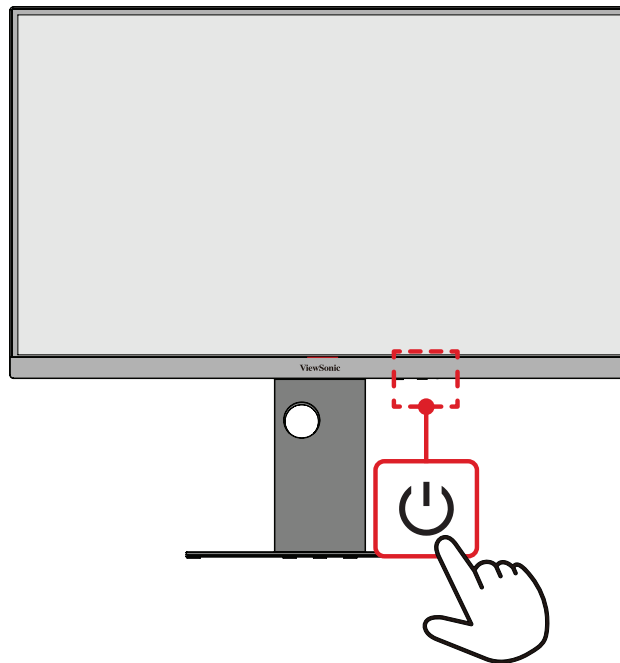

1. Plug the connected power adapter into a power outlet.
2. Press the **Power** button to turn on the monitor.
3. To turn the monitor off, press the **Power** button again.

Note: If the OSD Menu is still on screen, press and hold the **Power** button for three seconds to power off.

Using the Joy Key

Use the **Joy Key** to activate Hot Keys, navigate the On-Screen Display Menu, and change settings.

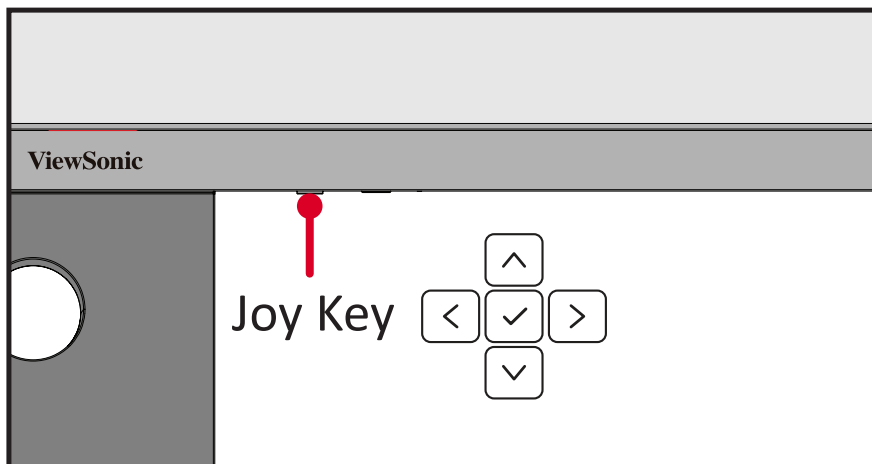

Startup Menu

Move the **Joy Key** (↓) to activate the Startup Menu.

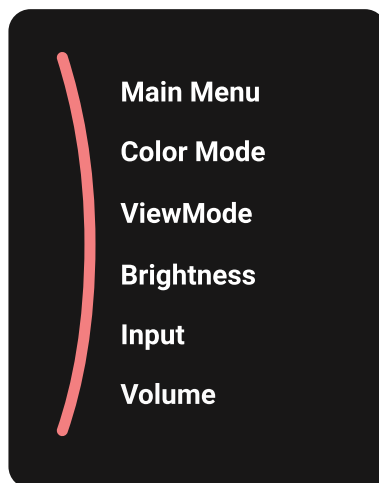

Note: Follow the key guide that appears on the screen to select the option or make adjustments.

Main Menu

Enter the On-Screen Display Menu.

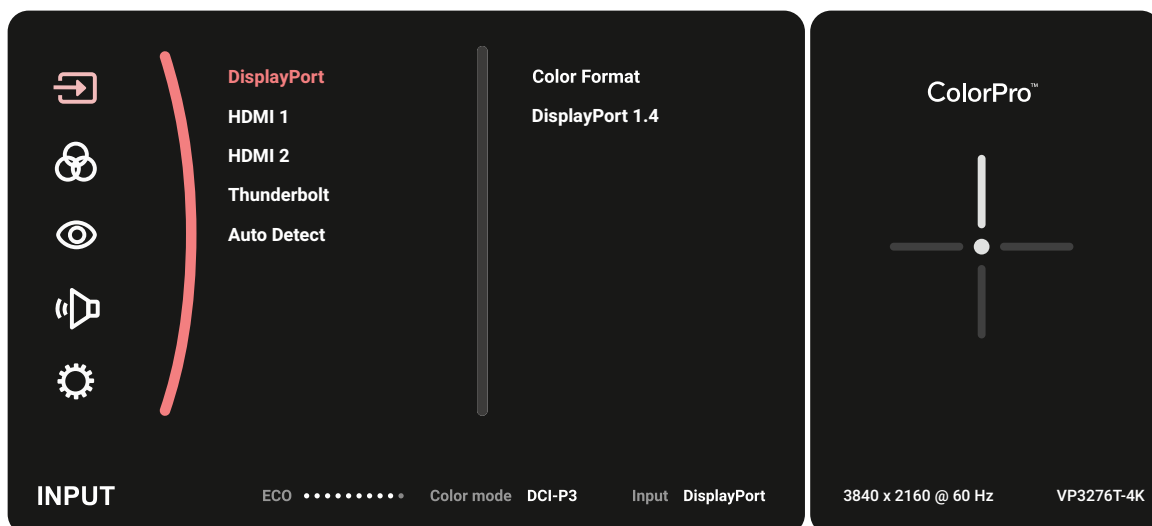

Color Mode

Select one of the preset standard color settings.

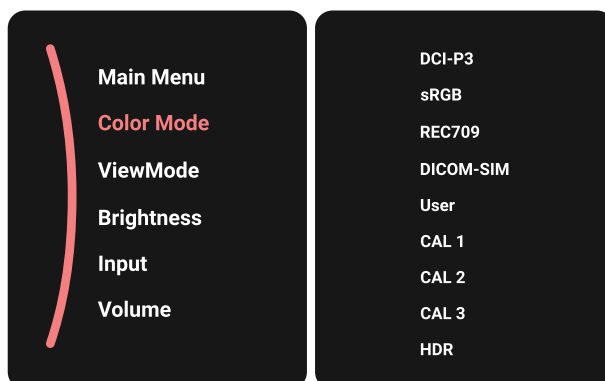

ViewMode

Select one of the preset display settings.

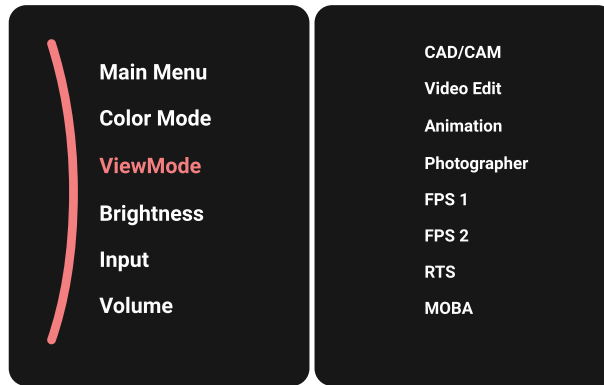

Brightness

Adjust the brightness level.

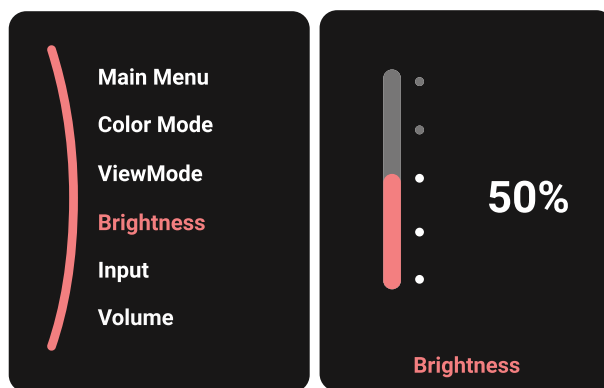

Input

Select the input source.

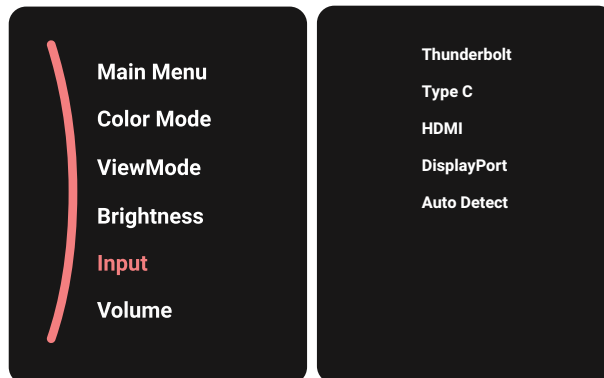

Volume

Adjust the volume settings.

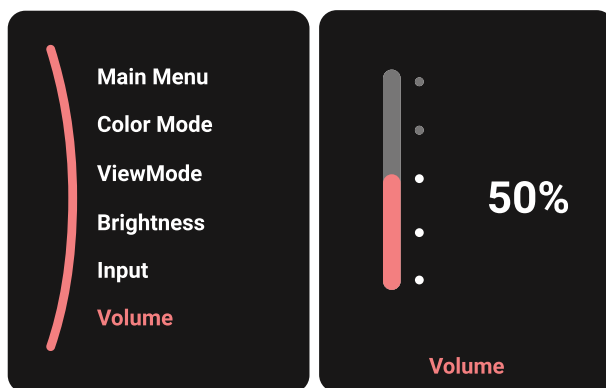

Note: Move the Joy Key (←) to return to the previous menu.

Hot Keys

When the On-Screen Display (OSD) Menu is off, you can quickly access special functions by using the **Joy Key**.

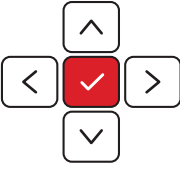
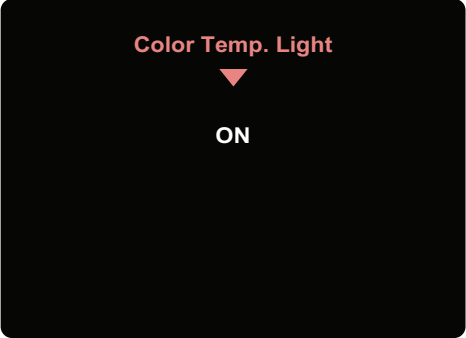
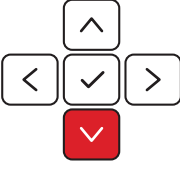
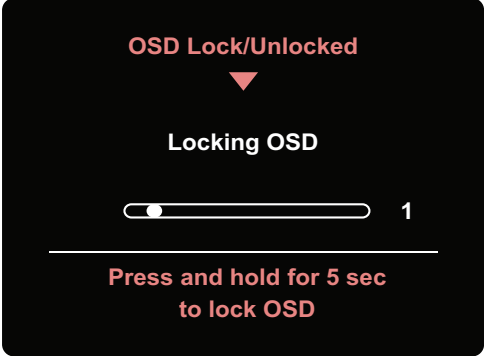
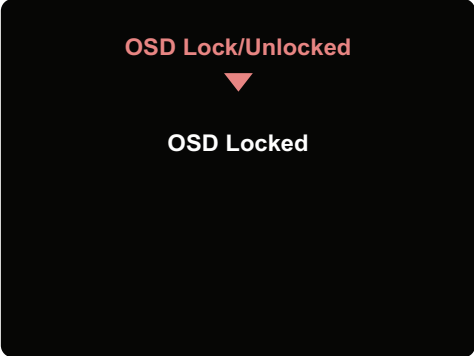
Key	Description
	<p>Press and hold the key for five seconds to turn on/off color temperature light.</p> 
	<p>Move and hold the key to lock/unlock the OSD Menu.</p> <p>When the menu appears on the screen, continue holding the key for 10 seconds to lock/unlock the OSD Menu.</p>  <p>If the OSD Menu is locked, the below message will appear on the screen:</p> 

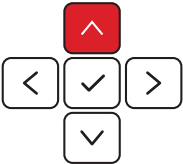
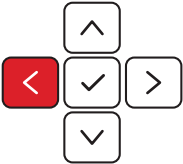
Key	Description
	<p>Move and hold the key to lock/unlock the Power button.</p> <p>When the menu appears on the screen, continue holding the key for 10 seconds to lock/unlock the Power button.</p> <div data-bbox="655 369 1141 719" style="background-color: black; color: white; padding: 10px; text-align: center;"> <p>Power Lock/Unlocked</p> <p>▼</p> <p>Locking Power Button</p> <p>▬ 1</p> <p>Press and hold for 5 sec to lock Power</p> </div> <p>If the Power button is locked, the below message will appear on the screen:</p> <div data-bbox="655 880 1141 1229" style="background-color: black; color: white; padding: 10px; text-align: center;"> <p>Power Lock/Unlocked</p> <p>▼</p> <p>Power Button Locked</p> </div>
	<p>When Power Indicator is turned off in the OSD Menu, move and hold the key for 10 seconds to display/hide the boot up screen when the device is turned on.</p> <div data-bbox="665 1415 1131 1751" style="background-color: black; color: white; padding: 10px; text-align: center;"> <p>Logo Boot Up Screen On/Off</p> <p>▼</p> <p>Off</p> <p>▬</p> <p>Press to turn On</p> </div>

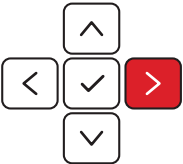
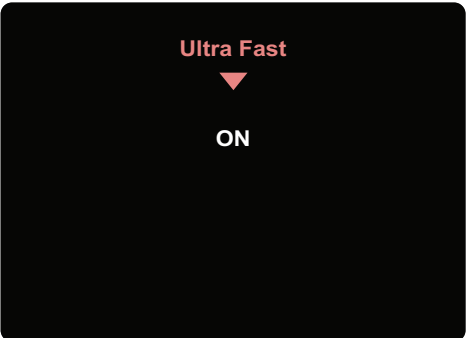
Key	Description
	<p>When Color Temperature is set to Panel Default in the OSD Menu for any Color Mode and the Response Time is set to Ultra Fast, move and hold the key for 10 seconds to turn on/off Ultra Fast response time.</p> 

Configuring the Settings

General Operations

1. Move the **Joy Key** (↓) to display the Startup Menu. Then navigate to **Main Menu** and press the **Joy Key** to display the OSD Menu.



2. Move the **Joy Key** (↑/↓) to select the main menu. Then press the **Joy Key** to enter the selected menu.

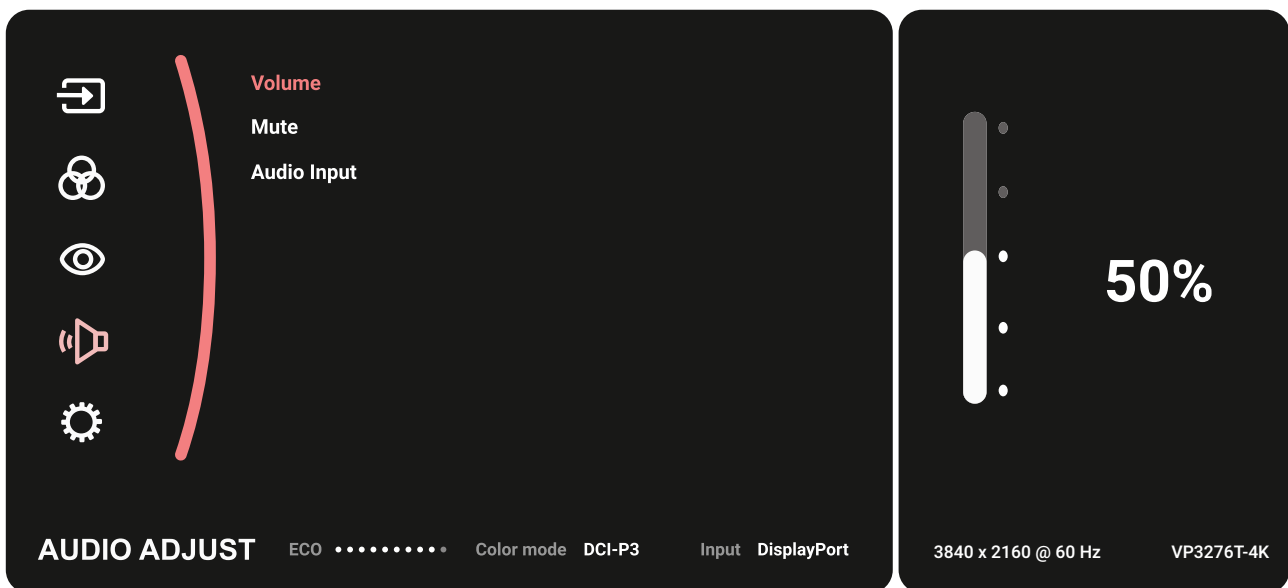

3. Move the Joy Key (↑/↓) to select the desired menu option. Then press the Joy Key to enter the sub-menu.



4. Move the Joy Key (↑/↓) to adjust/select the setting. Then press the Joy Key to confirm.



5. Move the Joy Key (←) to return to the previous menu.

On-Screen Display (OSD) Menu Tree

Main Menu	Sub-menu	Menu Option	
Input	DisplayPort	Color Format	Auto
			RGB (Full Range)
			RGB (Limited Range)
			YUV (Full Range)
			YUV (Limited Range)
		DisplayPort 1.4	On
			Off
	HDMI 1	Color Format	Auto
			RGB (Full Range)
			RGB (Limited Range)
			YUV (Full Range)
			YUV (Limited Range)
		HDMI 2.0	On
			Off
	HDMI 2	Color Format	Auto
			RGB (Full Range)
			RGB (Limited Range)
			YUV (Full Range)
			YUV (Limited Range)
		HDMI 2.0	On
			Off
	Thunderbolt	Color Format	Auto
			RGB (Full Range)
			RGB (Limited Range)
			YUV (Full Range)
			YUV (Limited Range)
		Thunderbolt Charging	On
			Off
		High Resolution	On
			Off
DisplayPort 1.4		On	
		Off	
Auto Detect		On	
		Off	

Main Menu	Sub-menu	Menu Option	
Color Mode	DCI-P3	Brightness	(-/+ , 0~100)/1
		Color Temperature	Panel Default
			9300K
			7500K
			6500K
			6300K
			5000K
		Gamma	DCI-P3
			1.0
			1.4
			1.8
			2.2
			2.4
			2.6
		Sharpness	(-/+ , 0~100)/1
		Aspect Ratio	1:1
			4:3
			Full Screen
		Uniformity	On
			Off
Recall			

Main Menu	Sub-menu	Menu Option	
Color Mode	sRGB	Brightness	(-/+ , 0~100)/1
		Color Temperature	Panel Default
			9300K
			7500K
			6500K
			6300K
			5000K
		Gamma	sRGB
			1.0
			1.4
			1.8
			2.2
			2.4
			2.6
		Sharpness	(-/+ , 0~100)/1
		Aspect Ratio	1:1
			4:3
			Full Screen
		Uniformity	On
			Off
Recall			

Main Menu	Sub-menu	Menu Option	
Color Mode	REC709	Brightness	(-/+ , 0~100)/1
		Color Temperature	Panel Default
			9300K
			7500K
			6500K
			6300K
			5000K
		Gamma	REC709
			1.0
			1.4
			1.8
			2.2
			2.4
		2.6	
	Sharpness	(-/+ , 0~100)/1	
	Aspect Ratio	1:1	
		4:3	
		Full Screen	
	Uniformity	On	
		Off	
Recall			
DICOM-SIM	Sharpness	(-/+ , 0~100)/1	
	Aspect Ratio	1:1	
		4:3	
		Full Screen	
Recall			

Main Menu	Sub-menu	Menu Option		
Color Mode	User	Contrast	(-/+ , 0~100)/1	
		Brightness	(-/+ , 0~100)/1	
		Color Temperature	Panel Default	
			9300K	
			7500K	
			6500K	
			6300K	
			5000K	
		Gamma	Panel Default	
			1.0	
			1.4	
			1.8	
			2.2	
			2.4	
			2.6	
		Advanced DCR	(-/+ , 0~100)/25	
		Gain	Red	(-/+ , 0~100)/1
			Green	(-/+ , 0~100)/1
			Blue	(-/+ , 0~100)/1
		Offset	Red	(-/+ , 0~100)/1
			Green	(-/+ , 0~100)/1
			Blue	(-/+ , 0~100)/1
		Hue	Red	(-/+ , 0~100)/1
Green	(-/+ , 0~100)/1			
Blue	(-/+ , 0~100)/1			
Cyan	(-/+ , 0~100)/1			
Magenta	(-/+ , 0~100)/1			
Yellow	(-/+ , 0~100)/1			

Main Menu	Sub-menu	Menu Option			
Color Mode	User	Saturation	Red	(-/+ , 0~100)/1	
			Green	(-/+ , 0~100)/1	
			Blue	(-/+ , 0~100)/1	
			Cyan	(-/+ , 0~100)/1	
			Magenta	(-/+ , 0~100)/1	
			Yellow	(-/+ , 0~100)/1	
		Sharpness	(-/+ , 0~100)/1		
		Aspect Ratio	1:1		
			4:3		
			Full Screen		
		Blue Light Filter	(-/+ , 0~100)/1		
		Uniformity	On		
			Off		
		Recall			
	CAL1/CAL2/ CAL3	Brightness	(-/+ , 0~100)/1		
		Color Calibration Notice	Result		
			Remind Schedule Hour		
			Counter Hour		
			Recall		
		Sharpness	(-/+ , 0~100)/1		
		Aspect Ratio	1:1		
			4:3		
			Full Screen		
		Uniformity	On		
			Off		
		Recall			
		HDR	Standard		
	HDR_M				
	HDR_H				

Main Menu	Sub-menu	Menu Option	
ViewMode	CAD/CAM	Brightness	(-/+ , 0~100)/1
		Contrast	(-/+ , 0~100)/1
		Ultra Clear	(-/+ , 0~4)
		Advanced-Sharpness	(-/+ , 0~100)
		Advanced-Gamma	(-/+ , 1.8~2.6)
	Video Edit	Brightness	(-/+ , 0~100)/1
		Contrast	(-/+ , 0~100)/1
		Ultra Clear	(-/+ , 0~4)
		Advanced-Sharpness	(-/+ , 0~100)
		Advanced-Gamma	(-/+ , 1.8~2.6)
	Animation	Brightness	(-/+ , 0~100)/1
		Contrast	(-/+ , 0~100)/1
		Ultra Clear	(-/+ , 0~4)
		Advanced-Sharpness	(-/+ , 0~100)
		Black Stabilization	(-/+ , 0~10)
	Photographer	Brightness	(-/+ , 0~100)/1
		Contrast	(-/+ , 0~100)/1
		Ultra Clear	(-/+ , 0~4)
		Advanced-Sharpness	(-/+ , 0~100)
		Advanced-Gamma	(-/+ , 1.8~2.6)
	FPS 1		
	FPS 2		
	RTS		
	MOBA		
	Clarity Boost		

Main Menu	Sub-menu	Menu Option		
ViewMode	Magnifier	Window Position	H. Position	(-/+ , 0~100)/1
			V. Position	(-/+ , 0~100)/1
		Window Size	(-/+ , 0~100)/1	
		Magnification	Off	
			2 x	
			4 x	
		Brightness	(-/+ , 0~100)/1	
		Contrast	(-/+ , 0~100)/1	
		Ultra Clear	(-/+ , 0~4)	
		Advanced-Sharpness	(-/+ , 0~100)	
		Color Temperature	Panel Default	
			9300K	
			7500K	
			6500K	
			6300K	
			5000K	
		Gamma	Panel Default	
			1.0	
			1.4	
			1.8	
2.2				
2.4				
2.6				
Audio Adjust	Volume	(-/+ , 0~100)/1		
	Mute	On		
		Off		
	Audio Input	DisplayPort		
		HDMI 1		
		HDMI 2		
Thunderbolt				

Main Menu	Sub-menu	Menu Option	
Setup Menu	Language Select	English	
		Français	
		Deutsch	
		Español	
		Italiano	
		Suomi	
		Русский	
		Türkçe	
		日本語	
		한국어	
		繁體中文	
		简体中文	
		Češka	
		Svenska	
	Tiếng Việt		
	Resolution Notice	On	
		Off	
	Information		
	OSD Timeout	(-/+ , 5/15/30/60)	
	OSD Background	On	
		Off	
	OSD Pivot	Auto	
		0°	
		+90°	
		-90°	
		180°	
	Portrait Display	On	
Off			
0°			
+90°			
-90°			
Cut Black Border			

Main Menu	Sub-menu	Menu Option		
Setup Menu	Power Indicator	On		
		Off		
	Auto Power Off	On		
		Off		
	Sleep	30 minutes		
		45 minutes		
		60 minutes		
		120 minutes		
		Off		
	Multi-Picture	Off		
		PBP Left-Right	Left Source Select	DisplayPort
				HDMI 1
				HDMI 2
			Right Source Select	Thunderbolt
				DisplayPort
				HDMI 1
		PIP	PIP Source Select	HDMI 2
				Thunderbolt
				DisplayPort
			PIP Position	PIP H. Position
				PIP V. Position
PIP Size			(-/+ , 0~100)	
Swap				

Main Menu	Sub-menu	Menu Option		
Setup Menu	Multi-Picture	Dual Color	DCI-P3	
			sRGB	
			REC709	
			DICOM-SIM	
			User	
			CAL 1	
			CAL 2	
			CAL 3	
			CAD/CAM	
			Video Edit	
			Animation	
			Photographer	
			FPS 1	
			FPS 2	
			RTS	
	MOBA			
	Clarity Boost			
	ECO Mode	Standard		
		Optimize		
		Conserve		
		Energy Saving		On
	Off			
	Overscan	On		
		Off		
	Response Time	Standard		
		Advanced		
		Ultra Fast		
USB Charging	On			
	Off			
Backstage Lighting	Level 1			
	Level 2			
	Level 3			
	Off			

Main Menu	Sub-menu	Menu Option	
Setup Menu	Burn-in Eraser	On	
		Off	
	DDC/CI	On	
		Off	
	Rename		
	All Recall		

Menu Options

Input

1. Move the **Joy Key** (↓) to display the Startup Menu. Then navigate to **Main Menu** and press the **Joy Key** to display the OSD Menu.
2. Move the **Joy Key** (↑/↓) to select **Input**. Then press the **Joy Key** to enter the **Input** menu.

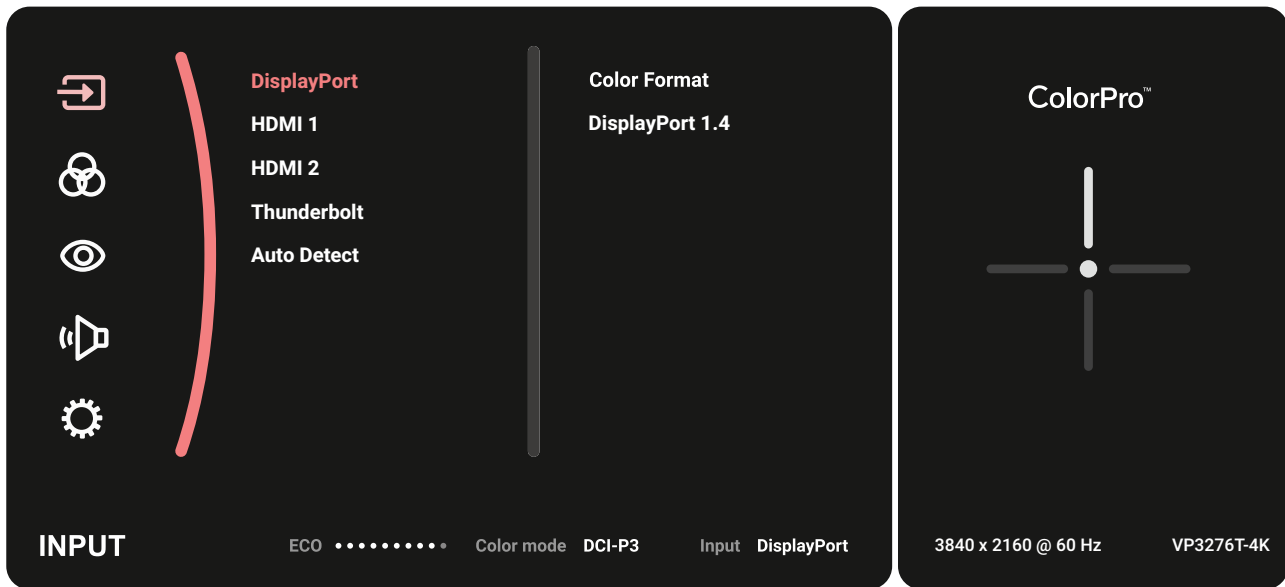

3. Move the **Joy Key** (↑/↓) to select the desired input source. Then press the **Joy Key** to confirm the selection.

Color Mode

1. Move the **Joy Key** (↓) to display the Startup Menu. Then navigate to **Main Menu** and press the **Joy Key** to display the OSD Menu.
2. Move the **Joy Key** (↑/↓) to select **Color Mode**. Then press the **Joy Key** to enter the **Color Mode** menu.

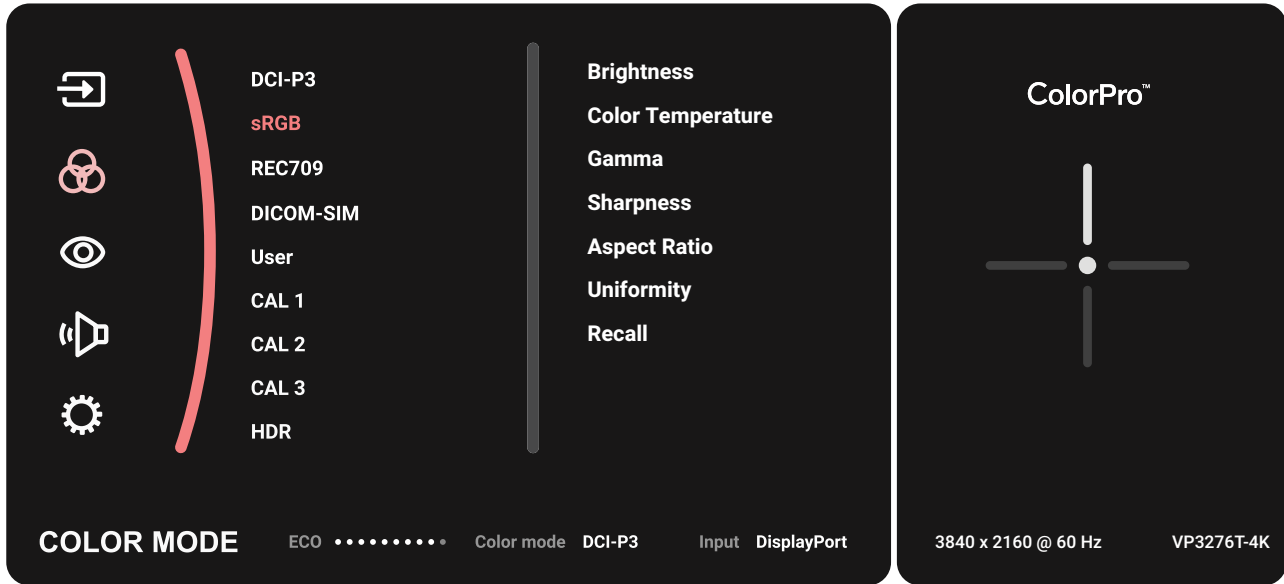

3. Move the **Joy Key** (↑/↓) to select the desired option. Then press the **Joy Key** to enter its sub-menu.
4. Move the **Joy Key** (↑/↓) to adjust/select the setting, and press the **Joy Key** to confirm the selection (if applicable).

Menu Option	Description
DCI-P3	Precise color gamut and gamma of DCI-P3 standard.
sRGB	Precise color gamut and gamma of sRGB standard.
REC709	Precise color gamut and gamma of ITU-R Rec. 709 standard.
DICOM-SIM	Gamma curves are set to a DICOM simulation.
User	Custom, user-defined settings.
CAL1/CAL2/CAL3	Display with the 1st/2nd/3rd user calibration mode.
HDR	Reduce the overall contrast of a given scene so that detail in the highlights and shadows can be seen.

ViewMode

1. Move the **Joy Key** (↓) to display the Startup Menu. Then navigate to **Main Menu** and press the **Joy Key** to display the OSD Menu.
2. Move the **Joy Key** (↑/↓) to select **ViewMode**. Then press the **Joy Key** to enter the **ViewMode** menu.

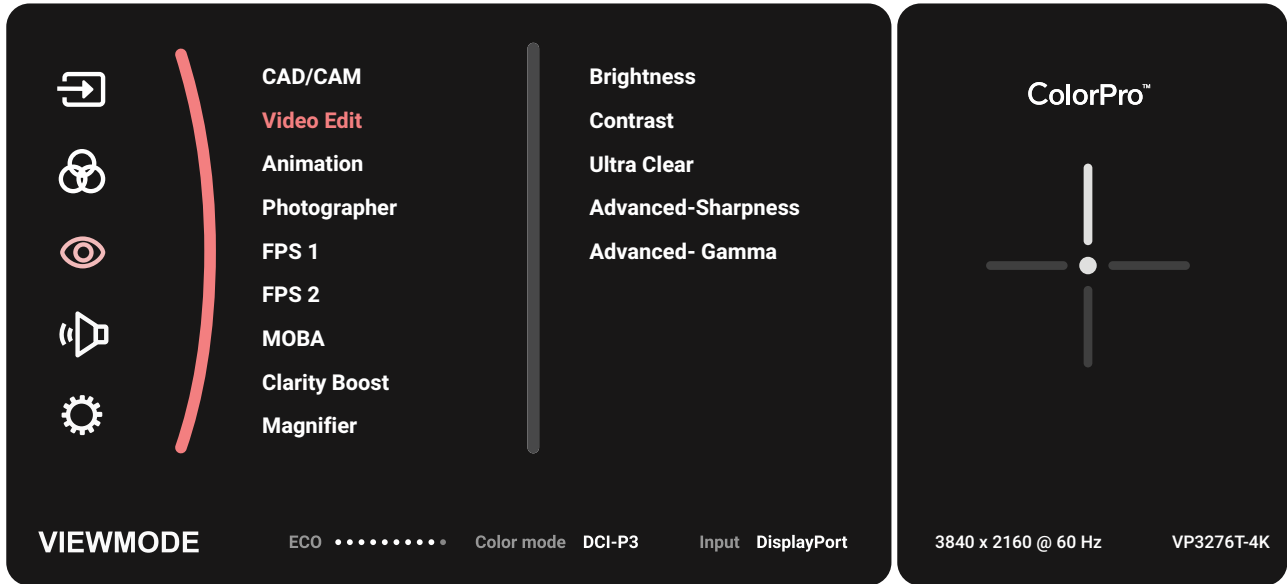

3. Move the **Joy Key** (↑/↓) to select the desired option. Then press the **Joy Key** to enter its sub-menu.

Menu Option	Description
CAD/CAM	Select this option for viewing graphic design files.
Video Edit	Select this option for video editing.
Animation	Select this option for animation.
Photographer	Select this option for viewing photo files.
FPS 1	Ideal for First-Person Shooter games.
FPS 2	Ideal for First-Person Shooter games.
RTS	Ideal for Real-Time Strategy games.
MOBA	Select this option for Multiplayer Online Battle Arena games.
Clarity Boost	Select this option to enhance the details of the darker part on the screen.
Magnifier	Select this option to enlarge the framed area to enhance the visibility of details.

Audio Adjust

1. Move the **Joy Key** (↓) to display the Startup Menu. Then navigate to **Main Menu** and press the **Joy Key** to display the OSD Menu.
2. Move the **Joy Key** (↑/↓) to select **Audio Adjust**. Then press the **Joy Key** to enter the **Audio Adjust** menu.



3. Move the **Joy Key** (↑/↓) to select the desired option. Then press the **Joy Key** to enter its sub-menu.
4. Move the **Joy Key** (↑/↓) to adjust/select the setting, and press the **Joy Key** to confirm the selection (if applicable).

Menu Option	Description
Volume	Adjust the monitor's sound level.
Mute	Turn off the monitor's sound.
Audio Input	Select the audio input source.

Setup Menu

1. Move the **Joy Key** (↓) to display the Startup Menu. Then navigate to **Main Menu** and press the **Joy Key** to display the OSD Menu.
2. Move the **Joy Key** (↑/↓) to select **Setup Menu**. Then press the **Joy Key** to enter the **Setup Menu** menu.

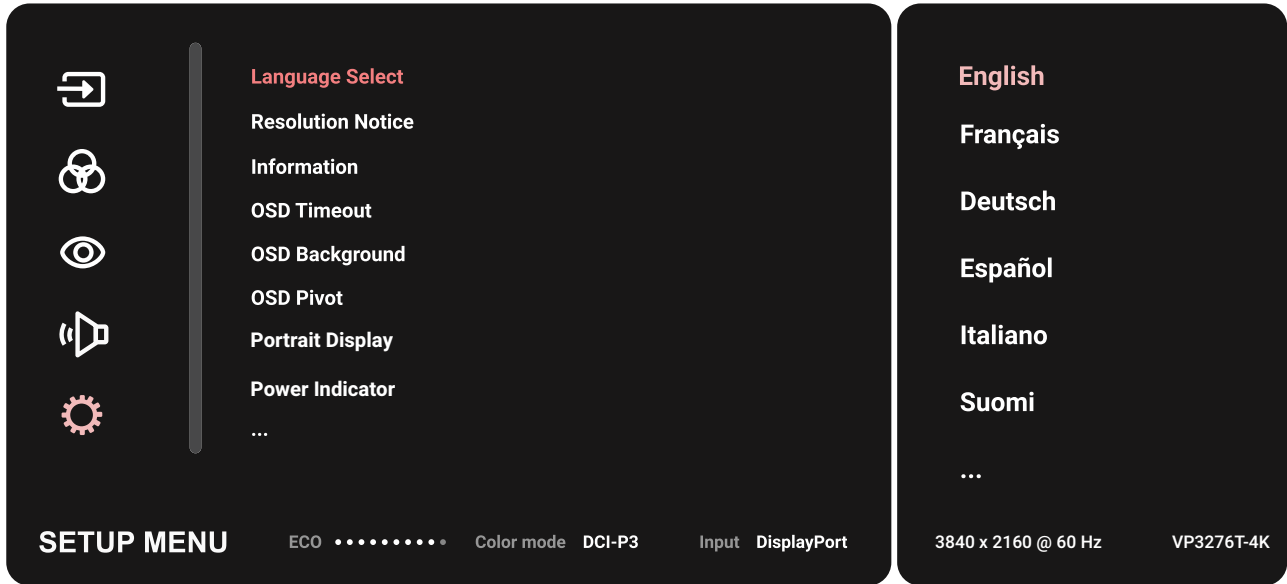

3. Move the **Joy Key** (↑/↓) to select the desired option. Then press the **Joy Key** to enter its sub-menu.
4. Move the **Joy Key** (↑/↓) to adjust/select the setting, and press the **Joy Key** to confirm the selection (if applicable).

Note: Some sub-menu options may have another sub-menu. To enter the respective sub-menu, press the **Joy Key**. Follow the key guide that appears on the bottom of the screen to select the option or make adjustments.

Menu Option	Description
Language Select	Select an available language for the OSD Menu.
Resolution Notice	Enable this option to allow the system to inform users that the current viewing resolution is not the correct native resolution.
Information	Display the monitor information.
OSD Timeout	Set the length of time the OSD Menu remains on screen.
OSD Background	Show/Hide the OSD background when the OSD Menu appears on the screen.

Menu Option	Description	
OSD Pivot	Set the OSD Menu orientation.	
	Auto	With the built-in G sensor, the OSD Menu can automatically pivot when the monitor is positioned vertically.
	0°	Sets the OSD Menu without a pivot.
	+90°	Sets the OSD Menu with a +90° pivot.
	-90°	Sets the OSD Menu with a -90° pivot.
	180°	Sets the OSD Menu with a 180° pivot.
Power Indicator	Set the Power Indicator On or Off. If the setting is set to On, the power indicator lights blue when the device is turned on.	
Auto Power Off	Enable this option to allow the monitor to automatically turn off after a certain amount of time.	
Sleep	Set the amount of idle time before the monitor enters Sleep mode.	
Multi-Picture	Off	Disable the function.
	PBP Left-Right	Display two windows, a 1x1 split screen, side-by-side on the left and right of the screen. User can specify the input source for each screen.
	PIP	Split the screen into two parts, a main window and an inset window. User can specify the input source for each screen.
	Dual Color	Display two different color settings in PIP or PBP mode.
ECO Mode	Choose between various modes, based on power consumption.	
Overscan	Enable this option to automatically enlarge the original picture horizontally and vertically to an equal aspect ratio that fills the screen.	
Response Time	Adjust the response time, creating smooth images without streaking, blurring or ghosting. A low response time is perfect for the most graphic-intense gaming, and provides amazing visual quality while watching sports or action movies.	
USB Charging	Turn on/off USB charging.	

Menu Option	Description
Backstage Lighting	Adjust the LED lighting.
Burn-in Eraser	Reduce image burn-in.
DDC/CI	Enable this option to allow the monitor control via the graphics card.
Rename	Rename the personalized custom profile.
All Recall	Resets all settings to their default values.

Advanced Features and Settings

Auto Pivot

The Auto Pivot function can detect the displayed image and adjust the image's orientation on the screen automatically when pivoting the screen.

Note: To use **Auto Pivot**, enable **DDC/CI** in the On-Screen Display Menu and download and install the ColorPro Display Manager application from our [ColorPro Software Download](#) site. ColorPro Display Manager is necessary for **Auto Pivot** functionality.

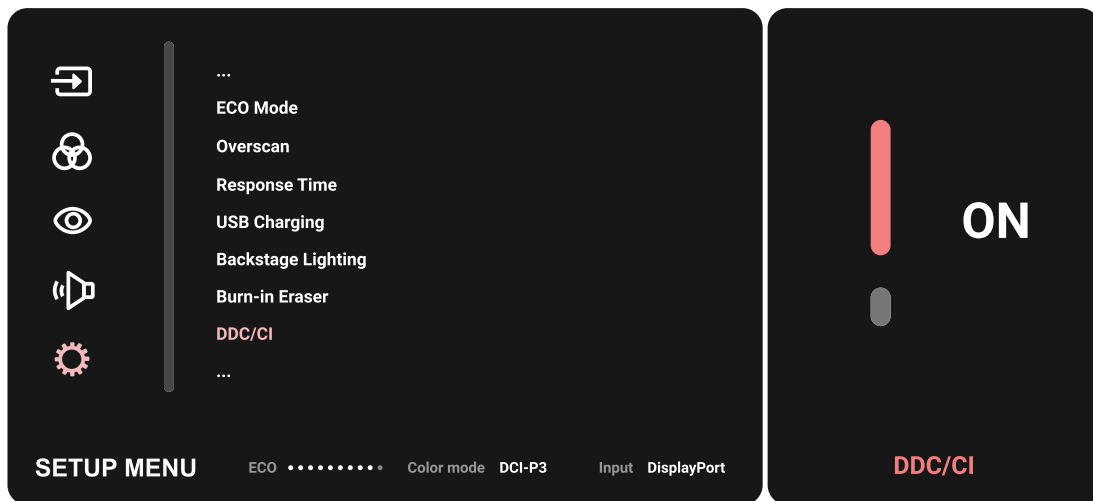

1. Move the **Joy Key** (↓) to display the Startup Menu. Then navigate to **Main Menu** and press the **Joy Key** to display the OSD Menu.
2. Move the **Joy Key** (↑/↓) to select the **Setup Menu** menu. Then press the **Joy Key** to enter the menu.
3. Move the **Joy Key** (↑/↓) to select **OSD Pivot**. Then press the **Joy Key** to enter its sub-menu.
4. Move the **Joy Key** (↑/↓) to select **Auto**. Then press the **Joy Key** to confirm.

Colorbration+

To ensure long-term color accuracy, some specific models support the hardware color calibration function. The Colorbration+ application installation file can be found at our [ColorPro Software Download](#).

Standard monitor packing does not include the color sensor, which the Colorbration+ application needs for the calibration process.

Note: For a detailed list of supported measurement devices, please refer to our [ColorPro Software Download](#).

Color Temp. Light

With the Color Temp. Light function, the monitor can adjust the LED color temperature to the optimal settings.

To configure the Color Temp. Light settings:

1. Move the **Joy Key** (↓) to display the Startup Menu. Then navigate to **Main Menu** and press the **Joy Key** to display the OSD Menu.
2. Move the **Joy Key** (↑/↓) to select the **Setup Menu** menu. Then press the **Joy Key** to enter the menu.
3. Move the **Joy Key** (↑/↓) to select **Color Temp. Light**. Then press the **Joy Key** to enter its sub-menu.
4. Move the **Joy Key** (↑/↓) to select **D50** or **D65** to enable the function. Then press the **Joy Key** to confirm.

Dual Color

The monitor comes with a dual color engine to display two different color settings in PIP (Picture-in-Picture) or PBP mode. You can set different color presets in both windows (Main Window and Secondary Window).

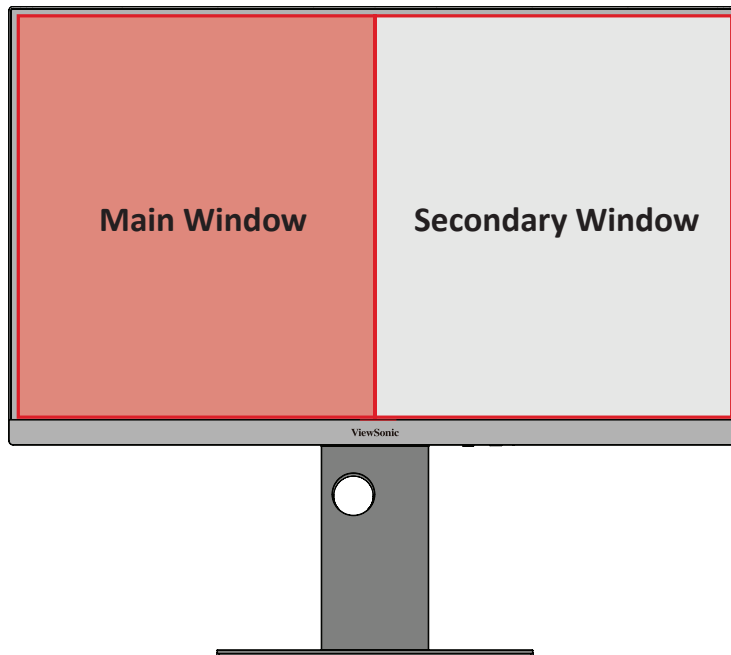

Note: To enable PIP or PBP mode, refer to “Multi-Picture”.

To configure Dual Color:

1. Move the **Joy Key** (↓) to display the Startup Menu. Then navigate to **Main Menu** and press the **Joy Key** to display the OSD Menu.
2. Move the **Joy Key** (↑/↓) to select the **Setup Menu** menu. Then press the **Joy Key** to enter the menu.
3. Move the **Joy Key** (↑/↓) to select **Multi-Picture**. Then press the **Joy Key** to enter its sub-menu.
4. Move the **Joy Key** (↑/↓) to select **Dual Color**. Then press the **Joy Key** to enter its sub-menu.
5. Move the **Joy Key** (↑/↓) to select the desired color setting. Then press the **Joy Key** to confirm.

Firmware Update

To maintain optimal display performance and address potential issues, regularly upgrade your monitor's firmware. Use the Firmware Update Tool and the supplied USB cable to install the updates.

Important: Do not interrupt the firmware upgrade process, as this may damage your monitor. Keep the USB cable connected and make sure both the computer and monitor remain turned on until the upgrade is complete.

1. Download and install the Display Portal application from our [ColorPro Software Download](#) site.
2. Connect one end of the USB cable to the USB upstream port of the monitor. Then connect the other end of the cable to the USB port of the computer.
3. Launch Display Portal and open the Firmware Update Tool application.
4. Select **Check for Update**.

Connection Requirements by Input Source

Input Source	USB Upstream Connection Required?
DisplayPort	Yes
HDMI	Yes
Thunderbolt	No

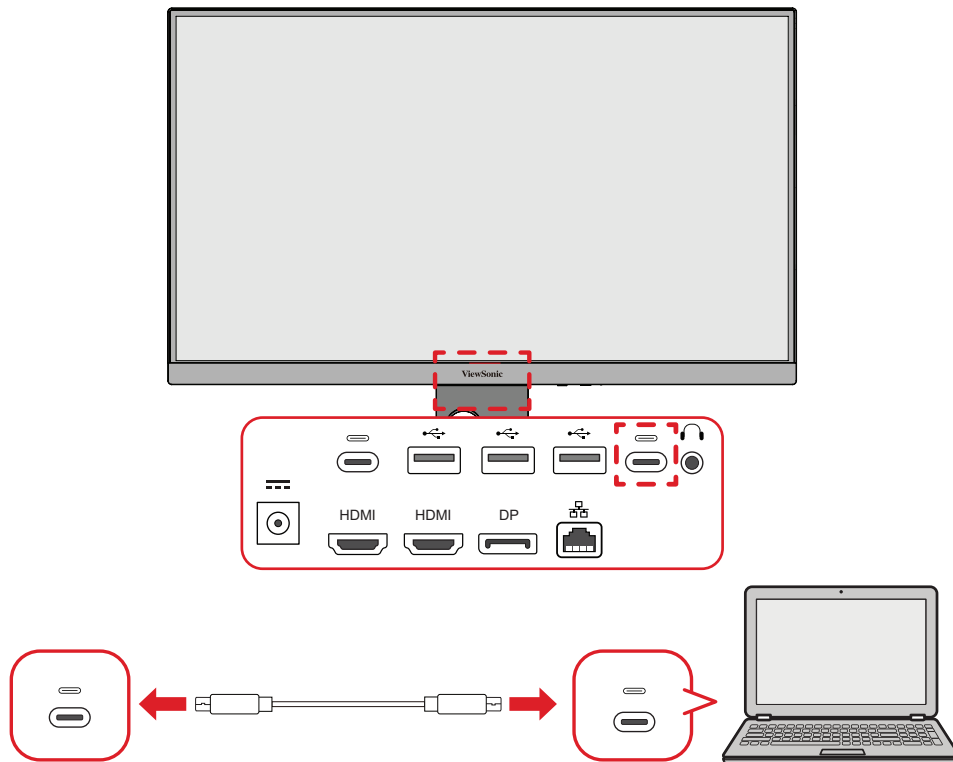

HDR (High-Dynamic-Range)

HDR reduces the overall contrast of a given scene so that detail in the highlights and shadows can be seen.

Note: Ensure the HDR setting is turned on on your device first before enabling the HDR on the monitor.

To enable the HDR function:

1. Move the **Joy Key** (↓) to display the Startup Menu. Then navigate to **Main Menu** and press the **Joy Key** to display the OSD Menu.
2. Move the **Joy Key** (↑/↓) to select **Color Mode**. Then press the **Joy Key** to enter the **Color Mode** menu.
3. Move the **Joy Key** (↑/↓) to select **HDR**. Then press the **Joy Key** to enter its sub-menu.
4. Move the **Joy Key** (↑/↓) to select one of the options . Then press the **Joy Key** to confirm.

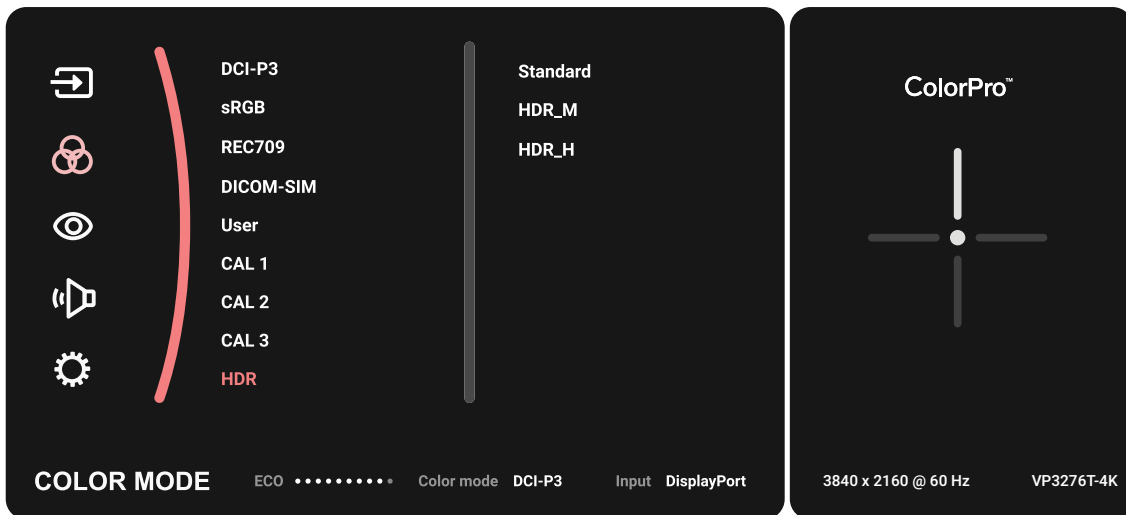

KVM

The KVM function allows the user to control two computers connected to the same monitor from a single keyboard and mouse.

Note: Only applicable in PBP (Picture-by-Picture) mode.

To connect the two computers to the monitor:

1. Connect one end of a Thunderbolt cable to the **Thunderbolt In** port of the monitor. Then connect the other end of the cable to the Thunderbolt port of the laptop.
2. Connect one end of a DisplayPort cable to the **DP** port of the monitor. Then connect the other end of the cable to the DisplayPort or Mini DisplayPort port of the computer. Or, connect one end of an HDMI cable to the **HDMI** port of the monitor. Then connect the other end of the cable to the HDMI port of the computer.

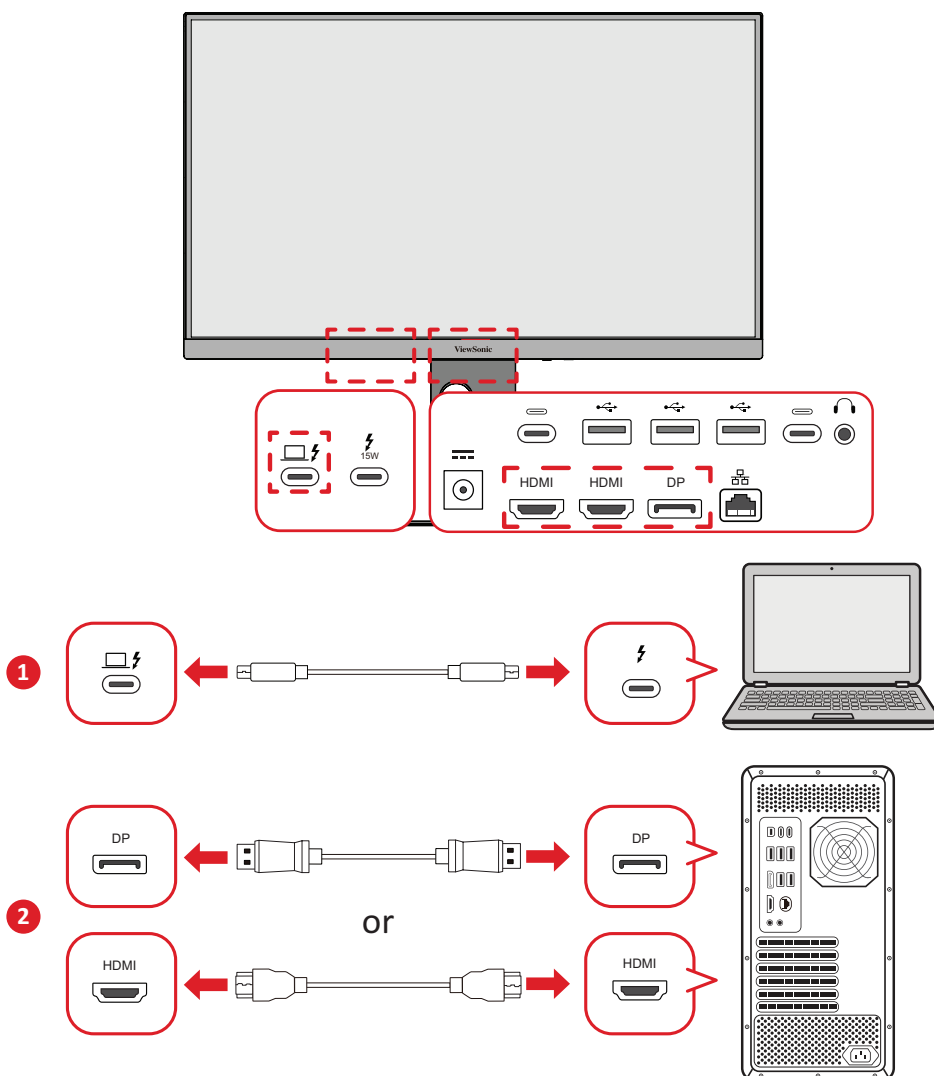

To enable PBP mode:

1. Move the **Joy Key** (↓) to display the Startup Menu. Then navigate to **Main Menu** and press the **Joy Key** to display the OSD Menu.
2. Move the **Joy Key** (↑/↓) to select the **Setup Menu** menu. Then press the **Joy Key** to enter the menu.
3. Move the **Joy Key** (↑/↓) to select **Multi-Picture**. Then press the **Joy Key** to enter its sub-menu.
4. Move the **Joy Key** (↑/↓) to select **PBP Left-Right**. Then press the **Joy Key** to enable PBP mode.

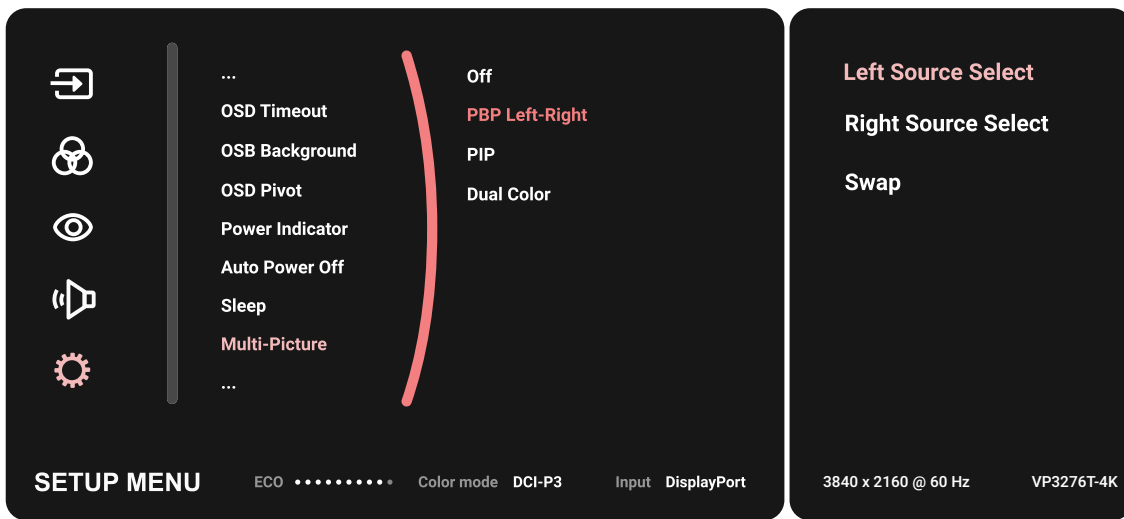

To activate the KVM function:

1. Move and hold the **Joy Key** (→) key for two seconds to activate the KVM function.
2. Then you will be able to switch the cursor between the two screens (left/right window).

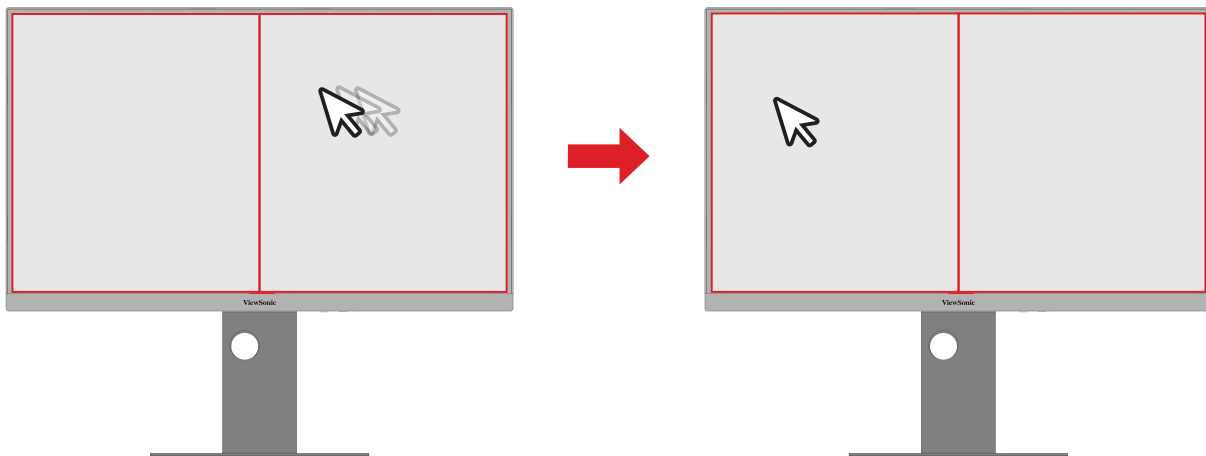

Multi-Picture

Multi-Picture allows users to further customize their work space by allowing up to two split windows from different inputs, displaying high resolution content with different aspect ratios, without distortion from the original input sources.

To enable Multi-Picture mode:

1. Move the **Joy Key** (↓) to display the Startup Menu. Then navigate to **Main Menu** and press the **Joy Key** to display the OSD Menu.
2. Move the **Joy Key** (↑/↓) to select **Color Mode**. Then press the **Joy Key** to enter the **Color Mode** menu.
3. Move the **Joy Key** (↑/↓) to select **Multi-Picture**. Then press the **Joy Key** to enter its sub-menu.
4. Move the **Joy Key** (↑/↓) to select **PBP Left-Right** or **PIP**. Then press the **Joy Key** to enter the selected mode.

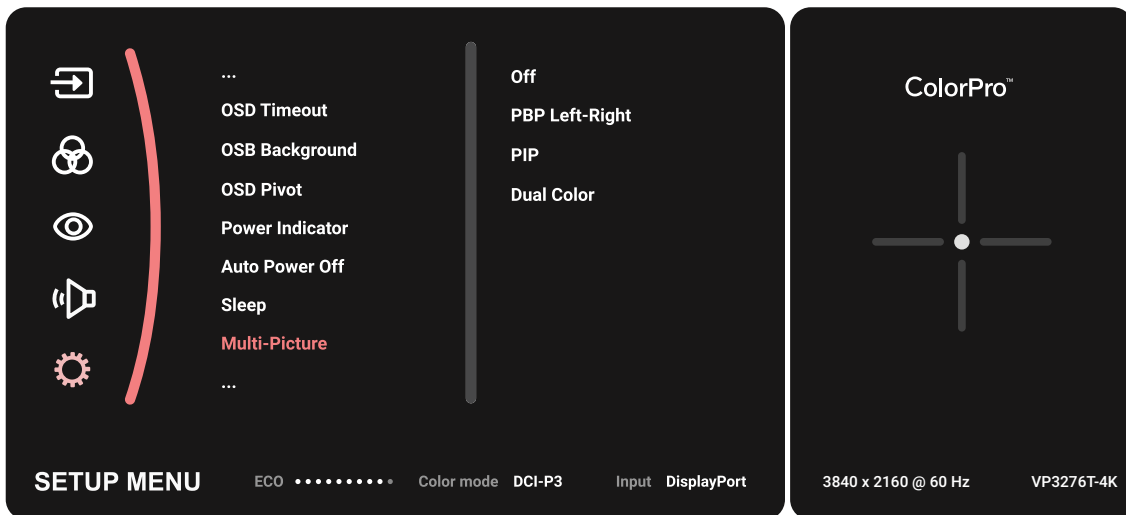

PBP (Picture-by-Picture)

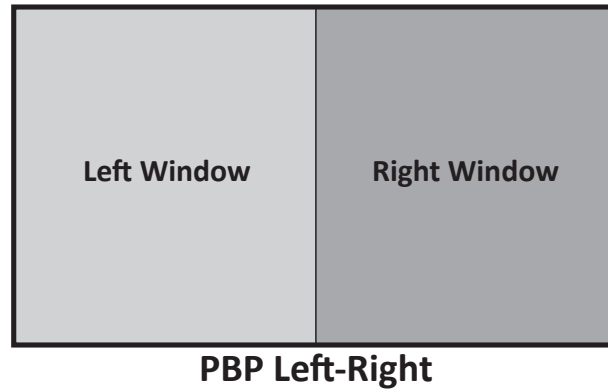

Note: To display full-sized images in the windows, please adjust the screen resolution to 3840 x 2160 @ 60 Hz (PBP Left-Right).

To configure PBP:

1. Move the **Joy Key** (↓) to display the Startup Menu. Then navigate to **Main Menu** and press the **Joy Key** to display the OSD Menu.
2. Move the **Joy Key** (↑/↓) to select the **Setup Menu** menu. Then press the **Joy Key** to enter the menu.
3. Move the **Joy Key** (↑/↓) to select **Multi-Picture**. Then press the **Joy Key** to enter its sub-menu.
4. Move the **Joy Key** (↑/↓) to select **PBP Left-Right**. Then press the **Joy Key** to enter its sub-menu.
5. To change the input source, select the source location (**Left Source Select/Right Source Select**) and press the **Joy Key**.
6. Move the **Joy Key** (↑/↓) to select the desired input source and press the **Joy Key** to confirm.
7. To swap the two windows, select **Swap** and press the **Joy Key** to confirm.

PIP (Picture-in-Picture)

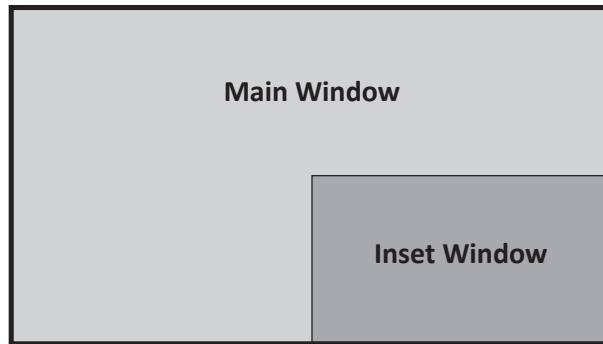

To configure PIP:

1. Move the **Joy Key** (↓) to display the Startup Menu. Then navigate to **Main Menu** and press the **Joy Key** to display the OSD Menu.
2. Move the **Joy Key** (↑/↓) to select the **Setup Menu** menu. Then press the **Joy Key** to enter the menu.
3. Move the **Joy Key** (↑/↓) to select **Multi-Picture**. Then press the **Joy Key** to enter its sub-menu.
4. Move the **Joy Key** (↑/↓) to select **PIP**. Then press the **Joy Key** to enter its sub-menu.
5. To change the input source for the Inset Window, select **PIP Source Select** and press the **Joy Key**. Then move the **Joy Key** (↑/↓) to select the desired input source and press the **Joy Key** to confirm.
6. To adjust the Inset Window position, select **PIP Position** and press the **Joy Key**.
 - » Press the **Joy Key** to select **PIP H.Position** or **PIP V.Position**.
 - » Move the **Joy Key** (↑/↓) to adjust the setting and press the **Joy Key** to confirm.
7. To adjust the Inset Window size, select **PIP Size** and press the **Joy Key**. Then move the **Joy Key** (↑/↓) to adjust the setting.
8. To swap the two windows, select **Swap** and press the **Joy Key** to confirm.

Appendix

Specifications

Item	Category	Specifications
LCD	Type	IPS type, a-si TFT Active Matrix 3840 x 2160 LCD, 0.18159 (H) mm x 0.18159 (V) mm pixel pitch
	Display Size	80.01 cm
		31.5" viewable
	Color Filter	RGB Vertical Stripe
Glass Surface	Anti-Glare (Haze 48%), Hard Coating (3H)	
Input Signal	Video Sync	<u>TMDS digital (100 Ω)</u> DisplayPort: f_h :30~150 kHz, f_v :24~75 Hz HDMI: f_h :30~150 kHz, f_v :24~75 Hz Thunderbolt 4: f_h :30~150 kHz, f_v :24~75 Hz
Compatibility	PC	up to 3840 x 2160
	Macintosh	up to 3840 x 2160
Resolution and Timings ¹	Recommended	3840 x 2160 @ 60 Hz
	Supported	<ul style="list-style-type: none"> • 3840 x 2160 @ 30, 50, 60 Hz • 2560 x 1440 @ 60, 75 Hz • 1920 x 1080 @ 60 Hz
Power ²	Input Voltage	AC 100-240V, 50/60 Hz (auto switch)
Display Area	Active Size (H x V)	797.306 x 392.234 mm
		31.39" x 15.44"
Operating Conditions	Altitude	3.048 km
		10,000 ft
	Relative Humidity	20% to 90% (non-condensing)
	Temperature	0° C to 40° C
32° F to 104° F		
Storage Conditions	Altitude	12 km
		39,370.1 ft
	Relative Humidity	5% to 90% (non-condensing)
	Temperature	-20° C to 60° C
-4° F to 140° F		
Dimensions (with stand)	Physical (W x H x D)	714.2 x 580.08~456.92 x 209.65 mm
		28.12" x 22.84"~17.99" x 8.25"

1- Do not set the graphics card in your computer to exceed these timing modes; doing so may result in permanent damage to the display.

2- Please use the power adapter/power cord from ViewSonic® or an authorized source only.

Item	Category	Specifications
Weight (with stand)	Physical	6.4 kg
		14 lb
Wall Mount	Dimensions	100 x 100 mm
Power Consumption	On ³	47W (Typical) without audio 57W (Typical) with 100% audio
	Standby	≤ 0.5W
	Off	≤ 0.3W (Maximum)

3- The test condition follows EEI standards.

Glossary

This section describes the standard glossary of terms used in all LCD display models. All terms are listed in alphabetical order.

Note: Some terms may not be applicable to your monitor.

A **Advanced DCR**

Advanced DCR technology automatically detects the image signal and intelligently controls the backlight brightness and color to improve on the ability to make the black blacker in a dark scene, and make the white whiter in a bright environment.

Audio Adjust

Adjusts the volume, mutes the sound, or toggles between inputs if you have more than one source.

Auto Detect

If the current input source has no signal, the monitor will automatically switch to the next input option. This function, on some models, is disabled by default.

B **Black Stabilization**

ViewSonic's Black Stabilization provides heightened visibility and detail by brightening dark scenes.

Blue Light Filter

Adjusts the filter that blocks high-energy blue light for a more comfortable viewing experience.

Boot Up Screen

Turning off the boot screen will disable the on-screen message from displaying when turning on the monitor.

Brightness

Adjusts background black levels of the screen image.

C Color Adjust

Provides several color adjustment modes to help adjust the color settings to fit the user's needs.

Color Range

The monitor can detect the input signal color range automatically. You can manually change the color range options to fit the correct color range if the colors are not displayed correctly.

Option	Description
Auto	The monitor automatically recognizes the color format and black and white levels.
Full Range	The color range of the black and white levels are full.
Limited Range	The color range of the black and white levels are limited.

Color Space

Allows users to choose which color space they would like to use for monitor color output (RGB, YUV).

Color Temperature

Allows users to select specific color temperature settings to further customize their viewing experience.

Option	Description
sRGB	Precise color gamut and gamma of the sRGB standard.
Bluish	Set the color temperature to 9300K.
Cool	Set the color temperature to 7500K.
Native	Default color temperature. Recommended for general use.
Warm	Set the color temperature to 5000K.

Contrast

Adjusts the difference between the image background (black level) and the foreground (white level).

Crosshair

Select from different crosshair styles and colors to overlay on your screen.

G Gamma

Allows users to manually adjust the brightness level of the monitor's grayscale levels. There are six selections: 1.0, 1.4, 1.8, 2.0, 2.2, 2.4, and 2.6.

H Hue

Adjusts the tint of each color (red, green, blue, cyan, magenta, and yellow).

I Information

Displays the timing mode (video signal input) coming from the graphics card in the computer, the LCD model number, the serial number, and the ViewSonic® website URL. See your graphics card's user guide for instructions on changing the resolution and refresh rate (vertical frequency).

Note: VESA 1024 x 768 @ 60Hz, for example, means that the resolution is 1024 x 768 and the refresh rate is 60Hz.

Input Select

Toggles between the various input options that are available for the monitor.

M Manual Image Adjust

Displays the "Manual Image Adjust" menu. You can manually set a variety of image quality adjustments.

Memory Recall

Returns the adjustments back to factory settings if the display is operating in a factory preset timing mode listed in the "Specifications" of this manual.

Note:

- (Exception) This control does not affect changes made in the "Language Select" or "Power Lock" setting.
- Memory Recall is the default as-shipped display configuration and settings. Memory Recall is the setting in which the product qualifies for ENERGY STAR®. Any changes to default as-shipped display configuration and settings would change the energy consumption, and may increase energy consumption beyond the limits required for ENERGY STAR® qualification, as applicable. ENERGY STAR® is a set of power-saving guidelines issued by the U.S. Environmental Protection Agency (EPA). ENERGY STAR® is a joint program of the U.S. Environmental Protection Agency and the U.S. Department of Energy helping us all save money and protect the environment through energy efficient products and practices.



O

Offset

Adjusts black levels for red, green, and blue. The gain and offset functions allow users to control the white balance for the upmost control when manipulating contrast and dark scenes.

OSD Pivot

Sets the monitor OSD Menu display direction.

Overscan

Refers to a cropped image on your monitor's screen. A setting on your monitor zooms in on movie content, so that you cannot see the outermost edges of the film.

P

Power Indicator

The light that displays whether the monitor is on or off. This setting also controls the lighting on the stand. Users can turn off the lighting effect under "Power Indicator". Additionally, the power indicator displays an average color directly interpreting the input color signal received on screen.

Q

Quick Access

Quickly initiate some functions and modes through the Quick Access key and menu. Users can also define which functions or modes they prefer in the Quick Access Menu via the **Setup Menu** in OSD. The function/mode will be enabled as soon as the light-bar moves on the item, and will disable after removing the light-bar.

R

Recall

Resets the ViewMode monitor settings.

Resolution Notice

The notice tells users that the current viewing resolution is not the correct native resolution. This notice will appear in the display settings window when setting up the display resolution.

S

Setup Menu

Adjusts On-Screen Display (OSD) Menu settings. Many of these settings can activate on-screen display notifications so users do not have to reopen the menu.

Sharpness

Adjusts the picture quality of the monitor.

V

ViewMode

ViewSonic's unique ViewMode feature offers "Game", "Movie", "Web", "Text", "MAC", and "Mono" presets. These presets are specifically designed to deliver an optimized viewing experience for different screen applications.

ViewScale

Gamers have the ability to adjust the display size of the image on the monitor, allowing for a "best fit" scenario.

Troubleshooting

This section describes some common problems that you may experience when using the monitor.

Problem or Issue	Possible Solutions
No power	<ul style="list-style-type: none">• Make sure you have turned on the monitor by pressing the Power button.• Make sure the power cord is properly and securely connected to the monitor and power outlet.• Plug another electrical device into the power outlet to verify that the outlet is supplying power.
Power is on, but no image appears on screen	<ul style="list-style-type: none">• Make sure the video cable connecting the monitor to the computer is properly and securely connected.• Adjust the brightness and contrast settings.• Make sure the correct input source is selected.
Wrong or abnormal colors	<ul style="list-style-type: none">• If any colors (red, green, or blue) are missing, check the video cable to make sure it is properly and securely connected. Loose or broken pins in the cable connector could cause an improper connection.• Connect the monitor to another computer.
Screen image is too light or dark	<ul style="list-style-type: none">• Adjust brightness and contrast settings via the OSD Menu.• Reset the monitor to factory settings.
Screen image cuts in and out	<ul style="list-style-type: none">• Make sure the correct input source is selected.• Check for bent or broken pins in the video cable connector.• Make sure the video cable connecting the monitor to the computer is properly and securely connected.
Screen image is blurred	<ul style="list-style-type: none">• Adjust the resolution to the correct Aspect Ratio.• Reset the monitor to factory settings.
The screen isn't centered correctly	<ul style="list-style-type: none">• Adjust the horizontal and vertical controls via the OSD Menu.• Check the Aspect Ratio.• Reset the monitor to factory settings.

Problem or Issue	Possible Solutions
The screen appears yellow	<ul style="list-style-type: none"> • Make sure the “Blue Light Filter” is Off.
The OSD Menu does not appear on the screen/the OSD controls are inaccessible	<ul style="list-style-type: none"> • Check whether the OSD Menu is locked. • Turn off the monitor, unplug the power cord, plug it back in, and then turn on the monitor. • Reset the monitor to factory settings.
Control panel keys do not work	<ul style="list-style-type: none"> • Press only one key at a time. • Restart the computer.
Some menus aren’t selectable in the OSD	<ul style="list-style-type: none"> • Adjust the ViewMode or the input source. • Reset the monitor to factory settings.
No audio output	<ul style="list-style-type: none"> • If using ear-/headphones, ensure the mini stereo jack is connected. • Make sure the volume is not muted, nor set to 0. • Check the Audio Input setting.
The monitor will not adjust	<ul style="list-style-type: none"> • Make sure there are no obstructions near or on the monitor, and that there is adequate spacing. • For more information, see "Adjusting the Viewing Angle" on page 22.
USB devices connected to the monitor do not work	<ul style="list-style-type: none"> • Make sure the USB cable is connected properly. • Try changing to another USB port (if applicable). • Some USB devices require a higher electric current; connect the device directly to the computer.
The external device is connected, but no image appears on the screen	<ul style="list-style-type: none"> • Make sure the Power is On • Adjust brightness and contrast via the OSD Menu. • Check the connecting cable and make sure it is properly and securely connected. Loose or broken pins in the cable connector could cause an improper connection.

Maintenance

General Precautions

- Make sure the monitor is turned off and the power cable is unplugged from the power outlet.
- Never spray or pour any liquid directly onto the screen or case.
- Handle the monitor with care, as a darker-colored monitor, if scuffed, may show marks more clearly than a lighter-colored monitor.

Cleaning the Screen

- Wipe the screen with a clean, soft, lint-free cloth. This removes dust and other particles.
- If the screen is still not clean, apply a small amount of non-ammonia, non-alcohol based glass cleaner onto a clean, soft, lint-free cloth; then wipe the screen.

Cleaning the Case

- Use a soft, dry cloth.
- If the case is still not clean, apply a small amount of non-ammonia, non-alcohol based, mild non-abrasive detergent onto a clean, soft, lint-free cloth, then wipe the surface.

Disclaimer

- ViewSonic® does not recommend the use of any ammonia or alcohol-based cleaners on the display screen or case. Some chemical cleaners have been reported to damage the screen and/or case of the monitor.
- ViewSonic® will not be liable for damage resulting from use of any ammonia or alcohol-based cleaners.

Blue Light Filter and Eye Health

The low blue light hardware blocks high-energy blue light for a more comfortable viewing experience.

While using and enjoying your monitor please keep the following in mind:

- Viewing computer screens for extended periods of time may cause eye irritation and discomfort. To reduce these effects, it is recommended to take periodic breaks from viewing to allow the eyes to relax.
- The monitor also supports Flicker-Free, which reduces or eliminates screen flicker, thus easing potential eye strain.
- The monitor uses a low blue light panel and complies with TÜV Rheinland (Hardware Solution) at factory reset/default setting mode.

Calculating Breaks

When viewing the monitor for extended periods, it is recommended to take periodic breaks from viewing. Short breaks of at least five minutes are recommended after one to two hours of continuous viewing.

Taking shorter, more frequent breaks are generally more beneficial than longer, less frequent breaks.

Looking at Distant Objects

While taking breaks, users can further reduce eye strain and dryness by focusing on objects that are further away from them.

Eye and Neck Exercises

Eye Exercises

Eye exercises can help minimize eye strain. Slowly roll your eyes to the left, right, up, and down. Repeat as many times as needed.

Neck Exercises

Neck exercises can also help minimize eye strain. Relax your arms and let them hang at your sides, bend forward slightly to stretch the neck, turn your head to the right and to the left. Repeat as many times as needed.

Regulatory and Service Information

Compliance Information

This section addresses all connected requirements and statements regarding regulations. Confirmed corresponding applications shall refer to nameplate labels and relevant markings on the unit.

FCC Compliance Statement

This device complies with part 15 of FCC Rules. Operation is subject to the following two conditions: (1) this device may not cause harmful interference, and (2) this device must accept any interference received, including interference that may cause undesired operation. This equipment has been tested and found to comply with the limits for a Class B digital device, pursuant to part 15 of the FCC Rules.

These limits are designed to provide reasonable protection against harmful interference in a residential installation. This equipment generates, uses, and can radiate radio frequency energy, and if not installed and used in accordance with the instructions, may cause harmful interference to radio communications. However, there is no guarantee that interference will not occur in a particular installation. If this equipment does cause harmful interference to radio or television reception, which can be determined by turning the equipment off and on, the user is encouraged to try to correct the interference by one or more of the following measures:

- Reorient or relocate the receiving antenna.
- Increase the separation between the equipment and receiver.
- Connect the equipment into an outlet on a circuit different from that to which the receiver is connected.
- Consult the dealer or an experienced radio/TV technician for help.

Warning: You are cautioned that changes or modifications not expressly approved by the party responsible for compliance could void your authority to operate the equipment.

Industry Canada Statement

CAN ICES (B) / NMB (B)

CE Conformity for European Countries

 The device complies with the EMC Directive 2014/30/EU and Low Voltage Directive 2014/35/EU.

The following information is only for EU-member states:

The mark shown to the right is in compliance with the Waste Electrical and Electronic Equipment Directive 2012/19/EU (WEEE). The mark indicates the requirement NOT to dispose of the equipment as unsorted municipal waste, but use the return and collection systems according to local law.



Declaration of RoHS2 Compliance

This product has been designed and manufactured in compliance with Directive 2011/65/EU of the European Parliament and the Council on restriction of the use of certain hazardous substances in electrical and electronic equipment (RoHS2 Directive) and is deemed to comply with the maximum concentration values issued by the European Technical Adaptation Committee (TAC) as shown below:

Substance	Proposed Maximum Concentration	Actual Concentration
Lead (Pb)	0.1%	< 0.1%
Mercury (Hg)	0.1%	< 0.1%
Cadmium (Cd)	0.01%	< 0.01%
Hexavalent Chromium (Cr6 ⁺)	0.1%	< 0.1%
Polybrominated biphenyls (PBB)	0.1%	< 0.1%
Polybrominated diphenyl ethers (PBDE)	0.1%	< 0.1%
Bis (2-ethylhexyl) phthalate (DEHP)	0.1%	< 0.1%
Butyl benzyl phthalate (BBP)	0.1%	< 0.1%
Dibutyl phthalate (DBP)	0.1%	< 0.1%
Diisobutyl phthalate (DIBP)	0.1%	< 0.1%

Certain components of products as stated above are exempted under the Annex III of the RoHS2 Directives as noted below. Examples of exempted components are:

- Copper alloy containing up to 4% lead by weight.
- Lead in high melting temperature type solders (i.e. lead-based alloys containing 85% by weight or more lead).
- Electrical and electronic components containing lead in a glass or ceramic other than dielectric ceramic in capacitors, e.g. piezoelectronic devices, or in a glass or ceramic matrix compound.
- Lead in dielectric ceramic in capacitors for a rated voltage of 125 V AC or 250 V DC or higher.

Indian Restriction of Hazardous Substances

Restriction on Hazardous Substances statement (India). This product complies with the “India E-waste Rule 2011” and prohibits use of lead, mercury, hexavalent chromium, polybrominated biphenyls or polybrominated diphenyl ethers in concentrations exceeding 0.1 weight % and 0.01 weight % for cadmium, except for the exemptions set in Schedule 2 of the Rule.

Product Disposal at End of Product Life

ViewSonic® respects the environment and is committed to working and living green. Thank you for being part of Smarter, Greener Computing. Please visit the ViewSonic® website to learn more.

USA & Canada:

<https://www.viewsonic.com/us/go-green-with-viewsonic>

Europe:

<https://www.viewsonic.com/eu/environmental-social-governance/recycle>

Taiwan:

<https://recycle.moenv.gov.tw/>

For EU users, please contact us for any safety/accident issue experienced with this product:

ViewSonic Europe Limited



Flevolaan 38, 1382JZ, Weesp,
the Netherlands



+31 08000232999



EPREL@viewsoniceurope.com



<https://www.viewsonic.com/eu/>

Copyright Information

Copyright© ViewSonic® Corporation, 2025. All rights reserved.

Macintosh and Power Macintosh are registered trademarks of Apple Inc.

Microsoft, Windows, and the Windows logo are registered trademarks of Microsoft Corporation in the United States and other countries.

ViewSonic® and the three birds logo are registered trademarks of ViewSonic® Corporation.

VESA is a registered trademark of the Video Electronics Standards Association. DPMS, DisplayPort, and DDC are trademarks of VESA.

ENERGY STAR® is a registered trademark of the U.S. Environmental Protection Agency (EPA).

As an ENERGY STAR® partner, ViewSonic® Corporation has determined that this product meets the ENERGY STAR® guidelines for energy efficiency.

Disclaimer: ViewSonic® Corporation shall not be liable for technical or editorial errors or omissions contained herein; nor for incidental or consequential damages resulting from furnishing this material, or the performance or use of this product.

In the interest of continuing product improvement, ViewSonic® Corporation reserves the right to change product specifications without notice. Information in this document may change without notice.

No part of this document may be copied, reproduced, or transmitted by any means, for any purpose without prior written permission from ViewSonic® Corporation.

Customer Service

For technical support or product service, see the table below or contact your reseller.

Note: You will need the product's serial number, which is located on the rear of the monitor by the I/O ports.

Country/ Region	Website	Country/ Region	Website
Asia Pacific & Africa			
Australia	www.viewsonic.com/au/	Bangladesh	www.viewsonic.com/bd/
中国 (China)	www.viewsonic.com.cn	香港 (繁體中文)	www.viewsonic.com/hk/
Hong Kong (English)	www.viewsonic.com/hk-en/	India	www.viewsonic.com/in/
Indonesia	www.viewsonic.com/id/	Israel	www.viewsonic.com/il/
日本 (Japan)	www.viewsonic.com/jp/	Korea	www.viewsonic.com/kr/
Malaysia	www.viewsonic.com/my/	Middle East	www.viewsonic.com/me/
Myanmar	www.viewsonic.com/mm/	Nepal	www.viewsonic.com/np/
New Zealand	www.viewsonic.com/nz/	Pakistan	www.viewsonic.com/pk/
Philippines	www.viewsonic.com/ph/	Singapore	www.viewsonic.com/sg/
臺灣 (Taiwan)	www.viewsonic.com/tw/	ประเทศไทย	www.viewsonic.com/th/
Việt Nam	www.viewsonic.com/vn/	South Africa & Mauritius	www.viewsonic.com/za/
Americas			
United States	www.viewsonic.com/us	Canada	www.viewsonic.com/us
Latin America	www.viewsonic.com/la		
Europe			
Europe	www.viewsonic.com/eu/	France	www.viewsonic.com/fr/
Deutschland	www.viewsonic.com/de/	Қазақстан	www.viewsonic.com/kz/
Россия	www.viewsonic.com/ru/	España	www.viewsonic.com/es/
Türkiye	www.viewsonic.com/tr/	Україна	www.viewsonic.com/ua/
United Kingdom	www.viewsonic.com/uk/		

Limited Warranty

ViewSonic® Display

What the warranty covers:

ViewSonic® warrants its products to be free from defects in material and workmanship during the warranty period. If a product proves to be defective in material or workmanship during the warranty period, ViewSonic® will, at its sole option, and as your sole remedy, repair or replace the product with a similar product. Replacement Product or parts may include remanufactured or refurbished parts or components. The repair or replacement unit or parts or components will be covered by the balance of the time remaining on the customer's original limited warranty and the warranty period will not be extended. ViewSonic® provides no warranty for any third-party software whether included with the product or installed by the customer, installation of any unauthorized hardware parts or components (e.g. Projector Lamps). (Please refer to: "What the warranty excludes and does not cover" section).

How long the warranty is effective:

ViewSonic® displays are warranted for between 1 and 3 years, depending on your country of purchase, for all parts including the light source and for all labor from the date of the first consumer purchase.

Who the warranty protects:

This warranty is valid only for the first consumer purchaser.

What the warranty excludes and does not cover:

- Any product on which the serial number has been defaced, modified, or removed.
- Damage, deterioration, or malfunction resulting from:
 - » Accident, misuse, neglect, fire, water, lightning, or other acts of nature, unauthorized product modification, or failure to follow instructions supplied with the product.
 - » Repair or attempted repair by anyone not authorized by ViewSonic®.
 - » Damage to or loss of any programs, data, or removable storage media.
 - » Normal wear and tear.
 - » Removal or installation of the product.
- Software or data loss occurring during repair or replacement.
- Any damage of the product due to shipment.

- Causes external to the product, such as electric power fluctuations or failure.
- Use of supplies or parts not meeting ViewSonic’s specifications.
- Failure of owner to perform periodic product maintenance as stated in the User Guide.
- Any other cause which does not relate to a product defect.
- Damage caused by static (non-moving) images displayed for lengthy periods of time (also referred to as image burn-in).
- Software - Any third-party software included with the product or installed by the customer.
- Hardware/Accessories/Parts/Components – Installation of any unauthorized hardware, accessories, consumable parts or components (e.g. Projector Lamps).
- Damage to, or abuse of, the coating on the surface of the display through inappropriate cleaning as described in the product User Guide.
- Removal, installation, and set-up service charges, including wall-mounting of the product.

How to get service:

- For information about receiving service under warranty, contact ViewSonic® Customer Support (Please refer to the “Customer Service” page). You will need to provide your product’s serial number.
- To obtain warranty service, you will be required to provide: (a) the original dated sales slip, (b) your name, (c) your address, (d) a description of the problem, and (e) the serial number of the product.
- Take or ship the product, freight prepaid, in the original container to an authorized ViewSonic® service center or ViewSonic®.
- For additional information or the name of the nearest ViewSonic® service center, contact ViewSonic®.

Limitation of implied warranties:

There are no warranties, express or implied, which extend beyond the description contained herein including the implied warranty of merchantability and fitness for a particular purpose.

Exclusion of damages:

ViewSonic's liability is limited to the cost of repair or replacement of the product. ViewSonic® shall not be liable for:

- Damage to other property caused by any defects in the product, damages based upon inconvenience, loss of use of the product, loss of time, loss of profits, loss of business opportunity, loss of goodwill, interference with business relationships, or other commercial loss, even if advised of the possibility of such damages.
- Any other damages, whether incidental, consequential or otherwise.
- Any claim against the customer by any other party.
- Repair or attempted repair by anyone not authorized by ViewSonic®.

Effect of state law:

This warranty gives you specific legal rights, and you may also have other rights which vary from state to state. Some states do not allow limitations on implied warranties and/or do not allow the exclusion of incidental or consequential damages, so the above limitations and exclusions may not apply to you.

Sales outside the U.S.A. and Canada:

For warranty information and service on ViewSonic® products sold outside of the U.S.A. and Canada, contact ViewSonic® or your local ViewSonic® dealer.

The warranty period for this product in mainland China (Hong Kong, Macao, and Taiwan Excluded) is subject to the terms and conditions of the Maintenance Guarantee Card.

For users in Europe and Russia, full details of warranty provided can be found at: <http://www.viewsonic.com/eu/> under "Support/Warranty Information".

Mexico Limited Warranty

ViewSonic® Display

What the warranty covers:

ViewSonic® warrants its products to be free from defects in material and workmanship, under normal use, during the warranty period. If a product proves to be defective in material or workmanship during the warranty period, ViewSonic® will, at its sole option, repair or replace the product with a like product. Replacement product or parts may include remanufactured or refurbished parts or components & accessories.

How long the warranty is effective:

ViewSonic® LCD displays are warranted for between 1 and 3 years, depending on your country of purchase, for all parts including the light source and for all labour from the date of the first consumer purchase.

Who the warranty protects:

This warranty is valid only for the first consumer purchaser.

What the warranty excludes and does not cover:

- Any product on which the serial number has been defaced, modified or removed.
- Damage, deterioration, or malfunction resulting from:
 - » Accident, misuse, neglect, fire, water, lightning, or other acts of nature, unauthorized product modification, unauthorized attempted repair, or failure to follow instructions supplied with the product.
 - » Causes external to the product, such as electrical power fluctuations or failure.
 - » Use of supplies or parts not meeting ViewSonic®'s specifications.
 - » Normal wear and tear.
 - » Any other cause which does not relate to a product defect.
- Any product exhibiting a condition commonly known as "image burn-in" which results when a static image is displayed on the product for an extended period of time.
- Removal, installation, insurance, and set-up service charges.

How to get service:

For information about receiving service under warranty, contact ViewSonic® Customer Support (Please refer to the attached “Customer Service” page). You will need to provide your product’s serial number, so please record the product information in the space provided below on your purchase for your future use. Please retain your receipt of proof of purchase to support your warranty claim.

For Your Records

Product Name: _____ Model Number: _____

Document Number: _____ Serial Number: _____

Purchase Date: _____ Extended Warranty Purchase? _____ (Y/N)

If so, what date does warranty expire? _____

- To obtain warranty service, you will be required to provide (a) the original dated sales slip, (b) your name, (c) your address, (d) a description of the problem, and (e) the serial number of the product.
- Take or ship the product, in the original container packaging, to an authorized ViewSonic® service center.
- Round trip transportation costs for in-warranty products will be paid by ViewSonic®.

Limitation of implied warranties:

There are no warranties, express or implied, which extend beyond the description contained herein including the implied warranty of merchantability and fitness for a particular purpose.

Exclusion of damages:

ViewSonic®’s liability is limited to the cost of repair or replacement of the product.

ViewSonic® shall not be liable for:

- Damage to other property caused by any defects in the product, damages based upon inconvenience, loss of use of the product, loss of time, loss of profits, loss of business opportunity, loss of goodwill, interference with business relationships, or other commercial loss, even if advised of the possibility of such damages.
- Any other damages, whether incidental, consequential or otherwise.
- Any claim against the customer by any other party.
- Repair or attempted repair by anyone not authorized by ViewSonic®.

Contact Information for Sales & Authorized Service (Centro Autorizado de Servicio) within Mexico:	
Name, address, of manufacturer and importers: México, Av. de la Palma #8 Piso 2 Despacho 203, Corporativo Interpalmas, Col. San Fernando Huixquilucan, Estado de México Tel: (55) 3605-1099 http://www.viewsonic.com/la/soporte/index.htm	
NÚMERO GRATIS DE ASISTENCIA TÉCNICA PARA TODO MÉXICO: 001.866.823.2004	
Hermosillo: Distribuciones y Servicios Computacionales SA de CV. Calle Juarez 284 local 2 Col. Bugambilias C.P: 83140 Tel: 01-66-22-14-9005 E-Mail: disc2@hmo.megared.net.mx	Villahermosa: Compumantenimientos Garantizados, S.A. de C.V. AV. GREGORIO MENDEZ #1504 COL, FLORIDA C.P. 86040 Tel: 01 (993) 3 52 00 47 / 3522074 / 3 52 20 09 E-Mail: compumantenimientos@prodigy.net.mx
Puebla, Pue. (Matriz): RENTA Y DATOS, S.A. DE C.V. Domicilio: 29 SUR 721 COL. LA PAZ 72160 PUEBLA, PUE. Tel: 01(52).222.891.55.77 CON 10 LINEAS E-Mail: datos@puebla.megared.net.mx	Veracruz, Ver.: CONEXION Y DESARROLLO, S.A DE C.V. Av. Americas # 419 ENTRE PINZÓN Y ALVARADO Fracc. Reforma C.P. 91919 Tel: 01-22-91-00-31-67 E-Mail: gacosta@qplus.com.mx
Chihuahua: Soluciones Globales en Computación C. Magisterio # 3321 Col. Magisterial Chihuahua, Chih. Tel: 4136954 E-Mail: Cefeo@soluglobales.com	Cuernavaca: Compusupport de Cuernavaca SA de CV Francisco Leyva # 178 Col. Miguel Hidalgo C.P. 62040, Cuernavaca Morelos Tel: 01 777 3180579 / 01 777 3124014 E-Mail: aquevedo@compusupportcva.com
Distrito Federal: QPLUS, S.A. de C.V. Av. Coyoacán 931 Col. Del Valle 03100, México, D.F. Tel: 01(52)55-50-00-27-35 E-Mail : gacosta@qplus.com.mx	Guadalajara, Jal.: SERVICRECE, S.A. de C.V. Av. Niños Héroes # 2281 Col. Arcos Sur, Sector Juárez 44170, Guadalajara, Jalisco Tel: 01(52)33-36-15-15-43 E-Mail: mmiranda@servicrece.com
Guerrero Acapulco: GS Computación (Grupo Sesicomp) Progreso #6-A, Colo Centro 39300 Acapulco, Guerrero Tel: 744-48-32627	Monterrey: Global Product Services Mar Caribe # 1987, Esquina con Golfo Pérsico Fracc. Bernardo Reyes, CP 64280 Monterrey N.L. México Tel: 8129-5103 E-Mail: aydeem@gps1.com.mx
MERIDA: ELECTROSER Av Reforma No. 403Gx39 y 41 Mérida, Yucatán, México CP97000 Tel: (52) 999-925-1916 E-Mail: rrrb@sureste.com	Oaxaca, Oax.: CENTRO DE DISTRIBUCION Y SERVICIO, S.A. de C.V. Murguía # 708 P.A., Col. Centro, 68000, Oaxaca Tel: 01(52)95-15-15-22-22 Fax: 01(52)95-15-13-67-00 E-Mail: gpotai2001@hotmail.com
Tijuana: STD Av Ferrocarril Sonora #3780 L-C Col 20 de Noviembre Tijuana, Mexico	FOR USA SUPPORT: ViewSonic® Corporation 381 Brea Canyon Road, Walnut, CA. 91789 USA Tel: 800-688-6688 E-Mail: http://www.viewsonic.com



ViewSonic®