

Wing + Brother Printer Mount

Assembly Instructions

Tools Required:

- All tools provided

Sheet Code: BP-IM-128_REV0
Release Date: 01/08/2025

Copyright 2025 SpotSpot Ltd. (T/A Bouncepad) all rights reserved. Confidential, no part of this publication may be reproduced or transmitted in any form without the written permission of the copyright holder.

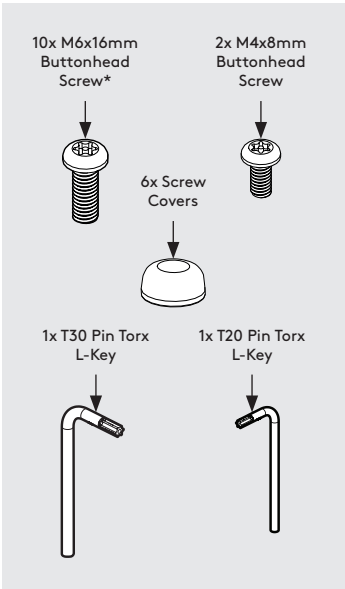
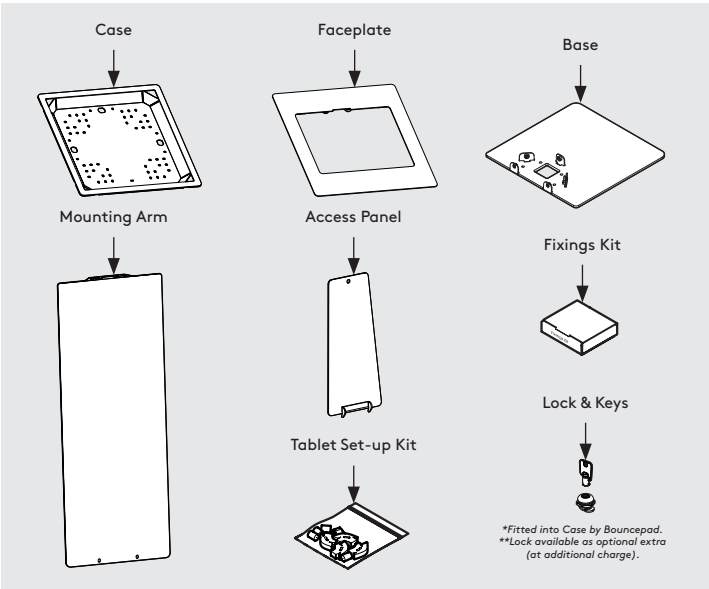

In the Box (Wing)

Large Shipping Box Contains: 'Mounting Arm' Only
Small Shipping Box Contains: 'Faceplate', 'Case', 'Access Panel', 'Base', 'Tablet Set-up Kit', 'Fixings Kit' & 'Lock & Keys**'



Fixings List (Wing)

Due to the modular nature of our product range you may receive additional fixings in the fixings kit.
* Previous models may have been supplied with 10mm.

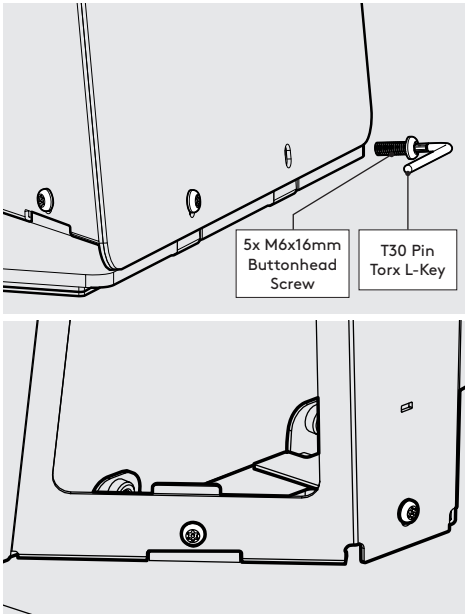
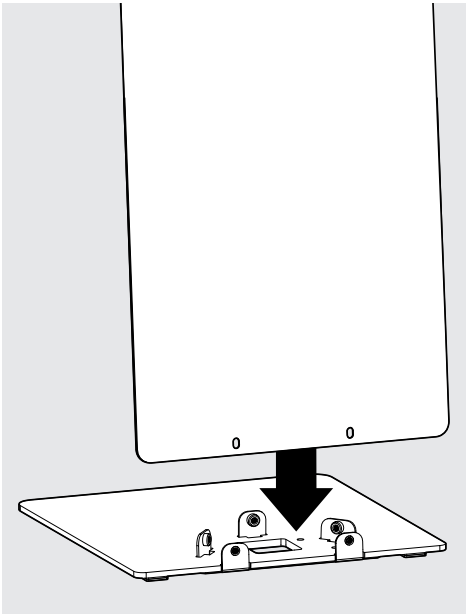
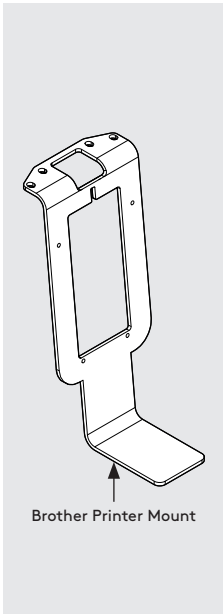

In the Box (Printer Mount)



Fixings List (Printer Mount)

1

Locate the Mounting Arm onto the Base.

2

Secure the Mounting Arm to the Base as shown.

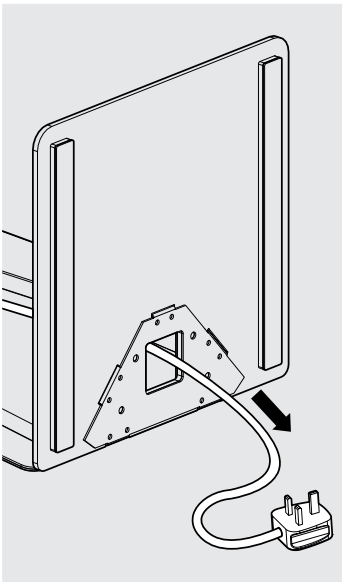
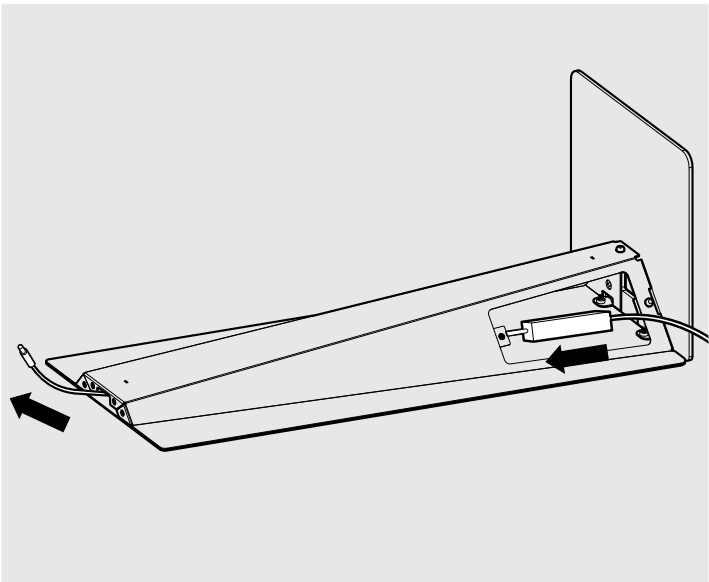
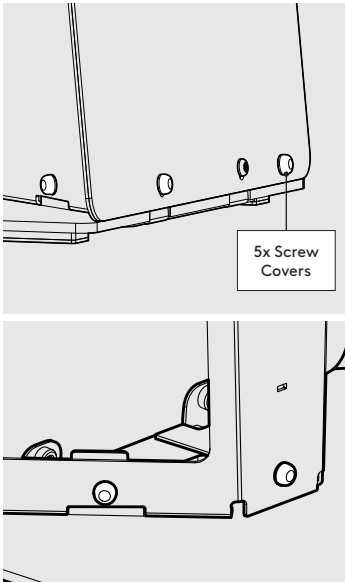

3

Attach 5x Screw Covers.

4

Feed the Printer's Power Cable through the Mounting Arm by entering through the Access Hole.

4

Feed the Printer's Power Cable Plug out of the Base.

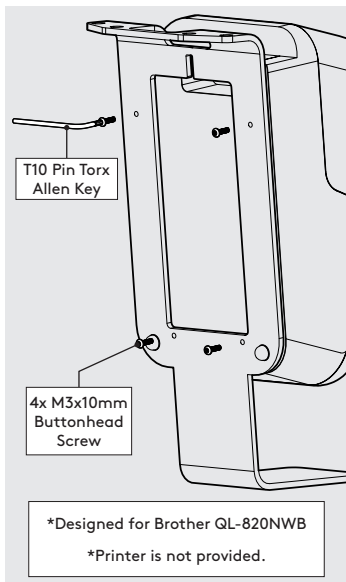

5 Attach the Printer to the Printer Mount using 4x M3x10mm Screws

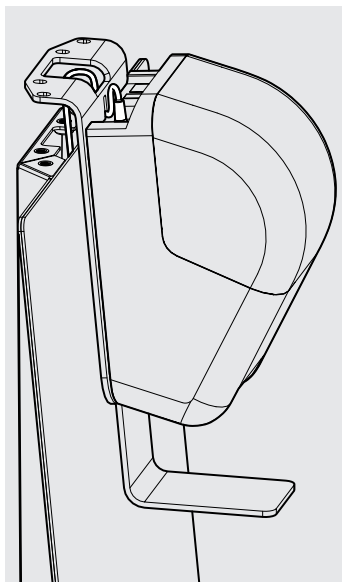

6 Feed Printer's Power Cable through Printer Mount & plug into the Printer.

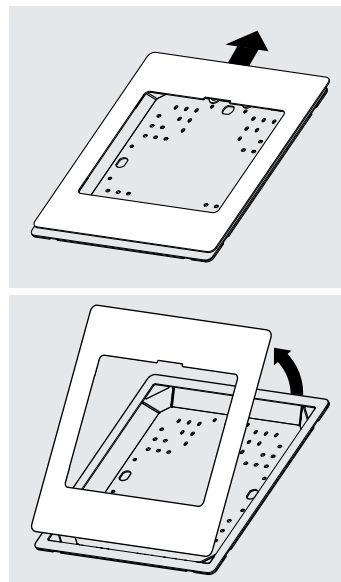

7 Remove the Faceplate from the Case by pushing upwards & pivoting.

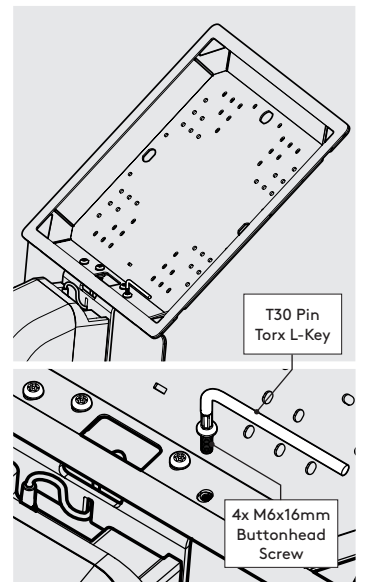

8 Attach the Case to the Mounting Arm & Printer Mount. Ensure the Case is aligned.

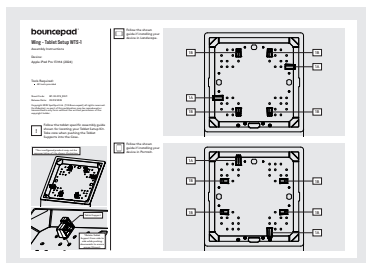

9 Select your Tablet Set-up Kit Instructions. Install the Tablet Set-up Kit. Each kit is specific per Tablet & Case.

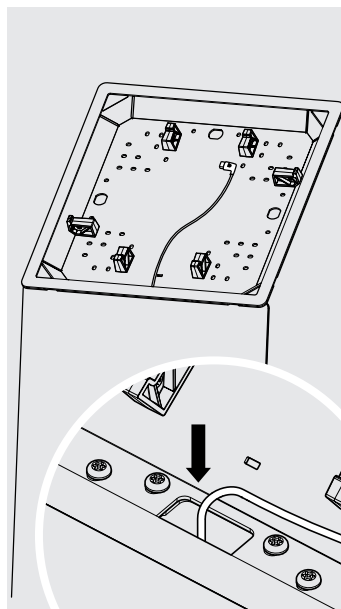

10 Feed the Tablet's Power Cable through the Case & Mounting Arm.

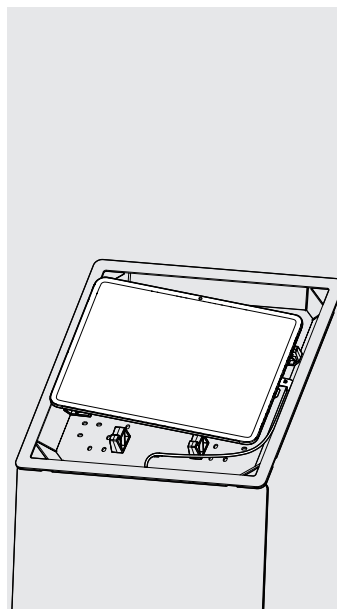

11 Place the Tablet into the Case & connect the Tablet's Power Cable.

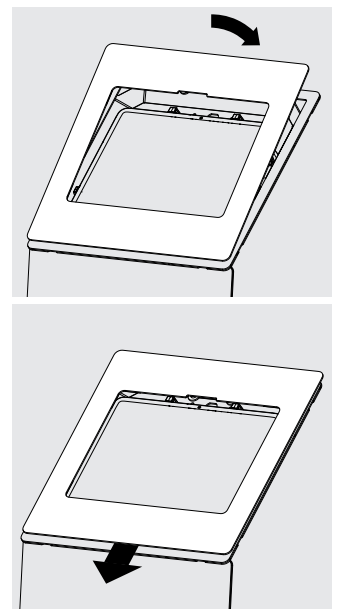

12 Locate the Faceplate to the Case by pivoting & pushing downwards.

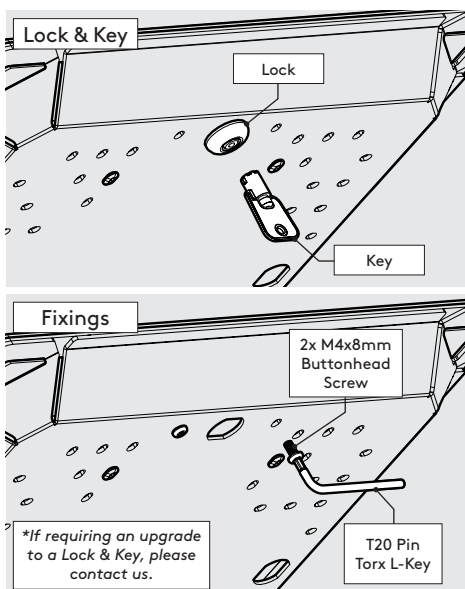

13 Secure the Faceplate with your chosen locking method.

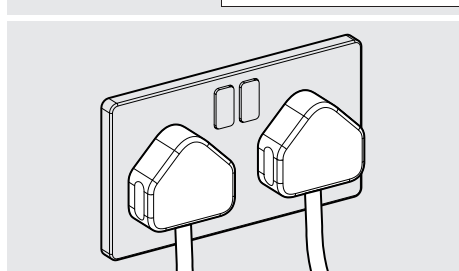
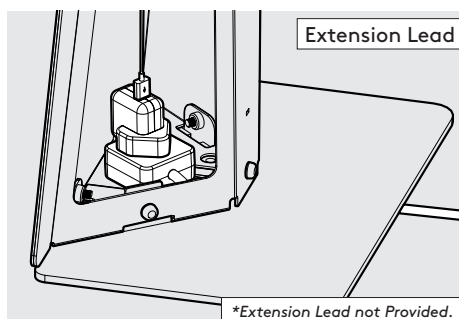

14.1 Connect the Tablet's Power Cable to an Extension Lead & then connect both Power Cables to a Power Source.

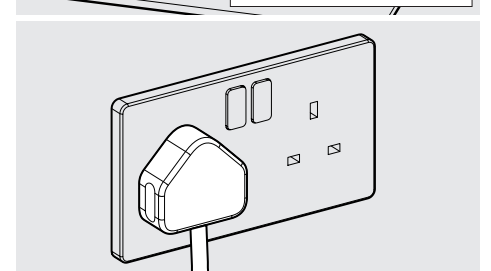
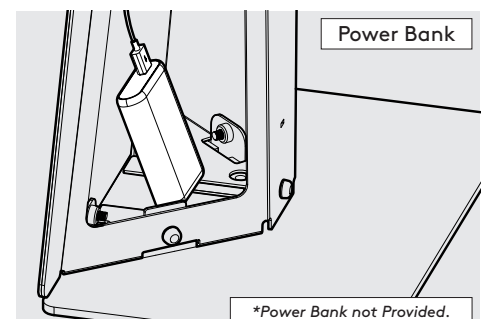

14.2 Connect the Tablet's Power Cable to a Power Bank & connect the Printer's Power Cable to a Power Source.

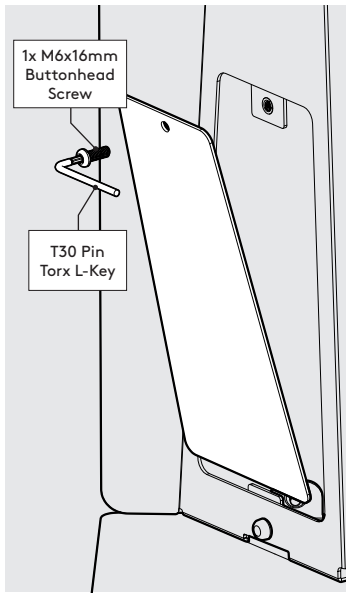

15 Locate and secure the Access Panel to the Mounting Arm.

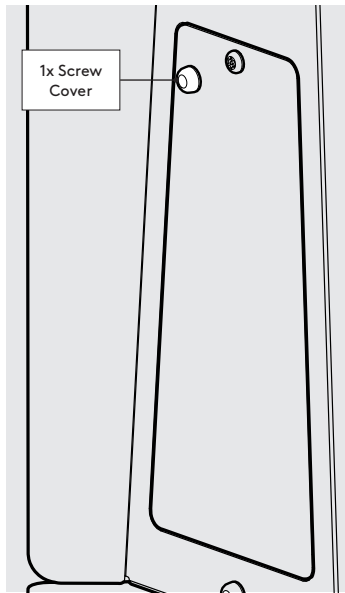

16 Attach 1x Screw Cover.

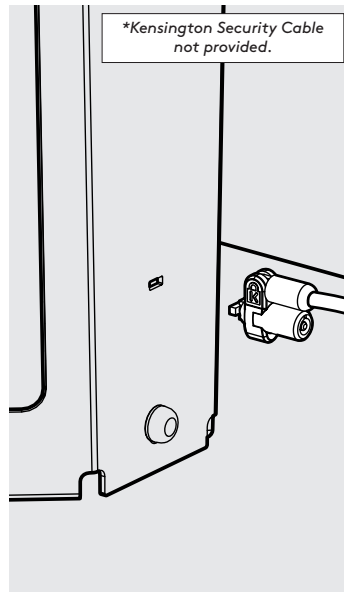

17 For added security, install a Kensington Security Cable.

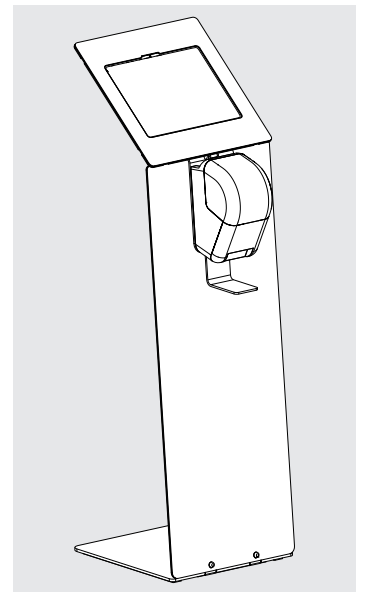

18 Installation is now complete.