



iiShare

User Manual

Catalog

1 Product Overview -----	2
1.1 Application Scenarios -----	2
1.2 App Download -----	2
1.3 Activation Process -----	2
2 Function List -----	4
2.1 IFPD Side -----	4
2.1.1 Main Interface -----	5
2.2 PC Side (Mac/Win) -----	10
2.2.1 Main Interface -----	11
2.3 Mobile Side (iOS/Android) -----	14
2.3.1 Main Interface -----	15
2.4 Hardware Side-SC1 -----	17
2.4.1 Quick Start -----	18
3 Native Protocol Casting -----	19
3.1 Miracast -----	19
3.2 Airplay -----	20
3.3 Google(Chrome) Cast -----	21
4 Key Features -----	23
4.1 Device Sync -----	23
4.2 Gallery Mode -----	25
4.3 Floating Window -----	27
4.4 Wired Projection Screen (Android) -----	29
4.5 Webcast - Cloud Screen Cast -----	30
4.6 NFC Casting -----	32

1 Product Overview

iiShare is a powerful wireless casting software that supports multi-device, multi-platform wireless casting for screen content sharing, display, interactive control and collaboration.

1.1 Application Scenarios

1. Business Meeting Scene
2. Education and Training Scene
3. Home Entertainment Scene
4. Business Presentation Scene
5. Medical Assistance Scene
6. Video Conference Scene

1.2 App Download

Download URL: <https://cast.helloigo.tech/v3>

1.3 Activation Process

The interface is not displayed for factory-activated software; unactivated software requires the entry of an activation code (supplied by the salesperson) upon initial startup.

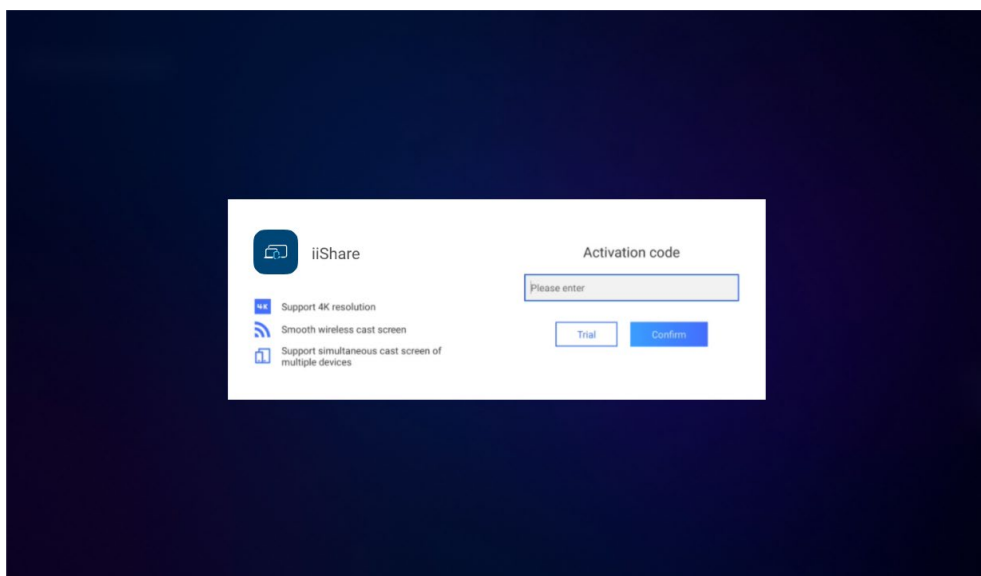

Activation code interface

①If the activation is successful, the top right corner of the main interface of the software will show whether the screen casting software is the Basic Version or the Professional Version.

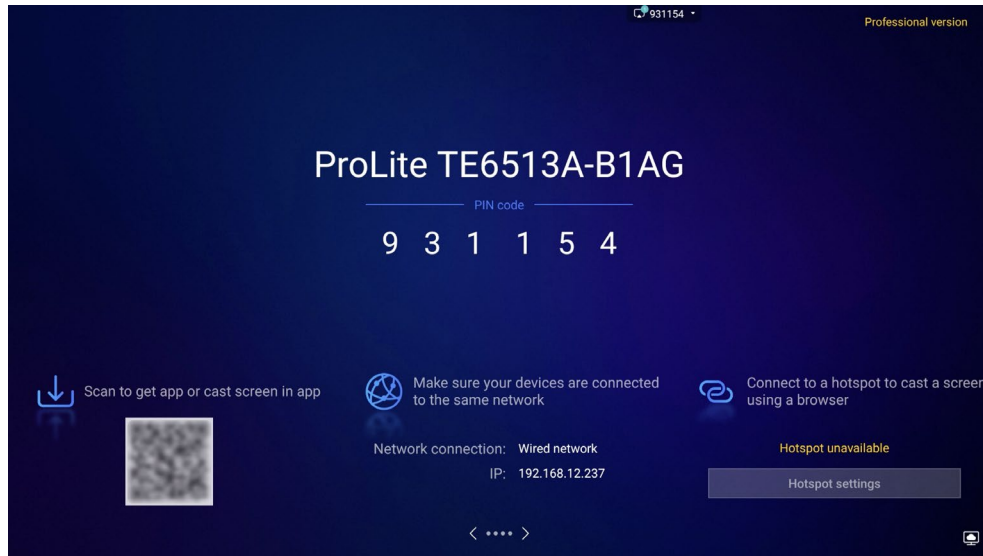

If you want to upgrade from Basic Version to Professional Version, please contact the Sales to get the activation code of Professional Version.

②If the activation fails, a prompt will appear on the IFPD, please follow the prompt to operate.

- **【Activation code error】** - please re-enter the activation code;
- **【Network connection failed, please try again later】** - please check the network settings;
- **【Activation code has been used by another device】** , **【Activation failed】** - please contact the Sales.

In addition: If you upgrade the firmware or perform a reset, you need to connect to the Internet again for automatic activation. If you don't have internet connection, there will be a problem of not being able to activate.

2 Function List

2.1 IFPD Side

Functions	Descriptions
Network Information Display	Dynamically displays the current network status, type, and signal strength
Click to Connect	Supports clients to directly connect by clicking on the device name
PIN Code Connection	Supports client connection through a PIN code
IP Cddress Connection	Supports client connection using an IP address
1080P casting	Supports real-time 1080P casting for clients
4K casting	Supports real-time 4K ultra-clear casting for clients
Applicaition Cindow Casting	Supports client application window casting
Document Casting	Supports client document casting
Media File Casting	Supports client media file casting
NFC Casting	Supports screen casting by NFC tags
Webcast - Cloud Screen Cast*	Support remote cross-network casting
ChromeCast*	Support chrome browser casting
BYOM*	Support to invoke IFPD external devices, such as: camera, speaker, microphone
Boardcast*	Support synchronise the screen and sound wirelessly and in real time between multiple IFPDs
Reverse Control*	Support client wireless control of IFPD
Audio Source Control	Supports switching audio output to the client or the IFPD
Full-Screen Switching	Supports switching to client-specific full-screen display
Intelligent Layout	Smart multi-screen layout, supports multi-channel casting
Custom Name	Supports customizing the device name on the IFPD
Caster Casting	Supports hardware casting

(* are iiShare professional functions)

2.1.1 Main Interface

On the homepage of iiShare, click on [Area 1](#) to open the [\[Function List\]](#).

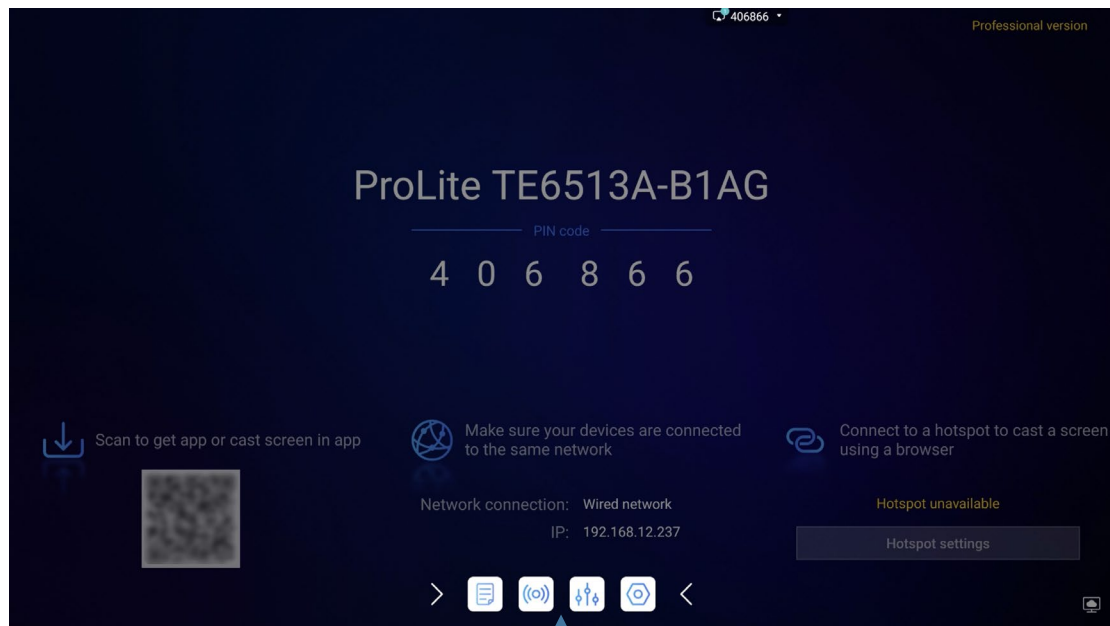
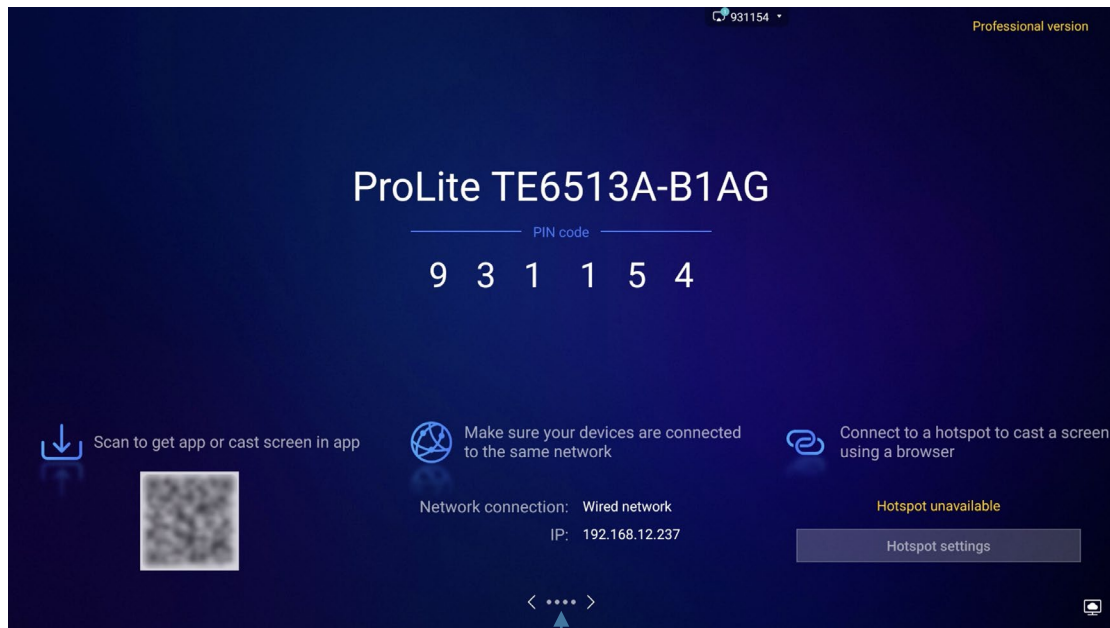

The function list contains:

Casting Tutorial, Broadcast, Device Management, and Settings.

(1) Casting Tutorial

As shown in the following image, there are various connection methods, including iiShare client, Miracast/Airplay/DLNA, and browser. You can follow these instructions to connect and use your device.

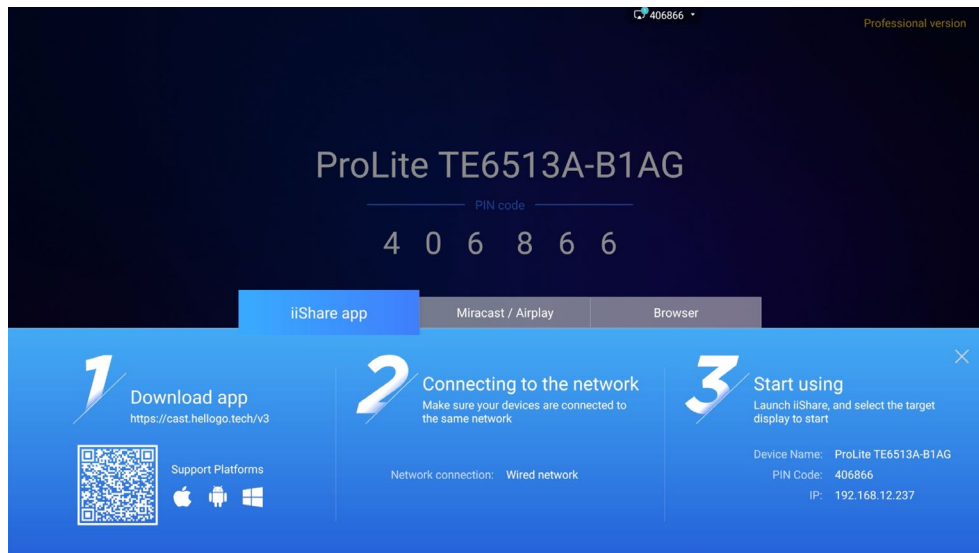

(2) Broadcast

In the same network, multiple IFPDs can wirelessly synchronize screen display and sound in real time without the need for an HDMI out connection cable.

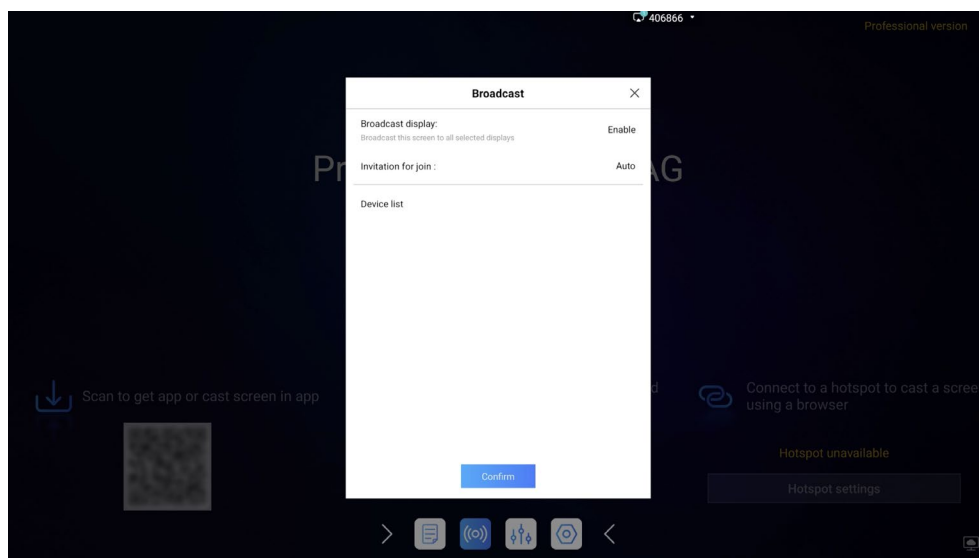

(3) Device Management

[Device Management]

The screen displays information about devices connected to the current IFPD. It supports user control and switching of the casting device's status, casting, reverse casting, pausing casting, and disconnecting.

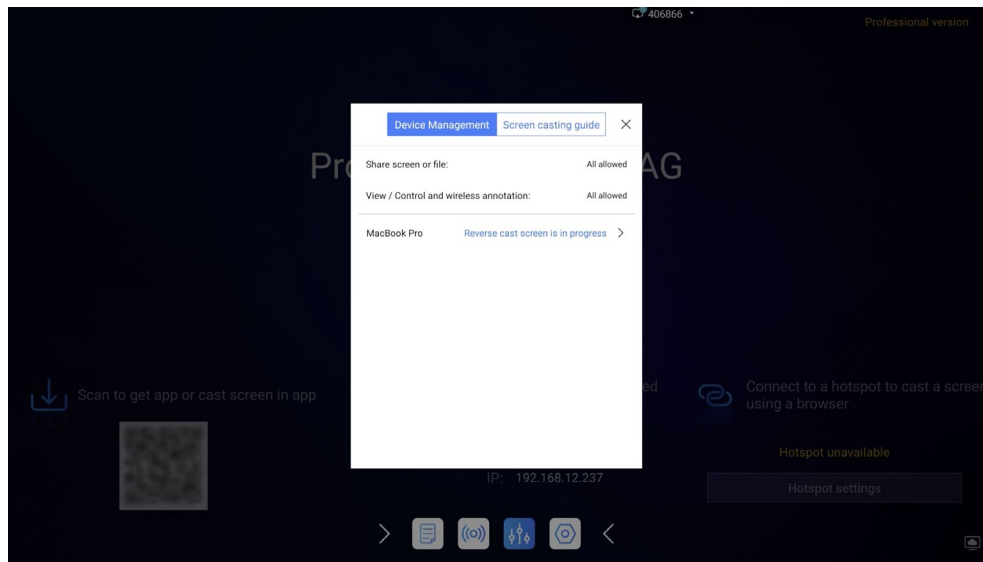

[Casting Guide]

This page displays the casting information for the current IFPD, making it convenient for other users to quickly initiate casting operations.

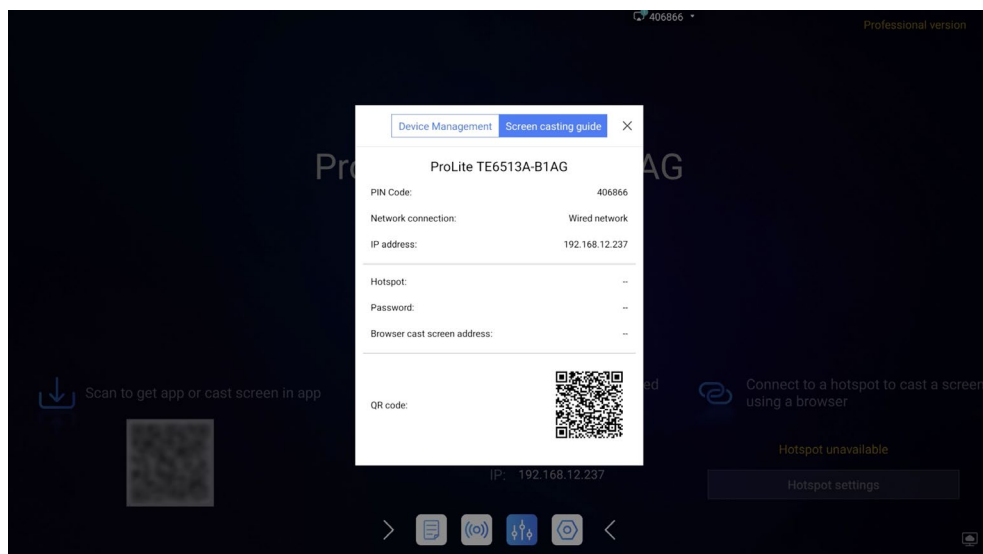

(4) Settings

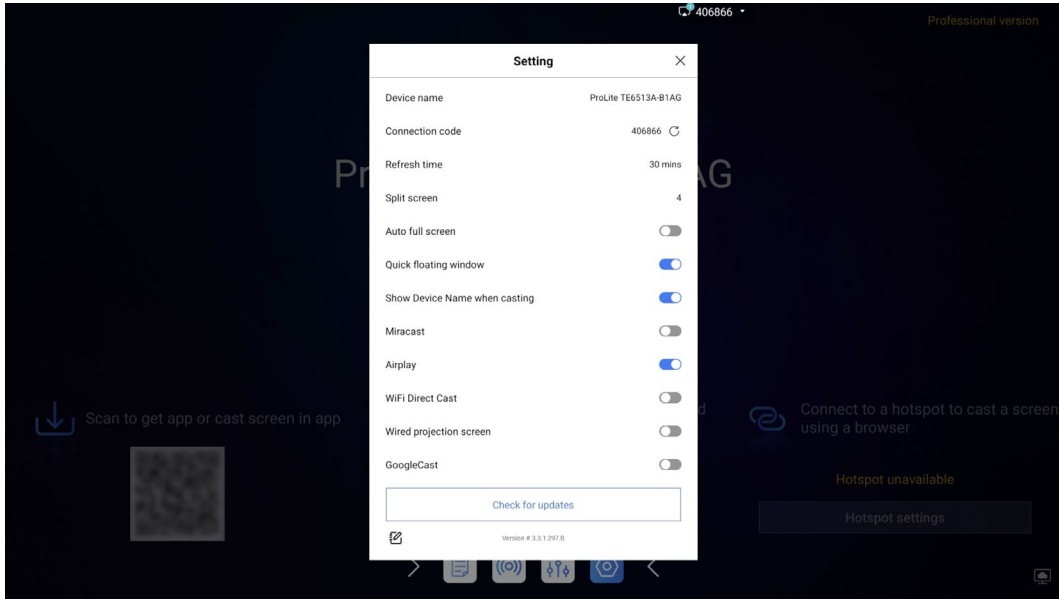

(1) **Device Name:** Edit the device name.

(2) **Connection code:** When cloud casting is not enabled, the connection code defaults to 6 digits, which can be refreshed manually; when cloud casting is enabled, the connection code defaults to 6 digits plus letters, if you need to refresh the connection code, please reset the system.

(3) **Refresh Time(When cloud casting is not enabled):** Set the update frequency of the casting code, you can set no refresh, update once every 30 minutes or once every 24 hours.

(4) **Split screen:** Choose the maximum number of screen casts, which is the maximum number of simultaneous multi-device screen casts;

(5) **Auto full screen:**When turned on, the cast screen content automatically fills the screen;

(6) **Quick Floating Window:** Enabled by default. The quick floating window is located at the top of the IFPD, displaying the casting code or IP information, as shown in the following image.

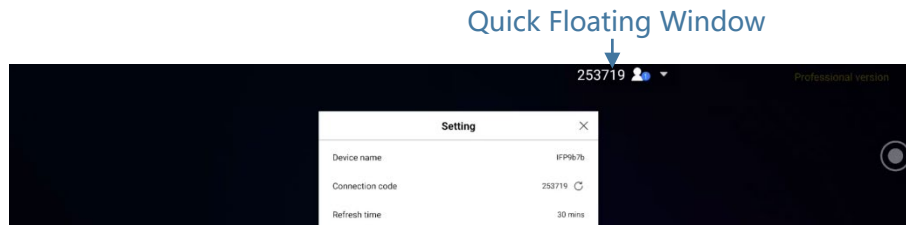

Click on [Quick Floating Window] to perform control operations, including [Device Management] and [Casting Guide].

(7) Miracast/Airplay/Google(Chrome)Cast: Enabled by default.

(8) WiFi Direct Cast: Disabled by default. When it is turned on, you can search and cast to the corresponding IFPD on the Windows client software by just enabling WiFi without connecting to the network.

(9) Check for Updates: Get the latest version of iiShare.

2.2 PC Side (Mac/Win)

Functions	Descriptions
Network Information Display	Dynamically shows the current network status, type, and signal strength
Discover Devices	Supports automatic and manual refreshing of the device list
Click to Connect	Supports direct connection by clicking on the device name
PIN Code Connection	Supports connection using a PIN code
IP Address Connection	Supports connection using an IP address
1080P Casting	Supports real-time 1080P casting
One-Click Casting	Supports triggering casting with a single click
Document Casting	Supports casting of document file types
Media Casting	Supports casting of images, audio, and video files
Reverse Casting*	Supports transferring content from the receiving end back to the casting end
Reverse Control*	Support client wireless control of IFPD
Webcast - Cloud Screen Cast*	Support remote cross-network casting
ChromeCast*	Support chrome browser casting
Device Sync*	Support to invoke IFPD external devices, such as: camera, speaker, microphone
Audio Source Control	Supports switching audio output to the IFPD or computer
Pause/Resume	Supports pausing or resuming casting
End Casting	Ends and exits the current casting content
Full Screen/Exit Full Screen	Supports displaying casting content in full screen and exiting full screen
Disconnect	Supports disconnecting from the mirrored device
Network Detection	Supports casting network environment detection
Customize Device Name	Supports customizing the casting device name
Caster Casting	Supports hardware casting

(* are iiShare professional functions)

2.2.1 Main Interface

(1) When disconnected

When it is ensured that both the computer and the IFPD are connected to the same network, you can directly enter the screen casting code or IP address to connect to the IFPD. Alternatively, you can click on the [Connect] button next to a specific IFPD device in the [Device List] at the bottom, and then enter the screen casting code to establish the connection.

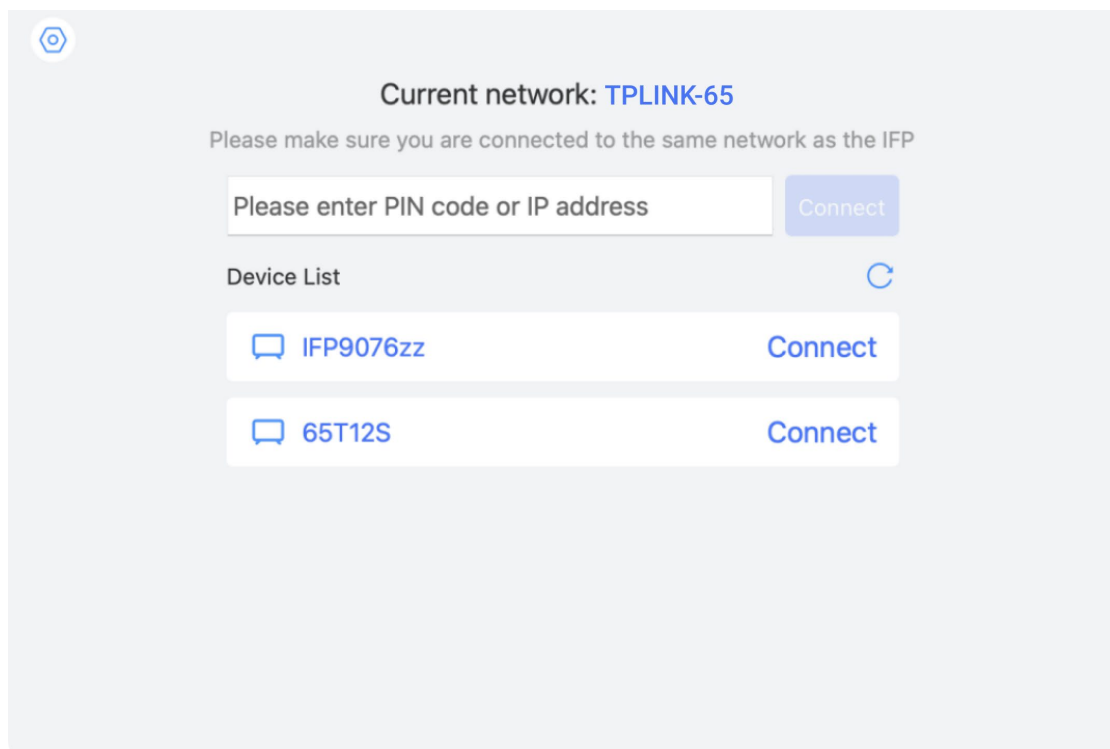

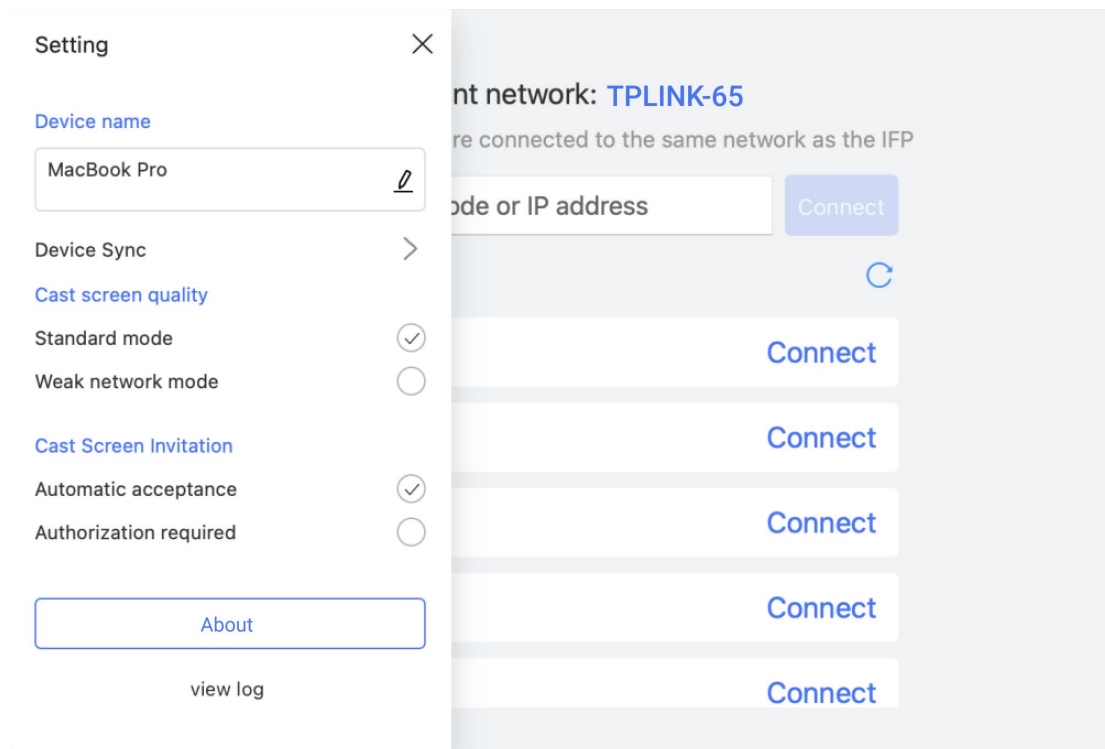

Click the top-left corner to open [Settings], where you can perform the following operations:

- Device Name: Customize the name of your computer device, which will be displayed in the [Device Management] interface on the IFPD.
- Device Sync: After connecting the device to the IFPD, you can enter the BYOM invocation interface to call the camera and microphone on the IFPD (see 4.1 BYOM for details).
- Screen Quality: Adjust the screen casting quality to Standard or Weak Network mode.
- Screen Casting Invitation: Set whether to automatically accept screen casting invitations or require authorization.

- About: Click to view the software version and check for updates.
- View Log: Click to view logs.

(2) When connected

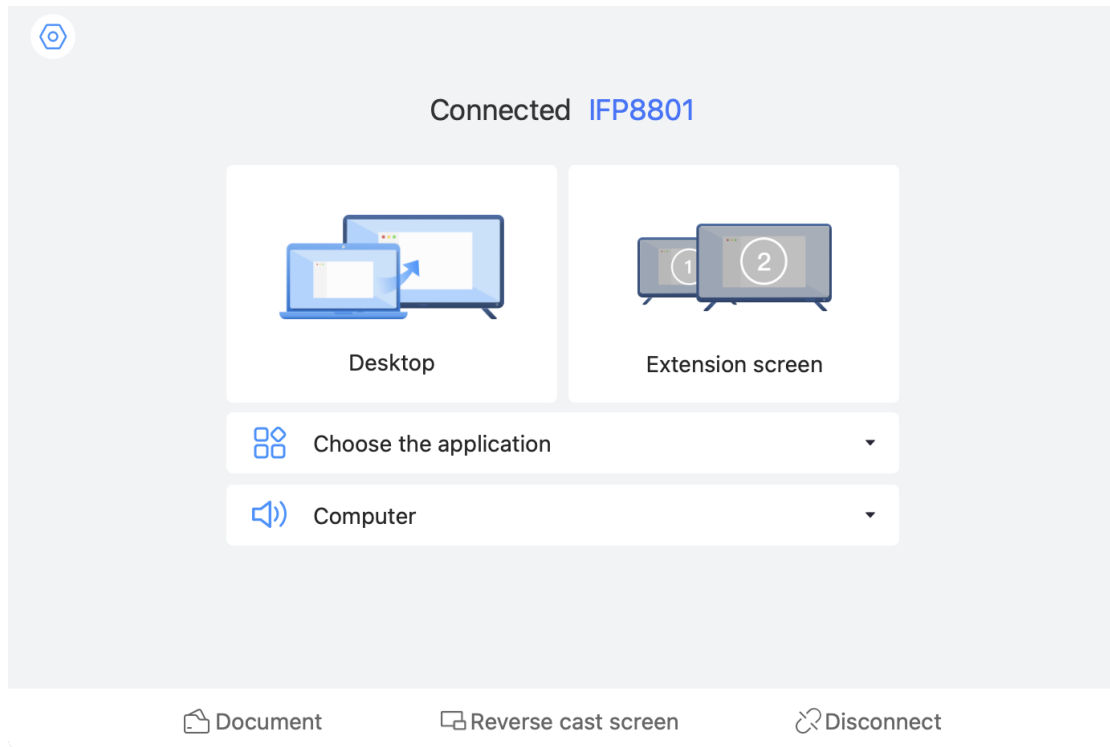

- Desktop: Click to cast the desktop screen to the IFPD.
- Extended Screen: Click to use the IFPD as an extended display.
- Choose the application: Click to cast the screen of an open application on your computer.
- Output Sound: Click to switch the audio output between the computer and the IFPD.
- Document: Click to select and cast documents from your computer.
- Reverse Cast Screen: Click to view and control the IFPD from your computer.
- Disconnect: Click to disconnect from the IFPD.

2.3 Mobile Side (iOS/Android)

Functions	Descriptions
Network Information Display	Dynamically shows the current network status, type, and signal strength
Discover Devices	Supports automatic and manual refreshing of the device list
Click to Connect	Supports direct connection by clicking on the device name
PIN Code Connection	Supports connection using a PIN code
IP Address Connection	Supports connection using an IP address
QR Code Connection	Supports connection by scanning a QR code
One-Click Casting	Supports triggering casting with a single click
Document Casting	Supports casting of document file types
Media Casting	Supports casting of images, audio, and video files
Reverse Casting	Supports transferring content from the receiving end back to the casting end
NFC Casting	Supports screen casting by NFC tags
Reverse Control*	Support client wireless control of IFPD
Pause/Resume	Supports pausing or resuming casting
End Casting	Ends and exits the current casting content
Full Screen/Exit Full Screen	Supports displaying casting content in full screen and exiting full screen
Disconnect	Supports disconnecting from the mirrored device
Disconnect and Reconnect	Supports automatic reconnection after a network interruption
Customize Device Name	Supports customizing the casting device name

(* are iiShare professional functions)

2.3.1 Main Interface

(1) When Disconnected

When it is ensured that both the computer and the IFPD are connected to the same network, you can directly enter the screen casting code or IP address to connect to the IFPD. Alternatively, you can click on a specific IFPD device in the [Device List] at the bottom, and then enter the screen casting code to establish the connection.

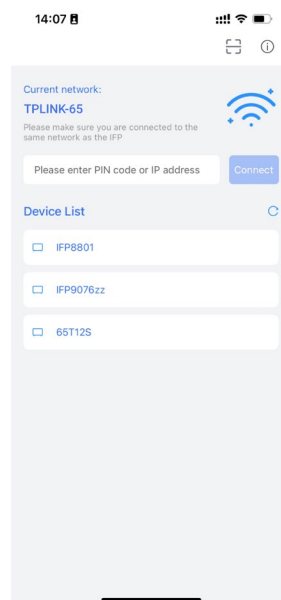

Right Upper Corner Operations:

- Scan Code: Click to connect by scanning the QR code on the home page of the IFPD.
- More Information: Click to change the device name on the mobile end and view the software version to check for updates.(Specific details are subject to the actual product.

(2) When Connected

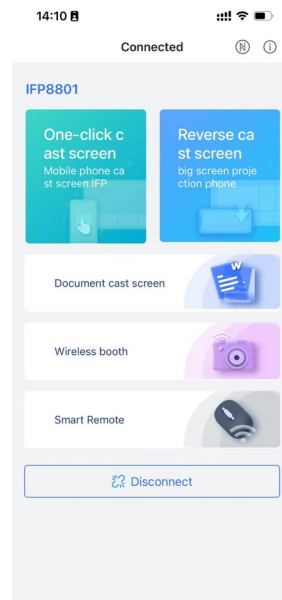

- One-Touch Casting: Click to cast the phone screen to the IFPD.
- Reverse Casting: Click to display the IFPD on the phone, allowing you to control the IFPD while also performing functions such as [Back], [Home], [Multitask], [Annotate], and [Screenshot].
- Document Casting: Click to cast documents (Word, PPT, Excel formats) from the phone to the IFPD.
- Infinite Podium: Click to display the content captured by the phone's camera on the IFPD.
- Smart Remote: Click to choose [Touch], [Mouse], or [Button] mode to control the IFPD from a distance.
- NFC Write: Click the [NFC Write] function in the top-right corner to write to an NFC tag (see section 4.6 NFC Casting for details).

2.4 Hardware Side-SC1

Designed for the integrated conferencing solution to facilitate the highly frequent screencasting demands during meetings. And more to content sharing, it enables wireless audio and camera connection, rendering an efficient remote collaboration preparation of cableless convenience and delight.



Functions	Descriptions
4K HD Resolution	Powered by 2x2 MIMO, Wi-Fi 6 chip with stable transmission and fast connection. Up to 4K/30 frame rate ultra HD casting presents superb video details
Secured Casting	Supports WPA3 data encryption to secure sharing, and guards your casting contents with high standard security of data encryption.
One Click Casting	Support pressing the screen casting button to cast directly
Touch Back	Support to control the screen casting screen of computer on the IFPD side
Device Sync	Allows meeting attendees to wirelessly use the camera connected to the display through screencasting pod with which the conference camera, microphones and screencasting can function as a whole, and only by the plug-in pod. It builds to an integrated wireless conferencing solution with efficiency and averts visually disruptive cabling

2.4.1 Quick Start

(1) Open the screen casting software and insert SC1 into the USB Type-C port. If there is no USB Type-C port, use an adapter to insert it into the USB Type-A port.

(2) Wait for the IFPD to display "USB Screen Dongle Pairing Successful," then insert SC1 into the Type-C port of the computer.

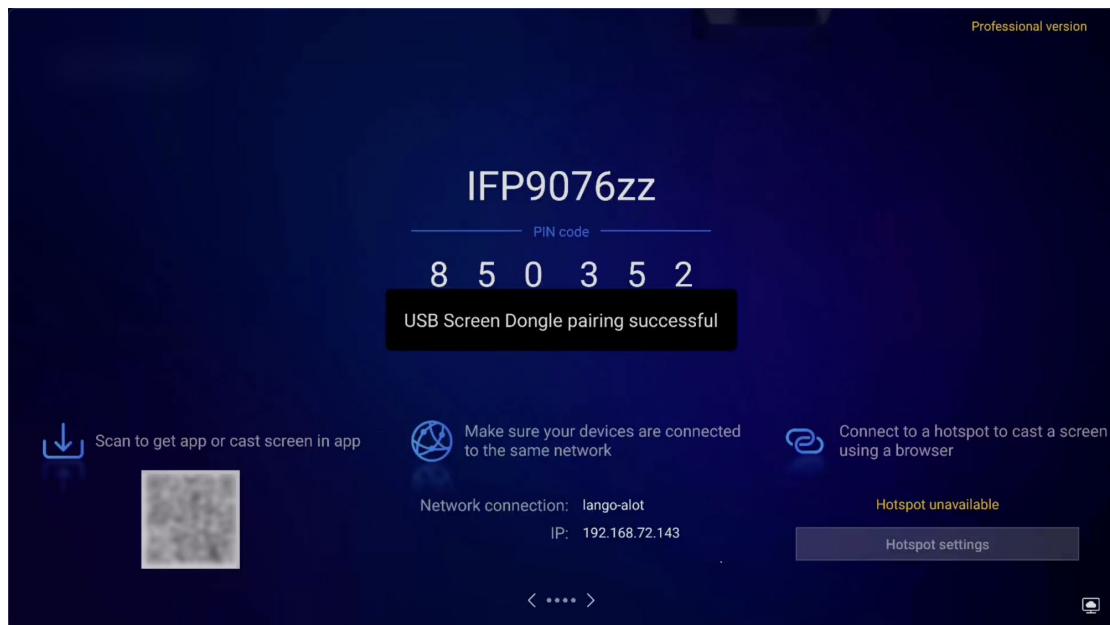

(3) Wait for the indicator light on SC1 to turn green, then press the screen casting button to start casting (press the button again to pause casting).

(4) In the conference software, select the camera, speaker, and microphone devices as SC1.

3 Native Protocol Casting

3.1 Miracast

(1) Turn on the [Miracast] function in [Settings];

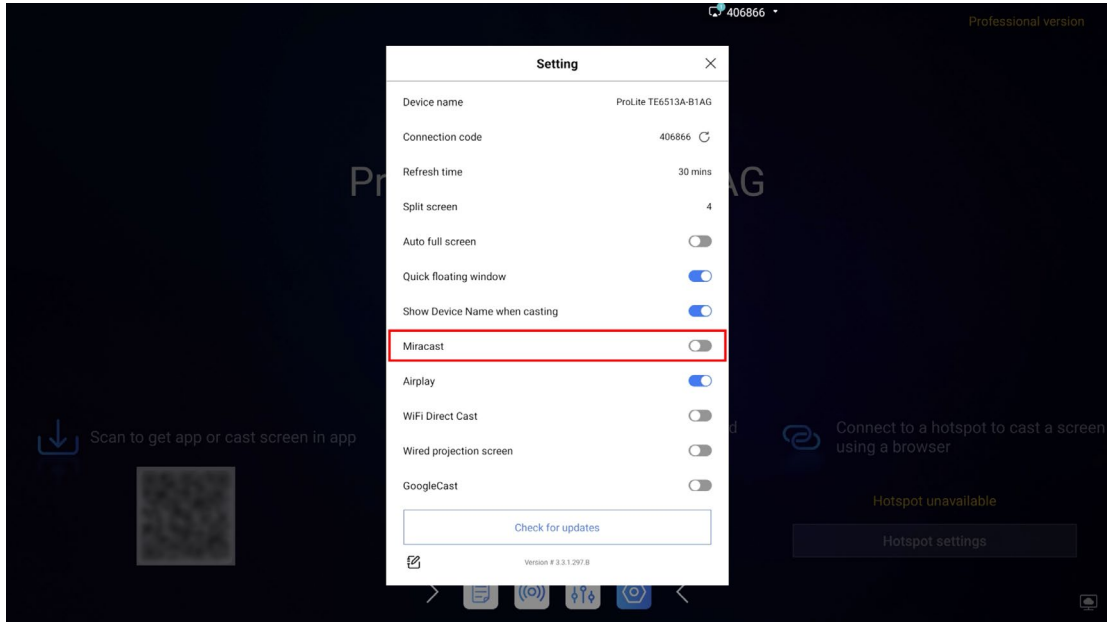

(2) Make sure the network of your Windows computer is the same as the IFPD;

(3) After clicking [Drop], you can drop the screen after selecting the corresponding IFPD device.

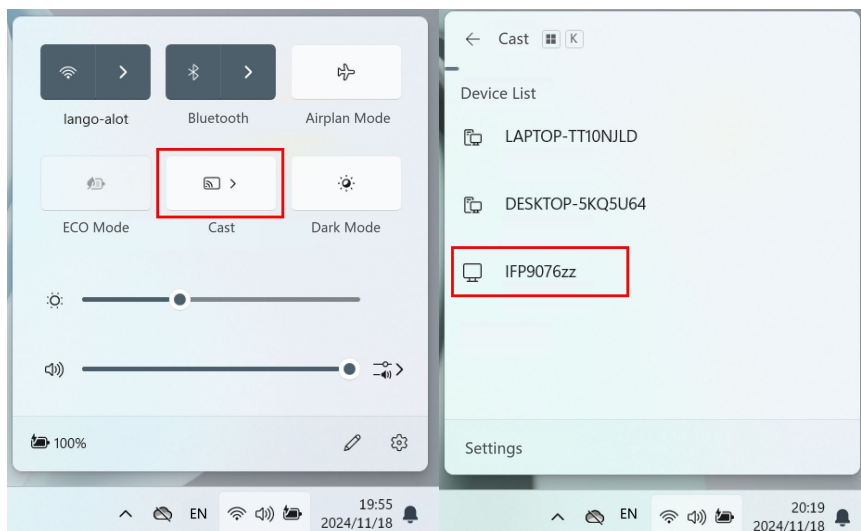

Note: Some motherboards need to close the hotspot on the IFPD end to use the Miracast function due to hardware or driver limitations.

3.2 Airplay

(1) Turn on the [Airplay] function in [Settings];

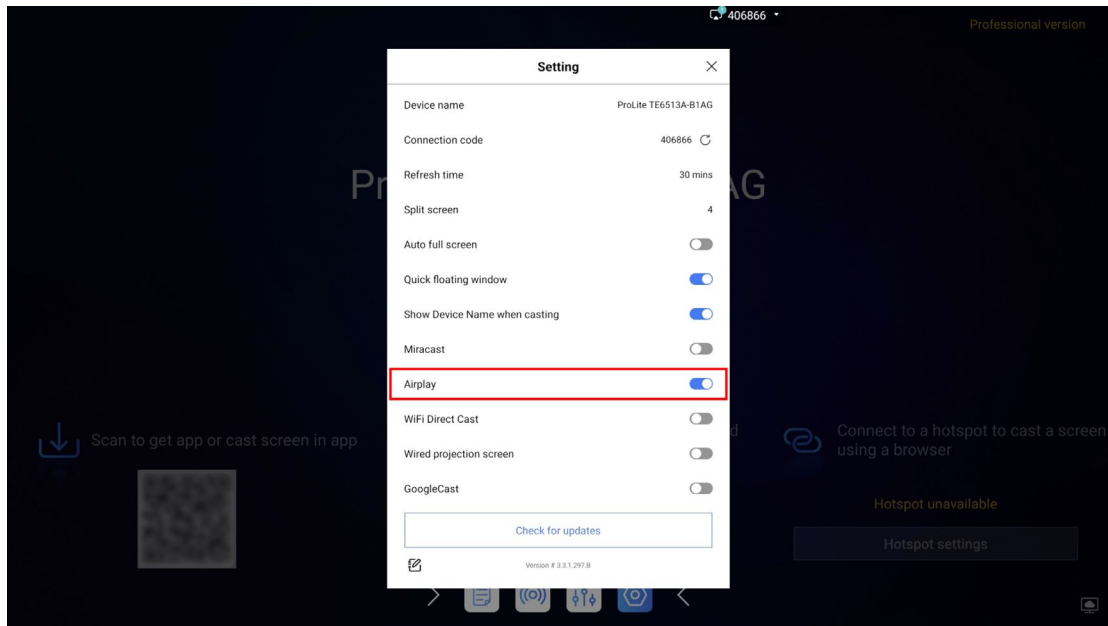

(2) Make sure the network of your Apple phone/computer is the same as the IFPD;

(3) After clicking [Screen Mirroring] in [Control Centre], you can see the name of the corresponding IFPD device in the device list, click it to start casting screen.

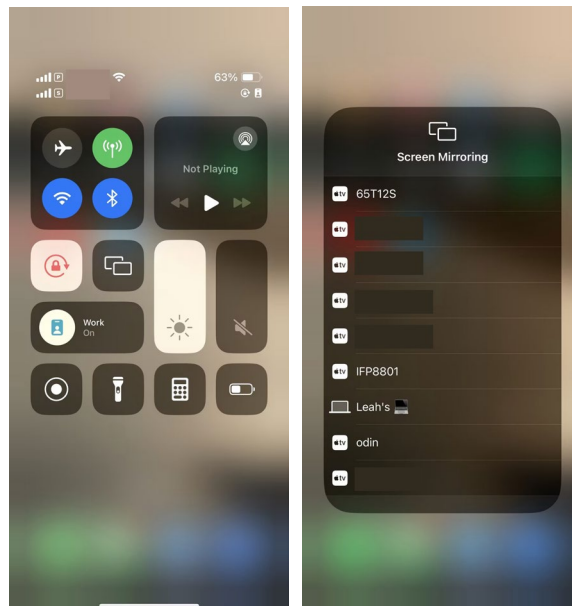

Mobile Side

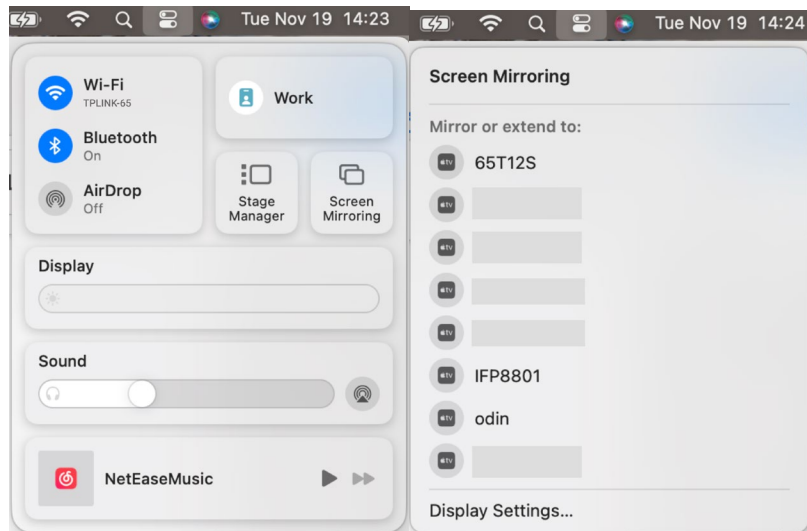

PC Side

3.3 Google(Chrome) Cast

(1) Turn on the [Google(Chrome)Cast] function in [Settings];

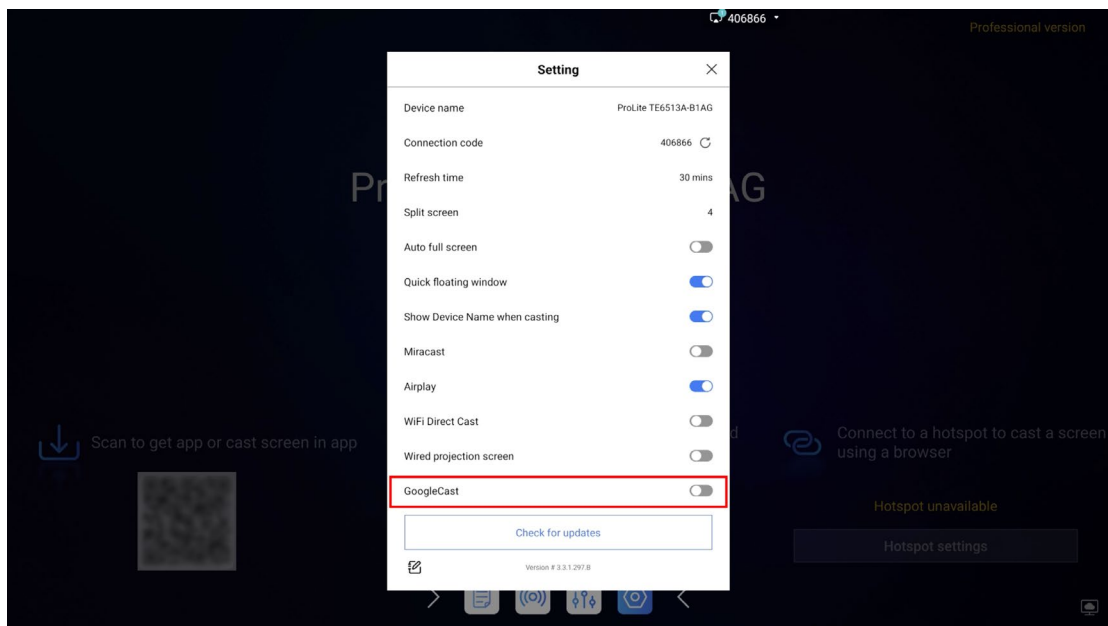

(2) Make sure the current computer's network is consistent with the IFPD;

(3) After using Google Chrome, click on the three dots in the upper right corner to expand More, then click on [Cast, Save & Share], and then click on [Cast];

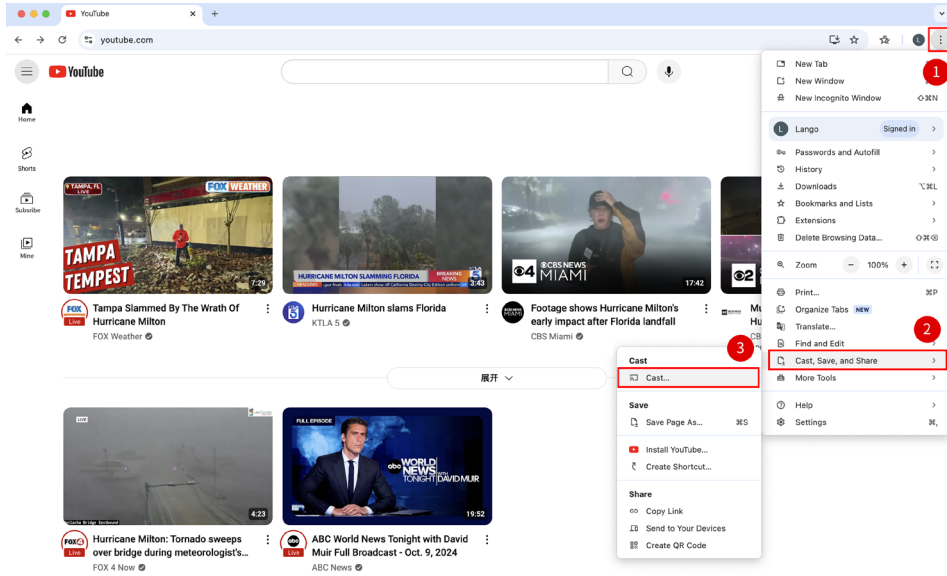

(4) The IFPD device can be seen in the current pop-up window, and you can cast the screen after clicking on it.

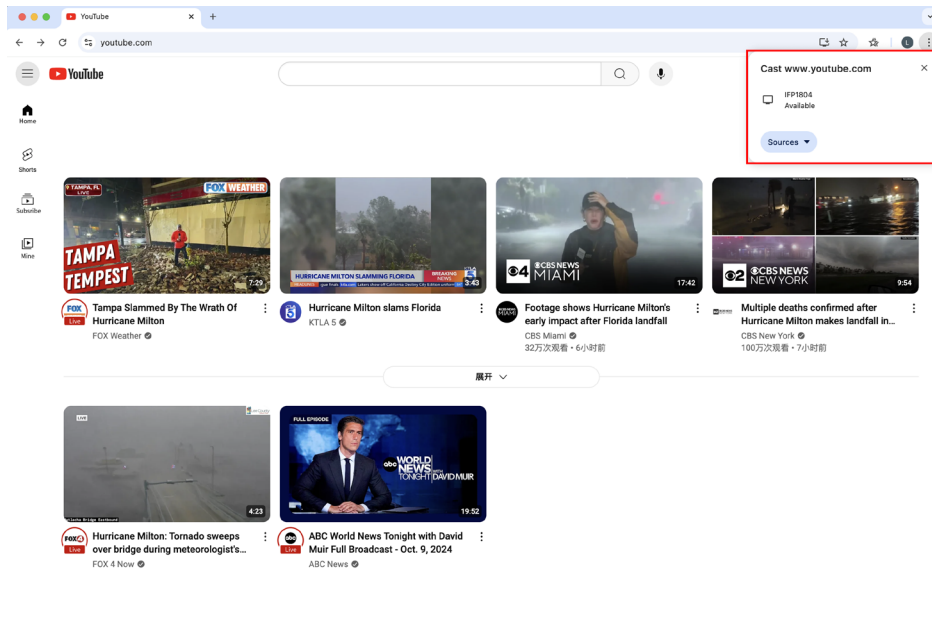

4 Key Features

4.1 Device Sync

(1) First, use a computer to connect to the IFPD device;

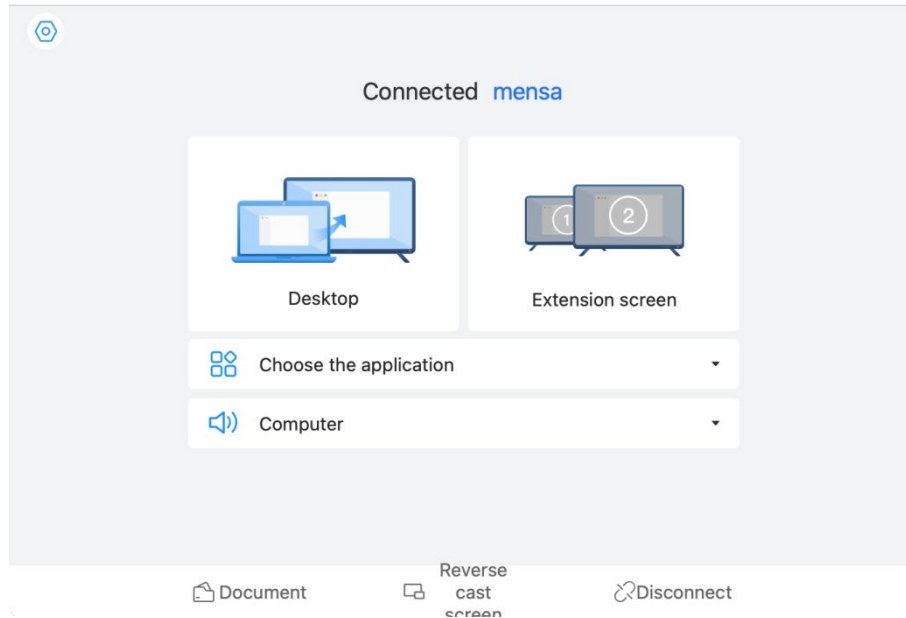

(2) Click "Settings - Device Sync" in the upper left corner to enter the BYOM debugging interface;

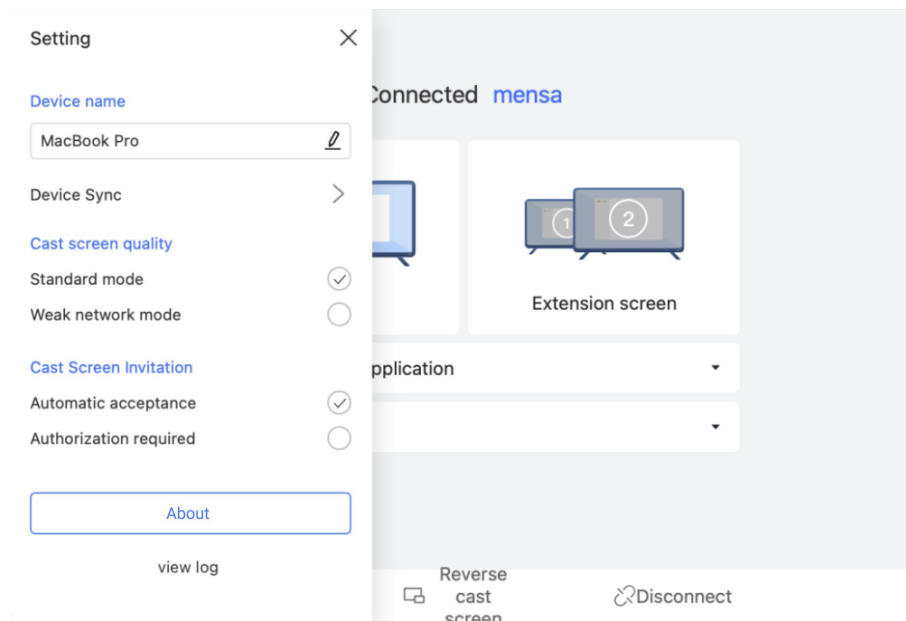

(3) You can open the camera or microphone for testing, and you can check the external camera invoking in the preview screen;

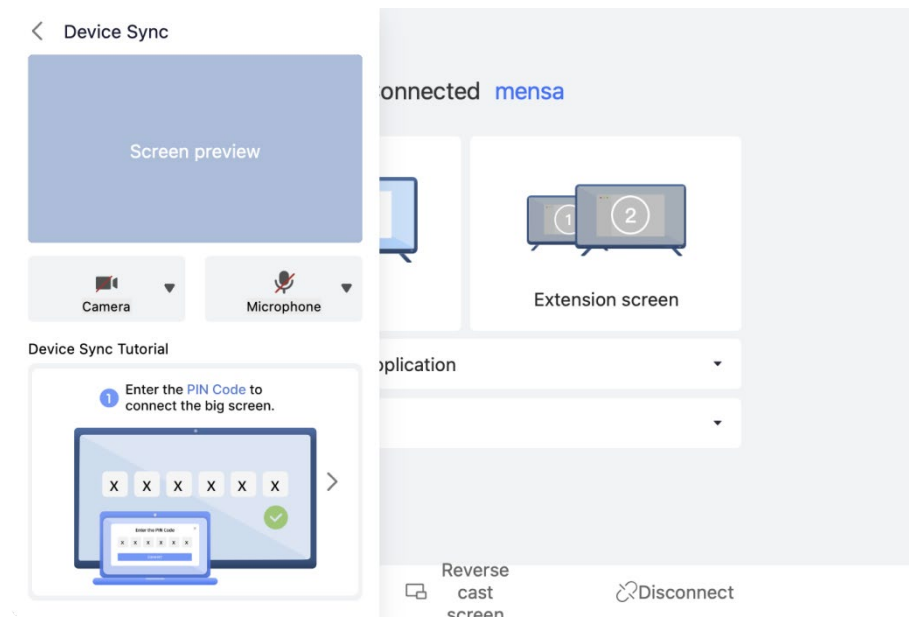

(4) When the external device is successfully invoked, you can open the conference software and select BYOM Audio and BYOM Camera in the Microphone and Camera list;

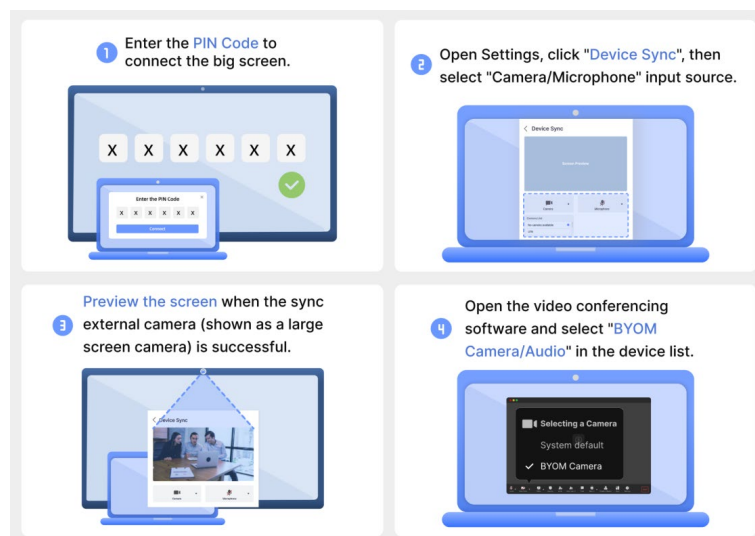



(5) Finally, start your meeting.

4.2 Gallery Mode

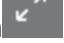
(1) After multiple client devices are connected to the IFPD, then start to cast the screen;

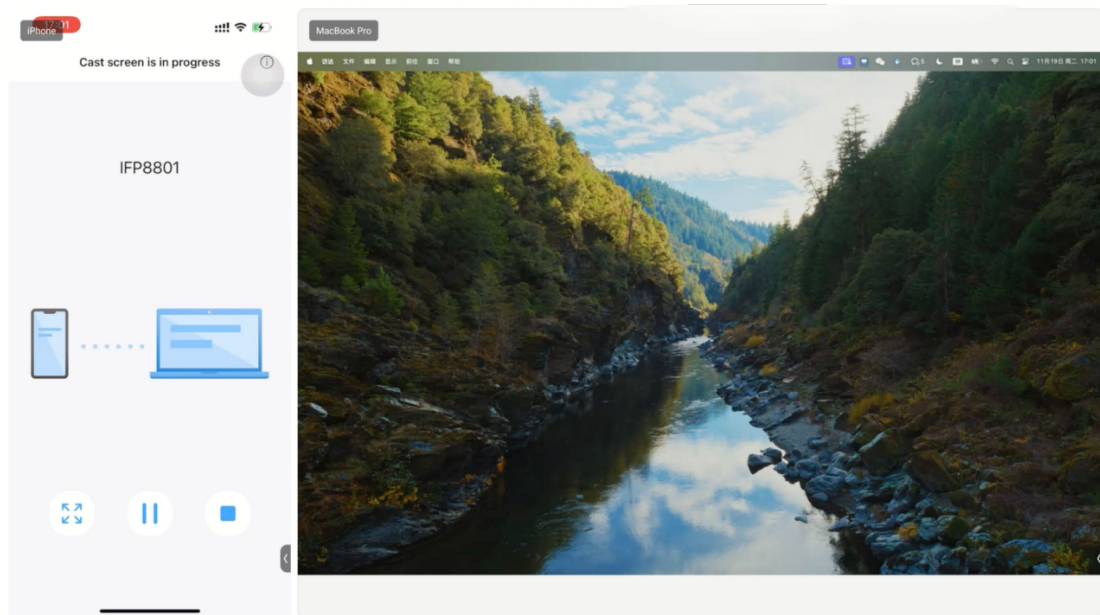
(2) Click the [Full Screen] button  in the toolbar at the bottom right corner of the projection screen;



- (3) At this time, the top right of the [Gallery] function  will display the number of screen casting devices.

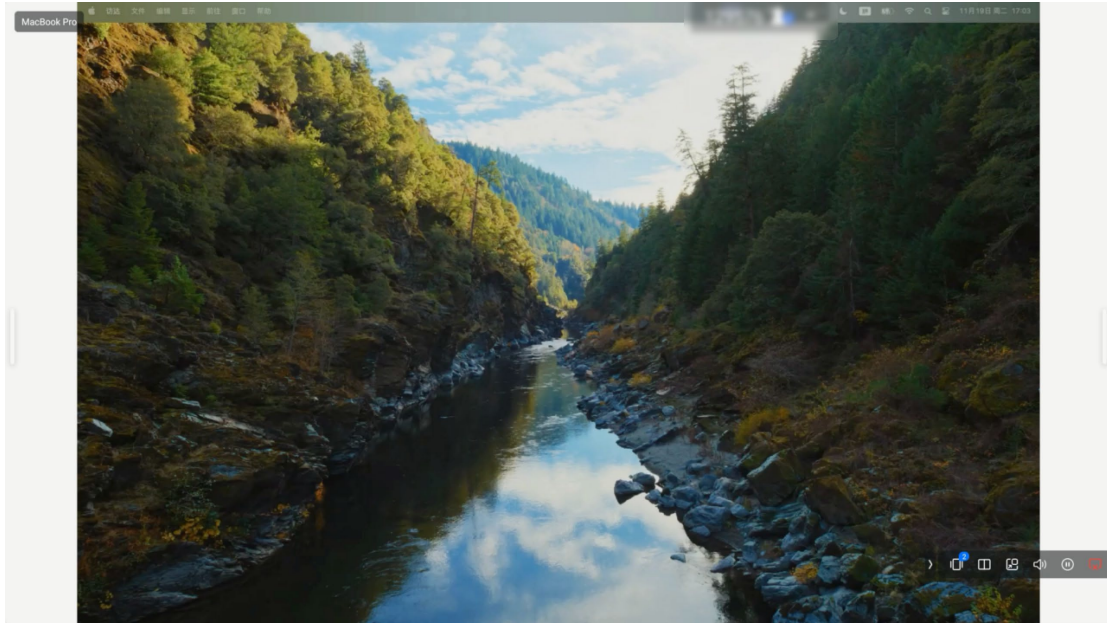

- (4) Click [Gallery] to view the screen casting screen of multiple clients, and then click any screen casting screen to switch the full-screen content to the screen casting screen of the device.

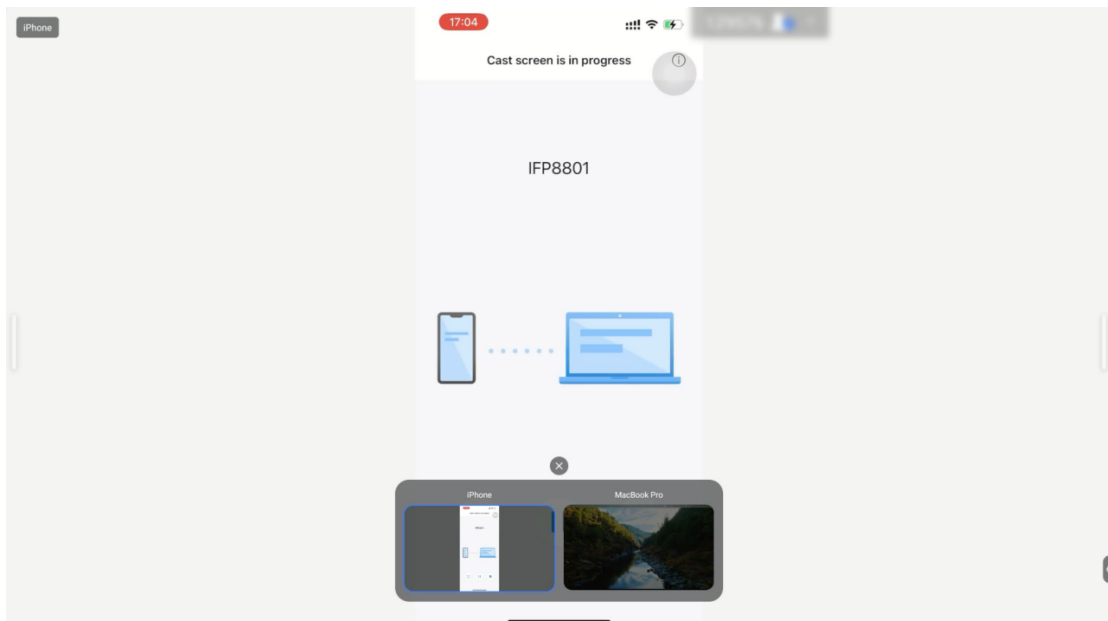

4.3 Floating Window

- (1) After the client device connects to the IFPD, it starts to cast the screen;
- (2) Click the [Floating Window] button  in the toolbar at the bottom right corner of the screen casting screen to display the screen casting screen in the floating window;

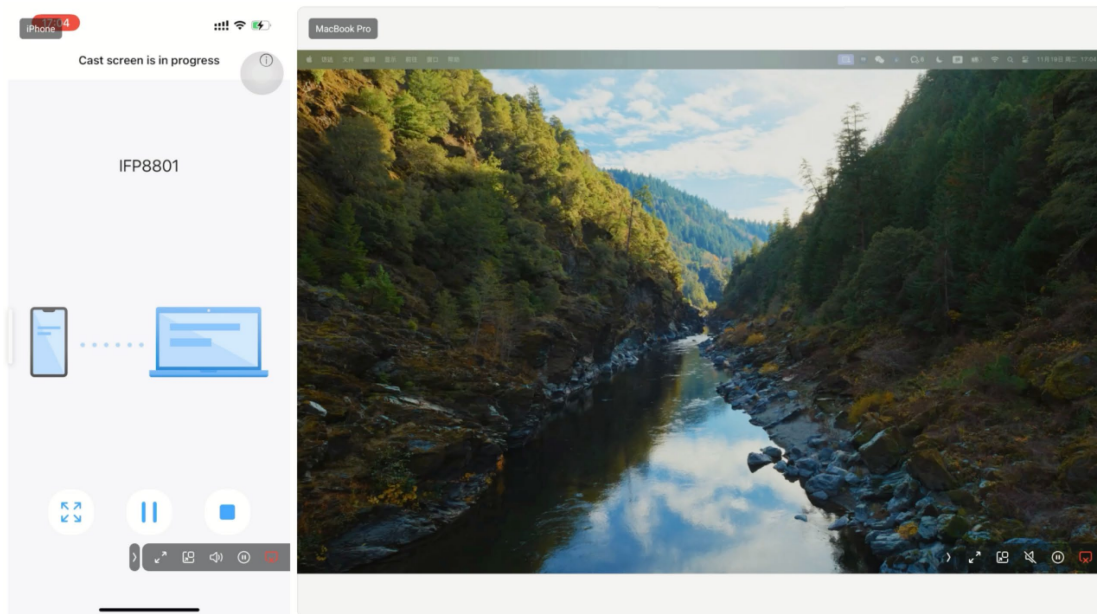

- (3) Press and hold the [Three Dots] button  to move the floating window;



(4) Click the [Three Dots] button  to scale the size of the floating window;



(5) Click the [Insert Whiteboard] button  in the Floating Window to insert a screenshot of the contents of the Floating Window into the Whiteboard;

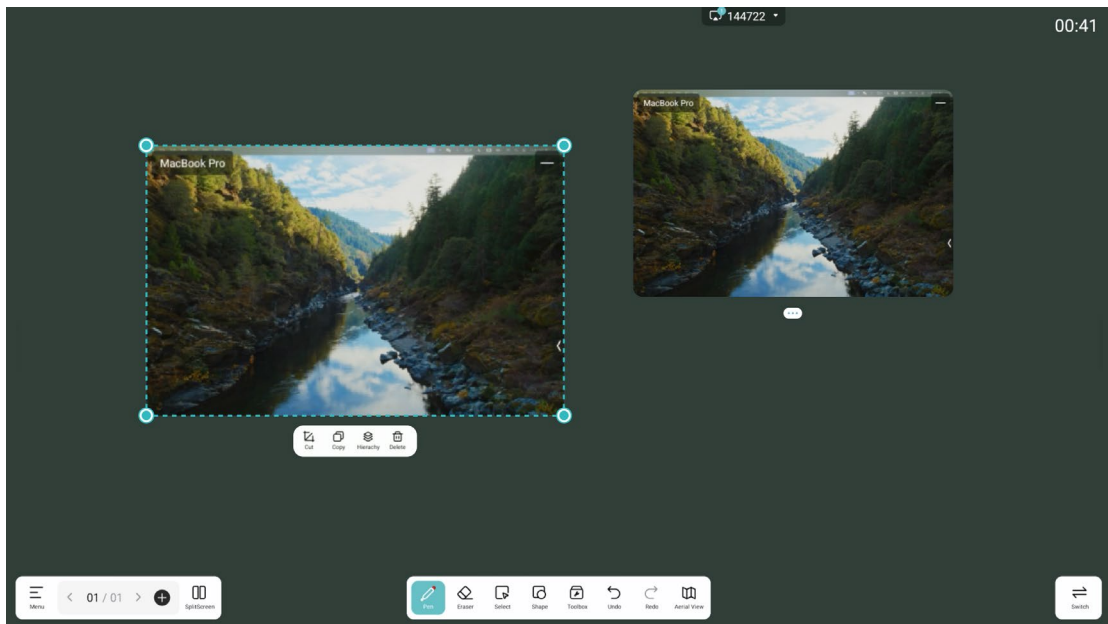

(6) Currently supports up to 9 simultaneous floating window displays for screen casting.

4.4 Wired Projection Screen (Android)

(1) Turn on the [Wired Projection Screen] function in the [Settings];

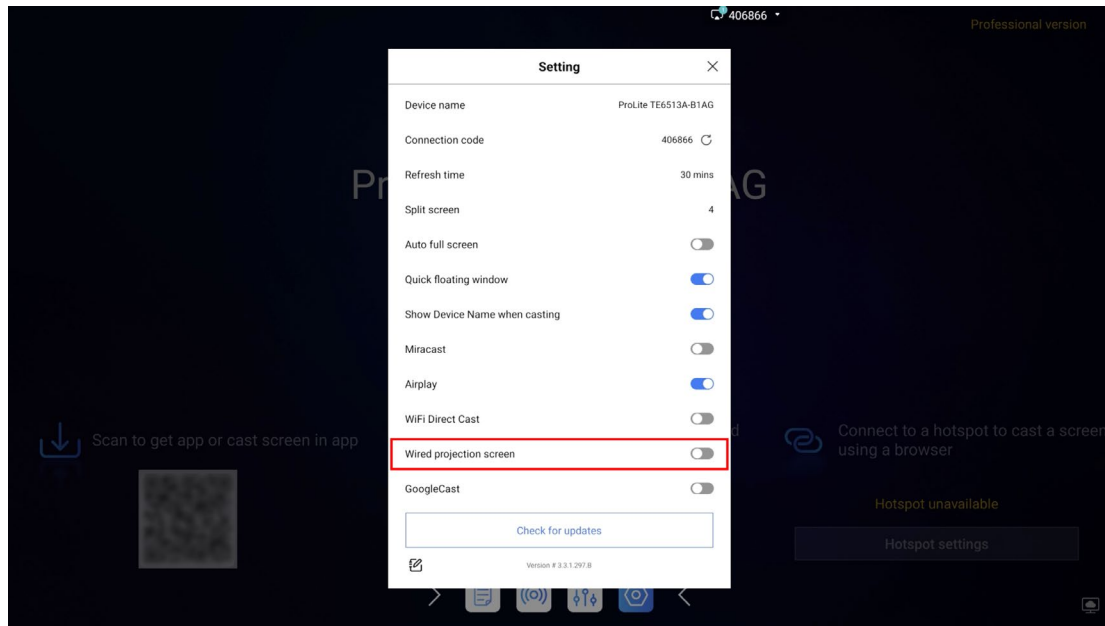

(2) Using a data cable, plug the USB port into the IFPD and the Type-C port into the Android mobile.

(3) After authorisation, the phone screen will be cast to the IFPD.

4.5 Webcast - Cloud Screen Cast

- (1) Click on Area 2 to open the [Webcast - Cloud Screen Cast] function pop-up window, click [Open Function] and the website: **Share.hellogo.tech** as well as the cloud code will appear.

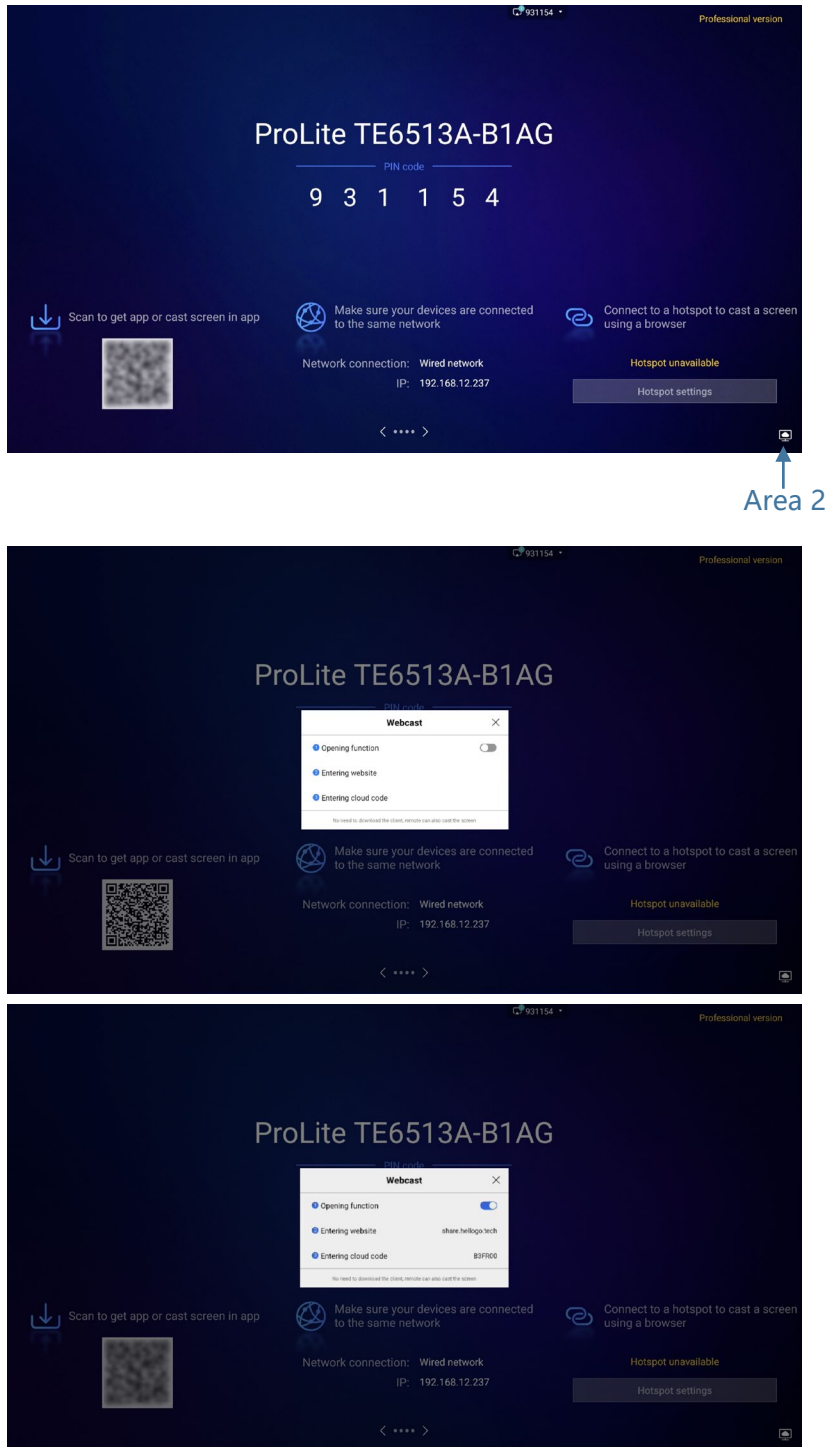

(2) Enter the URL in your browser and enter the cloud code.

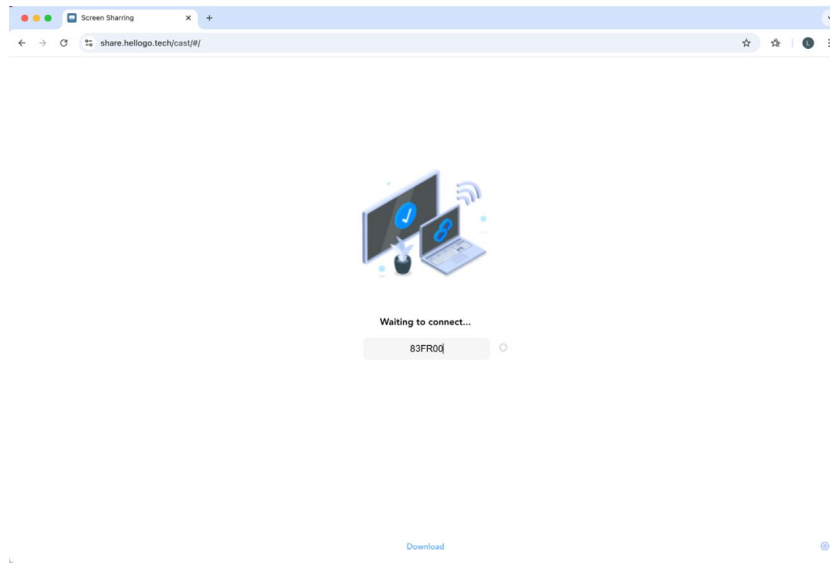

(3) At this time, the verification code pop-up window will appear on the IFPD, and you can select the tab you want to cast the screen after inputting the verification code to the web side.

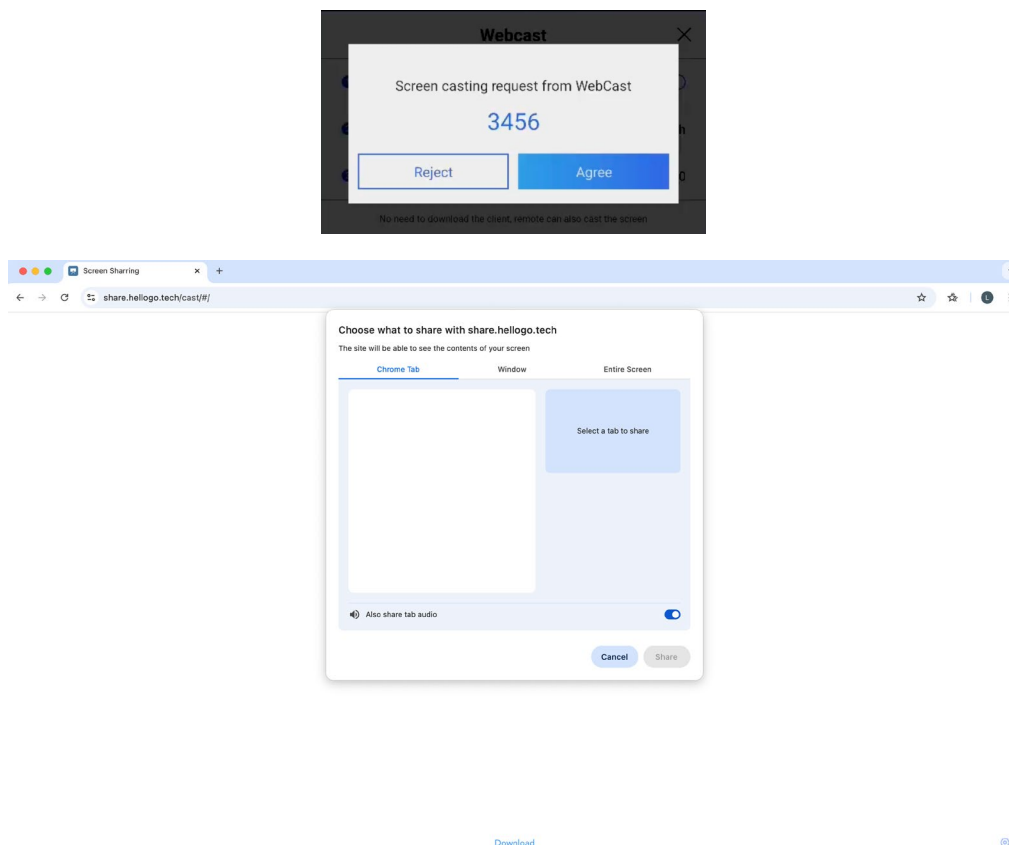

4.6 NFC Casting

NFC tag writing:

- (1) Connect your mobile phone to the IFPD;
- (2) NFC function button can be seen on the connected page;

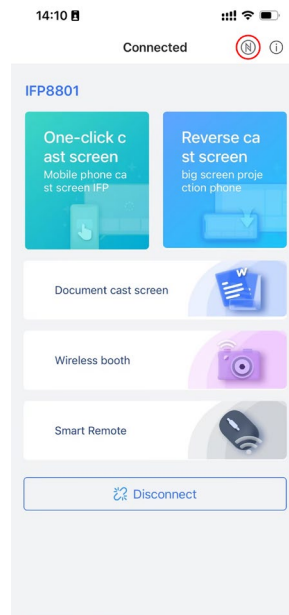

- (3) Tap the NFC function and stick the NFC tag to the sensing area at the back of the phone to start writing data;

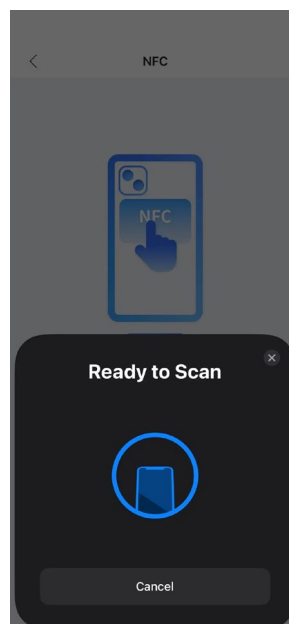

- (4) The page can be exited by displaying Write Card Success.

NFC tag reading:

- (1) Unlock the phone and stick the NFC tag with written data to the sensor area at the back of the phone;
- (2) Tap the NFC tag prompt pop-up window that appears on the top of the phone;

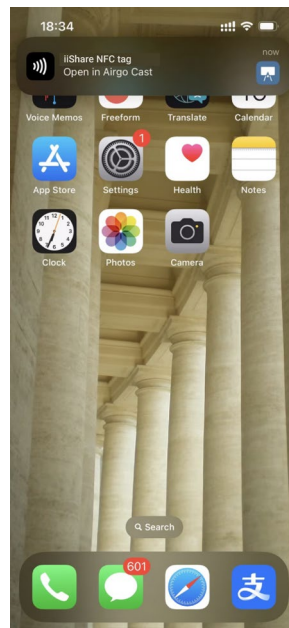

- (3) Click the pop-up window to jump to the iShare app, and if the mobile phone and the IFPD are on the same network, the casting will start directly.

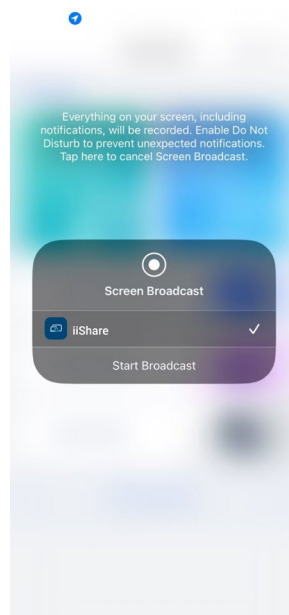

- (4) If the mobile phone and the IFPD are not in the same network, a pop-up window will appear to switch networks. After adjusting the mobile phone network to the same network manually, you can start casting screen directly.

