



Philips Brilliance
LCD monitor with Clinical
D-image

Clinical review display
24.1" (61 cm)
1920 x 1200 (2 MP)

Brilliance



C240P4QPYEW

Clinical Review Display

with Brilliant Images

This Philips display is ideal for everyday clinical care environments. Its D-image preset gives you consistent DICOM greyscale medical images. Its medical grade power supply ensures basic safety.

Clinical Review

- Clinical D-image pre-set for DICOM part 14 Greyscale images
- SmartImage Clinic for common display settings
- Medical-grade power supply ensures safety with low emission
- Design complements clinical environment

Brilliant performance

- IPS technology for full colours and wide viewing angles
- PowerSensor saves up to 80% energy costs
- Built-in stereo speakers for multimedia
- DisplayPort offers audio and video over a single, long cable
- USB Hub with four ports for easy connections

Designed for people

- SmartErgoBase enables user-friendly ergonomic adjustments
- Low bezel-to-table height for maximum reading comfort

PHILIPS

Highlights

Clinical D-image



Monitors must show medical images consistently with high quality to achieve reliable interpretations. The rendering of medical Greyscale images on standard monitors is mostly inconsistent at best, making them unsuitable for use in a clinical environment. Philips clinical review displays with clinical D-image pre-set are factory-calibrated to give DICOM part 14 compatible Greyscale standard display performance. By using high-quality LCD panels with LED technology, Philips offers you consistent and reliable performance at an affordable price. Further info on <http://medical.nema.org/>

SmartImage Clinic

SmartImage is an exclusive, leading-edge Philips technology that analyses the content displayed on your screen, and based on different applications/images displayed on a monitor, SmartImage optimises display content by dynamically adjusting brightness, contrast, colour and sharpness in real time.

Medical-grade power supply

Basic safety, essential performance and reliability are essential requirements in a professional clinical environment. Unlike standard displays, Philips clinical review displays employ special medical-grade power supplies in order to meet these requirements. It complies with the EN/IEC 60601-1 standard ensuring basic safety and essential performance. It also complies with the EN/IEC 60601-1-2 collateral standard for medical-grade electromagnetic tests and compatibility. Many countries, hospitals and clinics mandate

compliance to these standards as a requirement.

IPS technology

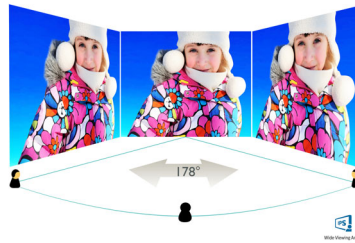

IPS displays use advanced technology that gives you extra-wide viewing angles of 178/178 degrees, making it possible to view the display from almost any angle — even in 90-degree Pivot mode! Unlike standard TN panels, IPS displays gives you remarkably crisp images with vivid colours, making it ideal not only for Photos, films and web browsing, but also for professional applications that demand colour accuracy and consistent brightness at all times.

PowerSensor

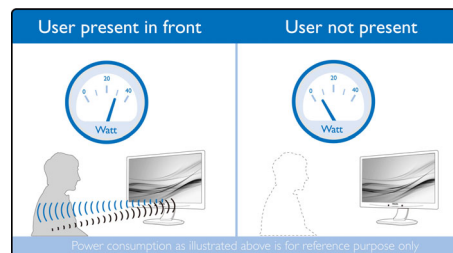

PowerSensor is a built-in 'people sensor' that transmits and receives harmless infrared signals to determine if the user is present and then automatically reduces monitor brightness when the user steps away from the desk, cutting energy costs by up to 80 percent and prolonging monitor life

DisplayPort

DisplayPort is a digital link from PC to monitor without any conversion. With higher capabilities than DVI standard, it is fully capable to support up to 15 metre cables and 10.8 Gbps/sec data transfer. With this high

performance and zero latency, you get the fastest imaging and refresh rates — making DisplayPort the best choice for not only general office or home use, but also for the more demanding gaming and films, video editing and more. It also keeps interoperability in mind via the use of various adapters.

SmartErgoBase



The SmartErgoBase is a monitor base that delivers ergonomic display comfort and provides cable management. The user-friendly height, swivel, tilt and rotation angle adjustments of the base allow the monitor to be positioned for maximum comfort to help ease the physical strains of a long workday. In addition, cable management reduces cable clutter and keeps the workspace neat and professional.

Low bezel-to-table height



Thanks to its advanced SmartErgoBase, the Philips monitor can be lowered down almost to desk level for a comfortable viewing angle. Low bezel-to-table height is the perfect solution if you use bifocals, trifocals or progressive lens glasses for your computing work. Additionally, it allows users of different heights to use the monitor at their preferred angle and height settings, helping them to reduce fatigue and strain.



Specifications

Picture/Display

- LCD panel type: IPS technology
- Backlight type: W-LED system
- Panel Size: 24 inch/61 cm
- Effective viewing area: 518.4 (H) x 324 (V)
- Aspect ratio: 16:10
- Optimum resolution: 1920 x 1200 @ 60 Hz
- Response time (typical): 14 ms
- Brightness: 300 cd/m²
- Contrast ratio (typical): 1000:1
- Pixel pitch: 0.270 x 0.270 mm
- Viewing angle: 178° (H)/178° (V), @ C/R > 10
- Display colours: 16.7 M
- Scanning Frequency: 24–94 kHz (H)/48–85 Hz (V)
- sRGB
- Picture enhancement: SmartImage Clinic
- DICOM: Clinical D-image, DICOM part-14
- DICOM calibrated brightness: 265 cd/m²

Connectivity

- Signal Input: DisplayPort 1.2, DVI-D (digital, HDCP), VGA (Analogue)
- USB: USB 2.0 x 4
- Sync Input: Sync on Green, Separate Sync
- Audio (In/Out): PC audio-in, Headphone out
- Built-in speakers: 2 W x 2

Convenience

- User convenience: SmartImage Clinic, PowerSensor, Menu, Power On/Off, 4:3/Wide
- Control software: SmartControl
- OSD Languages: English, French, German, Italian, Portuguese, Russian, Simplified Chinese, Spanish, Brazil Portuguese, Czech, Dutch, Finnish, Greek, Hungarian, Japanese, Korean, Polish, Swedish, Traditional Chinese, Turkish, Ukrainian
- Other convenience: Kensington lock, VESA mount (100 x 100 mm)
- Plug and Play Compatibility: DDC/CI, Mac OS X, sRGB, Windows 8.1 / 8 / 7

Stand

- Height adjustment: 130 mm
- Pivot: 90 degree
- Swivel: -65/65 degree
- Tilt: -5/20 degree

Power

- On mode: 31.4 W (typ.)
- Standby mode: 0.5 W (typ.)
- Off mode: Zero watts with Zero switch
- Power LED indicator: Operation - White, Standby mode - White (flashing)
- External power supply: 100-240VAC, 50-60 Hz (Medical cert.: IEC60601-1/EN60601-1)

Dimensions

- Product with stand (max height): 555 x 550 x 244 mm
- Product without stand (mm): 555 x 388 x 65 mm
- Packaging in mm (W x H x D): 632 x 457 x 286 mm

Weight

- Product with stand (kg): 6.97 kg
- Product without stand (kg): 4.64 kg
- Product with packaging (kg): 9.80 kg

Operating conditions

- Temperature range (operation): 0°C to 40°C °C
- Temperature range (storage): -20°C to 60°C °C
- Relative humidity: 20%–80% %
- Altitude: Operation: +12,000 ft (3658 m), Non-operation: +40,000 ft (12,192 m)
- MTBF: 30,000 hour(s)

Sustainability

- Environmental and energy: PowerSensor, RoHS, WEEE
- Recyclable packaging material: 100 %
- Specific Substances: PVC/BFR free housing, Mercury free, Lead free

Compliance and standards

- EMC: IEC/EN60601-1-2, CE Mark
- Safety: IEC/EN60601-1, CE Mark
- Ergonomic/Others: JIS Z2801, TUV/GS, TUV Ergo, ISO 13485 certified, CCC, CECP, RCM, UL/cUL, TCO certified

Cabinet

- Front bezel: White
- Rear cover: White
- Foot: White
- Finish: Texture



Issue date 2018-04-27

Version: 4.0.1

12 NC: 8670 001 02521
EAN: 87 12581 68599 7

© 2018 Koninklijke Philips N.V.
All Rights reserved.

Specifications are subject to change without notice.
Trademarks are the property of Koninklijke Philips N.V.
or their respective owners.

www.philips.com

* Please note: This display is not certified to be used in patient vicinity.
Any use for primary diagnostics is the sole responsibility of the hospital or clinic operator only.
* DICOM is the registered trademark of the NEMA for its standards publications relating to digital communications of medical information.
* "IPS" word mark / trademark and related patents on technologies belong to their respective owners.