

Always there to help you

Register your product and get support at
www.philips.com/support



HTD5510

HTD5540

HTD5570

Quick start guide

PHILIPS



EN Before using your product, read all accompanying safety information

ZH-CN 使用产品前，请阅读所有随附的安全信息



HTD5510

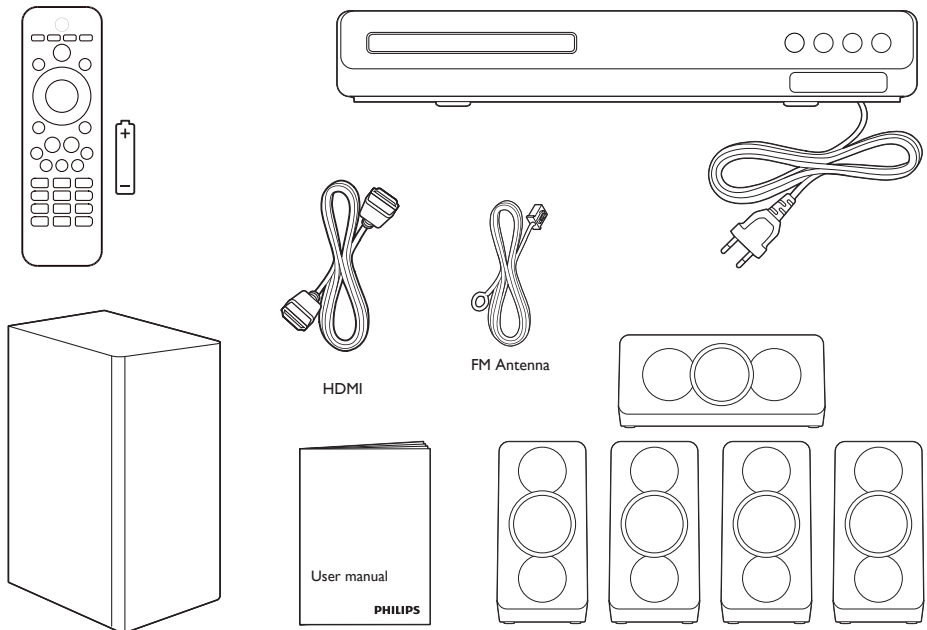

HTD5540

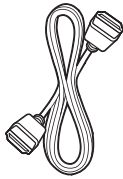
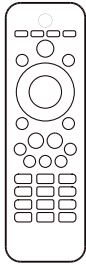

HDMI

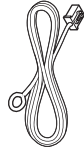
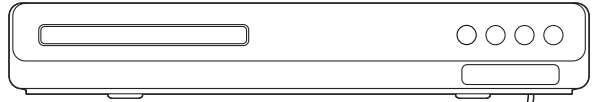

FM Antenna

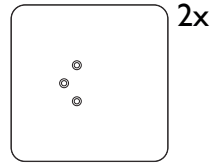
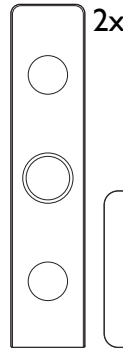
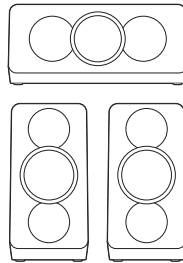
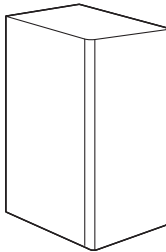
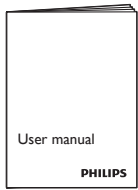
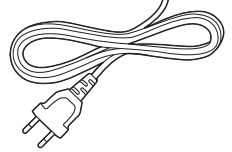

HTD5570

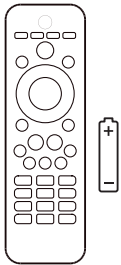

HDMI

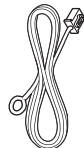
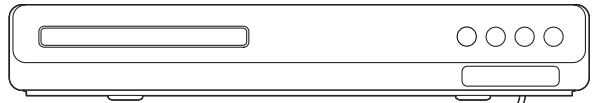

FM Antenna

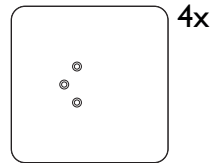
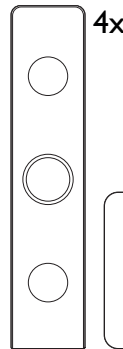
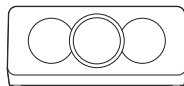
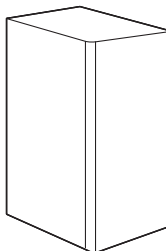
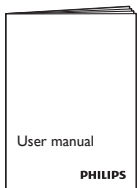
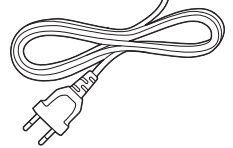

1

EN Stand mount the speakers
Applied to HTD5540 and HTD5570 only

ZH-CN 桌架和扬声器
只适用于 HTD5540 和 HTD5570 的型号

1

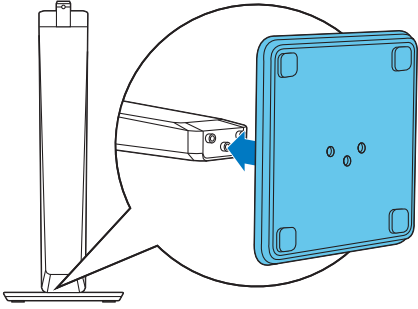

2

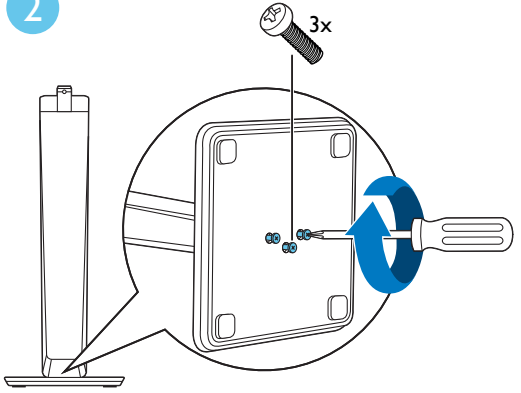

3

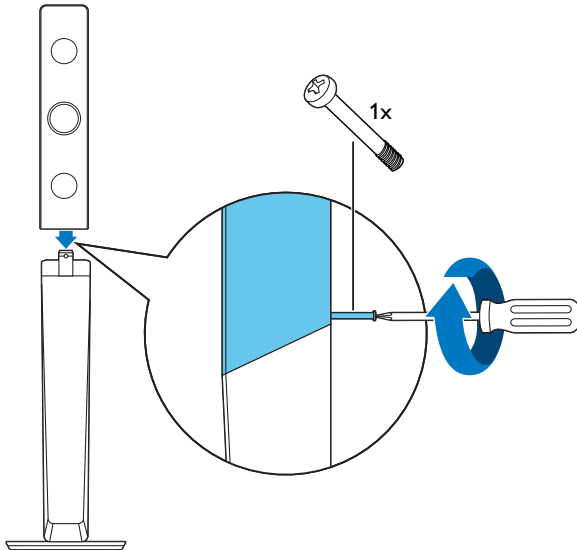

2

EN Connect and position the home theater

ZH-CN 连接和放置家庭影院

HTD5510

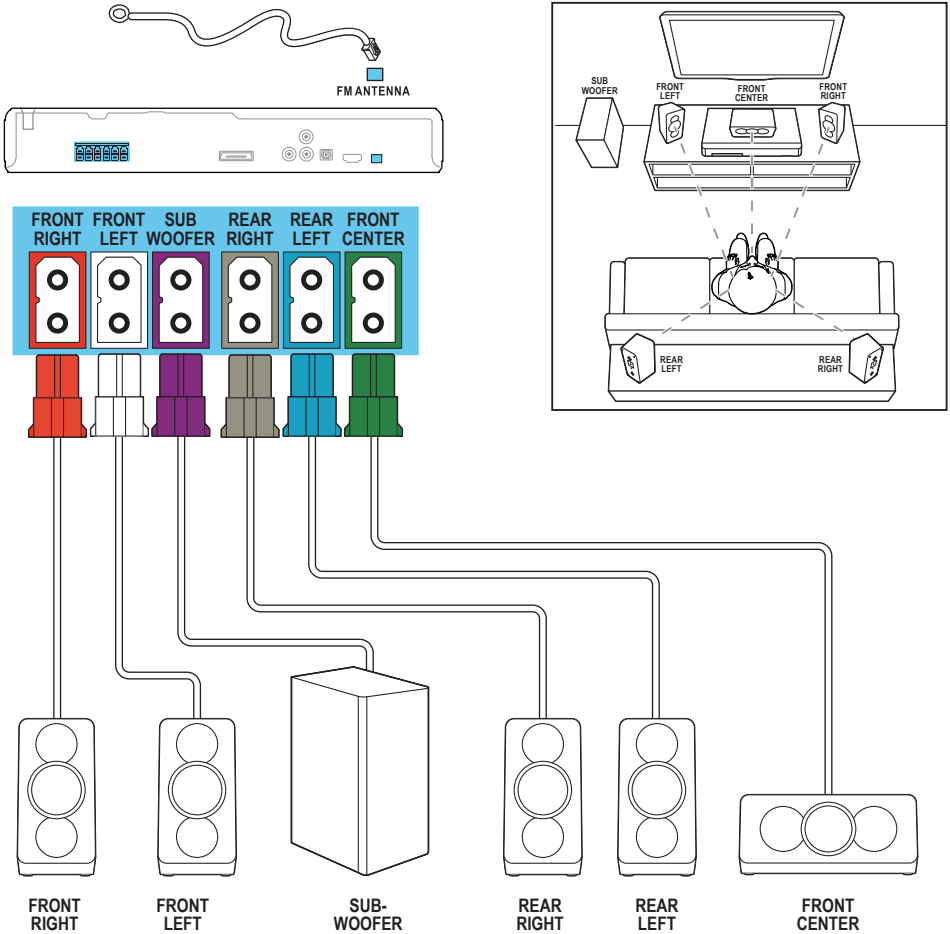

HTD5540

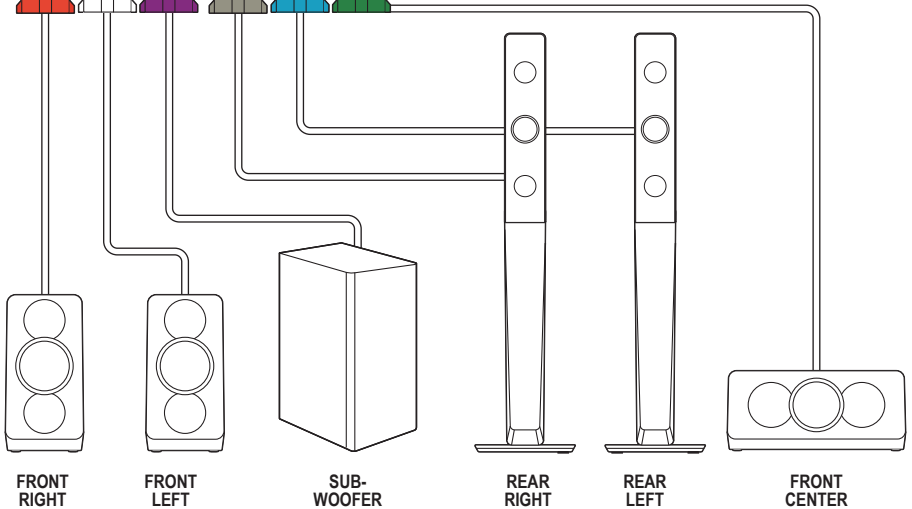
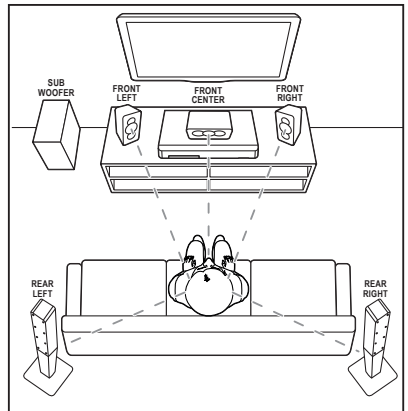
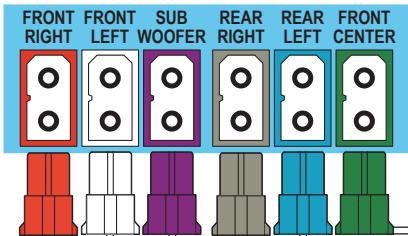
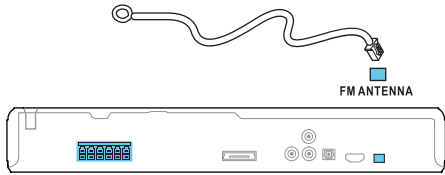

HTD5570

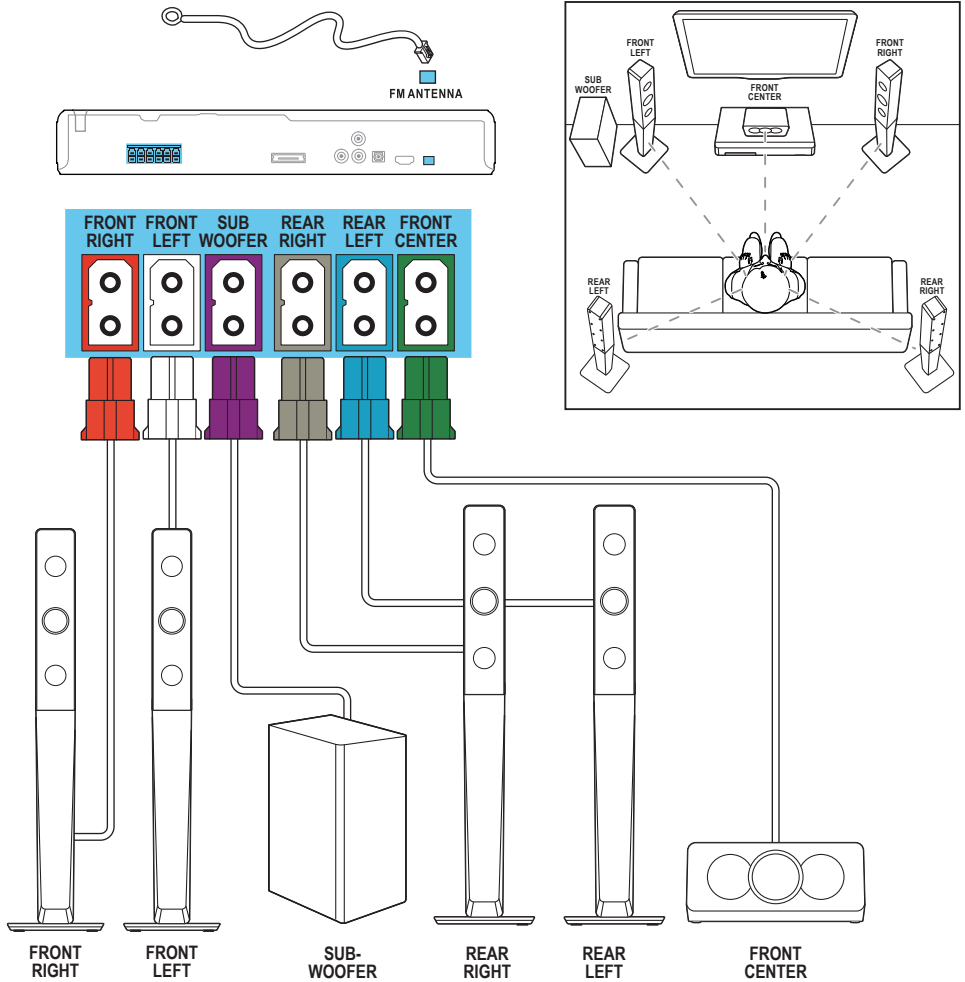

3

EN Connect to TV in one of these ways

ZH-CN 通过这些方式连接至电视

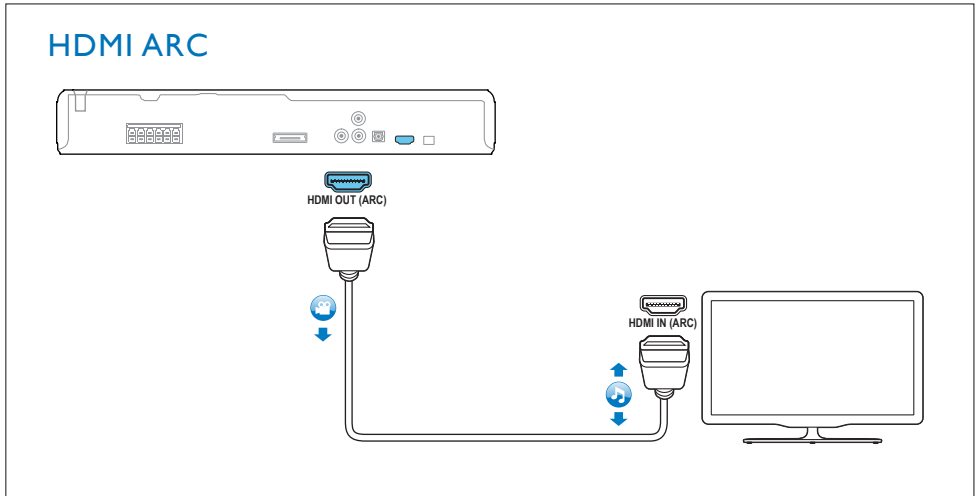

HDMI + OPTICAL

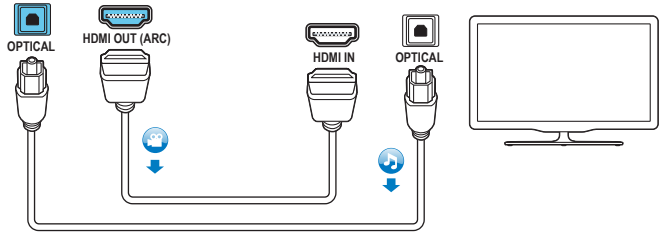

VIDEO + AUDIO L/R

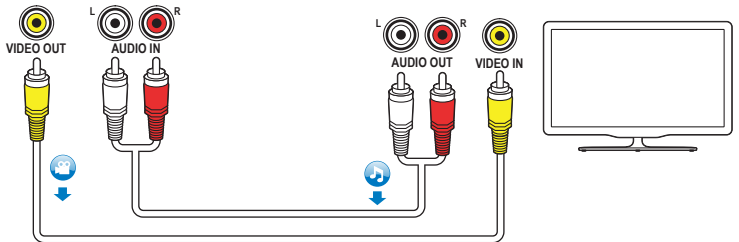

4

EN Switch on the home theater

ZH-CN 打开家庭影院

1

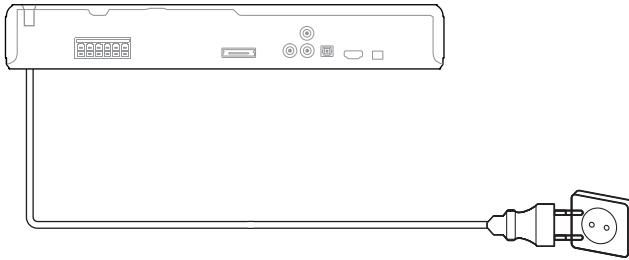

2

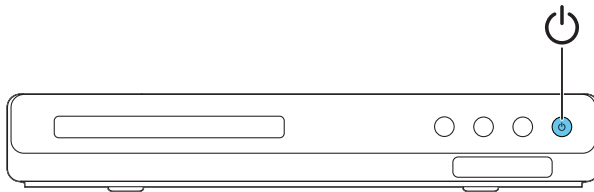

3

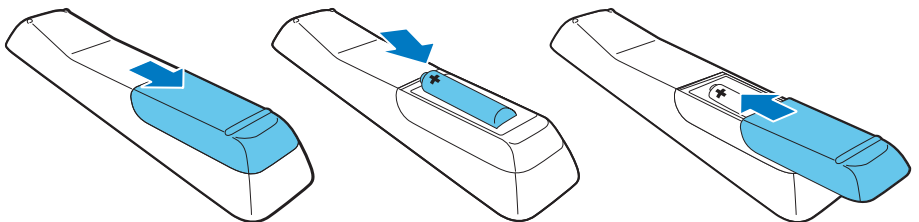

5

EN Complete the first time setup

ZH-CN 完成首次设置

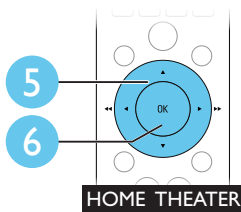
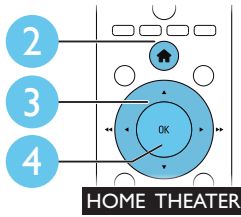
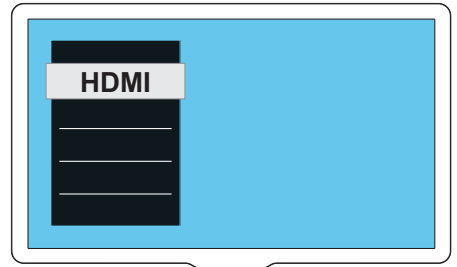
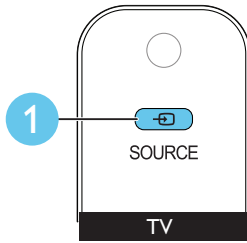

6

EN Use your home theater

ZH-CN 使用家庭影院

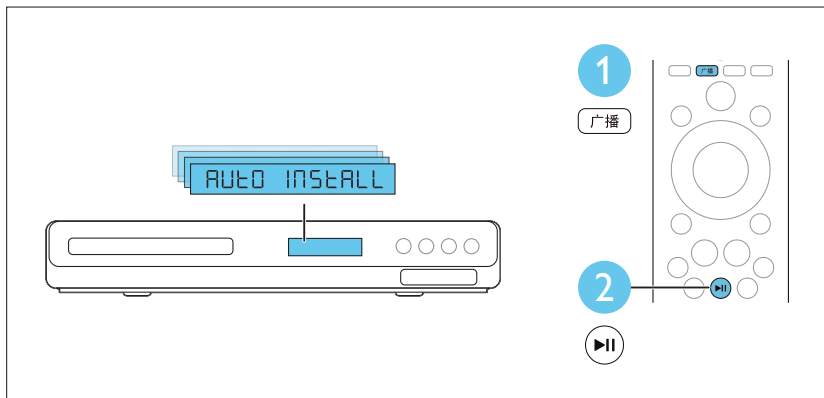
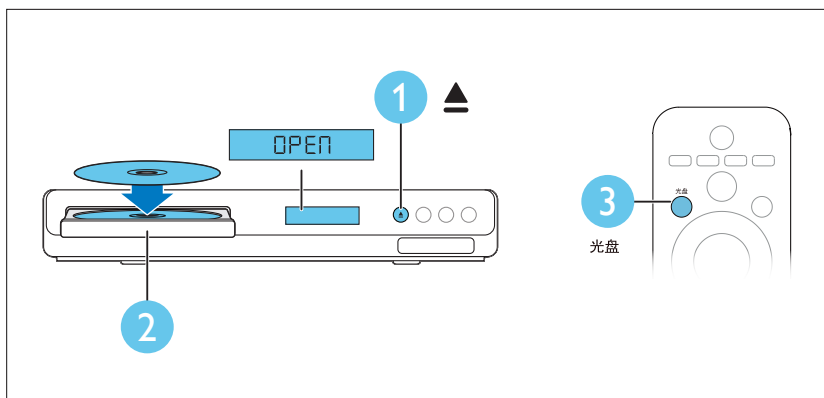

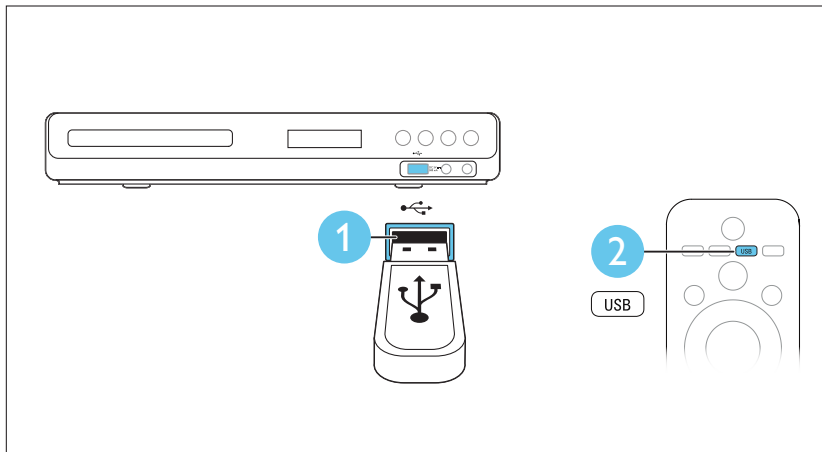
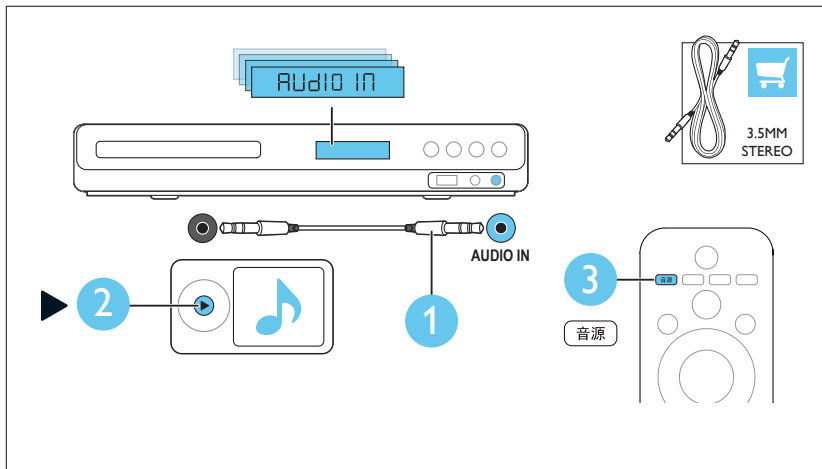



Specifications are subject to change without notice
© 2014 Koninklijke Philips N.V. All rights reserved.
Trademarks are the property of Koninklijke Philips N.V. or their respective owners.

HTD5510/5540/5570_93_QSG_V2.0

