

Always there to help you

Register your product and get support at
www.philips.com/welcome

HTD5510
HTD5540
HTD5570



Quick start guide

PHILIPS



EN Before using your product, read all accompanying safety information



HTD5510

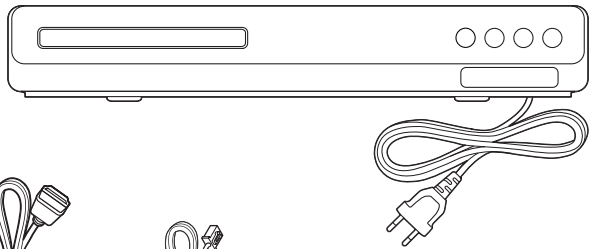
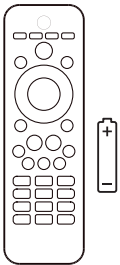

HDMI



FM Antenna

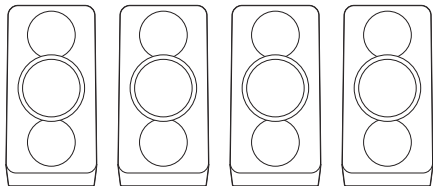
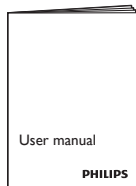
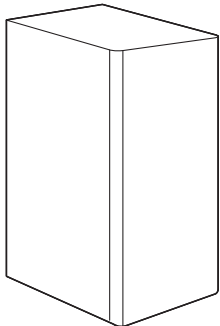
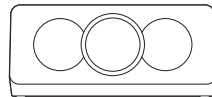

HTD5540

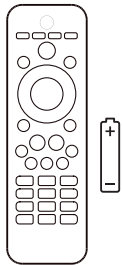

HDMI

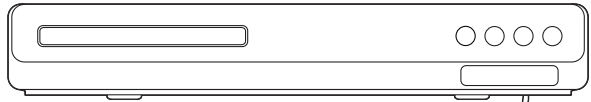

FM Antenna

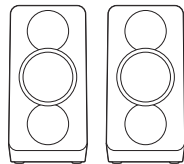
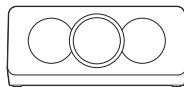
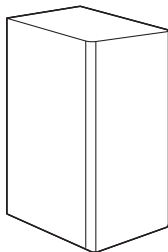
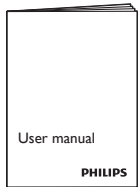
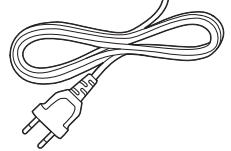

2x

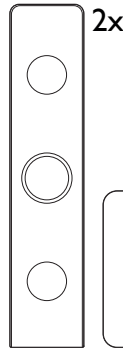

2x



6x



2x

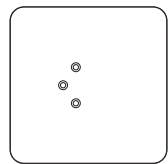

2x

HTD5570

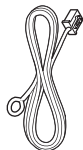
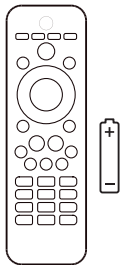

FM Antenna

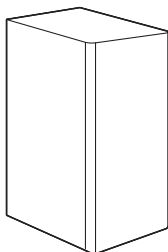
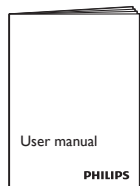
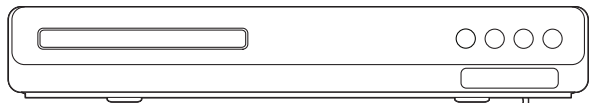

HDMI



4x

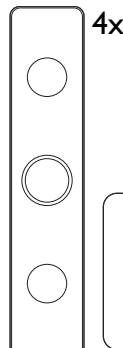

4x



12x

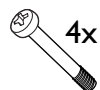

4x

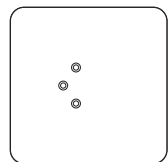

4x

1

EN Stand mount the speakers
Applied to HTD5540 and HTD5570 only

1

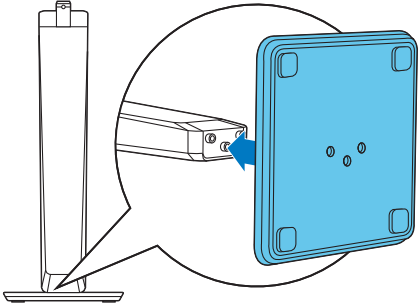

2

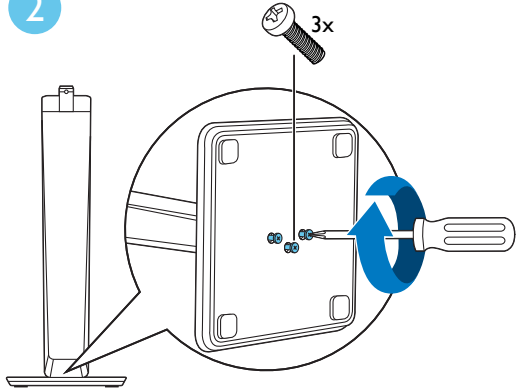

3

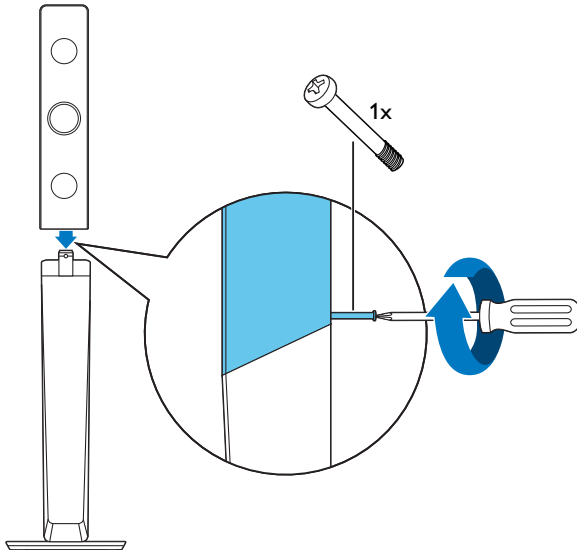

2

EN Connect and position the home theater

HTD5510

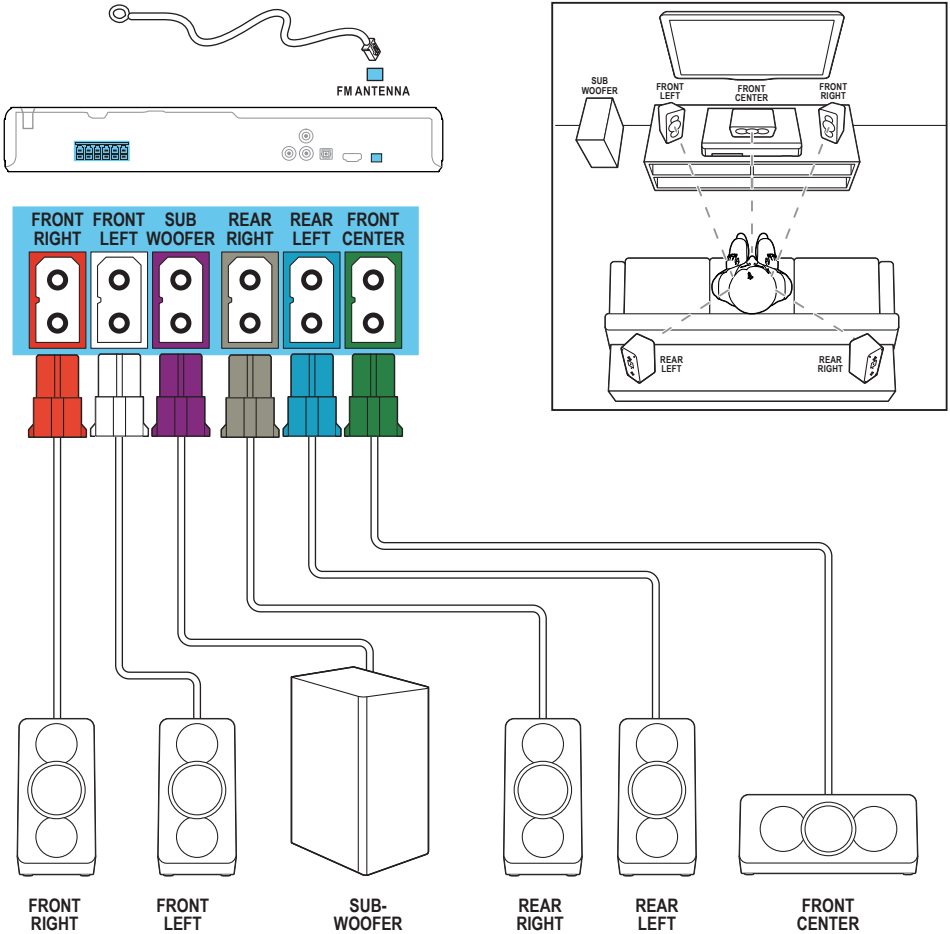

HTD5540

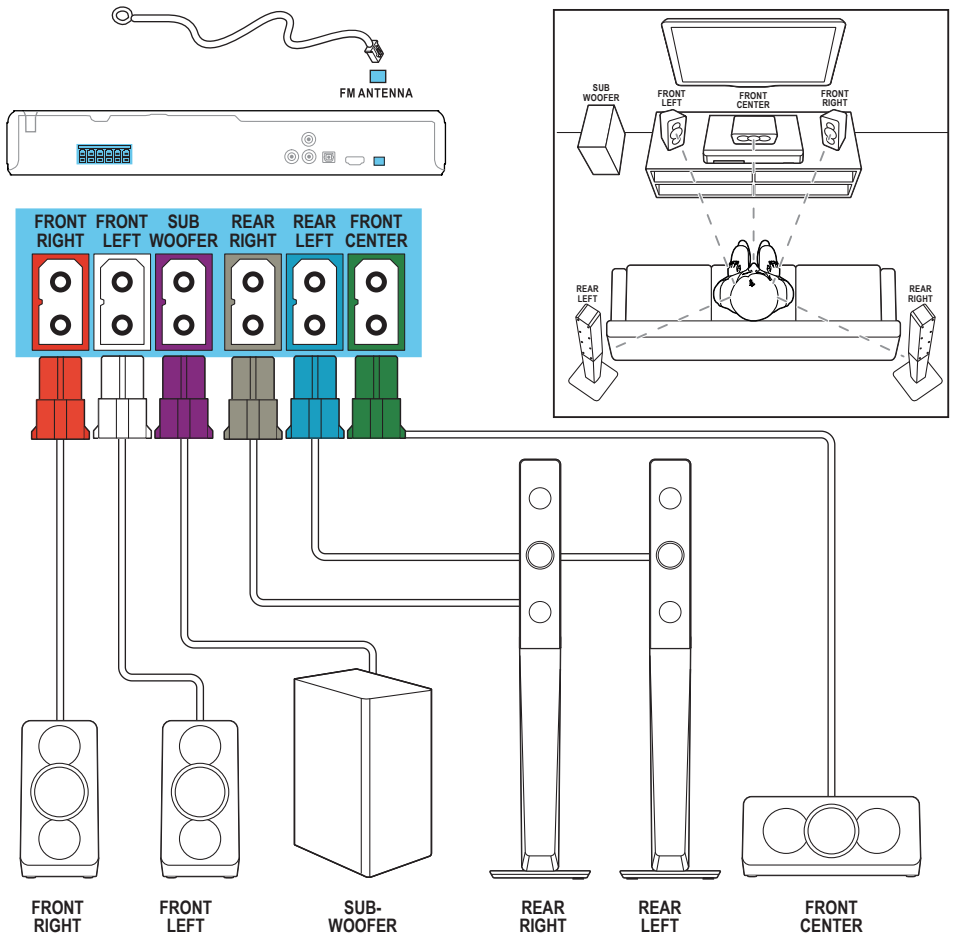

HTD5570

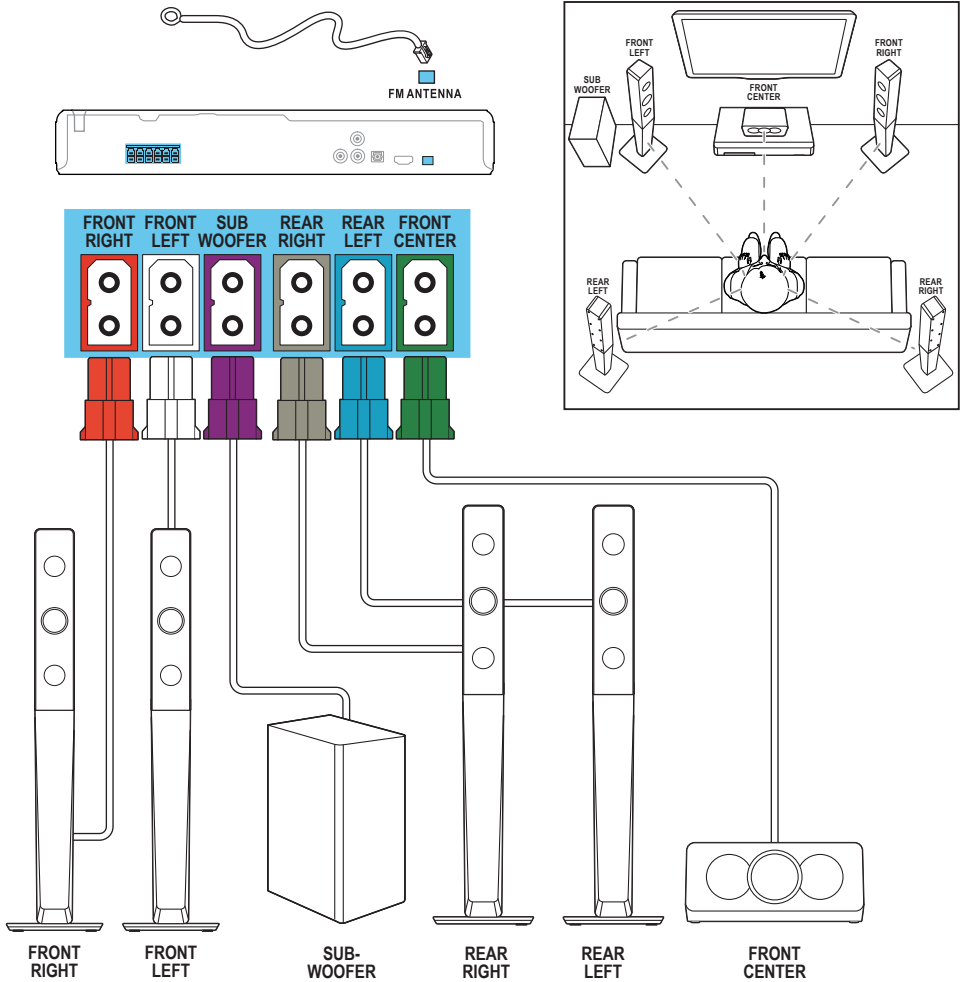

3

EN Connect to TV in one of these ways

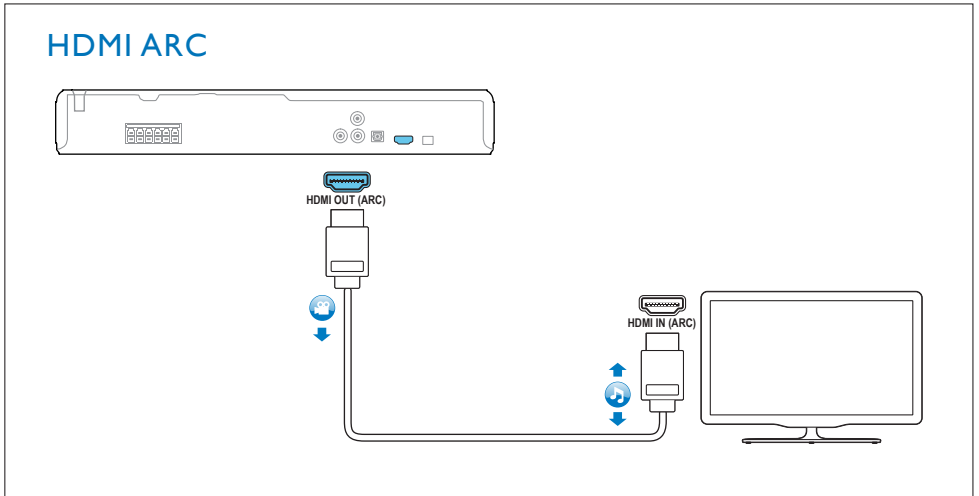

HDMI + OPTICAL

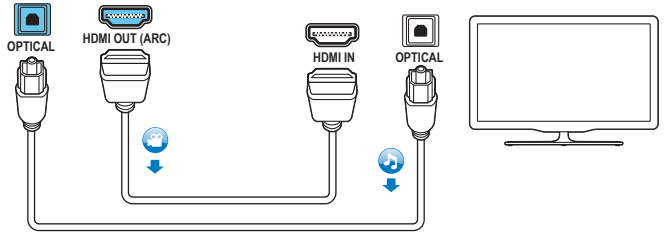

VIDEO + AUDIO L/R

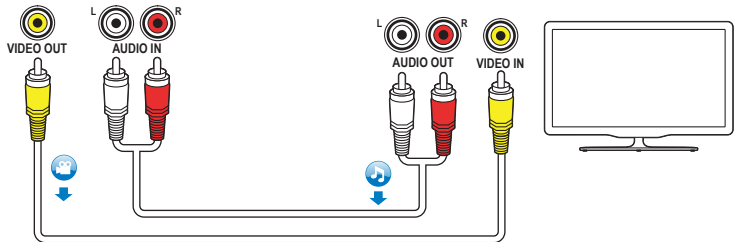

4

EN Switch on the home theater

1

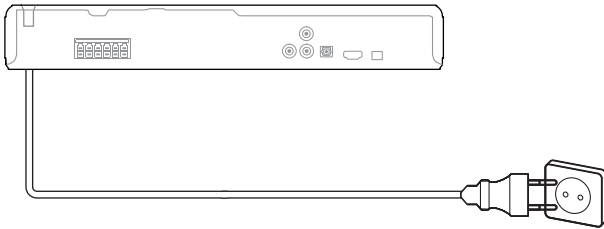

2

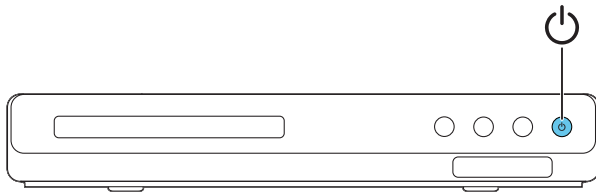

3

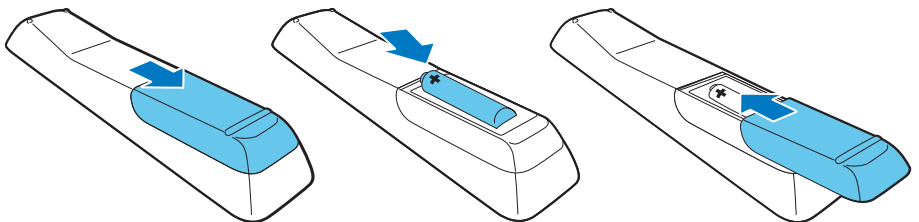

5

EN Complete the first time setup

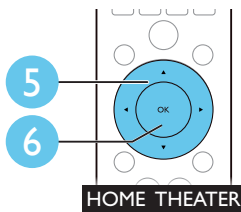
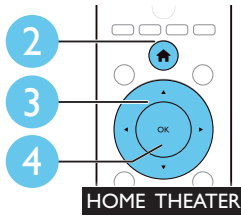
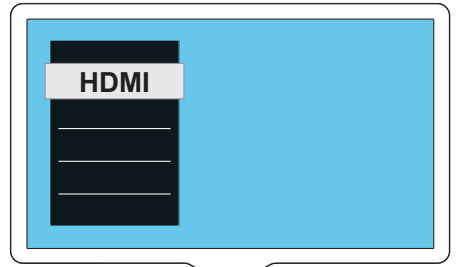
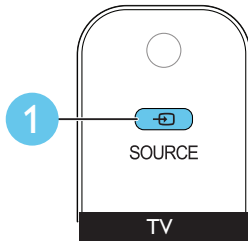

6

EN Use your home theater

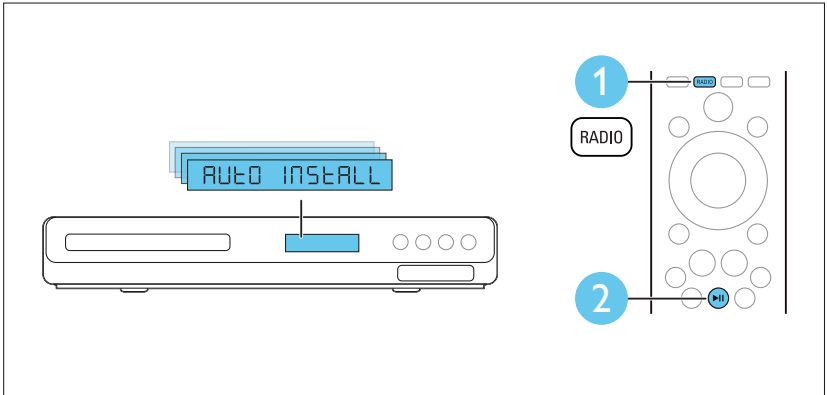
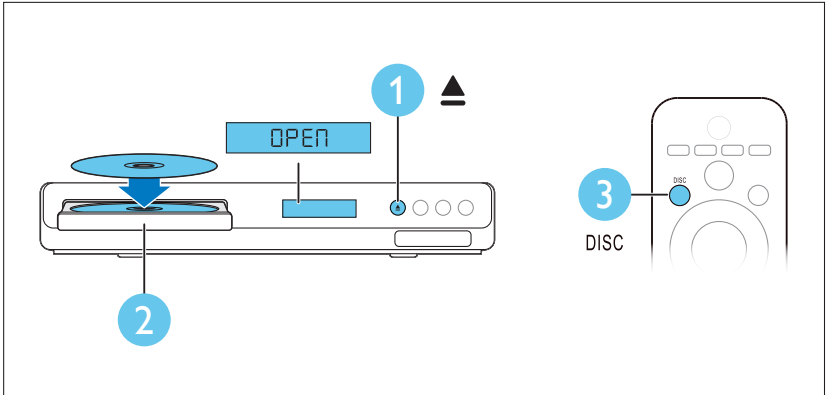

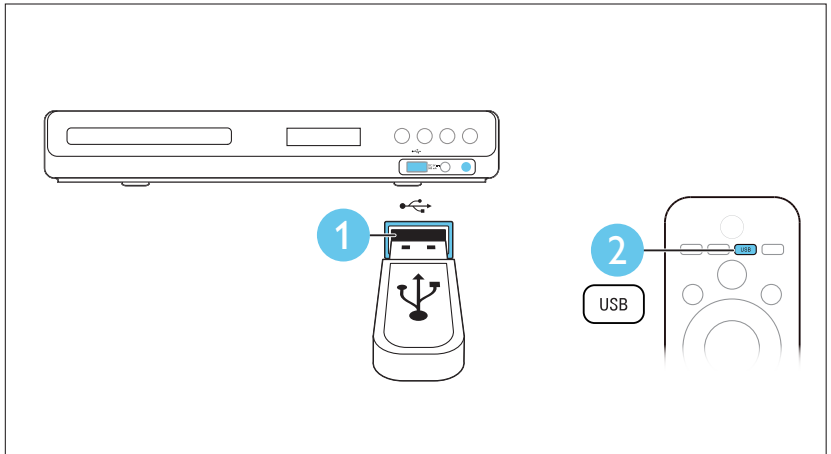
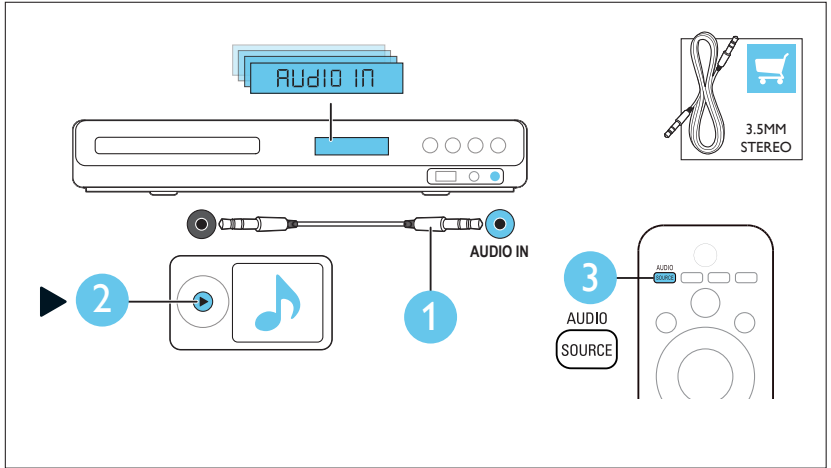



Specifications are subject to change without notice
© 2013 Koninklijke Philips Electronics N.V.
All rights reserved.

HTD5510/5540/5570_78_QSG_V1.0

