

Always there to help you

Register your product and get support at
www.philips.com/welcome

HTD5510
HTD5540
HTD5570



Quick start guide

PHILIPS



EN Before using your product, read all accompanying safety information



HTD5510

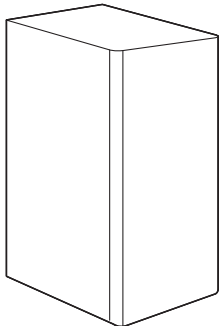
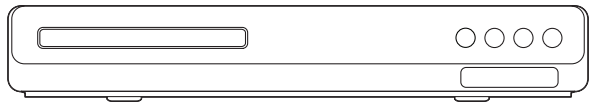
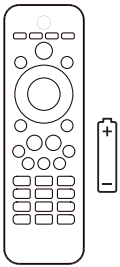

HDMI



Power Cord



FM Antenna

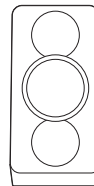
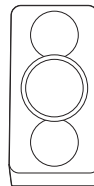
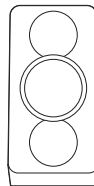
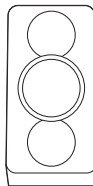
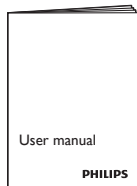
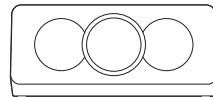

HTD5540

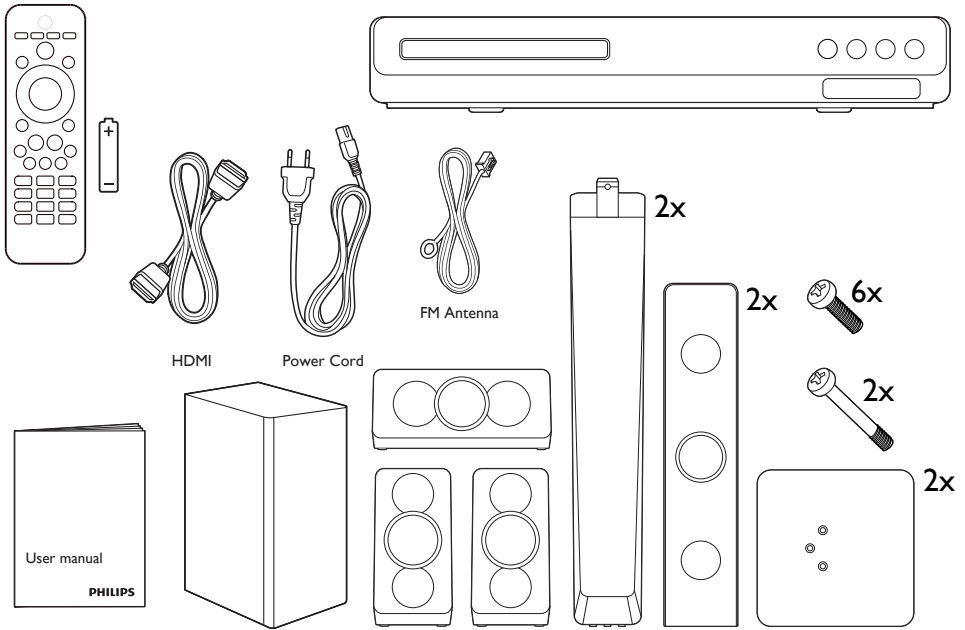

HTD5570

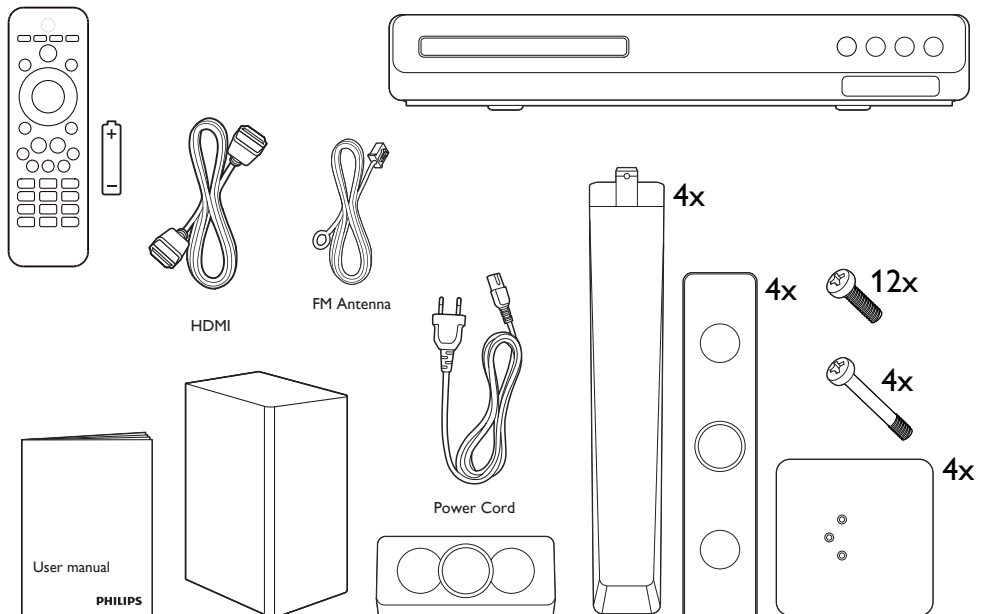

1

EN Stand mount the speakers
Applied to HTB3540 and HTB3570 only

1

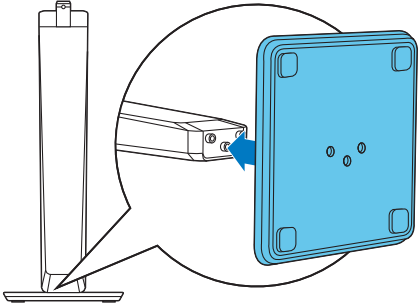

2

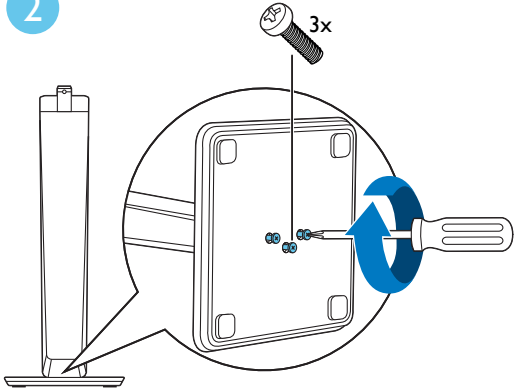

3

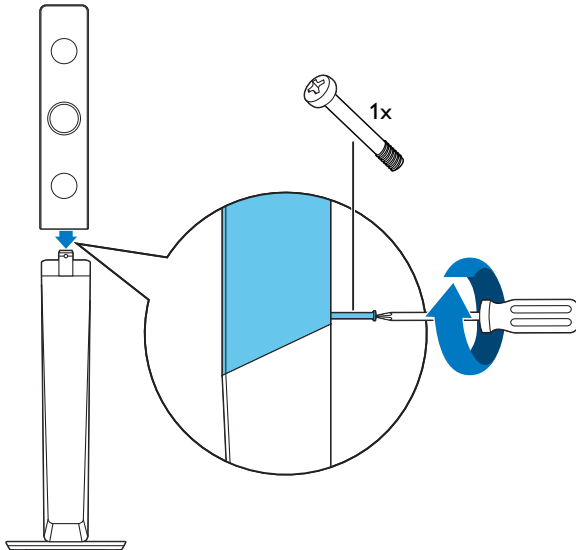

2

EN Connect and position the home theater

HTD5510

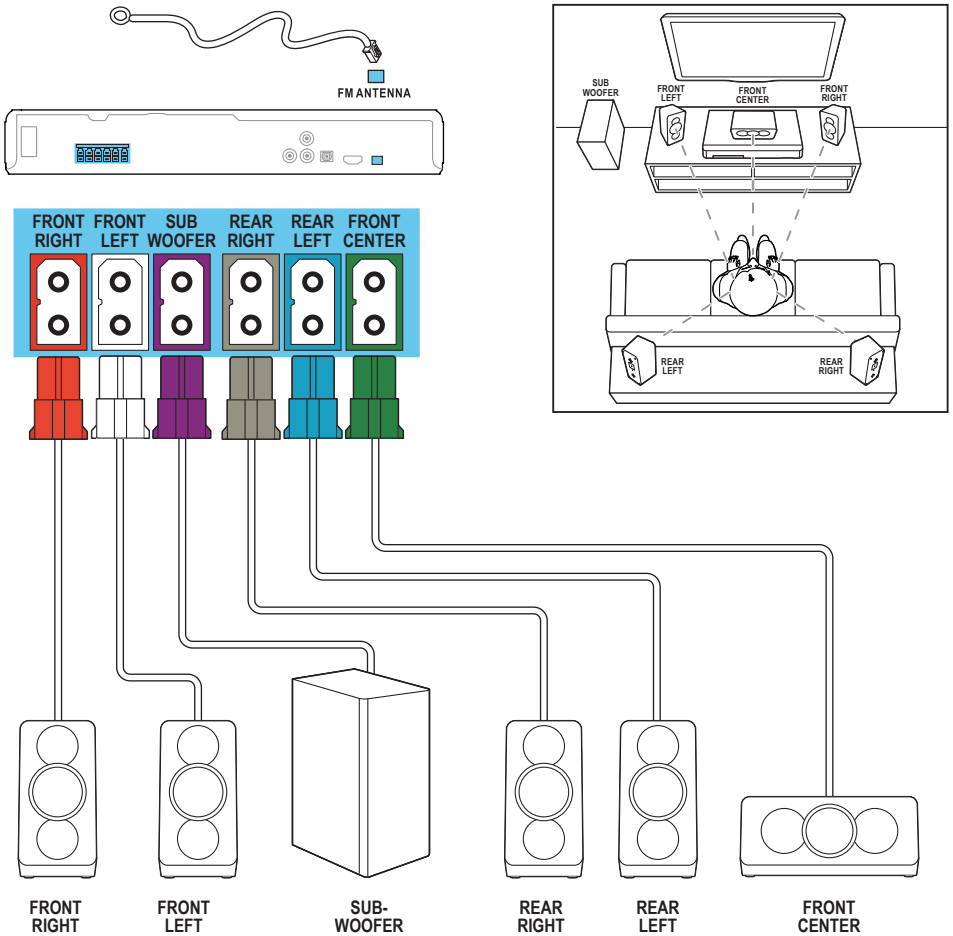

HTD5540

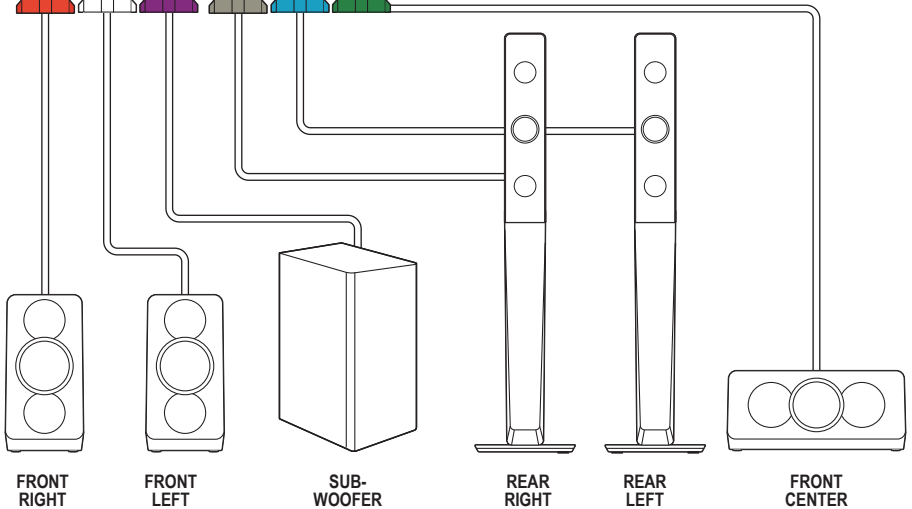
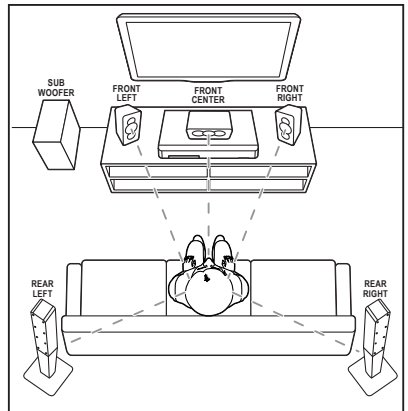
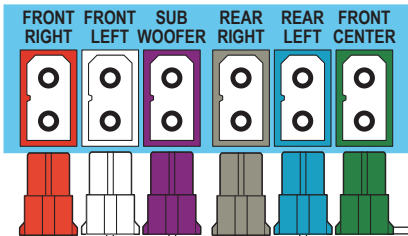
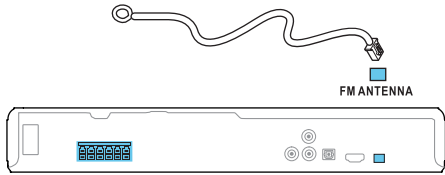

HTD5570

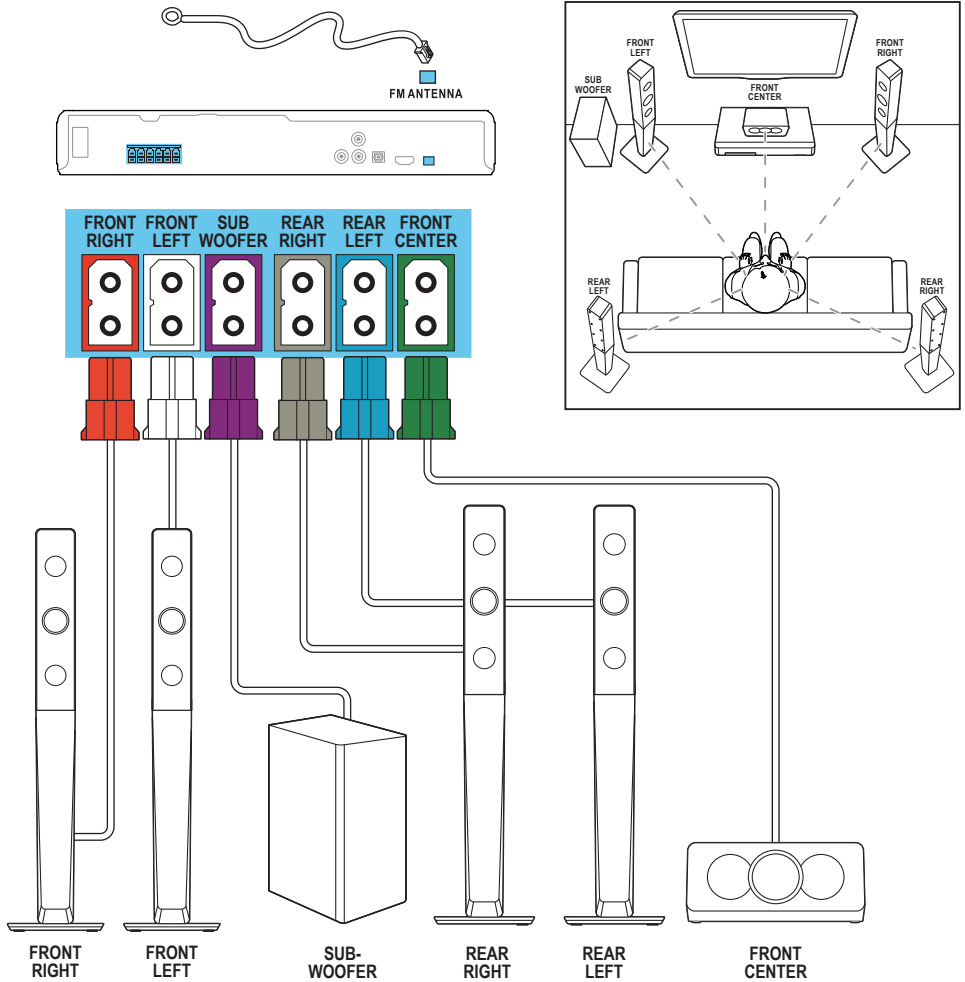

3

EN Connect to TV in one of these ways

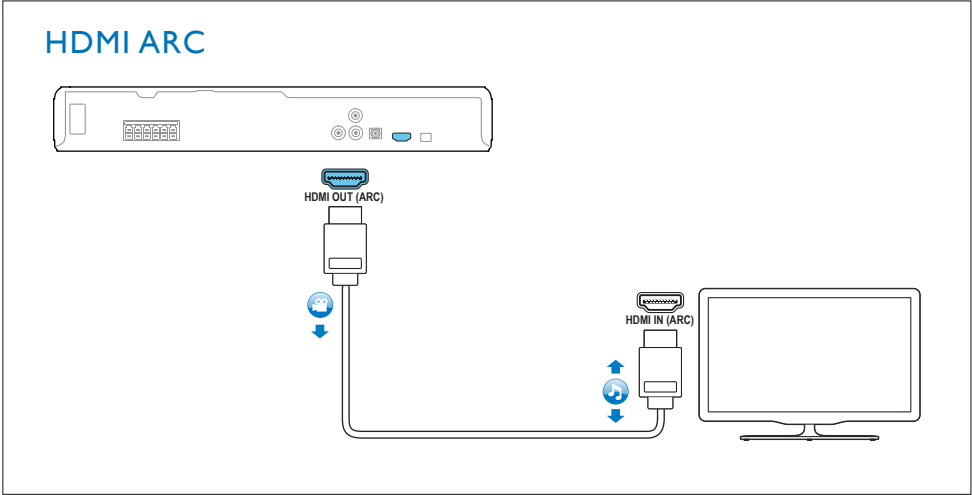

HDMI + OPTICAL

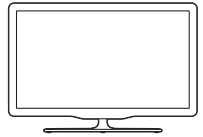
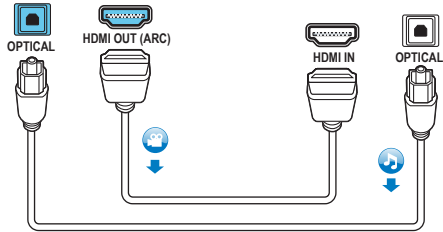

VIDEO + AUDIO L/R

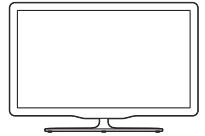
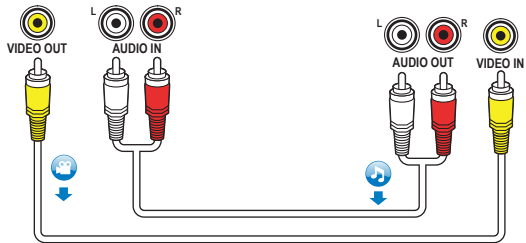

4

EN Switch on the home theater

1

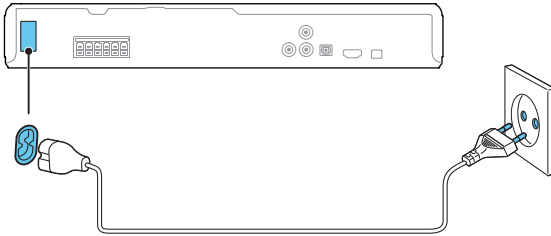

2

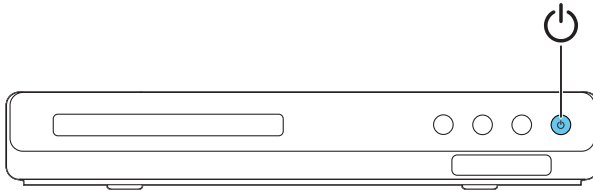

3

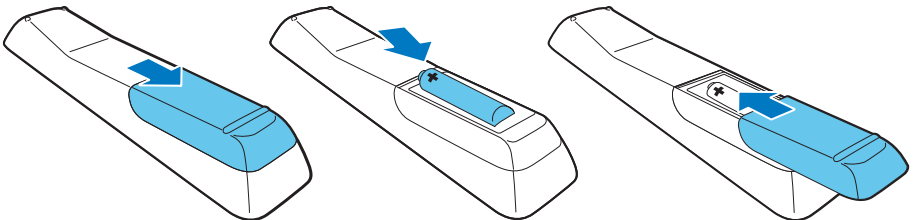

5

EN Complete the first time setup

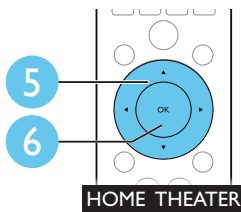
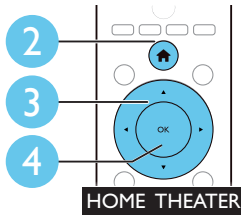
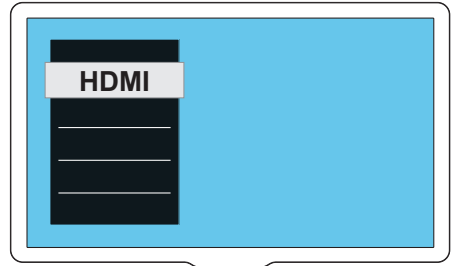
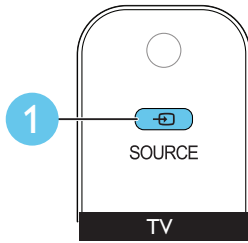

6

EN Use your home theater

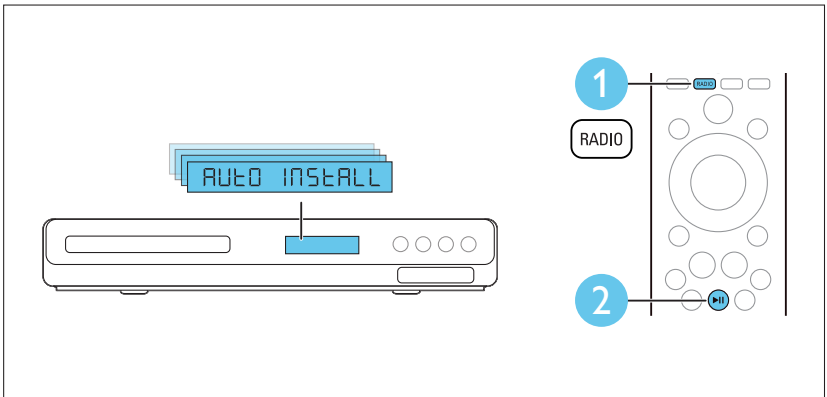
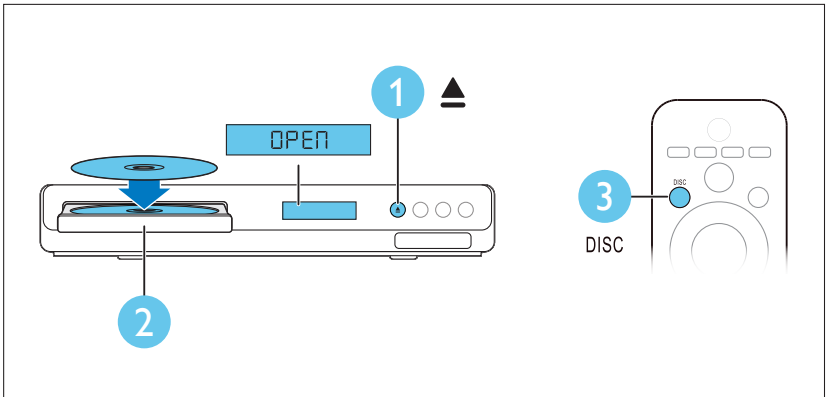

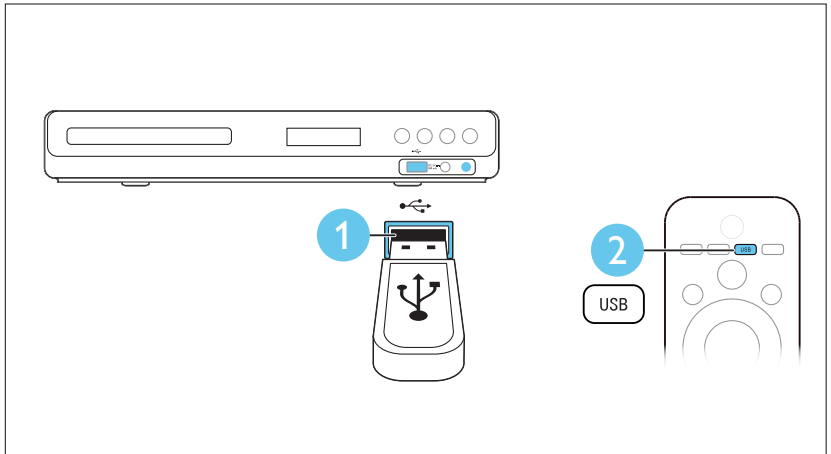
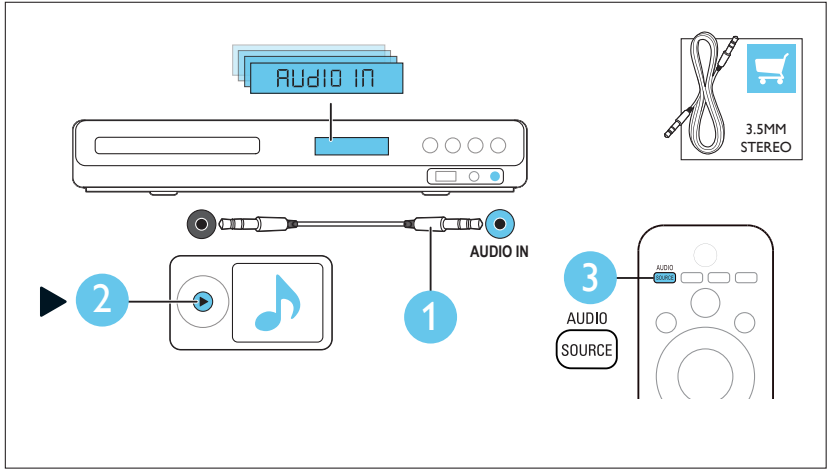



Specifications are subject to change without notice
© 2013 Koninklijke Philips Electronics N.V.
All rights reserved.

HTD5510/5540/5570_94_QSG_V1.0

