

PHILIPS **NORELCO**



AT620

**Rechargeable Cordless
Tripleheader Shaver**

Always here to help you

Register your product and get support at
www.norelco.com/register

BC

Question?
Contact
Philips
Norelco

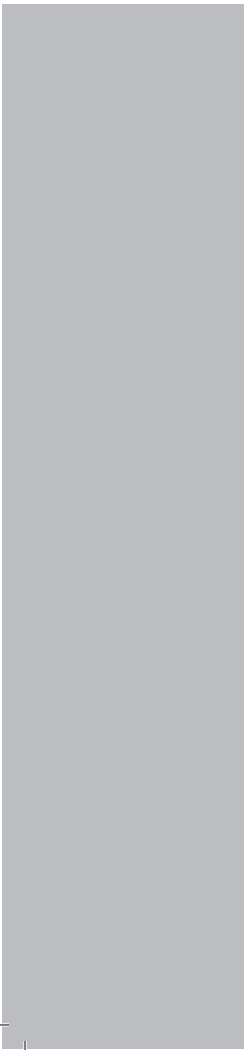

ENGLISH 4

AT620

Congratulations on your purchase and
welcome to Philips Norelco!

To fully benefit from the support that Philips
Norelco offers, register your product at
www.norelco.com/register

IMPORTANT SAFETY INSTRUCTIONS

When using an electric appliance, basic precautions should always be followed, including the following:

Read all instructions before using this appliance.

DANGER

To reduce the risk of electric shock:

1. Do not reach for a corded shaver that has fallen into water. Unplug immediately.
2. Power plug is not for immersion or for use in shower.
3. Do not use an extension cord with this appliance.
4. Always unplug this shaver from the electrical outlet immediately after use, except when shaver is (re)charging.
5. Unplug and remove power supply cord from shaver before cleaning.
6. The batteries used in this device may present a fire or chemical burn hazard if mistreated. Do not disassemble, heat above 100°C (212°F) or incinerate.

WARNING

To reduce the risk of burns, fire, electric shock, or injury to persons:

1. Close supervision is necessary when this shaver is used by, on, or near children or invalids.
2. Use this shaver for its intended household use as described in this manual. Do not use attachments not recommended by Philips Electronics North America Corporation.
3. Never operate this shaver if it has a damaged cord or charging plug, if it is not working properly, if it has been dropped or damaged, or dropped into water while plugged in. For assistance call 1-800-243-3050.

4. Keep the shaver, cord and charging plug away from heated surfaces.
5. Never drop or insert any object into any opening.
6. Do not use the adapter in or near a power outlet that contains an electric air freshener to prevent damage to the adapter.
7. Do not charge or plug in shaver outdoors or operate where aerosol (spray) products are being used or where oxygen is being administered.
8. Do not use this shaver with a damaged or broken comb, as facial injury may occur.
9. Always attach plug to shaver first, then plug into outlet. Be certain plug is inserted firmly into shaver up to mark indicated on plug. To disconnect, remove charging plug from outlet.
10. Never put the shaver in direct sunlight, use, charge and store at a temperature between 50°F (10°C) and 95°F (35°C).
11. Keep the cord dry at all times. Do not handle with wet hands.
12. To prevent possible damage to the cord, do not wrap cord around the shaver.
13. Do not attempt to open the appliance to replace the battery.
14. Only use the power plug supplied with the shaver.

SAVE THESE INSTRUCTIONS

IMPORTANT: The power plug contains a transformer. Do not cut off the power plug to replace it with another plug, as this will cause a hazardous condition.

PHILIPS

The logo for Philips Norelco, featuring the word "PHILIPS" in a simple sans-serif font above the word "NORELCO" in a bold, italicized sans-serif font. A stylized "P" symbol is positioned to the left of "NORELCO".**45 - DAY MONEY-BACK GUARANTEE**

To enjoy the closest and most comfortable shave from your new Philips Norelco Men's Shaver, the shaver should be used exclusively for 3 weeks. This allows your hair and skin enough time to adapt to the Philips Norelco Shaving System. If, after that period of time, you are not fully satisfied with your Philips Norelco Men's Shaver, send the product back along with dated sales receipt and we'll refund you the full purchase price. **The shaver must be shipped prepaid by insured mail, insurance prepaid, have the original sales receipt, indicating purchase price, the date of purchase, and the money-back guarantee return authorization form enclosed. We cannot be responsible for lost mail.**

The shaver must be postmarked no later than 45 days from the date of purchase. Philips Norelco reserves the right to verify the purchase price of the shaver and limit refunds not to exceed suggested retail price.

To obtain money-back guarantee return authorization form, call 1-800-243-3050 for assistance. Delivery of refund check will occur 6-8 weeks AFTER receipt of refund product.

Table of Contents

Features	8-9
Before First Use	10
Charging	10-11
Recharging	12
Put It To The Test & Shaving Tips	12
How to Shave With An Electric Shaver	13
Trimming	14
Cleaning.....	14-19
Replacing the Shaving Heads.....	20-21
Storage.....	21
Assistance	22
Disposal	22
Accessories	23
Warranty.....	Back Cover

Features

CloseCut
Blade System

Shaving Unit

Individually
Floating
Heads

Electronic
On/Off Button

Charging Light

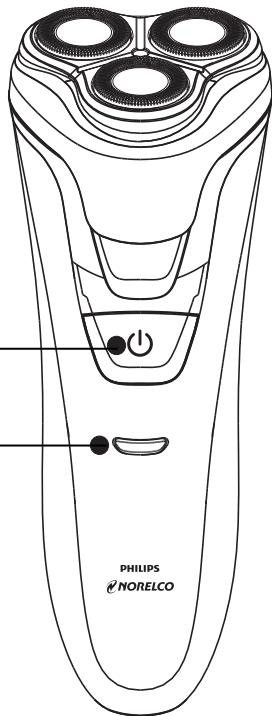

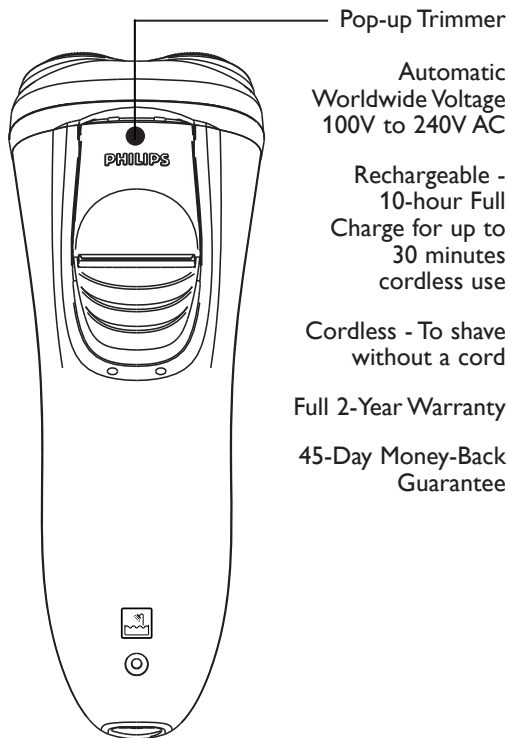

Before First Use

- ▶ Charge the shaver before you start using it (see 'Charging'). Make sure the shaver is switched off before you start charging it.

Important

- ▶ Only use the power cord provided to charge the shaver.
- ▶ The power plug transforms 100-240V AC to less than 24V DC.

Charging

- ▶ Charging or recharging at temperatures below 40°F/4,5°C or higher than 95°F/35°C adversely affects lifetime of batteries.
- ▶ If the shaver is subjected to a major change in temperature, pressure or humidity, let it acclimatize for 30 minutes before using.
- ▶ Charging or recharging requires 10 hours.
- ▶ A fully charged shaver has a cordless shaving time of up to 30 minutes.
- ▶ The shaving time may be less as a result of your shaving behavior, cleaning habits or beard type.
- ▶ When charging shaver for the first time or after a long period of non-use, charge for at least 10 hours.

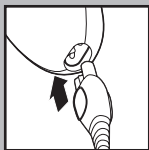

- 1** Connect cord directly to shaver and connect the charging plug into any 100V to 240V AC outlet. Use only the power cord provided.

- ▶ An adaptor plug may be necessary for charging plug usage in some foreign countries. Use an attachment plug adaptor of the proper configuration for the power outlet.

The charging plug will automatically convert to work on 100V to 240V AC systems.

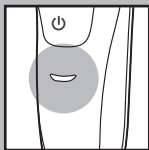

- ▶ The charging light on the shaver will light up green.

- 2** Charging and recharging requires a full 10 hours. A fully charged shaver has a cordless shaving time of up to 30 minutes.

- ▶ When the battery is fully charged, the charging light will remain green

- 3** The charging light will light up orange when the battery is almost empty (5 or less shaving minutes left). When you turn the shaver OFF the charging light continues to light up orange for a few seconds.

Recharging

1 Recharging requires 10 hours.

Recharge when the charging light on the shaver display lights up.

Put It To The Test & Shaving Tips

- ▶ **21 Day Trial and Conversion Process.** It is a fact that your skin and beard need time to adjust to a new shaving system.
- ▶ Use your new shaver exclusively for 3 weeks to fully enjoy the closeness of a Philips Norelco shave.
- ▶ At first you may not get as close a shave as you expect, or your face may even become slightly irritated. This is normal since your beard and skin will need time to adjust. Invest 3 weeks and you'll soon experience the full joy of your new shaver.
- ▶ Stick with it! If you alternate shaving methods during the adjustment period, it may make it more difficult to adapt to the Philips Norelco shaving system.
- ▶ If you are still not convinced after 21 days, Philips Norelco will refund you the full purchase price as long as the request is received within 45 days of purchase.

How To Shave With An Electric Shaver

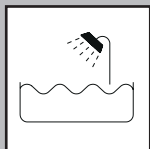

- ▶ This symbol on the shaver indicates that the shaver can be used in both the bath and shower.
- ▶ The shaver will not operate while power cord is connected to an electrical outlet.
- ▶ For hygienic reasons, the shaver should only be used by one person.
- ▶ Use this shaver for its intended household use as described in this manual.
- ▶ Shaving with a clean face gives the best results.



- 1** Turn shaver ON by pressing the on/off button once. Shave against the direction of beard growth using circular movements.
- 2** Stretch your skin with your free hand so blades can cut whiskers. Gently press shaver to skin so the floating heads can follow the contours of your face. DO NOT press too hard. Too much pressure can pinch the skin into the combs.
- 3** Turn shaver OFF by pressing the on/off button once.
- 4** Clean the shaver after each use (see chapter 'Cleaning').

Trimming

To groom sideburns and moustache:

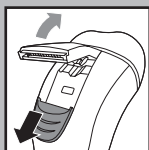

- 1** Turn shaver ON.
- 2** Push down spring-release trimmer switch. The trimmer can be activated while the shaver is running.



- 3** Move trimmer in downward strokes with gentle pressure.
- 4** Close trimmer by pressing trimmer down.
- 5** Turn shaver OFF.

Cleaning

- ▶ Always switch shaver OFF, unplug and remove power cord before cleaning.
- ▶ Never clean, remove or replace head assembly while motor is on.
- ▶ Do not apply pressure to combs. Do not touch shaving heads with hard objects as this may dent or damage precision-made slotted combs.
- ▶ Do not use shaver if combs are damaged or broken. Facial injury may occur.
- ▶ Do not use compressed air, abrasives, scourers or aggressive liquids such as gasoline or acetone to clean the shaver.

Cleaning the Shaving Unit

The shaving heads may be quickly cleaned after each use by rinsing with hot water: Water from the tap should be on a hot setting, **BUT BE CAREFUL TO TEST WATER FIRST SO AS NOT TO BURN OR SCALD HANDS.**

- ▶ Regular cleaning guarantees better shaving results.
- ▶ Do not immerse shaver in water.
- ▶ While rinsing shaving heads, water may drip out of the base of shaver. This is a normal occurrence.

1 Always turn shaver OFF, unplug from outlet and remove power cord from shaver.

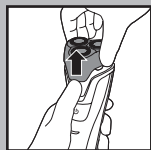

2 Place your thumb under the shaving unit and push the shaving unit off the shaver while holding it in your hand.

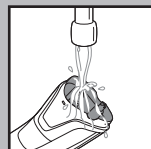

3 Clean the hair chamber by running under hot water.

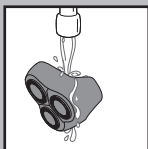

- 4** Clean inside of shaving unit by running under hot water.

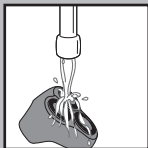

- 5** Clean outside of shaving unit by running under hot water.

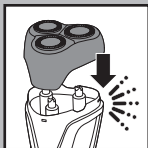

- 6** Reattach the shaving unit and shake off excess water.

Be careful not to hit the shaving unit against anything while shaking off excess water.

NOTE: Do not wipe or dry the shaving heads with a towel or tissue. This could damage the shaving heads.

Extra-thorough Cleaning Method

Do not mix up the cutters and combs as the shaving performance may be adversely affected for several weeks before optimal shaving performance is restored.

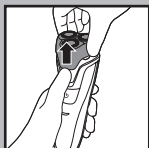

- 1** Turn shaver OFF, remove the charging plug from the outlet and power cord from the shaver.

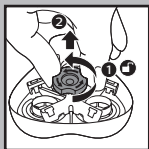

- 2** Place your thumb under the shaving unit and push the shaving unit off the shaver while holder it in your hand.

- 3** Turn the lock counterclockwise (1) to unlock and remove the retaining frame (2).

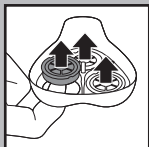

- 4** Remove and clean one set of cutters and combs at a time.

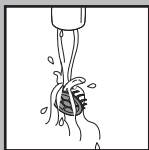

- 5** Separate the cutter from the comb. Clean the inside and outside of the cutter by rinsing under hot water.

Do not clean more than one cutter and comb at a time, since they are all matching sets. If you accidentally interchange the cutters and combs, it could take several weeks before optimal shaving performance is restored.

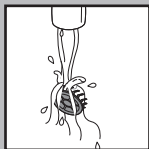

- 6** Clean the inside and outside of the comb by rinsing under hot water.

For optimum performance, shaver cutters and combs should be cleaned in a degreasing liquid (e.g. alcohol) and lubricated with one drop of mineral oil (in the center of the head). This helps prevent wear of the shaving heads.

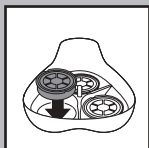

- 7** Replace the set back into the shaving unit.

Make sure that the projections of the shaving head fit exactly into the recesses.

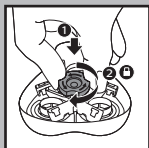

- 8** Repeat the process for the other two sets of cutters and combs.

- 9** Put the retaining frame back into the shaving unit.

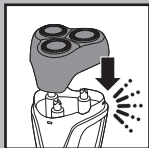

- 10** Reattach the shaving unit and shake excess water off the shaver.

NOTE: If the shaving unit does not close smoothly, make sure you inserted the shaving heads properly and that the retaining frame is locked.

- 11 Remove the shaving unit and let the shaver air dry thoroughly.

After Each Use: Trimmer



- 1 Turn shaver OFF.
- 2 Push down spring-release trimmer switch.

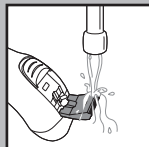

- 3 Clean the trimmer by rinsing under hot water and allow to air dry thoroughly.

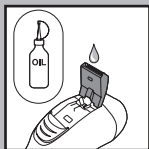

- 4 Lubricate the trimmer teeth with one drop of mineral oil every 6 months.
- 5 Close trimmer by pressing trimmer down.

Replacing the Shaving Heads

- ▶ Replace the shaving heads once a year for optimal shaving results.
- ▶ Replace damaged or worn shaving heads with model HQ56 Philips Norelco shaving heads only.
- ▶ HQ56 Philips Norelco shaving heads are available on www.philips.com/store

1 Turn shaver OFF, remove the charging plug from the outlet and power cord from the shaver.

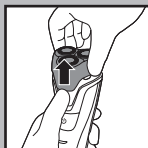

2 Place your thumb under the shaving unit and push the shaving unit off the shaver while holding it in your hand.

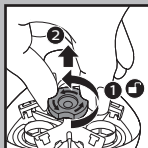

3 Turn the lock counterclockwise (1) to unlock and remove the retaining frame (2).

4 Remove the shaving heads and place the new shaving heads in the shaving unit.

Make sure that the projections of the shaving head fit exactly into the recesses.

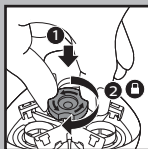

5 Put the retaining frame back into the shaving unit (1) and turn the lock clockwise until it locks into place (2).



6 Reattach the shaving unit.

NOTE: If the shaving unit does not close smoothly, make sure you inserted the shaving heads properly and that the retaining frame is locked.

This shaver has no other user-serviceable parts. For assistance call 1-800-243-3050.

Storage

- ▶ Be sure shaver is turned off. Remove cord from outlet and shaver before storing in a safe, dry location where it will not be crushed, banged, or subject to damage.
- ▶ Do not wrap power cord around shaver when storing.
- ▶ Store cord in a safe location where it will not be cut or damaged.
- ▶ Do not place or store shaver where it can fall or be pulled into a tub or sink, water or other liquid while plugged in.

Assistance

- ▶ For assistance, visit our website:

**www.philips.com/support or
call toll free 1-800-243-3050**

- ▶ Online information is available 24 hours a day,
7 days a week.

Disposal



- ▶ This Philips Norelco shaver contains a rechargeable nickel metal hydride battery which must be disposed of properly.
- ▶ Contact your local town or city officials for battery disposal information or call 1-800-822-8837 or visit www.call2recycle.org for battery drop-off locations.
- ▶ For assistance, visit our website, www.philips.com/support or call toll free: 1-800-243-3050.
- ▶ Your product is designed and manufactured with high quality materials and components, which can be recycled and reused. For recycling information, please contact your local waste management facilities or visit www.recycle.philips.com.

Accessories

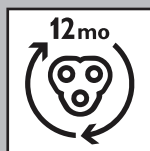

- ▶ **Replacement Heads**
Model HQ56 - For maximum shaver performance, replace your Philips Norelco shaving heads once a year.
- ▶ **Philips Norelco Shaver Accessories** may be purchased at a store near you, or on our website www.philips.com/store

FULL TWO YEAR WARRANTY

Philips Electronics North America Corporation warrants this new product (except cutters and combs) against defects in materials or workmanship for a period of two years from the date of purchase, and agrees to repair or replace any defective product without charge.

IMPORTANT: This warranty does not cover damage resulting from accident, misuse or abuse, lack of reasonable care, the affixing of any attachment not provided with the product or loss of parts or subjecting the product to any but the specified voltage or batteries.*

NO RESPONSIBILITY IS ASSUMED FOR ANY SPECIAL, INCIDENTAL OR CONSEQUENTIAL DAMAGES.

In order to obtain warranty service, simply go to www.philips.com/norelco or call 1-800-243-3050 for assistance. It is suggested that for your protection you return shipments of product by insured mail, insurance prepaid. Damage occurring during shipment is not covered by this warranty.

NOTE: No other warranty, written or oral, is authorized by Philips Electronics North America Corporation.

This warranty gives you specific legal rights, and you may also have other rights which vary from state to state. Some states do not allow the exclusion or limitation of incidental or consequential damages, so the above exclusion and limitations may not apply to you.

* Read enclosed instructions carefully.

Manufactured for:

Philips Consumer Lifestyle

A division of Philips Electronics North America Corporation
P.O.Box 10313, Stamford, CT 06904



This symbol on the product's nameplate means it is listed by Underwriters' Laboratories, Inc.

Norelco and Tripleheader are registered trademarks of Philips Electronics North America Corporation.

PHILIPS is a registered trademark of Koninklijke Philips N.V.

© 2016 Philips Electronics North America Corporation. All rights reserved.

4222 002 5999 1