

**Gebrauchsanweisung**

Instructions for use

**Mode d'emploi**

Gebruiksaanwijzing

**Istruzioni per l'uso**

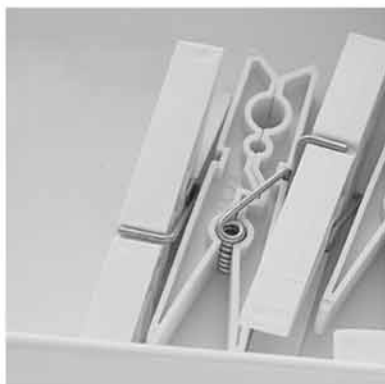

**Brugsanvisning**

Bruksanvisning

**Käyttöohje**

Manual de utilização

**Instrucciones para el uso**



**Οδηγίες χρήσης**

Instrukcje użytkowania

**Használati utasítás**

Инструкция за употреба

**Navodila za uporabo**

Upute za uporabu



**Návod k použití**

Návod na použitie

**Instrucțiuni de utilizare**

Инструкции по эксплуатации

**Uputstvo za upotrebu**

# CONTENTS



READ INSTRUCTIONS FOR USE!

## INSTRUCTIONS FOR USE

<b>SAFE INSTALLATION AND USE</b>	<b>Page 3</b>
<b>INTENDED USE</b>	<b>Page 7</b>
<b>INSTALLATION</b>	<b>Page 8</b>
<b>DESCRIPTION OF THE DRYER</b>	<b>Page 9</b>
<b>CLEANING AND MAINTENANCE</b>	<b>Page 10</b>
<b>CLEANING THE DOOR FILTER</b>	<b>Page 10</b>
<b>CLEANING THE BOTTOM FILTER</b>	<b>Page 11</b>
<b>DRAINAGE SYSTEM</b>	<b>Page 12</b>
<b>DOOR REVERSIBILITY</b>	<b>Page 14</b>
<b>ENERGY SAVING/AUTOMATIC SWITCH-OFF FUNCTION</b>	<b>Page 15</b>
<b>TROUBLESHOOTING GUIDE/AFTER-SALES SERVICE</b>	<b>Page 16</b>
<b>DISPOSAL</b>	<b>Page 18</b>

## QUICK REFERENCE GUIDE

<b>INDICATORS AND OPTIONS</b>
<b>PROGRAMME CHART</b>
<b>RUNNING A PROGRAMME</b>
<b>TROUBLESHOOTING / MAINTENANCE</b>
<b>CONSUMPTION DATA</b>



## SAFE INSTALLATION AND USE

To avoid injuries, damages on the dryer and its surrounding area or even a fire, you must observe the instructions below.

### Packaging, damages, handling

- Keep the packaging foil away from children; danger of suffocation.
- Do not operate the dryer if it has been damaged during transport or later. Inform the After-Sales Service.
- If the dryer was exposed to the cold before delivery, keep it at room temperature for a few hours before installation. Cold temperatures can affect the proper functioning of electronic parts.
- Never lift your dryer by holding it on extruding parts (e.g. door) or on the worktop; parts might loosen or break and persons might get injured.
- For lifting the dryer, at least 2 persons are necessary, to avoid accidents.
- The dryer must be carried in an upright position.

### Location and surrounding area

- The dryer is appropriate for indoor use only.
- Do not install the dryer in rooms with poor ventilation. If you want to install it in a small storage room, toilet, bathroom or similar, assure a good ventilation (open door, ventilation grid or slot larger than 500 cm<sup>2</sup>).
- Do not install the dryer where it will be exposed to extreme temperatures below 5°C or over 35°C, to avoid malfunction, damages to dryer parts or fire.
-  The dryer must be placed with the back towards a wall, to avoid injuries by touching the rear panel, which can become hot during the drying process.
- Do not store flammable fluids near the dryer, to prevent fires.
- Do not install the dryer behind a lockable door, a sliding door or a door with a hinge on the opposite side to the tumble dryer's door, in a way that a full opening of the dryer door is restricted.
- Do not install the dryer on a deep pile carpet, to avoid that the ventilation openings are clogged.
- Do not store flammable fluids near the dryer, to prevent fires.
- If you must install the dryer next to a gas or coal stove, you must fix a heat insulating plate (85 x 57 cm) between dryer and stove; the plate's side pointing towards the oven must be covered with aluminium foil, to protect the dryer against high temperatures.
- Built-in installation of the tumble dryer is not permitted.

- If you want to install the dryer under a worktop, make sure that a ventilation grid (minimum 45 x 8 cm) is inserted in the rear part of the worktop where the dryer will be installed, to assure sufficient ventilation.

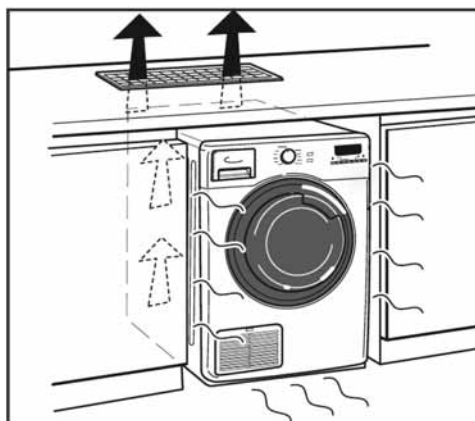

### **Stacking on a washing machine**

- If you want to place the dryer on top of your washing machine, first contact our After-Sales Service or your specialist dealer to verify if this is possible. Stacking of a dryer is only admitted if the dryer and your washing machine are compatible, and if an appropriate stacking kit is available through our After-Sales Service or your specialist dealer by which the dryer can be safely fixed on the washing machine.



### **Electrical connection**

- The dryer must only be connected to an earthed socket which is in compliance with the current safety regulations and which is appropriate for the values regarding voltage, power consumption and protection requirements as they are indicated on the rating plate on the rear of the dryer.
- Do not use extension leads, extension leads with multiple sockets, or adapters; they might cause a fire by overheating. If you need a longer mains cable, contact our After-Sales Service.
- After installation, access to the mains plug or to disconnection from mains supply by a double-pole switch must be ensured at all times, to make sure the dryer can be separated immediately from the mains supply.
- For unplugging the dryer, do not pull the mains cable, to avoid damaging it. Never touch the mains plug with wet hands, to avoid an electrical shock.

- Do not trap the mains cable between the dryer and the wall, to prevent damages on the cable.
- Do not operate the dryer if the mains cable or plug shows damages.
- Before doing any maintenance on the dryer, disconnect it from the mains supply, to avoid dangers.
- If necessary, the mains cable can be replaced; the replacement must only be done by our After-Sales Service or by a qualified technician, to avoid dangers.
- When using a residual current circuit breaker (RCCB), only use a model marked with 

### **Children and handicapped people**

- Children must not play with the dryer.
- Children younger than 3 years should be kept away from the dryer, unless they are continuously supervised.
- The dryer can be operated by children from the age of 8 years up, as well as by people with reduced physical, sensory or mental capabilities or lack of experience and knowledge, provided they are supervised or instructed regarding the safe use of the dryer and they understand the dangers resulting from the use.
- Care and maintenance works on the dryer must not be done by children without being supervised.
- Ensure that children and small animals cannot get into the drum.



### **Safe operation/minimizing the risk of a fire**

- Do not tumble dry laundry containing oil, to prevent a fire. Oil-bearing items can ignite spontaneously, especially when they are exposed to heat sources as in a tumble dryer. The items would become warm, causing an oxidation reaction in the oil. Oxidation creates heat; if the heat cannot escape, the item can become hot enough to catch fire.
- Do not tumble dry unwashed laundry in the tumble dryer.
- Laundry items that have been soiled with substances such as cooking oil, acetone, alcohol, benzene, petroleum, kerosene, stain removers, turpentine, wax or wax removers must be washed in hot water, with an extra amount of detergent, before being dried in the tumble dryer.
- Items such as foam rubber (latex foam), shower caps, waterproof textiles, rubber backed articles and clothes or pillows fitted with foam rubber pads must not be dried in the tumble dryer.
- Remove all objects from pockets such as lighters and matches.

- Do not use flammable cleaning agents.
- Do not use the tumble dryer if chemicals have been used for cleaning.
- Fabric softeners or similar products must be used as specified by the fabric softener instructions.
- Never stop the tumble dryer before the end of the drying cycle, unless all items are quickly removed and spread out so that the heat is dissipated. The final phase of a drying cycle always occurs without heat (cool down phase), to ensure that the laundry items are left at a temperature which does not cause damage to the laundry.
- Clean the door filter after each drying cycle (see paragraph CLEANING THE DOOR FILTER).
- Keep the surrounding area of the dryer free from lint.
- Always set the programme knob to the Off-position "O" after programme end, to reduce the risk that the dryer might be started accidentally.
- Drying clothes with buckles or using dryer balls may impact the surface of the drum.

### **Maintenance**

- Before doing any maintenance, switch off the dryer and disconnect it from the mains supply.
- Never use flammable fluids for cleaning the dryer.
- Do not use detergents containing solvents, scouring powder, glass or general purpose cleaners. They might harm the surfaces.

### **Repairs and spare parts**

- Repairs must only be done by our After-Sales service. Improper repairing can lead to unpredictable dangers for the user and to damages on the dryer and will moreover cause the loss of the guarantee.
- For repairs, only original spare parts are admitted, to assure proper functioning of the dryer.
- For dryer models with drum light: Replacing the light bulb must only be carried out by our After-Sales Service.

## INTENDED USE

This appliance is destined to dry laundry which is marked to be appropriate for being treated in a dryer, in quantities which are usual for private households.

- Observe the instructions given in these Instructions for Use and in the Quick Reference Guide when using the dryer.
- Keep these Instructions for Use and the Quick Reference Guide; if you pass on the dryer to another person, also give him/her Instructions for Use and Quick Reference Guide.

### Heat Pump Technology

This dryer with modern heat pump technology provides the same results, but only consumes a fraction of the energy used by traditional condenser and air-vented dryers. In order to treat your laundry as gentle as possible and to reach a low energy consumption, the laundry is dried with low temperature; therefore it may feel cooler than expected during and after the drying process.

For heat pump dryers, the initial heating phase is longer than it is for traditional dryers. For that reason, no or only little heat can be perceived inside the dryer during the first 10 to 20 minutes.

If possible, do not open the dryer door during the drying process to check dryness of your laundry. Otherwise heat will escape from the drum, and the programme time will be prolonged unnecessarily.

# INSTALLATION

For installing your dryer, you must observe the instructions of chapter SAFE INSTALLATION AND USE.

- Carefully level the dryer by adjusting the four feet; check the correct leveling with a level.
- Before running the first drying cycle, ensure that the water container is fully pushed inside and that the bottom filter is correctly positioned (see chapter DESCRIPTION OF THE DRYER).
- Also make sure that all hoses of the drainage system are connected as shown in the picture below.

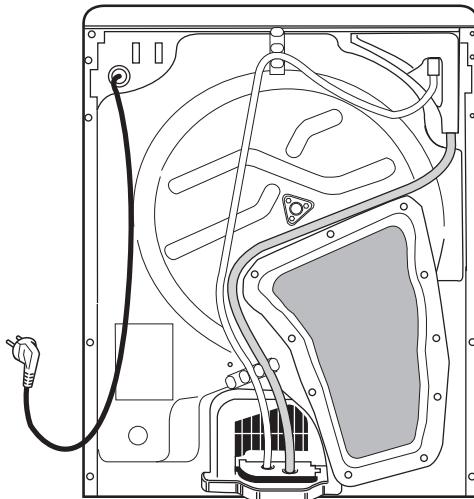

If possible you can drain the water directly into the domestic plumbing system. This will avoid having to empty the water container at the end of each drying cycle since the condensation water can be directly drained away (see chapter DRAINAGE SYSTEM).

## Electrical connection for Great Britain/Ireland

### 1) For Great Britain only

**Warning – this appliance must be earthed**

#### Fuse replacement

If the mains lead of this appliance is fitted with a BS 1 363A 13 amp fused plug, to change a fuse in this type of plug use an A.S.T.A. approved fuse to BS 1 362 type and proceed as follows:

1. Remove the fuse cover (A) and fuse (B).
2. Fit replacement 13A fuse into fuse cover.
3. Reinstall both into plug.

#### Important:

The fuse cover must be reinstalled when changing a fuse and if the fuse cover is lost, plug must not be used until a correct replacement is installed.

Correct replacements are identified by the color insert or the color embossed in words on the base of the plug. Replacement fuse covers are available from your local electrical store.

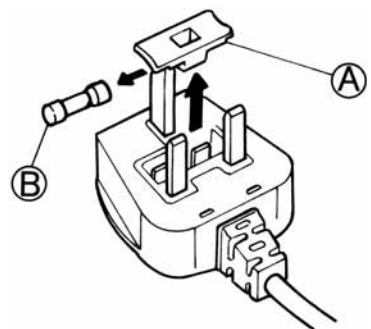

## **2) For the Republic of Ireland only**

The information given in respect of Great Britain will frequently apply, but a third type of plug and socket is also used, the 2-pin, side earth type.

## **3) Socket outlet / plug (valid for both countries)**

If the fitted plug is not suitable for your socket outlet, please contact Whirlpool Service for further instruction.

Please do not attempt to change plug yourself. This procedure needs to be carried out by a qualified Whirlpool technician in compliance with the manufactures instructions and current standard safety regulations.

# DESCRIPTION OF THE DRYER

- A.** Work top
- B.** Water container

- C.** Contact pin

- D.** Door:

To open the door: pull the handle.

To close the door: push gently until closed.

- E.** Door filter

- F.** Bottom filter

- G.** Bottom filter flap

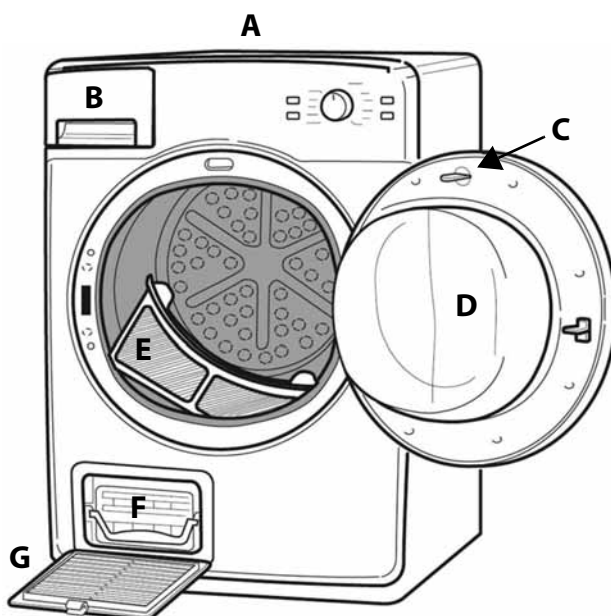

## CLEANING AND MAINTENANCE

### AFTER EACH DRYING CYCLE

- Switch off the dryer before cleaning or carrying out maintenance.
- Empty the water container at the end of each drying cycle.
- Clean the door filter at the end of every drying cycle.

### Dryer exterior and control panel:

- Use a soft, damp cloth. Dry with a soft cloth.
- Do not use detergents containing solvents, scouring powder, glass or general purpose cleaners; they may harm the surfaces.

### Door seal, door, filter area:

- Use a damp cloth to wipe away lint.
- Since lint can go through the filter, occasionally clean the complete filter area (including below the filter) with a brush, a damp cloth or a vacuum cleaner.

### CLEANING THE DOOR FILTER

Depending on the model of your dryer, the door filter can have different shapes.

- Remove the complete laundry out of the dryer before removing the lint filter.
- Take the D filter out of the dryer and carefully open the filter.
- Carefully remove the complete lint from the lint screen.
- If the mesh is clogged and cannot be cleaned by hand, run the filter under water and scrub with a soft brush.

When the door filter is clean, put it back into the dryer. Assure that it is positioned correctly before starting the next drying cycle.

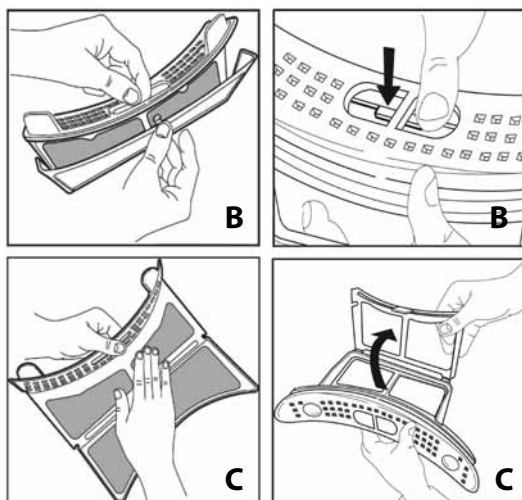

### IMPORTANT:

- Be aware that the lint filter is always correctly positioned when laundry is put into the drum or is taken out of it.
- Clean the door filter after each drying cycle.

## CLEANING THE BOTTOM FILTER

- A. Open the bottom filter flap. Lift up the handle of the filter and pull the bottom filter out.
- B. Open the filter by lifting on the latch of the filter frame.
- C. Take out the foam from the inside of the filter.
- D. Remove the lint on the surface of the foam by hand. Afterwards, clean the foam under running water to remove any remaining lint from the foam.
- E. Remove the lint from both filter parts by hand. If a white substance remains on the filter mesh that cannot be removed by hand, clean the filter parts under running water. If necessary, use a soft brush.
- F. Put the foam back into the filter frame. **The foam could also put inside the filter when it is wet, there is no effect to the drying result.**
- G. Install the filter frame into the housing by inserting the tabs of the frame into the slots on the filter housing and clicking the latch into place. Please take care that the foam is not pinched between the filter parts.
- H. Clean the filter housing and the mesh inside by hand, with a damp cloth, or very carefully with a vacuum cleaner.
- I. Install the filter again in the dryer, with the handle in horizontal position. When the filter is fully inserted, move the handle downwards to lock the filter in place. Ensure that the handle is fully engaged on both sides behind the hooks of the housing area.
- J. Fix the bottom filter flap again.

### IMPORTANT:

- Clean the bottom filter after every 5th drying cycle approximately.
- For performance tests according to EN 61121 by test institutes, the bottom filter must be cleaned after each drying cycle.
- Make sure that the filter meshes and foam are dry before starting a new drying cycle.
- The filter foam must not be washed together with laundry in a washing machine.

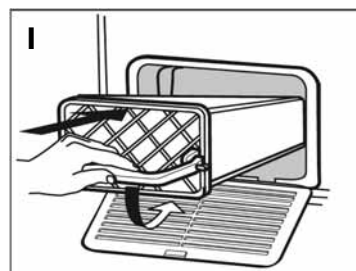
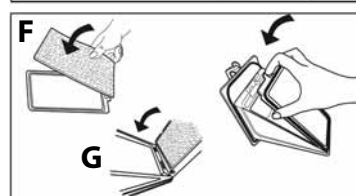
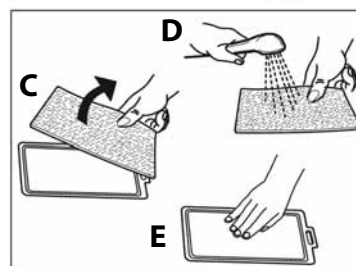
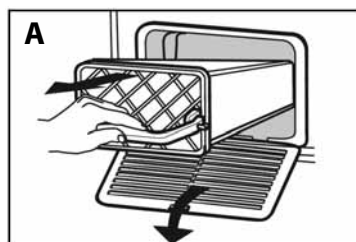

## DRAINAGE SYSTEM

For your convenience:

The dryer can be connected directly to the sewage system of the house to avoid the emptying of the water container after each drying cycle.

Place an absorbent cloth underneath to collect water spillage.

**A.** Unplug the hose located at the upper rear part of the dryer.

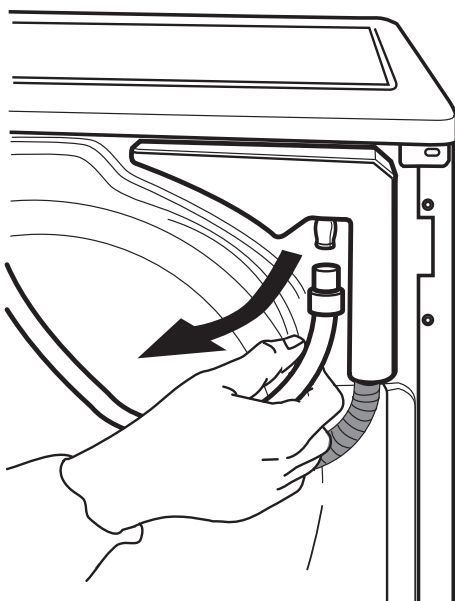

**B.** Remove the white hose from the hose fixation.

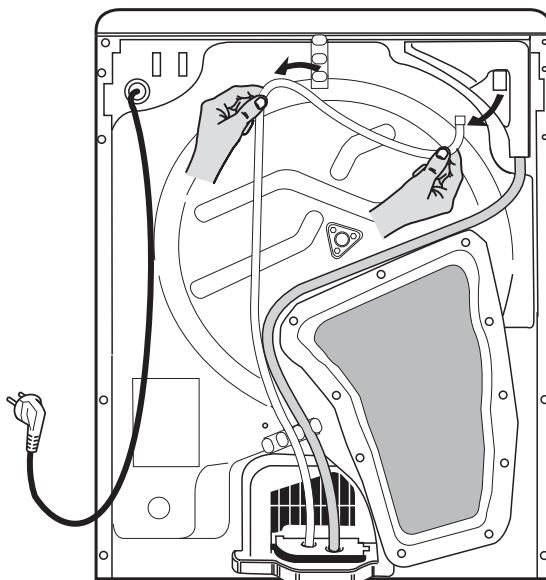

- C. Fix the hose to the sewage system. The height difference between the floor where the dryer stands on and the connection at the sewage system should not exceed 1 m.

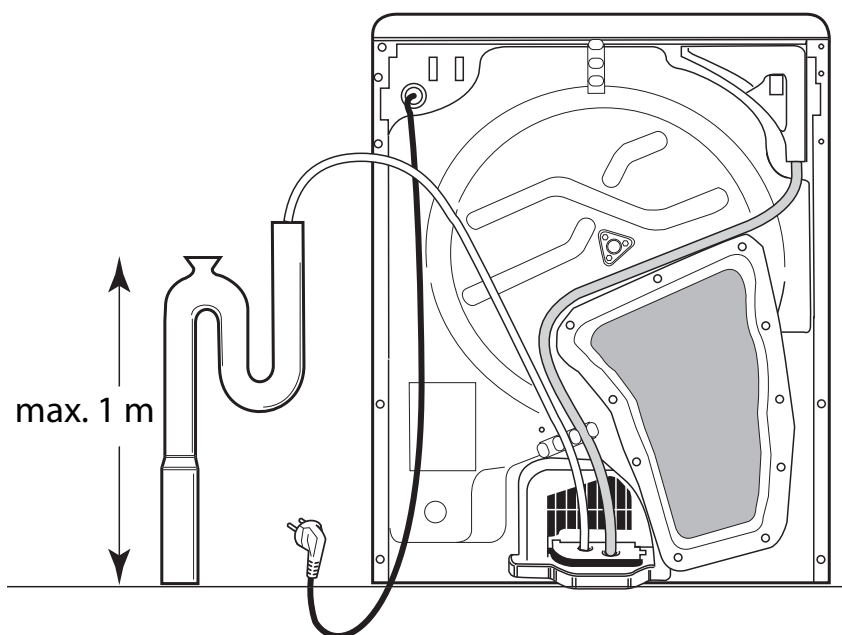

**NOTE:** To avoid siphoning, the end of the hose must not be immersed in the drain water. Avoid bending and twisting the hose.

## DOOR REVERSIBILITY

**For your convenience:**

**In case you want to stack the dryer on a washing machine, you can reverse the door opening direction, to bring the door handle in a lower position.**

**A.** Unplug the dryer.

**B.** Open the door.

**C.** Using pliers, turn the contact pin in the upper part of the door by 90° and pull it out.

**D.** Removing the door lock:  
Unscrew the 2 screws above and below the door lock system.

**E.** Press the small knob above the door lock system with a small screwdriver, move the door lock a little bit upwards and pull the door lock towards you with your finger.

**F.** Reverse the door:  
Remove the two screws of the door fixation.  
Fasten the door again on the desired side with the 2 screws.  
Take care to screw in horizontal position to avoid pinching off the door seal.

**G.** Repositioning of the door lock:  
Insert the door lock on the opposite side of the door fixation.  
Press it completely inside the hole and move it a little down, until the small knob of the door lock system is latching.

**H.** Fix the two screws above and below the door lock system.

**I.** Replace now the contact pin in the inside of the door on the top side, by inserting it and turning it again for 90°.

### **NOTE:**

Use a screw driver of the type "Torx T20".

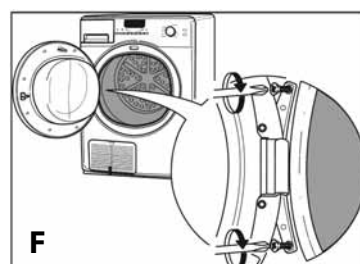
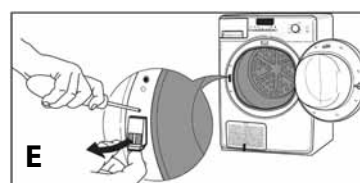
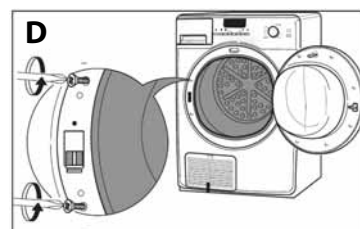
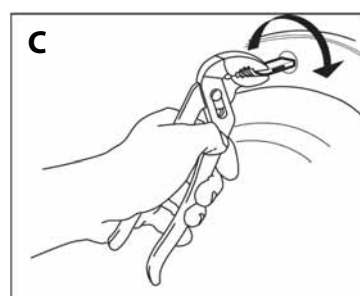
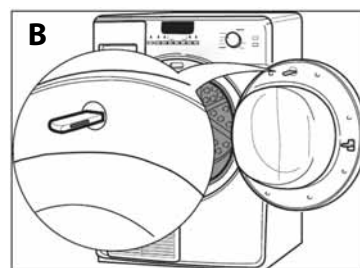

## ENERGY SAVING

For Dryers with Energy Label according to Directive 2010/30/EU

The Energy Label contains information on performance and consumption of your dryer:

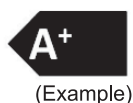

The bold black arrow marks the energy efficiency class (A+++ = most efficient / D = least efficient).



Power consumption per year



Type of dryer



Maximum load capacity



Drying time



Noise level drying



Condensation efficiency

### Automatic switch-off function

Your dryer is designed to save energy. For that reason, the dryer will switch off automatically a short time after programme end.

When a programme is selected but not yet started, the dryer will switch off after a few minutes.

To switch the dryer on again, turn the programme selector to "Off / O" and afterwards to the desired programme again.

### Energy saving tips

- The drying programme which is most efficient for drying wet cotton laundry is indicated in the separate Quick Reference Guide; it is the reference programme for the Energy Label.
- Your dryer is designed to save energy. After the end of a programme the dryer will therefore switch off after a short time. When a programme is selected but not yet started, the dryer will switch off as well after a few minutes.

- Always dry a full load: depending on the type of laundry and the programme/drying time. For detailed information, refer to the separate Quick Reference Guide.
- Use the maximum spin speed allowed by your washing machine, since draining the water mechanically requires less energy. You will save time and energy when running your drying cycle.
- Do not overdry the laundry.
- Clean the door filter after every drying cycle.
- Clean the bottom filter after every fifth drying cycle.
- Place your dryer in a room with a temperature between 15°C and 20°C. In case of higher temperature, ventilate the room, e.g. open the window.
- Always select the correct programme/ drying time for the load in order to obtain the desired drying results.
- Select the gentle option only with small loads.
- When drying cotton, dry iron dry and cupboard dry loads together: start with the iron dry programme/drying time setting, remove the laundry to be ironed at the end of that cycle and dry the remainder of the load on the cupboard dry setting.

## **TROUBLESHOOTING GUIDE/AFTER-SALES SERVICE**

**If a fault occurs, before contacting our After-Sales Service, perform the following checks to try to remedy the problem:**

### **Drying takes too long / laundry is not dry enough:**

- Correct programme selected?
- Inserted laundry too wet (Washing machine spin speed less than 800 rpm? When the spinning speed is less than 800 rpm the water container fault may occur during the drying cycle)?
- Door filter clogged (filter indicator lamp on)?
- Bottom filter clogged? (refer to the chapter "Door filter and bottom filter").
- Is the room temperature too high?
- END indicator lamps on? The drying cycle is complete and the laundry can be taken out.
- 'Gentle' option selected? The 'gentle' option should only be selected with small loads.
- Type of laundry mixed (for example cotton and synthetic load)?

### **The dryer does not operate:**

**(after a power failure and/or interruption to the mains supply, always press the Start/Pause button).**

- Plug connector properly inserted into the mains electricity socket?
- Dryer automatically switched off for energy saving? See paragraph "Automatic switch-off function".
- Power failure?
- Fuse blown?
- Door properly closed?
- Drying programme selected?
- Start delay option selected?
- Start/Pause button activated?
- Indicator lamps are lighting up?

**Door filter, water container or bottom filter indicator lamp on:**

- Door filter clean?
- Water container empty?
- Water container correctly positioned?
- Bottom filter clean and correctly positioned?

**Water droplets underneath the dryer:**

- Bottom filter correctly positioned?
- Any lint on the bottom filter seal removed?
- Any lint on the door seal removed?
- Water container positioned correctly?
- Dryer levelled?

**After-Sales Service**

**If, after carrying out the above checks the malfunction persists or appears again, turn the dryer off and call the After-Sales Service (refer to guarantee).**

**Please indicate:**

- The nature of the fault.
- The dryer type and model.
- The service code (the number after the word Service on the adhesive rating plate) on the lower side of the door opening.
- Your full address and phone number.

**SERVICE** 0000 000 00000

**Manufacturer:**

**Whirlpool Europe s.r.l.  
Viale Guido Borghi 27  
21025 Comerio (VA)  
Italy**

**EC Declaration of Conformity**

- This dryer has been designed, constructed and distributed in compliance with the safety requirements of EC Directives:
- 2006/95/EC Low Voltage Directive.
- 2004/108/EC Electromagnetic Compatibility Directive.



## DISPOSAL

- This appliance is marked according to the European directive 2002/96/EC on Waste Electrical and Electronic Equipment (WEEE).
- By ensuring this product is disposed of correctly, you will help prevent potential negative consequences for the environment and human health, which could otherwise be caused by inappropriate waste handling of this product.



### Packing

- The packing box may be fully recycled as confirmed by the recycling symbol.

### Disposing of packaging and old Dryer:

- The dryer is built from reusable materials. The dryer must be disposed of in compliance with local waste disposal regulations.
- Before disposing, cut off the power cable so that the dryer cannot be connected to the mains.
- The symbol  on the product or on the documents accompanying the product indicates that this appliance may not be treated as household waste. Instead it shall be handed over to the applicable collection point for the recycling of electrical and electronic equipment. Disposal must be carried out in accordance with local environmental regulations for waste disposal.
- For more detailed information about treatment, recovery and recycling of this product please contact your local city office, your household waste disposal service or the shop where you purchased the product.



