



Important information



Read and keep me

To enjoy the most out of your new steam generator, please read carefully.

For further information on usage and troubleshooting, please read the user manual.

1. Usage of right water type

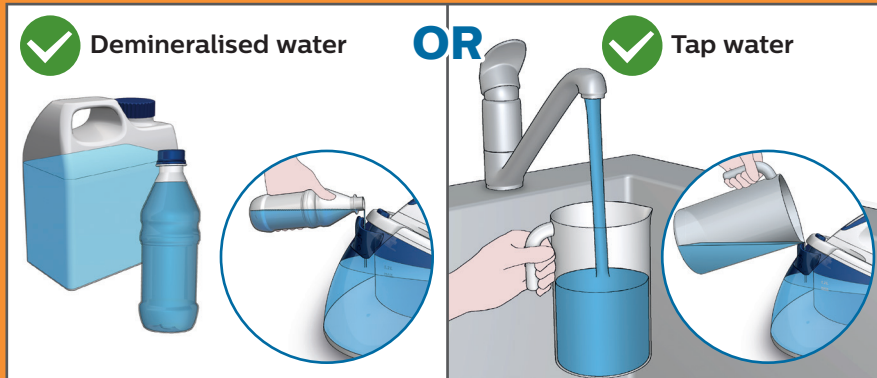

DO NOT USE:
Perfumed water, vinegar, descaling agents, ironing aids etc.

Recommended to use:
Demineralised water if you live in hard water area **OR** Tap water

2. Steam control

Steam will enhance your ironing performance.
Control the steam while ironing by using the steam trigger.



FOR FIRST USE:
Turn the temperature dial to ●● or higher and press the trigger continuously for up to 30 seconds for steam.

Press and hold the steam trigger for steam during ironing.

Any questions?

Don't go back to store, Philips is here to help. Contact us directly.

0207 949 0240 015245443

www.philips.com/support



3. Sound and light descaling reminder

With the new Smart Calc-Clean feature, you'll be reminded to descale your appliance when this is needed.



Perform descaling once the descaling light flashes and the appliance beeps.



The steam function will be disabled automatically if descaling is not performed.



With the **Calc-Clean container** provided, you can perform descaling easily and get clean steam.

4. Performing descaling

- ⚠️ Do not leave the appliance unattended during the descaling process.
- Hot water and steam will come out of the soleplate.
- Do not interrupt the descaling process (approx. 2 minutes).



Fill the water tank halfway and switch on the appliance.



Turn the temperature dial to **'CALC CLEAN'**.



Place the iron on the Calc-Clean container on an even, stable surface.



Press and hold the **'CALC CLEAN'** button for **2 seconds** until you hear short beeps.



Wait approximately **2 minutes**. You will hear short beeps.



When the descaling process is completed, the iron stops beeping.

