

# InstaRack™ LAN

*Specifications & Accessories*



**Emerson Network Power**, a division of Emerson, is a global company that provides a unique combination of industry expertise, technology, and resources to make the future of your business possible.

As a trusted industry leader in smart infrastructure technologies, the company provides innovative data center infrastructure management solutions that bridge the gap between IT and facility management, delivering efficiency and uncompromised availability regardless of capacity demands.



The wide product portfolio and integration capabilities enhanced by complete life cycle services support data centers, communication networks, healthcare and industrial facilities from project launch to performance optimization.

Emerson Network Power's areas of established expertise include solutions and services for AC and DC power, thermal management systems, infrastructure management & monitoring, integrated racks and enclosures, power switching and controls.

With presence in over 150 countries backed by the local service and support of over 3,200 certified professionals, Emerson Network Power is uniquely positioned to provide comprehensive solutions wherever you are located.

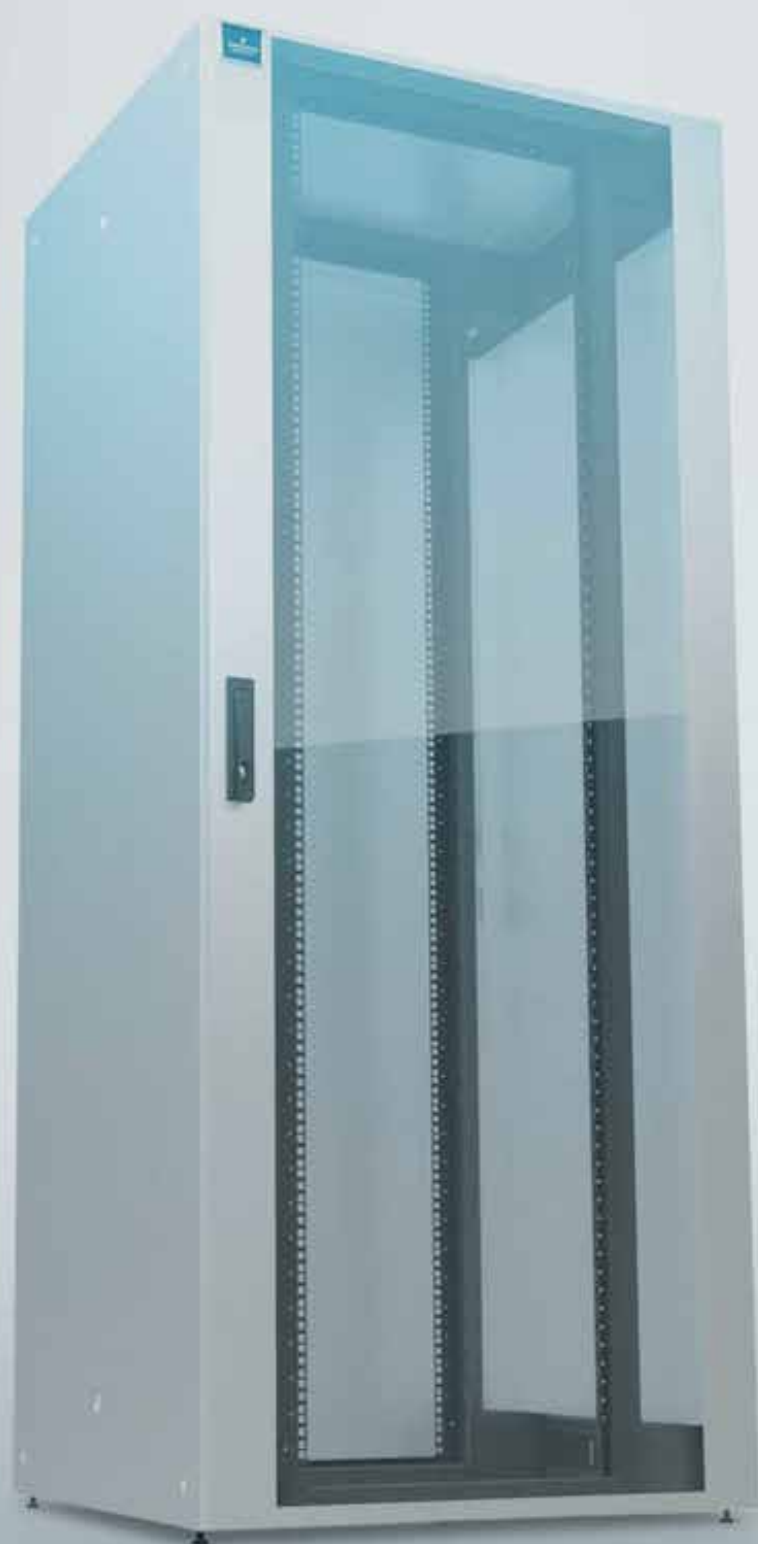

# InstaRack LAN

## InstaRack LAN

New modular rack enclosure optimized for fast assembly, easy installation and simplified cabling.

Emerson Network Power's new InstaRack LAN is designed to meet your LAN rack enclosure needs, offering all of the advantages of an easy to install and cost-effective modular solution. This modular rack enclosure offers stability with an 550 kg load carrying capacity. Furthermore, its intelligent design makes it easy to dismount and relocate wherever needed.

The standard InstaRack LAN network rack features:



### Intelligent Design

Intelligent Design - The preassembled InstaRack LAN is easily adaptable to buildings with restricted access, allowing for an easy disassembly in less than 30 minutes. Its intelligent design and modularity make it the perfect solution for different applications. InstaRack LAN can alternatively be shipped flat packed.



### Easy Access

Vertically separated side panels provide easy handling and fast, simple access to installed equipment.



### Flexible Cabling

Frameless architecture eliminates the need for cable threading allowing for optimal cable management.



### Tool-less Installation

No need for tools when installing Rack-PDU MPH2 and vertical side panels.





# Flexible Cabling and Fast Assembly

## ■ Flexible Cabling

The 800 mm wide universal top cover features cable entry points at the front, rear and sides for flexible and simplified cable management. Additional side openings allow cables to be easily routed between the 19" level and side panel. Brush strips for sealing the cable entry points are available as accessories.

## ■ Ventilation

The opening in the top cover used to install a CoolBlast® ventilation unit can be removed at any point. This allows a 3-fold thermostatically regulated or RPM-regulated CoolBlast to be installed. A fan guard can also be installed above the CoolBlast ventilation unit.

## ■ Fast Assembly

InstaRack LAN comprises only a small number of parts and identical screw connections, allowing fast and easy assembly and disassembly while providing a high degree of stability.

## ■ Load Rating

InstaRack LAN features a stable 19" frame that can securely carry loads up to 550 kg. A 12.5 mm grid in the front jumpering area and the insertion depth area allows 19" frames to be adapted to suit customers' requirements.

## ■ Easy Access

Side panels can be easily mounted and locked without using tools. Front and rear doors feature same closure types. Racks deeper than 1,000 mm have side panels formed by two parts ensuring optimum vertical access and minimum packing volume (800 mm flat pack maximum width).

## ■ Technical Details

- 19" LAN rack featuring IP20 protection class
- Steel construction design with removable side panels
- Glass door at the front and single steel sheet door at the back
- Special 19" profiles for mounting all standard 19" components
- Large floor clearance
- Cable entry via bottom and top
- Break-out openings for cable entry and fans are positioned in the top cover of the InstaRack Server.

## ■ Rack PDUs

All rack PDUs and MPH2™ in particular can be easily and securely integrated into the InstaRack LAN to create more space for fixtures.

## ■ Rack Base

InstaRack LAN features an open base, guaranteeing easy cable management. The base can be sealed using an additional cover. Cabling can be run either in front of or behind the 19" unit.

## ■ Leveling Feet, Castors

The LAN rack comes with leveling feet whichXh can also be fitted with castors (accessories).

## ■ Grounding

Grounding is available as an accessory and can be ordered if required. The grounding is installed safely in compliance with the applicable standard.

## ■ Delivery

- Two 19" frames with a hole grid
- Four depth braces
- Eight 19" brackets
- Two side panels for 800 mm depth and four two-piece side panels for 1,000 mm depth
- A glass door at the front
- A single steel sheet door at the back
- A top cover with perforations for cable entry and CoolBlast unit
- Assembly instructions enclosed

## ■ Accessories

- Brush strip for break-outs
- Base plate
- Castors
- Rack coupling chains
- C profile rails
- Base support for roof cabling.

## ■ Color

Visible surfaces, linings, 19" frame, depth braces and 19" brackets are painted in RAL7035 light gray.

## ■ Material/Finish

- Basic rack, depth braces, doors and side panels: powder-coated sheet metal
- 19" profiles, 2.0 mm sheet metal, coated.

## ■ Tests

Safety grounding in compliance with VDE 0100 T 540.

# InstaRack™ LAN Specifications

W	H	D	U	d1	d2	Gross Weight	Description	Part no.	UP
800	2000	800	42			132 kg	InstaRack LAN - flat packed	011500041006	1 unit
800	2000	1000	42			137 kg	InstaRack LAN - flat packed	011500041007	1 unit
800	2200	800	47			137 kg	InstaRack LAN - flat packed	011500041011	1 unit
800	2200	1000	47			145 kg	InstaRack LAN - flat packed	011500041012	1 unit
800	2000	800	42	78	544,5	115 kg	InstaRack LAN - assembled	011501041006	1 unit
800	2000	1000	42	78	744,5	120 kg	InstaRack LAN - assembled	011501041007	1 unit
600	2200	800	47	78	544,5	120 kg	InstaRack LAN - assembled	011501041011	1 unit
600	2200	100	47	78	744,5	128 kg	InstaRack LAN - assembled	011501041012	1 unit

d1) Jumpering space (standard depth, can be adjusted in 12,5 mm steps)

d2) Useful depth (standard depth, can be adjusted in 12,5 mm steps)

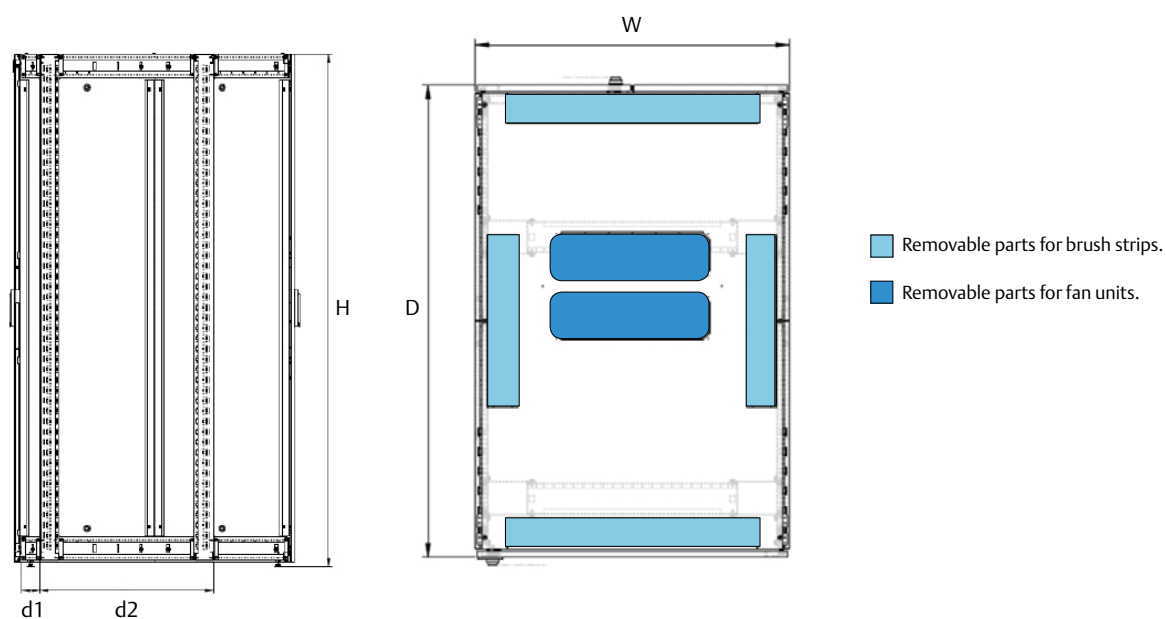



## InstaRack LAN Accessories

## Technical Specifications

### EARTHING SET FOR INSTARACK

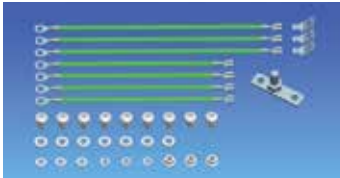

- For earthing top cover/ side panel and doors
- With central earthing bolt

- **Includes:**
  - Earthlines
  - washers
  - screws
  - earthing bolt
- **Supplied as:**
  - In sets
  - Set of 20 units

Description	Rack Type	Part No.	UP
Earthing set	InstaRack	<b>011500179001</b>	Set of 20 units

### CABLE ROUTING BOARD, 1U



- For orderly cable routing
- For safe and secure copper and fiberglass cable routing

- **Material/finish:**
  - Front panel, steel sheet 1.5 mm, powder-coated,  
Color code: 1 = RAL 7035, light grey  
Color code: 8 = RAL 7021, dark grey
- **Includes:**
  - 19" Front panel
  - Cable routers
- **Supplied as:**
  - Preassembled
  - Set of 20 units

Description	Rack Type	Part No. (X=insert color code)	UP
Cable routing board, 1U	InstaRack	<b>01150020X001</b>	Set of 20 units

### FIBER OPTIC CABLE ROUTING BOARD, 1U

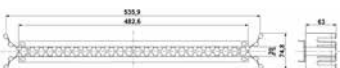

- For orderly cable routing
- For safe and secure fiberglass cable routing
- Optionally with cover panels to protect the cables as well as a labeling option

- **Material/finish:**
  - Steel sheet 1.5 mm, powder-coated, texture,  
Color code: 1 = RAL 7035, light grey  
Color code: 8 = RAL 7021, dark grey
- **Includes:**
  - Cable routing board
- **Supplied as:**
  - Set of 10 units

Description	Rack Type	Part No. (X=insert color code)	UP
Fiber optic cable routing board, 1U	InstaRack	<b>01150021X001</b>	Set of 10 units

\*Dimensions in mm: W = Width · H = Height · D = Depth · h = installation height · d = useful depth · L = Length · X = insert color code · HU = standardized height unit (1 HU = 44.45 mm).



## InstaRack LAN Accessories

## Technical Specifications

### COVER FOR CABLE ROUTING BOARD



- Cover for cable routing board

- **Includes:**
  - Cover
- **Finish:**
  - Powder-coated,  
Color code: 1 = RAL 7035, light grey  
Color code: 8 = RAL 7021, dark grey
- **Supplied as:**
  - Set of 10 units

Description	Rack Type	Part No. (X=insert color code)	UP
Cover for fiber optic cable routing board	InstaRack	<b>01150022X001</b>	Set of 10 units

### CABLE TRAY

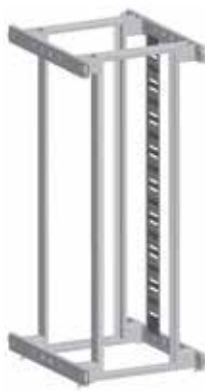

- For orderly cable management with in the rack
- Cable fixing possible using Velcro strips or cable ties

- **Material/finish:**
  - Steel sheet 1.5 mm,  
zinc passivated,  
powder-coated,  
Color code: 1 = RAL 7035, light grey  
Color code: 8 = RAL 7021, dark grey
- **Includes:**
  - Cable tray
  - Mounting material
- **Supplied as:**
  - Set of 10 units

* H	W	Rack Type	Part No. (X=insert color code)	UP
2000	150	InstaRack	<b>01150023X001</b>	Set of 10 units
2200	150	InstaRack	<b>01150023X002</b>	Set of 10 units

### 19" CABLE TRAY



- For orderly cable management in front of the 19" front
- Cable fixing possible using Velcro strips or cable ties
- Mounting on front panels possible

- **Material/finish:**
  - Sheet 1.5 mm, powder-coated,  
Color code: 1 = RAL 7035, light grey  
Color code: 8 = RAL 7021, dark grey
- **Includes:**
  - Cable tray
- **Supplied as:**
  - Set of 10 units

D	U	Rack Type	Part No. (X=insert color code)	UP
100	1	InstaRack	<b>01150024X001</b>	Set of 10 units

\*Dimensions in mm: W = Width · H = Height · D = Depth · h = installation height · d = useful depth · L = Length · X = insert color code · HU = standardized height unit (1 HU = 44.45 mm).

## InstaRack LAN Accessories

## Technical Specifications

### SQUARE JUMPERING BRACKET



- For orderly cable management
- Open version, not threading
- Mounted on the external side of the 19" extrusion
- All installation positions available
- For large cable volumes

- **Includes:**
  - 4 square jumpering brackets, mounting material
- **Finish:**
  - Zinc-passivated
- **Supplied as:**
  - Set of 20 units

Description	Rack Type	W	L	Part No.	UP
Square jumpering bracket	InstaRack	80	300	<b>011500259001</b>	Set of 20 units

### CABLE CANTILEVER



- For easy mounting in rack/on the shelf; Rapid connection to and from the shelf or rack with a spring clip
- Guarantees defined and kink-free cable management
- Minimum space requirement behind the pushed-in shelves: 40 mm

- **Includes:**
  - Cable cantilever girder, mounting material
- **Material/finish:**
  - Sheet steel 1.5 mm, zinc-passivated
- **Supplied as:**
  - Set of 10 units

Description	Rack Type	Part No.	UP
Cable cantilever	InstaRack	<b>011500270001</b>	Set of 10 units

### HOOK-IN CHASSIS RUNNER

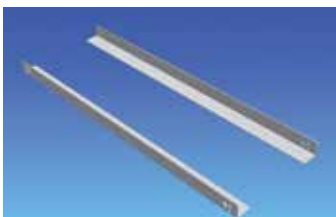

- For installation in 19" rack and enclosure
- Hang-ON for quick and easy mounting
- Can also be screwed for heavier load rating
- Can be screwed from the inside (use in rack suites)
- Height setting possible for various main section heights

- **Material/finish:**
  - Steel sheet 2.0 mm, zinc passivated, blue chrome-plated
- **Includes:**
  - Slot-in rails, mounting material
- **Supplied as:**
  - Set of 10 pairs

*d	L	Rack Type	Part No.	UP
544.5	515.5	InstaRack	<b>011500280001</b>	Set of 10 pairs
644.5	615.5	InstaRack	<b>011500280002</b>	Set of 10 pairs
744.5	715.5	InstaRack	<b>011500280003</b>	Set of 10 pairs

\*Dimensions in mm: W = Width · H = Height · D = Depth · h = installation height · d = useful depth · L = Length · X = insert color code · HU = standardized height unit (1 HU = 44.45 mm).

## InstaRack LAN Accessories

## Technical Specifications

### COOLBLAST® FAN UNIT FOR ROOF INSTALLATION THERMOSTAT CONTROLLED



- For forced rack cooling
- Suitable for installation at any time in the InstaRack top
- 115 VAC versions up on request
- Fan function (ON/OFF) thermostat controlled, setting from 0° to +60° C

- **Material:**
  - Housing: Sheet, high-grade steel grid
- **Finish:**
  - Zinc-passivated
- **Approvals:**
  - CE symbol in accordance with Low Voltage Directive, 73/23/EEC, EMC directive 89/366/EEC
- **Includes:**
  - 1 CoolBlast fan unit, 1 mains cable, 3 m with safety plug (230 VAC), mounting material, operating instructions
- **How supplied:**
  - Assembled, wired and tested
- **Supplied as:**
  - Set of 4 units

**Note:**  
Please also order specific mains cable.

Name	Model	Description	P(W)	V(m³/h)	ΔP(Pa)	P(Pa)	Part No.	UP
CoolBlast® 230V 3-piece	Thermostatet	207....253 VAC; 50/60 Hz	45	495	74	45.2	<b>011500451001</b>	Set of 4 units

### COOLBLAST® FAN UNIT FOR ROOF INSTALLATION SPEED CONTROLLED

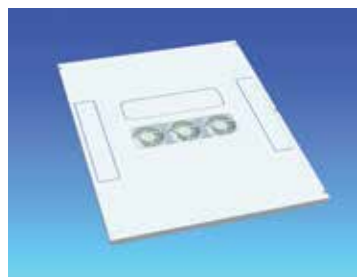

- For forced rack cooling
- Suitable for installation at any time in the InstaRack top
- DC version up on request (see CoolBlast fan units)
- Settable reference temperature (20°C to 55°C)
- Speed control: 30 to 100%, with sensor break 100 % rotation
- Individual fan monitoring
- Floating common alarm output for excess temperature alarm and fan failure
- Optical status display for, O.K., excess temperature, and fan failure
- Acoustic warning including reset button

- **Material:**
  - Housing: Sheet, high-grade steel grid
- **Finish:**
  - Zinc-passivated front panel, powder-coated, smooth in RAL 7035 light gray
- **Approvals:**
  - CE symbol in accordance with Low Voltage Directive, 73/23/EEC, EMC directive 89/366/EEC
- **Includes:**
  - 1 CoolBlast fan unit®, 1 sensor cable, 2 m (plug-in), 1 signal cable, 2 m (plug-in), 1 mains cable, 3 m with safety plug (230 VAC), mounting material, operating instructions
- **How supplied:**
  - Assembled, wired and tested
- **Supplied as:**
  - Set of 4 units

**Note:**  
Please also order specific mains cable.

Name	Model	Description	P(W)	V(m³/h)	ΔP(Pa)	P(Pa)	Part No.	UP
CoolBlast® 230V 3-piece	Controlled SP	100....253 VAC; 50/60 Hz	25	553	68	49.6	<b>011500461001</b>	Set of 4 units
CoolBlast® 230V 3-piece	Controlled HP	100....253 VAC; 50/60 Hzz	32	711	173	55.8	<b>011500471001</b>	Set of 4 units

\*Dimensions in mm: W = Width · H = Height · D = Depth · h = installation height · d = useful depth · L = Length · X = insert color code · HU = standardized height unit (1 HU = 44.45 mm).

## InstaRack LAN Accessories

## Technical Specifications

### COVER FOR ROOF MOUNT VENTILATION UNIT

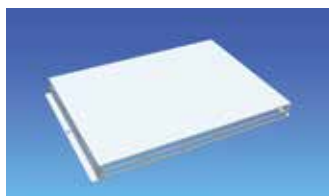

- Cover for CoolBlast® ventilation unit

- **Material/surface:**
  - Base plate, covers: 1.0 mm steel sheet
  - Part number end digit .1: powdercoated, RAL 7035, light grey, structure
- **Includes:**
  - 1 roof mount ventilation unit
  - Mounting material
- **How supplied:**
  - In sets

L	W	H	Rack Type	Part No.	UP
468	299	40	InstaRack	<b>011500181001</b>	Set of 1 unit

### INSTARACK BOTTOM COVER CLOSED



- For covering the base of the rack

- **Material/finish:**
  - Steel sheet 1 mm, zinc passivated
- **Includes:**
  - Bottom cover, mounting material
- **Supplied as:**
  - Set of 4 units

*W	d	Rack Type	Part No.	UP
600	544.5	InstaRack	<b>011500320001</b>	Set of 4 units
600	644.5	InstaRack	<b>011500320002</b>	Set of 4 units
600	744.5	InstaRack	<b>011500320003</b>	Set of 4 units
800	544.5	InstaRack	<b>011500320004</b>	Set of 4 units
800	644.5	InstaRack	<b>011500320005</b>	Set of 4 units
800	744.5	InstaRack	<b>011500320006</b>	Set of 4 units

\*Dimensions in mm: W = Width · H = Height · D = Depth · h = installation height · d = useful depth · L = Length · X = insert color code · HU = standardized height unit (1 HU = 44.45 mm).

## InstaRack LAN Accessories

## Technical Specifications

### INSTARACK PLINTH

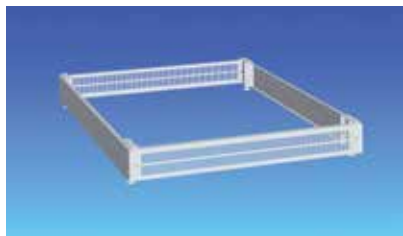

- Stationary
- Cable entry possible from all sides
- Front and rear panels with vent slots

- **Includes:**
  - 4 plinth corners
  - 2 plinth panels with slots
  - 2 plinth panels closed on the side
  - Mounting material
- **Material/finish:**
  - Steel sheet, powder-coated texture,
  - Color code: 1 = RAL 7035, light grey
  - Color code: 8 = RAL 7021, dark-grey
- **Load rating:**
  - 4000 N static
- **Supplied as:**
  - Set of 4 units

W	H	D	Rack Type	Part No. (X=insert color code)	UP
800	100	800	InstaRack	<b>01150040X005</b>	Set of 4 units
800	100	1000	InstaRack	<b>01150040X006</b>	Set of 4 units
800	100	1100	InstaRack	<b>01150040X007</b>	Set of 4 units
800	100	1200	InstaRack	<b>01150040X008</b>	Set of 4 units

### BRUSH STRIP

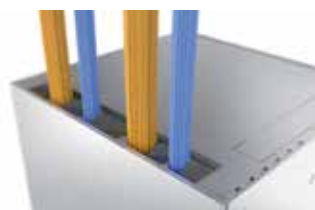

- Brush strip for top covers for flexible cable-entry
- **Supplied:**
    - Sets of 20 Units
  - **Includes:**
    - 2 brush strips

*L	Rack Type	Part No.	UP
436	InstaRack	<b>011500299001</b>	Set of 20 units
636	InstaRack	<b>011500299002</b>	Set of 20 units

\*Dimensions in mm: W = Width · H = Height · D = Depth · h = installation height · d = useful depth · L = Length · X = insert color code · HU = standardized height unit (1 HU = 44.45 mm).

## InstaRack LAN Accessories

## Technical Specifications

### INSTARACK SHEETTRACS M6X13



- **Standard inclusion:**
  - 50 x SHEETtracs M6x13
- **Delivery:**
  - Set of 10 units

Rack Type	Part No.	UP
InstaRack	011500169001	Set of 10 units

### MOUNTING SET CAGE NUTS



- Front panel mounting set; mounting holes, M5/plate, 2.5 mm
- For securing 19" front panels and 19" components

- **Standard inclusion:**
  - **Type 1:**
    - 50 x cage nuts M5 /plate, 2.5 mm
    - 50 x oval-head screws, Z-form, M5 x 16
  - **Type 2:**
    - 50 x cage nuts M5 /plate, 2.5 mm
    - 50 x countersunk screws, M5 x 16
    - 50 x rosettes
- **Delivery:**
  - In sets

Description	Part No.	UP
Type 1: Z-form screw	050413379	1 set
Type 2: screw + rosette	050413429	1 set

### MOUNTING ADAPTER



- For mounting standard Knürr components (storage shelves, drawers, chassis rails, keyboard tray, etc.) in 19" installation space.

- **Material/finish:**
  - Steel sheet, zinc-passivated 2.5 mm.
- **Standard inclusion:**
  - 4 x adapters

Description	Part No.	UP
Mounting adapter for 19" server extrusion	011476409	Set of 4 units

\*Dimensions in mm: W = Width · H = Height · D = Depth · h = installation height · d = useful depth · L = Length · X = insert color code · HU = standardized height unit (1 HU = 44.45 mm).

## InstaRack LAN Accessories

## Technical Specifications

### 19" RETRACTABLE SHELF

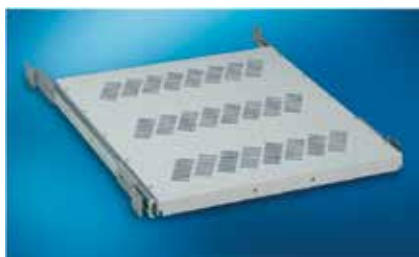

- Integrated mounting holes, front and rear for handle or hinged cable routing
  - Perforated to optimize air supply
  - Locks in retracted position (friction lock); easy conversion to form lock with stop spring.
  - Quick separator for tool-less removal and decoupling of shelf board
- Material / Finish**
- Sheet steel 1.0 mm, electroplated zinc, powder-coated texture
- **Color:**
- Color code: 1 = RAL 7035, light grey
  - Color code: 8 = RAL 7021, dark-grey

- **Load rating:**  
500 N static per item
- **Standard inclusion:**
- 1 x pair of telescopic slides
  - 1 x shelf board
  - 1 x extension board (from L = 600)
  - 1 x Mounting kit
- **Delivery:**
- In sets

**Note:**  
Order requisite mounting adapter:  
P/N 011476409.

Usefull depth	For Rack depth:	WxL	Retractable	Part No. (X=insert color code)	UP
544,5	800 mm	430x360 mm	Partially	<b>01102042X001</b>	Set of 1 unit
644,5	1000 mm	430x560 mm	Partially	<b>01102043X001</b>	Set of 1 unit
744,5	1100-1200 mm	430x560 mm	Partially	<b>01102043X001</b>	Set of 1 unit
744,5	1200 mm	430x560 mm	Fully	<b>01102041X001</b>	Set of 1 unit

### 19" SHELF FIXED

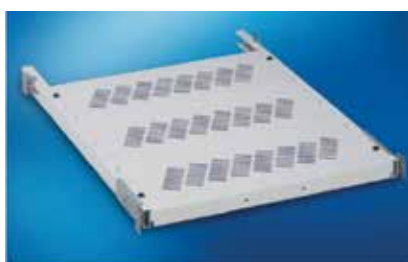

- Integrated mounting holes; front and rear for handle or hinged cable routing
- Perforated to optimize air supply

- **Material / Finish:**
- Sheet steel 1.0 mm, electroplated zinc, powder-coated texture
- **Color:**
- Color code: 1 = RAL 7035, light grey
  - Color code: 8 = RAL 7021, dark-grey
- **Load rating:**
- 500 N static per item
- **Standard inclusion:**
- 2 x mounting rails, incl. mounting bracket
  - 1 x shelf board
  - 1 x extension board (from L = 600)
  - 1 x Mounting kit
- **Delivery:**
- In sets

**Note:**  
Please order requisite mounting adapter:  
P/N 011476409.

Usefull depth	For Rack depth:	WxL	Part No. (X=insert color code)	UP
544,5	800 mm	430x300 mm	<b>01102002X</b>	Set of 1 unit
544,5; 644,5	1000 mm	430x500 mm	<b>01102003X</b>	Set of 1 unit
644,5; 744,5	1100-1200 mm	430x600 mm	<b>01102004X</b>	Set of 1 unit
744,5	1200 mm	430x600 mm	<b>01102005X</b>	Set of 1 unit

\*Dimensions in mm: W = Width · H = Height · D = Depth · h = installation height · d = useful depth · L = Length · X = insert color code · HU = standardized height unit (1 HU = 44.45 mm).

## InstaRack LAN Accessories

## Technical Specifications

### MULTIFUNCTIONAL BRACE



- For cable management with cable ties
- Provides universal securing options
- Holes for mounting caged nuts
- Installation between the 19" Frame front and rear side

- **Material:**
  - Sheet steel, 1.5 mm
- **Finish:**
  - Zinc-passivated
- **Material:**
  - Sheet steel, 1.5 mm
- **Standard inclusion:**
  - Set of 4 x multifunctional braces
- **Delivery:**
  - Set of 10 units

d	Rack Type	Part No.	UP
544.5	InstaRack	<b>011500349001</b>	Set of 10 units
644.5	InstaRack	<b>011500349002</b>	Set of 10 units
744.5	InstaRack	<b>011500349003</b>	Set of 10 units

### INSTARACK LOCKING SET FOR SIDE OR REAR PANEL



- For installation in the side or rear panel
- For protection against unauthorized access
- Can be retrofitted

- **Standard inclusion:**
  - 1 x lockable fastener
  - 2 x keys
- **Delivery:**
  - Set of 2 units (for 1 side panel)

Rack Type	Part No.	UP
InstaRack	<b>011500158001</b>	Set of 2 units



## InstaRack LAN Accessories

## Technical Specifications

### INSTARACK CABLE MANAGER



- Left and right versions (2 cable managers) supplied
- Ideal for orderly guiding patch cables (copper conductors and optical fibers)
- Retrofitting possible
- Made for complete hot/cold partitioning
- Cable fingers easy to mount (clip on)
- Cables can be fed through the rear of the rack thanks to rubber grommets and slots
- For mount depths of 145 mm and above

#### ■ Material/surface:

- Cable duct: steel sheet; 2.0 mm
- Part number end digit .8:
- powder-coated RAL 7021, black grey, structure
- Cable fingers: polyamide (UL 94 V-0), black

#### ■ Includes:

- 1 left cable duct
- 1 right cable duct
- 4 rows with cable fingers
- 4 rubber grommets
- Mounting material

#### ■ How supplied:

- In pairs (cable fingers included loose)
- Set of 4 pairs

* W <sub>rack</sub>	H <sub>rack</sub>	Mount Depth	Rack Type	Part No.	UP
800	2000	145 and above	InstaRack	<b>011500358001</b>	Set of 4 pairs
800	2200	145 and above	InstaRack	<b>011500358002</b>	Set of 4 pairs

### C-RAIL



- For securing cables using bolt clamps or cable management strips
- Space-saving installation with in the InstaRack

#### ■ Material/surface:

- Steel sheet 1.5 mm, galvanized

#### ■ Includes:

- 4 C-rails
- Mounting material

#### ■ How supplied:

- In sets
- Set of 10 units

#### Note:

Please order bolt clamps, cable management strips or threaded plate at the same time.

L	Rack Type	Insertion Depth	Part No.	UP
380	InstaRack	544.5	<b>011500379001</b>	Set of 10 units
480	InstaRack	644.5	<b>011500379002</b>	Set of 10 units
580	InstaRack	744.5	<b>011500379003</b>	Set of 10 units

### BOLT CLAMP

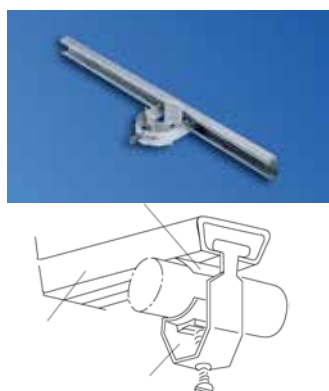

- To release tension and guide individual cables and lines
- Clamping range: 12-52 mm

#### ■ Material/surface:

- Steel/plastic

#### ■ Includes:

- 25 bolt clampst
- 25 counter troughs

#### ■ How supplied:

- In sets
- Set of 10 units

Clamping Range	Rack Type	Part No.	UP
12-16 mm	InstaRack	<b>011500399001</b>	Set of 10 units
22-28 mm	InstaRack	<b>011500399002</b>	Set of 10 units
46-52 mm	InstaRack	<b>011500399003</b>	Set of 10 units

\*Dimensions in mm: W = Width · H = Height · D = Depth · h = installation height · d = useful depth · L = Length · X = insert color code · HU = standardized height unit (1 HU = 44.45 mm).

## InstaRack LAN Accessories

## Technical Specifications

### INSTARACK AIR PARTITIONING



- Quick and easy retrofitting of hot/cold area separation within the rack
- Panels on sides each have two slots for cable feed-through
- 3 x 1 HU slots, covered with panels
- Screwed on the sides of the 19" profiles
- Sealing with lateral parts or with same plane in the cabinet placed side-by-side using foam elements; depth can thus be slightly adjusted

- **Material/surface:**
  - Steel sheet
  - Diagonal struts: powder-coated RAL 7021 black grey, structure
- **Includes:**
  - 2 lateral panels
  - 1 panel on base.
  - 1 foam material on base
  - 2 vertical foam materials
  - Mounting material
- **How supplied:**
  - In sets
  - Set of 4 pairs

*W	H	Version	Rack Type	Part No.	UP
800	2000	3 x 1 HU slot	InstaRack	<b>011500428001</b>	Set of 4 units
800	2200	3 x 1 HU slot	InstaRack	<b>011500428002</b>	Set of 4 units

### CLOSED INSTARACK AIR PARTITIONING



- Quick and easy retrofitting of hot/cold area separation with in the rack
- Closed lateral panels
- Screwed on the sides of the 19" profiles
- Sealed with lateral parts or with same plane in the cabinet and placed side-by-side using foam elements; depth can thus be slightly adjusted

- **Material/surface:**
  - Steel sheet
  - Diagonal struts: powder-coated RAL 7021 black grey, structure

- **Supply schedule:**
  - 2 lateral panels (B800 only)
  - 2 vertical foam materials.
  - 1 panel on base (for B800 only)
  - 1 foam material on base.
  - Mounting material.
- **How supplied:**
  - In sets
  - Set of 4 units

*W <sub>rack</sub>	H <sub>rack</sub>	Version	Rack Type	Part No.	UP
600	2000	Closed	InstaRack	<b>011500528001</b>	Set of 4 units
800	2000	Closed	InstaRack	<b>011500528002</b>	Set of 4 units
600	2000	Closed	InstaRack	<b>011500528003</b>	Set of 4 units
800	2200	Closed	InstaRack	<b>011500528004</b>	Set of 4 units

### INSTARACK BASE SUPPORT FOR ROOF CABLING

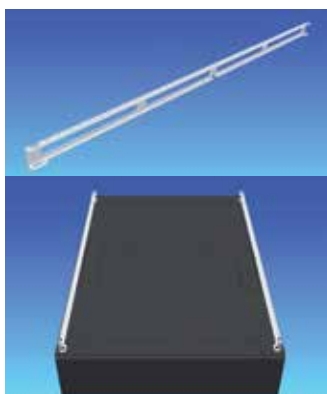

- Quick and easy to mount
- Compatible with InstaRack
- With screw holes for fixing angular brackets, transition and end parts

- **Material/surface:**
  - Steel sheet 2.0 mm
  - Part number end digit .8: powdercoated, RAL 7021 black grey

- **Includes:**
  - 2 base supports
  - Mounting material
- **How supplied:**
  - In sets
  - Set of 10 units

*H	D	Rack Type	Part No.	UP
44	800	InstaRack	<b>011500438001</b>	Set of 10 units
44	1000	InstaRack	<b>011500438003</b>	Set of 10 units
44	1100	InstaRack	<b>011500438004</b>	Set of 10 units
44	1200	InstaRack	<b>011500438005</b>	Set of 10 units

\*Dimensions in mm: W = Width · H = Height · D = Depth · h = installation height · d = useful depth · L = Length · X = insert color code · HU = standardized height unit (1 HU = 44.45 mm).

## InstaRack LAN Accessories

## Technical Specifications

### INSTARACK SIDE-BY-SIDE ROW CONNECTOR

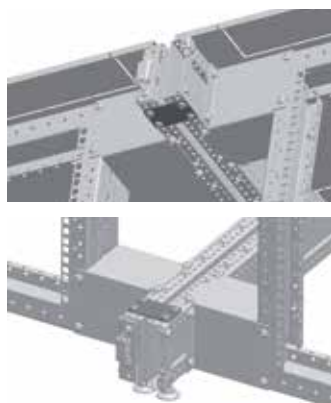

- For a mechanical and stable connection between InstaRack rows
- **Material/surface:**
  - Steel sheet, 2 mm galvanized
- **Installation positions:**
  - 1. On the base of the upper depth structure
  - 2. On the top of the lower depth structure

- **Includes:**
  - 4 side-by-side row connectors
  - Mounting material
- **How supplied:**
  - In sets
  - Set of 10 units

**Note:**  
Suitable only for cabinets without partitioned walls.

Rack Type	Part No.	UP
InstaRack	<b>011500268001</b>	Set of 10 units

### INSTARACK CROSS-BEAM WITH CASTERS



- On wheels; also includes two caster receptors with casters and integrated cable insertion

- **Material/surface:**
  - Steel sheet
  - Powder-coated, structure RAL 7021
- **Includes:**
  - 1 set of cross-beam with casters
  - Mounting material
- **How supplied:**
  - In sets
  - Set of 4 units

*W	Rack Type	Part No.	UP
600	InstaRack	<b>011500508001</b>	Set of 4 units
800	InstaRack	<b>011500508002</b>	Set of 4 units

### INSTARACK AIR PARTITIONING FOR CABLE MANAGER



- Compatible with InstaRack
- Separates hot/cold areas in side the cabinet
- Avoids hot spots (air recirculation).
- **Material/surface:**
  - Panel: 1.0 mm steel sheet
  - Part number end digit .8: powdercoated, RAL 7021, black grey, structure
  - Filling foam: polyurethane ether foam (UL94 HF-1)

- **Includes:**
  - 1 panel on base
  - 6 covers for cable feed-through
  - 2 foam materials, vertical
  - Mounting material
- **How supplied:**
  - In sets
  - Set of 4 units

W	HU	Rack Type	Part No.	UP
800	42	InstaRack	<b>011500368001</b>	Set of 4 units
800	47	InstaRack	<b>011500368002</b>	Set of 4 units

\*Dimensions in mm: W = Width · H = Height · D = Depth · h = installation height · d = useful depth · L = Length · X = insert color code · HU = standardized height unit (1 HU = 44.45 mm).

## Ensuring The High Availability Of Mission-Critical Data And Applications.

### About Emerson Network Power

Emerson Network Power, a business of Emerson (NYSE:EMR), is the world's leading provider of critical infrastructure technologies and life cycle services for information and communications technology systems. With an expansive portfolio of intelligent, rapidly deployable hardware and software solutions for power, thermal and infrastructure management, Emerson Network Power enables efficient, highly-available networks.

Learn more at [www.EmersonNetworkPower.eu](http://www.EmersonNetworkPower.eu)

While every precaution has been taken to ensure accuracy and completeness herein, Emerson assumes no responsibility, and disclaims all liability, for damages resulting from use of this information or for any errors or omissions. Specifications subject to change without notice.

MKA4L0UKIRLDT Rev.1-08/2015

**EmersonNetworkPower.eu**

### Locations

#### Emerson Network Power

Global Headquarters  
1050 Dearborn Drive  
P.O. Box 29186  
Columbus, OH 43229, USA  
Tel: +1 614 8880246

#### Emerson Network Power Europe Middle East And Africa

Mariakirchener Strasse 38  
94424 Arnstorf, Germany  
Tel: +49 8723 27 0  
Tel: +49 8723 27 154  
[knuerr@emerson.com](mailto:knuerr@emerson.com)

#### Emerson Network Power United Kingdom

George Curl Way  
Southampton  
SO18 2RY, UK  
Tel: +44 (0)23 8061 0311  
Fax: +44(0)23 8061 0852

Globe Park  
Fourth Avenue  
Marlow Bucks, SL7 1YG  
Tel: +44 1628 403200  
Fax: +44 1628 403203  
[UK.Enquiries@Emerson.com](mailto:UK.Enquiries@Emerson.com)

**Follow us on Social Media**



Emerson, Consider it Solved, Emerson Network Power and the Emerson Network Power logo are trademarks or service marks of Emerson Electric Co. or its affiliated companies. ©2015 Emerson Electric Co. All rights reserved.

**EMERSON. CONSIDER IT SOLVED.™**