

**Jabra®**

# JABRA STORM

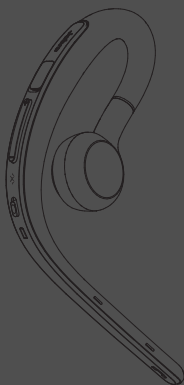

User Manual

[jabra.com/storm](http://jabra.com/storm)

A BRAND BY

**GN Netcom**

---

© 2014 GN Netcom A/S / GN Netcom US, Inc. All rights reserved. Jabra® is a registered trademark of GN Netcom A/S. All other trademarks included herein are the property of their respective owners. The Bluetooth® word mark and logos are owned by the Bluetooth SIG, Inc. and any use of such marks by GN Netcom A/S is under license.

---

Made in China  
MODEL: BTE7  
FCC ID: BCE-BTE7  
IC: 2386C-BTE7



**EAC**  **Bluetooth®**

---

**Declaration of Conformity** can be found on  
[www.jabra.com/CP/US/declarations-of-conformity](http://www.jabra.com/CP/US/declarations-of-conformity)

# CONTENTS

1. WELCOME .....	4
2. HEADSET OVERVIEW .....	5
3. HOW TO WEAR.....	6
4. HOW TO CHARGE THE BATTERY .....	7
4.1 BATTERY STATUS	
5. HOW TO CONNECT .....	9
5.1 CONNECT TO MOBILE DEVICE	
5.2 CONNECT TO MOBILE DEVICE (NFC)	
6. HOW TO USE .....	11
6.1 MULTIPLE CALL HANDLING	
6.2 HEADSET VOICE CONTROLS	
6.3 HEADSET VOICE GUIDANCE	
6.4 PHONE VOICE COMMANDS (SIRI®, GOOGLE NOW™, CORTANA™)	
6.5 HOW TO RESET THE HEADSET	
7. SOFTWARE .....	16
7.1 JABRA ASSIST	
8. SUPPORT .....	17
8.1 FAQ	
8.2 HOW TO CARE FOR YOUR HEADSET	
9. TECHNICAL SPECIFICATIONS .....	18

# 1. WELCOME

Thank you for using the Jabra Storm. We hope you will enjoy it!

## **JABRA STORM FEATURES**

- Voice guidance & control
- Wind Noise Blackout
- Long talk time - Up to 9 hours
- NFC for easy pairing

## 2. HEADSET OVERVIEW

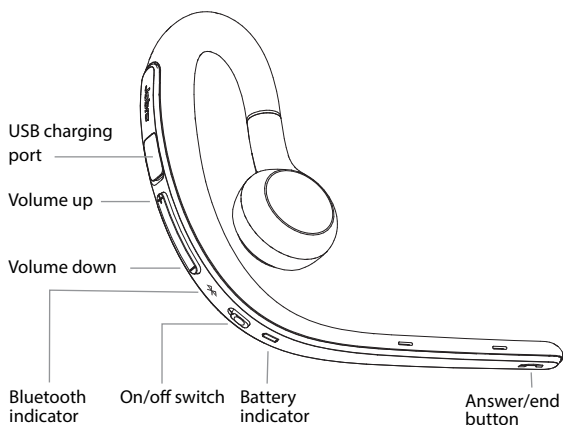

### 3. HOW TO WEAR

The headset can be worn on the left or right ear. Simply rotate the speaker and twist the eargel to fit your ear.

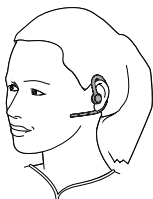
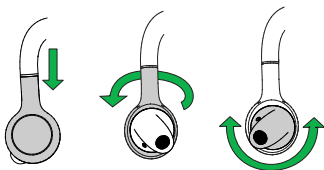

## 4. HOW TO CHARGE THE BATTERY

Pull open the charging cover to expose the USB charging port.

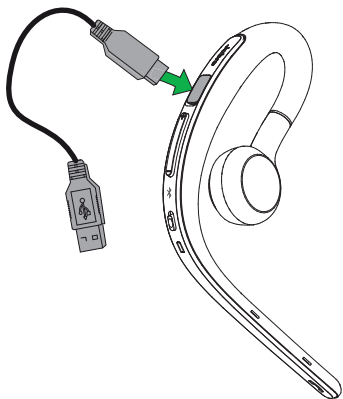

**NOTE:** For safety reasons, it is recommended not to use the headset while it is charging.

It takes approx. 2 hours to fully charge the battery.

## 4.1 BATTERY STATUS

---

To see the headset battery status, tap the **Answer/end** button, when not on a call.

### HEADSET BATTERY STATUS



20-100% battery



0-20% battery



# 5. HOW TO CONNECT

## 5.1 CONNECT TO MOBILE DEVICE

---

1. Turn the headset on (set the **On/off** switch to the On position).
2. Press and hold (3 secs) the **Answer/end** button until the Bluetooth indicator flashes blue. Pairing mode will be announced in the headset.
3. Wear the headset and follow the voice-guided pairing instructions to pair to your Bluetooth device.

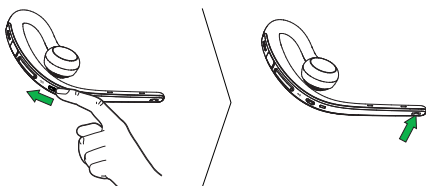

## 5.2 CONNECT TO MOBILE DEVICE (NFC)

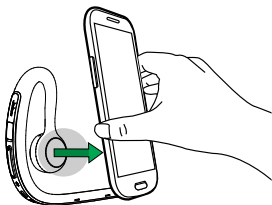

---

1. Ensure that NFC is enabled on your mobile device.
2. Slowly slide the **NFC zone** of the headset against the **NFC zone** of the mobile device until a connection is confirmed.

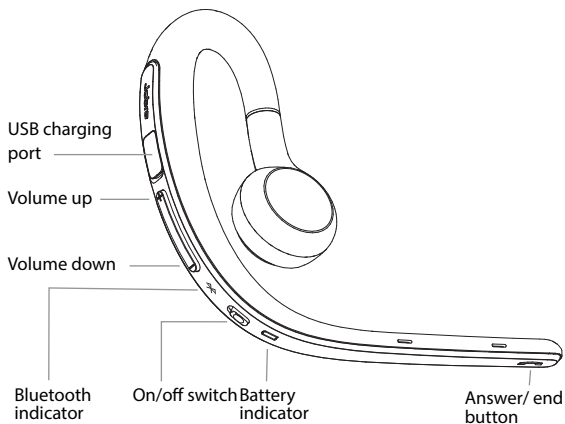

## 6. HOW TO USE



FUNCTION	ACTION
 <p data-bbox="260 244 341 277">On/off</p>	<p data-bbox="539 244 826 277">Slide the <b>On/off</b> switch</p>
	<p data-bbox="539 351 888 459">Tap the <b>Answer/End</b> button, or say 'Yes' (when voice commands are enabled)</p>
	<p data-bbox="539 505 881 538">Tap the <b>Answer/End</b> button</p>
 <p data-bbox="260 640 387 674">Reject call</p>	<p data-bbox="539 583 881 731">Double-tap the <b>Answer/End</b> button, or say 'No' (when voice commands are enabled)</p>
	<p data-bbox="539 764 888 839">Double-tap the <b>Answer/End</b> button when not on a call</p>
	<p data-bbox="539 893 868 1001">Press and hold (1 sec) the <b>Answer/End</b> button, when not on a call</p>
<p data-bbox="260 1078 446 1153">Adjust speaker volume</p>	<p data-bbox="539 1078 809 1153">Tap the <b>Volume up</b> or <b>Volume down</b> button</p>
 <p data-bbox="260 1252 433 1285">Mute/unmute</p>	<p data-bbox="539 1219 888 1326">Tap both the <b>Volume up</b> or <b>Volume down</b> button at the same time</p>
<p data-bbox="260 1400 443 1508">Enable/disable headset voice controls</p>	<p data-bbox="539 1364 873 1541">Press and hold (1 sec) both the <b>Volume down</b> and the <b>Answer/End</b> button at the same time, when not on a call</p>

## 6.1 MULTIPLE CALL HANDLING

---

The headset can accept and handle multiple calls simultaneously.

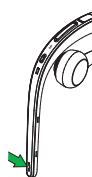
	<b>FUNCTION</b>	<b>ACTION</b>
	End current call and answer incoming call	Tap the <b>Answer/End</b> button
	Switch between held call and active call	Press and hold (2 secs) the <b>Answer/End</b> button
	Put current call on hold and answer incoming call	Press and hold (2 secs) the <b>Answer/End</b> button
	Reject incoming call	Double-tap the <b>Answer/End</b> button

## 6.2 HEADSET VOICE CONTROLS

---

Headset voice controls are commands you can speak to control the headset.

WHAT YOU CAN SAY	WHAT IT MEANS
Yes	Answer incoming call
No	Reject incoming call

Headset voice controls are only in English.

## 6.3 HEADSET VOICE GUIDANCE

---

Headset voice guidance are voice announcements intended to guide you or give headset status updates (e.g. connection and battery status).

Headset voice guidance are supplied in the following four languages: English (US), Chinese (Mandarin), Japanese, and French. Please note that it is not possible to change the language.

## 6.4 PHONE VOICE COMMANDS (SIRI®, GOOGLE NOW™, CORTANA™)

---

Phone voice commands enable you to speak to SiRi®/Cortana™/Google Now™ on your mobile phone using your headset. For more information on using SiRi®, Google Now™, or Cortana™, please refer to your phone's user manual.

---



Activate SiRi®/Google Now™/  
Cortana™(phone dependent)

Gently double-  
tap the headset  
when not on  
a call

---

## 6.5 HOW TO RESET THE HEADSET

---

Resetting the headset will clear the list of connected devices.

To reset the headset: Press and hold (10 secs) both the **Answer/end** button and the **Volume up** button until the Bluetooth indicator flashes purple, and then release the buttons.

The headset will reset, and you will need to reconnect to your mobile devices.

# 7. SOFTWARE

## 7.1 JABRA ASSIST

---

Jabra Assist is a smartphone app that enables GPS tracking of the headset, pairing assistance, and headset battery status.

**Download the latest version**

- Android download - Google Play
- iOS download - App Store



# 8. SUPPORT

## 8.1 FAQ

---

View the comprehensive FAQ on [jabra.com/storm](http://jabra.com/storm)

## 8.2 HOW TO CARE FOR YOUR HEADSET

---

- Always store the headset with the power off and safely protected.
- Avoid storage at extreme temperatures (above 70°C/158°F or below -20°C/-4°F). This can shorten battery life and may affect headset operation.
- Do not expose the headset to rain or other liquids.

## 9. TECHNICAL SPECIFICATIONS

JABRA STORM HEADSET	SPECIFICATION
Weight:	7.9g
Dimensions:	H 61.82 mm x W 83.71 mm x D 19.5 mm
Microphones:	Omni-directional microphone
Speaker:	Dynamic speaker
Operating range:	30m (98ft)
Bluetooth version:	4.0
Paired devices:	Up to 8, connected to two at the same time (MultiUse™)
Supported Bluetooth profiles:	A2DP (v1.2), Hands Free Profile (v1.6), Headset profile (v1.2)
Talk time:	Up to 9 hours
Standby time:	Up to 10 days
Operating temperature:	-10°C to 55°C (14°F to 131°F)
Storage temperature:	-20° C to 70°C (-4°F to 158°F)
Pairing passkey or PIN:	0000

