

始终如一地为您提供帮助

在以下网站上注册产品并获得支持

www.philips.com/welcome



HTB5520/93

HTB5550/93

HTB5580/93

快速操作指南



ZH-CN 使用产品前，请阅读所有随附的安全信息

EN Before using your product, read all accompanying safety information



HTB5520

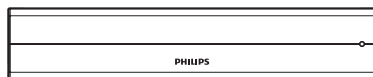

无线接收器

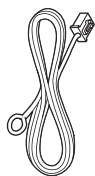
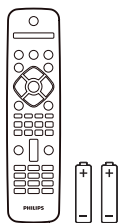

FM 天线



HIDM 线



麦克风转接头

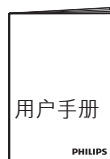

用户手册

PHILIPS

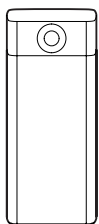
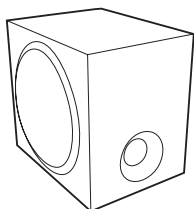

2x

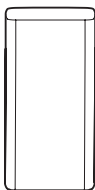

2x

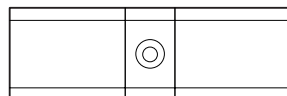

HTB5550

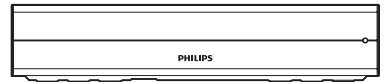
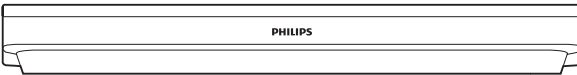

无线接收器

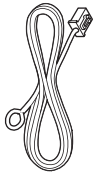
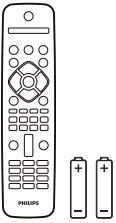

FM 天线



HIDM 线



麦克风转接头



用户手册

PHILIPS

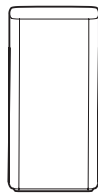
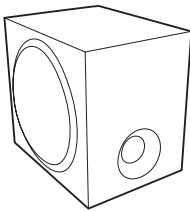

2x



2x

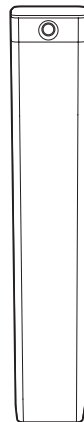

2x



8x



2x

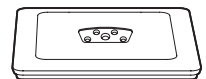

2x

HTB5580

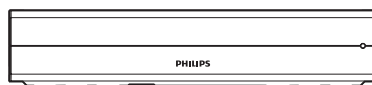

无线接收器

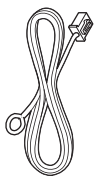
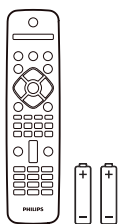

FM 天线



HIDM 线



麦克风转接头

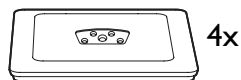
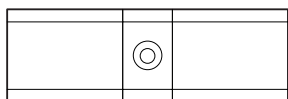
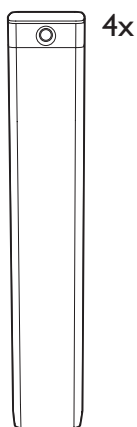
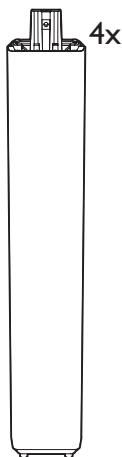
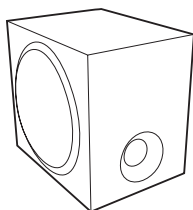
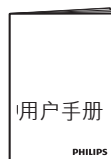

1

ZH-CN 桌架和扬声器
只适用于 HTB5550 和 HTB5580
的型号

EN Stand mount the speakers
Applied to HTB5550 and HTB5580 only

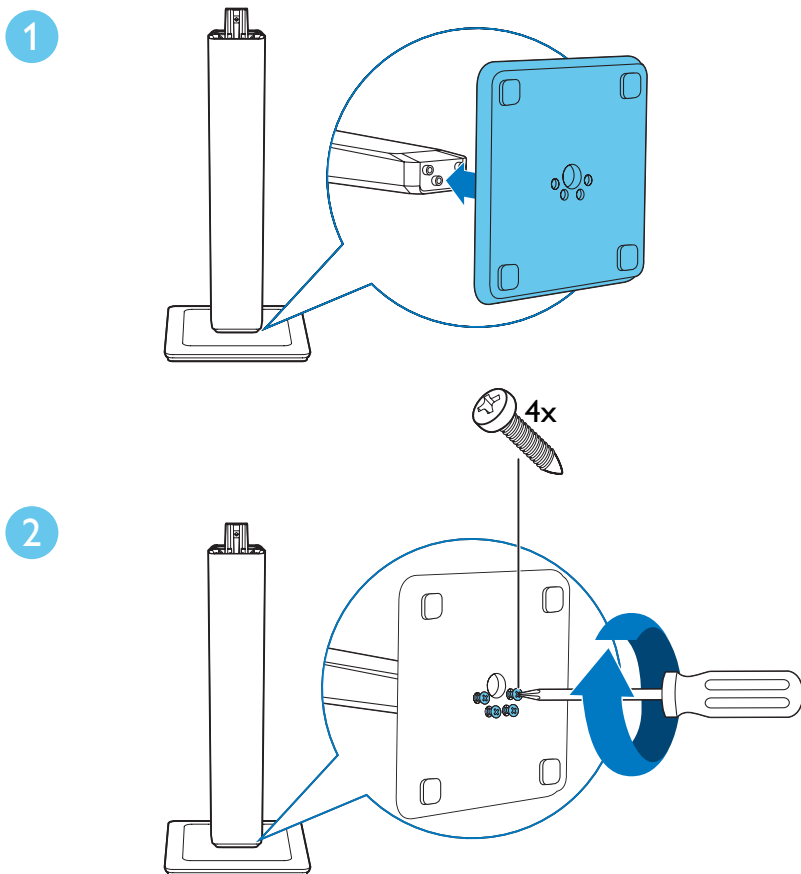

3

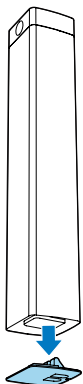

4

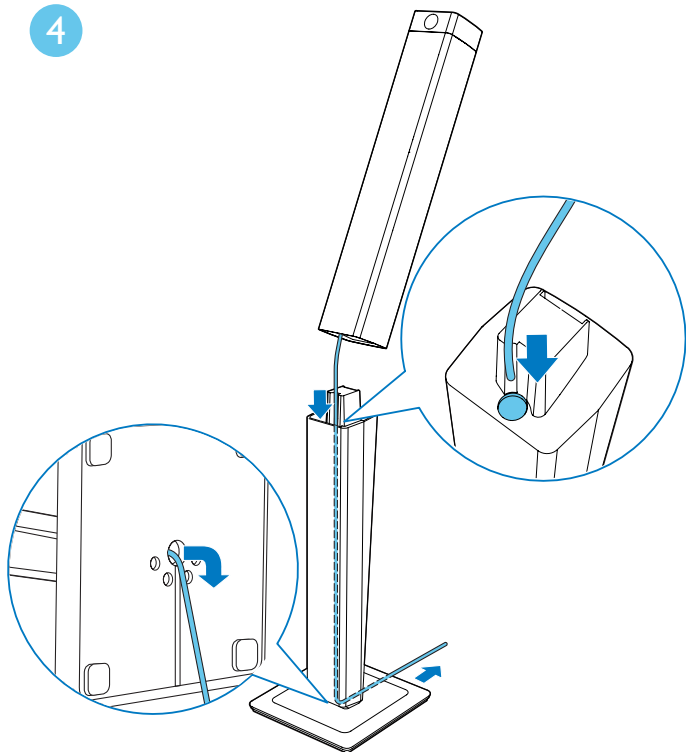

5

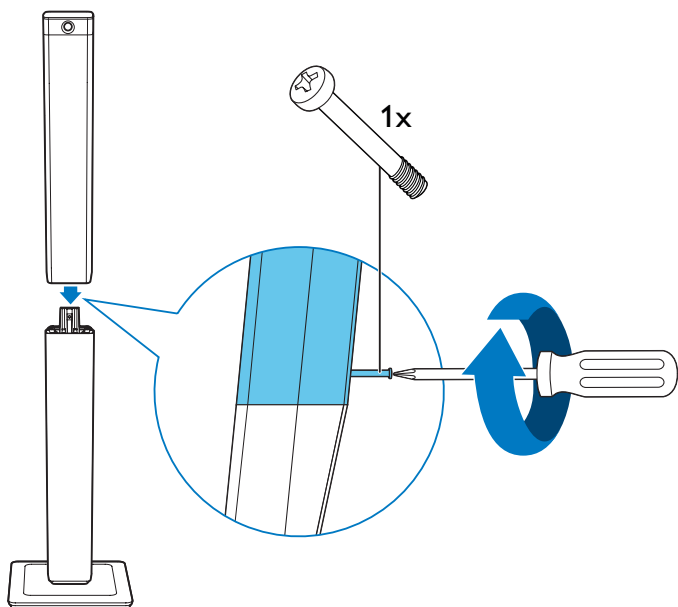

2

ZH-CN 连接和放置家庭影院

EN Connect and position the home theater

HTB5520

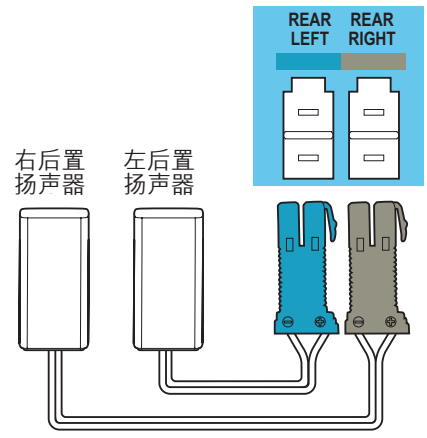
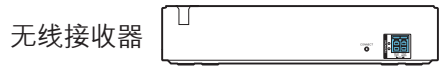
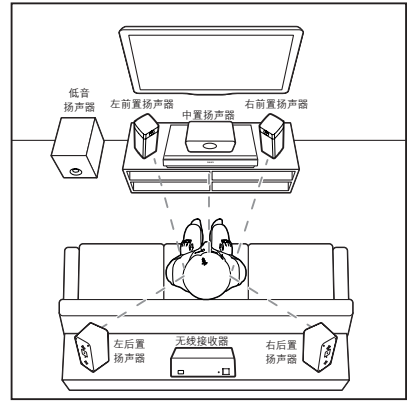
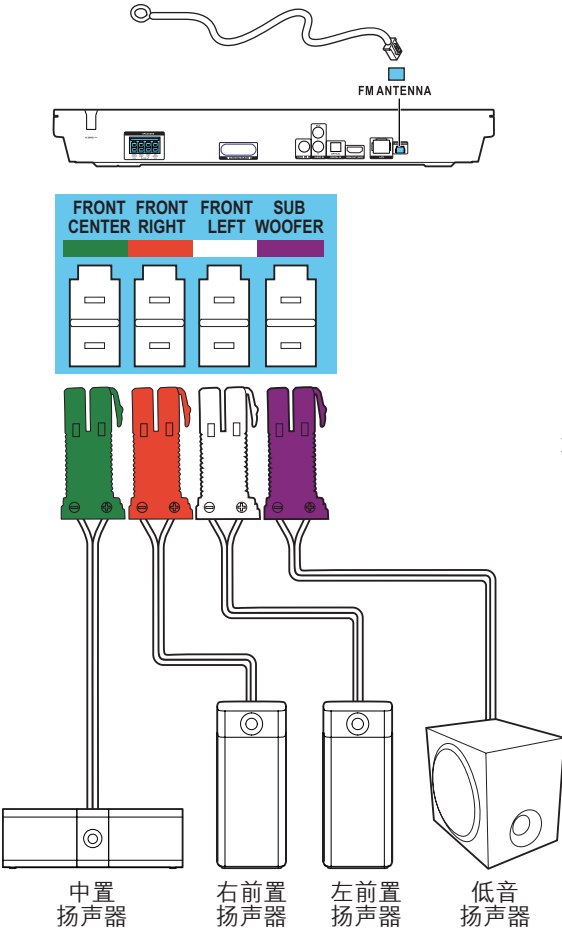

HTB5550

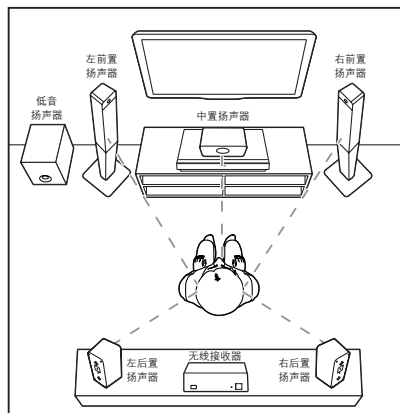
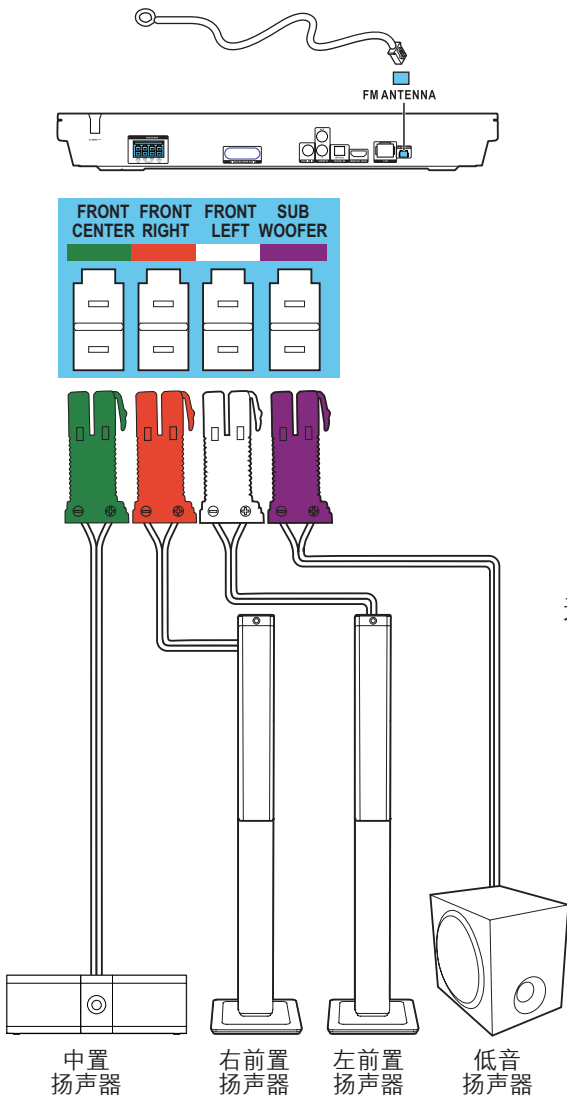

无线接收器

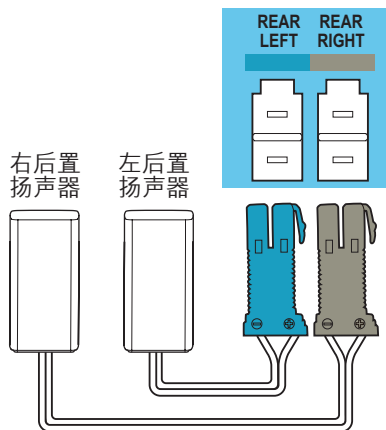

HTB5580

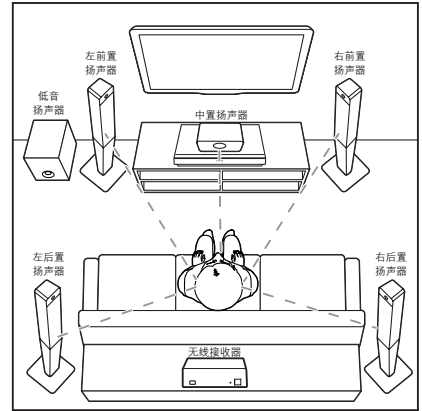
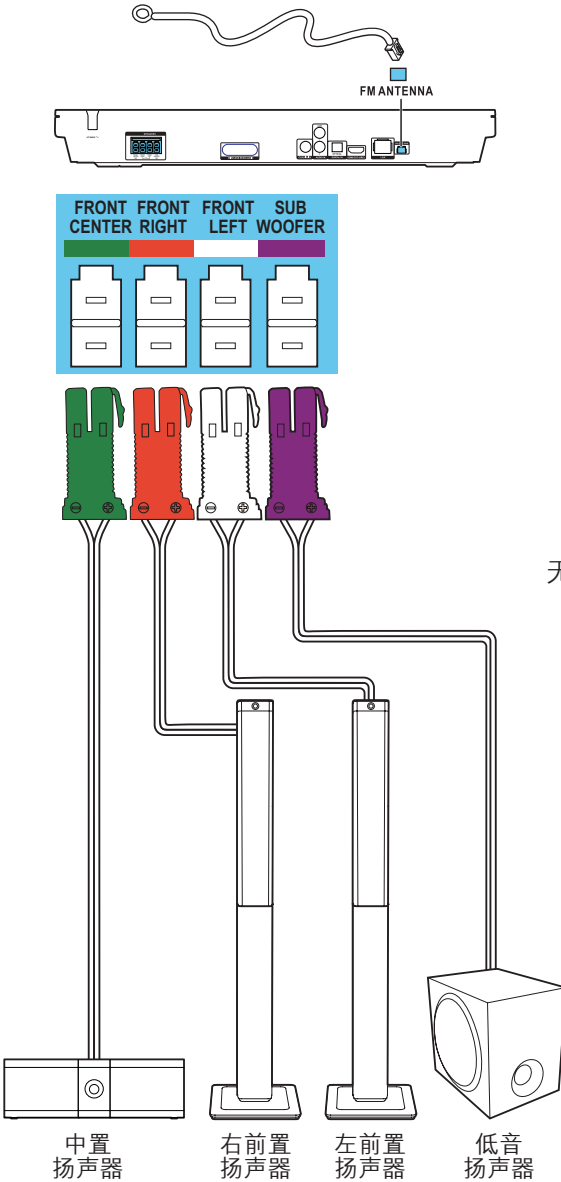

无线接收器

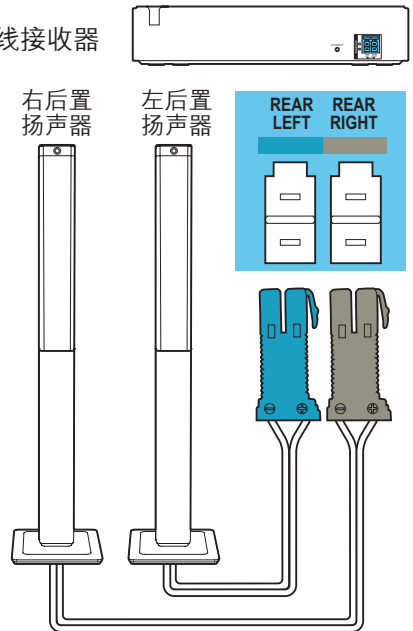

3

ZH-CN 通过这些方式连接至电视

EN Connect to TV in one of these ways

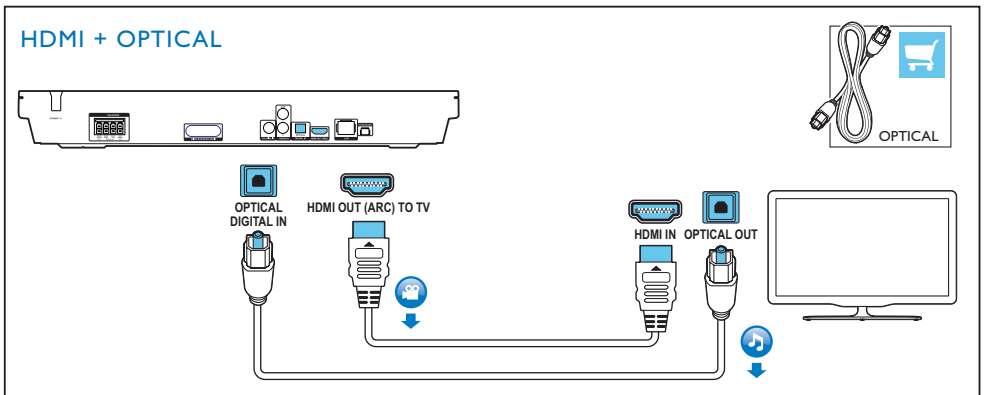
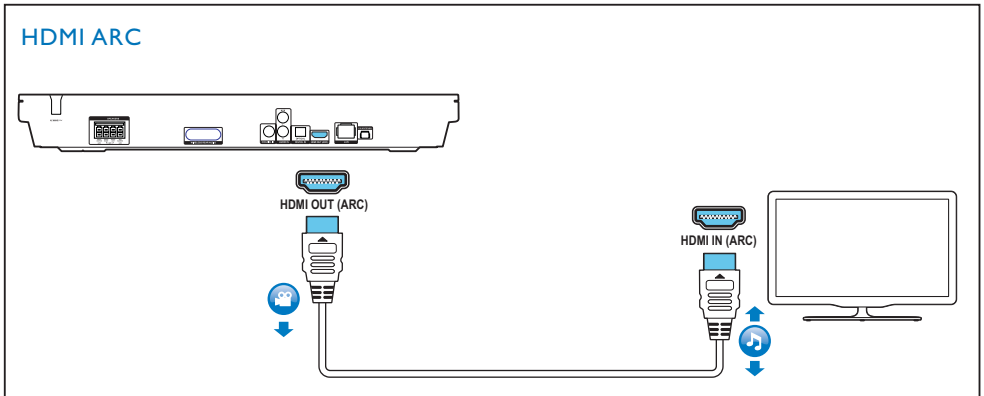

HDMI + COAXIAL

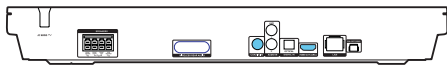

COAXIAL IN

HDMI OUT (ARC)

HDMI IN

COAXIAL OUT



COAXIAL

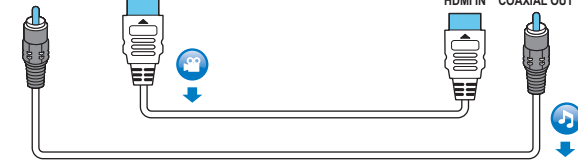

HDMI + AUDIO L/R



L
R
AUDIO IN

HDMI OUT (ARC) TO TV

L
R
HDMI IN

L
R
AUDIO OUT



AUDIO L/R

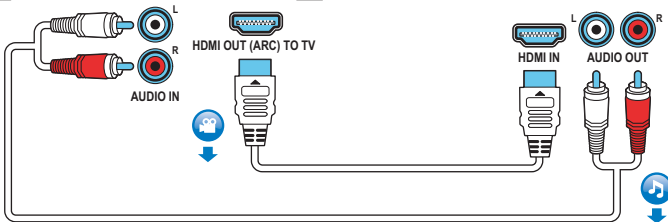

4a

ZH-CN 打开家庭影院

EN Switch on the home theater

1

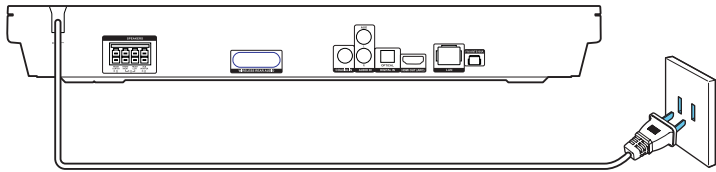

2

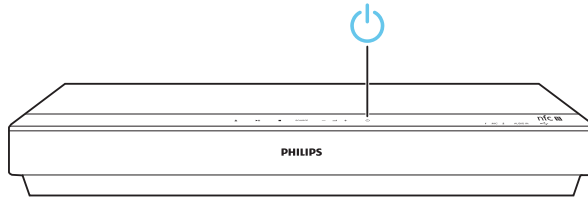

3

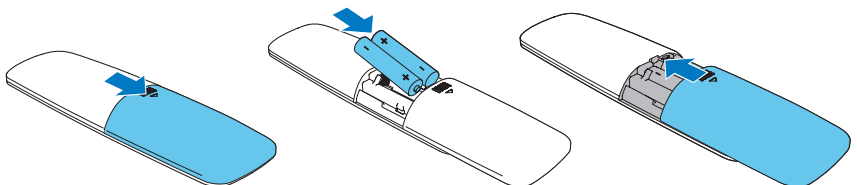

4b

ZH-CN 对后置扬声器进行配对（有关后置扬声器配对的书面说明，请参阅用户手册的第 2 章“连接和设置”）

EN Pair up the rear speakers (for the written instructions on pair-up of the rear speakers, refer to Chapter 2 “Connect and setup” of the User Manual)

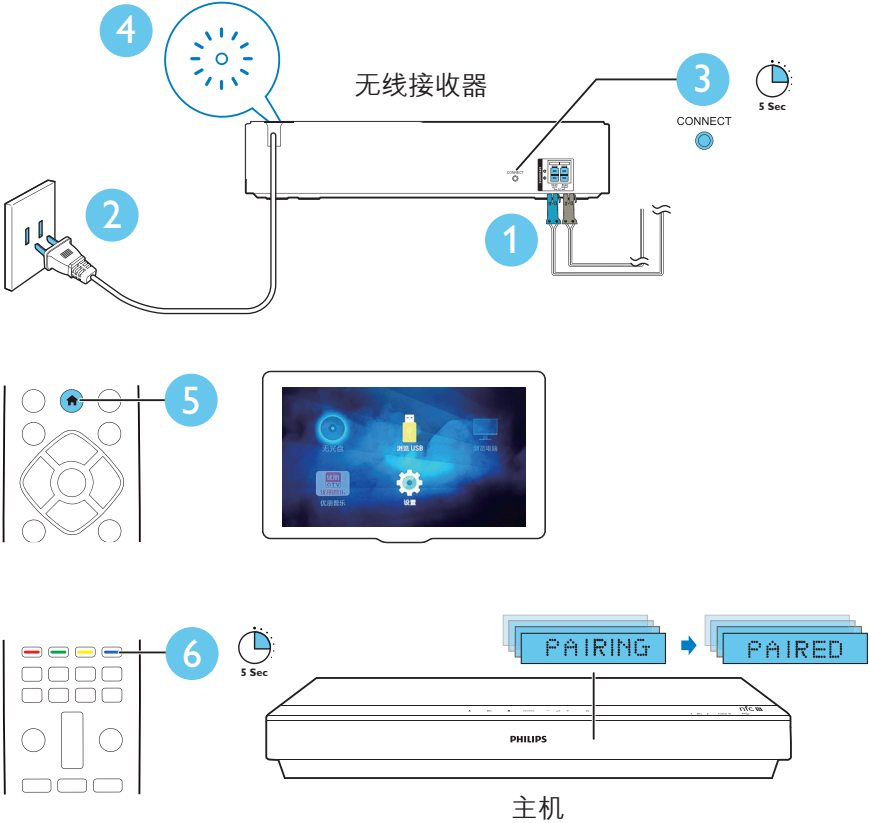

5

ZH-CN 完成首次设置

EN Complete the first time setup

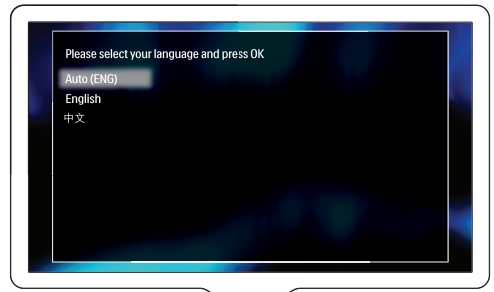
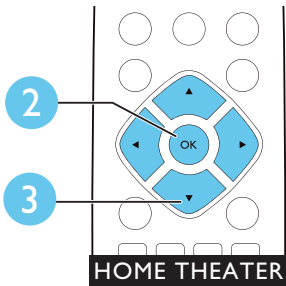
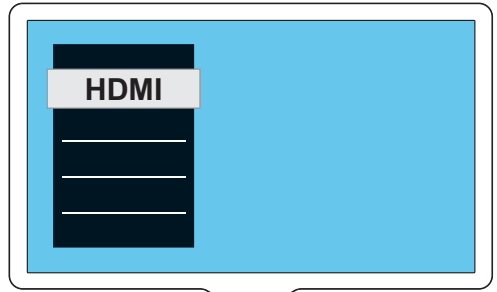
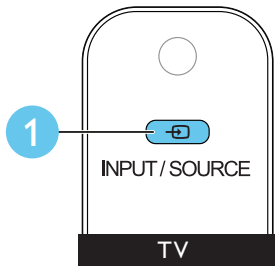

6

ZH-CN 使用家庭影院

EN Use your home theater

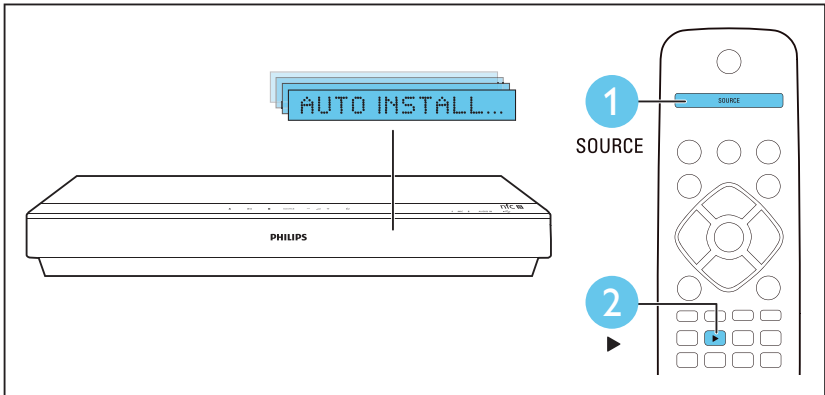
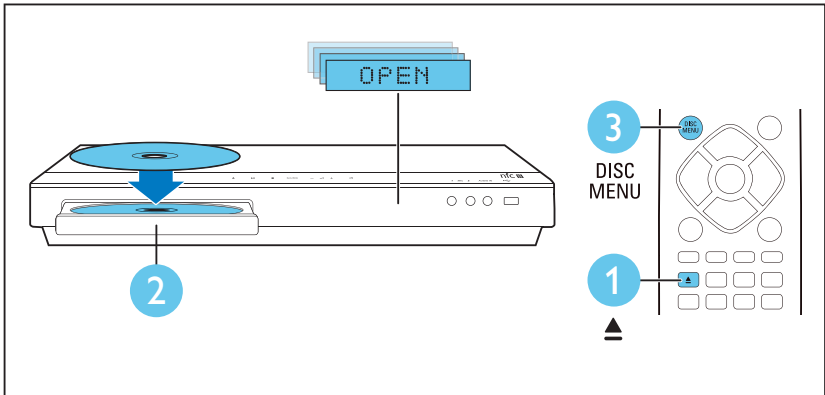

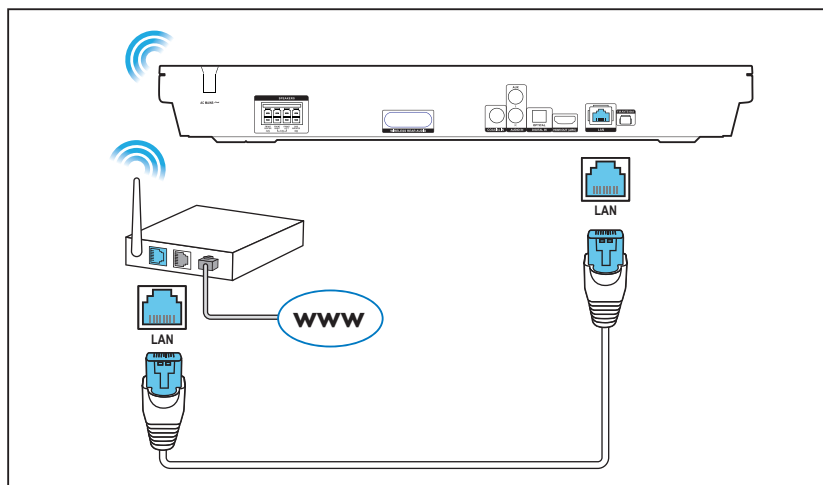
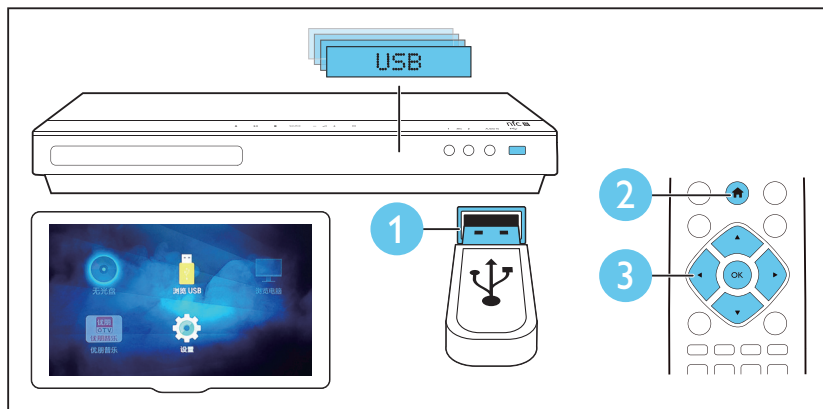
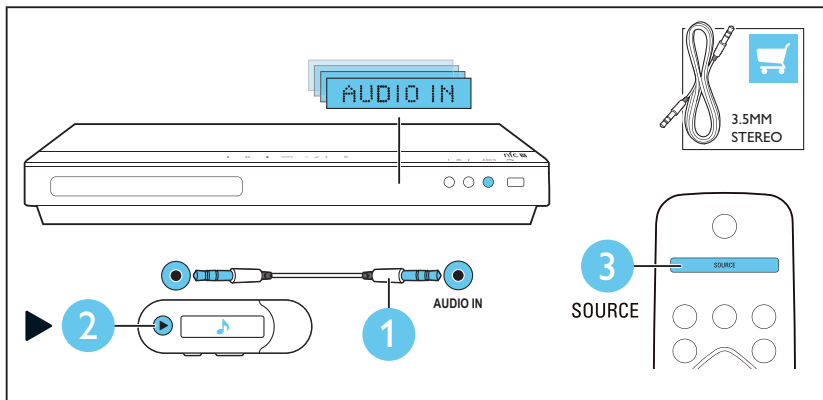

7

ZH-CN 通过蓝牙播放音频或通过 NFC 连接蓝牙

EN Play audio through Bluetooth or connect Bluetooth via NFC

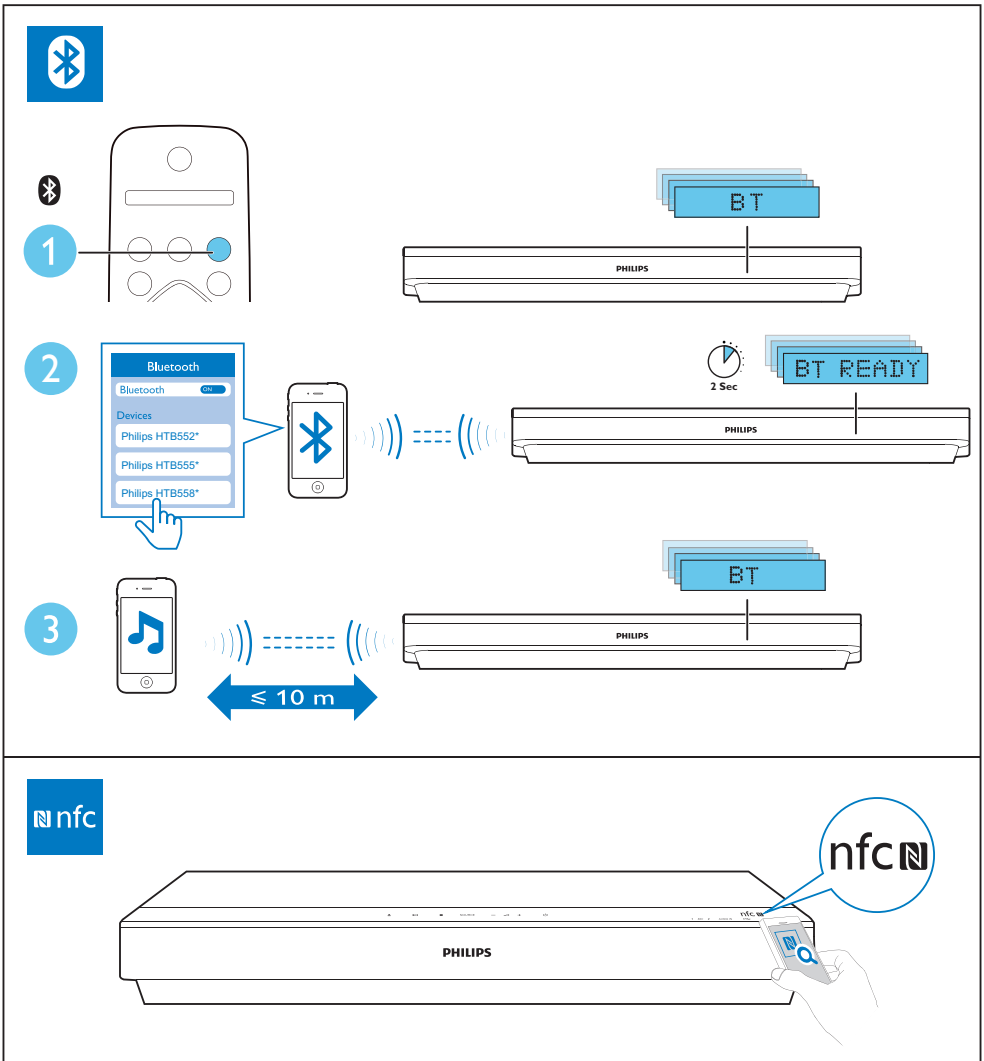



ZH-CN 访问 www.philips.com/support 更详细地了解本产品

EN For more information about using this product, visit www.philips.com/support



www.philips.com/support



Specifications are subject to change without notice
© 2014 Koninklijke Philips N.V. All rights reserved.
Trademarks are the property of Koninklijke Philips N.V. or their respective owners.

HTB352x/355x/358x_93_QSG_V1.0

