

Always here to help you / 始终如一地为您提供帮助

Register your product and get support at / 请登录以下网址并得到相应的帮助  
[www.philips.com/welcome](http://www.philips.com/welcome)



S5130  
S5110  
S5015  
S5013  
S5011  
S5010  
S5008



**PHILIPS**



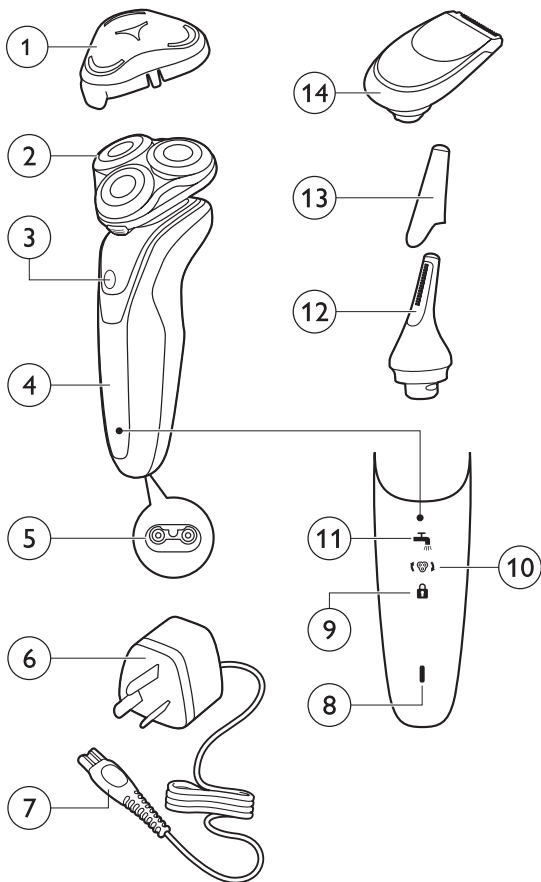



**S5130/04 , S5110/04 , S5015/61, S5013/04 , S5011/04 , S5010/03, S5008/ 04**

---

**ENGLISH 6**

简体中文 28

## Introduction

Congratulations on your purchase and welcome to Philips! To fully benefit from the support that Philips offers, register your product at [www.philips.com/welcome](http://www.philips.com/welcome).

## General description (Fig. 1)

- 1 Protection cap for shaving unit
- 2 Click-on shaving unit
- 3 On/off button
- 4 Handle
- 5 Socket for small plug
- 6 Adapter
- 7 Small plug
- 8 Battery charge indicator
- 9 Travel lock symbol
- 10 Replacement reminder  
(S5130/04, S5110/04, S5013/04 only)
- 11 Cleaning reminder  
(S5130/04, S5110/04, S5013/04 only)
- 12 Click-on nose trimmer attachment  
(S5015/61 only)
- 13 Protection cap for nose trimmer attachment  
(S5015/61 only)
- 14 Click-on trimmer attachment  
(S5130/04, S5110/04, S5015/61, S5013/04,  
S5011/04, S5008/04 only)

**Note:** *The accessories supplied may vary for different products. The box shows the accessories that have been supplied with your appliance.*

## Important safety information

Read this important information carefully before you use the appliance and its accessories and save it for future reference. The accessories supplied may vary for different products.

### Danger

- Keep the adapter dry.

### Warning

- The adapter contains a transformer. Do not cut off the adapter to replace it with another plug, as this causes a hazardous situation.
- This appliance is not intended for use by persons (including children) with reduced physical, sensory or mental capabilities, or lack of experience and knowledge, unless they have been given supervision or instruction concerning use of the appliance by a person responsible for their safety.
- Children should be supervised to ensure that they do not play with the appliance.
- Always unplug the shaver before you clean it under the tap.
- Always check the appliance before you use it. Do not use the appliance if it is damaged, as this may cause injury. Always replace a damaged part with one of the original type.

### Caution

- Never immerse the cleaning system or the charging stand in water and do not rinse it under the tap.
- Never immerse the shaver in water. Do not use the shaver in the bath or in the shower.
- Never use water hotter than 80°C to rinse the shaver.
- Only use this appliance for its intended purpose as shown in the user manual.



- For hygienic reasons, the appliance should only be used by one person.
- Never use compressed air, scouring pads, abrasive cleaning agents or aggressive liquids such as petrol or acetone to clean the appliance.
- If your shaver comes with a cleaning system, always use the original Philips cleaning fluid (cartridge or bottle, depending on the type of cleaning system).
- Always place the cleaning system on a stable, level and horizontal surface to prevent leakage.
- If your cleaning system uses a cleaning cartridge, always make sure that the cartridge compartment is closed before you use the cleaning system to clean or charge the shaver.
- When the cleaning system is ready for use, do not move it to prevent leakage of cleaning fluid.
- Water may drip from the socket at the bottom of the shaver when you rinse it. This is normal and not dangerous because all electronics are enclosed in a sealed power unit inside the shaver.

### **Electromagnetic fields (EMF)**

- This Philips appliance complies with all applicable standards and regulations regarding exposure to electromagnetic fields.

### **General**

- This shaver can be safely cleaned under the tap.
- The appliance is suitable for mains voltages ranging from 100 to 240 volts.
- The adapter transforms 100-240 volts to a safe low voltage of less than 24 volts.





## The display

### Charging

#### Battery charge indicator

- Charging takes approx. 1 hour (S5130/04, S5110/04, S5013/04 only) or 8 hours (S5015/61, S5011/04, S5010/03, S5008/04 only).
- Quick charge (S5130/04, S5110/04, S5013/04 only): When the appliance does not contain enough energy for one shave, the battery charge indicator flashes quickly. When the battery charge indicator starts flashing slowly, the appliance contains enough energy for one shave.
- If you leave the appliance connected to the mains, the charging process continues. To indicate that the appliance is charging, the battery charge indicator flashes slowly.

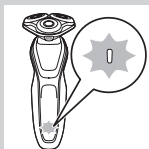

#### Battery fully charged

*Note: You can also use this appliance directly from the mains.*

*Note: When the battery is full, the display switches off automatically after 30 minutes.*

- When the battery is fully charged, the light of the battery charge indicator lights up continuously.

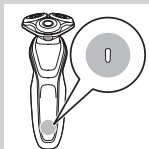

#### Battery low

- When the battery is almost empty, the battery charge indicator flashes orange.



## Cleaning reminder

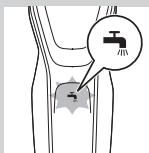

For optimal shaving performance, we advise you to clean the shaver after every use.

- When you switch off the shaver, the cleaning reminder flashes to remind you to clean the shaver (S5130/04, S5110/04, S5013/04 only).

## Travel lock

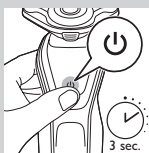

You can lock the shaver when you are going to travel. The travel lock prevents the shaver from being switched on by accident.

### Activating the travel lock

- 1** Press the on/off button for 3 seconds to enter the travel lock mode.

- While you activate the travel lock, the travel lock symbol lights up continuously. When the travel lock is activated, the travel lock symbol flashes.

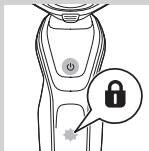

### Deactivating the travel lock

- 1** Press the on/off button for 3 seconds.

- The travel lock symbol flashes and then lights up continuously.

The shaver is now ready for use again.



## Replacing shaving heads



For maximum shaving performance, we advise you to replace the shaving heads every two years.

- The appliance is equipped with a replacement reminder (S5130/04, S5110/04, S5013/04 only) which reminds you to replace the shaving heads. The replacement reminder lights up white continuously.

**Note:** After replacing the shaving heads, you need to reset the replacement reminder by pressing the on/off button for 7 seconds.

## Charging

Charging takes approx. 1 hour (S5130/04, S5110/04, S5013/04) or 8 hours (S5015/61, S5011/04, S5010/03, S5008/04 only).

**Note:** You can also use this appliance directly from the mains.

Charge the shaver before you use it for the first time and when the display indicates that the battery is almost empty.

## Charging with the adapter

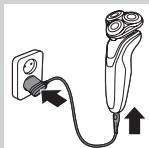

- 1 Insert the small plug into the appliance and put the adapter in the wall socket.

## Using the shaver

### Switching the appliance on and off

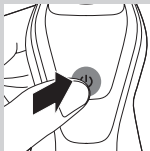

- 1** To switch on the appliance, press the on/off button once.
- 2** To switch off the appliance, press the on/off button once.

### Shaving

#### Skin adaptation period

Your first shaves may not bring you the result you expect and your skin may even become slightly irritated. This is normal. Your skin and beard need time to adapt to any new shaving system. We advise you to shave regularly (at least 3 times a week) with this shaver for a period of 3 weeks to allow your skin to adapt to the new shaver.

*Note: You can also use the shaver directly from the mains.*

- 1** Switch on the appliance.
- 2** Move the shaving heads over your skin in circular movements.

*Note: Do not make straight movements.*

- 3** Clean the shaver after use (see chapter 'Cleaning and maintenance').



## Using the click-on attachments

*Note: The accessories supplied may vary for different products. The box shows the accessories that have been supplied with your appliance.*

### Removing or attaching the click-on attachments

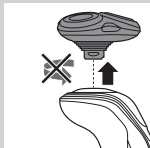

- 1** Make sure the appliance is switched off.
- 2** Pull the attachment straight off the appliance.

*Note: Do not twist the attachment while you pull it off the appliance.*

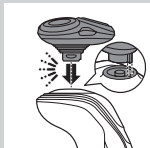

- 3** Insert the lug of the attachment into the slot in the top of the appliance. Then press down the attachment to attach it to the appliance ('click').

### Using the trimmer attachment (S5130/04, S5110/04, S5015/61, S5013/04, S5011/04, S5008/04 only)

You can use the trimmer attachment to groom your sideburns and moustache.



- 1** Make sure the appliance is switched off.
- 2** Insert the lug of the attachment into the slot in the top of the shaver. Then press down the trimmer attachment to attach it to the appliance ('click').
- 3** Switch on the appliance.
- 4** You can now start trimming.
- 5** Clean the attachment after use (see chapter 'Cleaning and maintenance').



### Using the nose trimmer attachment (S5015/61 only)

You can use the nose trimmer attachment to trim your nose hair.

Make sure your nostrils are clean.



- 1** Insert the lug of the attachment into the slot in the top of the appliance. Then press down the attachment to attach it to the appliance ('click').
- 2** Switch on the appliance.
- 3** Carefully insert the attachment into one of your nostrils.

Do not insert the attachment more than 0.5cm into your nostrils.



- 4** Slowly move the attachment around to remove all unwanted hairs in your nostrils.
- 5** Clean the attachment after use (see chapter 'Cleaning and maintenance').

### Trimming ear hair

You can use the nose trimmer attachment to trim your ear hair. Make sure your outer ear channels are clean and free from wax.



- 1** Insert the lug of the attachment into the slot in the top of the appliance. Then press down the attachment to attach it to the appliance ('click').
- 2** Switch on the appliance.
- 3** Slowly move the attachment along the rim of the ear to remove hairs that stick out beyond the rim.



- 4** Insert the attachment into the outer ear channel.

Do not insert the attachment more than 0.5cm into your ear channel, as this could damage the eardrum.

- 5** Slowly turn the attachment around to remove all unwanted hairs from your outer ear channel.
- 6** Clean the attachment after use (see chapter 'Cleaning and maintenance').

## Cleaning and maintenance

*Note: The accessories supplied may vary for different products. The box shows the accessories that have been supplied with your appliance.*

### Cleaning the shaver under the tap

Clean the shaver after every shave for optimal shaving performance.

Be careful with hot water. Always check if the water is not too hot, to prevent your hands from getting burnt.

Never dry the shaving unit with a towel or tissue, as this may damage the shaving heads.



- 1** Rinse the shaving unit under a warm tap for some time.



- 2** Press the release button and open the shaving unit.

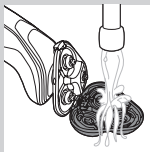

- 3** Rinse the shaving head holder under a warm tap for 30 seconds.
- 4** Carefully shake off excess water and let the shaving head holder dry.
- 5** Close the shaving head holder ('click').

### Thorough cleaning method

Make sure the appliance is switched off.



- 1** Press the release button and open the shaving unit.



- 2** Pull the shaving head holder off the bottom part of the shaving unit.

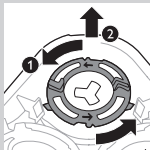

- 3** Turn the retaining rings anticlockwise and remove them.

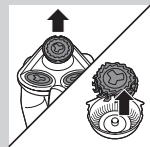

- 4** Remove the shaving heads from the shaving head holder. Each shaving head consists of a cutter and guard.

*Note: Do not clean more than one cutter and guard at a time, since they are all matching sets. If you accidentally put a cutter in the wrong shaving guard, it may take several weeks before optimal shaving performance is restored.*



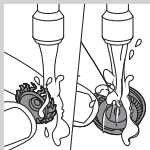

**5** Clean the cutter and guard under the tap.



**6** After cleaning, place the cutter back into the guard.

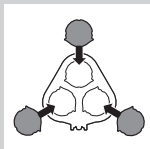

**7** Put the shaving heads back into the shaving head holder.

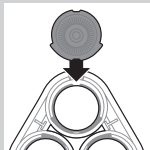

*Note: Make sure the projections of the shaving heads fit exactly into the recesses of the shaving-head holder.*

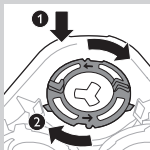

**8** Place the retaining rings back onto the shaving head holder and turn them clockwise.

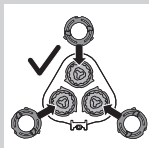

- Each retaining ring has two recesses and two projections that fit exactly in the projections and recesses of the shaving head holder.

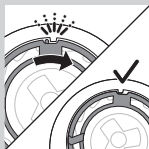

- Turn the retaining ring clockwise until you hear 'click' and the ring is fixed.

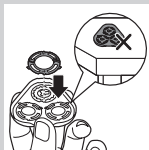

*Note: Hold the shaving head holder in your hand when you reinsert the shaving heads and reattach the retaining rings. Do not place the shaving head holder on a surface when you do this, as this may cause damage.*

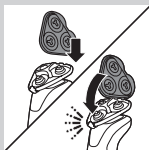

- 9** Reinsert the hinge of the shaving head holder into the slot of the shaving unit. Close the shaving head holder ('click').

## Cleaning the click-on attachments

Never dry the trimmer attachments with a towel or tissue, as this may damage the trimming teeth.

### Cleaning the trimmer attachment (S5130/04, S5110/04, S5015/61, S5013/04, S5011/04, S5008/04 only)

Clean the trimmer attachment every time you have used it.

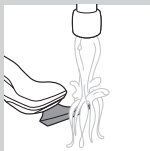

- 1** Switch on the appliance with the trimmer attachment attached.
- 2** Rinse the trimmer attachment under a hot tap for some time.
- 3** After cleaning, switch off the appliance.



- 4** Carefully shake off excess water and let the trimmer attachment dry.

*Tip: For optimal trimmer performance, lubricate the trimmer teeth with a drop of sewing machine oil every six months.*

### **Cleaning the nose trimmer attachment (S5015/61 only)**

Clean the nose trimmer attachment every time you have used it.



- 1** Make sure the appliance is switched off.
- 2** Rinse the cutting element of the nose trimming head with hot water.
- 3** Switch on the appliance and rinse the cutting element once more to remove any remaining hairs. Then switch off the appliance again.



- 4** Carefully shake off excess water and let the nose trimmer attachment dry.

*Tip: For optimal trimmer performance, lubricate the trimmer teeth with a drop of sewing machine oil every six months.*

## Storage

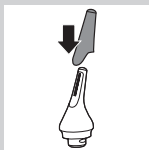

*Note: The accessories supplied may vary for different products. The box shows the accessories that have been supplied with your appliance.*

*Note: We advise you to let the appliance and its attachments dry before you put the protection caps on the attachments and store the shaver in the pouch.*

- S5015/61 only: Place the protection cap on the nose trimming head.
- Put the protection cap on the shaving head to protect it from dirt accumulation.

## Replacement

### Replacing the shaving heads

For maximum shaving performance, we advise you to replace the shaving heads every two years. Replace damaged shaving heads immediately. Only replace the shaving heads with original Philips shaving heads as specified in chapter 'Ordering accessories'.

### Replacement reminder (S5130/04, S5110/04, S5013/04 only)

The shaving unit symbol will light up to indicate that the shaving heads need to be replaced.

- 1** S5130/04, S5110/04, S5013/04 only: The shaving unit symbol lights up continuously when you switch off the shaver to indicate that the shaving heads need to be replaced.

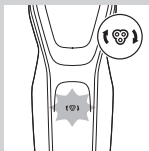



- 2** Press the release button and open the shaving unit.



- 3** Pull the shaving head holder off the bottom part of the shaving unit.

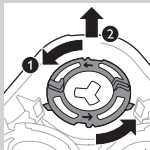

- 4** Turn the retaining rings anticlockwise and remove them.

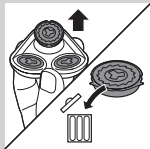

- 5** Remove the shavings heads from the shaving head holder and throw them away.

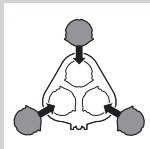

- 6** Place new shaving heads in the holder.

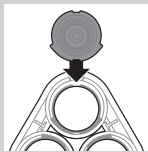

*Note: Make sure the projections of the shaving heads fit exactly into the recesses of the shaving head holder.*

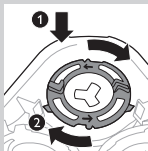

**7** Place the retaining rings back onto the shaving heads and turn them clockwise.

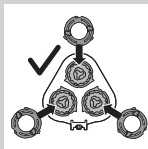

- Each retaining ring has two recesses and two projections that fit exactly in the projections and recesses of the shaving head holder.

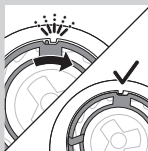

- Turn the retaining ring clockwise until you hear 'click' and the ring is fixed.

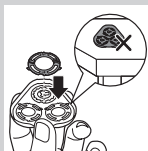

*Note: Hold the shaving head holder in your hand when you reinsert the shaving heads and reattach the retaining rings. Do not place the shaving head holder on a surface when you do this, as this may cause damage.*



- 8** Reinsert the hinge of the shaving head holder into the slot of the shaving unit. Close the shaving head holder ('click').

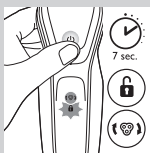

- 9** S5130/04, S5110/04, S5013/04 only: to reset the replacement reminder, press and hold the on/off button for approx. 7 seconds.

## Ordering accessories

To buy accessories or spare parts, visit **[www.shop.philips.com/service](http://www.shop.philips.com/service)** or go to your Philips dealer. You can also contact the Philips Consumer Care Centre in your country (see the worldwide guarantee leaflet for contact details).

The following parts are available:

- HQ8505 adapter
- SH50 Philips shaving heads
- HQ110 Philips Shaving Head Cleaning Spray
- RQ111 Philips beard styler attachment
- JC301, JC302, JC303, JC304, JC305 cleaning cartridge

*Note: Availability of the accessories may differ per country.*



## Shaving heads

- We advise you to replace your shaving heads every two years. Always replace the shaving heads with original SH50 Philips shaving heads.

## Recycling

Do not throw away the appliance with the normal household waste at the end of its life, but hand it in at an official collection point for recycling. By doing this, you help to preserve the environment.

## Removing the rechargeable shaver battery

Only remove the rechargeable battery when you discard the shaver. Make sure the battery is completely empty when you remove it.

Be careful, the battery strips are sharp.

- 1** Remove the screw in the backpanel with a screwdriver. Then remove the back panel.
- 2** Bend the hooks aside and remove the power unit.
- 3** Break the snap hooks and remove the front panel of the power unit.

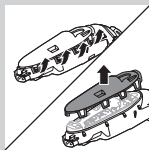
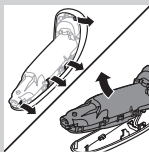
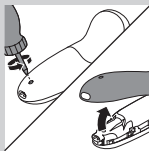



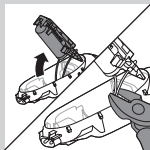

- 4 Take out the battery holder and cut the battery tags with a pair of cutting pliers.

### Guarantee and support

If you need information or support, please visit **[www.philips.com/support](http://www.philips.com/support)** or read the separate worldwide guarantee leaflet.

### Guarantee restrictions

The shaving heads (cutters and guards) are not covered by the terms of the international guarantee because they are subject to wear.

### Troubleshooting

This chapter summarises the most common problems you could encounter with the appliance. If you are unable to solve the problem with the information below, visit **[www.philips.com/support](http://www.philips.com/support)** for a list of frequently asked questions or contact the Consumer Care Centre in your country.

Problem	Possible cause	Solution
The shaver does not shave as well as it used to.	The shaving heads are damaged or worn.	Replace the shaving heads (see chapter 'Replacement').
	Hairs or dirt obstruct the shaving heads.	Clean the shaving heads by following the steps of the thorough cleaning method (see chapter 'Cleaning and maintenance').  Clean the shaver thoroughly before you continue shaving (see chapter 'Cleaning and maintenance').
The shaver does not work when I press the on/off button.	The rechargeable battery is empty.	Recharge the battery (see chapter 'Charging').
	The travel lock is activated.	Press the on/off button for 3 seconds to deactivate the travel lock.
I replaced the shaving heads, but the replacement reminder symbol is still showing.	The shaving unit is soiled or damaged to such an extent that the motor cannot run.	Clean the shaving heads or replace them (see chapters 'Cleaning and maintenance' and 'Replacement').
	You have not reset the shaver.	Reset the shaver by pressing the on/off button for approx. 7 seconds (see chapter 'Replacement').

Problem	Possible cause	Solution
A shaving head symbol has suddenly appeared on the display.	This symbol is a replacement reminder.	Replace the shaving heads (see chapter 'Replacement').
The nose trimmer attachment pulls at the hairs.	You move the appliance too fast.	Do not move the appliance too fast.
The nose trimmer attachment does not work.	The cutting element of the attachment is very dirty, for instance because some nasal mucus has dried inside the cutting element.	Clean the cutting element by rinsing it under the tap with hot water. Switch on the appliance and rinse the cutting element once more to remove any remaining hairs.

If rinsing the nose trimmer under the tap does not unblock the cutting element, then immerse it in a glass with warm water for a few minutes. Then switch on the appliance and rinse it under the tap.

## 简介

感谢您的惠顾，欢迎光临飞利浦！  
为了您能充分享受飞利浦提供的支持，  
请在 [www.philips.com/welcome](http://www.philips.com/welcome) 上注册您的产品。

## 基本说明 (图 1)

- 1 剃须刀头部件保护盖
- 2 卡入式剃须刀头部件
- 3 开/关按钮
- 4 手柄
- 5 小插头的转换插座
- 6 适配器
- 7 小插头
- 8 电池充电指示灯
- 9 旅行锁符号
- 10 更换提示 (仅限于 S5130/04、S5110/04, S5013/04)
- 11 清洁提示 (仅限于 S5130/04、S5110/04, S5013/04)
- 12 卡入式鼻毛修剪器附件 (仅限于 S5015/61)
- 13 鼻毛修剪器附件保护盖 (仅限于 S5015/61)
- 14 卡入式修剪器附件 (仅限于 S5130/04、S5110/04、S5015/61、S5013/04、S5011/04、S5008/04)

注意： 随附的附件可能因产品而异。  
包装盒将向您展示随附于您产品的附件。

## 重要安全信息

使用产品及其附件之前，请仔细阅读本重要信息，并妥善保管以供日后参考。随附的附件可能因产品而异。

### 危险

- 保持适配器干燥。
- 警告符号注释：禁止用在打开的水龙头下进行清洗。

### 警告

- 电源适配器内含有一个变压器。切勿自行更换插头，否则将导致严重后果。
- 产品不打算由有肢体、感官或精神能力缺陷或缺乏使用经验和知识的人（包括儿童）使用，除非有负责他们安全的人对他们进行与产品使用有关的监督或指导。
- 请照顾好儿童，本产品不能用于玩耍。
- 在自来水龙头下清洗剃须刀之前，务必拔掉其电源插头。
- 使用前，请务必检查产品。如果产品已经损坏，请勿再使用，否则可能对人体造成伤害。务必用原装型号更换损坏的部件。





## 警告

- 切勿将清洁系统或充电座浸入水中，也不要在水龙头下冲洗。
- 警告符号注释：禁止用在打开的水龙头下进行清洗。
- 切勿将剃须刀浸入水中。请勿在沐浴或淋浴时使用剃须刀。
- 切勿使用温度高于 80° C 的热水冲洗剃须刀。
- 只能将本产品用于用户手册中所示的原定用途。
- 出于卫生的目的，本产品只能供一个人使用。
- 切勿使用压缩气体、钢丝绒、研磨性清洁剂或腐蚀性液体（例如汽油或丙酮）来清洁产品。
- 如果剃须刀随附清洁系统，应始终使用原装飞利浦清洁液（滤芯或瓶，取决于清洁系统类型）。
- 清洁系统必须放在稳定、平坦的水平表面上，以防漏液。
- 如果清洁系统采用清洁滤芯，在使用清洁系统进行清洁或为剃须刀充电之前，应始终确保滤芯仓已关闭。
- 清洁系统准备就绪时，切勿移动，以免清洁液漏出。
- 冲洗产品时，水可能从剃须刀底部的插口滴出。这是正常的，而且没有危险，因为所有的电子线路都密封在剃须刀内的一个密封壳内。

## 电磁场 (EMF)

- 本飞利浦产品符合所有有关暴露于电磁场的适用标准和法规。

## 概述

- 这款剃须刀可放心在水龙头下清洗。
- 符号注释：适合用在打开的水龙头下进行清洗。
- 本产品适合在 100 - 240 伏的电源电压下工作。
- 电源适配器可将 100-240 伏的电压转换为 24 伏以下的安全低电压。



## 显示屏

### 充电

#### 电池充电指示灯

- 充电约需 1 小时（仅限于 S5130/04、S5110/04、S5013/04）或 8 小时（仅限于 S5015/61、S5011/04、S5010/03、S5008/04）。
- 快速充电（仅限于 S5130/04、S5110/04、S5013/04）：  
当产品所含电量不足以完成一次剃须时，电池充电指示灯将快速闪烁。  
当电池充电指示灯开始缓慢闪烁时，产品所含电量将足以完成一次剃须。
- 如果将产品接通电源，充电过程将继续。电池充电指示灯缓慢闪烁，表明产品正在充电。



## 电池已完全充满

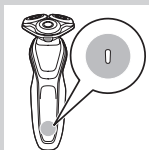

注意：您也可以直接插电使用本产品。

注意：电池充满电后，显示屏会在30分钟后自动关闭。

- 电池充满电后，电池充电指示灯将持续亮起。

## 电池电量不足

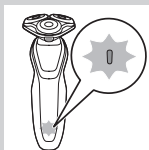

- 当电池的电量几乎耗尽时，电池充电指示灯会呈橙色闪烁。

## 清洗提示

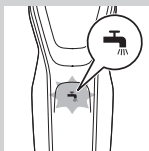

为获得更好剃须效果，我们建议您每次使用之后都要清洁剃须刀。

- 关闭剃须刀时，清洁提示符号闪烁，提醒您清洁剃须刀（仅限于 S5130/04、S5110/04, S5013/04）。

## 旅行锁

您可以在携带剃须刀旅行之前将其锁住。旅行锁可防止剃须刀被意外打开。

### 启用旅行锁

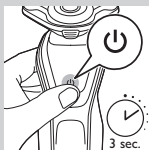

- 1 按住开/关按钮 3 秒钟以进入旅行锁模式。





- 启用旅行锁时，旅行锁符号会持续亮起。  
启用旅行锁后，旅行锁符号会闪烁。

## 解除旅行锁

**1** 按开/关按钮 3 秒钟。



- 旅行锁符号闪烁，然后持续亮起。  
现在可以重新开始使用剃须刀。

## 更换剃须刀头

为获得更好剃须效果，建议每两年更换一次剃须刀头。



- 本产品配有更换提示（仅限于 S5130/04、S5110/04、S5013/04），它会提醒您更换剃须刀头。  
更换提示符号会呈白色持续亮起。

**注意：** 更换剃须刀头后，您需要通过按开/关按钮 7 秒来重置更换提醒。

## 充电

充电约需 1 小时

（S5130/04、S5110/04、S5013/04）  
或 8 小时（仅限于 S5015/61、  
S5011/04、S5010/03、S5008/04）。

**注意：** 您也可以直接插电使用本产品。

首次使用剃须刀之前，或当显示屏指示电池电量几乎耗尽时，请先为剃须刀充电。

### 使用适配器充电

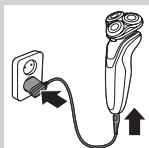

- 1 将小插头插入产品，然后将适配器插入电源插座。

### 使用剃须刀

#### 打开或关闭产品

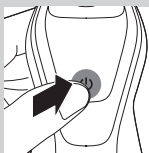

- 1 要打开产品，请按一下开/关按钮。
- 2 要关闭产品，请按一下开/关按钮。

#### 剃须

##### 皮肤适应期

前几次剃须可能不会带给您预期效果，并且您的皮肤可能会受到轻度刺激。这是正常的。您的皮肤和胡须需要时间适应新的剃须系统。建议您在 3 周时间内定期剃须（至少每周 3 次），以便让您的皮肤适应新的剃须刀。

注意：您也可以直接插电使用剃须刀。



- 1** 启动产品。
- 2** 将剃须刀头在您的皮肤上作迂回运动。  
注意：请勿作直线运动。
- 3** 使用后清洁剃须刀（  
请参阅“清洁和保养”一章）。

## 使用卡入式附件

注意：随附的附件可能因产品而异。  
包装盒将向您展示随附于您产品的附件。

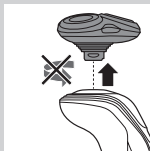

### 拆卸或安装卡入式配件

- 1** 确保产品电源已关闭。
- 2** 将配件竖直抽出产品。

注意：将配件从产品上抽出时，  
不要旋转。

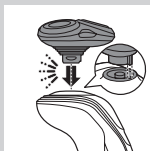

- 3** 将配件的凸缘插入产品顶部的槽  
内。然后按下配件以将其安装在产  
品上（可听到“咔哒”一声）。

使用修剪器附件（仅限于 S5130/04  
、S5110/04、S5015/61、S5013/04  
、S5011/04、S5008/04）

您可使用修剪器附件修剪鬓角和须髥。



- 1** 确保产品电源已关闭。
- 2** 将配件的凸缘插入剃须刀顶部的槽  
内。然后按下修剪器配件以将其安  
装在产品上（可听到“咔哒”一声）。



- 3 启动产品。
- 4 现在可以开始修剪了。
- 5 使用后清洁配件（请参阅“清洁和保养”一章）。

### 使用鼻毛修剪器附件（仅限于 S5015/61）

您可以使用鼻毛修剪器附件修剪鼻毛。确保鼻腔是清洁的。

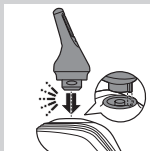

- 1 将配件的凸缘插入产品顶部的槽内。然后按下配件以将其安装在产品上（可听到“咔哒”一声）。

- 2 启动产品。

- 3 将附件小心地插入其中一个鼻孔。  
附件插入鼻孔的深度不得超过 0.5 厘米。



- 4 缓缓地来回移动附件，以剃掉鼻孔中所有多余的毛发。
- 5 使用后清洁配件（请参阅“清洁和保养”一章）。

### 修剪耳毛

您可以使用鼻毛修剪器附件修剪耳毛。确保外耳道洁净无耳垢。

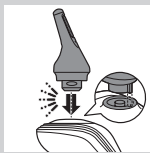

- 1 将配件的凸缘插入产品顶部的槽内。然后按下配件以将其安装在产品上（可听到“咔哒”一声）。
- 2 启动产品。

**3** 缓缓地沿着耳缘移动附件，以剃掉突出耳缘的毛发。

**4** 将附件插入外耳道。

附件插入耳道的深度不能超过 0.5 厘米，否则可能损伤鼓膜。

**5** 缓缓地转动附件，以剃掉外耳道中所有多余的毛发。

**6** 使用后清洁配件（请参阅“清洁和保养”一章）。

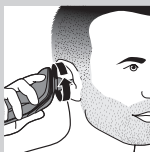

## 清洁和保养

注意：随附的附件可能因产品而异。包装盒将向您展示随附于您产品的附件。

### 在水龙头下冲洗剃须刀

每次剃须后清洁剃须刀，以获得最佳的剃须性能。

使用热水时一定要小心。切记先检查水温是否太高，以防烫手。

不要用毛巾或纸巾擦拭剃须刀头部件，因为这样可能会损坏剃须刀头。

**1** 在热水龙头下冲洗剃须刀头部件片刻。

**2** 按释放按钮，打开剃须刀头部件。



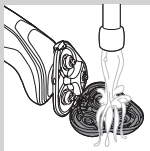

- 3 将剃须刀头支架在热水龙头下冲洗 30 秒。
- 4 小心甩干多余的水，然后使剃须刀头支架干燥。
- 5 合上剃须刀头支架（可听到“咔哒”一声）。

### 彻底清洁方法



确保产品电源已关闭。

- 1 按释放按钮，打开剃须刀头部件。

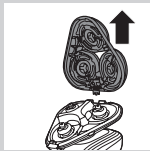

- 2 将剃须刀头支架从剃须刀头部件的底部抽离。

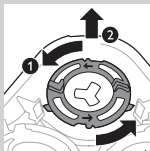

- 3 逆时针旋转固定环并将其取下。

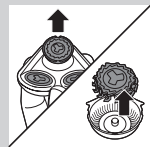

- 4 从剃须刀头支架上卸下剃须刀头。每个剃须刀头都包括刀片和网罩。

注意：不要同时清洁多组刀片和网罩，因为它们都是相互匹配的。如果不小心将刀片装到了错误的网罩上，则需要数周时间才能恢复产品的最佳剃须性能。

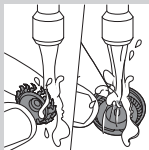

**5** 在水龙头下清洁刀片和网罩。



**6** 清洁后，将刀片放回网罩中。

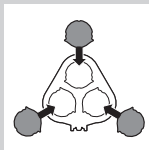

**7** 将剃须刀头装回到剃须刀头支架中。

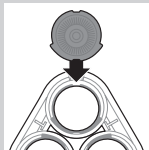

注意：确保剃须刀头的凸缘正好装入剃须刀头支架的凹槽。

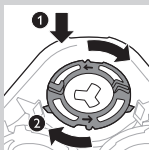

**8** 将固定环放回剃须刀头支架并将其顺时针旋转。

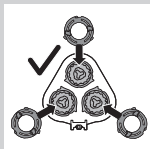

- 各固定环均具有两个凹槽和两个凸缘，正好装入剃须刀头支架的凸缘和凹槽内。

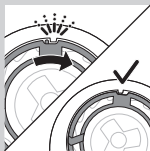

- 顺时针旋转固定环，直至听到“咔哒”一声，表明固定环已就位。

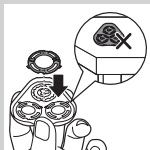

注意：当您重新插入剃须刀头并重新安装固定环时，请将剃须刀头支架握在手中。当您执行此操作时，切勿将剃须刀头支架放在平面上，否则可能会造成损坏。

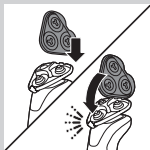

- 9 将剃须刀头支架的铰链重新卡入剃须刀头部件的槽内。合上剃须刀头支架（可听到“咔哒”一声）。



## 清洁卡入式附件

切勿用毛巾或纸巾擦干修剪器附件，可能会损坏修剪齿。

清洁修剪器附件（仅限于 S5130/04、S5110/04、S5015/61、S5013/04、S5011/04、S5008/04）

每次使用后都要清洁修剪器附件。

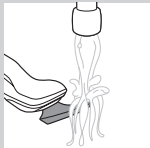

- 1** 打开装有修剪器附件的产品。
- 2** 在热水龙头下冲洗修剪器附件片刻。
- 3** 清洁完成后，关闭产品。
- 4** 小心地甩干多余的水，然后使修剪器附件干燥。



提示：为获得最佳修剪性能，每六个月用一滴缝纫机油润滑修发器齿。

清洁鼻毛修剪器附件（仅限于 S5015/61）

每次使用后都要清洁鼻毛修剪器附件。

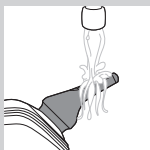

- 1** 确保产品电源已关闭。
- 2** 用热水冲洗鼻毛修剪刀头的修剪部件。
- 3** 打开产品，再次冲洗修剪部件，以清除任何剩余的毛发。然后再次关闭产品。
- 4** 小心地甩干多余的水份，然后将鼻毛修剪器附件晾干。



提示：为获得最佳修剪性能，每六个月用一滴缝纫机油润滑修发器齿。

## 存储

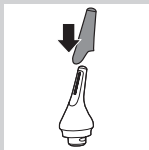

注意：随附的附件可能因产品而异。包装盒将向您展示随附于您产品的附件。

注意：建议您将产品及其配件晾干后再将保护盖放在配件上，将剃须刀存放在软袋中。

- 仅限于 S5015/61：将保护盖放在鼻毛修剪刀头上。
- 将保护盖放在剃须刀头上，以防其积聚灰尘。

## 更换

### 更换剃须刀头

为获得更好剃须效果，建议每两年更换一次剃须刀头。损坏的剃须刀头应立即更换。只能使用“订购附件”一章中指定的飞利浦原装剃须刀头进行更换。

### 更换提示（仅限于 S5130/04、S5110/04, S5013/04）

剃须刀头部件符号会亮起，表示需要更换剃须刀头。

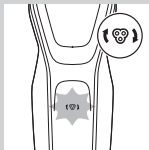

- 1** 仅限于 S5130/04、S5110/04, S5013/04：关闭剃须刀时，剃须刀头部件符号持续亮起，表示需要更换剃须刀头。



**2** 按释放按钮，打开剃须刀头部件。



**3** 将剃须刀头支架从剃须刀头部件的底部抽离。

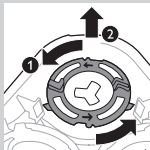

**4** 逆时针旋转固定环并将其取下。

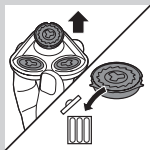

**5** 从剃须刀头支架上取下剃须刀头并将其丢弃。

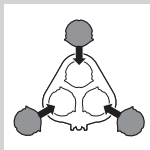

**6** 将新的剃须刀头放在支架中。

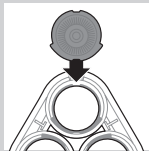

注意： 确保剃须刀头的凸缘正好装入剃须刀头支架的凹槽。

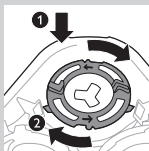

**7** 将固定环放回剃须刀头并将其顺时针旋转。

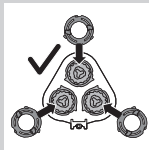

- 各固定环均具有两个凹槽和两个凸缘，正好装入剃须刀头支架的凸缘和凹槽内。

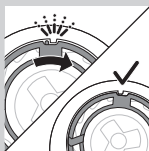

- 顺时针旋转固定环，直至听到“咔哒”一声，表明固定环已就位。

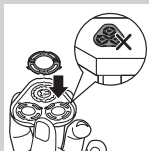

注意： 当您重新插入剃须刀头并重新安装固定环时，请将剃须刀头支架握在手中。当您执行此操作时，切勿将剃须刀头支架放在平面上，否则可能会造成损坏。

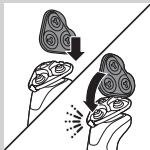

- 8** 将剃须刀头支架的铰链重新卡入剃须刀头部件的槽内。合上剃须刀头支架（可听到“咔哒”一声）。

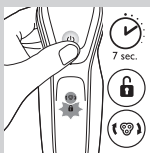

- 9** 仅限于 S5130/04、S5110/04、S5013/04：要重置更换提示，请按住开/关按钮约 7 秒钟。

## 订购附件

要购买附件和备件，请访问 [www.shop.philips.com/service](http://www.shop.philips.com/service) 或 请联系飞利浦经销商。您也可以联系您所在国家/地区的飞利浦客户服务中心（联系详情，请参阅全球保修卡）。

可选配以下附件：

- HQ8505 适配器
- SH50 飞利浦剃须刀头
- HQ110 飞利浦剃须刀头清洁喷雾剂
- RQ111 飞利浦胡须造型器附件
- JC301、JC302、JC303、JC304、JC305 清洁滤芯

注意：各国家/地区的配件可用性可能会有所不同。

## 剃须刀头

- 建议您每两年更换一次剃须刀头。务必使用原装 SH50 飞利浦剃须刀头进行更换。

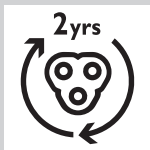

## 回收

弃置产品时，请不要将其与一般生活垃圾扔在一起，应将其交给指定的回收中心，这样做有利于环保。

### 卸下剃须刀的充电电池

只有在丢弃剃须刀时才可取下充电电池。请确保在取下电池时电量已完全耗尽。

注意，电池带非常锋利。

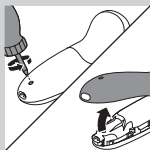

**1** 用螺丝刀卸下背板中的螺钉。  
然后卸下背板。

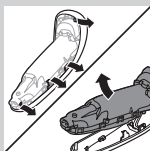

**2** 将钩子向外掰，取出电源部件。

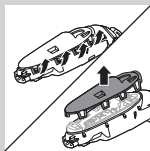

**3** 脱开安全钩，取下电源部件的前面板。

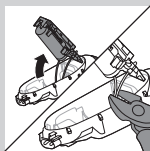

**4** 取出电池舱，用一把钢丝钳剪下电池标签。

## 保修和支持

如果您需要信息或支持，请访问 [www.philips.com/support](http://www.philips.com/support) 或阅读单独的全球保修卡。

## 保修条款

由于剃须刀头（刀片和网罩）属于易磨损物品，因此不在国际保修条款的涵盖范围之列。

## 故障种类和处理方法

本章归纳了使用本产品时最常见的一些问题。如果您无法根据以下信息解决问题，请访问 [www.philips.com/support](http://www.philips.com/support) 查阅常见问题列表，或联系您所在国家/地区的客户服务中心。

问题	可能的原因	解决方法
剃须刀的剃须效果没有以前好。	剃须刀头已损坏或磨损。	更换剃须刀头（见“更换”一章）。
	毛发或污垢堵塞了剃须刀头。	通过执行下列彻底清洁方法中的步骤来清洁剃须刀头（请参阅“清洁和保养”一章）。 在继续剃须前彻底清洁剃须刀（见“清洁和保养”一章）。
按下开/关钮时，剃须刀不工作。	充电电池的电量已耗尽。	给电池充电（见“充电”一章）。

问题	可能的原因	解决方法
	旅行锁已被激活。	按住开/关按钮 3 秒钟以禁用旅行锁。
	剃须刀头部件被污染或损坏，导致马达无法运行。	清洁剃须刀头或进行更换（见“清洁和保养”及“更换”章节）。
我更换了剃须刀头，但仍然显示更换提醒符号。	您尚未重置剃须刀。	按住开/关按钮大约 7 秒钟以重置剃须刀（见“更换”一章）。
显示屏上突然出现剃须刀头符号。	此符号是更换提醒。	更换剃须刀头（见“更换”一章）。
鼻毛修剪器附件拉拔毛发。	产品移动过快。	移动本产品时速度不要太快。
鼻毛修剪器附件不工作。	附件的修剪部件非常脏，因为修剪部件内部沾有一些干鼻涕（举个例子）。	清洁修剪部件：在热水龙头下冲洗。打开产品，再次冲洗修剪部件，以清除任何剩余的毛发。
		如果在水龙头下冲洗鼻毛修剪器时未解锁修剪部件，则将其浸入盛有温水的玻璃杯中几分钟。然后打开产品，在水龙头下冲洗。



## PHILIPS

产品：飞利浦电动剃须刀  
型号：S5130, S5110, S5015, S5013  
S5011, S5010, S5008

额定电压：220V~

额定频率：50Hz

额定输入功率：9 W

生产日期：请见产品本体

产地：中国广东珠海



珠海经济特区飞利浦家庭电器有限公司  
中国珠海市三灶镇琴石工业区  
全国顾客服务热线：4008 800 008

本产品根据国标：GB4706.1-2005, GB4706.9-2008制造

保留备用 07/04/2015



[www.philips.com](http://www.philips.com)



100% recycled paper  
100% 循环再造纸

4222.002.5760.1