

INSTALLATION

1. Unscrew and open the side panel of the chassis
2. Install the power supply as below

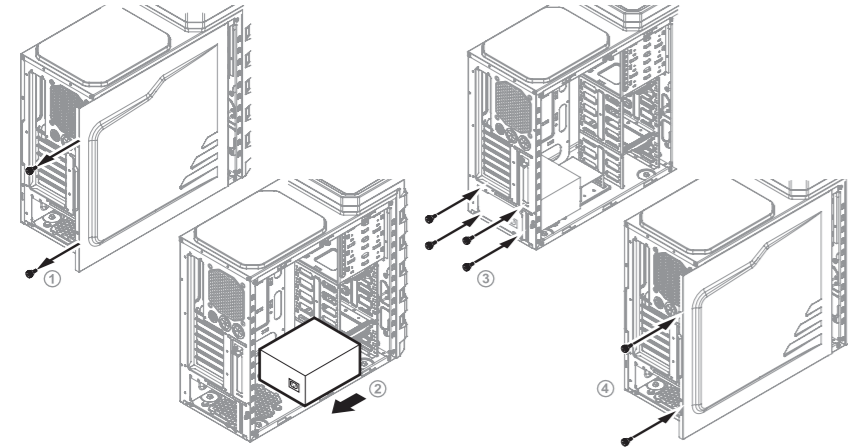

3. Connect Motherboard (20+4 Pin) and CPU (4+4 Pin) connectors to your motherboard(see connector spec table)
4. Connect other connectors, like PCI-E (6+2pin), SATA and Molex from power supply to your system components and make sure that all of them are well connected.(see connector spec table)
5. Close the chassis and reattach the case screws
6. Plug in the power cord of the power supply and switch on the power

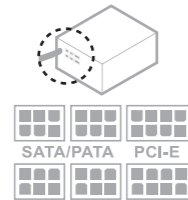

FEATURES



- Compatible with the Intel standard ATX 12V V2.31
- Compatible with the EPS 12V V2.93
- Compatible with ErP 2013 Lot 6
- Semi-Modular with black flat cables
- Support single rail 12V output for higher power usage
- MTBF more than 100,000 hours at 25°C to provide high reliability
- Heavy-duty protection: OVP/ OPP/ SCP/ UVP
- Active PFC(PF>0.9) provides clean and reliable power
- High quality design to meet maximum power output at a server-grade 40°C temperature environment

WARRANTY

Gigabyte provides hardware limited warranty for the power supply on the date of purchase and guarantees this device to be free of defects in material and workmanship. Please keep your receipt with safety. This product is designed only for computer and using this device in any other purposes will void the warranty. If you are not familiar with power supply installation, please ask for professional technical assistance. The warranty is applied to damages caused through normal usage and it will be voided if the device was damaged because of abuse, alteration, misuse, negligence, incorrect voltage supply, air/water pollution, accidents and natural disasters.

MODEL DESCRIPTION



G750H

- Guarantee to deliver 750W continuous output
- 80 PLUS Gold certificated and up to 90% energy efficiency(115V)
- 140mm Double ball bearing cooling fan with thermal speed control delivers silent and durable cooling performance
- All Japanese capacitors offer great reliability
- Safety: CE FCC TUV TUVus BSMI EAC CCC RCM



B700H

- Guarantee to deliver 700W continuous output
- 80 PLUS Bronze certificated and up to 85% energy efficiency(115V)
- 120mm Double ball bearing cooling fan with thermal speed control delivers silent and durable cooling performance
- Safety: CE FCC TUV UL BSMI EAC RCM



CAUTIONS AND WARNINGS

- Please unplug or switch off the power supply when installing it
- Please make sure that the power source is consistent with the specifications labeled on the nameplate before switching on the power supply
- Do not pull and/or unplug the power cord when the power supply is in use. Doing so may cause damage to your components
- Do not use the power supply in a high humidity and/or temperature environment
- High voltage exists in the power supply and only authorized service technician can open the power supply case
- All warranties and guarantees will be voided in the event of failure to comply with any of the warnings and cautions covered in this manual
- If the power supply is not working properly, please contact our Product Service Center.

TROUBLESHOOTING

If your computer does not work normally after installing the power supply, please follow the troubleshooting guide as listed below:

1. Please make sure the AC power is connected correctly
2. Please make sure the Motherboard 20+4pin and CPU 8 pin connectors are connected correctly to the motherboard
3. If the power supply still does not work normally, please contact our service center immediately.

GIGABYTE™



G750H



B700H

GIGABYTE™

**GP-G750H
SPEC**



AC INPUT	Input Voltage	100V-240 V			
	Input Current	10A			
	Frequency	47-63 Hz			
PFC	ACTIVE PFC				
DC OUTPUT	+5V	+3.3V	+12V	-12V	+5Vsb
OUTPUT CURRENT	22.0A	22.0A	62.0A	0.3A	2.5A
MAXIMUM COMBINED WATTAGE	120W	744W	6W	12.5W	
	750W				

**GP-B700H
SPEC**



AC INPUT	Input Voltage	100V-240 V			
	Input Current	10A			
	Frequency	47-63 Hz			
PFC	ACTIVE PFC				
DC OUTPUT	+5V	+3.3V	+12V	-12V	+5Vsb
OUTPUT CURRENT	18.0A	22.0A	54.0A	0.3A	2.5A
MAXIMUM COMBINED WATTAGE	130W	648W	6W	12.5W	
	700W				

**GP-G750H
GP-B700H
CONNECTORS'
SPEC**

