



LCD monitor

- E Line
- 22 (21.5"/54.6 cm diag.)
- Full HD (1920 x 1080)

227E7QDSB/00

Vivid colours, crisp details

in an elegant design

This brilliant wide-view display offers vivid colours and crisp details wrapped in an elegant design for a light and fresh face in any home or office.

Benefits

Superb Picture Quality

- AH-IPS display gives awesome images with wide viewing angles
- 16:9 Full HD display for crisp, detailed images
- Less eye fatigue with Flicker-Free technology
- SmartContrast for deep black level details
- SmartImage Lite for easy optimised image settings

Elegant Design

- Edge-to-edge narrow border display for seamless appearance
- EasySelect menu toggle key for quick on-screen menu access

- Elegant, slim design complements your home decor

Experience immersive multimedia

- MHL technology for enjoying mobile content on a big screen

Greener every day

- Low power consumption saves energy bills
- Mercury Free eco-friendly display

PHILIPS

Features

AH-IPS technology



AH-IPS displays use an advanced technology that gives you extra-wide viewing angles of 178/178 degrees, making it possible to view the display from almost any angle. Unlike standard TN panels, AH-IPS displays give you remarkably crisp images with vivid colours, making them ideal not only for Photos, movies and web browsing, but also for professional applications that demand colour accuracy and consistent brightness at all times.

16:9 Full HD display



Picture quality matters. Regular displays deliver quality, but you expect more. This display features enhanced Full HD 1920 x 1080 resolution. With Full HD for crisp detail paired with high brightness, incredible contrast and realistic colours, expect a true-to-life picture.

Flicker-Free technology



Due to the way brightness is controlled on LED-backlit screens, some users experience flicker on their screen which causes eye fatigue. Philips Flicker-Free technology applies a new solution to regulate brightness and reduce flicker for more comfortable viewing.

SmartContrast



SmartContrast is a Philips technology that analyses the contents you are displaying, automatically adjusting colours and controlling backlight intensity to dynamically enhance contrast for the best digital images and videos or when playing games where dark hues are displayed. When Economy mode is selected, contrast is adjusted and backlighting fine-tuned for just-right display of everyday office applications and lower power consumption.

SmartImage Lite

SmartImage Lite is an exclusive, leading edge Philips technology that analyses the content displayed on your screen. Based on a scenario you select, SmartImage Lite dynamically enhances the contrast, colour saturation and sharpness of images and videos for ultimate display performance - all in real time with the press of a single button.

Ultra-narrow Border



The new Philips displays feature ultra-narrow borders which allow for minimal distractions and maximum viewing size. Especially suited for multi-display or tiling setups like gaming, graphic design and professional applications, the ultra-narrow border display gives you the feeling of using one large display.

EasySelect Menu Toggle Key

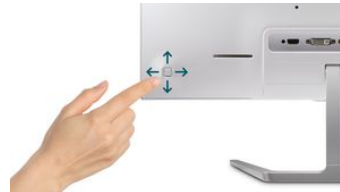

The discreetly placed EasySelect Menu Toggle Key allows you to make quick and easy adjustments to monitor settings in the On-Screen Display menu.

MHL technology



Mobile High-Definition Link (MHL) is a mobile audio/video interface for directly connecting mobile phones and other portable devices to high-definition displays. An optional MHL cable allows you to simply connect your MHL-capable mobile device to this large Philips MHL display and watch your HD videos come to life with full digital sound. Now not only can you enjoy your mobile games, photos, movies or other apps on its big screen, you can simultaneously charge your mobile device so you never run out of power halfway.

Mercury Free

Philips monitors with LED backlighting are free from Mercury, one of the most toxic natural substances, which affects humans and animals. This reduces the environmental impact of the display throughout its lifecycle, from manufacturing to disposal.

Specifications

Please note that this is a pre-sales leaflet. The contents of this leaflet reflect the best of our knowledge per date and country mentioned above. The contents of this leaflet are subject to change without notice. Philips does not accept any liability as to the contents of this leaflet.

Picture/Display

LCD panel type	AH-IPS LCD
Backlight type	W-LED system
Panel Size	21.5 inch/54.6 cm

Effective viewing area	476.06 (H) x 267.79 (V)
Aspect ratio	16:9
Optimum resolution	1920 x 1080 @ 60 Hz

Response time (typical)	14 (Grey to Grey) ms
SmartResponse (typical)	5 (Grey to Grey) ms
Brightness	250 cd/m ²
Contrast ratio (typical)	1000:1
SmartContrast	20,000,000:1
Pixel pitch	0.248 x 0.248 mm
Viewing angle	178° (H)/178° (V) @ C/R > 10
Flicker-free	Yes
Picture enhancement	SmartImage Lite
Display colours	16.7 M
Scanning Frequency	30-83 kHz (H) / 56-76 Hz (V)
MHL	1080p @ 30 Hz
sRGB	Yes

Connectivity

Signal Input	VGA (Analogue) DVI-D (digital, HDCP) MHL-HDMI (digital, HDCP)
Sync Input	Separate Sync Sync on Green
Audio (In/Out)	HDMI audio out

Convenience

User convenience	Power On/Off Menu Volume (HDMI Audio out) Input
OSD Languages	SmartImage Lite Brazil Portuguese Czech Dutch English Finnish French German Greek Hungarian Italian Japanese Korean Polish Portuguese Russian Simplified Chinese Spanish Swedish Traditional Chinese Turkish Ukrainian
Other convenience	Kensington lock VESA mount (100 x 100 mm)
Plug and Play Compatibility	DDC/CI Mac OS X sRGB Windows 8.1 / 8 / 7

Stand

Tilt	-5/20 degree
------	--------------

Power

On mode	17.04 W (typ.) (EnergyStar 6.0 test method)
---------	---

Standby mode	0.5 W (typ.)
Off mode	0.3 W (typ.)
Power LED indicator	Operation - White Standby mode - White (flashing)
Power supply	External 100-240 VAC, 50-60 Hz

Dimensions

Product with stand (mm)	499 x 398 x 213 mm
Product without stand (mm)	499 x 306 x 50 mm
Packaging in mm (W x H x D)	567 x 455 x 124 mm

Weight

Product with stand (kg)	2.96 kg
Product without stand (kg)	2.71 kg
Product with packaging (kg)	4.85 kg

Operating conditions

Temperature range (operation)	0°C to 40°C °C
Temperature range (storage)	-20°C to 60°C °C
Relative humidity	20%–80% %
Altitude	Operation: +12,000 ft (3658 m), Non-operation: +40,000 ft (12,192 m)
MTBF	50,000 (excluding backlight) hour(s)

Sustainability

Environmental and energy	EnergyStar 6.0 EPEAT Silver RoHS Lead-free Mercury Free
Recyclable packaging material	100 %

Compliance and standards

Regulatory Approvals	CE Mark FCC Class B VCCI C-Tick CECP CU SASO KUCAS cETLus TUV/ISO9241-307 EPA WEEE PSB TCO certified
----------------------	---

Cabinet

Colour	Black
Finish	Glossy

- * This Philips display is MHL-certified. However, if your MHL device does not connect or work correctly, check with your MHL device FAQ or vendor directly for instructions. The policy of your device manufacturer may require you to purchase its brand-specific MHL cable or adapter in order for it to work
- * Requires optional MHL-certified mobile device and MHL cable (not included). Please check with your MHL device vendor for compatibility.
- * Standby/Off energy saving of ErP is not applicable for the MHL charging functionality
- * For a complete list of MHL-enabled products, refer to www.mhlconsortium.org
- * "AH-IPS" word mark/trademark and related patents on technologies belong to their respective owners.
- * Smart response time is the optimum value from either GtG or GtG (BW) tests.



data subject to change
2017, August 3

Version: 2.0.1
EAN: 8712581739492

© 2017 Koninklijke Philips N.V.
All rights reserved.

Specifications are subject to change without notice. Trademarks are the property of Koninklijke Philips N.V. or their respective owners.

www.philips.com