



# REALiS

## NON-INTERCHANGEABLE LENS LCOS PROJECTOR WUX450ST / WUX450ST D



PROJECTORS.USA.CANON.COM

MARKETS/APPLICATIONS  
RECOMMENDED FOR:

- Museums & Galleries
- Higher Education
- Simulation & Training
- Corporate
- Government



## SHORT THROW WITH SIGNIFICANT LENS SHIFT & HIGH BRIGHTNESS

Ideal for a variety of markets and applications including higher education, business, training, digital signage and museums, the Canon REALiS WUX450ST Pro AV LCOS Projector displays large, high-impact images even in challenging installation environments. It can fit comfortably behind a presenter to eliminate long cable runs. The impressive combination of high brightness, short-throw ratio with significant lens shift, all in a compact form factor, allow this projector to stand apart from other short-throw projectors on the market today.

### A UNIQUE COMBINATION OF FEATURES PROVIDE A FLEXIBILITY OF INSTALLATION OPTIONS

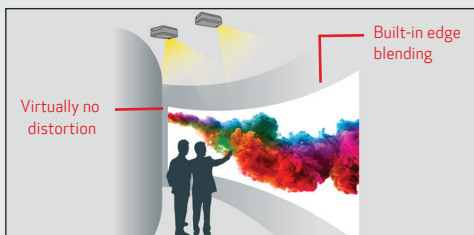

Short throw ratio with significant lens shift creates a versatility of installation options. Museum and gallery visitors can get up-close to large artwork projections and videos without blocking the content.

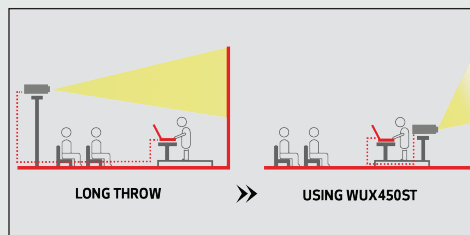

Long cable runs can be virtually eliminated as well as a reduction in glare that may distract the presenter.



### KEY FEATURES

- 4500 Lumens
- WUXGA Resolution (1920 x 1200)
- LCOS Technology with AISYS-enhancement
- Genuine Canon Optics
- Short Throw Ratio 0.56:1
- Lens Shift V: 0—75%, H: ±10%
- HDBaseT™ & WiFi®
- Built-in Edge Blending
- Versatile Connectivity Including HDMI and DVI
- Crestron Connectivity and AMX Device Discovery Support
- DICOM® Simulation Mode\*

\* WUX450ST D only

## SPECIFICATIONS

### PROJECTION SYSTEM

Imaging Device	0.71" LCOS Reflective LCD Panels x3
Aspect Ratio	16:10
Native Resolution	1920 x 1200 (WUXGA)
Brightness <sup>1</sup>	4500 Lumens (Normal) / 3460 Lumens (Power Saver)
Contrast Ratio	2000:1 (Presentation Mode, Iris On)
Uniformity	80%
F Number, Focal Length	F2.7, 8.8mm
Optical Zoom	1.35x
Electronic Zoom	12x Maximum
Image Size <sup>2</sup>	30 - 300"
Lens Shift	V: 0 - 75%, H: ±10%
Digital Keystone	V: ±12°, H: ±12°
Throw Ratio <sup>3</sup>	0.56:1

### IMAGE ADJUSTMENTS

Image Modes <sup>5</sup>	Standard / Presentation / Dynamic / Photo / sRGB / Video / User1 / User2 / User3 / User4 / User5 / DICOM SIM
Color Adjustment	Color Level, Color Balance, Color Temperature, Gains of RGB, Offsets of RGB
Screen Color Correction	Normal, Green Board, Adjust
Mounting	Upward, Downward, Table, Ceiling
Adjustable Feet	Bottom Front: 2 places (Maximum Elevation 6°)

### IMAGE SIGNALS

Scanning Frequency	H: 15.734kHz - 75.000kHz, V: 24.000Hz - 60.317Hz
Analog PC Input	WUXGA / UXGA / WSXGA+ / SXGA+ / WXGA+ / FWXGA / WXGA / SXGA / XGA / SVGA / VGA
Digital PC Input	WUXGA / UXGA / WSXGA+ / SXGA+ / WXGA+ / FWXGA / WXGA / SXGA / XGA / SVGA / VGA
Component Video Input	1080p / 1080i / 720p / 576p / 576i / 480p / 480i
Digital Video Input	1080p / 1080i / 720p / 576p / 480p
Dot Clock	162MHz (Maximum)
HDBaseT™	Equivalent to the Input Signals for HDMI Terminal
USB Data Transfer	JPEG Still Images Only

## DIMENSIONS

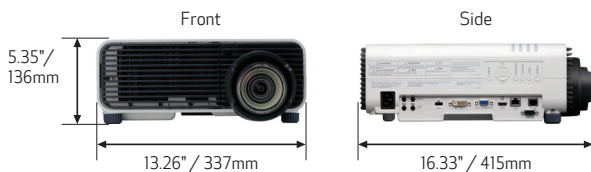

## CONNECTABILITY

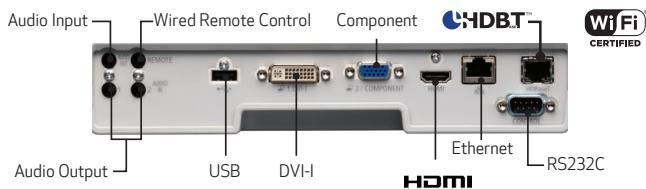

1. Lamp mode is Full power / Power saver. Brightness in Power saver mode is only a calculated value and is not guaranteed as specification. 2. Indicates projectable range, although the optical performance is guaranteed only for 50 - 200 inches. 3. Calculated value for 100 type image. 4. Varies depending on the combination of the HDBaseT™ and network settings. 5. The "DICOM SIM" image mode cannot be used for diagnosis.

© 2016 Canon U.S.A., Inc. All rights reserved. Not responsible for typographical errors. Specifications subject to change without notice. Products not shown to scale. Certain images and effects are simulated. Canon and REALiS are registered trademarks of Canon Inc. in the United States and may also be trademarks or registered trademarks in other countries. DICOM is the registered trademark of the National Electrical Manufacturers Association for its standards publications relating to digital communications of medical information. HDBaseT(TM) and the HDBaseT Alliance logo are trademarks of the HDBaseT Alliance. Wi-Fi and the Wi-Fi CERTIFIED logo are registered trademarks of the Wi-Fi Alliance. All other products and brand names may be registered trademarks, trademarks or service marks of their respective owners in the United States and/or other countries.

REALiS WUX450ST	ITEM CODE: 1204C002AA	UPC CODE: 13803271287
REALiS WUX450ST D	ITEM CODE: 1204C008AA	UPC CODE: 66068515212

### TERMINALS

DVI-I	Digital PC / Analog PC Input
HDMI	Digital PC / Digital Video Input
RJ-45	Network Connection (1000BASE-T / 100BASE-TX / 10BASE-T)
RJ-45 (HDBaseT™)	HDBaseT™ Input (Image, Audio, Control Signal and Network)
Dsub15	Analog PC / Component Video input
Dsub9 (Control)	RS-232 Connection
USB Type A	USB Connection
Mini Jack	Audio Input x2, Audio Output x1
Mini Jack (Remote)	Wired Remote Control Connection

### REMOTE CONTROL

Wireless Remote	Infrared (Supplied) / Wired (Optional)
-----------------	--

### BUILT-IN SOUND

Internal Amplifier	5W, Monaural
--------------------	--------------

### LAMP

Type	Super High Pressure Lamp
Life	3000H / 5000H
Lamp Power <sup>1</sup>	260 / 200W

### RATING

Fan Noise <sup>1</sup>	37 / 30 dB
Power Consumption <sup>1</sup>	365 / 295W
Standby Power <sup>4</sup>	1.8 - 0.2W
Power Voltage	AC100 - 240V : 50/60Hz
Operating Temperature	32°F - 104°F (0°C - 40°C), 20%RH - 85%RH
Storage Temperature	-4°F - 140°F (-20°C - 60°C)
Dimensions (W x H x D)	W: 13.26" (337mm), H: 5.35" (136mm), D: 16.33" (415mm)
Weight	13.88 lbs. (6.3kg)
Projector Warranty	3 Years (Parts and labor)
Lamp Warranty	120 Days

## WHAT'S IN THE BOX

- Projector
- Lens Cap
- Power Cord
- VGA to VGA Connection Cable (Mini Dsub15-Mini Dsub15)
- Projector Remote Control LV-RC06 (includes two AA batteries)
- Quick Start Guide (Book)
- User's Manual (CD-ROM)
- Warranty Card

## ACCESSORIES

ITEM	ITEM CODE
Projector Remote Control RS-RC06	8381B001
Projector Remote Control (Wired) RS-RC05	5750B001
Ceiling Mount RS-CL16	1214C001
Ceiling Extension RS-CL08 (16" - 24")	3096B001
Ceiling Extension RS-CL09 (24" - 39")	3097B001
Replacement Lamp RS-LP08	8377B001
Replacement Air Filter RS-FL02	8379B001
Optional Feet RS-F01 (Pack of Four)	8380B001