



ENGLISH

DEUTSCH

FRANÇAIS

ITALIANO

ESPAÑOL

PORTUGUESE

ΕΛΛΗΝΙΚΑ

NEDERLANDS

SVENSKA

NORSK

SUOMI

DANSK

POLSKI

ČESKÝ

SLOVENČINA

MAGYAR

ROMÂNĂ

БЪЛГАРСКИ

SPRSKI

SLOVENŠČINA

HRAVATSKI

SHQIP

МАКЕДОНСКИ

EESTI

LATVIJAS

LIETUVOS

OWNER'S MANUAL

REFRIGERATOR- FREEZER

Please read this owner's manual thoroughly before operating and keep it handy for reference at all times.

Table of Contents

2 Additional Information Of The Manual

2 Registration

3 Important Safety Instructions

3 Basic Safety Precautions

6 Installation

6 Appliance Usage Range

6 Starting

7 Climate Class

7 Operation

7 Identification of Parts

7 Max Freezing Capacity

7 Freezer Compartment

7 Fresh Converter

8 Folding Glass Shelf

8 Fresh Balancer

9 Suggestion For Energy Saving

9 Cleaning

9 Before Cleaning

9 Exterior

9 Interior

9 After Cleaning

9 Drip Tray

9 Exterior Dispenser

9 Water Tank

10 Cap Assembly Tank & Cap Tank

10 Smart Diagnosis™ (Optional)

11 Tag On Function (Optional)

11 High Temperature alarm

11 Disposal Of Your Old Appliance

Additional Information Of The Manual

Viewing the owner's manual

The owner's manual in a PDF format is supplied on a CD.

Install the Adobe Acrobat Reader to view the owner's manual on your PC.

1. Insert the supplied CD. The web page appears automatically.
2. Click Owner's Manual on the web page.
3. View the owner's manual.

If the web page does not appear automatically, access My computer and then click LG and index.htm to view the owner's manual.

Registration

The model and serial number are found on the rear (or side) of this unit. This number is unique to this unit and not available to others. You should record requested information here and retain this guide as a permanent record of your purchase. Staple your receipt here.

Date of Purchase : _____

Dealer Purchased From : _____

Dealer Address : _____

Dealer Phone No. : _____

Model No. : _____

Serial No. : _____

Important Safety Instructions

Basic Safety Precautions

This guide contains many important safety messages. Always read and obey all safety messages.

This is the safety alert symbol. It alerts you to safety messages that inform you of hazards that can kill or hurt you or others or cause damage to the product. All safety messages will be preceded by the safety alert symbol and the hazard signal word DANGER, WARNING, or CAUTION. These words mean:



DANGER

You will be killed or seriously injured if you don't follow instructions.



WARNING

You can be killed or seriously injured if you don't follow instructions.



CAUTION

Indicates an imminently hazardous situation which, if not avoided, may result in minor or moderate injury, or product damage only.

All safety messages will identify the hazard, tell you how to reduce the chance of injury, and tell you what can happen if the instructions are not followed.



WARNING

Before it is used, this refrigerator must be properly installed and located in accordance with the installation instructions in this docu-

ment. This Refrigerator is intended for Domestic indoor use only.

Never unplug your refrigerator by pulling on the power cord. Always grip plug firmly and pull it straight out from the outlet.

When moving your appliance away from the wall, be careful not to roll over the power cord or to damage it in any way.

After your refrigerator is in operation, do not touch the cold surfaces in the freezer compartment, particularly when your hands are damp or wet. Skin could adhere to these extremely cold surfaces.

Unplug the power cord from the power outlet for cleaning or other maintenance. Never touch the appliance with wet hands as you may receive an electric shock or injure yourself.

Never damage, press, severely bend, pull or twist the power cord as damage to the cord may cause a fire or electric shock. Never touch the cord if you are uncertain if the appliance is correctly earthed.

The fuse on the refrigerator must be changed by a qualified technician or service company.

- Failing to do so may result in electric shock or personal injury.

Never place glass items in the

freezer as they may break due to expansion of their contents on freezing.

Never put your hands into the storage bin of the automatic ice maker as you could be injured during its operation.

Never allow anyone to climb, sit, stand or hang on the refreshment centre door. These actions may damage the refrigerator and even tip it over, causing severe personal injury.

It is advised that this appliance should be connected through an independent power socket to prevent it and other appliances from overloading the circuit and causing a power outage.

The appliance should be positioned so that the supply plug is easily accessible for quick disconnection should an accident occur.

If the supply cord is damaged, it must be replaced by the manufacturer or its service agent or a similarly qualified person in order to avoid a hazard.

WARNING

Do not modify or extend the Power Cord length. It may cause electric shock or fire.

Connect the power plug in proper position with the cord hanging

down.

- If you connect the power plug upside down, wire can get cut off and cause fire or electric shock.

Make sure that the power plug is not squashed or damaged by the back of the refrigerator.

 **DANGER** : Risk of child entrapment.

Before you dispose of your old refrigerator please remove doors but leave the shelves in place so that children cannot climb inside.

This appliance can be used by children aged from 8 years and above and persons with reduced physical, sensory or mental capabilities or lack of experience and knowledge if they have been given supervision or instruction concerning use of the appliance in a safe way and understand the hazards involved.

Children shall not play with the appliance.

Cleaning and user maintenance shall not be made by children without supervision.

 Do not store or use gasoline or other flammable vapour and liquids in the vicinity of this or any other appliance.

 In the event of an electric short circuit, grounding (earthing) reduces the risk of electric shock

by providing an escape wire for the electric current.

In order to prevent possible electric shock this appliance must be earthed. Improper connection of the earthing plug can cause electric shock. Consult a qualified electrician or service engineer if the earthing instructions are not completely understood, or if you have doubts as to whether the appliance is properly earthed.

Do not move refrigerator while the refrigerator is operating. Compressor may occur a temporary rattling noise.

(This is normal and will not impact on the performance or the life of the compressor. The rattling will stop after the refrigerator comes to a rest.)

WARNING

- Keep ventilation openings in the room where the appliance is installed clear of obstruction.
- Do not use mechanical devices or other means to accelerate the defrosting process, other than those recommended by the manufacturer.
- Do not damage the refrigerant circuit.
- Do not use electrical appliances inside the food storage compartments of the appliance, unless they are of the type recommended by the manufacturer.

WARNING

- Disposal procedures. If disposing of this appliance, please consult with a service agent or a similarly qualified person for more details.
- Do not store explosive substances such as aerosol cans with a flammable propellant in this appliance.
- Do not use aerosols near the refrigerator.
 - Aerosols used near the refrigerator may cause an explosion or fire.



This appliance contains a small amount of isobutane refrigerant (R600a), natural gas with high environmental compatibility, but it is also combustible. When transporting and installing the appliance, care should be taken to ensure that no parts of the refrigerating circuit are damaged. Refrigerant squirting out of the pipes could ignite or cause an eye injury. If a leak is detected, avoid any naked flames or potential sources of ignition and air the room in which the appliance is standing for several minutes. In order to avoid the creation of a flammable gas air mixture if a leak in the refrigerating circuit occurs, the size of the room in which the appliance may be sited depends on the amount of refrigerant used. The room must be 1m² in size for every 8g of R600a refrigerant inside the appliance. The amount of refrigerant in your particular appliance is shown on the identification plate inside the appliance. Never start up an appliance showing any signs of damage. If in doubt, consult your dealer.

Installation

1. Select a good location. Place your fridge-freezer where it is easy to use.
2. Avoid placing the unit near heat sources, direct sunlight or moisture.
3. To ensure proper air circulation around the fridge-freezer, please maintain sufficient space on both the sides as well as top and maintain at least 2 inches (5cm) from the rear wall.
4. To avoid vibration, the unit must be leveled. If required, adjust the leveling screws to compensate for the uneven floor. The front should be slightly higher than the rear to aid in door closing. Leveling screws can be turned easily by tipping the cabinet slightly. Turn the leveling screws counterclockwise (↺) to raise the unit, clockwise (↻) to lower it.
5. Clean your fridge-freezer thoroughly and wipe off all dust accumulated during shipping.
6. Install accessories such as ice cube box, etc., in their proper places. They are packed together to prevent possible damage during shipment.
7. Connect the power supply cord (or plug) to the outlet. Don't double up with other appliances on the same outlet.

Appliance Usage Range

This appliance is intended to be used in household and similar applications such as:

- staff kitchen areas in shops, offices and other working environments;
- farm houses and by clients in hotels, motels and other residential type environments;
- bed and breakfast type environments;
- catering and similar non-retail applications

Starting

When your fridge-freezer is installed, allow it 2-3 hours to stabilize at normal operating temperature prior to filling it with fresh or frozen foods. If power plug is disconnected, allow 5 minutes delay before restarting. Your fridge-freezer is now ready for use.

Climate Class

The appliance is designed to operate at the limited range of ambient temperature, depending on climate zones. Do not use the appliance at the temperature out of the limit. Climate class of your appliance is indicated on the label with technical description inside the fridge compartment.

Class	Symbol	Ambient temperature range °C
Extended Temperate	SN	+10 ~ +32
Temperate	N	+16 ~ +32
Subtropical	ST	+16 ~ +38
Tropical	T	+16 ~ +43

Operation

Identification of Parts

Refer to Refrigerator drawings at the end of the manual.

If you find some parts missing from your unit, they may be parts only used in other models.

- 8 Bottle Rack
- 9 Removable Glass Shelf
- 10 Folding Glass Shelf
- 11 Custom Chill Regulator
- 12 Fresh Balancer
- 13 Vegetable Drawer (Used to store fruits and vegetables etc. fresh and crispy)
- 14 Custom Chill Drawer
- 15 Ice Tray
- 16 Freezer Tray
- 17 Wire Shelf
- 18 Freezer Drawer
- * The process of freezing occurs the fastest on the marked shelf
- 19 Leveling Screw
- 20 Basket Door
- 21 Water Tank
- 22 Egg Tray
- 23 Dairy Corner / Basket Door
- 24 Smart Diagnosis™
- 25 LED Lamp

Max Freezing Capacity

If there is already food in the compartment, please set freezer to the coldest condition (-23°C) and press on "Express Frz." button several hours before placing fresh produce in the freezer compartment to get maximum capacity. As a rule 7 hours is adequate.

Freezer Compartment

If a large quantity of food is to be placed in the freezer compartment,

1. The upper drawer of freezer compartment, twist ice maker kit shall be taken out of the appliance and the food shall be stacked directly on the wire shelf.
2. The middle drawer of freezer compartment shall be taken out of the appliance and food shall be stacked directly on the wire shelf.

Freezer compartment provides wire shelf on default to maximize food storage capacity. And also the drawer is provided to convenient usage for watery meat or half-liquid state food.

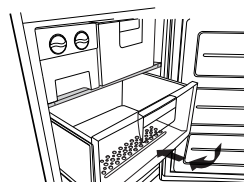

Fresh Converter

Fresh Converter storage compartment can control the temperature by adjusting the position of the temperature knob and generally its temperature is maintained lower than the set-up temperature of the refrigerator.

Under normal condition, middle position is recommended.

When keeping vegetables after setting up 'Meat' or 'Fish', the cold injury may occur.

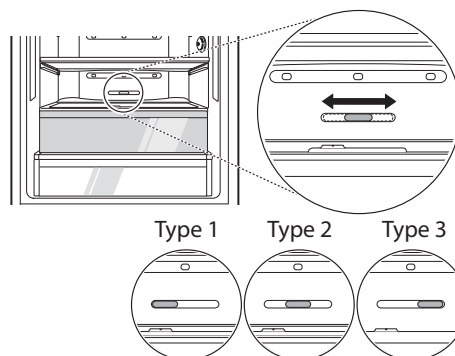

Open state : Move knob to the left(type1)
 Closed state : Move knob to the right(type3)
 Recommended state : Middle position(type2)

Folding Glass Shelf

For putting high items into the fridge, it is necessary:

Type 1:

Lift the front side of the shelf and shift it on its back side. To restore the shelf to its initial position, pull it to yourselves.

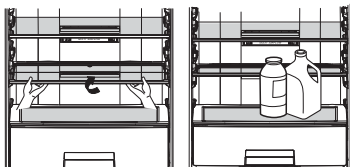

Type 2:

Lift the front side of the shelf and shift it under its back side.

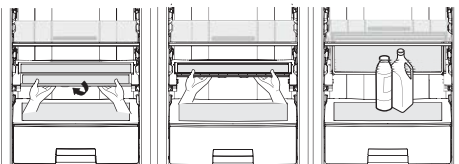

From this position, both sides of the shelf can be lifted up to free more space.

To restore the shelf to its initial position, draw down two sides and pull the lower side to yourselves.

How To Remove Shelf From Fridge

- Lift the front side of the shelf and shift it under its back side;
- Remove both sides from the frame by lifting them up;
- Lift up the shelf frame and pull it to yourselves.

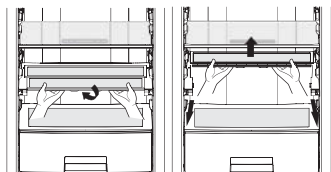

For installing the shelf into the fridge, carry out the same actions in the reverse order.

Fresh Balancer

Vegetable compartment can adjust the humidity by moving the knob.

If moved to the left side, cover and tray are opened, and if moved to the right side, cover and tray are closed – therefore, it can maintain the humidity.

Closed state is recommended for keeping vegetables, and open state is recommended for keeping fruits.

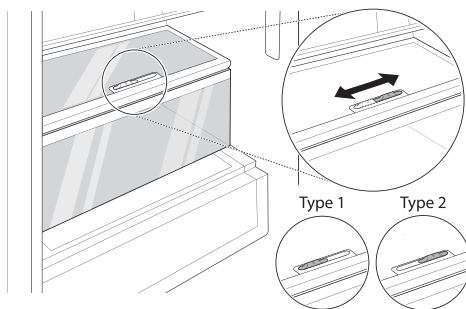

Suggestion For Energy Saving

- Please do not keep the door open for a long time, close door in the shortest time.
- Too much food are not advised to be put in. Enough space should be kept for cool air circulating freely.
- Do not set the temperature of fridge-freezer lower than needed. Do not put the food near the temperature sensor. Keep the distance of at least 5mm from the sensors.
- Allow hot food to cool prior to storing. Placing hot food in the fridge-freezer could spoil other food, and lead to higher electric bills.
- Do not block air vents with food. Smooth circulation of cold air keeps fridge-freezer temperature even.
- Do not open the door frequently. Opening the door lets warm air enter the fridge-freezer, and cause temperature to rise.
- To keep a position of inner parts like as baskets, drawers (Fridge), shelves and wire shelves Supplied by manufacturer is the most efficient usage for energy saving.

Cleaning

Before Cleaning

Be sure to unplug the power.

Exterior

Clean the outside of the fridge-freezer with a soft cloth soaked with hot water or liquid detergent. If you use a detergent, be sure to wipe it with a clean wet cloth.

Interior

Same as above.

After Cleaning

Check that the power cord is not damaged, power plug has not overheated, and that the power plug is tightly inserted into the outlet.

WARNING

Be sure to dry the appliance with a cloth after washing it with water.

Do not use abrasive, petroleum, benzene, thinner, hydrochloride acid, boiling water, rough brush, etc, as they may damage parts of the fridge-freezer.

Drip Tray

Wipe moisture out around the door part and the drip tray using a clean cloth.

Exterior Dispenser

Wipe moisture out of dispenser and on the dispenser pad using a cloth.

Water Tank

1. Turn the knob shutter to open. And pull out the water tank assembly.
2. After unlocking the clamp and remove it, clean and fully rinse the inside/outside part of the water tank by using neutral cleansing agent.

Cap Assembly Tank & Cap Tank

Clean and fully rinse the cap assembly tank & cap tank by using neutral cleansing agent. Especially for the groove part of the cap tank, it is convenient to cleanse it by using a small brush.

CAUTION

Don't separate the screw and tube from the cap assembly tank. Please clean the out surface.

Smart Diagnosis™ (Optional)

Should you experience any problems with your refrigerator, it has the capability of transmitting data via your telephone to the LG service center. This gives you the capability of speaking directly to our trained specialists. The specialist records the data transmitted from your machine and uses it to analyze the issue, providing a fast and effective diagnosis.

If you experience problems with your refrigerator, call to the LG service center. Only use the Smart Diagnosis feature when instructed to do so by the LG call center agent. The transmission sounds that you will hear are normal and sound similar to a fax machine.

Smart Diagnosis cannot be activated unless your refrigerator is connected to power. If your refrigerator is unable to turn on, then troubleshooting must be done without using Smart Diagnosis.

First, call to the LG service center. Only use the Smart Diagnosis feature when instructed to do so by the LG call center agent.

1. Lock the display. To lock the display, press and hold the Lock button for three seconds. (If the display has been locked for over five minutes, you must deactivate the lock and then reactivate it.)
2. Open the refrigerator door.
3. Press and Hold the 'Freezer' button for 3 seconds.



NOTE

If the door has been opened for over one minute, you must close the door and start again No.1

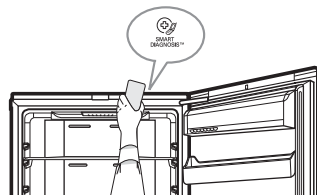

4. Following the instructions of the operator, hold the phone's microphone close to the icon «Smart Diagnosis».
5. Hold the phone in the position until the end of the sound data transfer.
6. Keep the phone in place until the tone transmission has finished. This takes about 3 second. Resume your conversation with the specialist, who will then be able to assist you in using the information transmitted for analysis.

NOTE

- For best results, do not move the phone while the tones are being transmitted.
- If the call center agent is not able to get an accurate recording of the data, you may be asked to try again.
- Call quality differences by region may affect the function.
- Use the home telephone for better communication performance, resulting in better service.
- Bad call quality may result in poor data transmission from your phone to the machine, which could cause Smart Diagnosis to not work properly.

Tag On Function (Optional)

Using the Tag On Function(Optional)

Conveniently use the LG Smart Diagnosis™ and Cycle Download features to communicate with the appliance right from a smart phone.

The Tag On function can only be used with most smart phones equipped with the NFC (Near Field Communication) function and based on the Android OS (operating system).

Installation of the Application

Search for the LG Smart ThinQ application from the Google Play Store on a smart phone.

Product Registration

1. Run the LG Smart ThinQ application on a smart phone.
2. Create an account and sign in.
3. Select Register.
4. Select Refrigerator.
5. Follow the instruction on the smart phone. If you see a pop-up message about NFC, turn on the NFC function in the smart phone.
6. Firmly attach the smartphone to the Tag On logo. If you can not make a connection, then move the smart phone up and down slowly.

EU Conformity Notice



Hereby, LG Electronics European Shared Service Center B.V., declares that this Refrigerator-Freezer is compliant with the essential

requirements and other relevant provisions of Directive 1999/5/EC. The complete Declaration of Conformity may be requested through the following postal address:

LG Electronics European Shared Service Center B.V.
Krijgsman 1
1186 DM Amstelveen
The Netherlands

or can be requested at our dedicated DoC website:
<http://www.lg.com/global/support/cedoc/cedoc#>



High Temperature alarm

- When the freezer temperature is high, because of power failure, the freezer temperature LED blinks and alarm sounds.
- Press Freezer button to stop. Or the blinking and sound will automatically stop if the temperature is sufficiently cold.
- This function could occur:
 - When the refrigerator is turned on.
 - When the freezer compartment is too warm
 - When there is a power outage during long period
 - When large amounts of warm food are placed in freezer
 - When the freezer door is open too long or too frequently.

Disposal Of Your Old Appliance



1. All electrical and electronic products should be disposed of separately from the municipal waste stream via designated collection facilities appointed by the government or the local authorities.
2. The correct disposal of your old appliance will help prevent potential negative consequences for the environment and human health.
3. For more detailed information about disposal of your old appliance, please contact your city office, waste disposal service or the shop where you purchased the product.

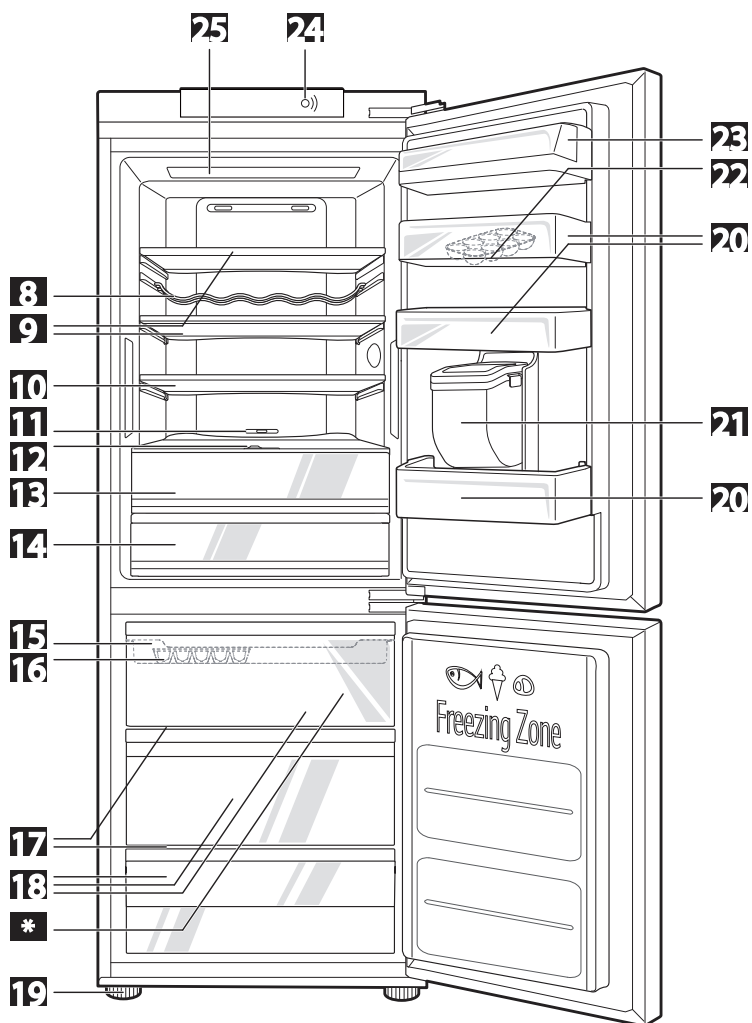

Model:

GB*60Z**, GB*60**Y**, GB*60**G**, GB*60**F****

GB*59Z**, GB*59**Y**, GB*59**G**, GB*59**F****

GBD6*8**, GBD6*5****,**

GBF6*8**, GBF6*5******

GB6*4****

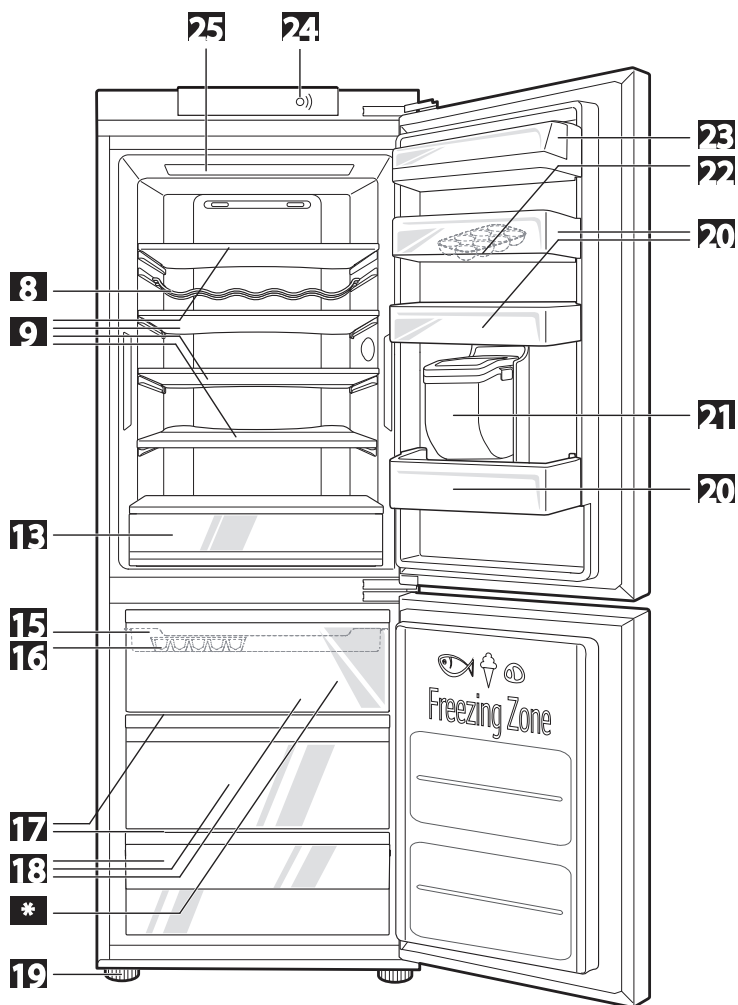

Model:

GB*60**D**, GB*60**E**, GB*60**J**, GB*60**K**, GB*60**R**
 GB*59**D**, GB*59**E**, GB*59**J**, GB*59**K**, GB*59**R**
 GBD6*3****, GBD6*2****, GBF6*2****, GBH6*1****,
 GB6*3****, GB6*1****, GB6*0****

LG Customer Information Centre

For inquiries or comments, visit www.lg.com or call;



DEUTSCHLAND	01806 11 54 11
BELGIQUE	015 200 255
LUXEMBOURG	0032 15 200 255
NEDERLAND	0900 543 5454
ITALIA	199 600 099
ESPAÑA	963 050 500
ČESKO	810 555 810
SLOVENSKO	0850 111 154
PORTUGAL	808 78 54 54
ROMÂNIA	031 228 35 42
LIETUVA	8 8000 8081
LATVIJA	8 0200 201
EESTI	800 9990
ΕΛΛΑΔΑ	801-11-200-900
ΚΥΠΡΟΣ	8000 0810
POLSKA	0801 54 54 54 022 454 54 54
РОССИЯ	8-800-200-76-76
ÖSTERREICH	0 810 144 131
SCHWEIZ	0848 543 543
SRBIJA	011 36 30 500
SVERIGE	0770 54 54 54
NORGE	815 691 54
DANMARK	78 79 64 54
SUOMI	0800 0 54 54
MAGYARORSZÁG	0 640 54 54 54
HRVATSKA	(01) 553 55 54
BOSNA	(033) 911 811
SLOVENIJA	080 543 543
БЪЛГАРИЯ	0 7001 54 54

Register your product Online!

www.lg.com



P.No: MFL69349601

The model and serial number of the refrigerator is located on the back or one side of the refrigerator. Record it below should you ever need service.

MODEL _____
SERIAL _____

Manufacturer address:

LG Electronics Wrocław Sp. z o. o.,
ul. LG Electronics 1-2, Biskupice Podgórne,
55-040 Kobierzyce, Poland.