

## Battery Replacement Instructions

K01-0000459-01

### Smart App Online RT 1-3KVA Series

MODEL: OL1000RTXL2U, OL1500RTXL2U, OL2200RTXL2U, OL3000RTXL2U, OL3000RTXL2UHV, OL1000ERTXL2U, OL1500ERTXL2U, OL2000ERTXL2U, OL3000ERTXL2U, OL1000RT JP, OL1500RT JP, OL2200RT JP, OL3000RT JP

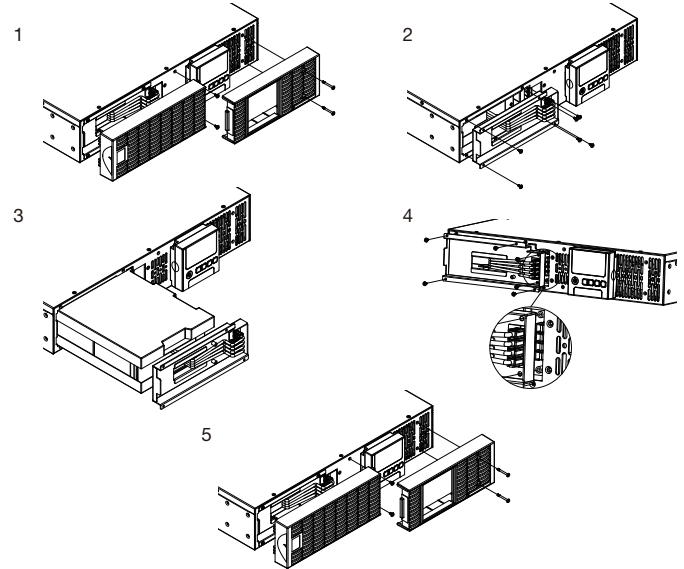

1. Remove the front faceplates.
2. Remove the screws securing the battery retention panel.
3. Pull the battery pack out together with the retention panel slowly and then put the new battery pack back into the UPS.
4. Reconnect the battery pack connectors to the UPS. Then tighten the screws of the battery retention panel.
5. Reinstall the front faceplates.

### Smart App Online Tower 1-3KVA Series

MODEL: OL1000XL, OL1500XL, OL2200XL, OL3000XL, OL1000EXL, OL1500EXL, OL2000EXL, OL3000EXL, OL1000XL JP, OL1500XL JP, OL2200XL JP, OL3000XL JP

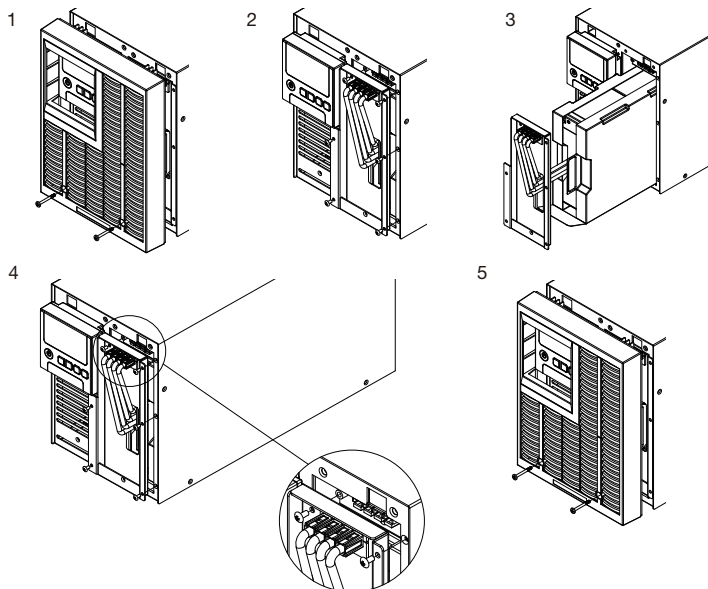

1. Remove the front faceplates.
2. Remove the screws securing the battery retention panel.
3. Pull the battery pack out together with the retention panel slowly and then put the new battery pack back into the UPS.
4. Reconnect the battery pack connectors to the UPS. Then tighten the screws of the battery retention panel.
5. Reinstall the front faceplates.

### Smart App Online EBM for RT 1-1.5KVA Series

MODEL: BP36V60ART2U, BPE36V60ART2U, BPE36V60ART2US

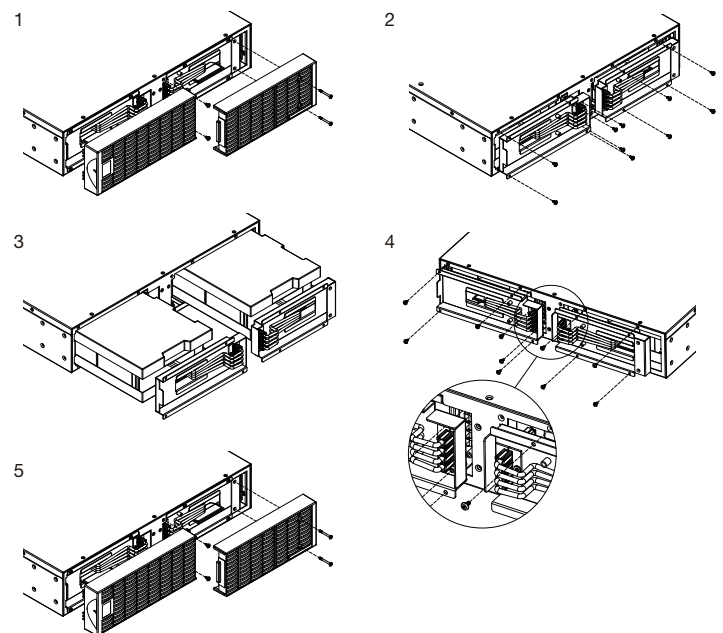

1. Remove the front faceplates.
2. Remove the screws securing the battery retention panels.
3. Pull the battery packs out together with the retention panels slowly and then put the new battery packs back into the EBM.
4. Reconnect the battery pack connectors to the EBM enclosure. Then tighten the screws of the battery retention panel.
5. Reinstall the front faceplates.

## Smart App Online EBM for RT 2-3KVA Series

MODEL: BP72V60ART2U, BPE72V60ART2U, BPE72V60ART2US

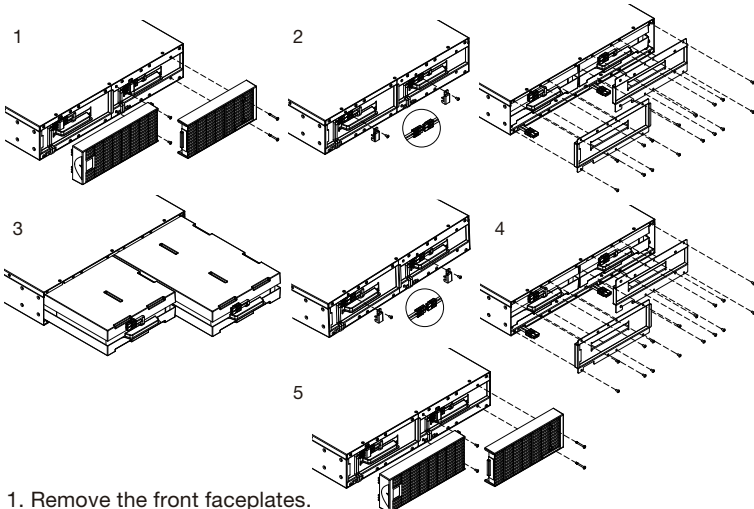

1. Remove the front faceplates.
  2. Remove the screws securing the battery retention panels. Unscrew the battery connector retention hardware. Disconnect the battery power cables and then remove the panel itself.
  3. Pull the battery packs out slowly and then put the new battery packs back into the compartment.
  4. Reconnect the battery pack to the EBM enclosure and screw on the battery connector retention hardware. Tighten the screws of the battery retaining cover.
- WARNING** - It is very important to reconnect battery connections with the correct polarity. Connectors are color coded red and black for positive and negative polarity respectively. Permanent damage may be caused to the equipment if polarity is reversed.
5. Reinstall the front faceplates.

## Smart App Online RT 6-10KVA Series

MODEL: BP240V30ART3U, BP240V50ART3U, BPE240V30ART3U, BPE240V50ART3U, BPE240V30ART3US, BPE240V50ART3US

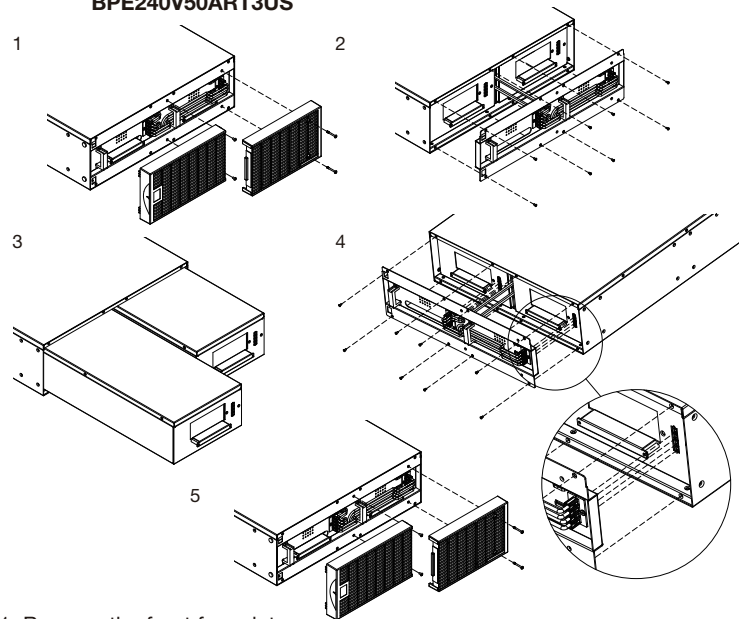

1. Remove the front faceplates.
2. Remove the screws securing the battery retention panel.
3. Raise the battery retention panel above the battery compartment opening to allow the battery trays to be pulled out. Then put the new battery trays into the compartment.
4. Align and reconnect the battery connectors and tighten the screws of the battery retention panel.
5. Reinstall the front faceplates.

## Smart App Online Tower 6-10KVA Series

MODEL: OL6000, OL8000, OL10000, OL6000E, OL8000E, OL10000E

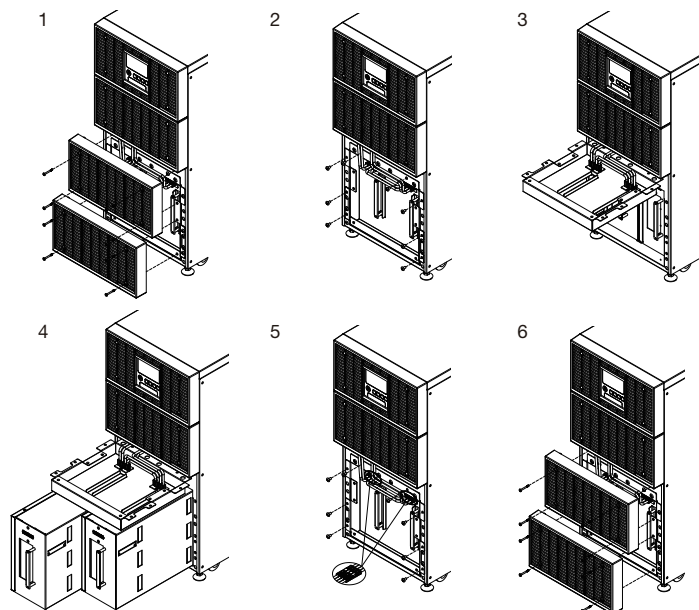

1. Remove the front faceplates.
2. Remove the screws securing the battery retention panel.
3. Raise the battery retention panel above the battery compartment opening to allow the battery trays to be pulled out.
4. Pull the battery trays out slowly and then put the new battery trays back into the compartment.
5. Reconnect the battery connectors and tighten the screws of battery retention panel.
6. Reinstall the front faceplates.

Replacement Battery Pack Table

Model Name	Battery QTY	UPS or EBM Model
RB1290X3L	3	OL1000RTXL2U OL1500RTXL2U BP36V60ART2U (LEFT)
RB1290X3R	3	BP36V60ART2U (RIGHT)
RB1290X3A	3	OL1500XL
RB1290X6A	6	OL2200RTXL2U OL3000RTXL2U OL3000RTXL2UHV
RB1290X6B	6	BP72V60ART2U
RB1290X6C	6	OL3000XL
RB1290X10	10	BP240V50A BP240V50ART3U OL8000 OL10000
RB1270X10	10	BP240V30A BP240V30ART3U OL6000
RB1270X6	6	OL2200XL

**CyberPower®**

**CyberPower Systems, Inc.**

[www.cyberpower.com](http://www.cyberpower.com)

**For USA and Canada:**

4241 12th Ave East, Suite 400

Shakopee, MN 55379

Toll-free: (877) 297-6937

**For all other regions:**

Please visit our website for local contact information.