

# AMW 730/IX

12NC: 858773001900

EAN code: 8003437394768



SENSING THE DIFFERENCE

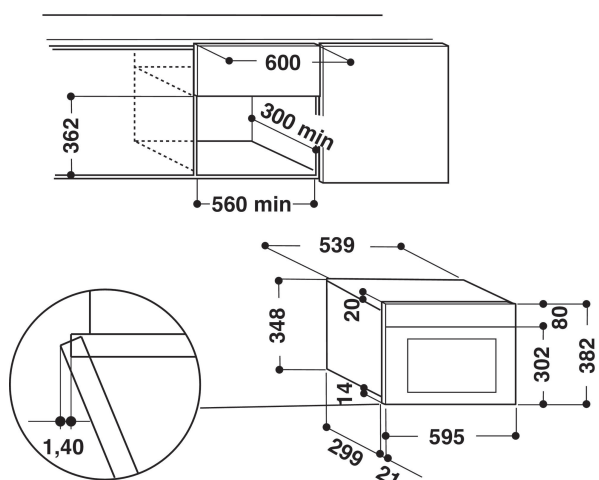

## MAIN FEATURES

|  |                   |
|--|-------------------|
| Product group                                  | Microwave         |
| Commercial code                                | AMW 730/IX        |
| Main colour of product                         | Stainless steel   |
| Type of micro-wave oven                        | MW+Grill function |
| Construction type                              | Built-in          |
| Type of control                                | Electronic        |
| Type of control setting and signalling devices | LCD               |
| Additional cooking method Grill                | Yes               |
| Crisp  | Yes               |
| Steam  | No                |
| Additional cooking method Fan cooking          | No                |
| Clock  | Yes               |
| Automatic programmes                           | Yes               |
| Height of the product                          | 385               |
| Width of the product                           | 595               |
| Depth of the product                           | 468               |
| Minimum niche height                           | 380               |
| Minimum niche width                            | 556               |
| Niche depth                                    | 550               |
| Net weight (kg)                                | 27                |
| Cavity capacity (l)                            | 31                |
| Turntable                                      | Yes               |
| Turntable diameter (mm)                        | 325               |
| Integrated Cleaning system                     | No                |

## TECHNICAL FEATURES

|                                       |                 |
|---------------------------------------|-----------------|
| Current (A)                           | 10              |
| Voltage (V)                           | 230             |
| Frequency (Hz)                        | 50              |
| Length of Electrical Supply Cord (cm) | 135             |
| Plug type                             | No              |
| Timer                                 | Minute minder   |
| Grill power (W)                       | 800             |
| Type of grill                         | Quartz          |
| Cavity material                       | Stainless steel |
| Interior light                        | Yes             |
| Additional cooking method Grill       | Yes             |
| Position of interior lights           | Right side      |

## PERFORMANCES

|                                  |           |
|----------------------------------|-----------|
| 6th Sense / Dynamic Intelligence | 6th Sense |
| Number of power levels           | 8         |
| Maximum micro-wave power (W)     | 1000      |
| Bread defrost                    | No        |
| Jet defrost                      | Yes       |
| Jet start                        | Yes       |