



RS554NRUA\*\*  
RS552NRUA\*\*  
SRS583NLS  
SRS582WW  
SRS603HLS

# Refrigerator

## user manual

Free Standing Appliance

English

imagine the possibilities

Thank you for purchasing a Samsung product.  
To receive a more complete service,  
please register your product at  
[www.samsung.com/register](http://www.samsung.com/register)

条形码

DA68-02556B-15

**SAMSUNG**

# features of your new refrigerator

---

## KEY FEATURES OF YOUR NEW REFRIGERATOR

---

Your Samsung Refrigerator comes equipped with various innovative storage and energy-efficient features.

- **Inverter compressor**

Its imported high effective inverter compressor reduces power consumption of the refrigerator, lowers noise while operation, operates different states at different frequency, and is advantageous in freezing capacity and cooling speed.

- **Home bar (Optional)**

With soft touch type Home Bar, just push and catch to open or close with latch and damping system. Now you can enjoy fashionable living.

- **Twin Cooling System**

The Refrigerator and Freezer have separate evaporators. Due to this independent cooling system, the Freezer and Refrigerator cool more efficiently.

- **Tempered glass door (Optional)**

Show unbeatable luxury.

---

## SAMSUNG

For easy future reference, write the model and serial number down.  
You will find your model number and serial number on side or rear of the refrigerator.

Model # \_\_\_\_\_

Serial # \_\_\_\_\_

# safety information

## SAFETY INFORMATION



**WARNING**

- Before operating the appliance, please read this manual thoroughly and retain it for your reference.



**WARNING**

- Because these following operating instructions cover various models, the characteristics of your refrigerator may differ slightly from those described in this manual.

### CAUTION/WARNING SYMBOLS USED

 <b>WARNING</b>	Indicates that a danger of death or serious injury exists.
 <b>CAUTION</b>	Indicates that a risk of personal injury or material damage exists.

### OTHER SYMBOLS USED

	Represents something you must NOT do.
	Represents something you must NOT disassemble.
	Represents something you must NOT touch.
	Represents something you must follow.
	Indicates that you must disconnect the power plug from the socket.
	Represents a ground is needed to prevent electric shock.
	It is recommended that this symbol be handled by service man.

**These warning signs are here to prevent injury to you and others.**

**Please follow them explicitly.**

**After reading this section, keep it in a safe place for future reference.**

- This refrigerator must be properly installed and located in accordance with the manual before it is used.
- Use this appliance only for its intended purpose as described in this user manual.
- We strongly recommend that any servicing be performed by a qualified individual.
- R600a/R134a can be used as a refrigerant. Check the compressor label or the circuit diagram on the rear of the appliance to see which refrigerant is used for the refrigerator



- In case of R600a refrigerant, this gas is natural gas with high environmental compatibility that is, however, also combustible. When transporting and installing the appliance, care should be taken to ensure that no parts of the refrigerating circuit are damaged.
- Refrigerant squirting out of the pipes could ignite or cause an eye injury. If a leak is detected, avoid any naked flames or potential sources of ignition and air the room in which the appliance is standing for several minutes.

# safety information

---



## WARNING

- In order to avoid the creation of a flammable gas-air mixture if a leak in the refrigerating circuit occurs, the size of the room in which the appliance may be sited depends on the amount of refrigerant used.
- The room must be 1m<sup>3</sup> in size for every 8g of R600a refrigerant inside the appliance.
- Never start up an appliance showing any signs of damage. If in doubt, consult your dealer.
- Please dispose of the packaging material for this product in an environmentally friendly manner
- Do not change the parts in the refrigerator at random.



## SEVERE WARNING SIGNS

---



## WARNING

- Do not install the refrigerator in a damp place or place where it may come in contact with water.
  - Deteriorated insulation of electrical parts may cause an electric shock or fire.
- Do not place this refrigerator in direct sunlight or expose to the heat from stoves, room heaters or other appliance.
- Do not place a lighted candle or open flames on the refrigerator.
  - This may result in electric shock or fire.
- Allow sufficient space to install the refrigerator on a flat surface.
  - If your refrigerator is not level, the internal cooling system may not work correctly.
- Use 220~240V power. Do not plug several appliances into the same multiple power board. The refrigerator should always be plugged into its own individual electrical which has a voltage rating that matched the rating plate. The refrigerator must be grounded.
  - This provides the best performance and also prevents overloading house wiring circuits, which could cause a fire hazard from overheated wires.
- Never unplug your refrigerator by pulling on the power cord. Always grip plug firmly and pull straight out from the outlet.
  - Damage to the cord may cause a short-circuit, fire and/or electric shock.
- Make sure that the power plug is not squashed or damaged by the back of the refrigerator.
- Do not bend the power cord excessively or place heavy articles on it.
  - This constitutes a fire hazard.
- Do not use a loose socket or a cord that shows cracks or abrasion damage along its length or at either end.
- If the power cord is damaged, have it replaced immediately by the manufacturer or its service agent.
- When moving the refrigerator, be careful not to roll over or damage the power cord.
- Do not insert the power plug with wet hands.
- Disconnect the power before cleaning or maintaining your refrigerator.
  - Do not use a wet or damp cloth when cleaning the plug.
- Remove any foreign matter or dust from the power plug pins.
  - Otherwise there is a risk of fire.
- If the refrigerator is disconnected from the power supply, you should wait for at least ten minutes before plugging it back.
- If the wall socket is loose, do not insert the power plug.
  - There is a risk of electric shock or fire.
- The appliance must be positioned so that the plug is accessible after installation.
- Do use separate and reliable earthing power. Don't share a socket with other appliances. In order to ensure safety, the socket and its connecting wire must be able to bear over 10A current.

-  • The refrigerator must be grounded.
  - You must ground the refrigerator to prevent any power leakages or electric shocks caused by current leakage from the refrigerator.
-  • Never use gas pipes, telephone lines or other potential lightening rods as ground.
  - Improper use of the ground plug can result in electric shock.
-  • Do not disassemble or repair the refrigerator by yourself.
  - You run risk of causing a fire, malfunction and/or personal injury.
- If you smell pharmaceutical or smoke, pull out power plug immediately and contact your Samsung electronics service center.
- Keep ventilation opening in the appliance enclosure or mounting structure clear of obstruction.
- Do not use mechanical devices or any other means to accelerate the defrosting process, other than those recommended by the manufacturer.
- Don't dismantle, repair or adapt structure of the refrigerator unadvisedly; otherwise, its refrigeration system may be damaged. Do not damage the refrigerant circuit.
- Do not place or use electrical appliance inside the refrigerator/freezer, unless they are of a type recommended by the manufacturer.
- Don't put a dryer in the refrigerator for drying.
- Do not replace LED lamp privately and please contact the specialized repair staff if necessary.
- Children can't use the refrigerator without supervision.
- Children should be supervised to ensure that they do not play with the appliance.
- The appliance is not to be used by persons (including children) with reduced physical, sensory or mental capabilities, or lack of experience and knowledge, unless they have been given supervision or instruction concerning use of the appliance by a person responsible for their safety.
- Do not let children hang on the door. If not, a serious injury may occur.
- Do not touch the inside walls of the freezer or products stored in the freezer with wet hands.
  - This may cause frostbite.
- If the refrigerator is not to be used for a long period of time, pull out the power plug.
  - Deterioration in the insulation may cause fire.
- Do not store articles on the top of the appliance.
  - When you open or close the door, the articles may fall and cause personal injury and/or material damage.

## CAUTION SIGNS

---



- Before the refrigerator is put into use, its leveling legs must be adjusted to contact the ground, and the refrigerator must be leveled, so as to avoid tilting.
- This product is intended only for the storage of food in a domestic environment.
- Manufacturer's recommended storage times should be adhered to. Refer to relevant instructions.
- Bottle should be stored tightly together so that they do not fall out.
- Don't store any carbonated drink or soda water in the freezer.
- Do not overfill the refrigerator with food.
  - When you open the door, an item may fall out and cause personal injury or material damage.
- Do not put bottles or glass containers in the freezer.
  - When the contents freeze, the glass may break and cause personal injury.
- Do not spray inflammable gas near the refrigerator.
  - There is a risk of explosion or fire.
- Do not directly spray water inside or outside the refrigerator or wipe it with benzene or alcohol.
  - There is a risk of fire or electric shock.

# safety information

---

- Do not store volatile or flammable substances in the refrigerator.
  - The storage of benzene, thinner, alcohol, ether, LP gas and other such products may cause explosions.
- You are recommended to empty the refrigerator and turn it off when you have a long term journey.
- Do not re-freeze frozen foods that have thawed completely.
- Do not store pharmaceuticals products, scientific materials or temperature-sensitive products in the refrigerator.
  - Products that require strict temperature controls must not be stored in the refrigerator.
- Do not put a container filled with water on the refrigerator.
  - If spilled, there is a risk of fire or electric shock.
- The two legs in the front of the refrigerator are rotatable. The front legs contact the ground so that the refrigerator will not move when opening its doors.
- Do not apply strong shock or excessive force onto the surface of glass.
  - Broken glass may result in a personal injury and/or property damage.

## CAUTION SIGNS FOR CLEANING

---

- Do not insert your hands into the bottom area under the appliance.
  - Any sharp edges may cause personal injury.
- Never put fingers or other objects into the dispenser hole and ice chute.
  - It may cause personal injury or material damage.
- Don't use wet cloth to clean the plug or remove its foreign substances or dust.
  - Otherwise, it will result in fire hazard.
- If the refrigerator is disconnected from the power supply, you should wait for at least ten minutes before plugging it back.

## WARNING SIGNS FOR DISPOSAL

---

- When disposing of this or other refrigerator/s, remove the door/door seals, so that small children or animals cannot become trapped inside.
- Leave the shelves in place so that children may not easily climb inside.
- Check the compressor label or the rating label on the rear of the appliance to see which refrigerant is used for your refrigerator. When this product contains flammable gas (Refrigerant R600a/R134a) contact your local authority in regard to safe disposal of this product.
- Cyclopentane is used as an insulation blowing gas. The gases in insulation material require special disposal procedure. Please contact your local authorities in regard to the environmentally safe disposal of this product. Ensure that none of the pipes on the back of the appliances are damaged prior to disposal. The pipes shall be broken in the open space.



**CAUTION**

**In the event of a power failure, call the local office of your Electricity Company and ask how long it is going to last.**

**Most power failures that are corrected in an hour or two will not affect your refrigerator temperatures.**

**However, you should minimize the number of door openings while the power is off.**

**But should the power failure last more than 24 hours, remove all frozen food; you'd better raise temperature of the freezer to at least 0°C and remove all ice blocks in the ice bunker; otherwise, it will result in flowing water or damage of the mechanism.**



**CAUTION**

**There is protective film on the surface of some refrigerator models, which is used to protect the refrigerator from scratches during transport. To avoid static electricity, please peel off the protective film slowly. If the protective film is not removed for a long time, it may cause color shading of the steel plate.**

# safety information

---



**It is hazardous for anyone other than an Authorised Service Person to service this CAUTION appliance. In Queensland - the authorized Service Person MUST hold a Gas Work Authorisation or Licence for hydrocarbon refrigerants, to carry out Servicing or repairs which involve the removal of covers. (For Australia only)**

## ADDITIONAL TIPS FOR PROPER USAGE

---



- Allow the appliance to stand for 2 hours after installation.
- To get best performance of product,
  - Do not place foods too closely in front of the vents at the rear of the appliance as it can obstruct free air circulation in the freezer compartment.
  - Wrap the food up properly or place it in airtight containers before put it into the fridge freezer
  - Do not put any newly introduced food for freezing near to already frozen food.
- Please observe maximum storage times and expiry dates of frozen goods.
- There is no need to disconnect the refrigerator from the power supply if you will be away for less than three weeks. But, remove all the food if you are going away for the three weeks or more. Unplug the refrigerator and clean it, rinse and dry.
- Most power failures that are corrected in an hour or two will not affect your refrigerator temperatures. However, you should minimize the number of door openings while the power is off. But should the power failure last more than 24 hours, remove all frozen food.
- Do not store food which goes bad easily at low temperature, such as bananas, melons.
- Place the ice tray at the originally provided position by manufacturer in order to achieve optimal ice-freezing.
- Your refrigerator is frost-free, so you are no need to defrost manually and the refrigerator will do so automatically.
- Temperature rising during the defrost can comply with relevant national requirement. But If you want to prevent an undue rise in the temperature of the frozen food while defrosting the appliance, please wrap the frozen food in several layers of paper such as newspaper.
- Any increase in temperature of frozen food during defrosting can shorten its storage life.

## SAVING ENERGY TIPS

---

- Install the appliance in a cool, dry room with adequate ventilation.  
Ensure that it is not exposed to direct sunlight and never put it near a direct source of heat (radiator, for example).
  - Never block any vents or grilles on the appliance.
  - Allow warm food to cool down before placing it in the appliance.
  - Put frozen food in the refrigerator to thaw. You can then use the low temperatures of the frozen products to cool food in the refrigerator.
  - Do not keep the door of the appliance open for too long when putting food in or taking food out. The shorter time for which the door is open, the less ice will form in the freezer.  
Clean the rear of the refrigerator regularly. Dust increases energy consumption.
  - Do not set temperature colder than necessary.
  - Ensure sufficient air exhaust at the refrigerator base and at the back wall of the refrigerator.
  - Do not cover air vent openings.
  - Allow clearance to the right, left, back and top when installing.  
This will help reduce power consumption and keep your energy bills lower.
- 

This appliance is intended to be used in household and similar applications such as

- Staff kitchen areas in shops, offices and other working environments;
- Farm houses and by clients in hotels, motels and other residential type environments;
- Bed and breakfast type environments;
- Catering and similar non-retail applications.

# contents

---

## SETTING UP YOUR SIDE-BY-SIDE REFRIGERATOR

9

- 09 Getting ready to install the refrigerator
- 10 Removing the refrigerator doors
- 12 Leveling the refrigerator
- 12 Making minor adjustments to the doors
- 12 Setting up the refrigerator

## OPERATING THE SAMSUNG SIDE-BY-SIDE REFRIGERATOR

13

- 13 Operating the refrigerator
- 14 Using the digital display
- 14 Controlling the temperature
- 15 Using the twist ice maker
- 16 Storing food
- 18 Removing the freezer accessories
- 18 Removing the fridge accessories
- 19 Cleaning the refrigerator
- 19 Using the doors

## TROUBLESHOOTING

20

## SPECIFICATIONS

21



# setting up your side-by-side refrigerator

## GETTING READY TO INSTALL THE REFRIGERATOR

Congratulations on the purchase of your Samsung Side-By-Side Refrigerator. We hope you will enjoy the many state-of-the-art features and efficiencies that this new appliance has to offer.

### Selecting the best location for the refrigerator

- Select a location without direct exposure to sunlight.
- Select a location with level (or nearly level) flooring.
  - If your refrigerator is not level, the internal cooling system may not work correctly.
- Select a location with enough space for the refrigerator doors to open easily.
  - Overall space required in use. Refer to drawing and dimension as below.

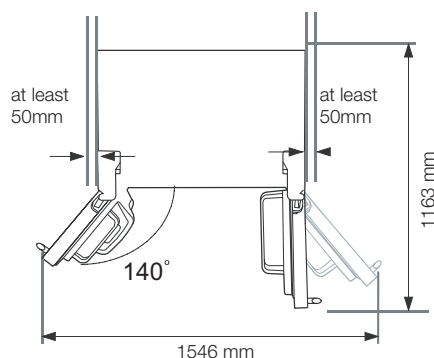
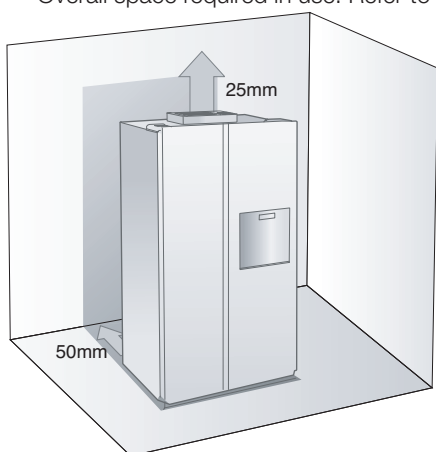

First thing! Make sure that you can easily move your Refrigerator to its final location by measuring doorways (both width and height), thresholds, ceilings, stairways, etc.

\* The following table lists heights and depths of different models of Samsung refrigerators.

Model			RS554NRUA** SRS603HLS	RS552NRUA** SRS583NLS SRS582WW
Capacity (L)			538 L	
Dimension (mm)	Width	Only main body	908mm	908mm
		Include doors	912mm	912mm
	Depth	Only main body	612mm	612mm
		Include doors	700mm	700mm
	Height	No doors	1743mm	1743mm
		Include doors	1789mm	1789mm



- Allow clearance to the right, left, back and top when installing. This will help reduce power consumption and keep your energy bills lower.
- Install the refrigerator at the place with suitable temperature.

# setting up your side-by-side refrigerator

## REMOVING THE REFRIGERATOR DOORS

If your entrance won't allow the refrigerator to pass easily through it, you can remove the doors.

### Removing and Installing the Freezer door

A few things to mention first.

- Make sure that you lift the door straight up so the hinges are not bent or broken.
  - Be careful not to pinch the wire harness on the door.
  - Place doors on a protected surface to prevent scratching or damage.
1. Remove the upper hinge cover **1** using a screwdriver, and then disconnect the wires by gently pulling them apart **2**.

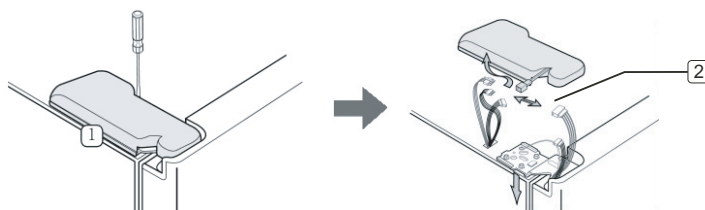

2. Remove hinge screws **3** and the ground screw **4** by turning counter-anticlockwise, and take off the upper hinge **5**. Be careful that the door does not fall on you as you are removing it.

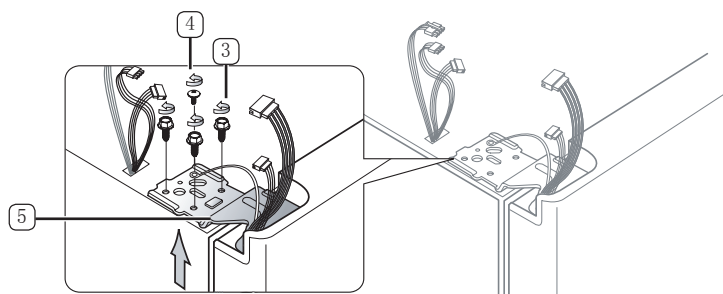

3. Remove the door from the lower hinge **6** by carefully lifting the door straight up **7**.

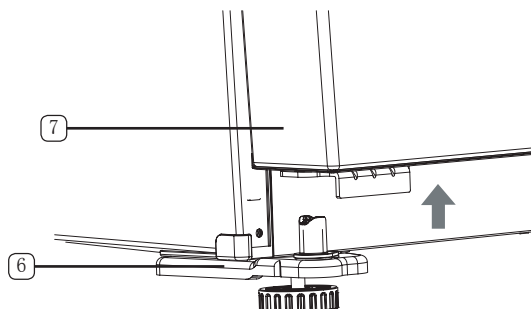

4. After the refrigerator is placed to the specified position, install the freezer door in the reverse order as follows: .

## REMOVING THE REFRIGERATOR DOORS

If your entrance won't allow the refrigerator to pass easily through it, you can remove the doors.

### Removing and Installing the Fridge door

A few things to mention first.

- Make sure that you lift the door straight up so the hinges are not bent or broken.
  - Be careful not to pinch the wire harness on the door.
  - Place doors on a protected surface to prevent scratching or damage.
1. Remove the upper hinge cover **1** using a screwdriver, and then disconnect the wires by gently pulling them apart **2**.

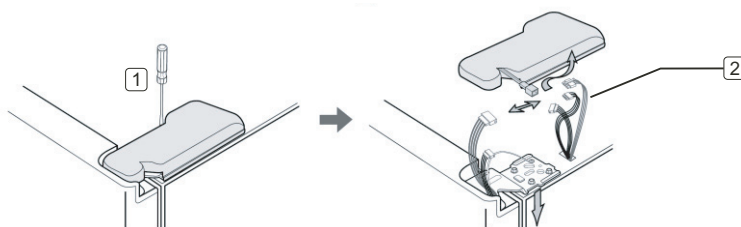

2. Remove hinge screws **3** and the ground screw **4** by turning counter-anticlockwise, and take off the upper hinge **5**. Be careful that the door does not fall on you as you are removing it.

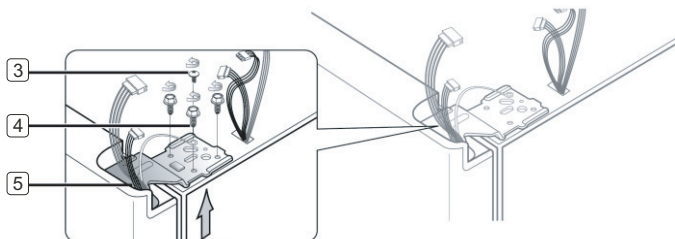

3. Remove the door from the lower hinge **6** by carefully lifting the door straight up **7**.

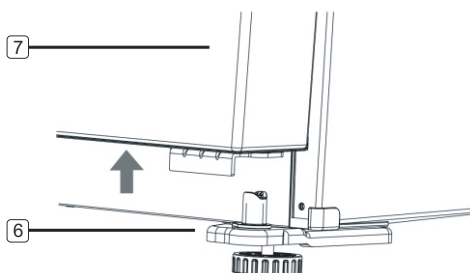

4. After the refrigerator is placed to the specified position, install the fridge door in the reverse order as follows:

# setting up your side-by-side refrigerator

## LEVELING THE REFRIGERATOR

Now that the doors are back on the refrigerator, you will want to make sure the refrigerator is level so you can then make final adjustments. If the refrigerator is not level, it will not be possible to get the doors perfectly even.

 The front leg of the refrigerator is adjustable. Adjust right and left leveling legs to keep the refrigerator stable.

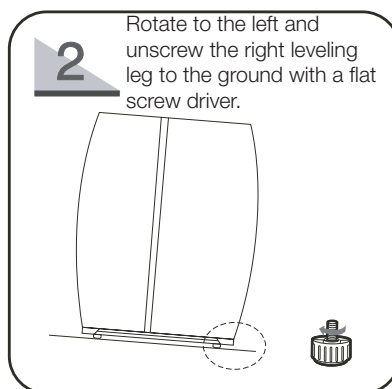
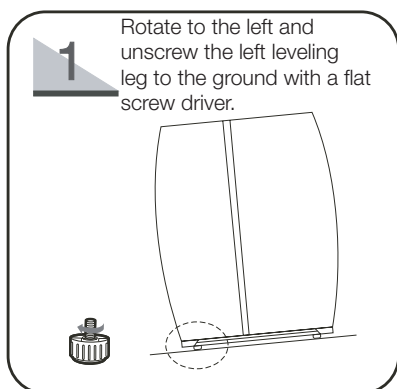

## MAKING MINOR ADJUSTMENTS TO THE DOORS

Remember, a leveling refrigerator is necessary for getting the doors perfectly even.

**When the freezer door is lower than the fridge**

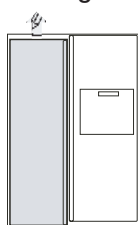

Adjustment part

**When the fridge door is lower than the freezer**

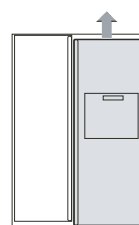

Adjustment part

Insert the wrench (4 mm) from the axle hole at bottom of the lower hinge, and rotate it; Face the refrigerator door, rotate and rise from left to right, rotate and descend from right to left;

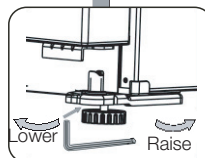

For safety reasons, adjust the front side a little higher than the rear side.

## SETTING UP THE REFRIGERATOR

Now that you have your new refrigerator installed and in place, you are ready to set up and enjoy the full features and functions of the appliance.

By completing the following steps, your refrigerator should be fully operational. If not, first check the power supply and electricity source or try the troubleshooting section at the back of this user guide. If you have any further questions, contact your Samsung Electronics service center.

1. Place the refrigerator in an appropriate location with reasonable clearance between the wall and the refrigerator. Refer to installation instructions in this manual.
2. Once the refrigerator is plugged in, make sure the interior light comes on when you open the doors.
3. Set the temperature control to the coldest temperature and wait for an hour. The freezer should get slightly chilled and the motor should run smoothly.
4. After powering the refrigerator, it will take a few hours to reach the appropriate temperature. Once the refrigerator temperature is sufficiently cool, you can store food and drink in the refrigerator.

# operating the SAMSUNG side-by-side refrigerator

## USING THE CONTROL PANEL

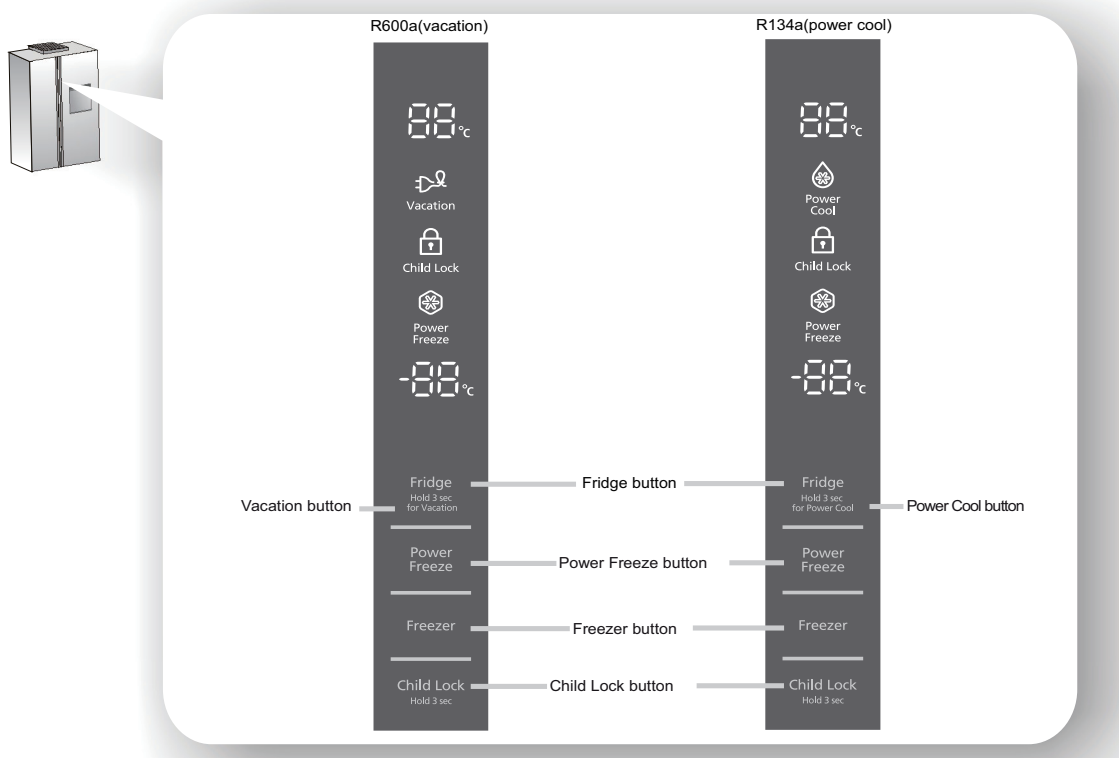

1	FRIDGE BUTTON	Press the <b>Fridge</b> button to set the fridge to your desired temperature, You can set the temperature from 1°C to 7°C .
2	VACATION BUTTON	If you are going on vacation or business trip or you do not need to use the refrigerator, pressing the Fridge button for 3 seconds to active the Vacation function. To cancel the Vacation function, the LED of Vacation function will be off. It is strongly requested to remove foods in the Fridge and do not leave the door open when you select Vacation function.
	POWER COOL BUTTON	Speeds up the time needed to fresh products in the fridge. This can be helpful if need to quickly cool fresh food, or if the temperature in the fridge has warmed dramatically (For example, if the door was opened too long, or put too much warm food in fridge suddenly)
3	POWER FREEZE BUTTON	Speeds up the time needed to freeze products in the freezer. This can be helpful if you need to quickly freeze items that spoil easily or if the temperature in the freezer has warmed dramatically (For example, if the door was left open).
4	FREEZER BUTTON	Press the <b>Freezer</b> button to set the freezer to your desired temperature, You can set the temperature from -14°C to -23°C .
5	CHILD LOCK BUTTON	By pressing the <b>Child Lock</b> button for 3 seconds, all buttons will be locked. To cancel this function, Press the <b>Child Lock</b> button for 3 seconds again.

# operating the SAMSUNG side-by-side refrigerator

## USING THE DIGITAL DISPLAY

“88” segment on Freezer part indicates the current Freezer temperature.

“88” segment on Fridge part indicates the current Fridge temperature.

- ✎ About a few seconds after the door close or display button operation, the display LEDs are turned off except the Child Lock, power freeze, vacation function/power cool function Indicator. It is not malfunction or failure of refrigerator. If any button is touched or door is opened, the display LEDs are turned on.

### Power Freeze

This icon will light up when you activate the **Power Freeze** feature. **Power Freeze** is great for times when you need a lot of ice. Press the **Power Freeze** button and ice production will increase. When you have enough, just press the button again to cancel the “**Power Freeze**” mode.

- ✎ When you use this function, the energy consumption of the refrigerator will increase. This function must be activated before putting large amount of food stuff in the freezer compartment at least 24 hours before.

### Child Lock

By pressing the **Child Lock** button for 3 seconds, all buttons will be locked. To cancel this function, Press the **Child Lock** button for 3 seconds again.

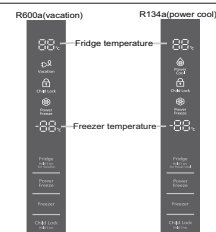

## CONTROLLING THE TEMPERATURE

### Controlling the Freezer temperature

The freezer temperature can be set from -14°C to -23°C to suit your particular needs. Press the **Freezer** button repeatedly until the desired temperature is shown in the temperature display. Keep in mind that foods like ice cream may melt at -16°C. The temperature display will move sequentially from -14°C to -23°C. When the display reaches -14°C, it will begin again at -23°C. Five seconds after the new temperature is set the display will again show the actual current freezer temperature. However, this number will change as the Freezer adjusts to the new temperature.

### Controlling the Fridge temperature

The refrigerator temperature can be set between 7°C and 1°C to suit your particular needs. Press the **Fridge** button repeatedly until the desired temperature is shown in the temperature display. The temperature control process for the Fridge works just like the Freezer process. Press the Fridge button to set your desired temperature. After a few seconds, the Fridge will begin tracking towards the newly set temperature. This will be reflected in the digital display.

- ✎ The temperature of the freezer or the refrigerator may rise from opening the doors too frequently, or if a large amount of warm or hot food is placed in either side. This may cause the digital display to blink. Once the freezer and refrigerator return to their normal set temperatures the blinking will stop. If the blinking continues, you may need to “reset” the refrigerator. Try unplugging the appliance, wait about 10 minutes and then plug back in. If you can’t solve the problem by this method, please contact SAMSUNG maintenance personnel.

## USING THE TWIST ICE MAKER

1. Pull out the twist ice maker.

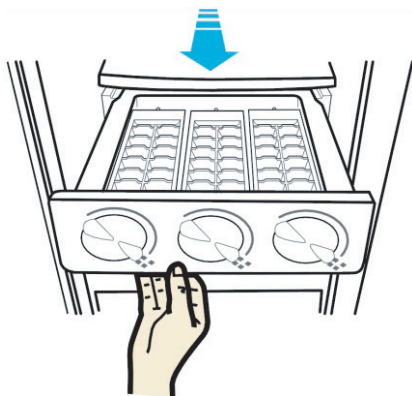

2. Pour cool water into the twist ice maker until it reaches the water level indicator on the ice maker.

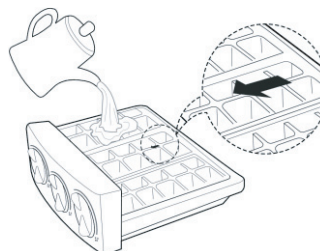

3. Place it inside ice maker.

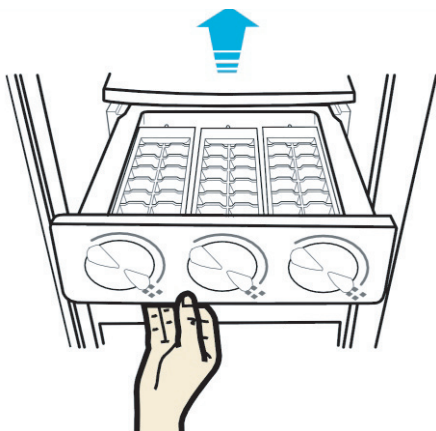

4. Turn twist ice maker button and the ice automatically full into the below ice compartment after release. Pull out ice storage compartment for ice.



### Note:

- The ice maker can be used when the freezer is below 0°C.
- For optimal ice-making effect, press the "Power Freeze" button before making ice. After stable operating, put the ice maker filled with a certain amount of water into the refrigerator.
- While making ice, you'd better put the ice maker on the first layer shelf of the freezer, so as to speed up ice making.
- Actual ice maker may differ from photo.

# operating the SAMSUNG side-by-side refrigerator

## STORING FOOD

### Storing Food in the Freezer

- The Samsung Side-By-Side Refrigerator has been designed to provide you with maximum spacesaving features and functions. Here are some of the customized compartments we have created to keep your food fresher, longer. Remember, in order to prevent odor penetration to the ice, stored food should be wrapped securely and as airtight as possible.
- To get more space, you can remove freezer drawer(s) except bottom freezer drawer , since it does not affect thermal and mechanical characteristics.
- A declared storage volume of frozen food storage compartment is calculated with the bottom freezer drawer reserved

Note: All illustrations of the Manual are schematic diagrams, and some features and devices may differ from your refrigerator, so actual structure and configuration shall be subject to your actual

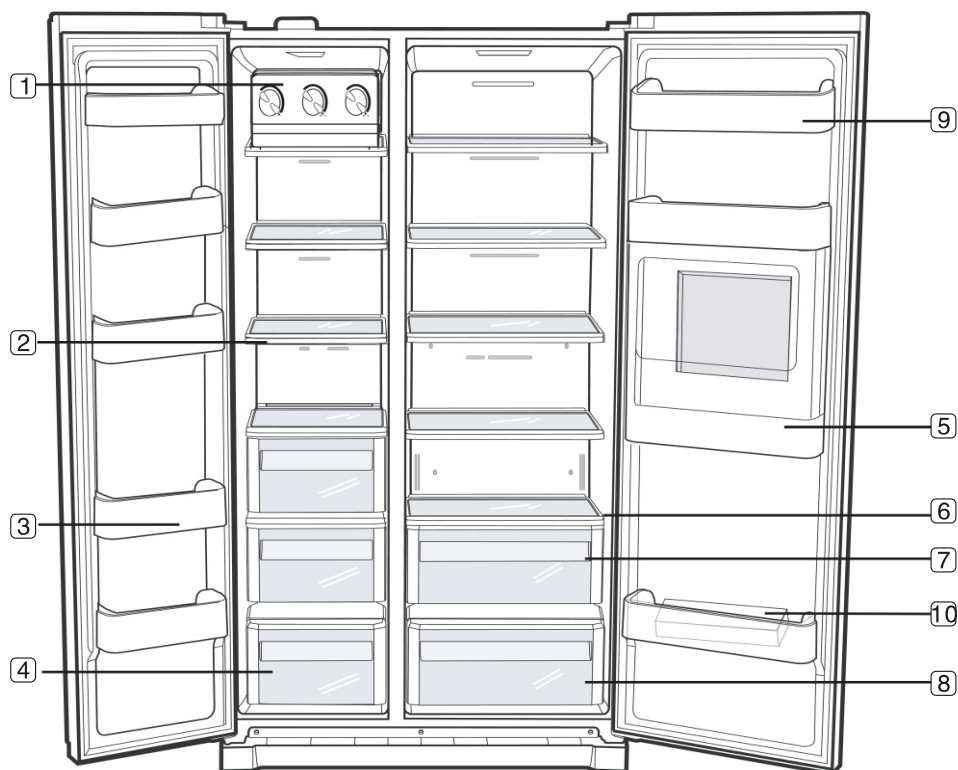



product.

Note:





- In order to keep enough cool air of the freezer (below  $-18^{\circ}\text{C}$ ), the stored foods shall not exceed the food limit line. If the cool air outlet is blocked, cool air may be hard to diffuse and foods may be hard to cool.
- To get the best energy efficiency of this product, please leave all selves, drawers and baskets on their original position like as above illustration.



## Storing Food in the Freezer

<b>1 TWIST ICE MAKER</b>	Do not put your fingers, hands or any other objects in the ice box or the ice maker bucket. This may result in personal injury or material damage.	
<b>2 GLASS SHELVES</b>	Can be used to store all types of frozen food.	
<b>3 DOOR BINS</b>	Can be used for small packages of frozen food.	
<b>4 DRAWERS</b>	Best used to store meats or dry foods. Stored food should be wrapped securely using foil or other suitable wrapping materials or containers.	

## Storing Food in the Fridge

<b>5 BEVERAGE CONTAINER (FOR THE MODEL WITH BAR)</b>	This design enables to store some beverage, fruits and drink through bar door of the fridge.	
<b>6 GLASS SHELVES</b>	Designed to be crack-resistant. They can be used to store all types of food and drinks. Circular marks on the glass surface are a normal phenomenon and can usually be wiped clean with a damp cloth.	
<b>7 PHOTOSYNTHESIS FRESH-KEEPING DRAWER</b>	When the fridge door is closed, the LED lamp at right of the fresh-keeping drawer will execute fresh-keeping function periodically every hour (30min. ON and 30min. OFF). Note: for optimal effect, you'd better store fruits and vegetables in transparent plastic bags or at natural state before putting them in the fresh-keeping drawer. Non-transparent case, container and black plastic gas are not recommended.	
<b>8 FRUIT &amp; VEGETABLE DRAWER</b>	Used to preserve the freshness of your stored vegetables and fruits. It has been specifically designed to control the level of humidity within the drawer.	
<b>9 DOOR BINS</b>	Designed to handle large, bulky items such as gallons of milk or other large bottles and containers.	
<b>10 EGG TRAY</b>	Store eggs or other small foods.	

 Bottles should be stored tightly together so that they do not tip and fall out when the refrigerator door is opened.



- If you plan to go away for a significant time, empty the refrigerator and turn it off. Wipe the excess moisture from the inside of the appliance and leave the doors open. This helps keep odor and mold from developing.
- If the refrigerator is not to be used for a long period of time, pull out the power plug.
  - Deterioration in the insulation may cause fire.

# operating the SAMSUNG side-by-side refrigerator

## REMOVING THE FREEZER ACCESSORIES

Cleaning and rearranging the interior of the freezer is a snap.

1. Remove the Glass Shelf by pulling the shelf out as far as it will go. Then, gently lift it up and remove it.



**WARNING**

In case it does not have hooks itself in the back side for not being tilted, a shelf should be placed deeply in a proper position where there are blocks for shelves as shown. If not, the shelf can fall out of a refrigerator.

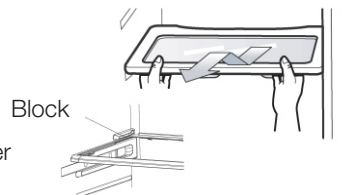

2. Remove the Door Bin by holding the door bin with both hands and then gently lift it up.



3. Remove the Plastic Drawer by pulling it out and slightly lifting it up.



## REMOVING THE FRIDGE ACCESSORIES

Cleaning and rearranging the interior of the fridge is a snap.

1. Remove the Glass Shelf by pulling the shelf out as far as it will go. Then, gently lift it up and gently remove it.



**WARNING**

In case it does not have hooks itself in the back side for not being tilted, a shelf should be placed deeply in a proper position where there are blocks for shelves as shown. If not, the shelf can fall out of a refrigerator.

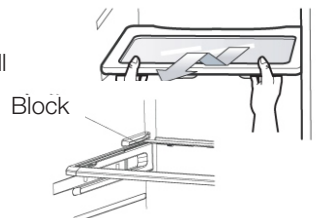

2. Remove the Vegetable & Fruit Drawer by pressing on the indentations and remove by pulling forward. Holding the drawer with one hand, lift it up a little bit while pulling it forward and take it out of the refrigerator.



3. Remove the Gallon Door Bin by holding the bin with both hands and gently lifting it up.

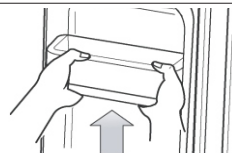

4. Home bar door (optional)
  - Grasp food box with both hands; lift and take it out.
  - Grasp bar box with both hands; lift and take it out.
  - Take out food box and bar box in order.

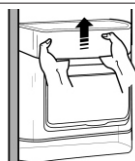

(1)

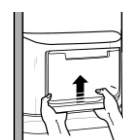

(2)

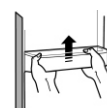

(3)



Before removing any accessories, make sure that no food is in the way. When possible, remove the food altogether to reduce the risk of accidents.

## CLEANING THE REFRIGERATOR

Caring for your Samsung Side-By-Side Refrigerator prolongs the life of your appliance and helps keep it odor and germ-free.

### Cleaning the Interior

Clean the inside walls and accessories with a mild detergent and then wipe dry with a soft cloth. You can remove the drawers and shelves for a more thorough cleaning. Just make sure to dry them before putting them back into place.

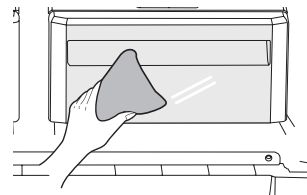

### Cleaning the Exterior

Wipe the digital panel and display panel with a clean, soft cloth. Spray water onto the cleaning cloth instead of spraying directly on the surface of the refrigerator. This helps ensure an even distribution of moisture to the surface. The doors, handles and cabinet surfaces should be cleaned with a mild detergent and then wiped dry with a soft cloth. To keep your appliance looking its best, the exterior should be polished once or twice a year.

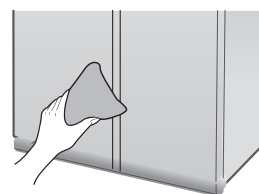

**WARNING**

Do not use Benzene, Thinner or Clorox™ for cleaning.

They may damage the surface of the appliance and can create a risk of fire.

### Home bar (optional)

- Press upper part of the home bar lightly to open its door.
- Clean the home bar with wet cloth. Wipe it with clean and soft cloth.
- Push upper part of the family home bar to close it when hearing click sound.

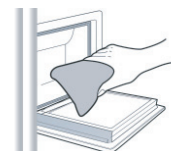

### Cleaning the Rubber door seals

If the rubber door seals are dirty the doors may not close properly, and the refrigerator will not operate efficiently. Keep the door seals free of grit or grime by cleaning the doors with a mild detergent and damp cloth. Wipe dry with a clean, soft cloth.



**CAUTION**

Do not spray the refrigerator with water while it is plugged in, as it may cause an electric shock. Do not clean the refrigerator with benzene, thinner or car detergent for risk of fire.

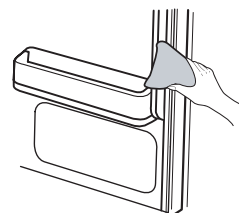

## USING THE DOORS

The refrigerator doors are equipped with a door opening and closing feature that ensures that the doors close all the way and are securely sealed.

After opening beyond a certain point, the door will “catch” and remain open. When the door is ajar ahead of the catch that allows it to stay open, it will close automatically.

# troubleshooting

PROBLEM	SOLUTION
The Refrigerator does not work at all or it does not chill sufficiently.	<ul style="list-style-type: none"><li>• Check that the power plug is properly connected.</li><li>• Is the temperature control on the display panel set to the correct temperature? Try setting it to a higher temperature.</li><li>• Is the refrigerator in direct sunlight or located near a heat source?</li><li>• Is the back of the refrigerator so close to the wall that air cannot keep circulating?</li></ul>
The food in the Refrigerator is frozen.	<ul style="list-style-type: none"><li>• Is the temperature control on the display set to the correct temperature? Try setting it to a warmer temperature.</li><li>• Is the temperature in the room too low?</li><li>• Did you store the food too close to the air vent at the back of the refrigerator? Move the food away from the air vent.</li></ul>
You hear unusual noise or sounds.	<ul style="list-style-type: none"><li>• Check that the refrigerator is level and stable.</li><li>• Is the back of the refrigerator too close to the wall and therefore keeping air from circulating?</li><li>• Was anything dropped behind or under the refrigerator?</li><li>• A “ticking” sound is heard from inside the refrigerator. It is normal and occurs because various accessories are contracting or expanding according to the temperature of the refrigerator interior.</li><li>• A “bleep” alarm sound is heard. Is the door of refrigerator or bar closed?</li></ul>
The front section of the appliance are hot and condensation is occurring.	<ul style="list-style-type: none"><li>• Some heat is normal as anti-condensators are installed in the front section of the refrigerator to prevent condensation.</li><li>• Is the refrigerator door ajar? Condensation can occur when you leave the door open for a long time.</li></ul>
You hear water bubbling in the Refrigerator.	<ul style="list-style-type: none"><li>• This is normal. The bubbling comes from the refrigerator coolant liquid circulating through the refrigerator.</li></ul>
There is a bad smell in the Refrigerator.	<ul style="list-style-type: none"><li>• Check for spoiled food.</li><li>• Foods with strong odors (for example, fish) should be tightly covered.</li><li>• Clean out your freezer periodically and throw away any spoiled or suspicious food.</li></ul>
Frost forms on the walls of the Freezer.	<ul style="list-style-type: none"><li>• Is the air vent blocked? Remove any obstructions so air can circulate freely.</li><li>• Allow sufficient space between the foods stored for efficient air circulation.</li><li>• Is the freezer drawer closed properly?</li></ul>
A short display of the board and a flash of the fridge light will get back to normal automatically. (For India Only)	<ul style="list-style-type: none"><li>• This is normal. The controller is equipped with over-voltage protection. Once the voltage of power supply exceeds the threshold, the protection will be triggered off immediately, causing a short display of the board and a flash of the fridge light, getting everything back to normal.</li></ul>

memo

---

## Ambient Room Temperature Limits

This fridge/freezer is designed to operate in ambient temperatures specified by its temperature class marked on the rating plate.

Class	Symbol	Ambient Temperature range(°C)
Extended Temperate	SN	+10 to +32
Temperate	N	+16 to +32
Subtropical	ST	+16 to +38
Tropical	T	+16 to +43

**NOTE:** Internal temperatures may be affected by such factors as the location of the fridge/freezer, ambient temperature and the frequency with which you open the door. Adjust the temperature as required to compensate for these factors.

### English



### Correct Disposal of This Product (Waste Electrical & Electronic Equipment)

*(Applicable in countries with separate collection systems)*

This marking on the product, accessories or literature indicates that the product and its electronic accessories (e.g. charger, headset, USB cable) should not be disposed of with other household waste at the end of their working life. To prevent possible harm to the environment or human health from uncontrolled waste disposal, please separate these items from other types of waste and recycle them responsibly to promote the sustainable reuse of material resources.

Household users should contact either the retailer where they purchased this product, or their local government office, for details of where and how they can take these items for environmentally safe recycling. Business users should contact their supplier and check the terms and conditions of the purchase contract. This product and its electronic accessories should not be mixed with other commercial wastes for disposal.

# SAMSUNG

## Contact SAMSUNG WORLD WIDE

If you have any questions or comments relating to Samsung products, please contact the SAMSUNG customer care center.

COUNTRY	CALL	WEB SITE
AUSTRALIA	1300 362 603	<a href="http://www.samsung.com/au/support">www.samsung.com/au/support</a>
COLOMBIA	Bogotá en el 600 12 72 Sin costo en todo el país 01 8000 112 112 Y desde tu celular #726	<a href="http://www.samsung.com/co/support">www.samsung.com/co/support</a>
EIRE	0818 717100	<a href="http://www.samsung.com/ie/support">www.samsung.com/ie/support</a>
HONG KONG	3698 4698	<a href="http://www.samsung.com/hk/support">www.samsung.com/hk/support</a> (Chinese) <a href="http://www.samsung.com/hk_en/support">www.samsung.com/hk_en/support</a> (English)
INDIA	1800 40 SAMSUNG (Toll Free) 1800 40 7267864 (Toll Free)	<a href="http://www.samsung.com/in/support">www.samsung.com/in/support</a>
Bangladesh	0961-2300300 0800-0300300 (Toll free)	<a href="http://www.samsung.com/support">www.samsung.com/support</a>
MALAYSIA	1800-88-9999 603-77137477 (Overseas contact)	<a href="http://www.samsung.com/my/support">www.samsung.com/my/support</a>
NEW ZEALAND	0800 726 786	<a href="http://www.samsung.com/nz/support">www.samsung.com/nz/support</a>
PANAMA	800-0101	<a href="http://www.samsung.com/latin/support">www.samsung.com/latin/support</a> (Spanish) <a href="http://www.samsung.com/latin_en/support">www.samsung.com/latin_en/support</a> (English)
PHILIPPINES	1-800-10-726-7864 [ PLDT Toll Free ] 1-800-8-726-7864 [ Globe Landline and Mobile ] 02- 422-2111 [ Standard Landline ]	<a href="http://www.samsung.com/ph/support">www.samsung.com/ph/support</a>
SINGAPORE	1800-SAMSUNG(726-7864)	<a href="http://www.samsung.com/sg/support">www.samsung.com/sg/support</a>
SOUTH AFRICA	0860 SAMSUNG (726 7864)	<a href="http://www.samsung.com/support">www.samsung.com/support</a>
UK	0330 SAMSUNG (7267864)	<a href="http://www.samsung.com/uk/support">www.samsung.com/uk/support</a>
VIETNAM	1800 588 889	<a href="http://www.samsung.com/vn/support">www.samsung.com/vn/support</a>

**This product is RoHS compliant**