

Always there to help you

Register your product and get support at
www.philips.com/welcome

Question?
Contact
Philips

GC3800 series



User manual

PHILIPS

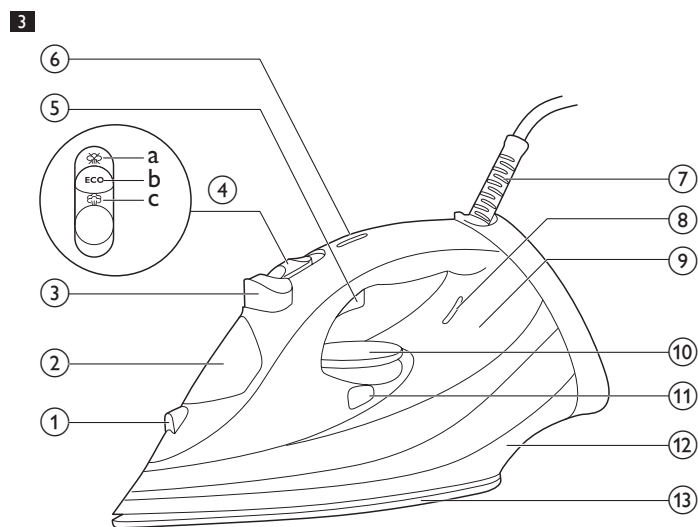

Introduction

Congratulations on your purchase and welcome to Philips! To fully benefit from the support that Philips offers, register your product at www.philips.com/welcome.

Important

Read this important information carefully before you use the appliance and save it for future reference.

Danger

- Never immerse the iron in water.

Warning

- Check if the voltage indicated on the appliance corresponds to the local mains voltage before you connect the appliance.
 - Do not use the appliance if the plug, the mains cord or the appliance itself shows visible damage, or if the appliance has been dropped or leaks.
 - If the mains cord is damaged, you must have it replaced by Philips, a service centre authorised by Philips or similarly qualified persons in order to avoid a hazard.
 - Never leave the appliance unattended when it is connected to the mains.
 - Always unplug the appliance from the socket outlet before you fill the water tank with water.
 - This appliance can be used by children aged from 8 years and above and by persons with reduced physical, sensory or mental capabilities or lack of experience and knowledge if they have been given supervision or instruction concerning use of the appliance in a safe way and if they understand the hazards involved.
 - Do not allow children to play with the appliance.
 - Older children are only allowed to clean the appliance and perform the Calc-Clean procedure under supervision.
 - Keep the iron and its mains cord out of the reach of children less than 8 years of age when the appliance is switched on or cooling down.
 - Always place and use the iron on a stable, level and horizontal surface.
 - Do not let the mains cord come into contact with the hot soleplate of the iron.
 - Cleaning and user maintenance shall not be made by children without supervision.
- #### Warning: For Iron models with Quick Calc Release feature
- Do not open and remove the Quick Calc Release tray from the appliance during use.
 - Only use the Quick Calc Release tray that is supplied with the appliance. Do not use other tray on the appliance.

- Do not fill water, perfume, vinegar, starch, descaling agents, ironing aids or other chemicals at the channel of the Quick Calc Release tray.
- Do not insert your finger or pointed objects into the channel of the Quick Calc Release tray.

CAUTION: Hot surface (Fig. 1)

Surfaces are liable to get hot during use (for irons with 'hot' symbol marked on the appliance).

Caution

- Only connect the appliance to an earthed wall socket.
- Check the mains cord regularly for possible damage.
- Fully unwind the mains cord before you plug it in the wall socket.
- The soleplate of the iron can become extremely hot and may cause burns if touched.
- Descale the iron regularly according to the instructions in chapter 'Cleaning and maintenance' in the user manual.
- When you have finished ironing, when you clean the appliance, when you fill or empty the water tank and also when you leave the iron even for a short while: set the steam control to the 'dry ironing' position, put the iron on its heel and remove the mains plug from the wall socket.
- Do not put perfume, vinegar, starch, descaling agents, ironing aids or other chemicals in the water tank.
- This appliance is intended for household use only.

Electromagnetic fields (EMF)

This Philips appliance complies with all applicable standards and regulations regarding exposure to electromagnetic fields.

Environment

- Do not throw away the appliance with the normal household waste at the end of its life, but hand it in at an official collection point for recycling. By doing this, you help to preserve the environment (Fig. 2).

Guarantee and support

If you need information or support, please visit www.philips.com/support or read the separate worldwide guarantee leaflet.

Product overview (Fig. 3)

- | | |
|----|---|
| 1 | Spray nozzle |
| 2 | Water filling door |
| 3 | Spray button |
| 4 | Steam slider |
| | a. Dry setting |
| | b. ECO setting |
| | c. Auto steam setting |
| 5 | Steam boost trigger |
| 6 | Safety auto-off light (specific types only) |
| 7 | Mains cord |
| 8 | Temperature indicator light |
| 9 | Water tank |
| 10 | Temperature dial with Auto steam control |
| 11 | Calc clean button |
| 12 | Typeplate |
| 13 | Soleplate |



Specifications are subject to change without notice
© 2014 Koninklijke Philips N.V.
All rights reserved.
4239 000 94381

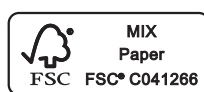

Using the appliance

Filling the water tank

Note: Your appliance has been designed to be used with tap water. If you live in an area with hard water, fast scale build-up may occur. Therefore, it is recommended to use 100% distilled or demineralized water to prolong the lifetime of your appliance.

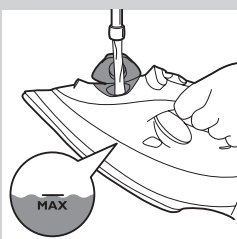

- 1 Open the water filling door.
- 2 Tilt the iron backwards and fill the water tank with tap water up to the maximum level.

Note: Do not fill the water tank beyond the MAX indication.

Do not put perfume, vinegar, starch, descaling agents, ironing aids or other chemicals in the water tank.

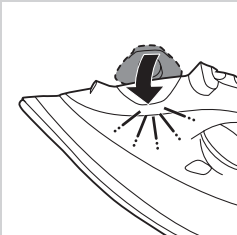

- 3 Close the water filling door ('click').

Temperature and steam setting

Table 1:

Warning: Do not use steam or steam boost at low temperature, as indicated in the below table. Otherwise, hot water may leak from the iron.

Fabric type	Temperature setting	Auto steam control	Steam boost
Linen	MAX	Automatically	Yes
Cotton	●●●	adjusted to the optimal amount	Yes
Wool	●●		No
Silk	●●		No
Synthetic fabric (e.g. acrylic, nylon, polyamide, polyester)	●	No steam	No

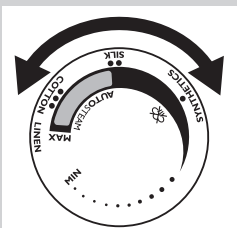

- 1 Consult table 1 to set the temperature dial to the appropriate setting for your garment.

- 2 Select Auto steam setting in the steam slider.

This iron is equipped with Auto steam control. According to the temperature you select, the iron automatically provides the optimal amount of steam for the best result.

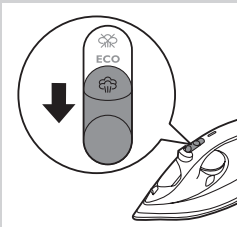

- 3 Put the iron on its heel and plug it in. The temperature light goes on to indicate that the iron is heating up.

- 4 When the temperature light goes out, the iron has reached the correct temperature and you could start ironing.

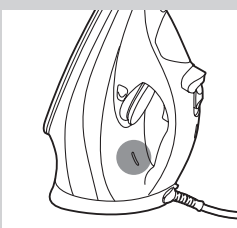

Features

Spray function

- Press the spray button to moisten the article to be ironed. This helps to remove stubborn creases.

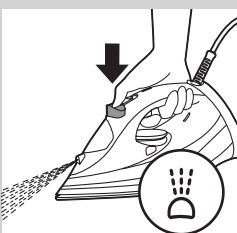

Steam boost function

- Press and release the steam boost trigger for a powerful boost of steam to remove stubborn creases.



Ironing with extra steam

- For extra steam during ironing, press and hold the steam boost trigger.



Vertical steam

- You can use the steam boost function when you hold the iron in vertical position for removing creases from hanging clothes, curtains etc.

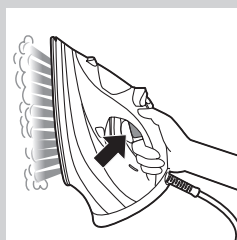

Eco steam setting / Dry ironing

- In stead of Auto steam, you could choose ECO setting in the steam slider to save energy, yet to achieve satisfactory ironing results.
- To iron without steam, select dry setting in the steam slider.

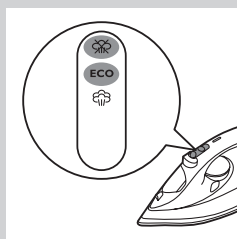

Safety auto-off (specific types only)

The safety auto-off function automatically switches off the iron if it has not been used for 30 seconds resting on its soleplate or 8 minutes resting on its backplate. The auto-off light will light up.

- To let the iron heat up again, pick up the iron or move it slightly. The auto-off light goes out.

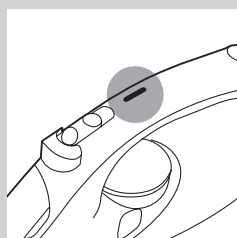

Cleaning and maintenance

Cleaning

- 1 Unplug the iron and let it cool down.
- 2 Pour any remaining water out of the water tank from the water filling door.
- 3 Wipe flakes and any other deposit off the soleplate with a damp cloth and a non-abrasive (liquid) cleaning agent.

To keep the soleplate smooth, avoid hard contact with metal objects. Never use a scouring pad, vinegar or other chemicals to clean the soleplate.



Calc-clean function

IMPORTANT: Use Calc-clean function every 1 month to prolong the life of your iron. If water in your area is very hard, or you see scales coming out from the soleplate during ironing, use this function more frequently.

- 1 Make sure the iron is unplugged and the steam slider is set to dry setting.
- 2 Fill the water tank to the MAX indication.

Do not pour vinegar or other descaling agents into the water tank.

- 3 Plug in the iron and set the temperature dial to MAX.
- 4 Unplug the iron when the temperature light goes out.
- 5 Hold the iron over the sink. Keep pushing the calc clean button and gently shake the iron forth and back until all water in the water tank has been used up.

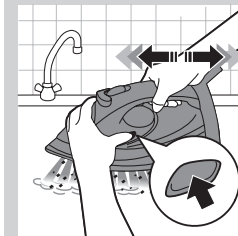

Scales is flushed out, steam and boiling water also come out of the soleplate.

Note: Repeat steps 2 to 5 if the water that comes out of the iron still contains scale particles.

- 6 Plug in the iron and let the iron heat up to dry the soleplate.
- 7 Unplug the iron when the temperature indicator light goes out.
- 8 Move the iron gently over a piece of cloth to remove any water stains on the soleplate.

Storage

- 1 Unplug the iron and empty the water tank. Let it cool down in a safe place.
- 2 Wind the mains cord around the backplate of the iron and store it on its heel.

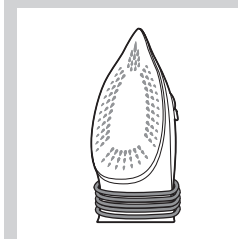

Troubleshooting

This chapter summarises the most common problems you could encounter with the appliance. If you are unable to solve the problem with the information below, visit www.philips.com/support for a list of frequently asked questions or contact the Consumer Care Centre in your country (see the worldwide guarantee leaflet for contact details).

Problem	Possible cause	Solution
The steam boost function does not work properly (water leaks out of the soleplate).	You have used the steam boost function too often within a very short period.	Wait for a few seconds before you use the steam boost function again.
	You have used the steam boost function at a too low temperature.	Set an ironing temperature at which the steam boost function can be used (●●● to MAX).
Flakes and impurities come out of the soleplate during ironing.	Scales are formed inside the soleplate.	Use the Calc-clean function (see chapter 'Cleaning and maintenance', section 'Calc-clean function').
Water leaks from the water filling door.	You have overfilled the water tank.	Do not fill the water tank beyond the MAX indication. Pour excess water out of the water tank.