



MCD370



PHILIPS

Use this simple and quick way to watch your favourite DVD movie and enjoy your Home Cinema experience!

Helpful Hints

You only need to make one video connection to your TV in order to view the DVD playback.

VIDEO OUT **S-VIDEO OUT** If your TV is not equipped with a **SCART** connector, connect your TV through the corresponding S-VIDEO IN or VIDEO IN connection.

first connect ...

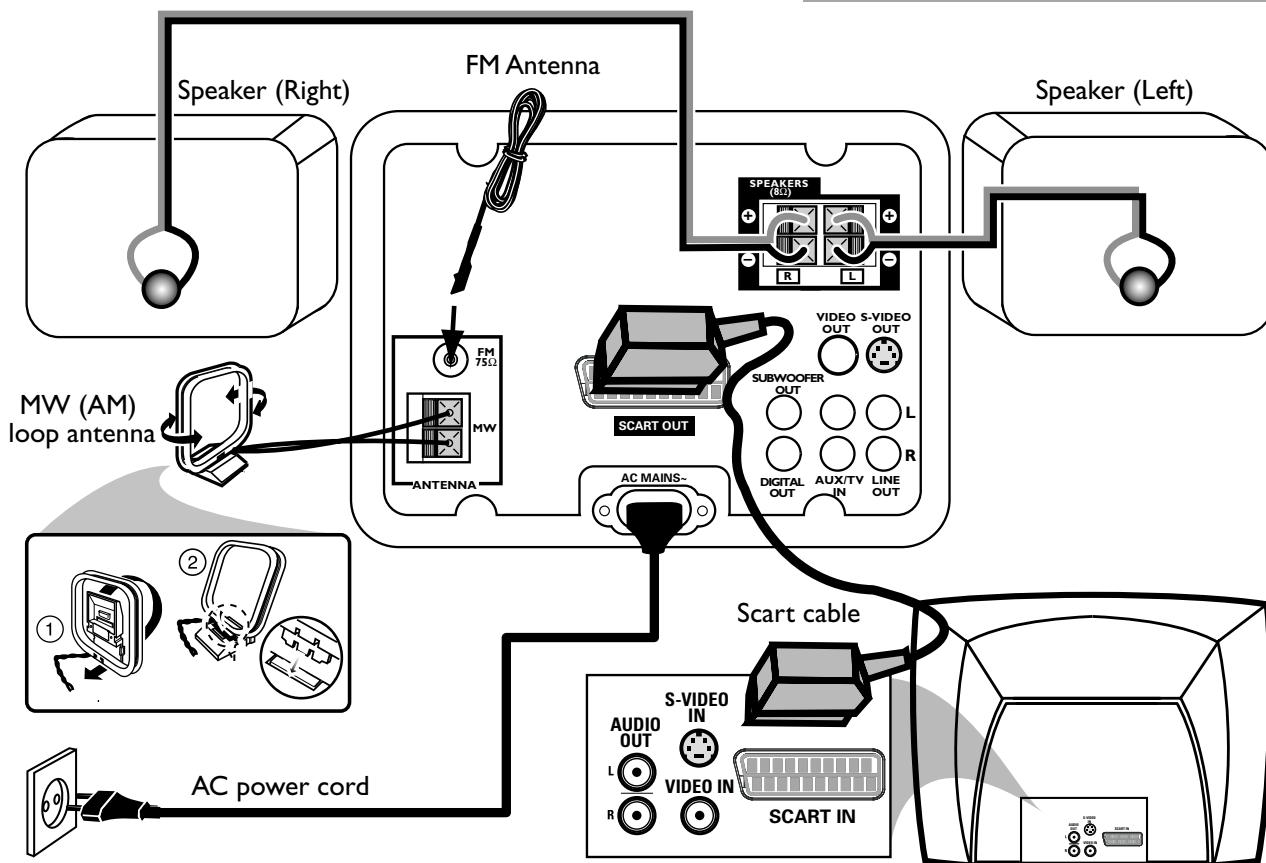

You should find the below accessories in the packaging box
(Not all the cables supplied are required for the basic hook-up).

| | | | |
|---------------------------|-------------------------------------------|------------------------------------|-----------------------------|
| <p>(A) FM antenna</p> | <p>(C) Composite video cable (yellow)</p> | <p>(E) AA size batteries</p> | <p>MW (AM) loop antenna</p> |
| <p>(B) AC power cable</p> | <p>(D) Scart cable</p> | <p>(F) Audio cable (red/white)</p> | <p>(G)</p> |

... then play (see next page)

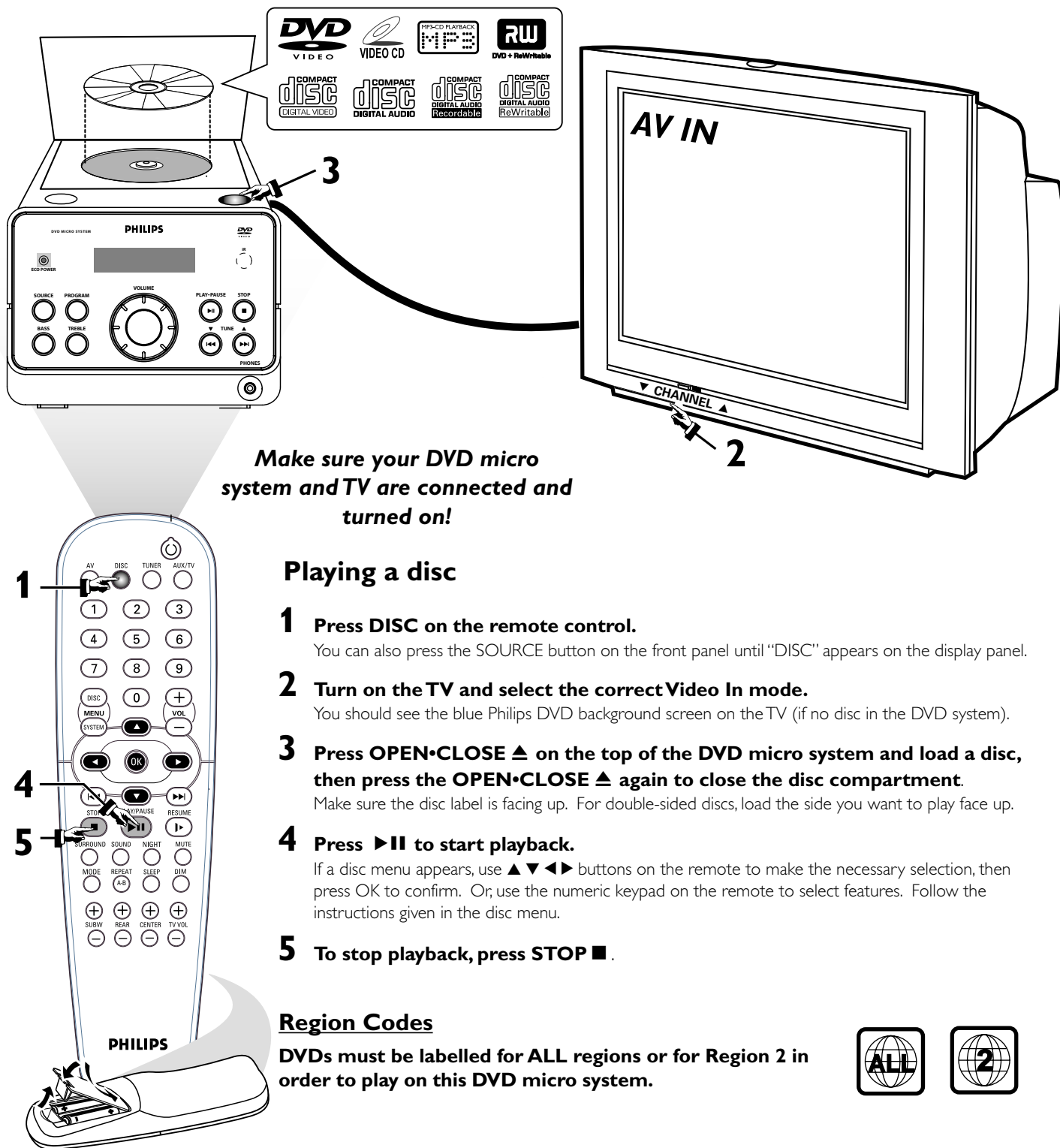

Make sure your DVD micro system and TV are connected and turned on!

Playing a disc

1 Press DISC on the remote control.

You can also press the SOURCE button on the front panel until "DISC" appears on the display panel.

2 Turn on the TV and select the correct Video In mode.

You should see the blue Philips DVD background screen on the TV (if no disc in the DVD system).

3 Press OPEN•CLOSE ▲ on the top of the DVD micro system and load a disc, then press the OPEN•CLOSE ▲ again to close the disc compartment.

Make sure the disc label is facing up. For double-sided discs, load the side you want to play face up.

4 Press ►II to start playback.

If a disc menu appears, use ▲▼◀▶ buttons on the remote to make the necessary selection, then press OK to confirm. Or, use the numeric keypad on the remote to select features. Follow the instructions given in the disc menu.

5 To stop playback, press STOP ■.

Region Codes

DVDs must be labelled for ALL regions or for Region 2 in order to play on this DVD micro system.



got sound, no picture!!

Check the AV (Audio/Video) mode on your TV.

- * Usually this channel is between the lowest and highest channels and may be called FRONT, AV IN, or VIDEO.
- * Or, you may go to channel 1 on your TV, then press the Channel down button repeatedly until you see the Video In channel.
- * Or, your TV remote control may have a button or switch that chooses different video modes.
- * See your TV manual for more details.

Detailed playback features and additional functions are described in the accompanying owner's manual.

DVD MICRO SYSTEM



PHILIPS

Important Note

Important notes for users in the U.K.

Mains plug

This apparatus is fitted with an approved 13 Amp plug. To change a fuse in this type of plug proceed as follows:

- 1 Remove fuse cover and fuse.
- 2 Fix new fuse which should be a BS1362 5 Amp, A.S.T.A. or BSI approved type.
- 3 Refit the fuse cover.

If the fitted plug is not suitable for your socket outlets, it should be cut off and an appropriate plug fitted in its place.

If the mains plug contains a fuse, this should have a value of 5 Amp. If a plug without a fuse is used, the fuse at the distribution board should not be greater than 5 Amp.

Note: *The severed plug must be disposed of to avoid a possible shock hazard should it be inserted into a 13 Amp socket elsewhere.*

How to connect a plug

The wires in the mains lead are coloured with the following code: blue = neutral (N), brown = live (L).

- As these colours may not correspond with the colour markings identifying the terminals in your plug, proceed as follows:
 - Connect the blue wire to the terminal marked N or coloured black.
 - Connect the brown wire to the terminal marked L or coloured red.
 - Do not connect either wire to the earth terminal in the plug, marked E (or \perp) or coloured green (or green and yellow).

Before replacing the plug cover, make certain that the cord grip is clamped over the sheath of the lead - not simply over the two wires.

Copyright in the U.K.

Recording and playback of material may require consent. See Copyright Act 1956 and The Performer's Protection Acts 1958 to 1972.

Italia

DICHIARAZIONE DI CONFORMITA'

Si dichiara che l'apparecchio MCD370 Philips risponde alle prescrizioni dell'art. 2 comma 1 del D.M. 28 Agosto 1995 n. 548.

Fatto a Eindhoven

Philips Consumer Electronics
Philips, Glaslaan 2
5616 JB Eindhoven, The Netherlands

Norge

Typeskilt finnes på apparatens underside.

Observer: *Nettbryteren er sekundert innkoplet. Den innebygde nettdelen er derfor ikke frakoplet nettet så lenge apparatet er tilsluttet nettkontakten.*

For å redusere faren for brann eller elektrisk støt, skal apparatet ikke utsettes for regn eller fuktighet.

DK

Advarsel: *Usynlig laserstråling ved åbning når sikkerhedsafbrydere er ude af funktion. Undgå utsættelse for stråling.*

Bemærk: *Netafbryderen er sekundært indkoblet og afbryder ikke strømmen fra nettet. Den indbyggede netdel er derfor tilsluttet til lysnettet så længe netstikket sidder i stikkontakten.*

S

Klass 1 laseraparat

Varning! *Om apparaten används på annat sätt än i denna bruksanvisning specificerats, kan användaren utsättas för osynlig laserstrålning, som överskrider gränsen för laserklass 1.*

Observera! *Stömbrytaren är sekundärt kopplad och bryter inte strömmen från nätet. Den inbyggda ntdelen är därför ansluten till elnätet så länge stickproppen sitter i vägguttaget.*

SF

Luokan 1 laserlaite

Varoitus! *Laitteen käyttäminen muulla kuin tässä käyttöohjeessa mainitulla tavalla saattaa altistaa käyttäjän turvallisuusluokan 1 ylittävälle näkymättömälle lasersäteilylle.*

Oikeus muutoksiin varataan. *Laite ei saa olla alttiina tippu- ja roiskevedelle.*

Huom. *Toiminnanvalitsin on kytketty toisiopuolelle, eikä se kytkä laitetta irti sähköverkosta. Sisäänrakennettu verkko-osa on kytkettynä sähköverkkoon aina silloin, kun pistoke on pistorasiassa.*

This product complies with the radio interference requirements of the European Community.

CAUTION

Use of controls or adjustments or performance of procedures other than herein may result in hazardous radiation exposure or other unsafe operation.

VAROITUS

Muiden kuin tässä esitettyjen toimintojen säädön tai asetusten muutto saattaa altistaa vaaralliselle säteilylle tai muille vaarallisille toiminnoille.

CAUTION

VISIBLE AND INVISIBLE LASER RADIATION WHEN OPEN AVOID EXPOSURE TO BEAM

ADVARSEL

SYNLIG OG USYNLIG LASERSTRÅLING VED ÅBNING
UNDGÅ UDSÆTTELSE FOR STRÅLING

VARNING

SYNLIG OCH OSYNLIG LASERSTRÅLNING NÄR
DENNA DEL ÄR ÖPPNAD BETRAKTA EJ STRÅLEN

VARO!

AVATTAESSA OLET ALTTIINA NÄKYVÄLLE JA
NÄKYMÄTTÖMÄLLE LASER SÄTEILYLLE. ÄLÄ KATSO
SÄTEESEEN

VORSICHT

SICHTBARE UND UNSICHTBARE LASERSTRAHLUNG
WENN ABDECKUNG GEÖFFNET NICHT DEM
STRAHL AUSSETZEN

ATTENTION

RAYONNEMENT LASER VISIBLE ET INVISIBLE EN CAS
D'OUVERTURE EXPOSITION DANGEREUSE AU
FAISCEAU

English ----- 4

Français ----- 24

Español ----- 44

Deutsch ----- 64

Nederlands ----- 84

Italiano ----- 104

Svenska ----- 124

Dansk ----- 144

Suomi ----- 164

Português ----- 184

Ελληνικά ----- 204

*Manufactured under license from Dolby Laboratories.
“Dolby” and the double-D symbol are trademarks of Dolby
Laboratories. Confidential Unpublished Works.
©1992-1997 Dolby Laboratories, Inc. All rights reserved.*

*Manufactured under license from Digital Theater Systems, Inc.
US Pat. No. 5,451,942, 5,956,674, 5,974,380, 5,978,762 and
other world-wide patents issued and pending. “DTS” and
“DTS Digital Surround” are registered trademarks of Digital
Theater Systems, Inc. Copyright 1996, 2000 Digital Theater
Systems, Inc. All Rights Reserved.*

*This product incorporates copyright protection technology
that is protected by method claims of certain U.S. patents
and other intellectual property rights owned by Macrovision
Corporation and other rights owners. Use of this copyright
protection technology must be authorized by Macrovision
Corporation, and is intended for home and other limited
viewing uses only unless otherwise authorized by
Macrovision Corporation. Reverse engineering or
disassembly is prohibited.*

CE The DVD VIDEO player is in conformity
with the EMC directive and low-voltage
directive.

English

Français

Español

Deutsch

Nederlands

Italiano

Svenska

Dansk

Suomi

Português

Ελληνικά

Introduction and General Information

| | |
|---------------------------------|---|
| Features | 5 |
| Supplied accessories | 5 |
| Environmental information | 5 |
| Installation | 5 |
| Maintenance | 5 |

Connections

| | |
|-------------------------------------------------|---|
| 1. Connecting the speakers | 6 |
| 2. Connecting antennas | 6 |
| MW Indoor Loop Antenna | |
| FM Indoor Antenna | |
| 3. Connecting a TV | 7 |
| Connecting additional equipment..... | 7 |
| 1) Listening to the playback of other equipment | |
| 2) Using the VCR for recording DVDs | |
| 3) Recording (digital) | |
| 4) Connecting an active subwoofer | |

Functional Overview

| | |
|------------------------------------|-----|
| Main unit and Remote control | 8–9 |
|------------------------------------|-----|

Preparations

| | |
|-----------------------------------------------------------|-------|
| Inserting batteries into the remote control | 10 |
| Switching on the system | 10 |
| System Setup (DVD) | 10–12 |
| Picture Setup (TV SHAPE, TV SYSTEM, VIDEO OUT, SCR SAVER) | |
| Sound Setup (DIGITAL OUT, NIGHT MODE) | |
| Language Setup (AUDIO, SUBTITLE, DISC MENU) | |
| Features Setup (PARENTAL, PASSWORD, MENU LANG, DEFAULTS) | |

Disc Operations

| | |
|---------------------------------------------------------|-------|
| Playable discs | 13 |
| Region code | |
| Basic playback | 13–14 |
| Skipping to another track/chapter | |
| Fast Search within a track/chapter | |
| Continue playback from the last stop point | |
| Selecting different play mode - Repeat and Shuffle.. | 14 |
| Repeat A-B | |
| Programme favourite tracks (audio CD or VCD only) | 14–15 |
| Using the display screen | |
| Using the menu bar | |
| Playing MP3/Picture disc (Kodak, JPEG) | 15 |

| | |
|----------------------------------------------|-------|
| Special DVD/VCD/SVCD features | 16–18 |
| Changing subtitle language | |
| Changing sound track language | |
| Playing in slow motion mode | |
| Searching for a particular passage | |
| Display the disc information during playback | |
| Moving to another title/chapter | |
| Playback from a selected point (DVD only) | |
| Zooming in | |
| Viewing from another angle (DVD only) | |
| Advancing by frames | |
| Playback Control-PBC (VCD only) | |
| Checking the contents of DVD | |

Radio Reception

| | |
|------------------------------------------|----|
| Tuning to radio stations | 19 |
| Presetting radio stations | 19 |
| Listening to preset radio stations | 19 |

Basic Functions

| | |
|-----------------------------------------------------------|----|
| Volume control | 20 |
| Selecting surround sound | 20 |
| Selecting the digital sound effect | 20 |
| Dimming the display screen | 20 |
| Adjusting Bass/Treble level | 20 |
| Using the remote to operate your Philips television | 20 |
| Sleep timer setting | 20 |

Specifications

Troubleshooting

Glossary

Features

Built-in DTS and Dolby® Digital decoder, 2.1-channel amplifier

Additional Component Connections

Lets you connect other audio and audio/visual components to the DVD micro system.

Night Mode

Lets you compress the dynamic range, reducing the difference in loudness between different sounds in Dolby Digital mode.

Parental Control (Rating Level)

Lets you set a ratings level so that your children cannot watch a DVD that has a rating higher than you set.

Sleep Timer

Enables the system to switch to standby mode automatically at a preset time.

Supplied accessories

- Remote control with two AA batteries
- MW (AM) loop antenna and FM wire antenna
- Scart cable for connection with the TV
- Audio cable (white/red)
- Composite video cable (yellow)
- Two satellite speakers
- Power cable for connection with the main unit
- This instruction booklet and Quick Use Guide

If any item is damaged or missing, contact your retailer or Philips.

Environmental information

All unnecessary packaging has been omitted. We have tried to make the packaging easy to separate into three materials: cardboard (box), polystyrene foam (buffer) and polyethylene (bags, protective foam sheet).

Your system consists of materials which can be recycled and reused if disassembled by a specialised company. Please observe the local regulations regarding the disposal of packaging materials, exhausted batteries and old equipment.

Installation

- Place the player on a flat, hard, and stable surface.
- In a cabinet, allows about 10cm (4 inches) of free space all around the player for adequate ventilation.
- Do not expose your player to extreme temperatures or humidity.

Maintenance

- When a disc becomes dirty, clean it with a cleaning cloth. Wipe the disc from the center out, in a straight line.
- Do not expose the player, batteries or discs to humidity, rain, sand or excessive heat (caused by heating equipment or direct sunlight). Always keep the disc tray closed to avoid dust on the lens.
- Do not use solvents such as benzene, thinner, commercially available cleaners, or anti-static spray intended for colour discs.
- The lens may cloud over when the player is suddenly moved from cold to warm surroundings, making it impossible to play a disc. Leave the player in the warm environment until the moisture evaporates.

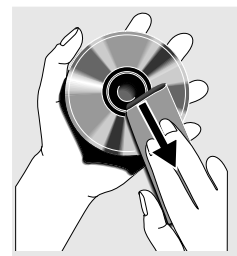

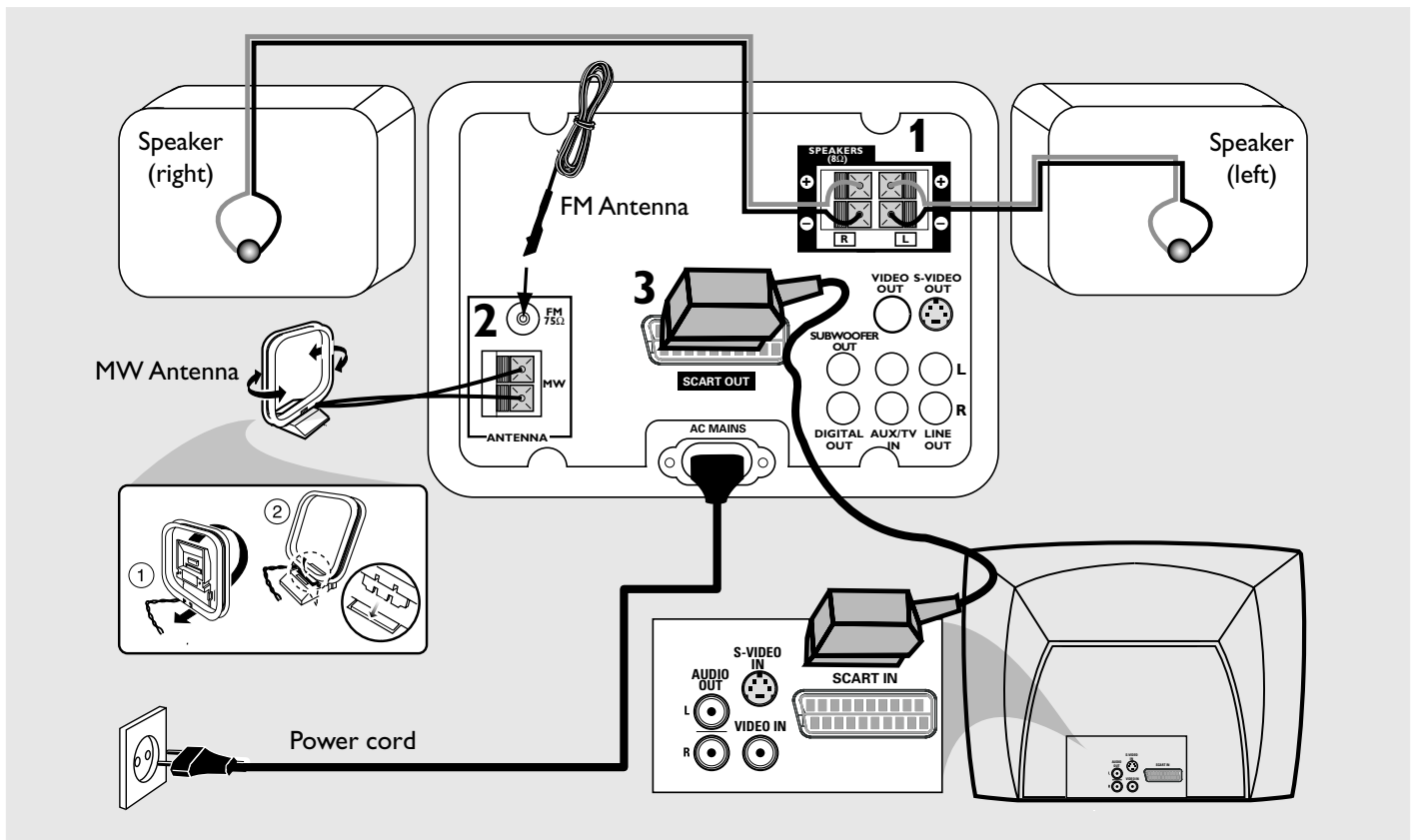

IMPORTANT!

- Before connecting the AC power cord to the wall outlet, ensure that all other connections have been made.
- Never make or change any connections with the power switched on.
- The type plate is located at the rear or bottom of the system.

1. Connecting the speakers

Connect the speaker cables to the **SPEAKERS** terminals. Right speaker to "R" and left speaker to "L", red (marked) wire to "+" and black (unmarked) wire to "–". Fully insert the stripped portion of the speaker wire into the terminal as shown.

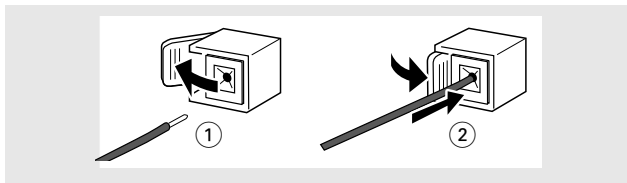

Helpful Hints:

- Ensure that the speaker cables are correctly connected. Improper connections may damage the system due to short-circuit.
- For optimal sound performance, use the supplied speakers.
- Do not connect more than one speaker to any one pair of + / – speaker jacks.
- Do not connect speakers with an impedance lower than the speakers supplied. Please refer to the **SPECIFICATIONS** section of this manual.

2. Connecting antennas

MW Indoor Loop Antenna

Connect the supplied MW (AM) loop antenna's wires to **MW** jack. Place the antenna on a shelf or attach it to a stand or wall.

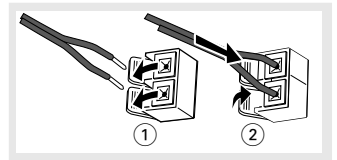

FM Indoor Antenna

Connect the supplied FM antenna to the **FM (75 Ω)** jack. Extend the FM antenna and fix its ends to the wall.

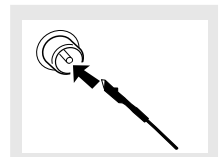

For better FM stereo reception, connect an external FM antenna using an 75 ohm coaxial cable (not supplied).

Helpful Hints:

- Adjust the position of the antennas for optimal reception.
- Position the antennas as far as possible from your TV, VCR or other radiation source to prevent unwanted interference.

3. Connecting a TV

You must connect a TV to your DVD micro system in order to view the DVD/VCD playback.

IMPORTANT!

– There are various ways to connect the system to a TV. You only need to make one of the best connections, depending on the capabilities of your TV system.

- Use the supplied Scart cable to connect **SCART OUT** jack to the corresponding SCART VIDEO IN jack on a TV.

If your TV is not equipped with a Euroconnector, you can select one of the following alternative connections :

Option 1

Connect the **S-VIDEO OUT** jack to the S-Video input jack on the TV using a S-Video cable (not supplied).

If S-Video jack is used for video connection, the system's VIDEO OUT setting will need to be set accordingly. Details are on page 11.

OR

Option 2

Connect the **VIDEO OUT** jack to the video input jack on the TV using a video cable (yellow).

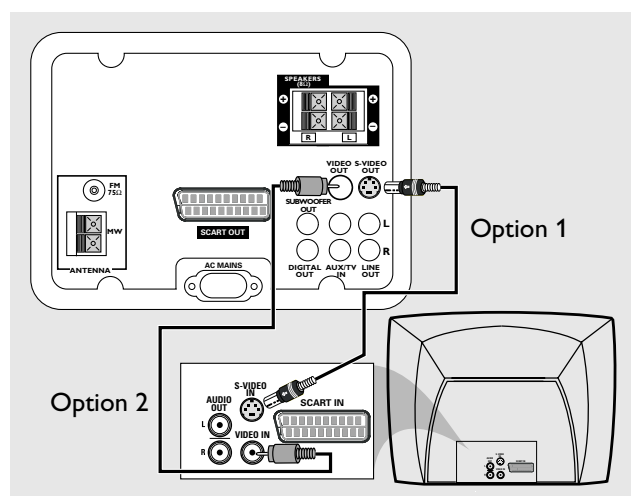

Helpful Hints:

– To avoid magnetic interference, do not position the front speakers too close to your TV.

Connecting additional equipment

IMPORTANT!

– Some DVDs are copy-protected. You cannot record the disc through a VCR or digital recording device.

– When making connections, make sure the colour of cables matches the colour of jacks.

– Always refer to the owner's manual of the other equipment for complete connection and usage details.

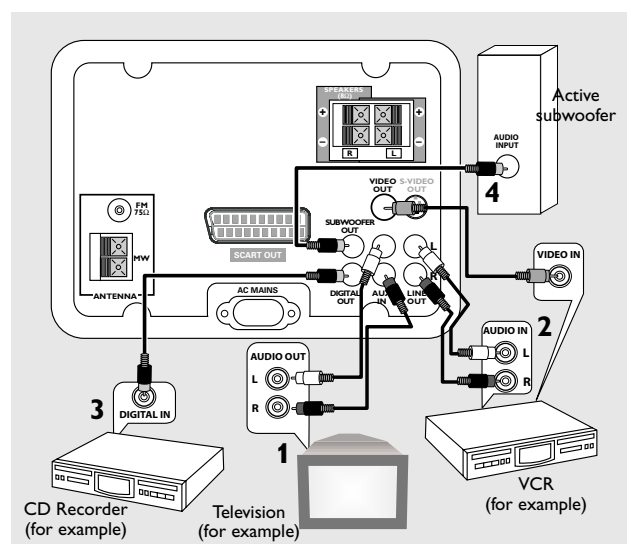

1) Viewing and listening to the playback of other equipment

Connect the system's **AUX/TV IN (R/L)** jacks to the **AUDIO OUT** jacks on the other audio/visual device (such as a TV, VCR, Laser Disc player or cassette deck).

Before starting operation, press **AUX/TV** on the remote in order to activate the input source.

2) Using the VCR for recording DVDs

Connect the system's **VIDEO OUT** jacks to the **VIDEO IN** jacks and **LINE OUT (R/L)** jacks to the **AUDIO IN** jacks on the VCR. This will allow you to make analogue stereo (two channel, right and left) recordings.

3) Recording (digital)

Connect the system's **DIGITAL OUT** jack to the **DIGITAL IN** jack on a digital recording device (such as DTS-Digital Theatre compatible, with Dolby Digital decoder).

Before starting operation, set the **DIGITAL OUTPUT** according to the audio connection. (See page 11).

4) Connecting an active subwoofer

Connect the DVD micro system's **SUBWOOFER OUT** jack to the **AUDIO INPUT** jack on an active subwoofer (not supplied).

Main unit and Remote control

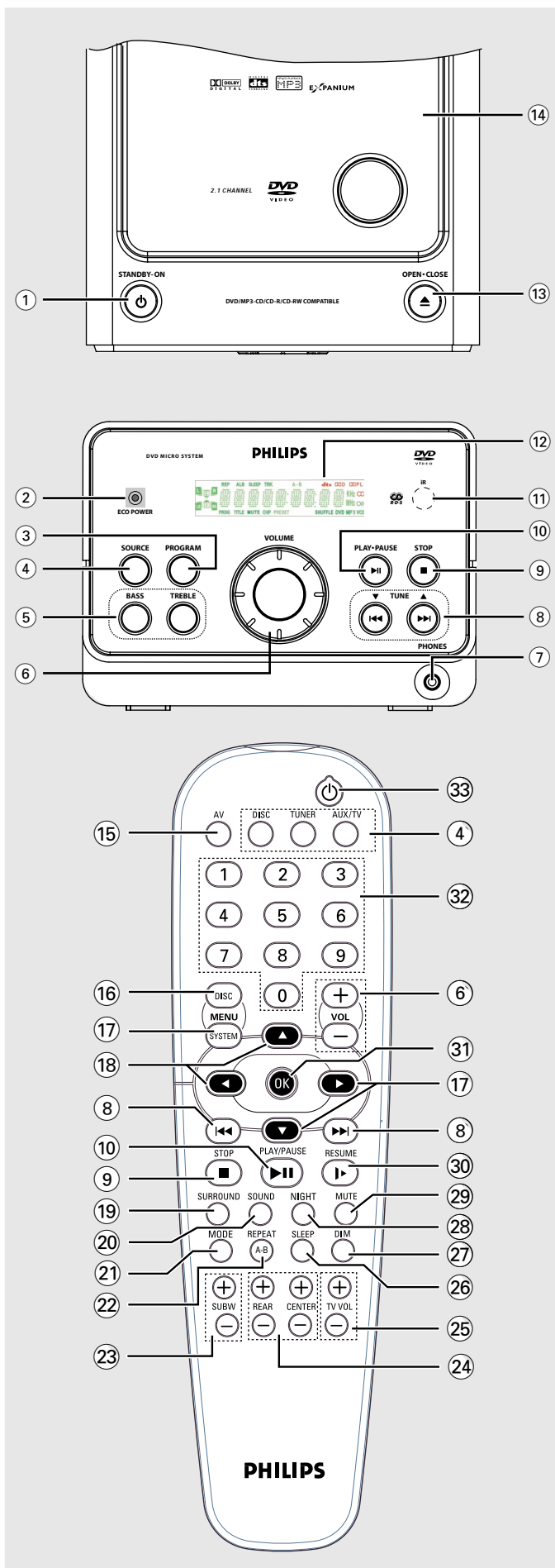

- ① **STANDBY ON** \odot
 - Switches between power on and Eco power standby modes.
- ② **ECO POWER indicator**
 - Lights up when the system is in Eco Power standby mode.
- ③ **PROGRAM**
 - In Disc mode, to programme disc tracks.
 - In Tuner mode, to programme preset radio stations.
- ④ **SOURCE**
 - Selects the desired source or external input source (DISC, TUNER or AUX/TV).
- ⑤ **BASS / TREBLE**
 - Selects bass or treble sound. Use the VOLUME control to select the desired enhancement level.
- ⑥ **VOLUME (VOL + -)**
 - Adjusts the master volume.
- ⑦ **PHONES**
 - Connect to headphones.
- ⑧ **TUNE ∇ \blacktriangle (\lll / \ggg)**
 - In Disc mode, press to skip to the previous/next chapter/track.
 - In Disc mode, hold down to fast reverse/forward the disc.
 - In Tuner mode, tune to a lower or higher radio frequency.
- ⑨ **STOP \blacksquare**
 - Stops playing the disc or erases a programme.
- ⑩ **PLAY-PAUSE $\blacktriangleright \parallel$**
 - Starts or interrupts disc playback.
- ⑪ **iR**
 - Points the remote control towards this sensor.
- ⑫ **Display screen**
- ⑬ **OPEN-CLOSE \blacktriangle**
 - Opens or closes the disc tray.
- ⑭ **Disc compartment**

- ⑮ **AV (for Philips TV only)**
 - Selects Philips television's AV (Audio/Video) channel.
- ⑯ **DISC MENU (disc mode only)**
 - Enters or exits the disc contents menu.
- ⑰ **SYSTEM MENU (disc mode only)**
 - Enters or exits the system menu bar.
- ⑱ **▲ ▼ ◀ ▶**
 - In Tuner mode, use ◀ or ▶ to select a preset radio station.
 - In Disc mode, to select movement direction in disc contents menu / system menu bar.
- ⑲ **SURROUND**
 - Selects surround (Dolby Digital, DTS-Digital Theatre Systems or VSS-Virtual Surround Sound) or stereo sound effect.
- ⑳ **SOUND**
 - Selects various sound effects : CONCERT, DRAMA, ACTION, SCI-FI, CLASSIC, JAZZ, ROCK or DIGITAL.
- ㉑ **MODE**
 - During disc playback, to select various repeat modes.
 - While playback stopped, to turn on/off shuffling mode.
- ㉒ **REPEAT A-B**
 - Repeats a specific section on a disc.
- ㉓ **SUBW + / –**
 - Adjusts the subwoofer's sound level (for optional active subwoofer that connected to this DVD micro system).
- ㉔ **REAR + / – , CENTER + / –**
(Not applicable for this model)
- ㉕ **TV VOL + / –**
 - Adjusts TV's volume (Philips TV only).
- ㉖ **SLEEP**
 - Sets the sleep timer (auto-off) function.
- ㉗ **DIM**
 - Selects different levels of brightness for the display screen.
- ㉘ **NIGHT (in Dolby Digital mode only)**
 - Optimises the dynamics of the sound output.

- ㉙ **MUTE**
 - Mutes or restores the volume.
- ㉚ **RESUME**
 - Continues disc playback after an interruption.
 - When playing picture CD, to select different slide show mode.
- ㉛ **OK**
 - Exits or confirms the selection.
- ㉜ **Numeric Keypad (0-9)**
 - Enters a track/title number of the disc.
 - Enters a number of a preset radio station.
- ㉝ **⏻**
 - Switches to standby mode.

Notes for remote control:

- **First, select the source you wish to control by pressing one of the source select keys on the remote control (DISC or TUNER, for example).**
- **Then select the desired function (▶, ◀◀, ▶▶ for example).**

Preparations

Inserting batteries into the remote control

- 1 Open the battery compartment.
- 2 Place the batteries in the compartment with the correct polarity as indicated by " + " and " - " symbols.
- 3 Close the cover.

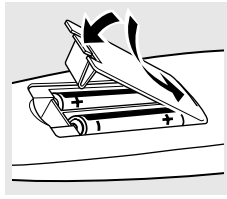

CAUTION!

- Remove batteries if they are exhausted or if the remote is not to be used for a long time.
- Do not use old and new or different types of batteries in combination.
- Batteries contain chemical substances, so they should be disposed off properly.

Switching on the system

- 1 After completing all the connections, connect the AC power cord of the player to the power outlet.
- 2 Press **STANDBY ON** to switch on the last selected source.
- 3 Adjust the **SOURCE** button (or press **DISC**, **TUNER** or **AUX/TV** on the remote) to select the input source.
→ The selected source will be displayed.
- **For viewing a DVD or VCD disc**, a TV set needs to be connected (refer to "Connections - Connecting a TV"). Switch on the TV and set to the correct video in channel (for example, EXT1, EXT2, AV1, AV2). Refer to your TV instruction manual for details.
→ The default screen appears on the TV.

System Setup (DVD)

The system setup is carried out via the TV, enabling you to customise the DVD micro system to suit your particular requirement. If the preferred options selected are not available on a disc, then the disc's own preference will be used.

IMPORTANT !

To access the System Setup menu, playback must be stopped.

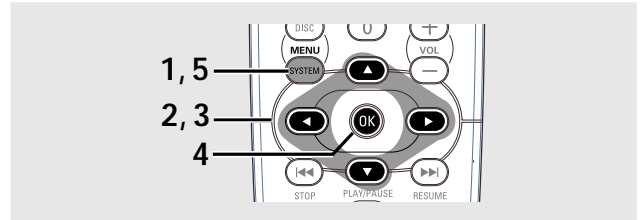

To enter System Setup menu

- 1 In disc mode, press **SYSTEM MENU** on the remote.
→ icon will be highlighted in the menu bar on the TV screen.
- 2 Press ▼ to activate the System Setup menu.
- 3 Use ▲▼ keys to select one of the setup menu options and press ► to enter the menu.

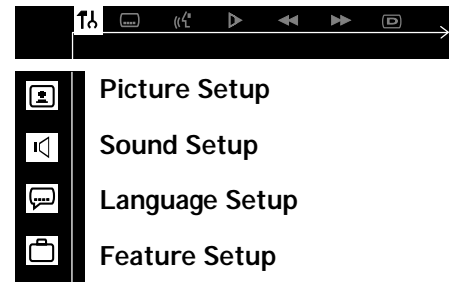

- 4 Press **OK** to confirm your selection.
- 5 To exit the System Setup menu, press **SYSTEM MENU**.

Picture Setup

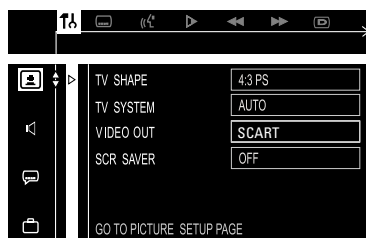

TV SHAPE

Select the aspect ratio of the TV to be connected. If your DVD is not encoded to allow you to change the aspect ratio, TV shape cannot be changed.

4:3 PS (panscan)

Select this if you have a conventional TV set and your DVD is not formatted for widescreen viewing, use this setting. A wide picture is displayed on the whole TV screen with a portion automatically cut off.

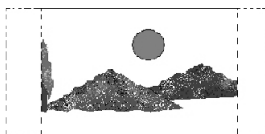

4:3 LB (letterbox)

Select this if you have a conventional TV set and your DVD is formatted for widescreen viewing, use this setting. Wide bands are displayed on the upper and lower portions of the TV screen.



16:9 (widescreen)

Select this if you have a widescreen TV set, use this setting (you must also set your widescreen TV to "full size").

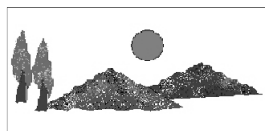

TV SYSTEM

Allows you to select the colour system that corresponds to your TV.

AUTO

Select this if the connected TV is multi system, select this mode. The output format will be in accordance with the video signal of the disc.

NTSC

Select this if the connected TV is NTSC system, select this mode. It will change the video signal of a PAL disc and output to NTSC format.

PAL

Select this if the connected TV is PAL system, select this mode. It will change the video signal of an NTSC disc and output to PAL format.

VIDEO OUT

Set the Video Output according to your video connection. This setting is not required if you are using the VIDEO OUT jack (yellow) to connect the DVD micro system to your TV.

SCART

Select this if you have connected the DVD micro system to your TV using the Scart jack.

S-VIDEO

Select this if you have connected the DVD micro system to your TV using S-Video jack.

SCR SAVER (Screen Saver)

OFF

Select this to disable the screen saver function.

ON

Select this if you wish to dim the TV screen when the disc playback is stopped or paused for more than one minute. This will prevent your display device from becoming damaged.

Sound Setup

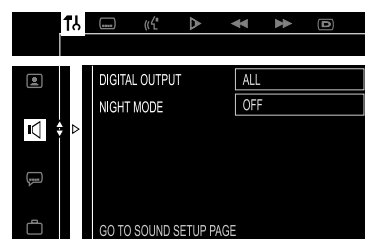

DIGITAL OUTPUT

Allows you to specify the type of digital output suitable for the optional audio equipment that connected through the DIGITAL OUT at the rear of your DVD micro system.

ALL

Select this if you have connected the digital output to a multichannel decoder receiver.

PCM 96K

Select this if the optional audio equipment is capable of processing digital signal input with sampling rates of 96 kHz.

PCM 48K

Select this if the optional audio equipment is incapable of processing 96 kHz digital signal input. The signal will then be converted to a standard signal with sampling rates of 48 kHz.

OFF

Select this to deactivate the digital output.

NIGHT MODE

Night function can also be accessed via the remote control.

OFF

Select this when you want to enjoy the surround sound with its full dynamic range.

ON

Select this to level out the volume. High volume outputs will be softened and low volume outputs are brought upward to an audible level. This feature is only available for movies with Dolby Digital mode.

Language Setup



AUDIO / SUBTITLE / DISC MENU

Select your preferred language settings for your DVD (audio language, subtitle language and disc menus) so that the system will automatically switch to the selected language whenever you load a DVD. If the language selected is not available on the disc, the original language designated by each disc will be selected.

Features Setup

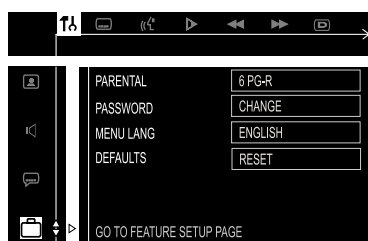

PARENTAL

Enables setting of playback limitation level. Some DVDs may have a parental level assigned to the complete disc or to certain scenes on the disc. The rating levels are from 1 to 8 and are country dependent. You can prohibit the playing of certain discs that are not suitable for your children or have certain discs played with alternative scenes.

- 1 Use the **numeric keypad (0-9)** to enter '1234' (default password) when you are asked to enter the four-digit password. You will have to enter the same code, exactly, twice.

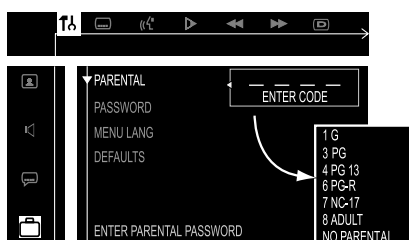

- 2 Use **▲▼** keys to select a rating level.
- 3 Press **OK** to confirm.

Rating explanations

NO PARENTAL – It will play all discs.

8 ADULT – Mature material; should be viewed only by adults due to graphic sexual material, violence, or language.

7 NC-17 – No children under age 17; not recommended viewing for children under age 17.

6 PG-R – Parental Guidance - Restricted; recommended that parents restrict children under 17 from viewing or allow to view only when supervised by a parent or adult guardian.

4 PG13 – Material is unsuitable for children under age 13.

3 PG – Parental Guidance suggested.

1 G – General Audience; recommended as acceptable for viewers of all ages.

Helpful Hints:

- Some DVDs are not encoded with a rating though the movie rating is printed on the disc jacket. The rating level feature does not work for such discs.
- If the player's parental level is set below 8, only discs with a lower or equal level will play. For example, if the player is set to 5, only discs with ratings of 5, 4, 3, 2 and 1 will be played. Higher rated scenes will not be played unless an alternative that has the same rating or lower is available on the disc. For example, consider a disc that generally is suitable for most audiences, and it is rated at level 2 for the most part. However, in the middle, there are also scenes rated at 5 (not suitable for children).

To enable playback of a higher rated disc or scene than the level set

Go to 'PARENTAL' and enter the four-digit cord before resetting the rating level to a higher number.

If you forget the 4-digit code

Press **■** **four times** when prompted for the password cord and the system will change back to the default password (1234).

PASSWORD

To set a new password for the parental control or to change the password.

CHANGE

If you are asked to enter the code for the first time, key in '1234' (default password). Then enter your new four-digit password code, twice.

MENU LANG (Menu language)

Select the language for on screen display.

DEFAULTS

RESET

Pressing **▶** on the remote will restore all the items in the setup menu to the original factory setting except for your Parental Control password.

IMPORTANT!

- DVD discs and players are designed with regional restrictions. Before playing a disc, make sure the disc is for the same zone as your player.
- Depending on the DVD or VIDEO CD, some operations may be different or restricted.
- Do not push on the disc tray or put any objects other than discs on the disc tray. Doing so may cause the disc player to malfunction.
- Do not move the disc player during playback, as doing so may damage the DVD micro system.
- The lens of the CD player should never be touched.

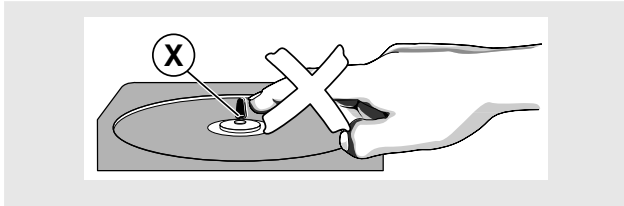

Playable discs

Your DVD player is able to play :

- Digital Video Discs (DVDs)
- Video CDs (VCDs)
- Super Video CDs (SVCDs) and AVCDs
- Digital Video Discs + Rewritable (DVD+RW)
- Compact Discs (CDs)
- MP3 discs, Picture (Kodak, JPEG) files on CD-R(W).
 - ISO 9660 format, UDF format
 - Supported sampling frequencies: 32 kHz, 44.1 kHz, 48 kHz
 - Supported bit-rates: 32~256 (Kbps), Variable bit-rates.



Region Codes

DVDs must be labeled for **ALL** regions or for **Region 2** in order to play on this DVD system. You cannot play discs that are labeled for other regions.



Helpful Hints:

- If you are having trouble playing a certain disc, remove the disc and try a different one. Improperly formatted discs will not play on this DVD system.

Basic playback

- 1 Press **SOURCE** until "DISC" appears on the display panel (or **DISC** on the remote).
- 2 Press **OPEN-CLOSE** button to open the disc compartment and load a disc, then close the disc compartment.
 - Make sure the label side is facing up. For double-sided discs, load the side you want to play face up.
- Some discs will start playing automatically, and others will display the Disc Contents Menu on the TV screen. If the menu is presented, use keys to highlight your selection and press **OK** to confirm. To select a play option, press **numeric keypad (0-9)**.
- 3 Press **▶||** to start playback.

Helpful Hints:

- If the inhibit icon appears on the TV screen when a button is pressed, it means the function is not available on the disc you are playing.

To interrupt playback

- Press **▶||**.
 - The picture freezes and the sound will be muted.
 - You are not able to select another track/chapter/title during pause mode.
- To resume playback, press **▶||** again.

To stop playback

- Press **■**.

Skipping to another track/chapter

- Press **◀◀** or **▶▶** repeatedly during playback to skip backward or forward. Each press will take the disc to the beginning of the current or next track/chapter.

Helpful Hints:

- If the **REPEAT TRACK** mode is active, pressing **◀◀** or **▶▶** will replay the same track/chapter.

To go directly to any track/chapter

- Use the **numeric keypad (0-9)** to enter the number of the desired track/chapter.

Fast Search within a track/chapter

- 1 Hold down **◀◀** or **▶▶** about **two seconds** to fast reverse or forward the disc.
- 2 To resume normal play, press **▶||**.

Continue playback from the last stop point

- In stop mode and when a disc has not been removed, press **RESUME** on the remote to resume playback from the point at which it stopped.

To cancel the resume mode

- Press **■** again.

Helpful Hints:

- Open the disc compartment or disconnect the system from the power supply will cancel the resume option.
- Resume option is not available when the VCD playback control is turned on (if PBC is on).
- The resume option may not be available on some discs.

Selecting different play mode - Repeat and Shuffle

You can use the **MODE** button on the remote to select different repeat and shuffle play mode.

DVD

Repeat Chapter → Repeat Title → Repeat Off

VCD (with PBC mode OFF) and CD

In stop mode, press **MODE** button repeatedly to select:
Shuffle → Shuffle + Repeat Disc → Off

When playback begins,

→ If 'Shuffle' or 'Shuffle + Repeat Disc' is selected, you can press **MODE** button repeatedly during playback to select:
Shuffle → Shuffle + Repeat Disc

→ If 'Off' is selected, you can press **MODE** button repeatedly during playback to select:

Repeat Track → Repeat Disc → Repeat Off

→ If playing the programmed tracks, you can press **MODE** button repeatedly to select:

Repeat Program → Repeat Off

MP3-CD and Picture CD

During playback, press **MODE** button repeatedly to select:
Repeat Track → Repeat Album (with menu on only)
→ Repeat Disc → Repeat Off

To cancel all the repeat/shuffle mode

- In stop mode, press **■** again.

Helpful Hints:

- Repeat play might not work correctly with some DVDs.
- For VCD, repeat play will not be possible if the PBC mode is turned on.
- For MP3 disc, Repeat Album will not be possible if the menu is turned off.
- Shuffle function is not applicable for programmed tracks, DVD, MP3-CD and Picture CD playback.

Repeat A-B

You can play a specific section in a track/chapter repeatedly.

- 1 Press **REPEAT A-B** on the remote at your chosen starting point.
- 2 Press **REPEAT A-B** again at your chosen end point.
→ The passage will now repeat continuously.
- 3 To resume normal play, press **REPEAT A-B** again.

Helpful Hints:

- The section A and B can be set only within the same chapter/track.

Programme favourite tracks (audio CD or VCD only)

You can play the contents of the disc in the order you want by programming the order of the tracks to be played. Up to 99 tracks can be stored.

Helpful Hints:

- Programme DVD and MP3-CD is not possible.

Using the display screen

- 1 While playback is stopped, press **PROGRAM** to enter programme mode.
→ "PROG" icon lights up and "P 00:00" appears.
- 2 Use the **numeric keypad (0-9)** to input the track number in the order you want.
→ "FULL" will appear if 99 tracks have been programmed.
- 3 Press **OK** to store the track.
- Repeat **steps 2-3** to store other tracks.
- 4 To start programme play, press **▶II**.
- 5 To stop playback, press **■ once**.
- 6 To cancel the programme, press **■** again in stop mode.

Using the menu bar

IMPORTANT!

You have to turn on your TV and set to the correct Video In channel (see page 10 - Switching on the system).

- 1 Stop playback, then press **SYSTEM MENU**.
→ The menu bar will appear across the top of the TV screen.
- 2 Press ► key to select and press ▼ to enter the programme menu.

PROGRAM P 00 : 00

- 3 Use **numeric keypad (0-9)** to enter the track number to be programmed.
- 4 Press **OK** to confirm the program.
- Repeat **steps 2-4** to store other tracks.
- 5 Press ► **II** to start programme playback.
- 6 To stop playback, press ■ **once**.
- 7 To cancel the programme, press ■ again in stop mode.

Helpful Hints:

– The system will exit programme menu automatically if no key is pressed within ten seconds during programming mode.

Playing MP3/Picture disc (Kodak, JPEG)

IMPORTANT!

You have to turn on your TV and set to the correct Video In channel (see page 10 - Switching on the system).

- 1 Load an MP3/Picture (Kodak, JPEG) disc.
→ The disc reading time may exceed 30 seconds due to the complexity of the directory/file configuration.
- 2 Playback will start automatically.
→ For picture discs, you can see the still pictures one after another automatically in the slide-show playback.
→ For MP3 discs, the tracks will play automatically and the TV displays: MP3 MENU OFF
PRESS DISC MENU TO
TURN ON. You can press **DISC MENU** to turn on the MP3 menu, a list of albums/titles will appear on the TV.

| | |
|------|----------------------|
| Root | Root |
| | MP3 "Title Name 1" 1 |
| | MP3 "Title Name 2" 2 |
| | MP3 "Title Name 3" 3 |
| | MP3 "Title Name 4" 4 |
| | MP3 "Title Name 5" 5 |

During playback, you can:

- Press ◀◀ / ▶▶ to select another title/picture in the current folder.
- Press **REPEAT** to select available repeat mode.
- Press ► **II** to pause/resume playback.
- For picture disc only, you can press **RESUME** to select different slide-show playback modes :

| | |
|-----------|-------------------------------------------|
| Mode 0 : | no special transition effect (by default) |
| Mode 1 : | wipe from top to bottom |
| Mode 2 : | wipe from bottom to top |
| Mode 3 : | wipe from top/bottom to centre |
| Mode 4 : | wipe from centre to top/bottom |
| Mode 5 : | wipe from vertical blind |
| Mode 6 : | wipe from left to right |
| Mode 7 : | wipe from right to left |
| Mode 8 : | wipe from left/right to centre |
| Mode 9 : | wipe from centre to left/right |
| Mode 10 : | wipe from edge to centre |
| Mode 11 : | horizontal blinds |
| Mode 12 : | random |

- 3 To stop playback, press ■.
- In stop mode, you can use ◀▶ ▲ ▼ keys on the remote to move within the menu and press **OK** to select the desired file to play.

Helpful Hints:

– Due to the recording nature of Digital Audio MP3 (DAM), only digital audio music will play.
– It is normal to experience an occasional "skip" while listening to your MP3 discs.
– Some files on Kodak or JPEG discs may be distorted during playback due to the configuration and characteristics of the disc.
– For multi-session discs with different formats, only the first session will be available.

Special DVD/VCD/SVCD features

A number of operations can be carried out directly via the multiple menu bars on the TV screen without interrupting disc playback.



From the left,
 SETUP MENU → SUBTITLE → LANGUAGE → SLOW
 → FAST REVERSE → FAST FORWARD → STATUS



From the left,
 TITLE SEARCH → CHAPTER SEARCH → TIME
 SEARCH → ZOOM → ANGLE → STEP →
 PBC ON/OFF



From the left,
 PROGRAM

IMPORTANT!

Some operations may be different or restricted, depending on the disc format. Refer to the jacket or case of the disc you are playing.

- 1 In disc mode, press **SYSTEM MENU**.
 → The menu bar will be displayed across the top of the TV screen.
- 2 Press ◀ or ▶ to move through the menu bar.
- 3 Press ▼ to select the highlighted icon and use ▲▼ keys to select your preferred option.
- 4 Press **OK** to confirm a highlighted selection.
- 5 To exit, press **SYSTEM MENU**.

Changing subtitle language

This operation works only on DVDs with multiple subtitle languages.

- Select from the menu bar and press ▼ key to select the desired language.

Changing sound track language

This operation works only on DVDs with multiple soundtrack language.

- Select from the menu bar and press ▼ key to select the desired language.

For VCD/SVCD:

- Press ▼ to select the desired audio channels for sound :
 LEFT VOCAL → RIGHT VOCAL → MONO LEFT
 → MONO RIGHT → LEFT VOCAL

Helpful Hint:

– When the desired language is not selected even after pressing the button several times, it means the language is not available on the disc.

Playing in slow motion mode



- 1 Select from the menu bar and press ▼ key to select the required slow motion speed :
 SF X2 → SF X4 → SF X8 → SR X2 → SR X4 →
 SR X8 → PLAY

(SF) = slow forward
 (SR) = slow reverse

For VCD/SVCD:

- 1 Press ▼ key to select the required slow motion speed :
 (forward): SF X1 → SF X2 → SF X3 → PLAY
- 2 To resume normal play, press ►||

Helpful Hint:

– The sound will be muted during slow-motion play.

Searching for a particular passage

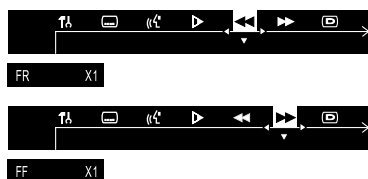

- 1 Select or from the menu bar to select fast reverse search or fast forward search respectively.
- 2 Press key to select the required search speed :
(reverse): FR X2 → FR X4 → FR X6 → FR X8 → PLAY
(forward): FF X2 → FF X4 → FF X6 → FF X8 → PLAY

For VCD/SVCD:

- 2 Press key to select the required search speed :
(reverse): FR X1 → FR X2 → FR X3 → FR X4 → PLAY
(forward): FF X1 → FF X2 → FF X3 → FF X4 → PLAY
- 3 To resume normal play, press

Helpful Hint:

– The sound will be muted during fast reverse or forward search.

Display the disc information during playback

- Select from the menu bar and press key to select the following display informations :

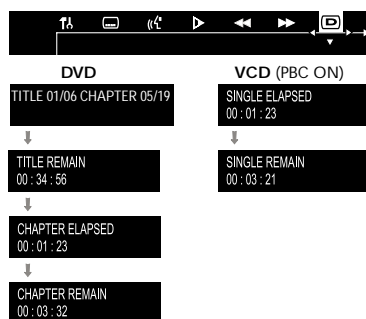

Moving to another title/chapter

Some discs may contain more than one title or chapter. If the disc has a title or chapter menu recorded on it, you can start playback from the selected item.

- 1 Select **T** (title) or **C** (chapter) from the menu bar.
- 2 Use **numeric keypad (0-9)** to select a desired title/ chapter number and press **OK** to start playback.

Helpful Hint:

– Selecting a title or chapter might not be possible on certain discs.

Playback from a selected point (DVD only)

This function allows you to start playing at any chosen time on the disc.



- 1 Select from the menu bar.
- 2 Enter hours, minutes and seconds from left to right in the time edit box using the **numeric keypad (0-9)**.
→ Each time an item has been entered, the underline of this item will disappear.
- 3 Press to start playback.

Helpful Hint:

– If the repeat playback mode is active, the time search function will not be available.

Zooming in

This function allows you to enlarge the picture on the TV screen and to pan through the enlarged image.

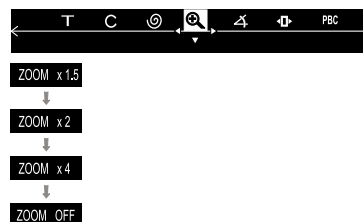

- 1 Select from the menu bar and press key repeatedly to select a zoom factor : x1.5 → x2 → x4 → OFF.
- 2 To pan through the enlarged image, use keys to move the zoomed picture left, right, up and down.
- 3 To exit ZOOM mode, select zoom factor to "ZOOM OFF" from the menu bar.

Viewing from another angle (DVD only)

If the disc contains sequences recorded from different camera angles, this allows you to view the picture from different angles. The selections of angle are depending on the disc format.



- Select from the menu bar and press keys to select the desired angle : 1/4, 2/4, 3/4 or 4/4.
→ Playback changes to the selected angle.

Advancing by frames



- 1 Select from the menu bar and press key to play the disc step by step (one frame each step).
- 2 To resume normal play, press .

Playback Control-PBC (VCD only)

PBC playback allows you to play Video CDs interactively, following the menu on the display.



- Select in the menu bar and press key to select 'PBC ON' or 'PBC OFF'.

When playing a disc with PBC function

- If "PBC OFF", the system will start playback automatically.
- If "PBC ON", the PBC menu (if available) will appear on the TV screen for selection. Use the **numeric keypad (0-9)** to enter your choice.

Helpful Hints:

- If PBC mode is switched on, TIME SEARCH and REPEAT functions are not available.



Checking the contents of DVD

- 1 Press **DISC MENU** on the remote.
 - If the current title has a menu, the menu will appear on the screen. Otherwise, the disc menu will be displayed.
- 2 Use , , , keys to select the desired title or chapter, followed by or **OK**.
 - The selected title or chapter starts playing.



Helpful Hints:

- The details of operation might differ depending on the DVD discs.
- Selecting a title or disc might not be possible on certain DVD discs.

Tuning to radio stations

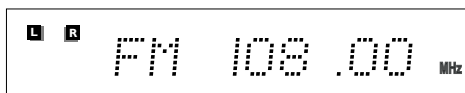
- 1 Press **STANDBY ON**  to switch on the last selected source.
- 2 Adjust **SOURCE** (or press **TUNER** on the remote) to select TUNER mode.
- 3 Press **TUNER** again to select the desired band : FM or MW.
- 4 Press and hold  or  until the frequency indication starts to change, then release.
→ The system automatically tunes to the next strong radio station.



- To tune to a weak station, press  or  briefly and repeatedly until an optimal reception is found.
- 5 Repeat **step 4** if necessary until you find the desired radio station.

Presetting radio stations

You can preset up to 40 stations regardless of the reception.

- 1 Tune to your desired radio station (refer to "Tuning to radio stations").
- 2 Press **PROGRAM**.
→ "PROG" icon appears.
- 3 Use the **numeric keypad (0-9)** to select the desired preset number:
→ If "PROG" icon goes off before you select the desired preset number; press PROGRAM again.

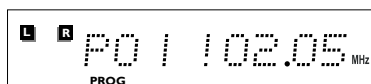

- 4 Press **PROGRAM** again to store the radio station.
- Repeat **steps 1–4** to store other radio stations.

Helpful Hints:

– During programming, if no key is pressed within five seconds, the system will exit the programme mode automatically.

Listening to preset radio stations

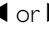
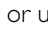
- In tuner mode, press  or  or use the **numeric keypad (0-9)** to select the desired preset number:
→ The preset number, radio frequency, and waveband are displayed.

Other Functions

Volume control

Adjust **VOLUME** button (or press **VOL + / -**) to increase or decrease the volume level.
 → "VOL XX" is displayed. "XX" denotes the volume level.

To listen through the headphones

- Connect the headphones plug to the **PHONES** socket at the front of the player.
 → The speakers will be muted.

To switch off the volume temporarily

- Press **MUTE** on the remote.
 → Playback will continue without sound and "MUTE" is displayed.
- To restore the volume, press **MUTE** again.

Selecting surround sound

IMPORTANT!

This DVD micro system can only produce 2.1 channel surround sound.

- Press **SURROUND** on the remote to select surround or stereo mode.
 → The availability of the various surround sound modes (Dolby Digital Surround, DTS Surround, Virtual Surround Sound) depends on the number of speakers used and the incoming sound information available on the disc.

Selecting the digital sound effect

The digital sound effects allow you to select from various pre-set modes that control the frequency bands of sound to optimise certain musical styles. It greatly enhances the excitement and enjoyment of your favourite music.

- Press **SOUND** on the remote repeatedly to select the available sound effect.

When playing a DVD/VCD/SVCD, select :

- CONCERT, DRAMA, ACTION or SCI-FI

When playing a CD/MP3 or in Tuner or Aux mode, select :

- CLASSIC, JAZZ, ROCK or DIGITAL

Dimming the display screen

- Press **DIM** repeatedly to select different levels of brightness for the display screen : **HIGH**, **MID** or **LOW**.

Adjusting Bass/Treble level

The **BASS** (low tone) and **TREBLE** (high tone) features enable you to define the sound-processor settings.

- 1 Press **BASS** or **TREBLE**.
- 2 Within five seconds, use the **VOLUME** control to adjust the Bass or Treble level.
 → If the volume control is not used within five seconds, it will resume its normal volume control function.
 → If headphone is connected, it will disable the bass/treble controls.

Using the remote to operate your Philips television

- 1 Press **AV** on the remote.
- 2 Press **◀◀** or **▶▶** or use the **numeric keypad (0-9)** to select the TV's channel.
- 3 Press **TV VOL + / -** to adjust the TV's volume level.
- 4 Press **⏻** to turn off your TV.

Sleep timer setting

The sleep timer enables the system to switch to standby mode automatically at a preset time.

- 1 Press **SLEEP** on the remote repeatedly to select a preset time.
 → The selections are as follows (time in minutes):
 15 → 30 → 45 → 60 → 90 → 120 → OFF → 15...



- 2 When you reach the desired length of time, stop pressing the **SLEEP** button.
 → "SLEEP" icon appears.

To check the remaining length of time after sleep timer is activated

- Press **SLEEP** once.

To change the preset sleep timer

- Press **SLEEP** again while the remaining sleep timer is shown.
 → The display will show the next sleep timer options.

To deactivate the sleep timer

- Press **SLEEP** repeatedly until "OFF" is displayed, or press the **STANDBY ON** **⏻** button.

AMPLIFIER SECTION

| | |
|-------------------------------------|------------------------------|
| Output power | 2 x 25 W |
| Total Harmonic Distortion | 10% at rated power (1 kHz) |
| Frequency Response | 180 Hz – 14 kHz / ± 1 dB |
| Signal-to-Noise Ratio | > 65 dB (CCIR) |
| Input Sensitivity (AUX/TV IN) | 400 mV |

TUNER SECTION

| | |
|----------------------------------|----------------------------------|
| Tuning Range | FM 87.5 – 108 MHz (50 kHz steps) |
| | MW 531 – 1602 kHz (9 kHz steps) |
| 26 dB Quieting Sensitivity | FM 20 dB |
| | MW 5000 μ V/m |
| Image Rejection Ratio | FM 25 dB |
| | MW 28 dB |
| IF Rejection Ratio | FM 60 dB |
| | MW 24 dB |
| Signal-to-Noise Ratio | FM 55 dB |
| | MW 35 dB |
| AM Suppression Ratio | FM 30 dB |
| Harmonic Distortion | FM Mono 3% |
| | FM Stereo 3% |
| | MW 5% |
| Frequency Response | FM 180 Hz – 10 kHz / ± 6 dB |
| Stereo Separation | FM 26 dB (1 kHz) |
| Stereo Threshold | FM 23.5 dB |

DVD SECTION

| | |
|------------------------------|------------------------------|
| Laser Type | Semiconductor |
| Disc Diameter | 12cm / 8cm |
| Video Decoding | MPEG-2 |
| Video DAC | 10 Bits |
| Signal System | PAL / NTSC |
| Video Format | 4:3 / 16:9 |
| Video S/N | 56 dB (minimum) |
| Composite Video Output | 1.0 Vp-p, 75 Ω |
| S-Video Output | Y - 1.0 Vp-p, 75 Ω |
| | C - 0.286 Vp-p, 75 Ω |
| Audio DAC | Direct Digital Amplification |
| Frequency Response | 4 Hz – 20 kHz (44.1 kHz) |
| | 4 Hz – 22 kHz (48 kHz) |
| | 4 Hz – 44 kHz (96 kHz) |
| Digital Output | SPDIF Coaxial |

MISCELLANEOUS

| | |
|------------------------------|--------------------------|
| Power Supply Rating | 220 – 240 V / 50 Hz |
| Power Consumption | 80 W |
| - Eco Power standby | < 1 W |
| Dimensions (w x h x d) | 180 mm x 135 mm x 300 mm |
| Weight | 3.7 kg |

SPEAKERS

| | |
|------------------------------|------------------------------|
| System | 2-way shielded |
| Impedance | 8 Ω |
| Speaker drivers | 2 x 2" woofer; 1.75" tweeter |
| Dimensions (w x h x d) | 180 mm x 135 mm x 208 mm |
| Weight | 1.75 kg/each |

Specifications subject to change without prior notice

Troubleshooting

WARNING!

Under no circumstances should you try to repair the system yourself, as this will invalidate the warranty. Do not open the system as there is a risk of electric shock.

If a fault occurs, first check the points listed below before taking the system for repair. If you are unable to solve a problem by following these hints, consult your dealer or service centre.

| Problem | Solution |
|------------------------------------------------------------------------------------------------|------------------------------------------------------------------------------------------------------------------------------------------------------------------------------------------------------------------------------------------------------------------------------------------------------------------------------------------------------------------------------------------------------------------------------------------------------------------------------------------------------------|
| No power. | <ul style="list-style-type: none"> – Check if the AC power cord is properly connected. – Press STANDBY ON on the top of the DVD micro system to turn on the power. |
| No picture. | <ul style="list-style-type: none"> – Check if the TV is switched on. – Check the video connection. – Press DISC on the remote. – Set your TV to the correct Video In channel. This channel is usually near channel 00. Or, you may have a button on the TV remote control that selects Auxiliary or A/V IN channel. See your TV owner's manual for details. Or, change channels at the TV until you see DVD screen on the TV. |
| Distorted or poor picture. | <ul style="list-style-type: none"> – Sometimes a small amount of picture distortion may appear. This is not a malfunction. – Clean the disc. |
| Completely distorted picture or black/white picture. | <ul style="list-style-type: none"> – TV has a colour system standard. If the disc's or DVD system's colour system is different than your TV's colour system, the picture may be distorted or colourless. Set to the correct 'TV SYSTEM' setting. |
| The aspect ratio of the screen cannot be changed even though you have set the TV shape. | <ul style="list-style-type: none"> – The aspect ratio is fixed on the DVD disc. – Depending on the TV, it may not be possible to change the aspect ratio. |
| No sound or distorted sound. | <ul style="list-style-type: none"> – Adjust the volume. – Check that the speakers are connected correctly. – Replace the speaker cables. – Disconnect the headphones. – The system is in pause, slow motion or fast forward/reverse mode, press PLAY to resume normal play mode. |
| The micro DVD player does not start playback. | <ul style="list-style-type: none"> – Insert a readable disc with the playback side facing down. – Check the disc type, colour system and regional code. Check for any scratches or smudges on the disc. – Press SYSTEM MENU to turn off the setup menu screen. – Cancel the parental control rating function or change the rating level. – Moisture has condensed inside the system. Remove the disc and leave the system turned on for about an hour. |
| The DVD micro system does not respond when the buttons are pressed. | <ul style="list-style-type: none"> – Disconnect the power plug from the outlet and insert again. |
| Cannot activate some features, such as Angles, Subtitles, or multi-language Audio. | <ul style="list-style-type: none"> – Multi-language sound or subtitle is not recorded on the DVD. – Changing the language for the sound or subtitle is prohibited on the DVD. – The features may not be available on the disc. |
| Considerable noise in radio broadcasts. | <ul style="list-style-type: none"> – Tune in to the correct frequency. – Connect the antennas. – Fully extend the FM wire antenna. Position for best reception and secure to a wall. – Connect an outdoor FM or MW antenna. – Adjust the direction and position for best reception. – Place the antenna farther away from any equipment that may be causing the noise. – Increase the distance between the system and your TV or VCR. |
| The remote control does not function. | <ul style="list-style-type: none"> – Select the correct source (DISC or TUNER, for example) before pressing the function button. – Point the remote control at the remote sensor of the unit. – Reduce the distance to the player. – Remove any possible obstacles. – Replace the batteries with new ones. – Check that the batteries are loaded correctly. |
| The display is dark. | <ul style="list-style-type: none"> – Press DIM again. |
| Low hum or buzz sound. | <ul style="list-style-type: none"> – Place the DVD micro system as far away as possible from electrical devices that may be causing interference. |
| Low bass response. | <ul style="list-style-type: none"> – Check all speakers for correct polarity. |

Aspect ratio: The ratio of vertical and horizontal sizes of a displayed image. The horizontal vs. vertical ratio of conventional TVs is 4:3, and that of wide-screens is 16:9.

AUDIO OUT Jacks: Jacks on the back of the DVD System that send audio to another system (TV, Stereo, etc.).

Bit Rate: The amount of data used to hold a given length of music; measured in kilobits per seconds, or kbps. Or, the speed at which you record. Generally, the higher the bit rate, or the higher the recording speed, the better the sound quality. However, higher bit rates use more space on a Disc.

Chapter: Sections of a picture or a music piece on a DVD that are smaller than titles. A title is composed of several chapters. Each chapter is assigned a chapter number enabling you to locate the chapter you want.

Disc menu: A screen display prepared for allowing selection of images, sounds, subtitles, multi-angles, etc recorded on a DVD.

Dolby Digital: A surround sound system developed by Dolby Laboratories containing up to six channels of digital audio (front left and right, surround left and right and centre).

DTS: Digital Theatre Systems. This is a surround sound system, but it is different from Dolby Digital. The formats were developed by different companies.

JPEG: A still-picture data compression system proposed by the Joint Photographic Expert Group, which features small decrease in image quality in spite of its high compression ratio.

MP3: A file format with a sound data compression system. "MP3" is the abbreviation of Motion Picture Experts Group 1 (or MPEG-1) Audio Layer 3. By using MP3 format, one CD-R or CD-RW can contain about 10 times as much data volume as a regular CD can.

Parental control: A function of the DVD to limit playback of the disc by the age of the users according to the limitation level in each country. The limitation varies from disc to disc; when it is activated, playback will be prohibited if the software's level is higher than the user-set level.

PCM (Pulse Code Modulation): A system for converting analogue sound signal to digital signal for later processing, with no data compression used in conversion.

Playback control (PBC): Refers to the signal recorded on video CDs or SVCDs for controlling reproduction. By using menu screens recorded on a Video CD or SVCD that supports PBC, you can enjoy interactive-type software as well as software having a search function.

Region code: A system for allowing discs to be played back only in the region designated beforehand. This unit will only play discs that have compatible region codes. You can find the region code of your unit by looking on the product label. Some discs are compatible with more than one region (or ALL regions).

S-Video: Produces a clear picture by sending separate signals for the luminance and the colour. You can use S-Video only if your TV has S-video In jack.

Sampling Frequency: Frequency of sampling data when analogue data is converted to digital data. Sampling frequency numerically represents how many times the original analogue signal is sampled per second.

Surround: A system for creating realistic three-dimensional sound fields full of realism by arranging multiple speakers around the listener.

Title: The longest section of a picture or music feature on DVD, music, etc., in video software, or the entire album in audio software. Each title is assigned a title number enabling you to locate the title you want.

VIDEO OUT jack: Jack on the back of the DVD System that sends video to a TV.