



# SmartBalance Free Floor Standing

## FS484F LED125S/840 PSD-T MLO ACL WH

SmartBalance FFS - LED Module, system flux 12,500 lm - 840 neutral white - Power supply unit with DALI touch-switch & dimming interface - Micro-lens optic - ActiLume - White

Free floor-standing luminaires are loved by customers as the ideal solution for personally controlled, flexible and comfortable lighting. SmartBalance is the next step in free floor-standing luminaires. Thanks to the application of state-of-the-art LED technology, it offers not only increased energy efficiency, but also a compact and clean design that blends into any environment. SmartBalance is also available in recessed, surface-mounted and suspended versions.

### Product data

General Information		Optical cover/lens type	
Number of light sources	1 pc	Optical cover/lens type	Micro-lens optic
Lamp family code	LED125S [ LED Module, system flux 12,500 lm]	Luminaire light beam spread	114°
Light source color	840 neutral white	Embedded control	ActiLume
Cap-Base	- [-]	Control interface	DALI
Light source replaceable	No	Separate switching	-
Number of gear units	2 units	Connection	Connection unit 3-pole
Gear	-	Cable	Cable 3.0 m with europlug connector 3-pole
Driver/power unit/transformer	Power supply unit with DALI touch-switch & dimming interface	Protection class IEC	Safety class I
Driver included	Yes	Glow-wire test	Temperature 650 °C, duration 30 s
Optic type	-	Flammability mark	For mounting on normally flammable surfaces
		CE mark	CE mark
		ENEC mark	ENEC plus mark

# SmartBalance Free Floor Standing

Warranty period	5 years
Constant light output	No
Number of products on MCB of 16 A type B	10
RoHS mark	RoHS mark
Accessory PFC	N/A
Product family code	FS484F [ SmartBalance FFS]

## Operating and Electrical

Input Voltage	220-240 V
Input Frequency	50 to 60 Hz
Control signal voltage	0-16 V DC DALI
Inrush current	50 A
Inrush time	2 ms
Power Factor (Min)	0.9

## Controls and Dimming

Dimmable	Yes
----------	-----

## Mechanical and Housing

Housing Material	Aluminum
Reflector material	Aluminum
Optic material	-
Optical cover/lens material	Acrylate and polycarbonate
Gear tray material	Steel
Fixation material	-
Optical cover/lens finish	Opal
Overall length	700 mm
Overall width	250 mm
Overall height	2000 mm

## Approval and Application

Ingress protection code	IP40 [ Wire-protected]
Mech. impact protection code	IK02 [ 0.2 J standard]

## Initial Performance (IEC Compliant)

Initial luminous flux (system flux)	12500 lm
-------------------------------------	----------

Luminous flux tolerance	+/-10%
Initial LED luminaire efficacy	125 lm/W
Init. Corr. Color Temperature	4000 K
Init. Color Rendering Index	≥80
Initial chromaticity	(0.43, 0.40) SDCM <3
Initial input power	100 W
Power consumption tolerance	+/-10%

## Over Time Performance (IEC Compliant)

Driver failure rate at 5000 h	1 %
Median useful life L70B50	80000 h
Median useful life L80B50	50000 h
Median useful life L90B50	25000 h

## Application Conditions

Ambient temperature range	+10 to +40 °C
Average ambient temperature	25 °C
Maximum dim level	1%
Suitable for random switching	Yes (relates to presence/ movement detection and daylight harvesting)

## Product Data

Full product code	871794310539700
Order product name	FS484F LED125S/840 PSD-T MLO ACL WH
EAN/UPC - Product	8717943105397
Order code	910504094503
Numerator - Quantity Per Pack	1
Numerator - Packs per outer box	1
Material Nr. (12NC)	910504094503
Net Weight (Piece)	16.900 kg

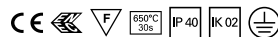

## Dimensional drawing

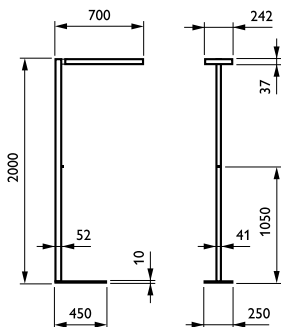

SmartBalance FS484F

## SmartBalance Free Floor Standing

