



SmartBalance Free Floor Standing

FS484F LED120S/830 PSD-T MLO ACL CCH WH

SmartBalance FFS - LED Module, system flux 12,000 lm - 830 warm white - Power supply unit with DALI touch-switch & dimming interface - Micro-lens optic - ActiLume - Cable 3.0 m with Swiss plug 3-pole - White

Free floor-standing luminaires are loved by customers as the ideal solution for personally controlled, flexible and comfortable lighting. SmartBalance is the next step in free floor-standing luminaires. Thanks to the application of state-of-the-art LED technology, it offers not only increased energy efficiency, but also a compact and clean design that blends into any environment. SmartBalance is also available in recessed, surface-mounted and suspended versions.

Product data

General Information	
Number of light sources	1 pc
Lamp family code	LED120S [LED Module, system flux 12,000 lm]
Light source color	830 warm white
Cap-Base	- [-]
Light source replaceable	No
Number of gear units	2 units
Gear	-
Driver/power unit/transformer	Power supply unit with DALI touch-switch & dimming interface
Driver included	Yes

Optic type	-
Optical cover/lens type	Micro-lens optic
Luminaire light beam spread	114°
Embedded control	ActiLume
Control interface	DALI
Separate switching	-
Connection	Connection unit 3-pole
Cable	Cable 3.0 m with Swiss plug 3-pole
Protection class IEC	Safety class I
Glow-wire test	Temperature 650 °C, duration 30 s
Flammability mark	For mounting on normally flammable surfaces

SmartBalance Free Floor Standing

CE mark	CE mark
ENEC mark	ENEC plus mark
UL mark	-
Warranty period	5 years
Constant light output	No
Number of products on MCB of 16 A type B	10
RoHS mark	RoHS mark
Accessory PFC	N/A
Product family code	FS484F [SmartBalance FFS]

Operating and Electrical

Input Voltage	220-240 V
Input Frequency	50 to 60 Hz
Control signal voltage	0-16 V DC DALI
Inrush current	50 A
Inrush time	2 ms
Power Factor (Min)	0.9

Controls and Dimming

Dimmable	Yes
----------	-----

Mechanical and Housing

Housing Material	Aluminum
Reflector material	Aluminum
Optic material	-
Optical cover/lens material	Acrylate and polycarbonate
Gear tray material	Steel
Fixation material	-
Optical cover/lens finish	Opal
Overall length	700 mm
Overall width	250 mm
Overall height	2000 mm

Approval and Application

Ingress protection code	IP40 [Wire-protected]
Mech. impact protection code	IK02 [0.2 J standard]

Initial Performance (IEC Compliant)

Initial luminous flux (system flux)	12000 lm
Luminous flux tolerance	+/-10%
Initial LED luminaire efficacy	119 lm/W
Init. Corr. Color Temperature	3000 K
Init. Color Rendering Index	≥80
Initial chromaticity	(0.43, 0.40) SDCM <3
Initial input power	101 W
Power consumption tolerance	+/-10%

Over Time Performance (IEC Compliant)

Driver failure rate at 5000 h	1 %
Median useful life L70B50	80000 h
Median useful life L80B50	50000 h
Median useful life L90B50	25000 h

Application Conditions

Ambient temperature range	+10 to +40 °C
Average ambient temperature	25 °C
Maximum dim level	1%
Suitable for random switching	Yes (relates to presence/ movement detection and daylight harvesting)

Product Data

Full product code	871794311111400
Order product name	FS484F LED120S/830 PSD-T MLO ACL CCH WH
EAN/UPC - Product	8717943111114
Order code	910504095603
Numerator - Quantity Per Pack	1
Numerator - Packs per outer box	1
Material Nr. (12NC)	910504095603
Net Weight (Piece)	16.900 kg

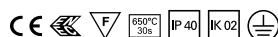

Dimensional drawing

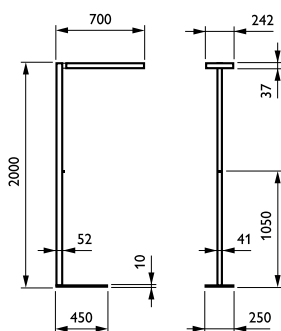

SmartBalance FS484F

SmartBalance Free Floor Standing

