



CoreLine Surface-mounted

SM120V LED27S/830 PSD W20L120 VAR-PC

Coreline Surface - LED Module, system flux 2700 lm - 830 warm white - Power supply unit with DALI interface - Width 0.20 m, length 1.20 m - Variable linear-lens array in polycarbonate cover

Whether for a new building or renovation of an existing space, customers want lighting solutions that provide quality of light and substantial energy and maintenance savings. The new CoreLine Surface-mounted range of LED products can be used to replace functional luminaires in general lighting applications. The process of selecting, installing and maintaining is so easy – it's a simple switch.

Product data

General Information			
Number of light sources	2 pcs	Emergency lighting	-
Lamp family code	LED27S [LED Module, system flux 2700 lm]	Control interface	DALI
Light source color	830 warm white	Connection	Push-in connector and pull relief
Cap-Base	- [-]	Cable	-
Light source replaceable	No	Protection class IEC	Safety class I
Number of gear units	1 unit	Glow-wire test	Temperature 850 °C, duration 30 s
Gear	-	Flammability mark	For mounting on normally flammable surfaces
Driver/power unit/transformer	Power supply unit with DALI interface	Safety device	No [-]
Driver included	Yes	CE mark	CE mark
Optic type	Wide beam	ENEC mark	ENEC mark
Optical cover/lens type	Variable linear-lens array in polycarbonate cover	UL mark	-
Luminaire light beam spread	75°	Warranty period	5 years
		Constant light output	No

CoreLine Surface-mounted

Number of products on MCB of 16 A type B 38	
RoHS mark	RoHS mark
Product family code	SM120V [Coreline Surface]
Operating and Electrical	
Input Voltage	220 to 240 V
Input Frequency	50 to 60 Hz
Inrush current	14.7 A
Inrush time	0.25 ms
Power Factor (Min)	0.9
Controls and Dimming	
Dimmable	Yes
Mechanical and Housing	
Geometry	Width 0.20 m, length 1.20 m
Housing Material	Steel
Reflector material	Steel
Optic material	Polycarbonate
Optical cover/lens material	Polycarbonate
Gear tray material	Steel
Fixation material	Steel
Optical cover/lens finish	Textured
Overall length	1197 mm
Overall width	197 mm
Overall height	36 mm
Approval and Application	
Ingress protection code	IP20 [Finger-protected]
Mech. Impact protection code	IK02 [0.2 J standard]
Initial Performance (IEC Compliant)	
Initial luminous flux (system flux)	2700 lm

Luminous flux tolerance	+/-10%
Initial LED luminaire efficacy	115 lm/W
Init. Corr. Color Temperature	3000 K
Init. Color Rendering Index	≥80
Initial chromaticity	(0.43, 0.40) SDCM <3
Initial input power	23.1 W
Power consumption tolerance	+/-10%
Over Time Performance (IEC Compliant)	
Driver failure rate at 5000 h	1 %
Median useful life L70B50	50000 h
Median useful life L80B50	30000 h
Median useful life L90B50	15000 h
Application Conditions	
Ambient temperature range	+10 to +40 °C
Average ambient temperature	25 °C
Maximum dim level	1%
Suitable for random switching	Yes (relates to presence/ movement detection and daylight harvesting)
Product Data	
Full product code	871829126663100
Order product name	SM120V LED27S/830 PSD W20L120 VAR-PC
EAN/UPC - Product	8718291266631
Order code	910501997603
Numerator - Quantity Per Pack	1
Numerator - Packs per outer box	1
Material Nr. (12NC)	910501997603
Net Weight (Piece)	3.100 kg



Dimensional drawing

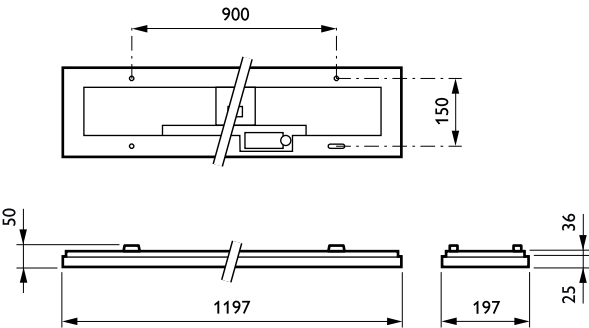

CoreLine Surface-mounted SM120V

CoreLine Surface-mounted

