

MOTORIZED MOBILE FLAT SCREEN TV CART, 28 CM OF VERTICAL TRAVEL

COLUMN BLACK ANODIZED, H-STYLE BASE

PRODUCT

Motorized flat screen tv cart & mobile monitor stand for 42"-100" (interactive) Flat-Panel displays.

Renowned for its stability and versatility the SCETA28B mobile monitor stand has been Conen Mounts worldwide best-selling mobile stand for many years. The monitor stand is designed to withstand intensive daily use and to safely support displays up to 100" or 136 kg. The SCETA28B tv cart features the standard center column, offering 28 cm of smooth motorized height adjustment.

For user convenience and to enhance the teaching experience the stand allows for several accessories to be mounted, including PC shelves, handles and whiteboard side wings.

Product ships flat-packed. Cartons are courier shippable.

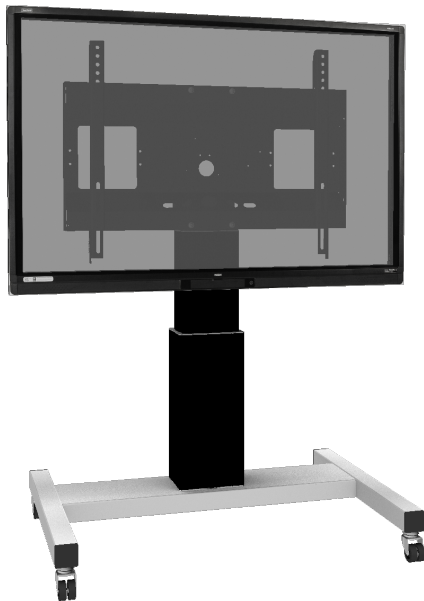

Accessories



Keyboard shelf



Extender for 2-part height adjustable aluminum columns

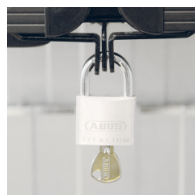

Brackets and wing lock for locking the side wings in front of the display



Front shelf

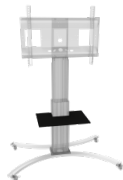

Front shelf



Front shelf

FEATURES

- > Heavy duty mobile tv cart for displays up to 100"
- > Easy mounting of display thanks to "pull & release" brackets
- > Display mount with integrated cable management
- > Wide range of accessories available
- > Actuator safely concealed in center column offering 28 cm of vertical travel
- > Wired remote is standard included
- > Robust H-style base designed to withstand intensive daily use



Display mount



Mobile



Motorized height adjustable



Single display



5 years warranty



Max. load
136 kg / 299.8 lbs



Max. Vesa
800 x 600

| | | |
|---------------------------------|---|-----------------------|
| Item number | SCETA28B | |
| Vesa horizontal / Vesa vertical | 300 mm - 800 mm / 200 mm - 600 mm | |
| Frame for all | 42" - 100" | |
| Center to floor distance | 865 mm - 1145 mm | 34.1" - 45.1" |
| Load capacity | 136 kg | 299.8 lbs |
| Weight | 55,8 kg | 123 lbs |
| Warranty | 5 years limited warranty | |
| Frame color | RAL 9005 deep black | |
| Column color | Black anodized | |
| Chassis color | RAL 9005 deep black | |
| Packages | Package dimensions WxHxD | Package weight |
| AF-SCETA-N | 900 x 160 x 450 mm / 35.4 x 6.3 x 17.7" | 13,6 kg / 30 lbs |
| CCE-28WB | 680 x 270 x 220 mm / 26.8 x 10.6 x 8.7" | 18 kg / 39.7 lbs |
| MST-SCETAB | | |

DIMENSIONS

in mm / inch

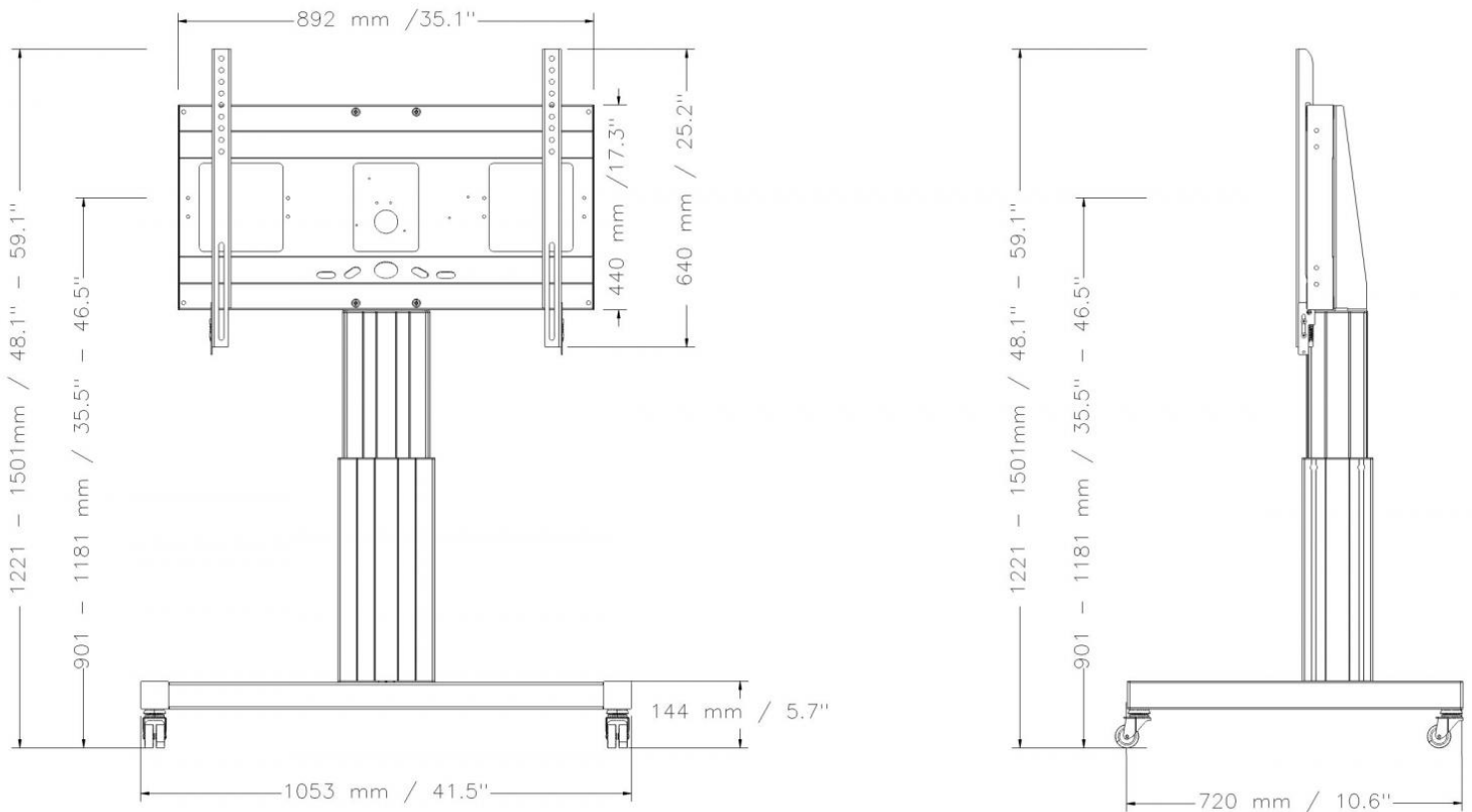

MANUFACTURER:

CONEN Produkte GmbH
 Conenstr. 4
 54497 Morbach-Gonzerath

Phone: +49 (0) 6533 75-100
 Fax: +49 (0) 6533 75-600
 E-Mail: info@conenmounts.com

Germany

www.conenmounts.com