

# Jabra Move Style Edition



## User manual

1. WELCOME.....	3
2. WHAT'S IN THE BOX.....	4
3. HOW TO WEAR.....	5
3.1 HEIGHT ADJUSTMENT	
4. HOW TO CHARGE.....	6
4.1 BATTERY STATUS	
5. HOW TO CONNECT.....	7
5.1 BLUETOOTH CONNECT TO A NEW OR SECOND MOBILE DEVICE	
5.2 CONNECT TO 3.5 MM JACK CONNECTOR	
6. HOW TO USE .....	9
6.1 MUSIC & CHAT	
6.2 TURN HEADPHONES ON/OFF	
6.3 MULTIPLE CALL HANDLING	
6.4 VOICE GUIDANCE	
7. SUPPORT .....	13
7.1 FAQ	
7.2 FACTORY RESET	
7.3 HOW TO CARE FOR YOUR HEADPHONES	
8. TECHNICAL SPECIFICATIONS .....	14

# 1. WELCOME

Thank you for purchasing the Jabra Move Style Edition. We hope you will enjoy it!

## **JABRA MOVE STYLE EDITION FEATURES**

- Premium wireless sound experience - amplifies without distortion. Brings out the depth and clarity of your music
- Seals the sound - angled earcups allow you to hear all the music
- Easily connect with any device via Bluetooth 4.0
- Life proof - lightweight, comfortable headphones built & tested for life on the move
- Premium materials - stainless steel
- Wired option - detachable cord for when you need to be wired

## 2. WHAT'S IN THE BOX

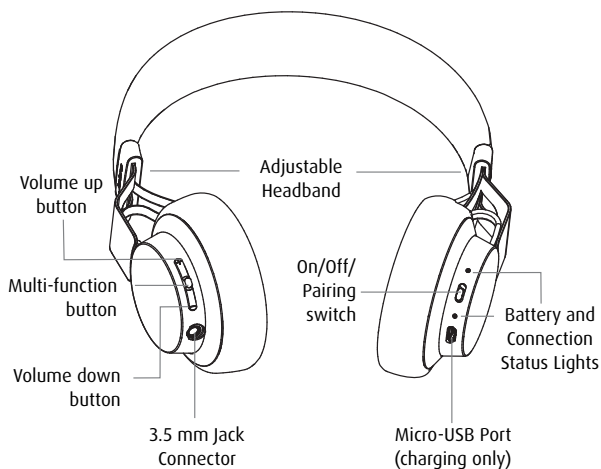

Micro-USB cable



Audio cable

## 3. HOW TO WEAR

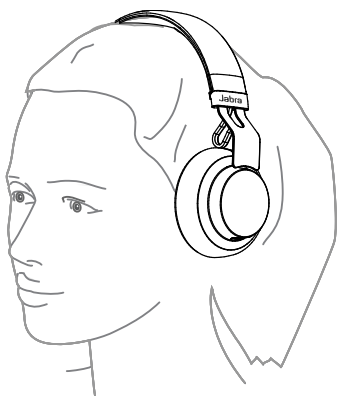

### 3.1 HEIGHT ADJUSTMENT

---

Get the perfect fit by adjusting the headband, as illustrated.

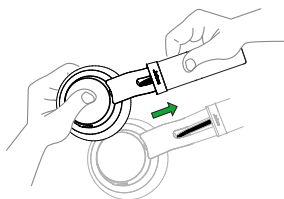

## 4. HOW TO CHARGE

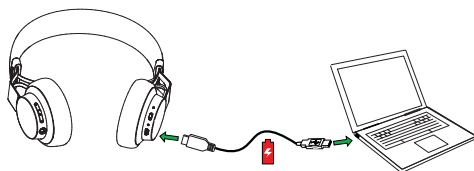

Plug the headphones into any available USB port on your PC using any micro-USB cable.



### 4.1 BATTERY STATUS

---

Tap the Multi-function button when not on a call to see the battery status. It takes 1-2 hours to fully charge the headphones.

LED	COLOR	BATTERY LEVEL
	Green	Medium/High
	Red	Low
	Flashing red	Critically low

# 5. HOW TO CONNECT

The Jabra Move Style Edition will automatically attempt to Bluetooth connect to a mobile device whenever it is powered on (unless already connected to a Bluetooth device). Simply follow the voice-guided connection instructions.

## 5.1 BLUETOOTH CONNECT TO A NEW OR SECOND MOBILE DEVICE

---

1. Hold the **On/Off/Pairing** switch in the Pairing position for 3 secs.
2. Pairing mode will be announced in the headphones, and the Bluetooth light will flash blue.
3. Follow the voice-guided instructions to connect to your Bluetooth device.

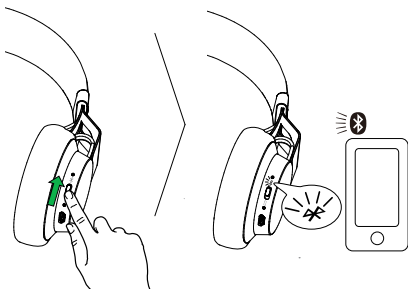

**NOTE:** If two mobile phones have been connected to the Jabra Move Style Edition, you may need to select which phone will be used for calls/music. Simply open the Bluetooth menu on the mobile phone you wish to use for calls/music and select the Jabra Move Style Edition from the list of devices.

## 5.2 CONNECT TO 3.5 MM JACK CONNECTOR

---

Connect the headphones to a 3.5 mm jack connector on your mobile device or PC using the supplied audio cable.

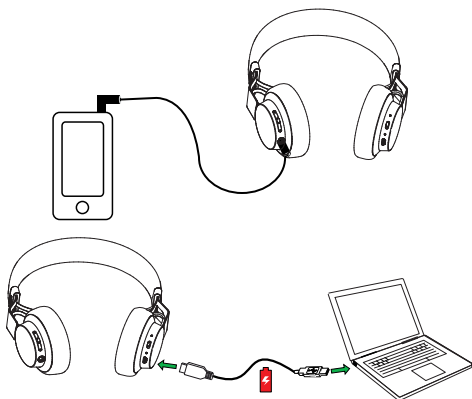

**NOTE:** Bluetooth connections are disabled when connected to the 3.5 mm Jack Connector.



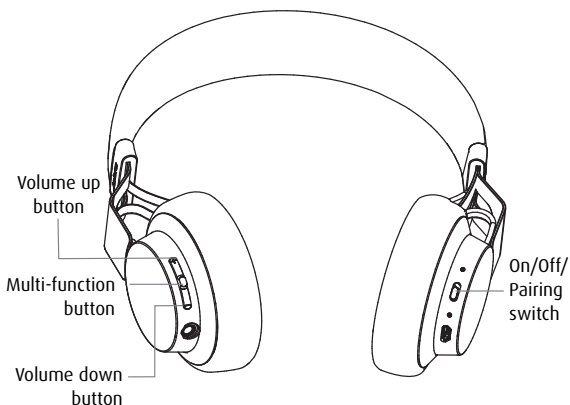

# 6. HOW TO USE



## 6.1 MUSIC & CHAT

---

The buttons on the headphones enable you to control your music and phone calls.

FUNCTION	HOW TO DO IT
 <p data-bbox="273 252 459 282">Pause/play music</p>	<p data-bbox="584 237 850 299">Tap the <b>Multi-function</b> button</p>
<p data-bbox="273 398 425 427">Adjust volume</p>	<p data-bbox="584 378 840 439">Tap the <b>Volume up</b> or <b>Volume down</b> button</p>
 <p data-bbox="273 526 377 556">Skip track</p>	<p data-bbox="584 493 855 591">Press and hold either the <b>Volume up</b> or <b>Volume down</b> button</p>
<p data-bbox="273 670 420 700">Battery status</p>	<p data-bbox="584 637 845 735">Tap the <b>Volume up</b> or <b>Volume down</b> button, when not on a call</p>
<p data-bbox="273 802 444 832">Answer/end call</p>	<p data-bbox="584 783 850 844">Tap the <b>Multi-function</b> button</p>
 <p data-bbox="273 935 382 964">Reject call</p>	<p data-bbox="584 915 855 976">Press and hold (1 sec) the <b>Multi-function</b> button</p>
<p data-bbox="273 1067 472 1096">Redial last number</p>	<p data-bbox="584 1047 827 1108">Double-tap the <b>Multi-function</b> button</p>

## 6.2 TURN HEADPHONES ON/OFF

---

Slide the **On/Off/Pairing** switch to **On** or **Off**.

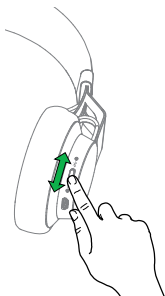

## 6.3 MULTIPLE CALL HANDLING

---

The headphones can accept and handle multiple calls simultaneously.

	FUNCTION	HOW TO DO IT
	Put current call on hold and answer incoming call	Press (2 secs) the <b>Multi-function</b> button
	Switch between held call and active call	Press (2 secs) the <b>Multi-function</b> button
	Reject incoming call	Double-tap the <b>Multi-function</b> button

---

## 6.4 VOICE GUIDANCE

---

### CLICK TO LISTEN WHAT YOU HEAR

To connect Move, go to the Bluetooth menu on your phone and select it from the list.

---

Connected

---

Disconnected

---

Connection cancelled

---

Two devices connected

---

No device connected

---

Recharge battery

---

Battery level low

---

Battery level medium

---

Battery level full

---

Voice prompts off

---

Voice prompts on

---

Redialing

---

# 7. SUPPORT

## 7.1 FAQ

---

View the full FAQ at [jabra.com/movestyle](http://jabra.com/movestyle) edition

## 7.2 FACTORY RESET

---

To factory reset the headphones and clear the pairing list, press and hold (5 secs) both the **Volume up** button and the **Multi-function** button at the same time.

## 7.3 HOW TO CARE FOR YOUR HEADPHONES

---

- Always store the headphones with the power off and safely protected.
- Avoid storage at extreme temperatures (above 85°C/185°F or below -20°C/-4°F). This can shorten battery life and may affect operation. High temperatures may also degrade performance.
- Do not expose the headphones to rain or other liquids.

## 8. TECHNICAL SPECIFICATIONS

JABRA MOVE HEADPHONES	SPECIFICATION
Weight:	150 grams
Dimensions:	H 172 mm x W 146.1 mm x L 59 mm
Microphone:	4 mm Omni-directional microphone
Speaker:	40 mm dynamic speaker
Operating range:	Up to 10 meters (33 feet)
Bluetooth version:	4.0
Paired devices:	Up to 8 devices, connected to 2 at same time (MultiUse™)
Supported Bluetooth profiles:	Headset profile v1.2, Handsfree profile v1.6, A2DP v1.2, AVRCP v1.4
Talk time:	Up to 14 hours
Standby time:	Up to 12 days
Operating temperature:	-10° C to 60° C (14 F to 140 F)
Storage temperature:	-20° C to 85° C (-4 F to 185 F)
Pairing passkey or PIN:	0000