



Philips
DVD micro music system

DVD
Bluetooth® aptX
HDMI

BTD7170

Relax with great music and movie

Obsessed with sound

Great sound & movie experience with this Philips BTD7170 DVD micro system. HiFi dome tweeters bring you detailed and natural sound. Even you can stream your music in high quality via Bluetooth with aptX and NFC offer one touch easy pairing

Enrich your sound experience

- 150W RMS maximum output power
- Treble and Bass Control for easy high and low tone settings
- Bass Reflex Speaker System delivers a powerful, deeper bass
- Digital Sound Control for optimized music style settings

Easy to use

- One-Touch with NFC-enabled smartphones for Bluetooth pairing
- FM digital tuning to preset up to 20 stations
- Motorized CD loader for convenience access

Enjoy your favorite movies and music

- Bluetooth wireless music streaming from your music devices
- HDMI 1080p upscales to high definition for sharper pictures
- HDMI ARC to access all the sound from your TV
- Play DVD, (S)VCD, MP3-CD, CD(RW) and Picture CD
- Karaoke for endless singing entertainment at home

PHILIPS

Highlights

Bluetooth wireless streaming

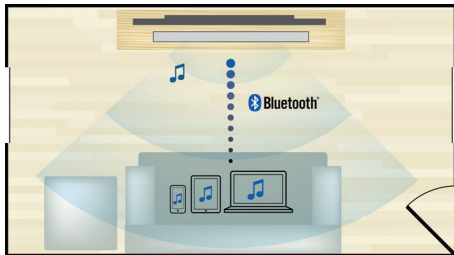

Bluetooth wireless music streaming from your music devices

NFC technology

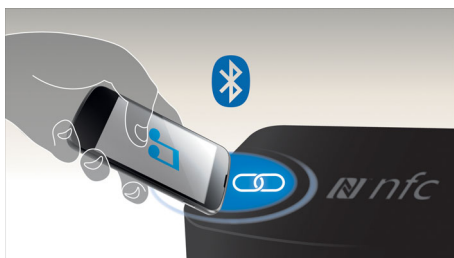

Pair Bluetooth devices easily with one-touch NFC (Near Field Communications) technology. Just tap the NFC enabled smartphone or tablet on the NFC area of a speaker to turn the speaker on, start Bluetooth pairing, and begin streaming music.

HDMI 1080p



HDMI 1080p upscaling delivers images that are crystal clear. Movies in standard definition can now be enjoyed in true high definition resolution - ensuring more details and more true-to-life pictures. Progressive Scan (represented by "p" in "1080p") eliminates the line structure prevalent on TV screens, again ensuring relentlessly sharp images. To top it off, HDMI makes a direct digital connection that can carry uncompressed digital HD video as well as digital multichannel audio, without conversions to analog - delivering perfect picture and sound quality, completely free from noise.

HDMI ARC

HDMI ARC to access all the sound from your TV

Play DVD, VCD, MP3-CD, CD(RW) & Pict



The Philips player is compatible with most DVD and CD discs available in the market. DVD, (S)VCD, MP3-CD, CD(RW) and Picture CD - all of them can play on the player. SVCD stands for "Super VideoCD". The quality of a SVCD is much better than a VCD, especially much more sharpen picture than a VCD because of the higher resolution. CD(RW) is a shorthand term for a CD drive that can accept the common rewritable CD format.

Treble and Bass Control

Treble and bass are equalizer features that control the high and low frequency sound levels of your audio respectively. Treble specifically regulates the amplification of the high tones in the music while bass controls the amplification level of the low tones. Using the up and down keys, the listener can conveniently place more or less emphasis on the low and high tones, or leave treble and bass flat to playback music according to its original recorded setting. Treble and Bass Control lets you listen to your music the way you like it.

Specifications

Sound

- Sound System: Dolby Digital
- Maximum output power (RMS): 150W
- Sound Enhancement: Treble and Bass Control

Loudspeakers

- Speaker drivers: 5.25" woofer
- Loudspeaker types: Dome tweeter
- Main Speaker: 2 way

Video Playback

- Playback Media: DivX, DVD-Video, Picture CD, Video CD/SVCD, DVD+R/+RW, DVD-R/-RW
- Disc Playback Modes: A-B Repeat, Angle, PBC, Slow Motion, Zoom, Parental control, Disc Menu, Fast Backward, Fast Forward, OSD, Resume Playback from Stop
- DVD Region.: 3
- Video Enhancement: Progressive Scan, Video Upscaling

Audio Playback

- Playback Media: MP3-CD, CD, CD-R, CD-RW
- Disc Playback Modes: Fast Forward/Backward, Next/Previous Track Search, Repeat Play
- USB Direct Modes: Fast Backward/Fast Forward, Play/Pause, Previous/Next, Repeat, Stop

Still Picture Playback

- Picture Compression Format: JPEG
- Picture Enhancement: Slideshow with MP3 playback
- Playback Media: Picture CD, CD-R/RW, DVD+R/+RW

Tuner/Reception/Transmission

- Tuner Bands: FM Stereo
- Auto digital tuning
- Tuner Enhancements: Auto Store
- Station presets: 20

- Antenna: FM antenna
- RDS: Program Type, Station Name

Connectivity

- HDMI 1: HDMI (Audio Return Channel)
- Video Output - Analog: Composite CVBS (yellow cinch)
- Bluetooth profiles: A2DP
- Audio Connections: Analogue Audio In (L/R)
- USB: USB host
- Microphone: Microphone socket
- Headphone: 3.5 mm
- Bluetooth: Support Aptx code c

Convenience

- Alarms: CD Alarm, Sleep timer, Radio Alarm, USB alarm
- Clock: On main display
- Indications: DIM mode

Accessories

- Included accessories: Composite video cable (Y), AC Power Cord
- User Manual: Multi-languages
- Remote control

Dimensions

- Gross weight: 10.6 kg
- Main unit depth: 240 mm
- Main unit height: 145 mm
- Main unit width: 230 mm
- Main speaker dimensions (W x D): 173 x 241 mm
- Main speaker height: 261 mm
- Packaging depth: 589 mm
- Packaging height: 309 mm
- Packaging width: 330 mm
- Net weight: 9.4 kg

Power

- Power supply: 110-240V, 50/60 Hz



Issue date 2017-03-30

Version: 3.0.2

12 NC: 8670 001 13163
EAN: 87 12581 71547 2

© 2017 Koninklijke Philips N.V.
All Rights reserved.

Specifications are subject to change without notice.
Trademarks are the property of Koninklijke Philips N.V.
or their respective owners.

www.philips.com